

ARCHER, CATHRO
AND ASSOCIATES LTD.
CONSULTING GEOLOGICAL ENGINEERS

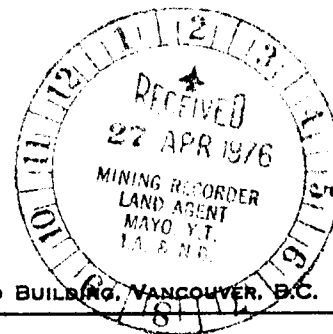

Box 4127, WHITEHORSE, Y.T. Y1A 3S9 667-4415

STANDARD BUILDING, VANCOUVER, B.C. 688-2568

1016 STANDARD BUILDING
510 WEST HASTINGS STREET
VANCOUVER, B.C.
V6B 1L8

REPORT ON SOIL GEOCHEMISTRY, GEOLOGY
AND RADIOMETRIC SURVEY

BOND 1-96 CLAIMS

Mayo Mining District
Claim Sheet 106D/10

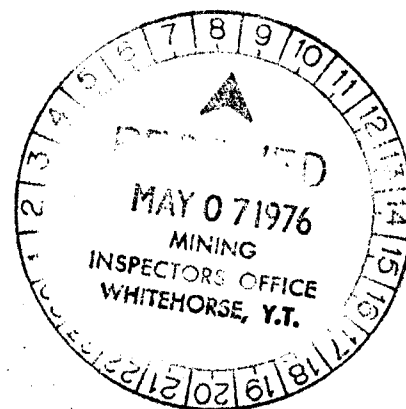

Latitude 64°40' North

Longitude 134°57' West

15 March, 1976

Alan R. Archer

Consulting Engineer

090/26

Office of The Supervising Mining Recorder
MAY - 4 1976
WHITEHORSE
Yukon Territory

Office of The Supervising Mining Recorder
MAY - 4 1976
Yukon Territory

This report has been examined by the
Geological Evaluation Unit and is recom-
mended to the Commissioner to be consid-
ered as representation work in the amount of

\$18,400.00

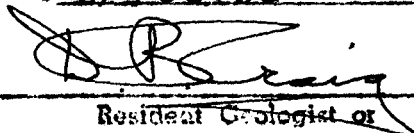

Resident Geologist or
Resident Mining Engineer

Considered as representation work under
Section 53 (4) Yukon Quartz Mining Act.

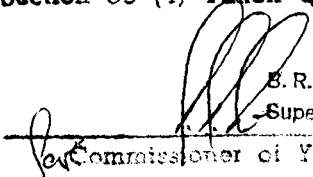
B. R. BAXTER

Supervising Mining Recorder

Per Commissioner of Yukon Territory

TABLE OF CONTENTS

<u>In Text</u>	<u>Page</u>
Introduction	1
Property, Location and Access	1
Geology and Mineralization	2
Geochemistry and Radiometrics	6
Conclusions and Recommendations	8

<u>Figures in Pocket</u>	<u>Pocket No.</u>
Figure B1 - Bond Occurrence - Geology, Scale 1"= 200 feet	1
Figure B2 - Bond Occurrence - Radiometric Survey, Scale 1"= 200 feet	1
Figure B3 - Bond Occurrence - U, Cu, Mo Geochemistry, Scale 1"= 200 feet	2
Figure B4 - Bond Occurrence - Pb, Zn, V Geochemistry, Scale 1"= 200 feet	2
Figure B5 - Bond 1A and 1B Showings - Geology and Channel Sampling Scale 1"= 100 feet; 1"= 10 feet	2
Figure B6 - Bond 2 Showing - Channel Sampling, Scale 1"= 100 feet	2
Figure B7 - Bond 2 Showing- Detailed Ground Level Radiometric Survey, Scale 1"= 5 feet	3
Figure B7A- Bond 2 Showing - Detailed Waist Level Radiometric Survey, Scale 1"= 5 feet	3

INTRODUCTION

The Bond claims cover an uranium occurrence found by Wernecke Joint Venture (Standard Oil Co. of B.C. Ltd., Aquitaine Co. of Canada Ltd., and Messrs. L & H Clay) in June, 1975 and explored by soil sampling, geological mapping, radiometric surveys, hand trenching and chip channel sampling. This work was performed on a part time basis during the period 30 July-September 1 by a field crew based at Kiwi Lake. The crew consisted of geologists U. Schmidt, A. Gregson, T. Bremner, J. Slater and field men D. Eaton , J. Dickinson and R. Dennett. The project was managed by Archer, Cathro & Associates Ltd. and supervision was provided by M.P. Phillips and the writer.

PROPERTY, LOCATION AND ACCESS

The Bond Property consists of ninety-six contiguous Bond mineral claims recorded in the Mayo Mining District as follows:

<u>Claim Name</u>	<u>Grant Numbers</u>	<u>Expiry Date</u>
Bond 1-4	Y97398-Y97401	9 June, 1976
Bond 5-56	Y97546-Y97597	27 June, 1976
Bond 57-72	YA1198-YA1213	4 Sept, 1976
Bond 73-96	YA1290-YA1313	10 Sept, 1976

The property is located at latitude 64°40' north, longitude 134°57' west on NTS claim sheet 106D/10, eighty miles northeast of Mayo. Access was by Jet Ranger helicopter from the Wernecke Joint Venture (WJV) base camp at Kiwi Lake, forty miles due north. Kiwi Lake was serviced by float equipped aircraft from Mayo, 120 miles to the southwest .

The nearest fixed-wing landing sites to the Bond claims are Hart Lake to the southwest and a rough bush airstrip on the Wind River to the northeast, each about ten miles distance. Both Hart Lake and the Wind River Trail, a winter

road, are separated from the Bond claims by rugged topography and the only possible road access is by constructing a fourteen mile tote road northeast along Bond Creek to its junction with the Wind River Trail near the airstrip. The total road distance to Mayo, via this route, would be about 130 miles.

GEOLOGY AND MINERALIZATION

The property is situated near the southern headwaters of Bond Creek, a northeast flowing tributary of the north flowing Wind River. Topography consists of a series of broad, U-shaped tributary valleys with steep headwalls and intervening ridges which fan out to the south from the wider, flat valley of Bond Creek. Vegetation is sparse, consisting of scattered clumps of low willow and alder (buck brush) with a few stunted black spruce. Alpine glaciation was locally active in the late Pleistocene and most valley bottoms have a thin veneer of glaciofluvial till.

Uranium mineralization is found in a window of Proterozoic rocks exposed through Ordovician and Silurian limestone and dolomite. The Proterozoic is mapped by the Geological Survey of Canada (Memoir 364, by L.H. Green) as undivided Unit 1 shales, argillites and quartzites. Regional mapping by WJV subdivided G.S.C. Unit 1 into six units, numbered Units 1 to 6 respectively. Only two of the WJV units are present on the Bond claims, these are (a) Unit 3, a fine grained metavolcanic with mudstone interbeds that is occasionally altered to green phyllite and (b) Unit 6, a fanglomerate or regolith. The Unit 3 metavolcanics are strongly foliated in an eastern direction and the sequence has been complexly folded. An area of approximately eight mineral claims (400 acres) was mapped in the vicinity of the two best uranium occurrences at a scale of one inch to 200 feet, as illustrated on Figure B1. Here, Unit 3 has been divided into five sub-units on the basis of colour, degree of foliation and evidence of brecciation. The most important is breccia Unit 3a which hosts most of the uranium mineralization.

It has been mapped as an intraformational breccia because of its apparent sharp boundaries and conformably attitude. Unit 3a is strongly foliated and most breccia fragments are augen shaped within a fine grained chlorite and clay rich matrix. In areas of intense foliation, individual fragments became unrecognizable and the rock develops a phyllitic texture.

In addition to the two main occurrences (called Bond 1 and Bond 2) numerous small areas of radioactive float have been found by grid prospecting, as illustrated on Figure B2.

The Bond 1 occurrence, shown in detail on Figure B5, contains three mineralized zones, called Bond 1A, 1B and 1C, that are partially exposed in a narrow, steep walled creek canyon, up to thirty feet deep, which cuts through a gentle, upland surface covered by up to ten feet of glaciofluvial till. The Bond 1A and 1B zones, both of which are covered by talus, occur diagonally across the creek from each other and may represent a single continuous zone offset a few feet by a fault in the creek. A three foot deep hand trench on the 1A zone failed to reach bedrock but did expose several large angular boulders with an aggregate thickness of 4.0 feet. The boulders average 4,980 cps with a Scintrex BGS-1S broadband scintillometer (1" by 1" crystal) but a chip sample by WJV assayed only 0.024 per cent U_3O_8 , much lower than the count suggested. A three foot chip sample collected from the same locality by H. Wober (Chevron) assayed 0.512 per cent U_3O_8 (almost exactly the value expected assuming equilibrium), 0.12 per cent $BaSO_4$, trace ThO_2 and 0.011 oz/ton silver. The boulders are composed of a mixture of dark vein quartz and siderite with minor chalcopyrite, pyrite and pyrrhotite. Although the radioactivity cannot be attributed to any specific visible mineral, it is probably caused by disseminated uraninite.

The Bond 1B occurrence is located on the west bank of the creek and is partially covered by talus. It has been explored by a twenty-six foot long, two foot deep, hand trench that exposes a radioactive barite-siderite-quartz vein containing a trace of pyrite and chalcopyrite. The vein is at least thirteen feet wide, with a strike of about N50°W and a dip of 75° northwest. Chip channel sampling returned a weighted average grade of 0.092 per cent U_3O_8 across a true width of ten feet, and gave assays ranging from 0.004 per cent to 0.144 per cent U_3O_8 . Radioactivity across the same section averaged 2,100 cps with a BGS-1S scintillometer. This is equivalent to 0.24 per cent U_3O_8 or more than 2.5 times the actual assay. In common with the Bond 1 mineralization, no radioactive mineral has been specifically identified.

Bond 1C is an area of weak radioactivity averaging about 375 cps with a BGS-1S scintillometer. It is underlain by a strongly foliated Unit 3A metavolcanics which are well exposed by the creek canyon. The radioactive zone is about three feet wide, may crosstrend the foliation slightly, and has no related structures or accessory mineralization to distinguish it from the host rock. A three foot wide chip sample assayed 0.005 per cent U_3O_8 . It can be traced discontinuously across the canyon for a length of some forty feet before disappearing under overburden on either side.

The Bond 2 occurrence is located 3,800 feet southeast of Bond 1. Radioactivity is found in several discrete iron and manganese stained, lensoid zones in a foliated Unit 3a brecciated metavolcanics within an area of outcrop about 150 feet long and 100 feet wide. The outcrop consists of frost-broken bedrock situated on the east side of a small creek within a broad upland valley that has been scoured by alpine glaciers and then partially covered by debris from the retreating ice. Individual mineral zones more or less parallel the foliation which strikes a little north of west and dips slightly to the north.

The original bedding attitude cannot be identified due to absence of any distinct marker. A detailed radiometric survey, sketch of outcrop distribution, and assays from three lines of chip channel samples across the outcrop area are illustrated in detail on Figure B7 and summarized on Figure B6. The best individual mineralized lens occurs on the northeast side of the outcrop and is about twenty feet wide and thirty-five feet long. Channel sample line B averages 0.098 per cent U_3O_8 across twenty-one feet where it cuts across this lens. The average reading across the same twenty-one feet with the BGS-1S scintillometer is 3,180 cps, which is equivalent to 0.36 per cent U_3O_8 , or almost four times the actual assay. A comparison between assay results and radioactivity from other zones cut by the three lines of channel samples exhibit equal or even more pronounced disequilibrium. Test assaying for potassium and thorium (see Figure B6) returned normal background ranges for both metals suggesting the disequilibrium is caused by uranium daughter elements. The mineralized lenses are strongly leached and occasionally exhibit minor yellow-green staining which has been identified as iriginite, a hydrated uranium molybdenate. An autoradiograph of a polished section indicates finely disseminated radioactivity in the core of Unit 3A breccia fragments surrounded by barren rims and matrix, which presumably indicates surface leaching. The disseminated mineralization is currently being examined in polished section for identification. A specimen of mineralization (sample #732) assaying 0.26 per cent U_3O_8 was spectrographically analyzed as shown on attached Certificate No. 220.

Numerous small areas of radioactive float have also been found in talus to the south and southeast of the Bond 1 and 2 occurrences. Radioactivity is usually weak and occurs in leached Unit 3A breccia with traces of copper

oxide. The presence of several small showings of hematite and/or magnetite mineralization has been indicated by float and hematite occurs in outcrop on both sides of a small creek due north of the Bond 2 showing, at about 1,300 North on Line 4,000 East. A quartz vein near the headwaters of the small south-flowing stream on the western side of the Bond claims is weakly mineralized with chalcopyrite over a strike length of at least 1,000 feet and a width that ranges up to thirty feet. A specimen containing about twenty per cent chalcopyrite assayed 0.68 oz/ton silver and trace gold and had no associated radioactivity.

GEOCHEMISTRY AND RADIOMETRICS

An 8,800 foot baseline was established by tape and compass across the upland valley through the Bond 1 and 2 occurrences. Stations were marked along the baseline with four foot high lath pickets at 100 foot intervals. Soil samples and radiometric readings were taken on pace and compass crosslines spaced 400 feet apart and extending 1,200 feet on either side of the baseline. Crosslines were marked with two foot high lath pickets at 200 foot intervals.

Soil samples were taken at 200 foot intervals on the crosslines by digging to a C soil horizon with a grubhoe. Samples were collected in individual prenumbered kraft paper bags and shipped by air freight to Chemex Labs Ltd., North Vancouver, B.C., where they were dried, screened to a minus 80 mesh fraction and split into two portions. One portion was ashed for 15 minutes at 550°C, dried twice in four molar nitric acid, picked up in acidified water, fused with a standard sodium fluoride-based flux and assayed for uranium in parts per million (ppm) with a G.K. Turner fluorometer. The remaining portion was digested in nitric-perchloric acid and analyzed in ppm for copper, lead, zinc, molybdenum and vanadium by atomic absorption spectrometry. Uranium, copper and molybdenum values are illustrated on Figure B4 while

lead, zinc and vanadium are shown on Figure B5. Most of the northern two-thirds of the grid area is underlain by glaciofluvial till which is predominantly composed of limestone and dolomite from the surrounding Ordovician and Silurian sediments. The southern third of the grid is largely talus from steeper slopes underlain by Unit 3 metavolcanics and Unit 6 fanglomerate. Uranium geochemical response is low with only a few scattered erratic above threshold values up to 5 ppm over a background of less than 0.5 ppm. Copper and molybdenum show a similar erratic pattern of slightly above threshold values except in the southeast portion of the grid, underlain by Unit 6 fanglomerate, where copper assays up to 700 ppm over a background of less than 100 ppm and molybdenum is as high as 14 ppm over a background of less than 1 ppm. Lead, zinc and vanadium values show erratic response, particularly from the glacial till covered portion of the grid. Vanadium response from Unit 6 is weakly anomalous with values up to 275 ppm over a background of 90 to 100 ppm.

Radioactivity was measured at fifty foot intervals on each crossline using a Scintrex BGS-1S (1 inch by 1 inch crystal) broadband scintillometer. The readings, as illustrated on Figure B2, are in cps at waist level, about three feet above the ground. Background ranges from 20 to 40 cps over areas of glaciofluvial till, 40 to 50 cps over areas of Unit 3 talus and 60 to 75 cps over Unit 6. Several small areas with weak to moderately radioactive float were located in talus above the till covered valley. The glacial till prevents radiometric exploration along strike of both the Bond 1 and 2 occurrences. A close spaced (reading at one foot intervals on lines five feet apart) survey was carried out over the Bond 2 outcrop area to aid in outlining

specific mineralized zones and locate targets for sampling. Details of this survey are illustrated on Figure B7 while a similarly spaced survey of the same area at waist level, about three feet above ground, is illustrated on Figure B7A.

CONCLUSIONS AND RECOMMENDATIONS

Geochemistry is not an effective exploration technique for locating specific radioactive occurrences. The grid radiometric surveys work well in areas of residual till and should be extended to cover all of the Proterozoic window. Neither the Bond 1 or Bond 2 showings can be traced along strike by prospecting or radiometric surveys because of a shallow, but fairly continuous, cover of glaciofluvial till. A soil radon survey should be tested although samples will be difficult to collect because of permafrost.

The Bond 1 and 2 mineral occurrences do not assay as high in uranium as the radiometric count suggest they should. The Bond 2 occurrence exhibits the greatest disequilibrium, with most samples assaying between three and twelve times lower than expected. Test assays show the disequilibrium is not caused by thorium or potassium. The most logical explanation is selective surface leaching of uranium from its more radioactive and less soluble daughter element radium. Both occurrences contain barite which has a strong chemical affinity for radium and would further immobilize it. The obvious implication, which can only be tested by drilling, is that uranium assays could improve with depth by a factor of three to twelve times the surface value.

Respectfully submitted,
ARCHER, CATHRO & ASSOCIATES LTD.

A.R. Archer, B.A.Sc., P.Eng.

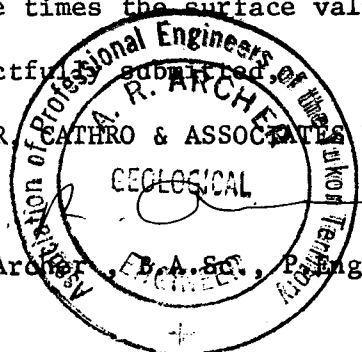



CHEMEX LABS LTD.

212 BROOKSBANK AVE.
NORTH VANCOUVER, B.C.
CANADA V7J 2C1
TELEPHONE: 985-0648
AREA CODE: 604

•ANALYTICAL CHEMISTS •GEOCHEMISTS • REGISTERED ASSAYERS

CERTIFICATE OF ANALYSIS

TO: Archer, Cathro & Assoc. Ltd.,
Box 4127
Whitehorse, Y.T.

ATTN:

WJV

CERTIFICATE NO. SP220

INVOICE NO. 14168

RECEIVED June 17, 1975

ANALYSED July 8, 1975

SAMPLE NO. :	Lower Concentration Limit (PPM)	A00732
Antimony	50	bcl
Arsenic	50	200
Barium	5	>5000
Beryllium	5	bcl
Bismuth	5	10
Boron	20	200
Cadmium	20	bcl
Calcium	0.05%	<0.05%
Chromium	10	50
Cobalt	10	50
Copper	1	500
Gallium	2	20
Germanium	20	bcl
Iron	0.05%	2%
Lead	5	500
Magnesium	0.02%	0.1%
Manganese	5	1000
Molybdenum	10	500
Nickel	5	100
Niobium	50	bcl
Silver	1	5
Strontium	20	bcl
Tantalum	200	bcl
Tellurium	200	bcl
Thorium	100	bcl
Tin	10	10
Titanium	5	5000
Vanadium	10	100
Zinc	50	bcl
Zirconium	20	100

Concentration Range	
>5000 ppm =>5000 ppm	50 ppm = 25-100 ppm
5000 ppm = 2500-10000 ppm	20 ppm = 10-50 ppm
2000 ppm = 1000-4000 ppm	10 ppm = 5-20 ppm
1000 ppm = 500-2000 ppm	5 ppm = 2-10 ppm
500 ppm = 250-1000 ppm	2 ppm = 1-4 ppm
200 ppm = 100-400 ppm	1 ppm = 0.5-2 ppm
100 ppm = 50-200 ppm	bcl = below concentration limit

Ranges for Iron, Calcium & Magnesium are reported in %

BOND 2 specimen
ASSAYING
0.26% U₃O₈



MEMBER
CANADIAN TESTING
ASSOCIATION

CERTIFIED BY: *[Signature]*


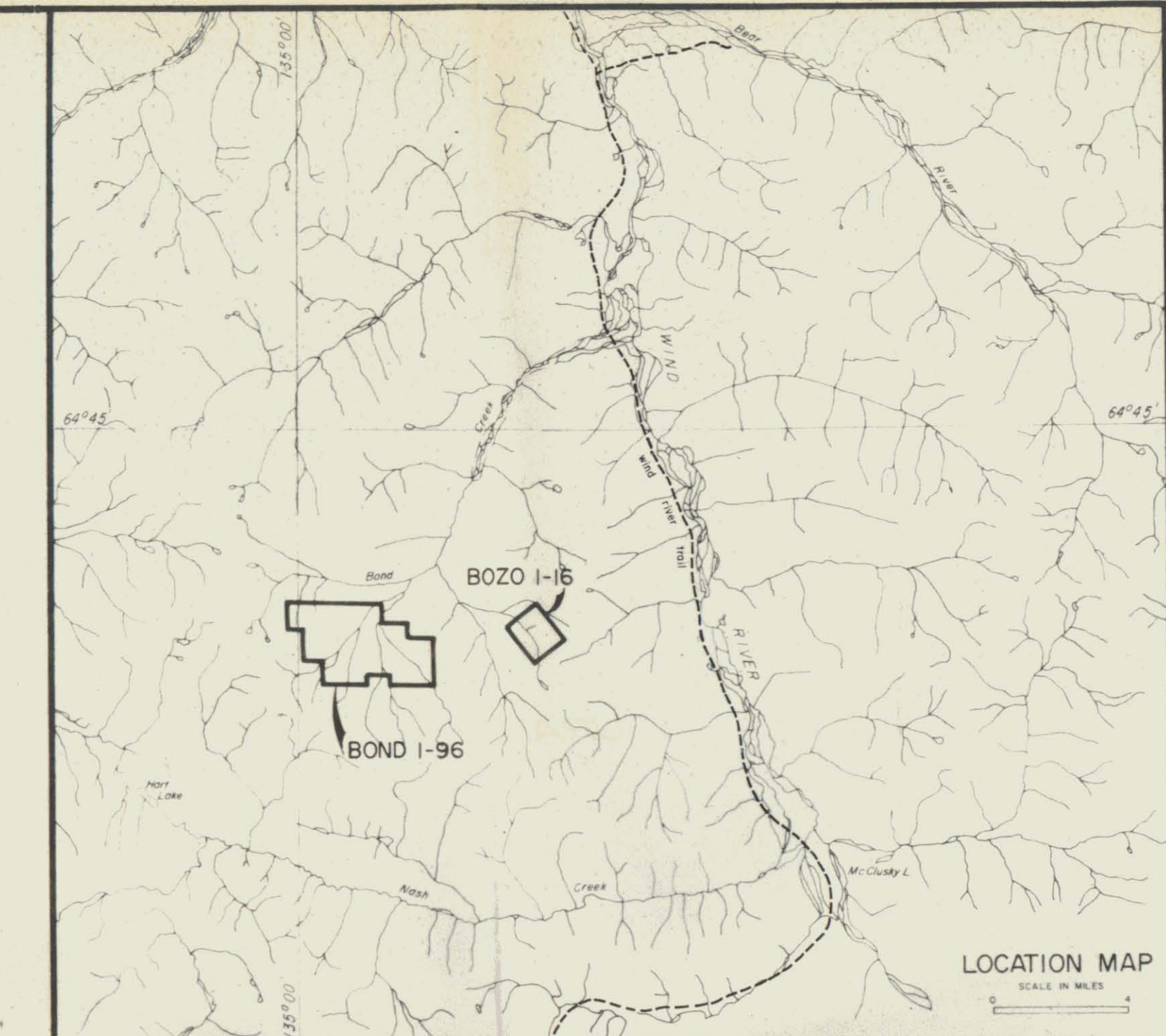
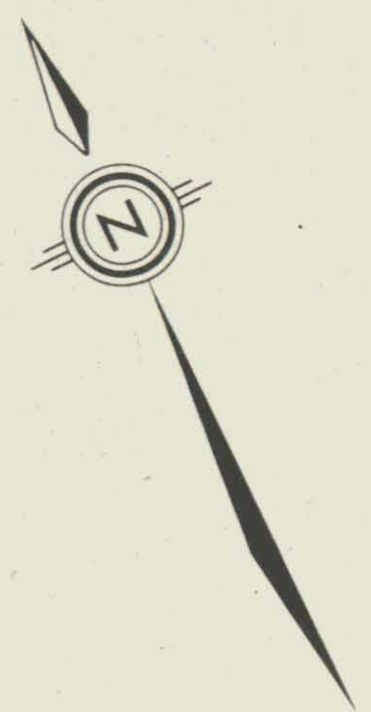

LEGEND
• Soil sample 11, Co, Mo in ppm by Ochsner Lab Ltd, N. Vancouver, B.C.

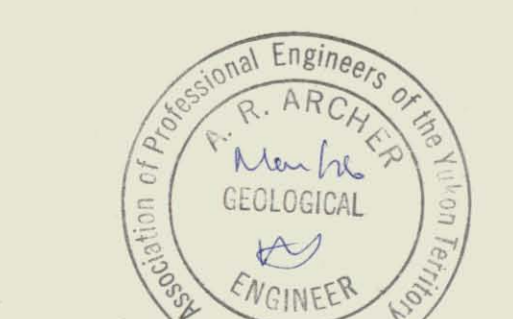

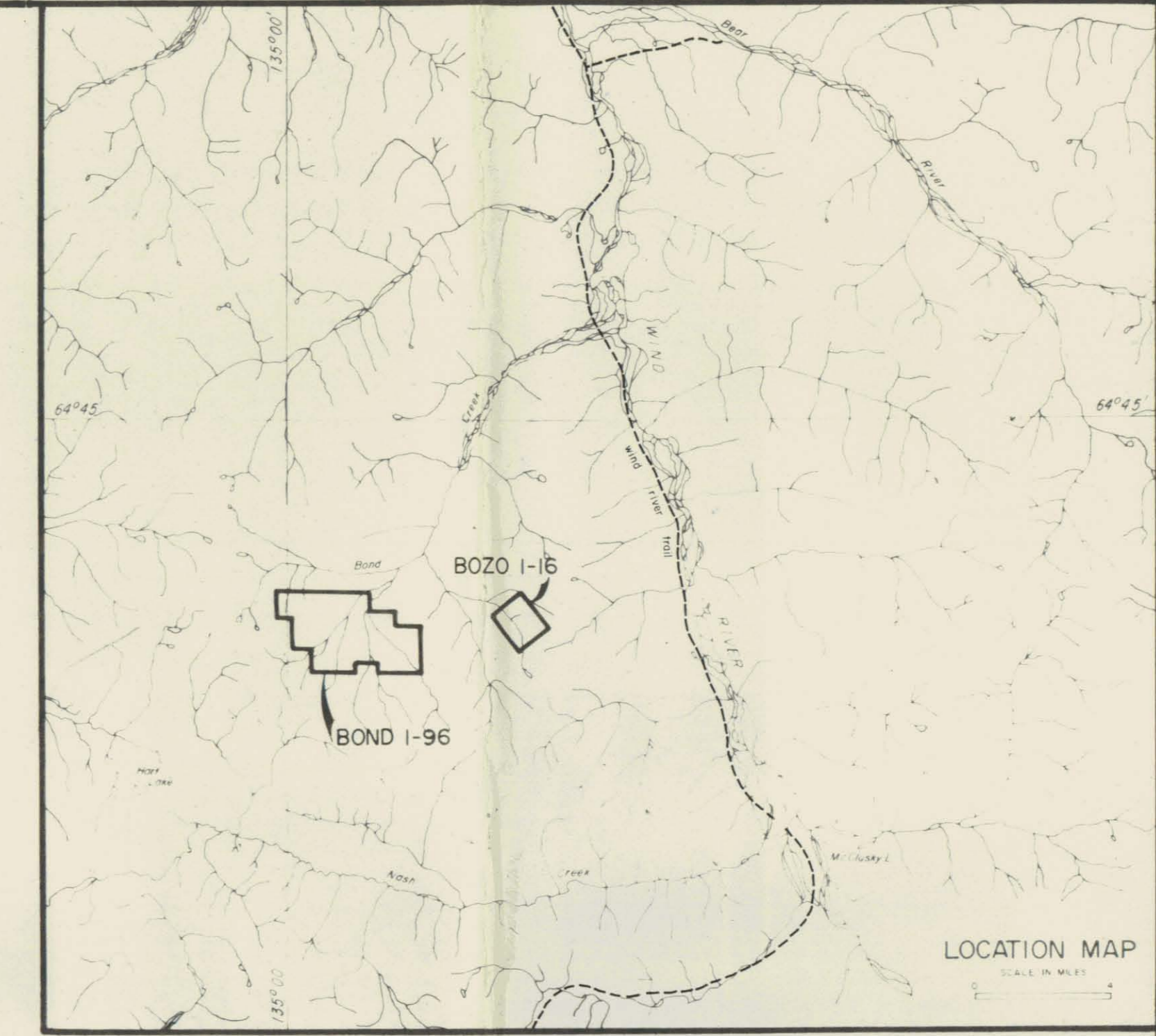
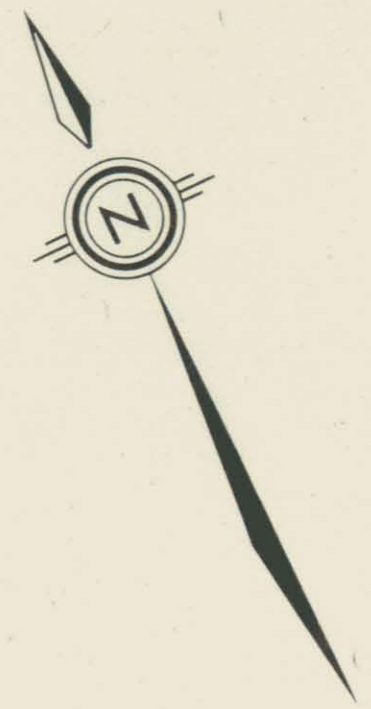

FIG. B3
ANALYSIS REPORT OF OCHSNER LTD.
URANIUM, COPPER, MOLYBDENUM
BOND OCCURRENCE
BOND I-96
WERNECKE JOINT VENTURE





LEGEND
 • Soil sample P1, 2, 3, 4, 5, 6, 7, 8, 9, 10, 11, 12, 13, 14, 15, 16, 17, 18, 19, 20, 21, 22, 23, 24, 25, 26, 27, 28, 29, 30, 31, 32, 33, 34, 35, 36, 37, 38, 39, 40, 41, 42, 43, 44, 45, 46, 47, 48, 49, 50, 51, 52, 53, 54, 55, 56, 57, 58, 59, 60, 61, 62, 63, 64, 65, 66, 67, 68, 69, 70, 71, 72, 73, 74, 75, 76, 77, 78, 79, 80, 81, 82, 83, 84, 85, 86, 87, 88, 89, 90, 91, 92, 93, 94, 95, 96, 97, 98, 99, 100, 101, 102, 103, 104, 105, 106, 107, 108, 109, 110, 111, 112, 113, 114, 115, 116, 117, 118, 119, 120, 121, 122, 123, 124, 125, 126, 127, 128, 129, 130, 131, 132, 133, 134, 135, 136, 137, 138, 139, 140, 141, 142, 143, 144, 145, 146, 147, 148, 149, 150, 151, 152, 153, 154, 155, 156, 157, 158, 159, 160, 161, 162, 163, 164, 165, 166, 167, 168, 169, 170, 171, 172, 173, 174, 175, 176, 177, 178, 179, 180, 181, 182, 183, 184, 185, 186, 187, 188, 189, 190, 191, 192, 193, 194, 195, 196, 197, 198, 199, 200, 201, 202, 203, 204, 205, 206, 207, 208, 209, 210, 211, 212, 213, 214, 215, 216, 217, 218, 219, 220, 221, 222, 223, 224, 225, 226, 227, 228, 229, 230, 231, 232, 233, 234, 235, 236, 237, 238, 239, 240, 241, 242, 243, 244, 245, 246, 247, 248, 249, 250, 251, 252, 253, 254, 255, 256, 257, 258, 259, 260, 261, 262, 263, 264, 265, 266, 267, 268, 269, 270, 271, 272, 273, 274, 275, 276, 277, 278, 279, 280, 281, 282, 283, 284, 285, 286, 287, 288, 289, 290, 291, 292, 293, 294, 295, 296, 297, 298, 299, 300, 301, 302, 303, 304, 305, 306, 307, 308, 309, 310, 311, 312, 313, 314, 315, 316, 317, 318, 319, 320, 321, 322, 323, 324, 325, 326, 327, 328, 329, 330, 331, 332, 333, 334, 335, 336, 337, 338, 339, 340, 341, 342, 343, 344, 345, 346, 347, 348, 349, 350, 351, 352, 353, 354, 355, 356, 357, 358, 359, 360, 361, 362, 363, 364, 365, 366, 367, 368, 369, 370, 371, 372, 373, 374, 375, 376, 377, 378, 379, 380, 381, 382, 383, 384, 385, 386, 387, 388, 389, 390, 391, 392, 393, 394, 395, 396, 397, 398, 399, 400, 401, 402, 403, 404, 405, 406, 407, 408, 409, 410, 411, 412, 413, 414, 415, 416, 417, 418, 419, 420, 421, 422, 423, 424, 425, 426, 427, 428, 429, 430, 431, 432, 433, 434, 435, 436, 437, 438, 439, 440, 441, 442, 443, 444, 445, 446, 447, 448, 449, 450, 451, 452, 453, 454, 455, 456, 457, 458, 459, 460, 461, 462, 463, 464, 465, 466, 467, 468, 469, 470, 471, 472, 473, 474, 475, 476, 477, 478, 479, 480, 481, 482, 483, 484, 485, 486, 487, 488, 489, 490, 491, 492, 493, 494, 495, 496, 497, 498, 499, 500, 501, 502, 503, 504, 505, 506, 507, 508, 509, 510, 511, 512, 513, 514, 515, 516, 517, 518, 519, 520, 521, 522, 523, 524, 525, 526, 527, 528, 529, 530, 531, 532, 533, 534, 535, 536, 537, 538, 539, 540, 541, 542, 543, 544, 545, 546, 547, 548, 549, 550, 551, 552, 553, 554, 555, 556, 557, 558, 559, 560, 561, 562, 563, 564, 565, 566, 567, 568, 569, 570, 571, 572, 573, 574, 575, 576, 577, 578, 579, 580, 581, 582, 583, 584, 585, 586, 587, 588, 589, 590, 591, 592, 593, 594, 595, 596, 597, 598, 599, 600, 601, 602, 603, 604, 605, 606, 607, 608, 609, 610, 611, 612, 613, 614, 615, 616, 617, 618, 619, 620, 621, 622, 623, 624, 625, 626, 627, 628, 629, 630, 631, 632, 633, 634, 635, 636, 637, 638, 639, 640, 641, 642, 643, 644, 645, 646, 647, 648, 649, 650, 651, 652, 653, 654, 655, 656, 657, 658, 659, 660, 661, 662, 663, 664, 665, 666, 667, 668, 669, 670, 671, 672, 673, 674, 675, 676, 677, 678, 679, 680, 681, 682, 683, 684, 685, 686, 687, 688, 689, 690, 691, 692, 693, 694, 695, 696, 697, 698, 699, 700, 701, 702, 703, 704, 705, 706, 707, 708, 709, 710, 711, 712, 713, 714, 715, 716, 717, 718, 719, 720, 721, 722, 723, 724, 725, 726, 727, 728, 729, 730, 731, 732, 733, 734, 735, 736, 737, 738, 739, 740, 741, 742, 743, 744, 745, 746, 747, 748, 749, 750, 751, 752, 753, 754, 755, 756, 757, 758, 759, 760, 761, 762, 763, 764, 765, 766, 767, 768, 769, 770, 771, 772, 773, 774, 775, 776, 777, 778, 779, 780, 781, 782, 783, 784, 785, 786, 787, 788, 789, 790, 791, 792, 793, 794, 795, 796, 797, 798, 799, 800, 801, 802, 803, 804, 805, 806, 807, 808, 809, 810, 811, 812, 813, 814, 815, 816, 817, 818, 819, 820, 821, 822, 823, 824, 825, 826, 827, 828, 829, 830, 831, 832, 833, 834, 835, 836, 837, 838, 839, 840, 841, 842, 843, 844, 845, 846, 847, 848, 849, 850, 851, 852, 853, 854, 855, 856, 857, 858, 859, 860, 861, 862, 863, 864, 865, 866, 867, 868, 869, 870, 871, 872, 873, 874, 875, 876, 877, 878, 879, 880, 881, 882, 883, 884, 885, 886, 887, 888, 889, 890, 891, 892, 893, 894, 895, 896, 897, 898, 899, 900, 901, 902, 903, 904, 905, 906, 907, 908, 909, 910, 911, 912, 913, 914, 915, 916, 917, 918, 919, 920, 921, 922, 923, 924, 925, 926, 927, 928, 929, 930, 931, 932, 933, 934, 935, 936, 937, 938, 939, 940, 941, 942, 943, 944, 945, 946, 947, 948, 949, 950, 951, 952, 953, 954, 955, 956, 957, 958, 959, 960, 961, 962, 963, 964, 965, 966, 967, 968, 969, 970, 971, 972, 973, 974, 975, 976, 977, 978, 979, 980, 981, 982, 983, 984, 985, 986, 987, 988, 989, 990, 991, 992, 993, 994, 995, 996, 997, 998, 999, 1000.

FIG B4
 LEAD, ZINC, VANADIUM
 GEOCHEMISTRY
 BOND OCCURRENCE
 BOND I-96
 WERNECKE JOINT VENTURE

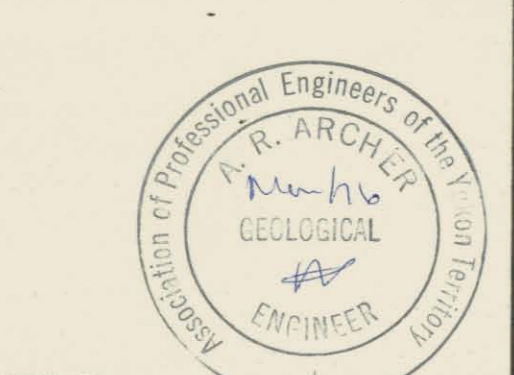

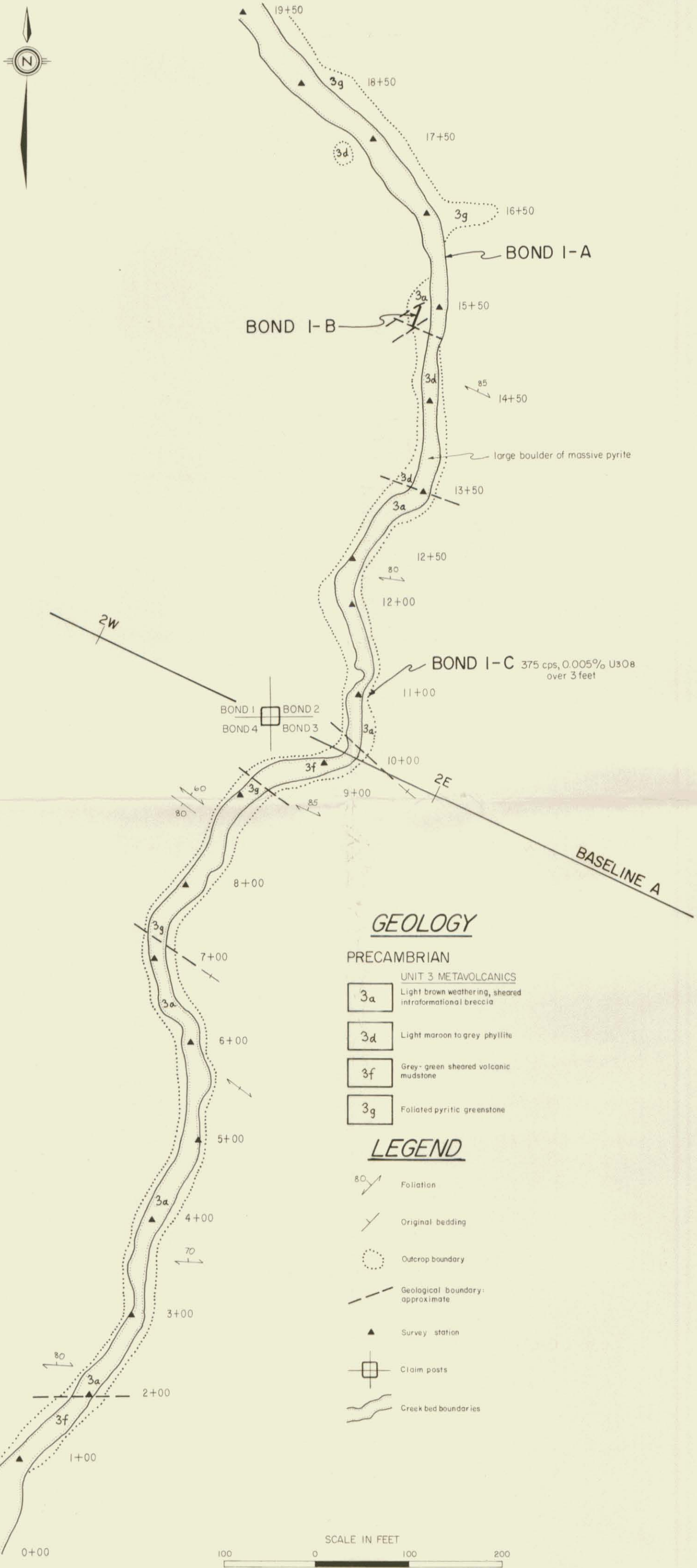

SAMPLE NUMBER	SAMPLE DISTANCE (feet)	AVERAGE COUNTS PER SECOND	PERCENT U ₃ O ₈
10554	4	4980	0.024 *



INTERVAL (feet)	SAMPLE NUMBER	SAMPLE DISTANCE (feet)	AVERAGE COUNTS PER SECOND	PERCENT U ₃ O ₈	PPM THORIUM	PERCENT POTASSIUM
21-26	10553	5	1225	0.004	12	1.70
17-21	10552	4	1800	0.108	NA	NA
13-17	10551	4	1940	0.144	410	0.56
10-13	10550	3	2710	0.18	NA	NA
7-10	10549	3	2010	0.087	NA	NA
4-7	10548	3	1577	0.028	NA	NA
0-4	10547	4	2575	0.076	NA	NA

NA - NOT ASSAYED

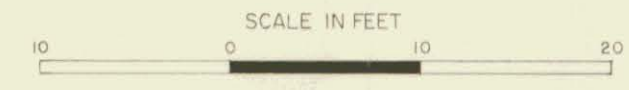

Note: Radiometric readings taken in counts per second with a scintrex BGS-1S broadband scintillometer (1" X 1" thallium activated sodium iodide crystal)



FIG. B5
 ARCHER, CATHRO & ASSOCIATES LTD.
GEOLOGY & CHANNEL SAMPLING
 BOND I-A & I-B SHOWING
 BOND OCCURRENCE
 BOND I-96 CLAIMS
 WERNECKE JOINT VENTURE



LINE A 3+00S to 5+00S

INTERVAL (feet)	SAMPLE NUMBER	SAMPLE DISTANCE (feet)	AVERAGE COUNTS PER SECOND	PERCENT U ₃ O ₈
0 - 57.5	NS			
57.5 - 63.5	10501	6.0	340	0.007
63.5 - 65.5	NS			
65.5 - 70.5	10502	5.0	470	0.009
70.5 - 75.5	10503	5.0	950	0.011
75.5 - 78.5	10504	3.0	900	0.003
78.5 - 82.5	10505	4.0	2400	0.057
82.5 - 84.5	10506	2.0	1350	0.019
84.5 - 102.5	NS			
102.5 - 106.5	10507	4.0	440	0.007
106.5 - 108.5	10508	3.0	150	0.001
108.5 - 113.5	NS			
113.5 - 118.5	10509	5.0	920	0.032
118.5 - 124.5	NS			
124.5 - 128.5	10510	4.0	200	<0.001
128.5 - 131.5	NS			
131.5 - 133.5	10511	2.0	1450	0.024
133.5 - 200.0	NS			

LINE B
LINE C
LINE A

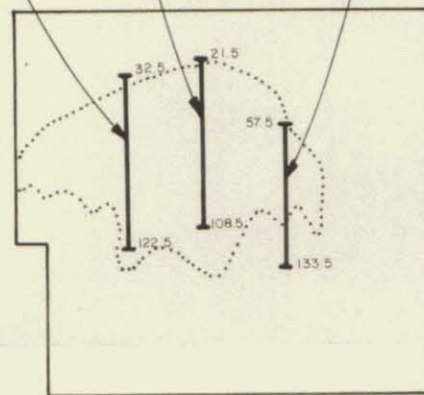

LINE B 3+00S to 5+00S

INTERVAL (feet)	SAMPLE NUMBER	SAMPLE DISTANCE (feet)	AVERAGE COUNTS PER SECOND	PERCENT U ₃ O ₈	PPM THORIUM	PERCENT POTASSIUM
0 - 21.5	NS				NA	NA
21.5 - 23.5	10512	2.0	570	0.018	NA	NA
23.5 - 25.5	NS				NA	NA
25.5 - 28.5	10513	3.0	1400	0.025	NA	NA
28.5 - 34.5	10514	6.0	2267	0.040	NA	NA
34.5 - 40.5	10515	6.0	3067	0.134	NA	NA
40.5 - 45.5	10516	5.0	3920	0.145	10	3.80
45.5 - 49.5	10517	4.0	3800	0.072	25	3.06
49.5 - 53.5	10518	4.0	1390	0.039	NA	NA
53.5 - 56.5	NS				NA	NA
56.5 - 59.5	10519	3.0	100	0.001	NA	NA
59.5 - 61.5	NS				NA	NA
61.5 - 65.5	10520	4.0	86	0.001	NA	NA
65.5 - 69.5	NS				NA	NA
69.5 - 72.5	10521	3.0	293	0.011	NA	NA
72.5 - 80.5	NS				NA	NA
80.5 - 84.5	10522	4.0	84	0.001	NA	NA
84.5 - 86.5	NS				NA	NA
86.5 - 90.5	10523	4.0	100	0.001	NA	NA
90.5 - 92.5	NS				NA	NA
92.5 - 96.5	10524	4.0	75	0.001	NA	NA
96.5 - 98.5	10525	2.0	300	0.001	NA	NA
98.5 - 102.5	10526	4.0	1430	0.096	12	3.00
102.5 - 104.5	NS				NA	NA
104.5 - 108.5	10527	4.0	180	0.003	NA	NA
108.5 - 200	NS					

LINE C 3+00S to 5+00S

INTERVAL (feet)	SAMPLE NUMBER	SAMPLE DISTANCE (feet)	AVERAGE COUNTS PER SECOND	PERCENT U ₃ O ₈	PPM THORIUM	PERCENT POTASSIUM
0 - 32.5	NS					
32.5 - 43.5	10528	5.0	552	0.011		
43.5 - 48.5	10529	5.0	1104	0.047	20	2.96
48.5 - 51.5	10530	3.0	1140	0.061	17	2.90
51.5 - 56.5	10531	5.0	180	0.001	NA	NA
56.5 - 61.5	10532	5.0	200	0.007	NA	NA
61.5 - 63.5	10533	2.0	440	0.022	NA	NA
63.5 - 67.5	10534	4.0	670	0.023	NA	NA
67.5 - 70.5	10535	3.0	800	0.006	NA	NA
70.5 - 74.5	10536	4.0	1010	0.008	NA	NA
74.5 - 80.5	10537	6.0	3300	0.048	25	2.30
80.5 - 84.5	NS					
84.5 - 86.5	10538	2.0	1050	0.012	NA	NA
86.5 - 91.5	10539	5.0	2260	0.019	10	1.90
91.5 - 94.5	10540	3.0	1300	0.012	NA	NA
94.5 - 97.5	10541	3.0	93	0.042	NA	NA
97.5 - 101.5	10542	4.0	570	0.009	NA	NA
101.5 - 106.5	10543	5.0	287	0.014	NA	NA
106.5 - 114.5	NS					
114.5 - 118.5	10544	4.0	95	0.002	NA	NA
118.5 - 122.5	10545	4.0	75	0.001	NA	NA
122.5 - 200	NS					

LEGEND

- Outcrop
- Sample line
- NS Not sampled
- NA Not assayed

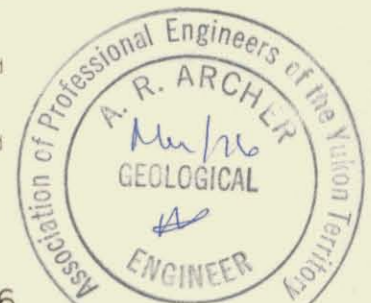
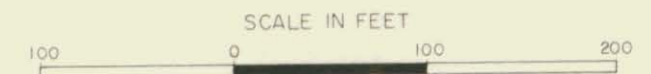

FIG. B6
ARCHER, CATHRO & ASSOCIATES LTD.

CHANNEL SAMPLING

BOND 2 SHOWING
BOND OCCURRENCE
BOND 1-96 CLAIMS
WERNECKE JOINT VENTURE



NOTE: Radiometric readings taken in counts per second with a scintrex BGS-1S broadband scintillometer (1" X 1" thallium activated sodium iodide crystal). Regional background is 50cps.

FIG. B7
ARCHER CANHAM & ASSOCIATES LTD.
DETAILED RADIO-METRIC SURVEY

BOND 2 SHOWING
BOND OCCURRENCE
BOND I-96 CLAIMS
WERNERKE JOINT VENTURE
SCALE: IN FEET

- LEGEND
- Outline property first lease
 - Outline bond covered
 - Bond occurrence (shown as a circle) and bond claim (shown as a square) (shown as a circle)
 - 0.010 Bond rate number
 - 6.0 Width of strip closure sample
 - 0.134% Dryly heavy

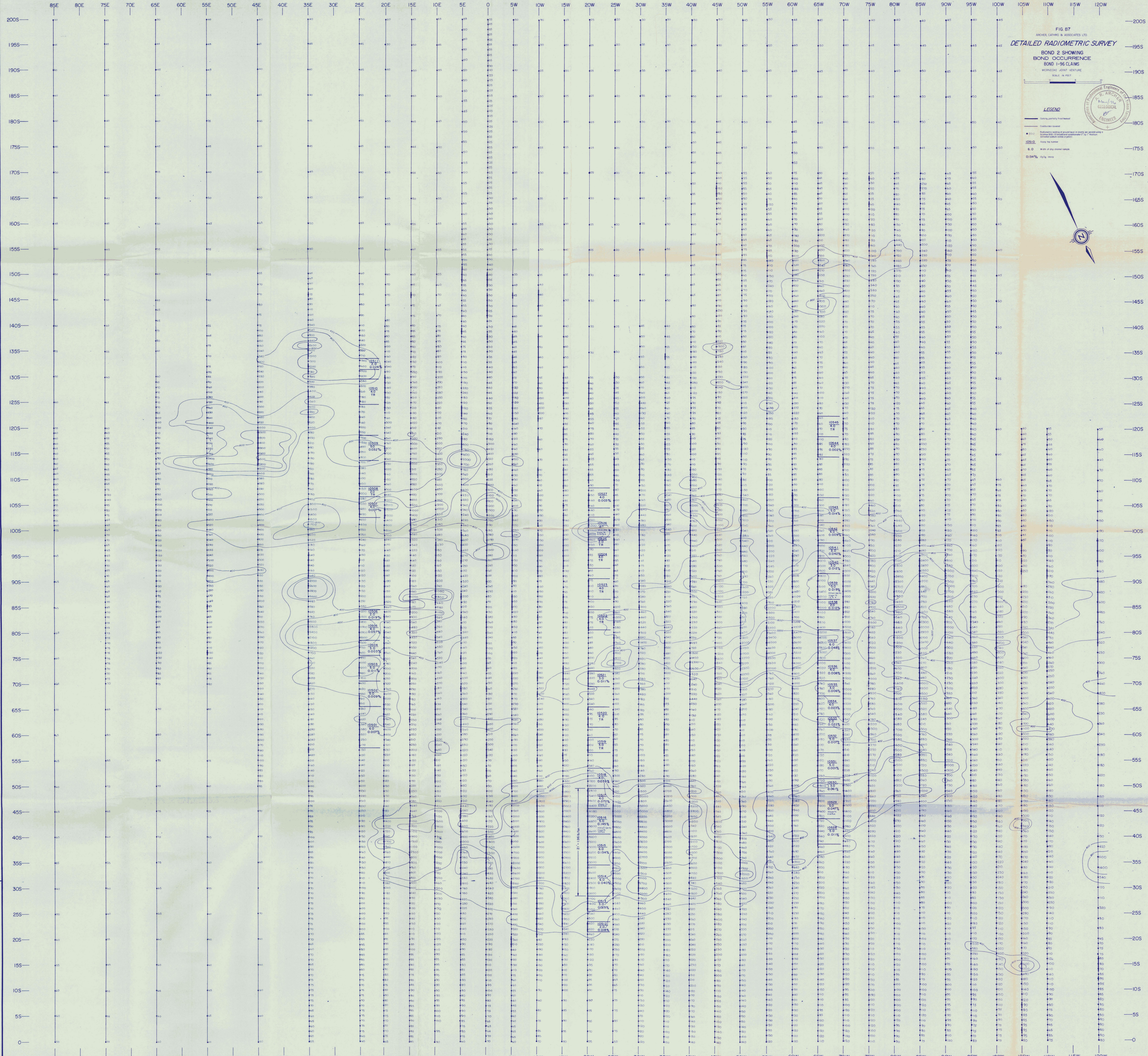
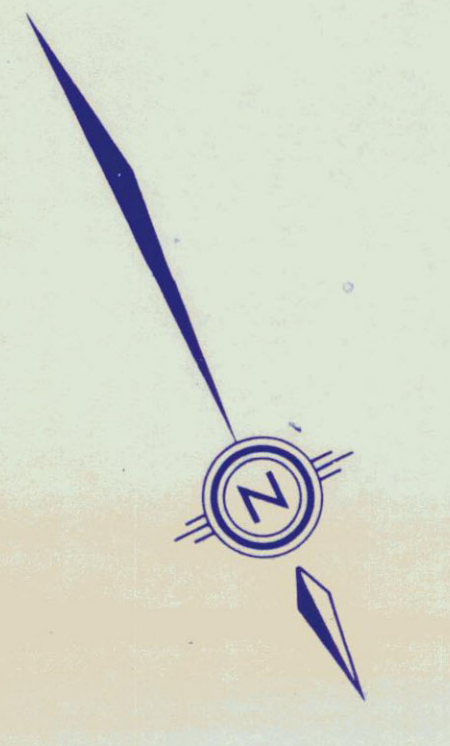
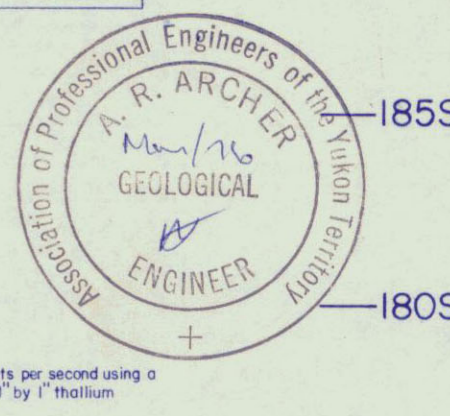

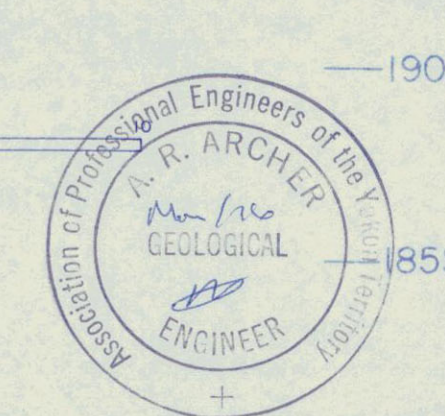

LEGEND
Contours, per 100 Feet Head

- 250 Radio-metric reading of water level in centre of natural spring
- 1000 Radio-metric reading of water level in centre of natural spring
- 10000 Radio-metric reading of water level in centre of natural spring
- 100000 Radio-metric reading of water level in centre of natural spring
- 1000000 Radio-metric reading of water level in centre of natural spring
- 6.0 Width of dry stream channel
- 0.134% $\frac{1}{1000}$ slope

