

This report has been examined by the Geological Evaluation Unit and is recommended to the Commissioner to be considered as representation work in the amount of \$1700.00

D.R. Craig
Resident Geologist or
~~Resident Mining Engineer~~

Considered as representation work under Section 53 (4) Yukon Quartz Mining Act.

A REPORT

[Signature]
A.R. BAXTER
Supervising Mining Recorder
Commissioner of Yukon Territory

ON



A GRAVITY SURVEY

Lisa Grid, Anvil Area, Yukon Territory

FOR

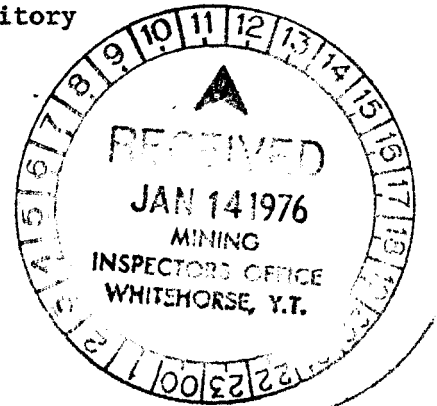

CYPRUS ANVIL MINING CORPORATION

Vancouver, British Columbia

BY

PETER E. WALCOTT & ASSOCIATES LIMITED

Vancouver, British Columbia

DECEMBER 1975

TABLE OF CONTENTS

	<u>Page</u>
INTRODUCTION	1
PROPERTY, LOCATION AND ACCESS	2
PURPOSE	3
PREVIOUS WORK	4
GEOLOGY	5
SURVEY SPECIFICATIONS	6
DISCUSSION OF RESULTS	7
SUMMARY, CONCLUSIONS AND RECOMMENDATIONS	8

APPENDIX

COST OF SURVEY	i
PERSONNEL EMPLOYED ON SURVEY	ii
CERTIFICATION	iii

ACCOMPANYING MAPS - Scale 1" = 200'

PROFILES OF BOUGUER GRAVITY AND SURFACE ELEVATIONS W-201-1

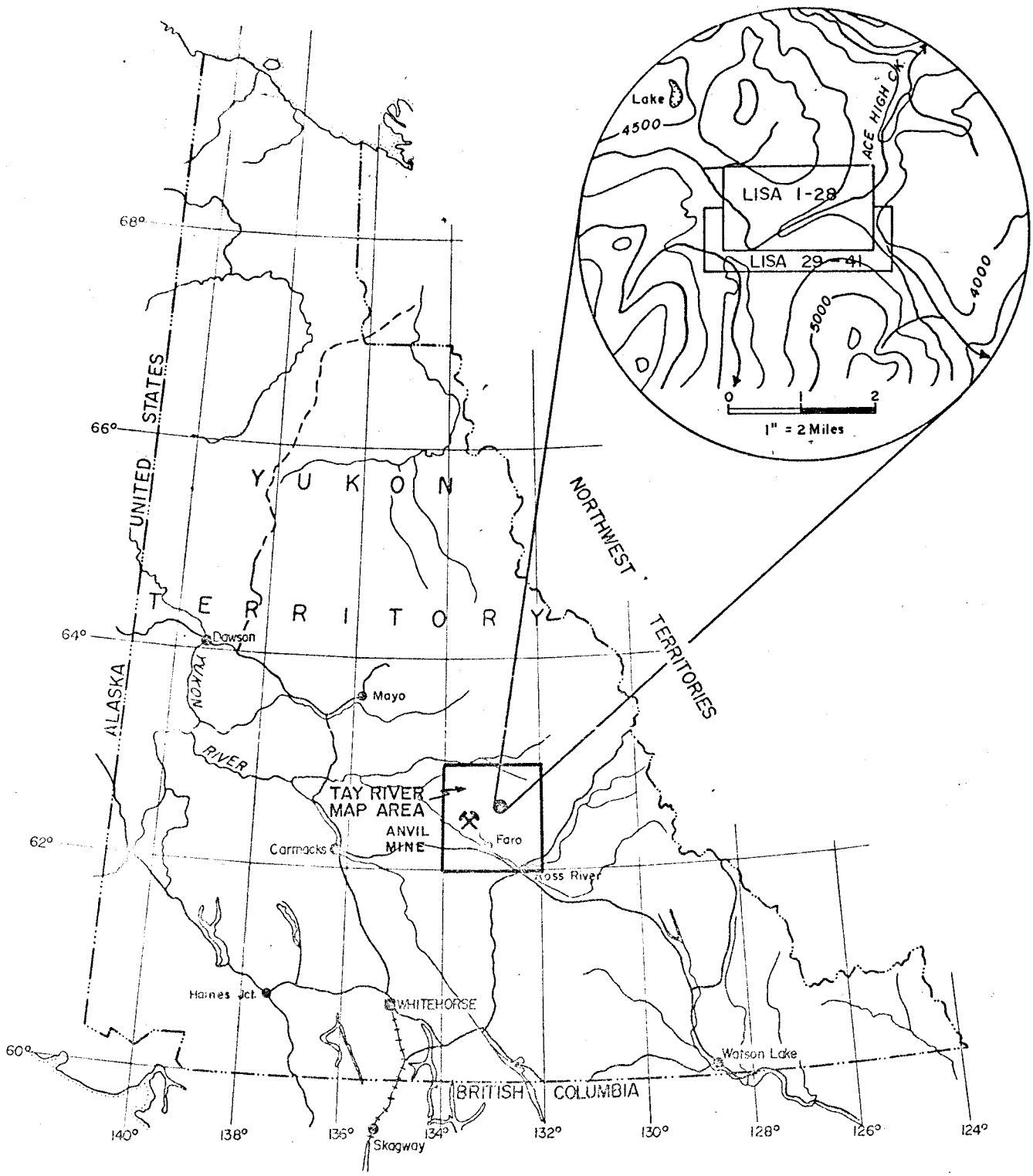

CYPRUS ANVIL MINING CORPORATION

LISA CLAIMS

PROPERTY LOCATION MAP

YUKON

SCALE : 1" = 100 MILES

Figure 1

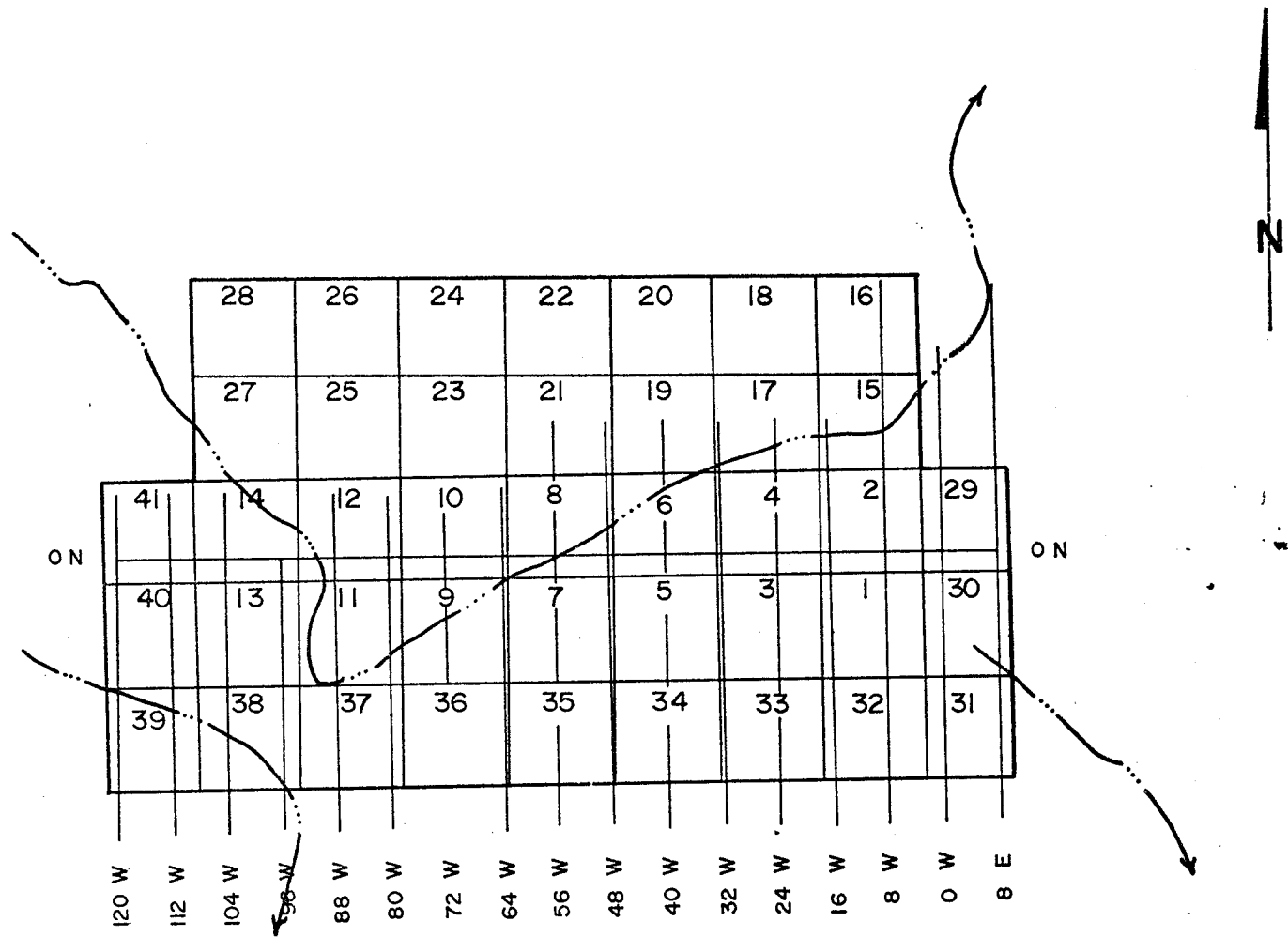

LISA CLAIMS AND GRID

Scale: 1" = 1/2 Mile

Figure 2

PURPOSE

The purpose of the survey was to see if any excess massive that could be indicative of massive sulphide mineralization was associated with the weak Turam conductor (1974) and the possible structure envisioned by the geologist.

PREVIOUS WORK

Previous work on the property consisted of airborne magnetic and electric surveying, geological mapping and prospecting, geochemical soil sampling, ground magnetic, electromagnetic and induced polarization surveys.

The results of the above work are documented in reports held by Cyprus Anvil Mining Corporation.

GEOLOGY

The reader is referred to a report by G. Jilson of Cyprus Anvil Mining Corporation dated April 1975.

SURVEY SPECIFICATIONS

The gravity survey was carried out using a Scintrex CG-2 gravity meter, which measures variations in the earth's gravitational field to an accuracy of ± 0.01 milligals.

Values of observed gravity were obtained every 100 feet along the picket lines. Corrections for meter drift were made by tying-in to previously established base stations at intervals not exceeding 2 to 3 hours. Drifts of over 0.10 milligals per hour were not allowable.

The elevations of the gravity stations were determined by rod and transit (Sokkisha TM-20C) using the stadia method. Errors in the tying-in of loops were kept to a minimal, this being dependent on the severity of the topography but less than 1.0 feet per loop.

Corrections were then applied to the observed gravity for differences in elevation and latitude using a density of 2.7 gm/cc on the former.

The final Bouguer gravity values were then plotted.

DISCUSSION OF RESULTS

No readings that could be indicative of excess mass were observed over the possible target zone on the south side of Ace High Creek as can be seen from the profiles on Map W-201-1.

The lower gravity readings on the northern extremities of the lines are believed to indicate a rock type change.

SUMMARY, CONCLUSIONS AND RECOMMENDATIONS

On August 21st, 1975 Peter E. Walcott & Associates Limited carried out a limited gravity survey on the Lisa grid for Cyprus Anvil Mining Corporation.

No readings indicative of excess mass that could be attributed to sulphide mineralization were obtained.

As a result of the above the writer recommends that no further work be done on this part of the Lisa grid.

Respectfully submitted,

PETER E. WALCOTT & ASSOCIATES LIMITED

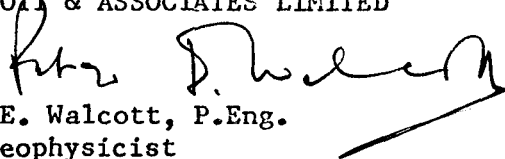
Peter E. Walcott, P.Eng.
Geophysicist

Vancouver, B.C.

December 1975

A P P E N D I X



COST OF SURVEY

Peter E. Walcott & Associates Limited undertook the survey on a daily basis. Report writing and drafting charges were extra so that the total cost of services provided was \$1,165.00.

PERSONNEL EMPLOYED ON SURVEY

<u>Name</u>	<u>Occupation</u>	<u>Address</u>	<u>Dates</u>
Peter E. Walcott	Geophysicist	Peter E. Walcott & Assoc. 605 Rutland Court, Coquitlam, B.C.	Aug. 21st - 22nd, Dec. 9th, 1975
G. MacMillan	Geophysical Operator	" "	Sept. 3rd, Dec. 14th 1975
D. Bingham	"	" "	Aug. 21st, 1975
S. Scurvey	Rodman	" "	"
J. Walcott	Typing	" "	Dec. 15th, 1975

CERTIFICATION.

I, Peter E. Walcott of the Municipality of Coquitlam, British Columbia, hereby certify that:

1. I am a Graduate of the University of Toronto in 1962 with a B.A.Sc. in Engineering Physics, Geophysics Option.
2. I have been practising my profession for the last fourteen years.
3. I am a member of the Association of Professional Engineers of British Columbia, Ontario and the Yukon Territory.
4. I hold no interest in the property described in this report nor do I expect to receive any.

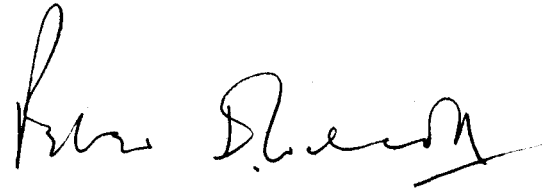

Peter E. Walcott, P.Eng.

Vancouver,
British Columbia

December 1975

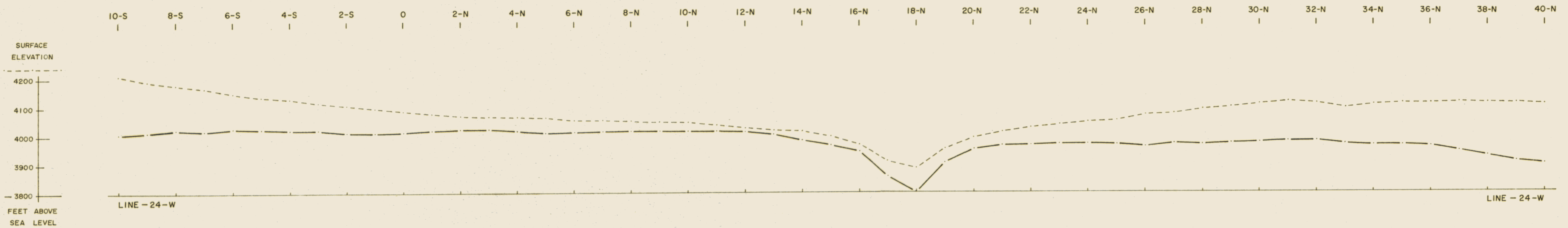

P. E. Walcott
 PROFESSIONAL ENGINEER
 BRITISH COLUMBIA
 PETER E. WALCOTT

CYPRUS ANVIL MINING CORP.
 LISA GRID ; ANVIL AREA ; WHITEHORSE M.D., YUKON

GRAVITY SURVEY
 PROFILES OF BOUGUER GRAVITY & SURFACE ELEVATION
 (IN MILLI-GALS & FEET ABOVE SEA LEVEL)

SCALE : 1" = 200 FEET

MAP No. W-201-1
 TO ACCOMPANY A REPORT BY
 PETER E. WALCOTT, P. Eng., DATED - DEC. 1975

PETER E. WALCOTT & ASSOC. LTD.
 AUGUST - 1975