

GEOCHEMICAL REPORT
ON
PONG 41 - 62
CORN CREEK AREA
MAYO MINING DIVISION
106-C-10, 64°40'N, 132°55'W

FOR

BOW RIVER RESOURCES LTD. & HIGHHAWK MINES LTD.

BY

J.W. MacLeod, P.Eng.

Vancouver, B.C.

December 19, 1975

NMEAP
Received
Jan 23, 1976.

TABLE OF CONTENTS

	<u>PAGE NUMBER</u>
INTRODUCTION	1
SUMMARY & CONCLUSIONS	1
PROPERTY & HISTORY	2
LOCATION & ACCESS	3
GENERAL	3
GEOLOGY	4
MINERAL OCCURRENCES	5
GEOCHEMICAL SURVEY	5
ASSAY RESULTS	6
RECOMMENDATIONS	7

APPENDIX I

ANALYTICAL PROCEDURE & ASSAY RESULTS

APPENDIX II

1975 EXPENDITURE

APPENDIX III

ENGINEERS CERTIFICATE

ILLUSTRATIONS

	<u>SCALE</u>
LOCATION MAP	1" = 50 miles
PROPERTY MAP	1:50,000
ZINC IN SOILS	1" = 500'
LEAD IN SOILS	1" = 500'

INTRODUCTION

The following report has been prepared to fulfill the requirements of the Quartz Mining Act governing the filing of geochemical work for assessment credit. The field work was carried out between June 24 and July 9, 1975 by D. Peel, graduate geologist, and J. Poikans under the authors direction.

SUMMARY & CONCLUSIONS

During the period June 24 - July 8 a soil sampling program was completed on the Pong 41-62 claim group. Samples were taken at 200 foot stations on lines at 400 foot intervals.

The 493 samples collected were analysed for copper, lead and zinc. No significant anomalous copper values were obtained. Statistically anomalous lead and zinc are erratically distributed but two Zones requiring more detailed investigation are indicated.

An expenditure of \$7,000 on follow up geochemistry and prospecting is recommended to evaluate the anomalous indications.

PROPERTY & HISTORY

The property under consideration consists of 22 claims, Pong 41 to 62 inclusive, located on February 27, 1975 and recorded on March 7, 1975. Grant numbers are Y97257 to Y97278.

These claims adjoin to the north and west of Pong claim 1-40 which were the subject of a geological program during the 1974 season and reported on by T.L. Saddler-Brown. As a result of this program it was concluded that the original group was too high in the section to cover the favourable dolomite horizon and it was for this reason that the Pong 41 to 62 were staked.

LOCATION & ACCESS

The property is located in the Corn Creek area of the Bonnet Plume district.

Access in the exploration stage is by helicopter from Pinguicula Lake 13 miles to the northwest. Pinguicula Lake can accommodate all float equipped aircraft operating out of the supply base at Mayo, 115 miles to the southwest.

GENERAL

The claims are located in the valley bottom on the south side of a small tributary of Corn Creek. In an area of generally rugged topography, they cover a relatively flat area of extensive overburden, of hummocky glacial material.

Being at about 4,000' in elevation, timberline in this region, bush and small jackpine are prevalent.

GEOLOGY

The results of regional mapping in this area by the G.S.C. are available in Paper 53-7, Report of Activities 70-1 Part A, and Open Files 205 and 206.

The general area is underlain by sedimentary rocks ranging in age from Precambrian to Triassic. Of particular interest within this thick sequence are three carbonate horizons which are known to host strata-bound zinc deposits - these are the Lower Cambrian Sekwi and Backbone Ranges Formations and the unnamed dolomite horizon near the top of the Hadrynian. The Cambrian and Hadrynian carbonates are separated by a recessive black slate known as the Sheepbed Formation.

The distribution of these units as they occur in the Corn Creek area is shown on the accompanying Map 2. The spatial relationship between lead-zinc showings and the upper Hadrynian dolomite horizon is obvious on this map.

MINERAL OCCURRENCES

No mineral occurrences is known to outcrop on the property.

GEOCHEMICAL SURVEY

The extensive cover of the property presents an exploration problem compared to the light overburden of the upper slopes in this area. Samples were taken with a mattock in the B horizon of poorly sorted glacial material, which is very variable in depth. Therefore a low order anomaly can be of economic significance.

All samples collected were analysed for copper, lead, and zinc by the procedure outlined in Appendix I.

ASSAY RESULTS

COPPER - Copper values are persistent between 20 and 30 p.p.m. Two values of 165 p.p.m. and 136 p.p.m. are statistically anomalous but in view of their isolated nature are not considered significant.

LEAD - The background for lead is 30 to 50 p.p.m. and double the latter or 100 p.p.m. may be considered anomalous. A low order anomaly is indicated along a length of 2400 feet trending east-west on claims Pong 49 and 50 having its centre at 6800 on the baseline.

ZINC - Zinc values range from 28 to 2200 p.p.m. with a plateau at about 100, so values above 200 p.p.m. may be considered anomalous. A specific anomaly is located on the most westerly line 140+00 west and trends north northwesterly. this anomaly is significant since the trend is the same as the attitude of few small outcrops of dolomite in the vicinity. Other erratically distributed values occur, the significance of which can be established while checking the lead anomaly.

(7)

RECOMMENDATIONS

The anomalous lead and zinc values obtained by the soil survey require detailed investigation to determine their economic significance. This can best be done by a close spaced soil grid in the areas of interest accompanied by detailed prospecting.

A two man party would be occupied for 1 month to accomplish the initial follow up of the soil survey at a total cost of \$7,000.00.

Respectfully submitted,

J.W. MacLeod, P.Eng.

Vancouver, B.C.
December 19, 1975

APPENDIX I
ANALYTICAL PROCEDURE & ASSAY RESULTS



VANGEOCHEM LAB LTD. 1521 PEMBERTON AVE., NORTH VANCOUVER, B.C., CANADA 604-988-2172

December 19, 1975

TO: Bow River Resources Ltd.,
333 - 885 Dunsmuir Street,
Vancouver, B. C.,
V6C 1N5

FROM: Mr. Conway Chun,
Vangeochem Lab Ltd.,
1521 Pemberton Avenue,
North Vancouver, B. C.

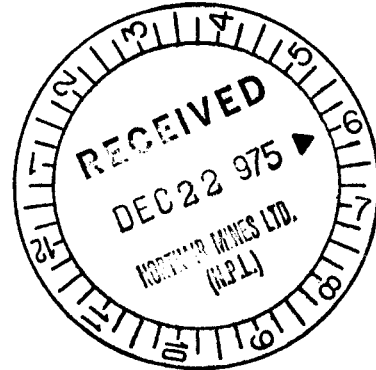

SUBJECT: Analytical procedure used to determine acid soluble
Pb, Zn, Cu in geochemical samples.

Re: Analytical Report # 75-19-005

1. Sample Preparation

- (a) Geochemical soil or silt samples were received in the laboratory in wet-strength 3½ x 6½ Kraft paper bags.
- (b) The wet samples were dried in a ventilated oven.
- (c) The dried soil and silt samples were sifted by using a shaking machine with an 80-mesh stainless steel sieve. The plus 80-mesh fraction was rejected and the minus 80-mesh fraction was transferred into a new bag for analysis later.

2. Methods of Digestion

- (a) 0.50 gram of the minus 80-mesh samples was used. Samples were weighed out by using a top-loading balance.
- (b) Samples were heated in a sand bath with nitric and perchloric acids (15% to 85% by volume of the concentrated acids respectively).

.....2

- (c) The digested samples were diluted with demineralized water to a fixed volume and shaken.

3. Method of Analysis

Pb, Zn, Cu analyses were determined by using a Techtron Atomic Absorption Spectrophotometer Model AA4 or Model AA5 with their respective hollow cathode lamp. The digested samples were aspirated directly into an air and acetylene flame. The results, in parts per million, were calculated by comparing a set of standards to calibrate the atomic absorption unit.

4. The analyses were supervised or determined by Mr. Conway Chun and the laboratory staff.

Conway Chun
VANGEOCHEM LAB LTD.

CC:smb



VANGEOCHEM LAB LTD.
 1521 PEMBERTON AVE.,
 NORTH VANCOUVER, B.C.,
 CANADA V7P 2S3

TELEPHONE: 988-2172
 AREA CODE: 604

• Specialising in Trace Elements Analyses •

Certificate of Geochemical Analyses

-IN ACCOUNT WITH-

Bow River Resources Ltd.
 #333 - 885 Dunsmair Street
 Vancouver, B. C.

Attention:

Report No: **75 19 005** Page **1** of **13**
 Samples Arrived: **July 16, 1975**
 Report Completed: **July 22, 1975**
 For Project:
 Analyst: **E.T., R.H.**
 Invoice #3368 Job No. 75-090

Sample Marking	Cu ppm	Pb ppm	Zn ppm			
XC	0	12	105	250		
	2	12	46	138		
	4	11	55	200		
	6	13	48	93		
	8	15	45	75		
	10	18	35	60		
	12	11	46	160		
	14	12	45	225		
	16	5	37	38		
	18	11	55	120		
	20	11	20	50		
	22	8	25	70		
	24	25	35	128		
	26	18	40	150		
	28	14	70	330		
SC	30	15	50	85		
	3A	17	51	190		
	3B	16	48	200		
	3C	17	23	103		
	3D	26	22	83		
	3E	23	92	198		
	3F	17	225	243		
	3G	16	97	153		
	3H	25	82	158		
	3I	12	40	88		
LO	3J	8	42	183		
	BL	7	35	38		
	2 8	10	35	63		
	4 8	15	36	73		
	6 8	5	22	43		
	8 8	15	35	73		
	10 8	25	33	73		
	12 8	33	30	128		
	14 8	22	25	23		
	16 8	29	23	65		
L 4	2 8	8	35	38		
	2 8	12	30	83		
	4 8	15	31	53		
	6 8	7	30	28		

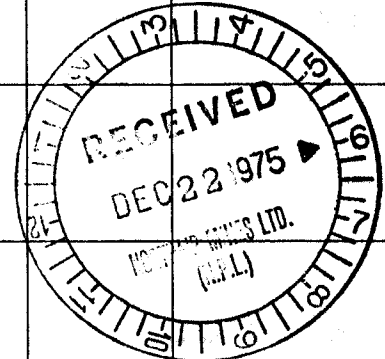

MASTER PRINTING LTD.

REMARKS:

Signed: *E. Dean*

% Mo x 1.6683 = % MoS₂ 1 Troy oz./ton = 34.28 ppm 1 ppm = 0.0001% nd = none detected ppm = parts per million
 All values are believed to be correct to the best knowledge of the analyst based on the method and instruments used.



VANGEOCHEM LAB LTD.
 1521 PEMBERTON AVE.,
 NORTH VANCOUVER, B.C.,
 CANADA V7P 2S3

TELEPHONE: 988-2172
 AREA CODE: 604

• Specialising in Trace Elements Analyses •

Certificate of Geochemical Analyses

-IN ACCOUNT WITH-

Bow River Resources Ltd.

Attention:

Report No: **75 19 005** Page **2** of **13**
 Samples Arrived:
 Report Completed:
 For Project:
 Analyst:

Sample Marking	Cu ppm	Pb ppm	Zn ppm			
L 4 8 S	9	36	25			
10 S	33	17	6			
L 4 12 S	15	31	65			
L 4 14 S	20	40	65			
L 8 B L	14	70	115			
2 N	25	20	17			
2 S	24	40	270			
4 N	12	39	70			
4 S	9	37	35			
6 S	21	28	35			
8 S	17	28	107			
10 S	28	24	50			
L 8 12 S	18	34	63			
L 8 14 S	22	35	125			
L 12 2 N	40	42	100			
2 S	32	43	110			
4 N	26	40	107			
4 S	19	40	95			
6 S	24	35	108			
8 S	24	35	95			
L 12 10 S	20	30	32			
12 S	20	20	50			
L 16 14 S	16	31	90			
L 16 B L	18	40	105			
2 N	24	35	80			
2 S	46	27	70			
4 N	26	46	94			
4 S	26	30	63			
6 N	8	40	47			
6 S	34	38	97			
8 S	15	30	80			
10 S	40	40	105			
11 S	27	28	54			
12 S	35	35	80			
L 16 14 S	20	32	124			
L 20 B L	32	36	93			
QT 50 S	36	37	95			
2 N	38	55	160			
L 20 2 S	31	37	90			

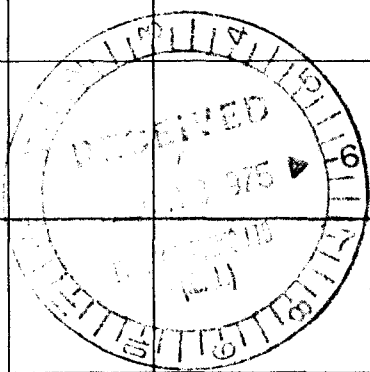

MASTER PRINTING LTD.

REMARKS:

Signed:

% Mo x 1.6683 = % MoS₂ 1 Troy oz./ton = 34.28 ppm 1 ppm = 0.0001% nd = none detected ppm = parts per million
 All values are believed to be correct to the best knowledge of the analyst based on the method and instruments used.



VANGEOCHEM LAB LTD.
1521 PEMBERTON AVE.,
NORTH VANCOUVER, B.C.,
CANADA V7P 2S3

TELEPHONE: 988-2172
AREA CODE: 604

• Specialising in Trace Elements Analyses •

Certificate of Geochemical Analyses

-IN ACCOUNT WITH-

Bow River Resources Ltd.

Attention:

Report No: **75 19 005** Page **3** of **13**
Samples Arrived:
Report Completed:
For Project:
Analyst:

Sample Marking	Cu PPM	Pb PPM	Zn PPM			
L 20 4 N 4 S 6 N 6 S 8 S	32	35	93			
	39	38	73			
	14	40	58			
	16	28	55			
	16	26	46			
L 20 10 S 12 S L 24 14 S L 24 8 L 2 N	9	13	53			
	20	35	58			
	24	32	78			
	27	23	45			
	32	35	108			
2 S 4 N 4 S 6 N 6 S	39	23	58			
	32	26	168			
	37	38	107			
	37	40	95			
	26	43	125			
	22	35	90			
L 24 8 S 10 S 12 S L 24 14 S L 28 8 L	22	36	78			
	18	32	58			
	27	34	65			
	19	31	70			
	19	15	28			
2 S 2 S 4 N 4 S 6 N	14	40	58			
	37	45	108			
	15	33	120			
	16	67	143			
	17	32	100			
	24	20	48			
L 28 8 S 10 S 12 S 14 S	26	32	100			
	21	29	63			
	22	34	83			
	36	12	15			
	24	40	88			
L 32 2 N 2 S 4 N 4 S	26	33	100			
	32	45	98			
	25	46	125			
	23	37	75			
	19	86	153			
L 32 6 S 8 N 8 S	20	48	108			
	22	41	150			

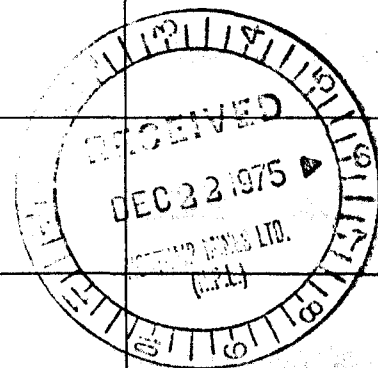

MASTER PRINTING LTD.

REMARKS:

Signed:

% Mo x 1.6683 = % MoS₂ 1 Troy oz./ton = 34.28 ppm 1 ppm = 0.0001% nd = none detected ppm = parts per million
All values are believed to be correct to the best knowledge of the analyst based on the method and instruments used.



VANGEOCHEM LAB LTD.
 1521 PEMBERTON AVE.,
 NORTH VANCOUVER, B.C.,
 CANADA V7P 2S3

TELEPHONE: 988-2172
 AREA CODE: 604

• Specialising in Trace Elements Analyses •

Certificate of Geochemical Analyses

-IN ACCOUNT WITH-

Bow River Resources Ltd.

Attention:

Report No: **75 19 005** Page **4** of **13**
 Samples Arrived:
 Report Completed:
 For Project:
 Analyst:

Sample Marking	Cu PPM	Pb PPM	Zn PPM			
L 32 10 S	20	36	95			
12 S	22	33	56			
L 32 14 S	19	42	96			
L 36 B L	26	42	75			
2 N	24	38	71			
2 S	26	36	78			
4 N	16	40	68			
4 S	27	42	73			
6 N	27	37	71			
6 S	28	37	70			
8 N	14	45	76			
8 S	24	36	55			
10 S	26	45	85			
L 36 12 S	15	68	87			
L 36 14 S	42	47	82	silt		
L 40 B L	34	40	110			
2 N	30	32	110			
2 S	31	41	80			
4 N	27	40	74			
4 S	43	152	262			
6 N	23	35	64			
6 S	30	110	345	silt		
8 NA	42	43	120			
8 NB	16	43	65			
8 S	21	37	80			
10 S	19	42	103			
12 S	26	36	150			
L 40 14 S	21	35	70			
L 44 B L	22	200	149			
2 N	8	80	155			
2 S	14	150	178			
4 N	9	83	210			
4 S	23	80	245			
6 N	28	46	82			
6 S	26	77	216			
8 N	21	45	107			
8 S	22	56	122			
10 S	21	30	58			
L 44 12 S	17	27	54			

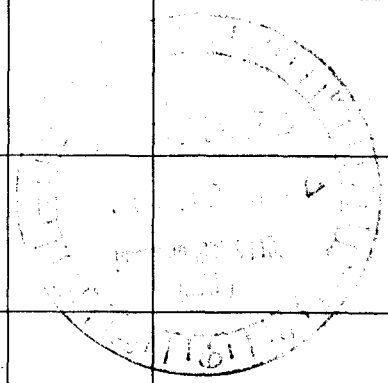

MASTER PRINTING LTD.

REMARKS:

Signed: _____

% Mo x 1.6683 = % MoS₂ 1 Troy oz./ton = 34.28 ppm 1 ppm = 0.0001% nd = none detected ppm = parts per million
 All values are believed to be correct to the best knowledge of the analyst based on the method and instruments used.



VANGEOCHEM LAB LTD.
 1521 PEMBERTON AVE.,
 NORTH VANCOUVER, B.C.,
 CANADA V7P 2S3

TELEPHONE: 988-2172
 AREA CODE: 604

• Specialising in Trace Elements Analyses •

Certificate of Geochemical Analyses

-IN ACCOUNT WITH-

Bow River Resources Ltd.

Attention:

Report No: **75 19 005** Page **6** of **13**
 Samples Arrived:
 Report Completed:
 For Project:
 Analyst:

Sample Marking	Cu ppm	Pb ppm	Zn ppm			
L 60 4 N	32	32	72			
4 S	15	95	119			
6 S	19	108	254			
8 N	8	66	53			
8 S	13	110	345			
10 N	20	36	72			
10 S	14	55	90			
12 N	9	47	55			
12 S	16	30	58			
L 60 14 N	12	44	48			
L 64 B L	46	20	18			
2 N	23	35	67			
2 S	14	70	115			
4 N	35	43	85			
4 S	18	110	135			
6 N	22	62	231	Silt		
6 S	34	35	90			
8 S	28	95	270			
10 N	12	55	52			
10 S	23	15	26			
12 N	16	42	50			
12 S	36	35	70			
L 64 14 N	15	45	63			
L 68 B L	16	103	146			
2 N	12	65	96			
2 S	26	62	293			
4 N	51	60	97			
4 S	20	75	175			
6 N	15	67	115			
6 S	19	55	76			
8 N	25	47	154			
8 S	22	32	65			
10 N	16	72	116			
10 S	11	32	54			
12 N	12	100	110			
L 58 14 N	44	38	94			
L 72 B L	34	92	147			
2 N	18	80	124			
L 72 2 S	14	70	200			

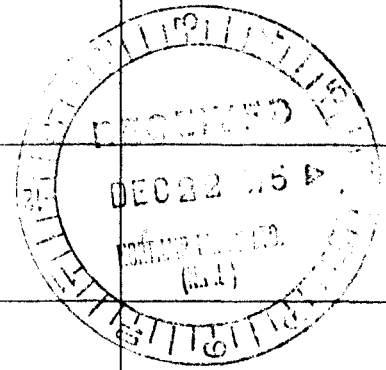

MASTER PRINTING LTD.

REMARKS:

Signed: 6

% Mo x 1.6683 = % MoS₂ 1 Troy oz./ton = 34.28 ppm 1 ppm = 0.0001% nd = none detected ppm = parts per million
 All values are believed to be correct to the best knowledge of the analyst based on the method and instruments used.



VANGEOCHEM LAB LTD.
 1521 PEMBERTON AVE.,
 NORTH VANCOUVER, B.C.,
 CANADA V7P 2S3

TELEPHONE: 988-2172
 AREA CODE: 604

• Specialising in Trace Elements Analyses •

Certificate of Geochemical Analyses

-IN ACCOUNT WITH-

Bow River Resources Ltd.

Attention:

Report No: **75 19 005** Page **9** of **13**
 Samples Arrived:
 Report Completed:
 For Project:
 Analyst:

Sample Marking	Cu ppm	Pb ppm	Zn ppm			
L 96 4 S	55	15	14			
6 N	23	40	80			
6 S	25	25	67			
8 N	21	34	80			
8 S	16	25	60			
10 N	32	28	110			
10 S	22	24	65			
12 N	22	35	80			
12 S	32	30	75			
L 96 14 S	45	30	89			
L 100 B L	23	25	85			
2 N	30	23	92			
2 S	20	20	74			
4 N	40	23	82			
4 S	44	12	15			
6 N	56	22	72			
6 S	30	22	67			
8 N	36	27	95			
8 S	14	20	38			
L 100 10 N	20	48	152			
12 N	55	32	188			
12 S	15	30	85			
14 N	22	30	150			
L 100 14 S	165	17	124			
L 104 2 N	29	23	85			
4 N	23	28	75			
6 N	20	24	69			
8 N	12	24	74			
8 S	15	15	27			
10 N	22	30	75			
12 N	30	25	87			
12 S	17	28	55			
14 N	38	28	97			
L 104 14 S	30	14	20			
L 108 B L	22	25	65			
2 N	21	27	58			
2 S	22	29	94			
L 108 B 2 SA	24	26	82			

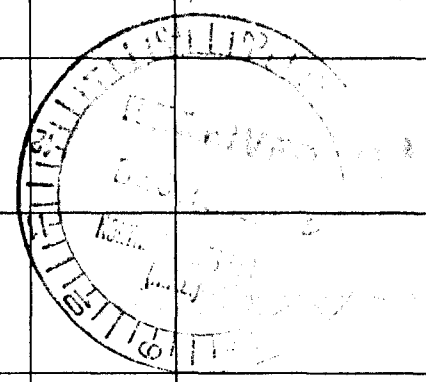

MASTER PRINTING LTD.

REMARKS:

Signed: _____

% Mo x 1.6683 = % MoS₂ 1 Troy oz./ton = 34.28 ppm 1 ppm = 0.0001% nd = none detected ppm = parts per million

All values are believed to be correct to the best knowledge of the analyst based on the method and instruments used.



VANGEOCHEM LAB LTD.
 1521 PEMBERTON AVE.,
 NORTH VANCOUVER, B.C.,
 CANADA V7P 2S3

TELEPHONE: 988-2172
 AREA CODE: 604

• Specialising in Trace Elements Analyses •

Certificate of Geochemical Analyses

-IN ACCOUNT WITH-

Bow River Resources

Attention:

Report No: **75 19 005** Page **10** of **13**
 Samples Arrived:
 Report Completed:
 For Project:
 Analyst:

Sample Marking	Cu ppm	Pb ppm	Zn ppm			
L 108 4 N	26	35	50			
4 S	22	31	75			
4 SA	25	36	75			
5 S	12	135	222			
6 N	17	37	70			
6 S	49	42	145			
6 SA	17	20	45			
8 N	18	26	88			
8 S	14	20	60			
8 SA	18	20	65			
10 N	14	34	76			
10 S	30	15	28			
12 N	7	33	46			
12 S	15	23	80			
14 N	15	25	72			
L 108 14 S	24	23	55			
L 112 8 L	24	22	60			
2 N	22	30	74			
2 S	25	22	65			
L 112 4 N	14	24	68			
L 112 4 S	20	26	70			
6 N	22	43	75			
6 S	18	23	35			
8 N	17	30	60			
8 S	26	28	80			
10 N	22	22	50			
10 S	35	22	45			
12 N	17	30	70			
12 S	20	24	65			
14 N	9	47	55			
14 S	20	24	50			
L 112 - 2 + 30 N	16	22	75	811t		
L 116 8 L	19	123	125			
2 N	21	24	80			
2 S	29	27	90			
4 N	27	28	80			
4 S	42	18	65			
6 N	28	25	80			
L 116 6 S	18	21	50			

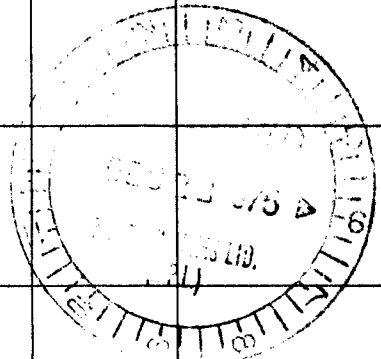

MASTER PRINTING LTD.

REMARKS:

Signed: *b.*



VANGEOCHEM LAB LTD.
 1521 PEMBERTON AVE.,
 NORTH VANCOUVER, B.C.,
 CANADA V7P 2S3

TELEPHONE: 988-2172
 AREA CODE: 604

• Specialising in Trace Elements Analyses •

Certificate of Geochemical Analyses

-IN ACCOUNT WITH-

Bow River Resources Ltd.

Attention:

Report No: **75 19 005** Page **11** of **13**
 Samples Arrived:
 Report Completed:
 For Project:
 Analyst:

Sample Marking	Cd PPM	Pb PPM	Zn PPM		
L 116 8 N	39	25	230		
8 S	25	25	107		
10 N	15	65	133		
10 S	17	27	85		
12 N	14	37	88		
12 S	38	26	58		
L 116 14 N	28	45	105		
L 120 14 S	33	27	80		
2 N	22	29	64		
2 S	26	27	60		
4 N	13	30	68	silt	
4 S	15	22	70		
6 N	16	26	58		
6 S	18	25	114		
8 N	27	28	55	silt	
8 S	36	45	155		
10 N	24	30	53		
10 S	21	30	95		
L 120 12 N	12	12	17		
L 120 12 S	10	58	94		
14 N	18	30	80		
L 120 14 S	17	27	34		
L 124 14 S	19	27	68		
2 N	42	17	20		
2 S	28	23	69		
2 SA	20	25	53		
4 N	17	35	80		
4 S	26	27	72		
4 SA	15	25	58		
6 N	25	32	77		
6 S	21	20	98		
6 SA	18	30	70		
8 N	24	32	88		
8 S	26	28	94		
8 SA	15	22	64		
10 N	32	30	62		
L 124 10 S	14	65	132		
12 N	16	10	52		
12 S	44	56	144		

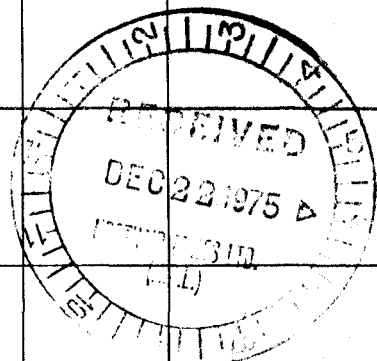

MASTER PRINTING LTD.

REMARKS:

Signed: 6

% Mo x 1.6683 = % MoS₂

1 Troy oz./ton = 34.28 ppm

1 ppm = 0.0001%

nd = none detected

ppm = parts per million

All values are believed to be correct to the best knowledge of the analyst based on the method and instruments used.



VANGEOCHEM LAB LTD.
 1521 PEMBERTON AVE.,
 NORTH VANCOUVER, B.C.,
 CANADA V7P 2S3

TELEPHONE: 988-2172
 AREA CODE: 604

• Specialising in Trace Elements Analyses •

Certificate of Geochemical Analyses

-IN ACCOUNT WITH-

Bow River Resources Ltd.

Attention:

Report No: **75 19 005** Page **12** of **13**
 Samples Arrived:
 Report Completed:
 For Project:
 Analyst:

Sample Marking	Cu ppm	Pb ppm	Zn ppm			
L 124 12 S	21	20	62			
14 N	16	35	54			
L 124 14 S	16	25	50			
L 128 B L	24	53	96			
2 N	19	30	75			
2 S	27	18	56			
4 N	23	20	58			
4 S	22	30	135			
6 N	18	20	64			
6 S	32	30	98			
8 N	18	22	85			
8 S	25	35	75			
10 N	23	25	70			
10 S	28	43	158			
12 N	17	42	112			
12 S	21	35	90			
L 128 14 N	15	48	143			
14 S	23	22	82			
L 132 B L	35	38	90			
L 132 2 N	20	105	103			
L 132 2 S	22	55	112			
4 N	18	52	94			
4 S	28	17	73			
6 N	30	37	47			
6 S	15	67	142			
8 N	36	125	85			
8 S	17	160	200			
10 N	22	40	82			
10 S	19	100	205			
12 N	39	20	45			
12 S	19	40	107	silt		
L 132 14 N	17	50	118			
14 S	25	30	85			
L 136 B L	16	40	90			
2 N	28	45	128			
2 S	15	15	75			
4 N	16	50	80			
4 S	25	40	90			
L 136 6 N	12	45	165			

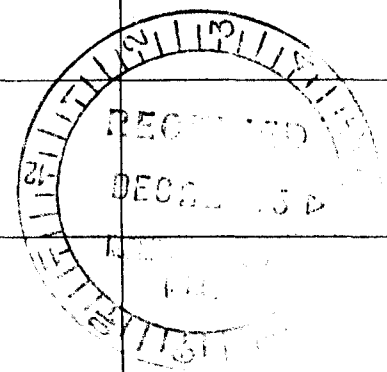

MASTER PRINTING LTD.

REMARKS:

Signed: 6

% Mo x 1.6683 = % MoS₂ 1 Troy oz./ton = 34.28 ppm 1 ppm = 0.0001% nd = none detected ppm = parts per million
 All values are believed to be correct to the best knowledge of the analyst based on the method and instruments used.

INTRODUCTION

On August 21st, 1975 Peter E. Walcott & Associates Limited carried out a limited gravity survey over two lines on the Lisa grid, located in the Anvil area of the Yukon Territory, optioned by Cyprus Anvil Mining Corporation.

The survey was carried out over two handcut lines 800 feet apart that were part of a larger grid over which previous exploration work had been done.

Measurements of relative gravity were made every 100 feet along the picket lines using a CG-2 gravity meter. In addition elevations at each of the gravity stations were obtained using a Sokkisha TM-20C theodolite and rod.

The data was then processed and presented in profile form on Map W-201-1 that accompanies this report.

PROPERTY, LOCATION AND ACCESS

The property, held by Ridgemount Mining Corporation, is located in the Whitehorse Mining District and consists of the following claims:

<u>Claim Name</u>	<u>Grant No.</u>
LISA 1 - 28	Y 75073 - 100
29 - 41	Y 80441 - 453

The claims are located straddling Ace High Creek some sixteen miles east of the Anvil minesite.

Access is obtained by helicopter from the town of Faro, some fourteen miles to the southwest.



VANGEOCHEM LAB LTD.
 1521 PEMBERTON AVE.,
 NORTH VANCOUVER, B.C.,
 CANADA V7P 2S3

TELEPHONE: 988-2172
 AREA CODE: 604

•Specialising in Trace Elements Analyses•

Certificate of Geochemical Analyses

-IN ACCOUNT WITH-

Bow River Resources Ltd.

Attention:

Report No: **75 19 005** Page **13** of **13**
 Samples Arrived:
 Report Completed:
 For Project:
 Analyst:

Sample Marking	Cu ppm	Pb ppm	Zn ppm			
L 136 6 S	14	40	165			
8 N	12	25	63			
8 S	10	40	131			
10 N	36	40	95			
10 S	15	52	202			
12 N	14	30	133			
12 S	29	12	68			
14 N	10	45	80			
L 136 14 S	20	38	93			
L 140 BL	20	52	222			
2 N	32	30	77			
2 S	56	12	2200			
4 N	7	18	106			
4 S	32	40	500			
6 N	8	32	130			
6 S	48	140	380			
8 N	25	24	183			
8 S	12	55	112			
10 N	20	47	104			
L 140 10 S	10	28	76			
L 140 12 N	15	13	63			
12 S	14	40	100			
14 N	34	20	62			
L 140 14 S	27	45	120			
L 12 - BL	16	187	560			

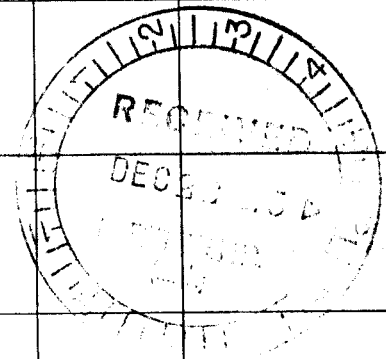

MASTER PRINTING LTD.

REMARKS:

Signed: _____

% Mo x 1.6683 = % MoS₂ 1 Troy oz./ton = 34.28 ppm 1 ppm = 0.0001% nd = none detected ppm = parts per million
 All values are believed to be correct to the best knowledge of the analyst based on the method and instruments used.

APPENDIX II
1975 EXPENDITURE

Sample collecting - June 24 - July 8

D. Peel	- 15 days @ 50.00 =	\$750.00
J. Poikans	- 15 days, @ 50.00 =	750.00
Sample analysis		1,153.62
Helicopter in & out		984.00
Accommodation 30 man days @ 20.00 =		600.00
Report preparation		<u>200.00</u>
		4,437.62



VANGEOCHEM LAB LTD.

604-988-2172

1521 PEMBERTON AVE., NORTH VANCOUVER, B.C.
CANADA

IN ACCOUNT WITH:

Bow River Resources Ltd.
#333 - 885 Dunsmuir Street
Vancouver, B. C.

INVOICE: 3368

DATE: July 22, 1975

TERMS: NET 21 DAYS

FOR REPORT 75 19 005
Job No. 75-090

PROJECT:

ORDER NO.

493 samples for preparation	@ \$0.35/ea.	\$ 172.55
493 analyses for Cu, Pb, Zn	@ \$2.25/ea.	1,109.25
	sub-total	\$ 1,281.80
	Less discount of 10%	<u>128.18</u>
		<u>\$ 1,153.62</u>

GOODS REC'D	OK FOR PAYMENT
PRICES & EXT. OK	CHEQUE NO.
CODE	AMOUNT

OK. H&B.

Low In.

50% H&B.

CHARTER TICKET

MAYO HELICOPTERS

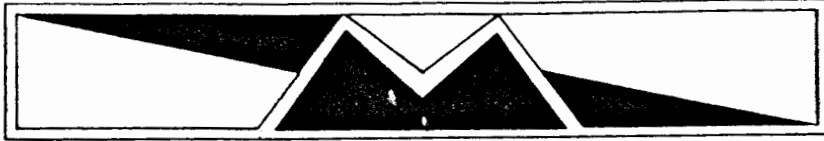

MAYO, Y.T. /BOX 5/ PHONE 996-3291

WHITEHORSE, Y.T. /BOX 2295/ PHONE 633-2214

A/C MLW CF MLW DATE 8 JUL 1975

NAME Bow River Resources LTD

ADD. _____

FROM	MILES	HOURS	CARGO	PASS.	REMARKS
PORTERHULL		2.7			
TO: PUNG LAKE					
<i>P. Paul</i> PILOT'S SIGNATURE					
SPECIAL INSTRUCTIONS					
OUR FUEL	GALS.	2.7 @ 175 PER HOUR			472 50
THEIR FUEL	GALS.	@ PER MILE			
AREA		WAITING TIME @ PER HOUR			
PICK UP DATE		EXTRA LANDINGS @ PER LANDING			
LOCATION		OTHER			
SEE REVERSE FOR CONDITIONS					
X <i>D. Paul</i> TOTAL					472 50

3379 Mayo
BASE

CHARTER'S AUTHORIZATION CUSTOMER COPY

CHARTER TICKET

MAYO HELICOPTERS

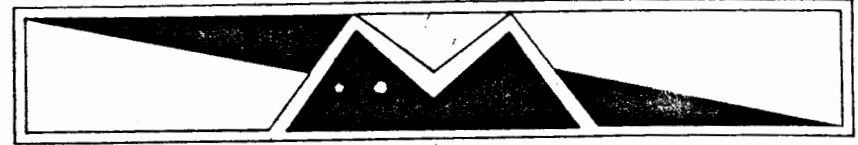

MAYO, Y.T. /BOX 5/ PHONE 996-3291

WHITEHORSE, Y.T. /BOX 2295/ PHONE 633-2214

A/C HTK CF HTK DATE 24 June 1975

NAME Bow River Res.

ADD. _____

FROM	MILES	HOURS	CARGO	PASS.	REMARKS
CAMP		3.3			
TO: Local					
<i>A. Johnson</i> PILOT'S SIGNATURE					
SPECIAL INSTRUCTIONS					
OUR FUEL	GALS.	3.3 @ 155 PER HOUR			511 50
THEIR FUEL	GALS.	@ PER MILE			
AREA		WAITING TIME @ PER HOUR			
PICK UP DATE		EXTRA LANDINGS @ PER LANDING			
LOCATION		OTHER			
SEE REVERSE FOR CONDITIONS					
X <i>D. Paul</i> TOTAL					511 50

3220 BASE

CHARTER'S AUTHORIZATION CUSTOMER COPY

APPENDIX III
ENGINEERS CERTIFICATE

APPENDIX III
ENGINEERS CERTIFICATE

I, James W. MacLeod, of 1220 Arbutus Street, in the city of Vancouver, in the Province of British Columbia, DO HEREBY CERTIFY:

1. That I am a Consulting Engineer, with a business address at #333-885 Dunsmuir Street, in the City of Vancouver, in the Province of British Columbia.
2. That I am a graduate of the University of Alberta with the degree of B.Sc. in Mining Engineering.
3. That I have actively practiced my profession in Mineral exploration since graduation in 1946.
4. That I am a registered Professional Engineer in the Province of British Columbia
5. That this report is based on the results of field work carried out by D. Peel, B.Sc. and J. Poikans between June 24 and July 8, 1975 under the direction of the writer.

J.W. MacLeod, B.Sc., P. Eng.

Dated at the City of Vancouver,
Province of British Columbia,
this 19th day of December, 1975.

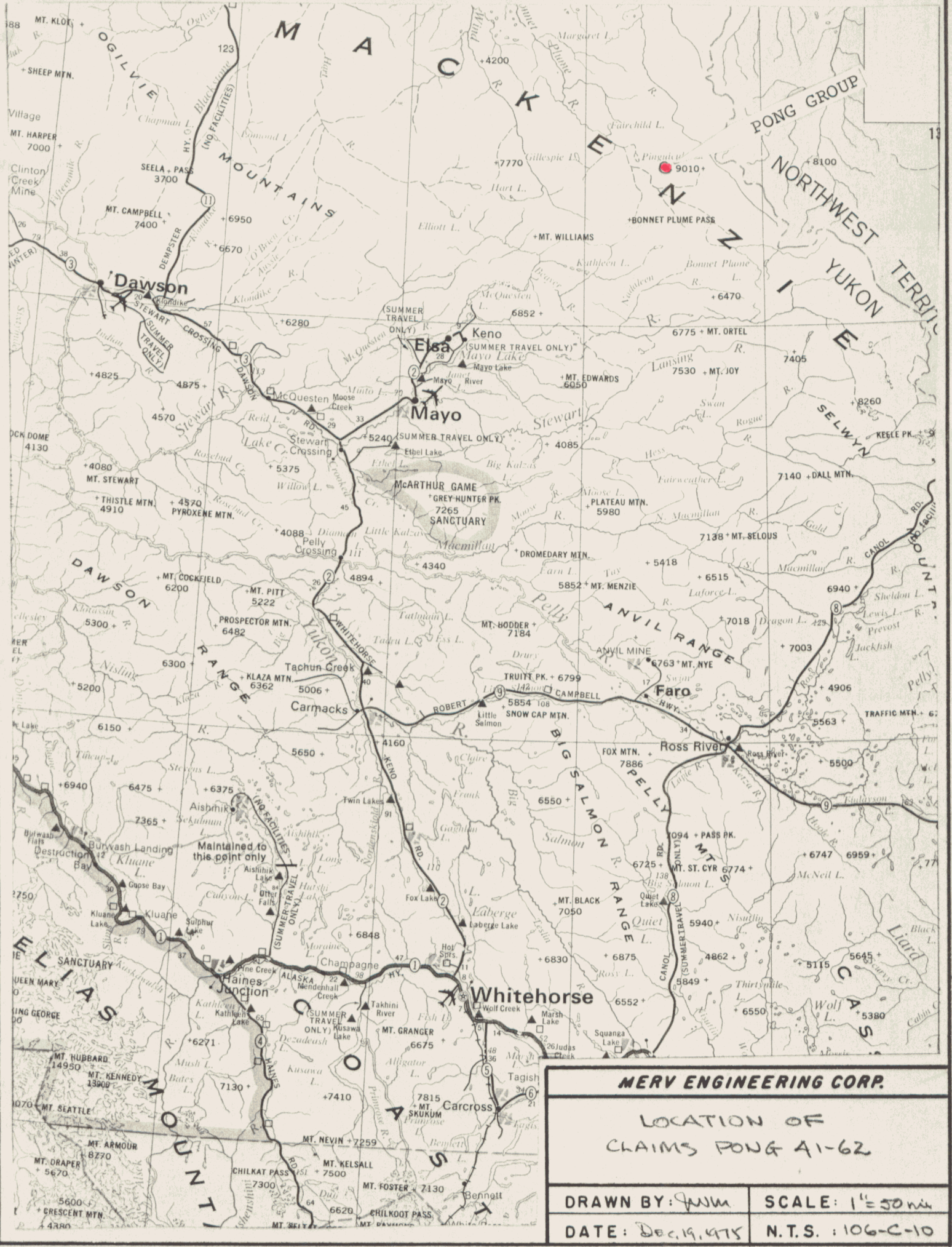

MERV ENGINEERING CORP.	
LOCATION OF CLAIMS PONG A1-62	
DRAWN BY: JAWM	SCALE: 1" = 50 NM
DATE: DEC. 19, 1975	N.T.S. : 106-C-10

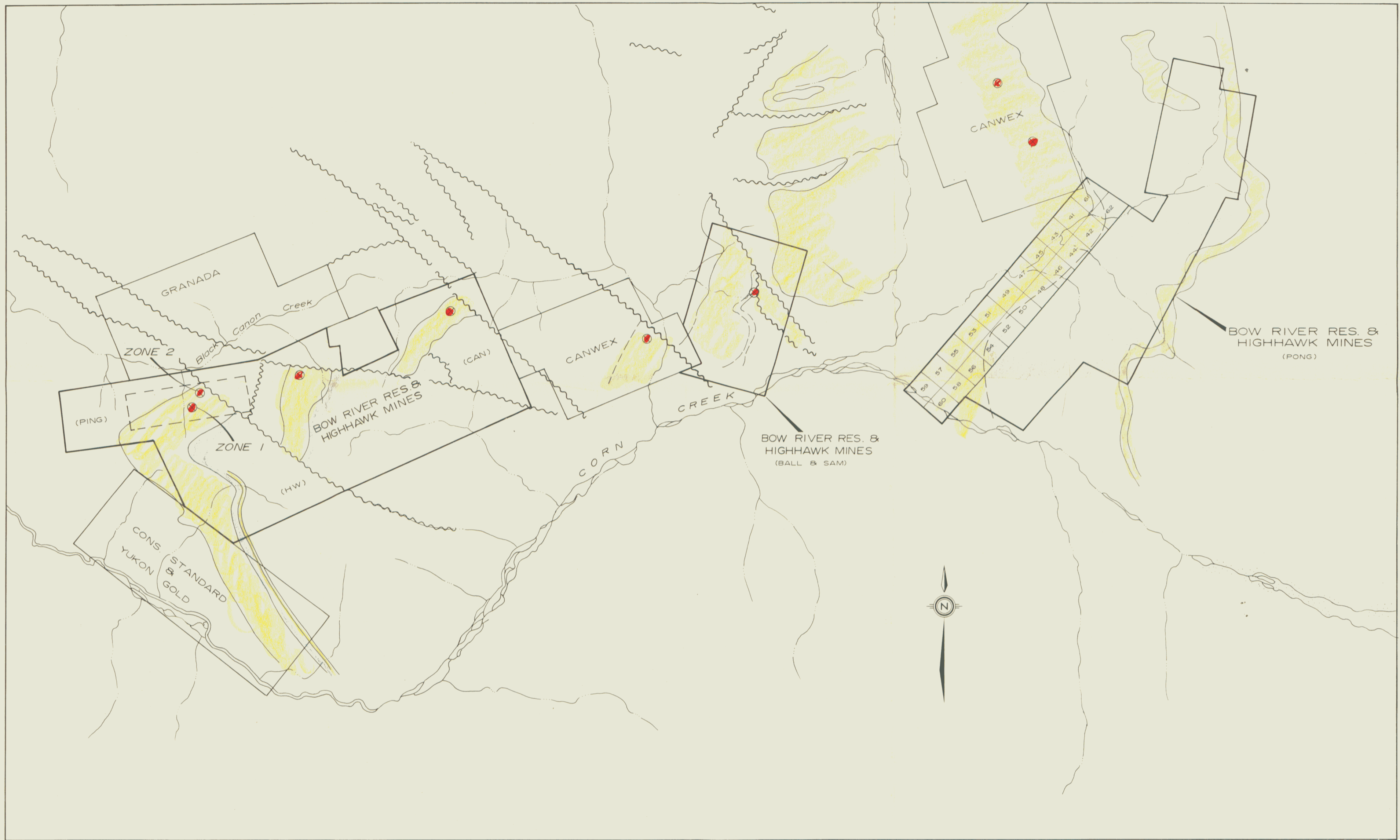

LEGEND

- DOLOMITE - (BACKBONE RANGES Fm.)
- SHALE - (SHEEPBED Fm.)
- DOLOMITE - (UPPER HADRYNIAN)
- MINERALIZED SHOWING

MAP 2

BOW RIVER RESOURCES LTD.
&
HIGHHAWK MINES LTD. (N.P.L.)

GENERAL GEOLOGY
PONG CLAIMS

DRAWN BY : J.W.M.

SCALE: 1 : 50,000

DATE: DECEMBER, 1975

N.T.S.: 106 C 10 & 11

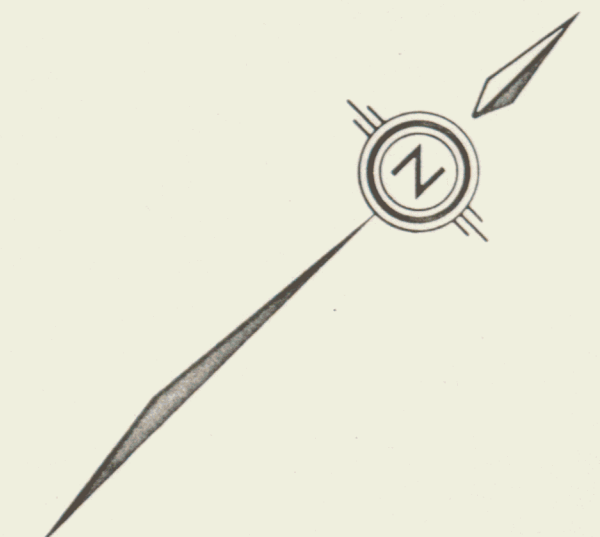

BOW RIVER RESOURCES LTD & HIGHHAWK MINES LTD.			
Drawn by:	Traced by:	PONG CLAIMS	
Revised by:	Revised by:	GEOCHEMICAL SURVEY	
		Ppm Zn	
		Scale: 1" = 500'	Date: July, 1975
			Plate:

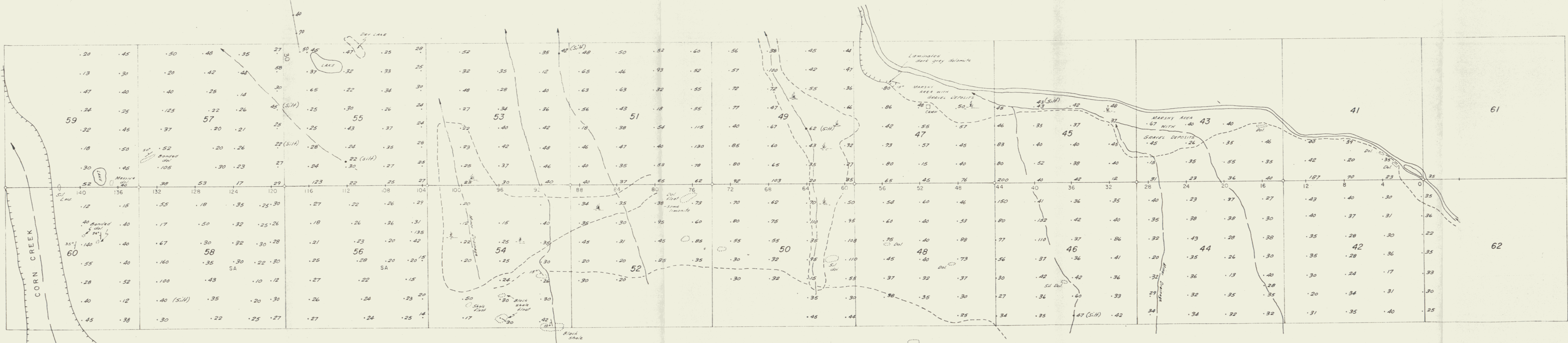
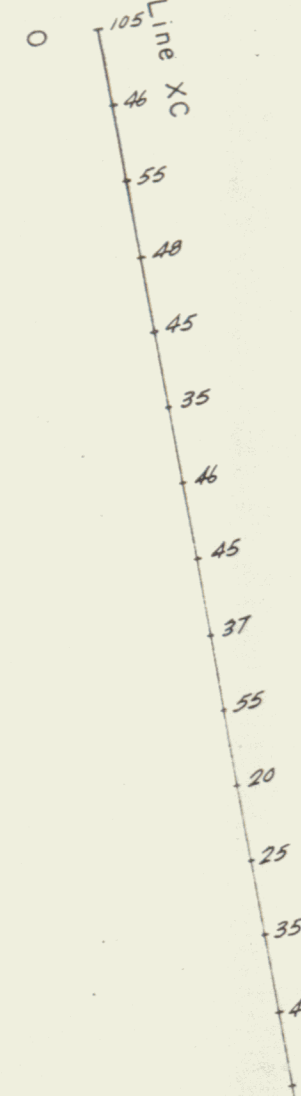
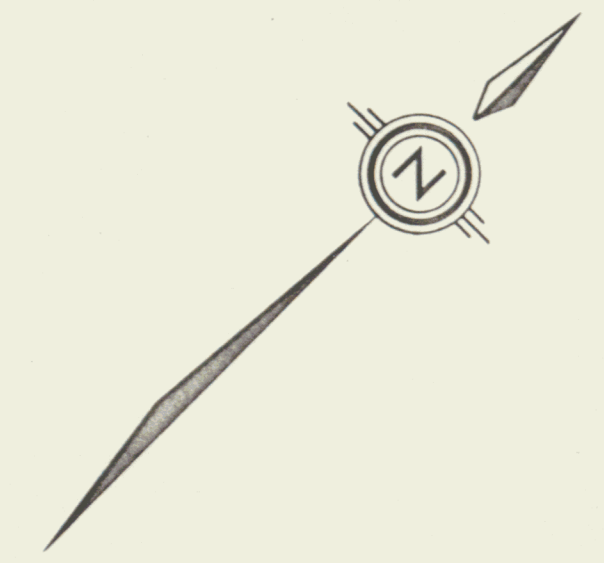

BOW RIVER RESOURCES LTD & HIGHHAWK MINES LTD.			
Drawn by:	Traced by: <i>PLG</i>	PONG CLAIMS	
Revised by:	Revised by:	GEOCHEMICAL SURVEY	
		Ppm Pb	
		Scale: 1" = 500'	Date: July, 1975
			Plate: