

MAP No.

105-M-14

ASSESSMENT REPORT
N. M. E. A. P.
CONFIDENTIAL
OPEN FILE

X

TYPE OF

WORK: Summary Geol.

REPORT FILED UNDER	Decker Lake Mines Ltd.	DOCUMENT NO.061569
DATE PERFORMED	1975	DATE FILED: July 11, 1977
LOCATION - LAT.	63° 57' N	AREA: Keno Hill, Yukon
LONG.	135° 11' W	
CLAIM NO.	Laurasia Gp (7 patented claims, see report)	
VALUE \$		
WORK DONE BY	D.C. Malcolm	
WORK DONE FOR	Decker Lake Mines Ltd.	
REMARKS	Summary of work completed to date on the Laurasia Option which contains 2 silver veins in connection with proposed program for 1977.	

**D. C. MALCOLM, P. ENG.
CONSULTING GEOLOGIST**

TELEPHONE 731-7208

2290 WEST 25RD AVENUE
VANCOUVER 8, B.C.
V6L 1N4
May 30, 1977

DECKER LAKE MINES LIMITED (N.P.L.)
618 - 510 West Hastings Street
Vancouver, B.C.

Dear Sirs:-

Your Larasia claims on Keno Hill in the Yukon Territory have two silver veins typical of the area. These were described in my November 24, 1975 Report which recommended work which would lead to production from the Runtum vein and to the further exposure of the vein on the muskeg covered Bucaneer claim. This work should be completed and some test shipments should be made from the Runtum vein.

Geochemical work done by others on claims adjoining the Larasia claims is described as being successful. In recent years, in the Mayo District, programs of geochemical work done in conjunction with percussion drilling, have located ore bodies.

The southern part of the Larasia claims are muskeg covered but contain some good indications of new deposits.

I would recommend a geochemical-percussion drilling program on these claims in addition to the completion of the recommended work on the veins.

I would estimate the percussion drilling would cost \$15,000 and the geochemical work, mobilization, assaying and line cutting would cost \$5,000.

The overall estimated cost of 1977 field work on the Larasia would be about \$39,000.

Yours truly,

D. C. Malcolm

D. C. MALCOLM, P. Eng.,
Consulting Geologist

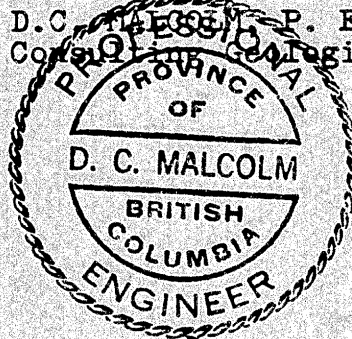

pdm

VANCOUVER CURB
EXCHANGE LISTING

DECKER LAKE MINES LTD (NPL)

LAURASIA RESOURCES LTD. OPTION

KENO HILL

MAYO MINING DISTRICT, YUKON TERRITORY

SUMMARY

DECKER LAKE MINES have an option on seven centrally located Patented claims covering a band of Keno Hill Quartzite on Keno Hill.

In 1975 an access road was built to veins on the Bucaneer and Rum Tum claims. Bulldozer trenching exposed a 200 foot length of the Nabob No. 2 vein on the Bucaneer with silver values ranging from 8.37 to 336.25 oz. per ton. Rock trenching on the Rum Tum exposed a 40 foot zone with oxidized sheared rock with a number of quartz veins and silver values ranging from 6.06 oz. per ton to 462.3 oz. per ton.

Trenching on the Broken Spur claim indicated other veins may be located on the claims.

The DECKER LAKE Keno Hill claims contain two good grade typical silver veins in the Central quartzite formation. The same type of veins have made the Mines in the Keno District the most productive silver producers in Canada.

I recommend further bulldozer trenching to explore the claims, trenching to extend the Bucaneer vein, and rock trenching to prepare a tunnel portal below the Rum Tum zone.

<u>PROPERTY</u>	Seven patented claims:	Bucaneer	Lot 646
		Rum Tum	Lot 686
		Pirate	Lot 685
		Broken Spur	Lot 645
		Amber	Lot 643
		Dipper	Lot 644
		Emerald	Lot 642

under option from LAURASIA RESOURCES LTD.

<u>LOCATION</u>	Latitude:	63° 57' North
	Longitude	135° 11' West
	Elevation:	4,700 to 5,400 Feet

The claims cover a spur to the north of Keno Hill ten miles northeast of Elsa. They are at the headwaters of McKay Gulch.

They are reached by mining and tractor roads from Keno, a distance of six miles.

**VANCOUVER CURB
EXCHANGE LISTING**

TOPOGRAPHY

The claims cover an open hill or spur north of the Keno Hill summit. The ground drops off very steeply north to the headwaters of McKay Gulch and to the west to the steep valley of Faro Creek. Talus covers part of the claims and obscures the geology.

GENERAL GEOLOGY

The Keno Hill area is underlain by a series of quartz graphitic, quartz sericite, quartz chlorite schists and by quartzite beds. The formations are on the south limb of an open anticline and strike east and dip 20 to 40 degrees south. There is possibly some doming caused by a north west trending anticline.

The beds, including some chlorite schists thought to be andesite sills, are conformable and a few rhyolite porphyry bodies follow the bedding.

The middle member of this series is the Keno Hill or Central quartzite. This is a 2,000 foot or greater series of quartzite beds 1 to 5 feet thick separated by graphitic schist beds 1 inch to 12 inches thick.

The veins are in persistent faults which strike north 30-45 degrees east or north 60 degrees east and dip 50 to 80 degrees to the south east. They are quartz-siderite fillings of brecciated and faulted quartzite or schists with varying amounts of galena, sphalerite, arsenopyrite, pyrite and tetrahedrite.

The veins are strong in the quartzite and tail out in the schist members. They show pre and post sulphide movement along the faults. The most important ore bodies occur in the Keno Hill Quartzite. Oxidation on the surface has reduced the vein outcrops to rusty gossans and weathering has left much of the surface covered with quartzite boulders or talus.

CLAIM GEOLOGY

The claims are mainly underlain by east striking quartzite beds which dip 30 to 45 degrees south. There are some chloritic schist or greenstone outcrops and some graphitic schist ones.

The surface is covered by frozen overburden, some muskeg, quartzite boulders and frost heaved talus.

On the Bucaneer claim the Nabob No. 2 shaft explored a vein north of the Bucaneer claim boundary. It has a strike of north 45 degrees east and dips 70 degrees south east. A pit on the Bucaneer claim showed the extension along strike.

**VANCOUVER CURB
EXCHANGE LISTING**

3.

On the Rum Tum a rusty gossan zone outcrops on a schist and quartzite steep cliff or talus slope and contains 4 northeast striking quartz veins which dip 75 degrees south east. The gossan extends down hill below the outcrop and some malachite shows in the cliff above the exposure.

Some rust is exposed on the Broken Spur claim in frost heaved talus and some zinc float was found near the Amber-Broken Spur claim boundary.

WORK DONE

The DECKER LAKE (Lauracia Option) patented claim group is relatively unexplored. In 1975 a road was built, as shown on the plan of the claims, around the headwaters of Faro Gulch and across the claims to the Bucaneer vein. Some bulldozer trenching was done on the Broken Spur claim and a 200 foot long trench was cut in the permafrost on the Bucaneer. A road was built around the headwaters of McKay Gulch to the Rum Tum vein. Rock trenching was done on this oxidized gossan over a 40 foot width with the following results:

West or footwall 20 Feet mud with quartz fragments; 0.7 oz. silver per ton
 7 Feet talus; not sampled
 2 Inches arsenopyrite; not sampled
 2 Inches rusty siderite with quartz crystals and much pale zinc; 6.06 oz. silver per ton
 6 Feet quartz sericite schist; not sampled

Main Quartz Vein Quartz siderite with massive and disseminated tetrahedrite exposed 50 feet up and along the outcrop averages 12 inches wide; 272.94 oz. silver per ton

Three picked samples of this vein assayed:
 542.4 oz. silver; 924.00 oz. silver, .444 oz. gold;
 1,564.00 oz. silver, .868 oz. gold per ton; giving
 an average over 1,000 oz. silver and .43 oz. gold per ton.

Ten feet in the hanging wall an 8 inch vein assayed
 94.0 oz. silver per ton and 1.11% lead.

Three feet beyond this a second 10 inch vein
 assayed 8 oz. silver per ton.

Fifty feet below and north of this trench a gossan
 zone shows the vein extension.

Bucaneer On the Bucaneer the trench is in permafrost and the vein is not well exposed. General samples of vein in the permafrost averaged 27.75 oz. silver per ton and one sample across 14" assayed 336.25 oz. silver per ton and 29.58 % lead at one point where the vein was exposed through the permafrost.

CONCLUSIONS

DECKER LAKE MINES LTD (NPL) have exposed two good grade silver veins in trenches and there are indications of other veins on the claims.

RECOMMENDATIONS

I recommend further bulldozer trenching on the Buccaneer vein and on the claim group. Rock work should be done to the north of the Rum Tum trench to provide a tunnel portal on the vein. All high grade ore encountered during this work should be stockpiled on the property or could be shipped directly to a smelter.

ESTIMATED COSTS

Bulldozer Trenching	\$10,000.00
Rock Work	10,000.00
Transportation	3,000.00
Powder & Equipment	8,000.00
Trucking & freight	4,000.00
Camp & Supplies	3,000.00
Geology & Engineering	2,000.00
Assaying	1,000.00
Travelling	1,000.00
Consulting	2,000.00
Contingencies	6,000.00
ESTIMATED TOTAL	<u>\$50,000.00</u>

Report by

D.C. MALCOLM
Consulting Engineer

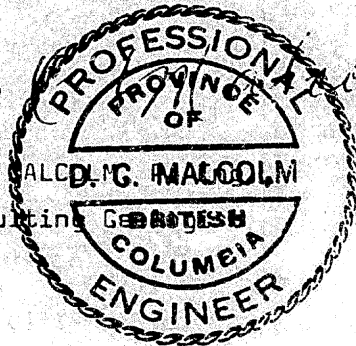

Vancouver, B.C.

November 24, 1975

**VANCOUVER CURB
EXCHANGE LISTING**

REFERENCES

- Yukon Territory - Geological Survey of Canada
Memoir 284 by H.S.BOSTOCK
Page 508 - Geology and Ore Deposits of Keno Hill
by W.E.COCKFIELD
- KARL E. WICKSTROM - Personal Communications.
- G.S.C. Map 46, 1965 - Silver Content of Stream and
Spring Sediments - Keno Hill Area,
compiled by C.F.GLEESON
- G.S.C. Map 1147A - Geology - Keno Hill - Galena Hill
Area by R.W.BOYLE, 1964.
- C.I.M.M. Bulletin, October 1961, Page 722.
Current Operations at UNITED KENO HILL MINES LIMITED
by the Staff.
- Dr. A.E. AHO - Mineral Potential of the Mayo District,
Western Miner, October 1964, Page 80.

VANCOUVER CURB
EXCHANGE LISTING

C E R T I F I C A T E

This is to certify that:

1. I, DOUGLAS COLE MALCOLM am a resident of Vancouver, B.C., and live at 2290 West 23rd Avenue.
2. I am a graduate of the University of British Columbia with the degree of Bachelor of Applied Science in Geological Engineering (1935).
3. I am a member of the Association of Professional Engineers of British Columbia and Ontario and have practised my profession continuously since graduation.
4. I have not, directly or indirectly, received or expect to receive any interest, direct or indirect, in the property of DECKER LAKE MINES LIMITED (N.P.L.), or of any affiliate; or beneficially own, directly or indirectly, any securities of the company or of any affiliate.
5. This report is based on an examination made by myself on November 3, 1975 and from information of reports as shown in the references.

D. C. Malcolm
D. C. MALCOLM, P. Eng.,
Consulting Geologist

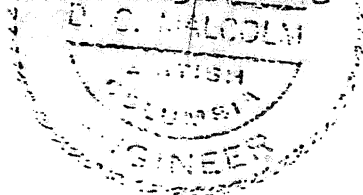

Vancouver, B.C.
November 24, 1975

**VANCOUVER CURB
EXCHANGE LISTING**

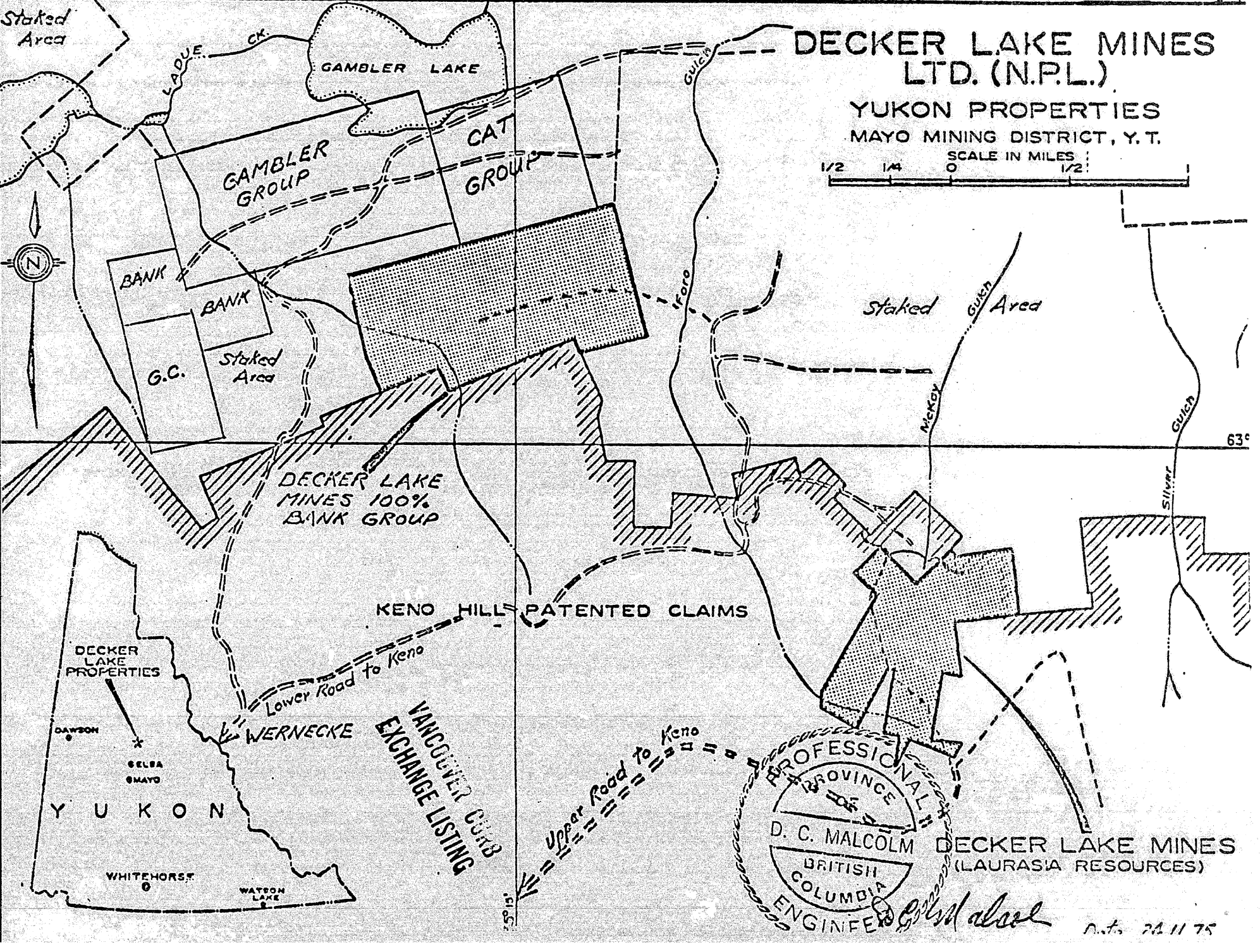

DECKER LAKE MINES LTD. (N.P.L.)

YUKON PROPERTIES
MAYO MINING DISTRICT, Y.T.

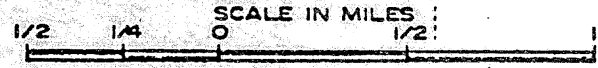

Staked Area



GAMBLER LAKE

GAMBLER GROUP

CAT GROUP

BANK

BANK

G.C.

Staked Area

DECKER LAKE MINES 100% BANK GROUP

KENO HILL PATENTED CLAIMS

DECKER LAKE PROPERTIES

DAWSON

SELBA
SMAYO

Y U K O N

WHITEHORSE

WATSON LAKE

VANCOUVER Curb
EXCHANGE LISTING

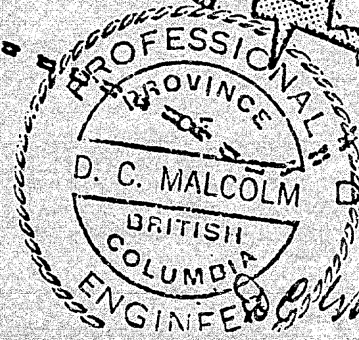

DECKER LAKE MINES (LAURASIA RESOURCES)

D.C. Malcolm

D.C. 7/11/75

63°

Upper Road to Keno

Lower Road to Keno

WERNECKE

Staked Area

Silver Gulch

Yukon

Guich

McKay

LADUE CK.

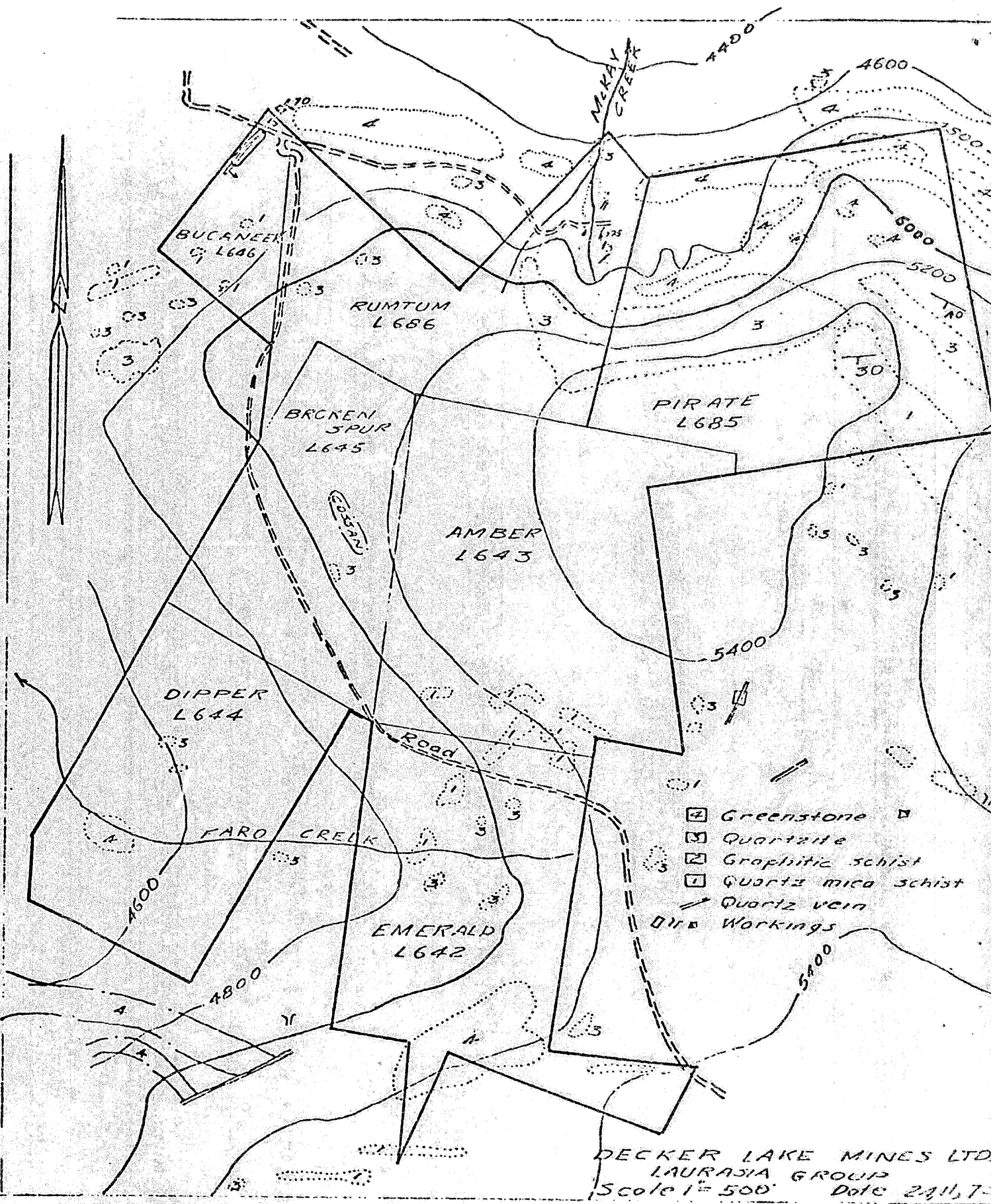



McKay Gulch

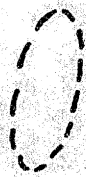

El. 4700 Approx.

Trench & Road

x Tr Au Tr Ag

1.17 Ag
 Tr Au 0.72 Ag
 Tr Au 0.48 Ag

3' Asbestosite

2" 6.00 Ag
 30°
 75°
 16" 0.21 Au
 422.47 Ag
 14" 83.71 Ag
 7.55% Zn
 10" 462.3 Ag

10" 8.0 Ag

8" 94.0 Ag 1.11% Pb

VANCOUVER CURB EXCHANGE LISTING

DECKER LAKE MINES LTD
RUM TUM ASSAYS

Scale 1"-10' Date 10,11,75

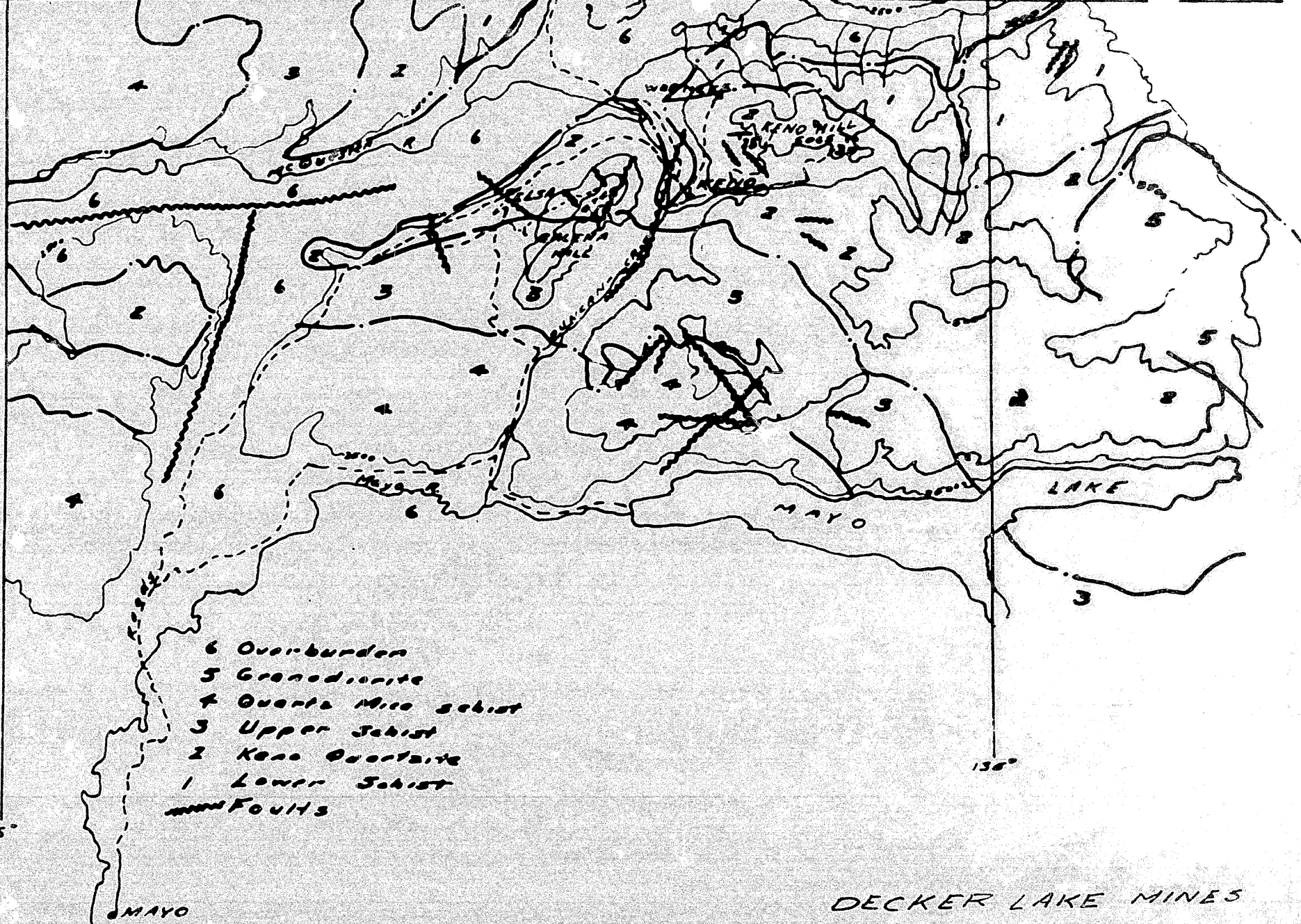

- 6 Overburden
- 5 Granodiorite
- 4 Quartzite schist
- 3 Upper Schist
- 2 Keno Quartzite
- 1 Lower Schist
- Faults

DECKER LAKE MINES
BANK GROUP

Scale 1" = 4 Miles Date 20, 10, 74

After G.S.C. Map 1147A