

GEOCHEMICAL REPORT ON THE  
END GROUP  
WHITEHORSE MINING DIVISION  
105-L-10, 62° 40' 134° 06'

for

ENVOY RESOURCES LTD.  
BOW RIVER RESOURCES LTD.  
333-885 Dunsmuir St.,  
Vancouver, B.C.

by

J.W. MacLeod, P.Eng.

VANCOUVER, B.C.

OCT. 10, 1975

*NMEAP  
Received  
Jan 23, 1976.*

TABLE OF CONTENTS

	Page
INTRODUCTION .....	1
SUMMARY & CONCLUSIONS .....	1
PROPERTY .....	2
HISTORY .....	2
LOCATION & ACCESS .....	3
GENERAL .....	3
GROUND CONTROL .....	3
GEOLOGY .....	4
SOIL .....	4
LEAD .....	5
ZINC .....	5
COPPER .....	5
CONCLUSIONS & RECOMMENDATIONS.....	8
APPENDIX I - ANALYTICAL PROCEDURE	
APPENDIX II - ANALYSES	
APPENDIX III - EXPENDITURE	
APPENDIX IV - ENGINEER'S CERTIFICATE	

## ILLUSTRATIONS

Location Map	Scale 1" = 50 miles
Claim Map	Scale 1" = 1/2 mile
Geology	Scale 1" = 400'
Copper in Soils	Scale 1" = 400'
Zinc in Soils	Scale 1" = 400'
Lead in Soils	Scale 1" = 400'

INTRODUCTION:

The following report has been prepared to fulfill the requirements of the Quartz Mining Act governing the filing of geochemical work for assessment credit.

SUMMARY & CONCLUSIONS:

Between August 5 and August 16 of this year 390 soil samples were collected on the End Group and analysed for copper, lead and zinc.

Anomalous values in zinc and copper were obtained justifying an expenditure of \$2,500.00 in detail geochemical work to determine if the highs have any lateral continuity.

PROPERTY:

The End Group consists of 24 contiguous claims recorded on November 5, 1974. Grant Numbers are Y91534 to Y91557 inclusive.

The registered owner of the claims is Bow River Resources Ltd. as to 50% and Envoy Resources Ltd. as to 50%. The address of both companies is 333-885 Dunsmuir Street, Vancouver, B.C.

HISTORY:

The only known exploration of what is now the End Group was carried out between 1966 and 1968 when the ground was held by Glenlyon Mines and optioned to McIntyre Porcupine which company drilled one 550 foot hole to test a copper occurrence.

The present geochemical program was carried out between August 5 and August 15 by D. Peel a Graduate Geologist assisted by J. Poikins. This field work was under the direction of the writer.

LOCATION & ACCESS:

The End claims are located southeast of a bend in the Pelly River known as "The Detour", 68 miles northeast of Carmacks and 124 miles due north of Whitehorse. A 70 mile winter road has been built from the Klondike Highway to "The Detour".

Present access to the property is by means of aircraft which can land on the Pelly River at the northwest end of the property.

GENERAL:

The claims cover an area of fairly gentle relief with elevations ranging from 2,000 to 3,000 feet.

The western 5-6 claims are covered by hummocks from recent glacial action. The remainder of the property is lightly overburdened with perhaps 10% outcrop.

The area has recently been thoroughly burnt.

GROUND CONTROL:

Chained and flagged crosslines were run at 800 foot intervals from a base line bearing N 54° W.

GEOLOGY:

The general geology of the area is available in G.S.C. Memoir 352 by R.B. Campbell.

Outcrops on the property consist of phyllite and schist with foliation trending northwest and dipping 50-80 degrees to the southwest.

These rocks are the same series as those hosting the sulfide deposits in the Anvil area 50 miles to the southeast.

A copper showing consisting of numerous quartz veins carrying chalcopyrite occurs on a small bluff on claim 10. Here two adjoining 50 float samples along the bluff assayed 0.75 and 0.57% copper.

SOIL:

The A horizon is poorly developed in this area. In general the A and B horizons are separated by a layer of volcanic ash from 1 inch to 1 foot thick. Soil samples were collected below this ash layer in the B horizon.

A total of 390 soil samples were collected and analysed for lead, zinc and copper by the procedure outlined in Appendix I.

LEAD:

The values for the lead in soil varies from 3 to 25 p.p.m. with no indication of anomalous conditions.

ZINC:

The accompanying plot of the distribution of the zinc values in the soil shows a plateau at 250 p.p.m. and values over 350 p.p.m. are anomalous. Four locations; SW 25 (580 p.p.m.), 16E 6N (460 p.p.m.) 16 E 8N (415 p.p.m.) and 24E 10N (630 p.p.m.) should be specifically investigated.

COPPER:

The statistical analysis of the copper values indicates any concentration in the soils over 200 p.p.m. to be anomalous and five stations reported readings in this range. These are at L09S (322 p.p.m.), 12S (1290 p.p.m.), 15S (200 p.p.m.) and L48E 2S (200 p.p.m.), 32S (200 p.p.m.)

The copper occurrence on claim 10 is not defined by the survey indicating a line spacing too widespread to locate this mineralization.

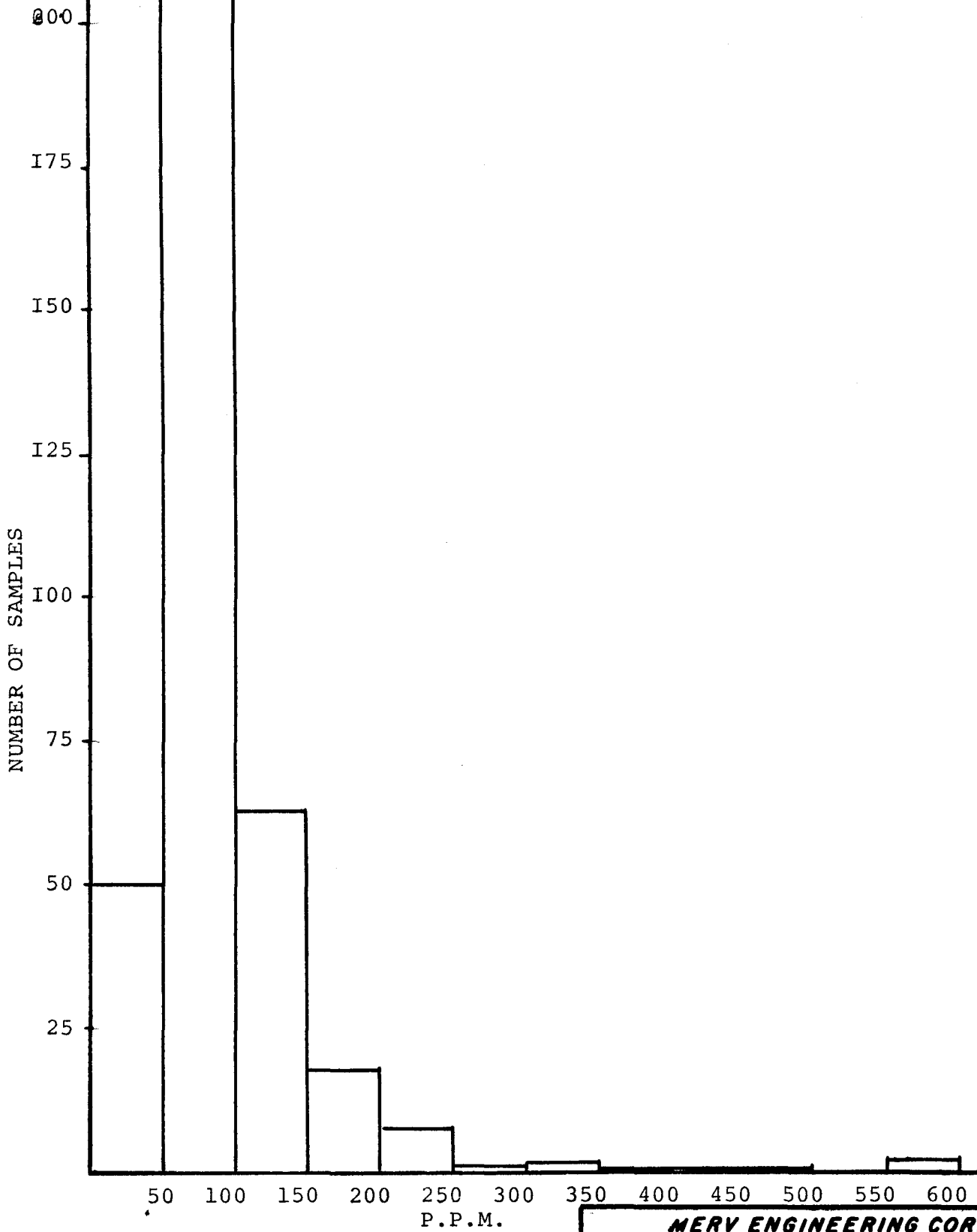

**MERV ENGINEERING CORP.**

DISTRIBUTION OF ZINC IN SOILS

<b>DRAWN BY:</b> J.W.M.	<b>SCALE:</b>
<b>DATE:</b> Oct. 10, 1975	<b>N.T.S. :</b>

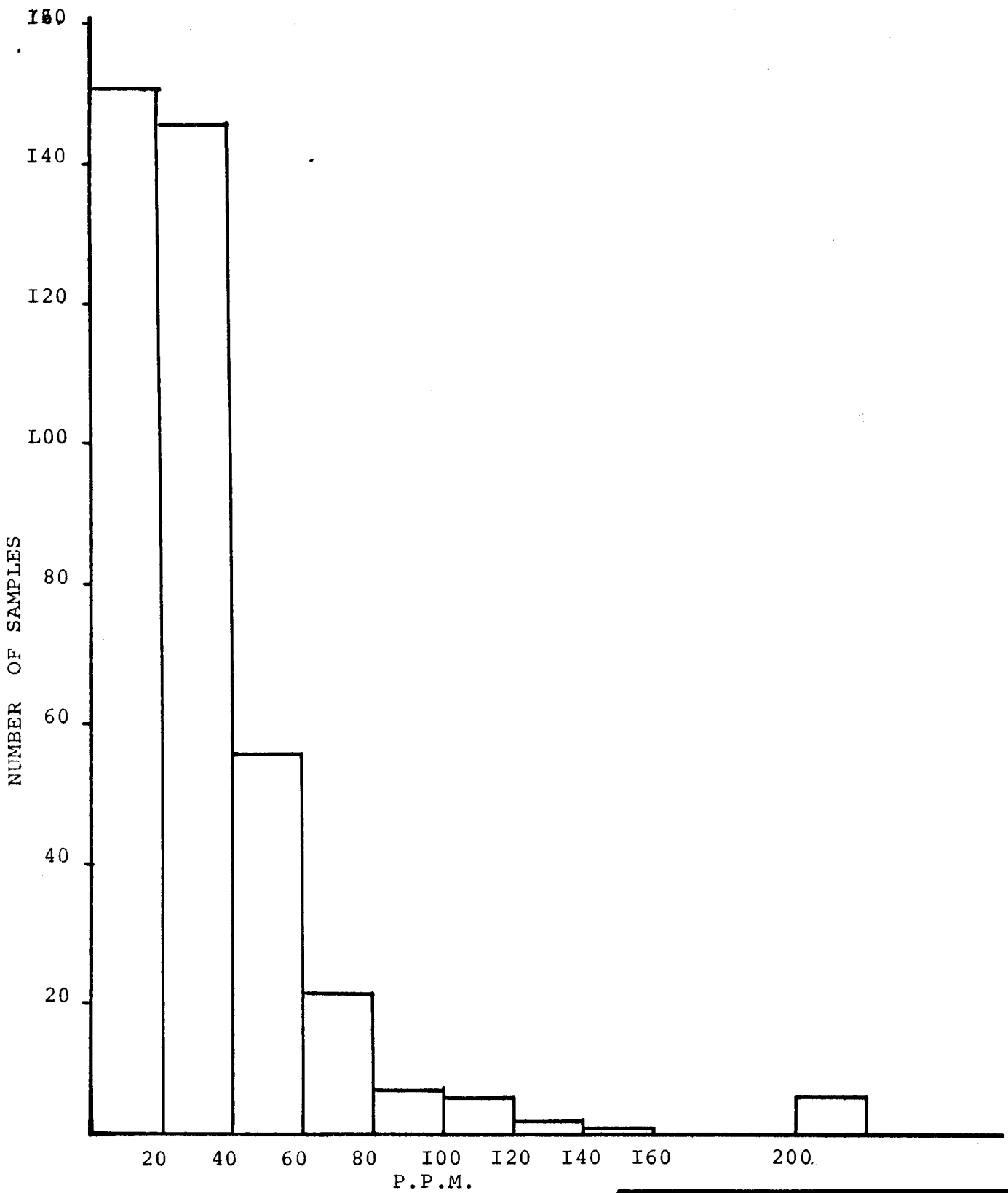

**MERV ENGINEERING CORP.**

DISTRIBUTION OF COPPER IN SOILS

DRAWN BY: J.W.M.

SCALE:

DATE: Oct. 10, 1975

N.T.S. :

CONCLUSIONS & RECOMMENDATIONS:

The soil survey has located anomalous values in zinc and copper requiring further investigation.

Although a vague trend paralleling the foliation is indicated the 800 foot spacing is too far apart to allow contouring.

Further sampling is required to establish continuity. This could be accomplished by the collection of 300 samples at an estimated cost of \$2,500.00 in the first phase of follow up work.

Respectfully submitted,

J.W. MacLeod, P.Eng.

APPENDIX I

ANALYTICAL PROCEDURE



VANGEOCHEM LAB LTD. 1521 PEMBERTON AVE., NORTH VANCOUVER, B.C., CANADA 604-988-2172

October 10, 1975

TO: Bow River Resources Ltd.,  
# 333 - 885 Dunsmuir Street,  
Vancouver, B. C.,  
V6C 1N5

FROM: Mr. Conway Chun,  
Vangeochem Lab Ltd.,  
1521 Pemberton Avenue,  
North Vancouver, B. C.

SUBJECT: Analytical procedure used to determine acid soluble  
Cu, Pb, Zn in geochemical samples.

Re: Analytical Report # 75-19-008



1. Sample Preparation

- (a) Geochemical soil or silt samples were received in the laboratory in wet-strength  $3\frac{1}{2}$  x  $6\frac{1}{2}$  Kraft paper bags.
- (b) The wet samples were dried in a ventilated oven.
- (c) The dried soil and silt samples were sifted by using a shaking machine using an 80-mesh stainless steel sieve. The plus 80-mesh fraction was rejected and the minus 80-mesh fraction was transferred into a new bag for analysis later.

2. Methods of Digestion

- (a) 0.50 gram of the minus 80-mesh samples was used. Samples were weighed out by using a top-loading balance.
- (b) Samples were heated in a sand bath with nitric and perchloric acids (15% to 85% by volume of the concentrated acids respectively).
- (c) The digested samples were diluted with demineralized water to a fixed volume and shaken.

.....2

3. Method of Analysis

Cu, Pb, Zn analyses were determined by using a Techtron Atomic Absorption Spectrophotometer Model AA4 or Model AA5 with their respective hollow cathode lamp. The digested samples were aspirated directly into an air and acetylene flame. The results, in parts per million, were calculated by comparing a set of standards to calibrate the atomic absorption unit.

4. The analyses were supervised or determined by Mr. Conway Chun and the laboratory staff.

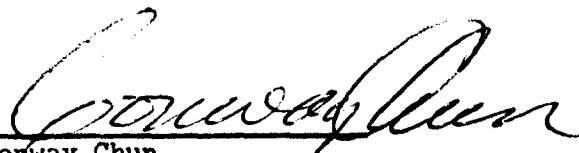
  
Conway Chun  
VANGEOCHEM LAB LTD.

CC:amb

APPENDIX II

ANALYSES



VANGEOCHEM LAB LTD.  
 1521 PEMBERTON AVE.,  
 NORTH VANCOUVER, B.C.,  
 CANADA V7P 2S3

TELEPHONE: 988-2172  
 AREA CODE: 604

• Specialising in Trace Elements Analyses •

### Certificate of Geochemical Analyses

-IN ACCOUNT WITH-

**Bow River Resources Ltd.,**  
 # 333 - 885 Dunsmuir Street,  
 Vancouver, B. C.

Attention:

Report No: **75 19 008** Page **1** of **11**  
 Samples Arrived: **August 28, 1975**  
 Report Completed: **Sept. 3, 1975**  
 For Project:  
 Analyst: **E. T., R.N.**  
 Invoice # **3494** Job # **75-191**

Sample Marking	Cu ppm	Pb ppm	Zn ppm		
LO BL	22	15	44		
1 N	8	16	44		
2 N	7	17	38		
3 N	4	15	60		
4 N	25	24	70		
5 N	26	23	80		
6 N	38	25	115		
7 N	32	21	62		
8 N	14	15	56		
9 N	13	15	47		
10 N	62	20	60		
11 N	60	25	118		
12 N	42	22	82		
13 N	47	25	99		
LO 14 N	7	22	96		
LO 1 S	12	18	43		
2 S	16	22	80		
3 S	13	17	60		
4 S	32	20	82		
5 S	25	22	54		
6 S	17	18	55		
7 S	64	20	53		
8 S	8	15	60		
9 S	322	20	64		
10 S	7	11	85		
11 S	18	20	32		
12 S	1290	22	64		
13 S	26	20	52		
14 S	47	22	58		
15 S	200	21	73		
16 S	19	20	67		
17 S	3	13	104		
18 S	45	20	63		
19 S	12	16	58		
20 S	8	14	82		
21 S	15	20	68		
22 S	44	20	42		
23 S	48	17	68		
LO 24 S	27	15	60		

MASTER PRINTING LTD.

REMARKS:

Signed:

% Mo x 1.6683 = % MoS<sub>2</sub>      1 Troy oz./ton = 34.28 ppm      1 ppm = 0.0001%      nd = none detected      ppm = parts per mill  
 All values are believed to be correct to the best knowledge of the analyst based on the method and instruments used.



VANGEOCHEM LAB LTD.  
 1521 PEMBERTON AVE.,  
 NORTH VANCOUVER, B.C.,  
 CANADA V7P 2S3

TELEPHONE: 988-2172  
 AREA CODE: 604

• Specialising in Trace Elements Analyses •

### Certificate of Geochemical Analyses

-IN ACCOUNT WITH-  
**Bow River Resources Ltd.**

Report No: **75 19 008** Page **2** of **11**  
 Samples Arrived:  
 Report Completed:  
 For Project:  
 Analyst:

Attention:

Sample Marking	Cu ppm	Pb ppm	Zn ppm			
10 25 S	12	12	44			
26 S	27	21	65			
27 S	19	15	108			
28 S	16	14	142			
29 S	12	15	80			
30 S	14	20	117			
31 S	23	20	156			
32 S	12	17	96			
33 S	16	15	146			
34 S	14	13	90			
10 35 S	45	23	184			
L 8 E BL	55	19	65			
2 N	27	20	77			
4 N	18	16	92			
6 N	10	14	104			
8 N	13	19	125			
10 N	18	25	169			
12 N	42	25	100			
L 8 E 14 N	42	30	86			
L 8 E 2 S	125	20	49			
4 S	14	20	45			
6 S	25	20	56			
8 S	9	18	79			
10 S	11	15	62			
12 S	19	20	62			
14 S	30	20	65			
16 S	18	18	49			
18 S	12	15	49			
20 S	52	21	64			
22 S	12	16	53			
24 S	62	20	64			
26 S	22	19	106			
L 8 E 28 S	35	18	67			
L 8 E 30 S	22	16	55			
32 S	77	20	102			
34 S	72	20	54			
36 S	92	22	290			
38 S	17	17	105			
L 8 E 40 S	15	15	59			

MASTER PRINTING LTD.

REMARKS:

Signed: 

% Mo x 1.6683 = % MoS<sub>2</sub>      1 Troy oz./ton = 34.28 ppm      1 ppm = 0.0001%      nd = none detected      ppm = parts per mill  
 All values are believed to be correct to the best knowledge of the analyst based on the method and instruments used.



VANGEOCHEM LAB LTD.  
 1521 PEMBERTON AVE.,  
 NORTH VANCOUVER, B.C.,  
 CANADA V7P 2S3

TELEPHONE: 988-2172  
 AREA CODE: 604

•Specialising in Trace Elements Analyses•

### Certificate of Geochemical Analyses

-IN ACCOUNT WITH-  
**Bow River Resources Ltd.**

Report No: **75 19 008** Page **3** of **11**  
 Samples Arrived:  
 Report Completed:  
 For Project:  
 Analyst:

Attention:

Sample Marking	Cu ppm	Pb ppm	Zn ppm			
L 8 W BL	45	18	98			
2 N	45	17	89			
4 N	52	16	99			
6 N	23	18	105			
8 N	5	12	58			
10 N	32	17	32			
12 N	10	5	27			
L 8 W 14 N	52	16	55			
L 8 W 2 S	17	27	580			
4 S	20	14	152			
6 S	28	20	80			
8 S	34	17	73			
10 S	20	17	92			
12 S	23	18	72			
14 S	56	22	57			
16 S	7	15	76			
18 S	22	16	42			
20 S	15	14	56			
22 S	8	12	65			
24 S	24	12	17			
26 S	15	15	62			
28 S	28	24	118			
30 S	15	18	124			
32 S	20	20	165			
L 8 W 34 S	32	20	118			
10 W 14 N	15	17	68			
L 16 E BL	9	17	154			
1 N	5	16	82			
2 N	15	6	80			
3 N	29	17	92			
4 N	9	16	54			
5 N	5	15	99			
6 N	39	20	460			
7 N	32	26	165			
8 N	59	29	415			
9 N	65	16	118			
10 N	24	16	80			
11 N	30	16	160			
L 16 E 12 N	60	20	70			

MASTER PRINTING LTD.

REMARKS:

Signed: 

% Mo x 1.6683 = % MoS<sub>2</sub>

1 Troy oz./ton = 34.28 ppm

1 ppm = 0.0001%

nd = none detected

ppm = parts per millic

All values are believed to be correct to the best knowledge of the analyst based on the method and instruments used.



VANGEOCHEM LAB LTD.  
 1521 PEMBERTON AVE.,  
 NORTH VANCOUVER, B.C.,  
 CANADA V7P 2S3

TELEPHONE: 988-2172  
 AREA CODE: 604

• Specialising in Trace Elements Analyses •

### Certificate of Geochemical Analyses

-IN ACCOUNT WITH-  
**Bow River Resources Ltd.**

Report No: **75 19 008** Page **4** of **11**  
 Samples Arrived:  
 Report Completed:  
 For Project:  
 Analyst:

Attention:

Sample Marking	Cu ppm	Pb ppm	Zn ppm			
L 16 E 13 N	38	18	72			
L 16 E 14 N	17	26	60			
L 16 E 1 S	12	15	122			
2 S	15	20	123			
3 S	37	15	65			
4 S	17	9	14			
5 S	13	8	23			
6 S	15	4	5			
7 S	62	18	65			
8 S	40	16	45			
9 S	120	17	72			
10 S	16	15	54			
11 S	13	12	125			
12 S	66	12	80			
13 S	24	16	144			
14 S	10	15	87			
15 S	20	17	74			
16 S	12	17	68			
17 S	9	13	56			
18 S	7	14	65			
19 S	14	15	105			
20 S	12	17	90			
21 S	36	20	64			
22 S	52	21	55			
23 S	18	18	54			
24 S	14	15	70			
25 S	18	16	64			
26 S	67	23	84			
27 S	20	17	96			
28 S	35	20	82			
29 S	25	21	52			
30 S	28	11	9			
31 S	15	8	48			
32 S	38	16	83			
33 S	20	7	52			
34 S	15	16	90			
35 S	65	21	127			
L 16 E 36 S	13	14	132			
L 16 E 37 S	9	16	177			

MASTER PRINTING LTD.

REMARKS:

Signed: 

% Mo x 1.6683 = % MoS<sub>2</sub>      1 Troy oz./ton = 34.28 ppm      1 ppm = 0.0001%      nd = none detected      ppm = parts per mill  
 All values are believed to be correct to the best knowledge of the analyst based on the method and instruments used.



VANGOCHEM LAB LTD.  
 1521 PEMBERTON AVE.,  
 NORTH VANCOUVER, B.C.,  
 CANADA V7P 2S3

TELEPHONE: 988-2172  
 AREA CODE: 604

•Specialising in Trace Elements Analyses•

# Certificate of Geochemical Analyses

-IN ACCOUNT WITH-  
**Bow River Resources Ltd.**

Report No: **75 19 008** Page **5** of **11**  
 Samples Arrived:  
 Report Completed:  
 For Project:  
 Analyst:

Attention:

Sample Marking	Cu ppm	Pb ppm	Zn ppm			
L 16 E 38 S	18	15	102			
39 S	23	17	96			
L 16 E 40 S	43	30	117			
L 16 W BL	43	20	114			
1 N	30	14	60			
2 N	35	21	95			
3 N	28	20	90			
4 N	30	15	57			
5 N	33	21	95			
6 N	23	10	44			
7 N	25	15	80			
8 N	28	25	100			
9 N	8	3	9			
10 N	25	25	78			
11 N	43	20	74			
12 N	35	20	65			
13 N	48	24	116			
L 16 W 14 W	23	20	70			
L 16 W 1 S	13	10	126			
L 16 W 2 S	33	18	205			
L 16 W 3 S	43	18	99			
4 S	35	15	60			
5 S	45	17	307			
7 S	25	20	99			
11 S	48	15	70			
12 S	20	16	76			
13 S	13	12	34			
14 S	58	17	55			
15 S	83	20	90			
16 S	20	12	88			
17 S	15	12	72			
18 S	13	11	75			
19 S	23	12	90			
20 S	18	15	105			
21 S	15	14	119			
22 S	15	12	77			
23 S	8	12	88			
24 S	18	18	162			
L 16 W 25 S	17	15	150			

MASTER PRINTING LTD.

REMARKS:

Signed: 

% Mo x 1.6683 = % MoS<sub>2</sub>      1 Troy oz./ton = 34.28 ppm      1 ppm = 0.0001%      nd = none detected      ppm = parts per mi  
 All values are believed to be correct to the best knowledge of the analyst based on the method and instruments used.



VANGOCHEM LAB LTD.  
 1521 PEMBERTON AVE.,  
 NORTH VANCOUVER, B.C.,  
 CANADA V7P 2S3

TELEPHONE: 988-2172  
 AREA CODE: 604

• Specialising in Trace Elements Analyses •

### Certificate of Geochemical Analyses

-IN ACCOUNT WITH-  
**Bow River Resources Ltd.**

Report No: **75 19 008** Page **6** of **11**  
 Samples Arrived:  
 Report Completed:  
 For Project:  
 Analyst:

Attention:

Sample Marking	Cu ppm	Pb ppm	Zn ppm			
L 16 W 26 S	25	22	82			
L 24 E BL	15	15	80			
2 N	48	26	250			
4 N	25	20	95			
6 N	18	20	177			
8 N	30	16	195			
10 N	18	21	630			
12 N	53	22	77			
L 24 E 14 N	58	42	107			
L 24 E 2 S	30	15	37			
4 S	63	18	57			
6 S	25	20	88			
8 S	33	20	52			
10 S	98	24	67			
12 S	30	16	75			
14 S	40	18	53			
16 S	18	15	56			
18 S	18	16	62			
20 S	110	20	56			
22 S	35	15	49			
24 S	45	20	52			
26 S	45	22	55			
28 S	33	20	78			
30 S	18	16	54			
32 S	28	16	42			
34 S	15	16	105			
36 S	48	23	140			
38 S	15	12	54			
40 S	13	35	106			
42 S	40	24	155			
L 24 E 44 S	15	18	98			
L 24 W BL	13	15	82			
2 N	13	21	98			
4 N	28	23	98			
6 N	18	22	112			
8 N	25	27	85			
10 N	18	20	79			
12 N	25	20	104			
L 24 W 14 N	33	20	57			

MASTER PRINTING LTD.

REMARKS:

Signed: 

% Mo x 1.6683 = % MoS<sub>2</sub>

1 Troy oz./ton = 34.28 ppm

1 ppm = 0.0001%

nd = none detected

ppm = parts per mil

All values are believed to be correct to the best knowledge of the analyst based on the method and instruments used.



VANGEOCHEM LAB LTD.  
 1521 PEMBERTON AVE.,  
 NORTH VANCOUVER, B.C.,  
 CANADA V7P 2S3

TELEPHONE: 988-2172  
 AREA CODE: 604

• Specialising in Trace Elements Analyses •

### Certificate of Geochemical Analyses

-IN ACCOUNT WITH-  
**Bow River Resources Ltd.**

Report No: **75 19 008** Page **7** of **11**  
 Samples Arrived:  
 Report Completed:  
 For Project:  
 Analyst:

Attention:

Sample Marking	Cu ppm	Pb ppm	Zn ppm			
L 24 W 2 S	15	24	84			
4 S	10	16	64			
6 S	13	16	60			
8 S	25	25	325			
10 S	27	25	125			
12 S	23	24	104			
14 S	80	22	89			
16 S	22	22	140			
18 S	28	22	104			
20 S	25	25	112			
L 24 W 22 S	25	17	74			
30 E 10 S	30	12	45			
L 32 E HL	40	25	260			
1 N	33	22	92			
2 N	45	23	89			
3 N	53	23	90			
4 N	8	16	98			
5 N	15	22	140			
6 N	13	30	215			
7 N	23	22	115			
9 N	30	22	110			
10 N	15	21	65			
11 N	18	18	96			
12 N	15	20	152			
13 N	28	6	29			
L 32 E 14 N	20	23	57			
L 32 E 1 S	73	23	73			
2 S	25	20	56			
3 S	30	22	55			
4 S	13	15	60			
5 S	18	13	52			
6 S	28	20	57			
7 S	13	18	115			
8 S	20	21	53			
9 S	103	23	66			
10 S	47	23	65			
11 S	18	16	186			
12 S	15	15	56			
L 32 E 13 S	150	21	65			

MASTER PRINTING LTD.

REMARKS: L 32 E 8 N is on last page

Signed: \_\_\_\_\_

% Mo x 1.6683 = % MoS<sub>2</sub>

1 Troy oz./ton = 34.28 ppm

1 ppm = 0.0001%

nd = none detected

ppm = parts per millic

All values are believed to be correct to the best knowledge of the analyst based on the method and instruments used.



VANGEOCHEM LAB LTD.  
 1521 PEMBERTON AVE.,  
 NORTH VANCOUVER, B.C.,  
 CANADA V7P 2S3

TELEPHONE: 988-2172  
 AREA CODE: 604

•Specialising in Trace Elements Analyses•

### Certificate of Geochemical Analyses

-IN ACCOUNT WITH-  
**Bow River Resources Ltd.**

Report No: **75 19 008** Page **8** of **11**  
 Samples Arrived:  
 Report Completed:  
 For Project:  
 Analyst:

Attention:

Sample Marking	Cu ppm	Pb ppm	Zn ppm			
L 32 E 14 S	13	17	75			
15 S	33	18	49			
16 S	40	26	52			
17 S	55	23	82			
18 S	48	25	60			
19 S	38	21	75			
20 S	25	22	65			
21 S	35	23	52			
22 S	45	21	50			
23 S	33	16	45			
24 S	23	16	65			
25 S	23	15	34			
26 S	30	18	42			
27 S	50	20	65			
28 S	33	12	26			
29 S	30	26	14			
30 S	30	26	60			
31 S	23	13	14			
32 S	25	8	9			
33 S	15	16	90			
34 S	28	19	105			
35 S	28	20	70			
36 S	20	20	85			
37 S	20	20	138			
38 S	25	22	70			
39 S	135	40	395			
40 S	30	18	226			
41 S	90	22	72			
42 S	30	15	60			
43 S	23	16	70			
L 32 E 44 S	40	26	82			
L 32 W BL	25	17	93			
1 N	15	15	97			
2 N	90	18	57			
3 N	55	21	155			
4 N	40	22	83			
5 N	35	22	95			
6 N	28	17	72			
L 32 W 7 N	28	18	63			

MASTER PRINTING LTD.

REMARKS:

Signed:

% Mo x 1.6683 = % MoS<sub>2</sub>      1 Troy oz./ton = 34.28 ppm      1 ppm = 0.0001%      nd = none detected      ppm = parts per mill  
 All values are believed to be correct to the best knowledge of the analyst based on the method and instruments used.



VANGOCHEM LAB LTD.  
 1521 PEMBERTON AVE.,  
 NORTH VANCOUVER, B.C.,  
 CANADA V7P 2S3

TELEPHONE: 988-2172  
 AREA CODE: 604

• Specialising in Trace Elements Analyses •

### Certificate of Geochemical Analyses

-IN ACCOUNT WITH-  
**Bow River Resources Ltd.**

Report No: **75 19 008** Page **9** of **11**  
 Samples Arrived:  
 Report Completed:  
 For Project:  
 Analyst:

Attention:

Sample Marking	Cu ppm	Pb ppm	Zn ppm			
L 32 W 8 N	23	17	60			
9 N	33	18	85			
10 N	25	17	74			
11 N	33	22	87			
12 N	22	15	59			
13 N	40	26	106			
L 32 W 14 N	40	24	95			
L 32 W 1 S	30	20	97			
2 S	13	15	85			
3 S	10	14	65			
4 S	18	12	65			
5 S	25	18	89			
6 S	8	14	120			
7 S	13	20	225			
8 S	13	16	82			
9 S	20	16	65			
10 S	13	16	130			
11 S	20	25	104			
L 32 W 12 S	20	15	70			
L 40 E BL	103	20	65			
2 N	15	15	145			
4 N	20	19	89			
6 N	20	17	103			
8 N	8	11	205			
10 N	28	15	233			
12 N	8	12	115			
L 40 E 14 N	25	15	54			
L 40 E 2 S	30	15	64			
4 S	70	20	72			
6 S	18	14	65			
8 S	90	20	45			
10 S	35	20	48			
12 S	38	10	42			
14 S	23	15	115			
16 S	15	15	55			
18 S	55	31	72			
20 S	18	18	53			
22 S	24	17	53			
L 40 E 24 S	28	17	42			

MASTER PRINTING LTD.

REMARKS:

Signed:         6        

% Mo x 1.6683 = % MoS<sub>2</sub>

1 Troy oz./ton = 34.28 ppm

1 ppm = 0.0001%

nd = none detected

ppm = parts per mill

All values are believed to be correct to the best knowledge of the analyst based on the method and instruments used.





VANGEOCHEM LAB LTD.  
 1521 PEMBERTON AVE.,  
 NORTH VANCOUVER, B.C.,  
 CANADA V7P 2S3

TELEPHONE: 988-2172  
 AREA CODE: 604

• Specialising in Trace Elements Analyses •

### Certificate of Geochemical Analyses

-IN ACCOUNT WITH-  
**Bow River Resources Ltd.**

Report No: **75 19 008** Page **11** of **11**  
 Samples Arrived:  
 Report Completed:  
 For Project:  
 Analyst:

Attention:

Sample Marking	Cu ppm	Pb ppm	Zn ppm			
L 48 E 44 S L 32 E 8 N	19 32	16 25	88 110			

MASTER PRINTING LTD.

REMARKS:

Signed:

% Mo x 1.6683 = % MoS<sub>2</sub>      1 Troy oz./ton = 34.28 ppm      1 ppm = 0.0001%      nd = none detected      ppm = parts per million  
 All values are believed to be correct to the best knowledge of the analyst based on the method and instruments used.

APPENDIX III

EXPENDITURE

EXPENDITURE

Wages - D. Peel, J. Poikans	1,150.26
Soil Analyses & Assaying	1,028.28
Travel	610.10
Supplies	211.85
Radio	7.00
J.W. MacLeod-Expenses	116.45
D. Peel-Expenses	245.10
Drafting	<u>356.68</u>
	3,725.72

REMARKS

Payroll Pk: END GP.

PER MAN  
423.34  
135.79  
16.01

$\$75.14 \times 2 = \underline{\underline{\$150.28}}$

RECORDED 131 Aug 15 1944

DEBITS			CREDITS		
ACCOUNT NUMBER		AMOUNT	ACCOUNT NUMBER		AMOUNT
	Salaries	584 58	1-51	W.C.B.	75 30
	Biological	23 95	1-52	A.I.C.	33 70
	Food	539 12	1-53	I.T.	1031 70
	Printing	115 79	1-54	W.C.B.	
	Printing by mail	250 84	1-58	Accrued Holiday	64 00
	W.C.B. Acc	1,243 20	1-59	Wages Payable	62 00
		2,931 54			3,153 00
	Chemical	207 68	1-54	W.C.B.	4 70
	W.C.B. Acc. Rec	207 67	1-58	Accrued Holiday	15 00
		415 35			
	Salaries				
	Biological	413 74	1-54	W.C.B.	26 15
	Biological	135 79	1-58	Accrued Holiday	42 00
	W.C.B. Acc	539 12			
		1,118 55			
		4,450 84			4,470 84

PREPARED BY

EXAMINED BY

APPROVED BY

REMARKS

*Trans. 1000*

DEBITS		CREDITS		
AMOUNT	AMOUNT	ACCOUNT NUMBER	AMOUNT	AMOUNT
			<i>Trans. 1000</i>	
			<i>to portion of CBO + UIC for May 1947</i>	
	<i>100.00</i>	<i>151</i>	<i>CBO</i>	<i>27.00</i>
	<i>100.00</i>	<i>152</i>	<i>UIC</i>	<i>47.00</i>
				<i>100.00</i>
			<i>to charge with <del>to</del> portion of</i>	
			<i>CBO + UIC</i>	
	<i>100.00</i>	<i>312</i>	<i>Trans.</i>	<i>47.00</i>
	<i>100.00</i>			<i>100.00</i>



VANGEOCHEM LAB LTD.

604-988-2172

1521 PEMBERTON AVE., NORTH VANCOUVER, B.C.  
CANADA

IN ACCOUNT WITH:

Bow River Resources Ltd.,  
# 333 - 885 Dunsmuir Street,  
Vancouver, B. C.,  
V6C 1N5

INVOICE: 3494

DATE: September 4, 1975

TERMS: NET 21 DAYS

FOR REPORT 75 19 008  
Job # 75-191

PROJECT:

ORDER NO.

392 soil samples for preparation	@ \$ 0.35	\$ 137.20
392 geochem analyses for Cu, Pb, Zn	@ \$ 2.25	882.00
		\$ 1,019.20
Less 10% discount		101.92
		\$ 917.28
Plus shipping charges		
C. P. Air Waybill # 018-0913-5814		83.50
		<u>83.50</u>
Total		\$ <u>1,000.78</u>

21167
umber 4/75
2757
NO.
AMOUNT

*Atau*  
50% Emv 500.39

1 AuAg	=	7.50
2 Cu	=	9.00
2 Zn	=	11.00
		<u>27.50</u>

\$ 27.50

*Atau Lake*  
50% 1/11 Emv 13.75



901 883 735 2 1972

00525

BOW RIVER

X REC'D BY

*Les Kleber* 76

White Pass Petroleum  
CORPORATION  
1120 BRIDGEYUKON  
NAVIGATION COMPANY LIMITED

ALASKAN ORDER LOGG MO. DATE  
MILE 1202 DAY YEAR  
ALASKA HIGHWAY 070675

QUANTITY	PRICE	AMOUNT
5.3	999	5.25
SALES TAX		
TOTAL		5.25

4.T.  
EC 1770  
VEHICLE LICENSE NUMBER

D 0984173

STATEMENT COPY

THIS INVOICE INCLUDES FEDERAL AND TERRITORIAL OF 1% MERCHANDISE TAXES AS APPLICABLE TO THE ABOVE PRODUCTS AT THE TIME OF SALE 8-20-67 (14-73)

*Wholesale charged to  
S.C. & H. Co. Envoy, 1611 K.  
1.75 at*



Graham's General Store

(1973) Ltd.

BOX 36

MADE, YUKON

PHONE 3541

SOLD TO

*White Pass Resources*

SHIPPED TO

ADDRESS

VIA

CUSTOMER'S NO.	15829
DATE	<i>Aug. 7/75</i>
CUSTOMER'S ORDER	
SALESMAN	
TERMS	
F.O.B.	

INVOICE

<i>Spec.</i>		211.85
<i>Barry H. Graham</i>		
GOODS REC'D	OK FOR PAYMENT	
PRICES & EXT. OK	CHEQUE NO.	
CODE	AMOUNT	
		211.85

Telecommunications Statement of Long Distance Tolls  
 SQ--0914 BOW RIVER RESOURCES LT 10 AUG 1975 1

Day Mo Place Called Number Originated At Amount  
 \*\* CHARGE TO MINIMUM - 7.00

TOTAL - 7.00

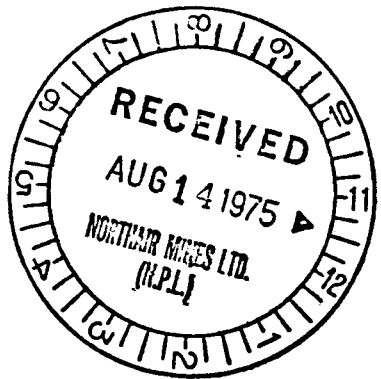

GOODS REC'D	9/29/75	OK FOR PAYMENT
RICES # EXT. OK		CHEQUE NO. 2261
CODE	4-11-55	AMOUNT 7.00

Code ▲ 1-Operator 2-3rd Number 3-Credit Card 4-Collect 8-Dialed 9-Misc. R-Radio  
 6572 5 (9-68) 48-46-010 ▲

Telecommunications  
 This account is now due  
 If you are the person  
 responsible for this entire account

SQ-0914

Telephone Account  
 AUG 10 75  
 WHITEHORSE

BCW RIVER RESOURCES LT  
 333-885 DUNSMUIR ST  
 VANCOUVER BC

Pay from last account (if paid, deduct from total) .....  
 Exchange Service - for one month from date of account .....  
 Directory Charges - for one month .....  
 Long Distance Charges - Statement enclosed .....  
 Other Charges & Credits - Statement enclosed .....  
 PAY CNT BOX 37, EDMONTON ALT Total amount due

7.00  
 7.00

Telecommunications  
 Please return this stub with your payment  
 SQ-0914  
 AUG 10 75  
 WHITEHORSE

BOW RIVER RESOURCES LT  
 333-885 DUNSMUIR ST  
 VANCOUVER BC

Pay from last account .....  
 Exchange Service .....  
 Directory Charges .....  
 Long Distance Charges ..... 7.00  
 Other Charges & Credits .....  
 Tax .....  
 7.00 BOX 37, EDMONTON ALT Total 7.00



LOW RIVER RESOURCES LTD.  
333-885 Dunsmuir Street  
Vancouver 1, B.C.

EXPENSE SUMMARY SHEET FROM Jan 3 TO Jan 31, 1968

NAME D. Page & Tom Page CHEQUE # \_\_\_\_\_ DATE Jan 31

EXPLORATION & DEVELOPMENT EXPENSES

	<u>Property</u>	<u>Amount</u>
1. Assays	_____	1. _____
2. Fuel & Oil	_____	2. _____
3. Freight	_____	3. _____
4. Hotel & Meals	_____	4. _____
5. Licences	_____	5. _____
6. Maps	_____	6. _____
7. Promotion	_____	7. _____
8. Telephone	_____	8. _____
9. Repairs & Maintenance	_____	9. _____
10. Supplies	_____	10. _____
11. Travel - auto	_____	11. _____
- air	_____	_____
- other <u>Tax</u>	_____	_____
12. Miscellaneous <u>TIPS</u>	_____	12. _____
TOTAL	_____	\$ _____
Less: Cash Advance	_____	\$ _____
AMOUNT DUE	_____	\$ _____

*Handwritten notes:*  
 5378 cc = 364.10  
 3596 cc = 275.10  
 1500 Mints = 91.00  
 700.24

*Handwritten calculations:*  
 1500  
 (299.24)

ADMINISTRATION EXPENSES

1. Advertising & Promotion	_____	1. _____
2. Gas & Oil	_____	2. _____
3. Hotel & Meals	_____	3. _____
4. Office Supplies	_____	4. _____
5. Printing & Stationery	_____	5. _____
6. Telephone	_____	6. _____
7. Travel - auto	_____	7. _____
- air	_____	_____
- other _____	_____	_____
8. Miscellaneous	_____	8. _____
TOTAL	_____	\$ _____
Less: Cash Advance	_____	\$ _____
AMOUNT DUE	_____	\$ _____

ALTAIR DRAFTING SERVICES LTD.

No. 5 - 821 WEST PENDER STREET  
VANCOUVER 1. B.C.

OUR NUMBER

051711

DATE

Oct 14/75

CUSTOMER'S ORDER

SALESMAN

TERMS

F. O. B.

SOLD TO Bow River ad Envoy Res.

SHIPPED TO End Claims.

ADDRESS \_\_\_\_\_ VIA \_\_\_\_\_

INVOICE

	Draft Geological Plan ad 3 Geochron Soil Survey plans showing Copper, Lead, Zinc @ 1" = 400'					
			32 m/hr @ 10. <sup>00</sup>		320 00	
	320.00					
	18.34					
	18.34					
	<u>356.68</u>					
			TOTAL \$		320 00	

ALTAIR DRAFTING SERVICES LTD.  
 No. 5 - 821 WEST PENDER STREET  
 VANCOUVER 1, B.C.

OUR NUMBER	008043
DATE	Oct 14/75
CUSTOMER'S ORDER	
SALESMAN	
TERMS	
F. O. B.	

SOLD TO Bow River of Encoy Resumes  
 SHIPPED TO END Claims  
 ADDRESS \_\_\_\_\_ VIA \_\_\_\_\_

INVOICE

1	orig x 6 Blacklin @ 10 <sup>4</sup> soft.			
	156 soft.		15	60
		Fed Tax	1	87
			17	47
		STAX		87
			18	34
		TOTAL #	18	34

REDIFORM - 7M32

ALTAIR DRAFTING SERVICES LTD.  
 No. 5 - 821 WEST PENDER STREET  
 VANCOUVER 1, B.C.

OUR NUMBER	008042
DATE	Oct 14/75
CUSTOMER'S ORDER	
SALESMAN	
TERMS	
F. O. B.	

SOLD TO Bow River of Encoy Res.  
 SHIPPED TO END Group  
 ADDRESS \_\_\_\_\_ VIA \_\_\_\_\_

INVOICE

1	orig x 3 Duplex @ 80 <sup>4</sup> soft.			
	19 1/2 soft.		15	60
		Fed Tax	1	87
			17	47
		STAX		87
			18	34
		TOTAL #	18	34

REDIFORM - 7M32

APPENDIX IV  
ENGINEER'S CERTIFICATE

CERTIFICATE

I, James W. MacLeod, of 1220 Arbutus Street, in the City of Vancouver, in the Province of British Columbia, DO HEREBY CERTIFY:

1. That I am a Consulting Engineer, with a business address at 335-885 Dunsmuir Street, in the City of Vancouver, in the Province of British Columbia.
2. That I am a graduate of the University of Alberta with the degree of B.Sc. in Mining Engineering.
3. That I have actively practiced my profession in mineral exploration since graduation in 1946.
4. That I am a registered Professional Engineer in the Province of British Columbia.
5. That the soil sampling survey of the End Group was carried out under my supervision.

---

J.W. MacLeod, B.Sc., P.Eng.

Dated at the City of Vancouver, Province of British Columbia, this 10th day of October, 1975.

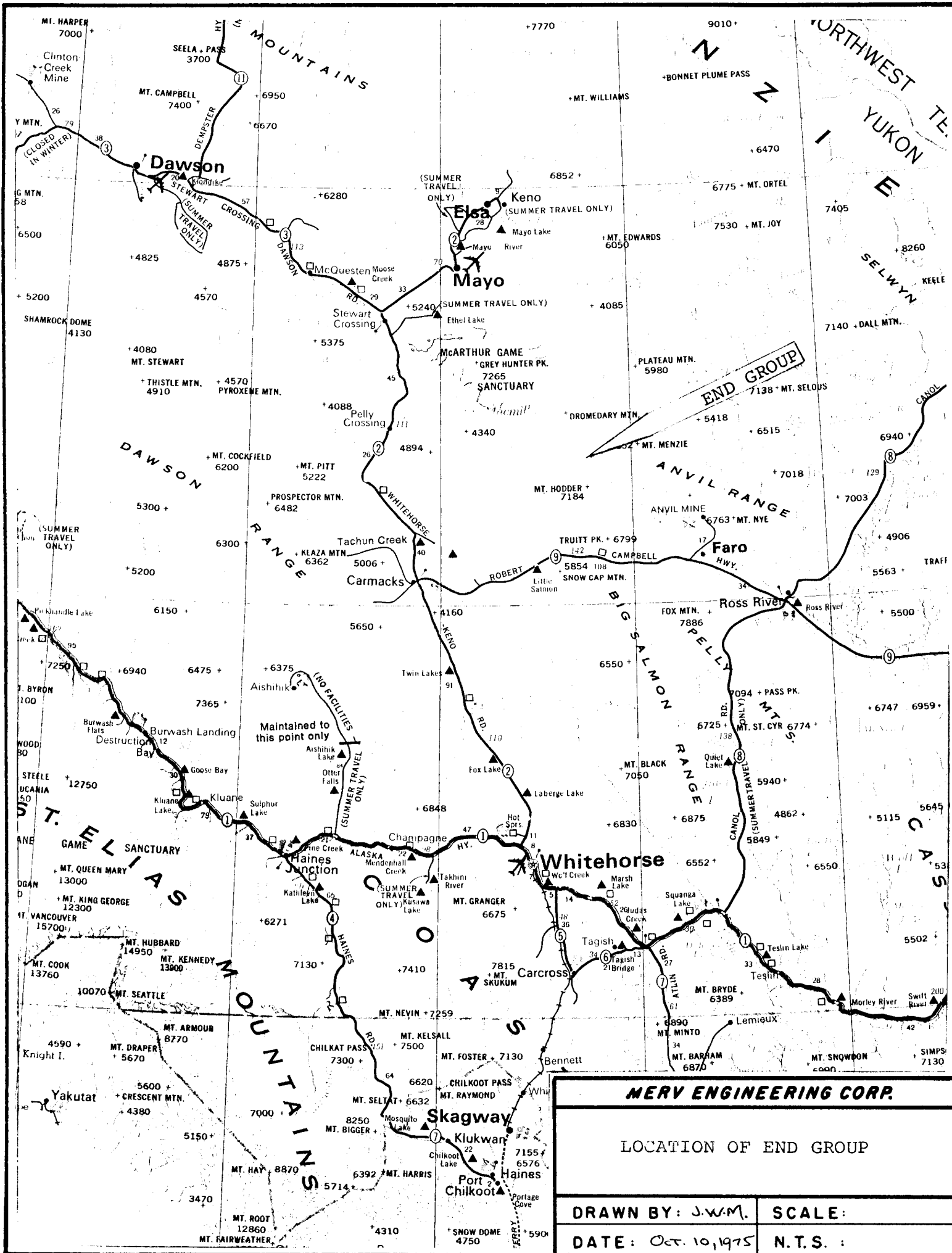

<b>MERV ENGINEERING CORP.</b>	
LOCATION OF END GROUP	
DRAWN BY: J.W.M.	SCALE:
DATE: Oct. 10, 1975	N.T.S. :

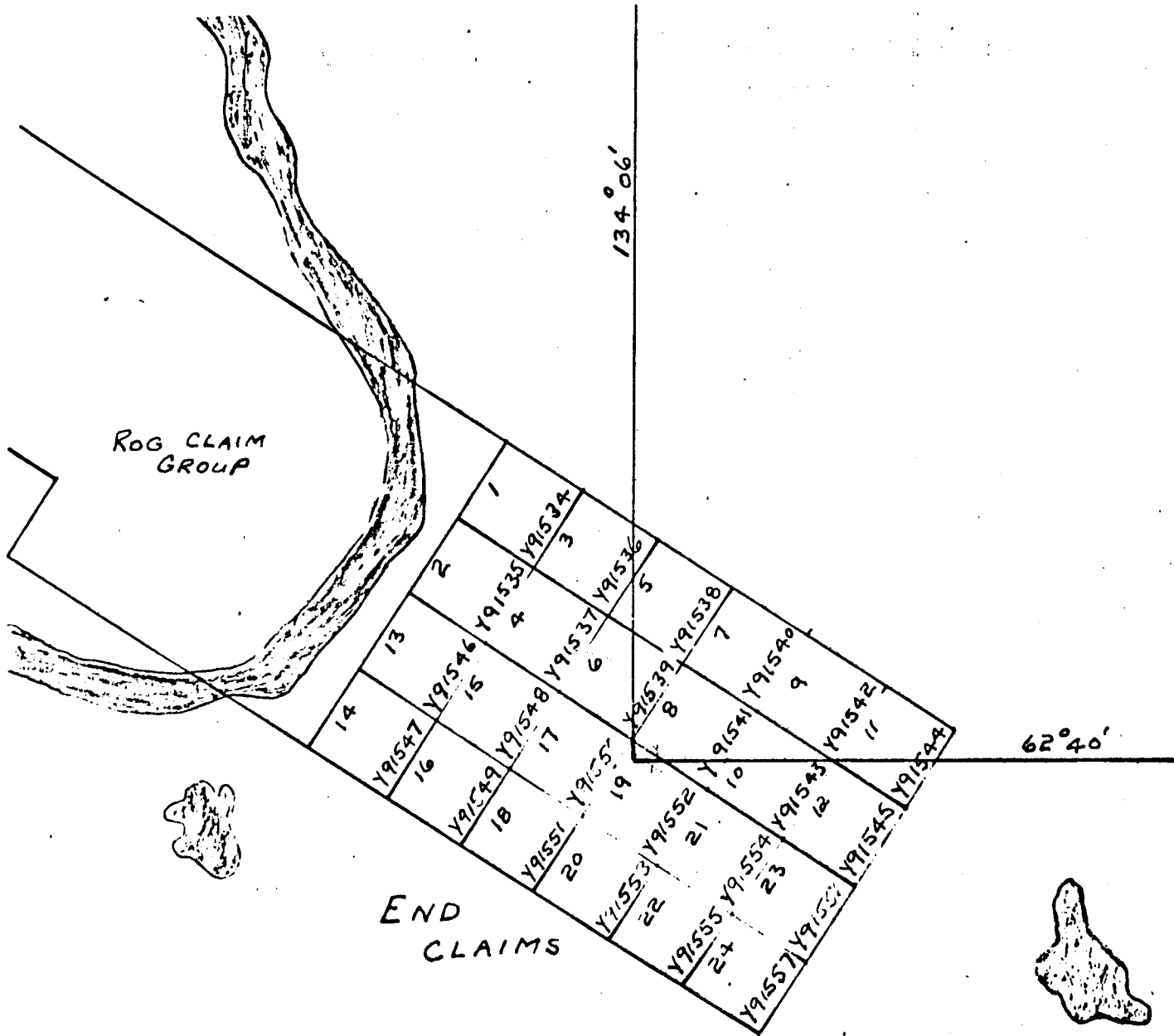

MERV ENGINEERING CORP.

PLAN OF END GROUP

DRAWN BY: *AWH*

SCALE: 1" = 1/2 mi.

DATE: *OCT. 1975*

N.T.S. : 105-L-10

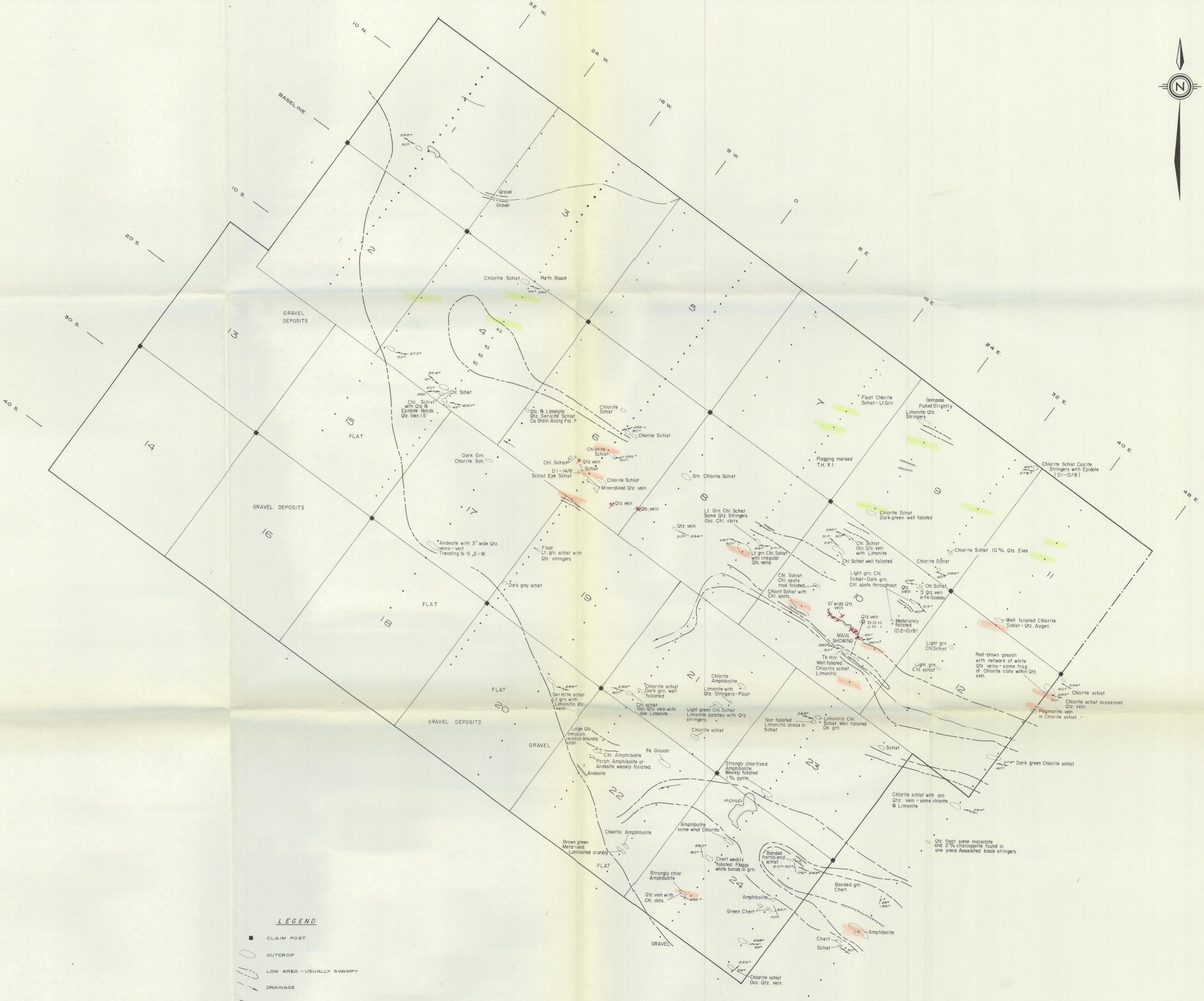
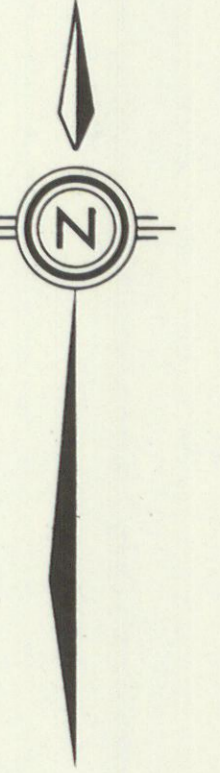

**LEGEND**

- CLAIM POST
- OUTCROP
- LOW AREA - USUALLY SWAMPY
- DRAINAGE
- CLIFF
- FOLIATION
- CLAIM BOUNDARY
- ANOMALOUS COPPER
- ANOMALOUS ZINC

BOW RIVER RESOURCES LTD.  
& ENVOY RESOURCES LTD.

**END CLAIMS  
GEOCHEM. SOIL SURVEY  
& GEOLOGY**

SCALE IN FEET  
0 200 400 800 1200 1600

DATE: OCTOBER, 1975  
DRAWN: ALTAIR

NTS. 105 L/10

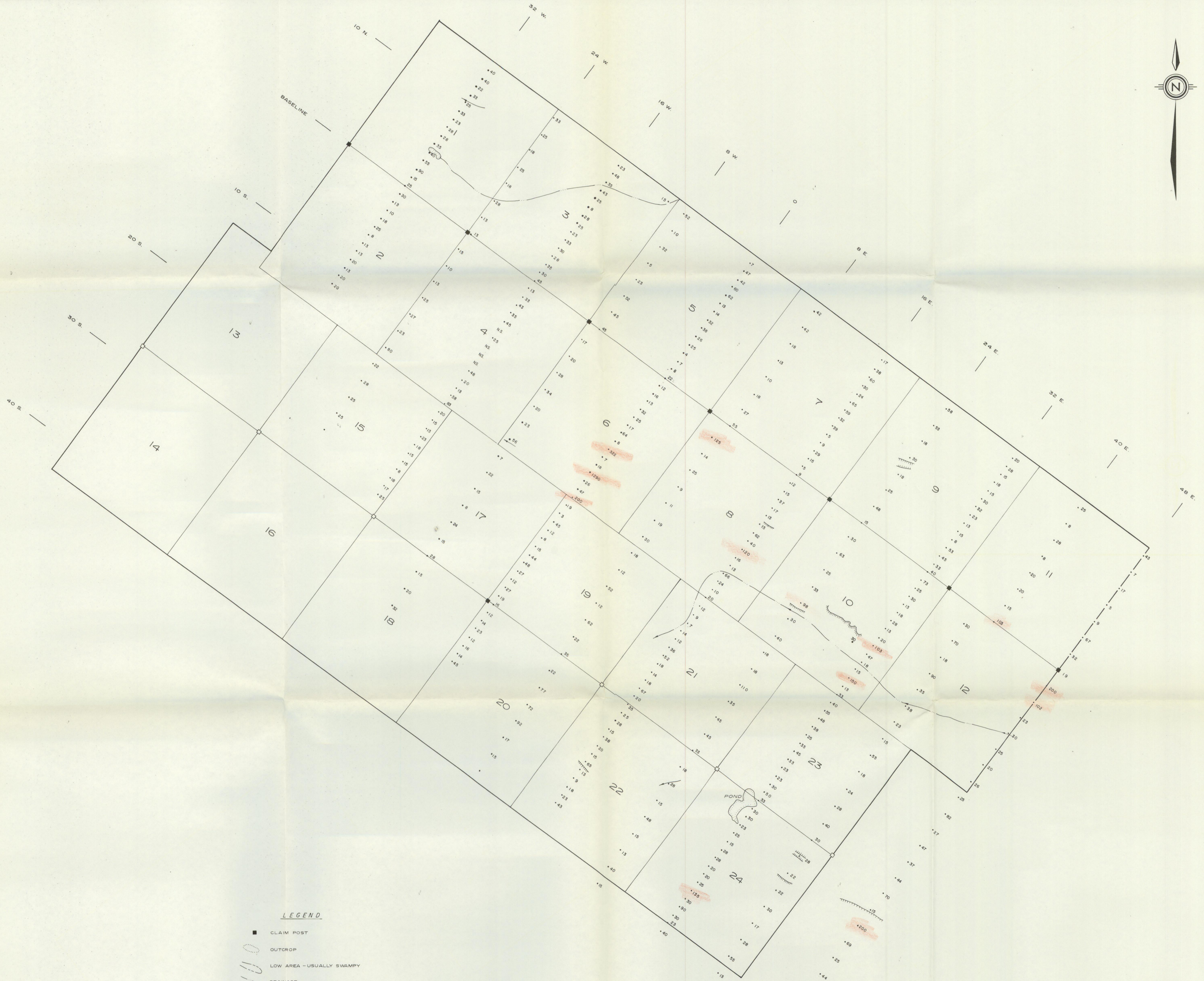
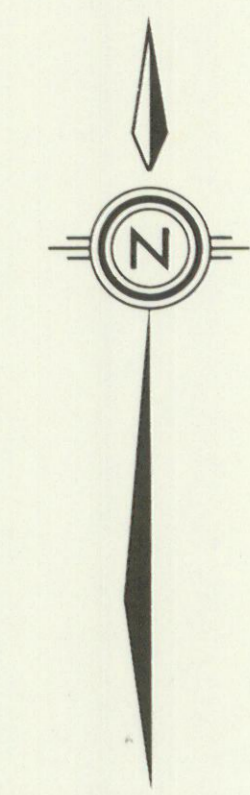

LEGEND

- CLAIM POST
- OUTCROP
- LOW AREA - USUALLY SWAMPY
- DRAINAGE
- CLIFF
- FOLIATION
- CLAIM BOUNDARY
- 40 GEOCHEM. SOIL SAMPLE

BOW RIVER RESOURCES LTD.  
& ENVOY RESOURCES LTD.

**END CLAIMS  
GEOCHEM. SOIL SURVEY  
& GEOLOGY  
COPPER**

0 200 400 800 1200 1600  
SCALE IN FEET

DATE: OCTOBER, 1975  
DRAWN: ALTAIR

N.T.S. 105 L/10



**LEGEND**

- CLAIM POST
- OUTCROP
- LOW AREA - USUALLY SWAMPY
- DRAINAGE
- CLIFF
- FOLIATION
- CLAIM BOUNDARY
- 100 GEOCHEM. SOIL SAMPLE

BOW RIVER RESOURCES LTD.  
& ENVY RESOURCES LTD.

**END CLAIMS  
GEOCHEM. SOIL SURVEY  
& GEOLOGY  
ZINC**

0 200 400 800 1200 1600 SCALE IN FEET

DATE: OCTOBER, 1975  
DRAWN: ALTAIR NTS. 105 L/10

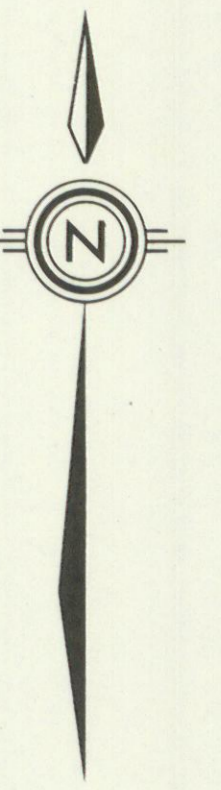

LEGEND

- CLAIM POST
- OUTCROP
- LOW AREA - USUALLY SWAMPY
- DRAINAGE
- CLIFF
- FOLIATION
- CLAIM BOUNDARY
- GEOCHEM. SOIL SAMPLE

BOW RIVER RESOURCES LTD.  
& ENVY RESOURCES LTD.

**END CLAIMS  
GEOCHEM. SOIL SURVEY  
& GEOLOGY  
LEAD**

SCALE IN FEET  
0 200 400 800 1200 1600

DATE: OCTOBER, 1975  
DRAWN: ALTAIR

NTS. 105 L/10