

Report on the
BONNET PLUME - GOZ CREEK PROPERTY
YUKON TERRITORY

Latitude $64^{\circ} 27' N$

Longitude $132^{\circ} 57' W$

NTS 106 C

4800

This report has been examined by the Geological Evaluation Unit and is recommended to the Commissioner to be considered as representation work in the amount of \$4800.00

D.B. Craig

Resident Geologist or
Resident Mining Engineer

for

Considered as representation work under Section 53 (4) Yukon Quartz Mining Act.

[Signature]

Commissioner of Yukon Territory

T. R. V. Minerals Corp., Ltd.

Claim Names

C V O 41 - 56
B P R 1 - 12
B P R 21 - 40
T R W 1 - 40

Record Numbers

Y 85358 - Y 85373
Y 85374 - Y 85385
Y 85394 - Y 85413
Y 85414 - Y 85453

by:

John J. Oberbillig, P. Geol.

Vancouver, B.C.

January 8, 1975

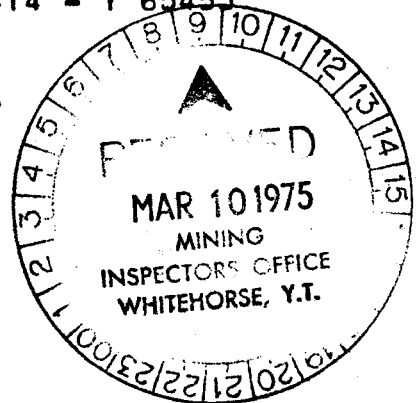

TABLE OF CONTENTS

Introduction.....1
Summary and Conclusions.....2
Recommendations.....3
Estimated Costs.....4
Geography.....5
 Location.....5
 Access.....5
 Topography.....5
 Climate.....6
 Vegetation.....6
 Water.....6
Claims.....6
History.....7
Geology.....8
Geochemistry.....9

Location Map.....12

Maps in Pocket:
Geology, Claim & Topographic Map, 1" = 1,000 '
Lead and Zinc content in Soil Map, 1" = 1,000'

INTRODUCTION

This report was written at the request of Mr. W. L. C. Newsom of T. R. V. Minerals Corp., Ltd.

The writer examined and carried out a work program on the CVO, BPR & TRW group of claims from July 20th to August 2nd, 1974.

The program consisted of line cutting, establishing a base-line grid system, geochemical soil sampling, and geological mapping.

This work program was carried out and completed under the supervision of Mr. Gordon C. Gutrath, P. Eng., following the recommendations set forth in his report of February, 1974.

This report is based on information and results obtained through the program plus information compiled from published and private reports on the area.

SUMMARY AND CONCLUSIONS

The TRW, BPR & CVO claim groups consist of 88 contiguous claims located in the northeastern Yukon Territory approximately 120 air miles from the community of Mayo. Present access to the property is only by float aircraft and/or helicopter. The Bonnet Plume River flows northwesterly through the property approximately dividing the CVO and BPR claim groups.

The TRW & BPR groups and portions of the CVO group are located south of the river and are underlain by Precambrian shales. Through the southeast portion of TRW 22, a dolomite unit occurs striking almost east-west.

Through a reconnaissance geological mapping and geochemical sampling program, no mineral values of economic importance were found associated with either the shale or this dolomite. It is therefore concluded that no further work is recommended for the TRW group of claims.

Anomalous zones of zinc mineralization occur over a lateral extent of about 12,000 feet along the northeastern portion of the CVO group. This, coupled with the close proximity of the known zinc occurrences and favorable geology for strata-bound zinc mineralization, definitely warrants that this group be explored much more in detail.

RECOMMENDATIONS

PHASE I

A. TRW Group

1. No further work is recommended on this portion of the property.

B. CVO-BPR Group

1. Survey all claims in this group
2. Collect additional soil samples to give a 200 by 200 ft. grid system. Analyse for lead & zinc.
3. Detailed geological mapping
4. Conduct an electromagnetic survey using a Ronka EM 16 instrument. This will assist in locating the lower shale-carbonate contact.

PHASE II

This phase is contingent upon obtaining favorable results from Phase I. If the results warrant further exploration, a minimum of 4000 lineal feet of diamond drilling is recommended.

ESTIMATED COSTS

PHASE I

A. TRW Group

No costs

B. CVO-BPR Group

1. Claim Survey:

1 Surveyor	10 days @ \$100/day	\$1,000.00
1 Helper	10 days @ 50/day	500.00
1 Senior Technician	10 days @ 80/day	800.00
1 Helper	10 days @ 50/day	500.00
Equipment Rental		300.00
Food & Accomodation, 40 man days @ \$25.00		1,000.00

2. Soil Sampling, Mapping & EM Survey:

1 Geologist	30 days @ \$150/day	4,500.00
1 Senior Field Tech.	20 days @ 80/day	1,600.00
2 Soil Samplers	20 days @ 50/day	2,000.00
Food & Accomodation, 90 man days @ \$25.00		2,250.00
Equipment rental, EM		500.00

3. Soil Sample analyses: 1,000 @ \$2.00 ea. 2,000.00

4. Transportation:

Scheduled Aircraft	1,500.00
Helicopter; 15 hrs. @ \$296.00/ hr.	4,440.00

5. Consulting, Data Compilation, Report 1,000.00

23,890.00

Overhead and Contingincies @ 20% 4,778.00

Total, Phase I.....\$28,668.00

PHASE II

(Contingent on Phase I)

4,000 lineal feet of BQ wireline diamond drilling
at a cost of \$35.00 per foot
.....\$140,000.00

GEOGRAPHY

LOCATION:

The property is located on both sides of the Bonnet Plume River approximately ~~14~~⁶ air miles northwest of the confluence of Goz Creek and the Bonnett Plume River.

The claim group is approximately at 64° ~~27~~²⁴' North Latitude and ~~133~~¹³²° ~~00~~⁰⁰' West Longitude; or about ~~120~~¹⁰⁵ air miles ~~northwest~~^{northwest} of the community of Mayo, Yukon.

ACCESS:

Access to the property is by float aircraft from the community of Mayo to a small lake named Porter Puddle; thence by helicopter 6 miles northwesterly to the property.

TOPOGRAPHY:

The BPR and TRW claim groups cover part of the lower south-side of the Bonnet Plume Valley. These claims are between the elevations of 2,800 feet and 3,600 feet.

The CVO group of claims cover part of the lower north-side of the Bonnet Plume River Valley, starting at the river elevation of 2,800 feet and extending northeasterly up-slope to approximately 3,000 feet.

CLIMATE:

The average annual rainfall would be in the range of from 20 to 25 inches. Snowfall would probably average from 3 to 6 feet along the Bonnet Plume Valley. The valley below 4,000 feet would be snow covered from October to June.

VEGETATION:

The valley bottom is covered by arctic spruce which is suitable for mine timber and lumber. The slopes are covered with muskeg and intermittent stands of balsam and buckbrush to the 3,000 foot elevation.

WATER:

There is ample water on the property for mineral exploration and domestic purposes.

CLAIMS

The following information was given to the writer by a representative of T.R.V. Minerals Corp., Ltd. (formally known as Twin River Resources Ltd.) as claims held by their company. No search or substantiation was carried out by the writer.

<u>NAME</u>	<u>RECORD NUMBER</u>	<u>EXPIRY DATE</u>
CVO 41 to 56	Y85358 to Y85373	September 10, 1974
BPR 1 to 12	Y85374 to Y85385	September 10, 1974
BPR 21 to 40	Y85394 to Y85413	September 10, 1974
TRW 1 to 40	Y85414 to Y85453	September 10, 1974

These claims are located in the Mayo Mining District, Yukon Territory.

HISTORY

"During the 1973 exploration season, Barrier Reef Resources Ltd. discovered a significant zinc occurrence near the junction of Goz and Duo Creeks in the Bonnet Plume River area. There was already considerable exploration activity for lead and zinc mineralization in the northeastern Yukon with the discovery by Placer Development of zinc mineralization in the Howards Pass area followed by numerous discoveries in the Godlin Lakes area. The Barrier discovery resulted in a staking rush and over 1,800 claims were staked. It was during this initial staking rush that Cypress Resources Ltd. discovered zinc and lead mineralization in the carbonate formation adjoining the CVO group to the northwest.

There has been no exploration done on the CVO, BPR or TRW Claims."

Quote from report of Gordon C. Gutrath, P. Eng., June 1974.

GEOLOGY

The BPR and TRW groups are located on the northern slope of the Rackla Range and is underlain by a thick sequence of sedimentary rocks of Precambrian age. The BPR, CVO & TRW claims south of the Bonnet Plume River contain a brown shale with beds of siltstone and conglomerate. Across the northeast corner of TRW 17, a contact zone was noted exposing a grey dolomite, probably of Precambrian to lower Cambrian age. Strike of this contact is approximately N 80 E. The CVO group occupies part of the southern slope of the Bonnet Plume Range and is underlain by a thick sequence of sedimentary rocks of Precambrian age. The northern portion of the property is reported to cover the lower part of a Precambrian dolomite, overlying the shales. Due to the heavy muskeg cover on the CVO claims, minimal exposures of 'rock in place' could only be observed where the cover was cut by the small streams present.

Indications are that the property is located on the north limb of a broad, open anticline, striking approximately N 60 W.

Adjoining the CVO group to the northeast, is a group of claims owned by Cypress Resources Ltd. In the dolomite unit, they have discovered zinc mineralization in the form of Sphalerite and Smithsonite in silicified breccia zones. Minor lead occurrences are associated with the zinc mineralization.

Approximately one mile to the north, Barrier Reef Resources has located a strata-bound, pyritic, lead-zinc mineralized structure in this dolomite unit.

GEOCHEMISTRY

A grid system was established on the BPR & TRW claim groups with the North - South base line occupying the common boundary between claims BPR 39 & 40, BPR 37 & 38, BPR 35 & 36, BPR 33 & 34 and continuing through to the common border between BPR 1 & 2. The East and West line was approximately cut through the center of claims BPR 29 & 30, TRW 29 & 30, CVO 49 & 50. Bearing of the east-west line is about N 25 E.

At right angles to the north-south base line, thirty lines were established extending across the property, terminating at the south edge of the Bonnet Plume River. Soil samples were taken from the 'B Horizon' at 400 ft. intervals along these lines. Several instances occurred where no soil was readily available and rock geochemical samples were taken.

On the north side of the river, soil samples were taken from the 'B Horizon', where possible, and labeled as numerical numbers rather than a grid system. These samples were taken on 400 ft. intervals with approximately 600 ft. spacing between lines. Lines were established and closures made on the entire group using a Topofil-Brunton method.

From established information in the area, a background value of 70 ppm was taken for Lead and 140 ppm for Zinc. Threshold values were assumed accurate at twice the background value. Analysis of the samples was made by the Barriner Research Lab., Whitehorse, Yukon.

None of the lead values were significant enough to plot and contour on the claim groups. Neither Lead nor zinc values were contoured below background.

Anomalous to Strongly Anomalous values in Zinc occur consistently along the northeast boundary of the CVO group over a lateral extent of approximately 12,000 feet. Contour configurations of these zinc values along this part of the group indicate the probability of the underlying shale-dolomite contact being present.

No significant values in Lead or Zinc were noted in the TRW claim group. With one exception, in BPR 40, the values in the BPR group ranged between background and threshold significance.

Respectfully submitted,

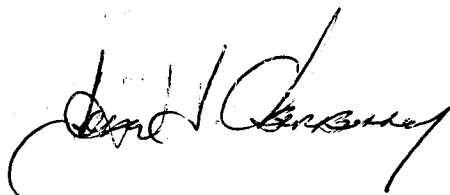

John J. Oberbillig, P. Geol.

11

ATLED EXPLORATION MANAGEMENT LTD.

420—475 HOWE STREET • VANCOUVER 1, B.C.
TELEPHONE 688-0471

October 16, 1974

TO WHOM IT MAY CONCERN

I have reviewed the Report on the CVO-BPR
Claim Groups, Mayo Mining Division, Yukon
Territory by John J. Oberbillig, P.Geol.,
and agree with the Conclusion, Recommendations
and Estimated Costs outlined in the Report.

Respectfully submitted,

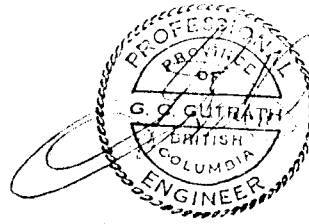

G. C. Gutrath, B.Sc., P.Eng., Geologist
ATLED EXPLORATION MANAGEMENT LTD.

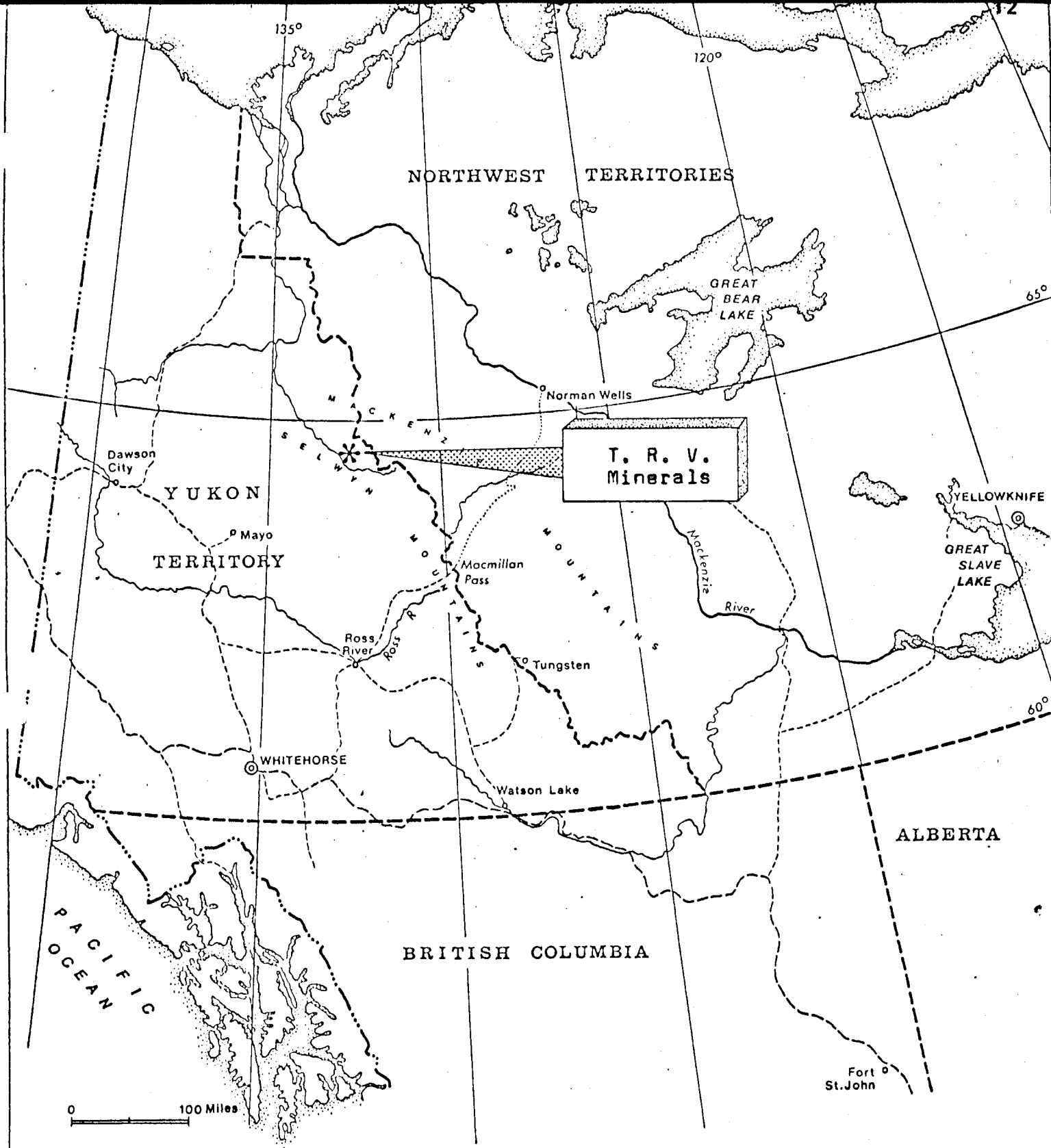

Location Map

T, R. V. Minerals Corp., Ltd.
 Vancouver, B. C.

ATLED EXPLORATION MANAGEMENT LTD

BARRINGER RESEARCH LIMITED

Geochemical

**Laboratory
Reports**

304 CARLINGVIEW DRIVE
REXDALE, ONTARIO, CANADA
PHONE: 416-677-2491
CABLE: BARESEARCH

DATE January 30th, 1975

H.E.W. Management Ltd.
101-325 Howe Street
Vancouver, British Columbia
Attention: Mr. J. J. Oberbillig

REPORT NUMBER 58-A

377.

SAMPLE NUMBER	HClO ₄ Pb ppm	HClO ₄ Zn ppm	Sample No.	HClO ₄ Pb ppm	HClO ₄ Zn ppm		
2	32	220		23	36	210	
3	39	240		24	39	240	
4	36	165		25	33	390	
5	130	540		26	41	215	
6	145	600		27	38	240	
7	125	625		28	44	260	
8	30	150		30	55	430	
9	74	390		31	42	140	
10	31	290		33	53	320	
11	49	320		34	42	330	
12	38	340		36	37	150	
13	48	350		37	50	250	
14	39	650		38	43	290	
15	49	245		43	36	240	
16	38	280		44	36	260	
17	43	530		45	38	250	
18	30	350		46	36	220	
19	38	570		47	39	200	
20	44	800		48	37	280	
22	37	240					

Sample No.	HC10 ₄ Pb ppm	HC10 ₄ Zn ppm		Sample No.	HC10 ₄ Pb ppm	HC10 ₄ Zn ppm			
102	42	110		31N	47	150			
103	45	225		36N	43	175			
104	43	420		38N	36	100			
105	31	160		4S (R)	34	120			
106	48	260		8S (R)	38	94			
107	54	290		12S (R)	40	89			
108	63	240		16S (R)	33	140			
109	70	270		20S (R)	29	94			
111	32	200		24S (R)	28	140			
112	39	51		28S	42	130			
113	50	110		32S (R)	38	125			
114	41	200	0 + 00	36S	33	89			
115	43	240		40S	37	165			
116	46	160	BL - 5W	(R)	41	79			
117	47	240		15W	34	140			
118	45	70		25W	41	190			
119	44	180		35W	47	145			
120	54	180		45W	42	145			
0 + 00 BL	35	72		55W	NS	NS			
0 + 00 4N (R)	47	60		65W	43	135			
8N (R)	44	92		75W	45	125			
12N	39	87		5E	30	70			
16N	42	83		15E	34	150			
20N	39	110		25E (R)	36	94			
24N	39	130		35E (R)	40	120			
26.50N	34	93		45E	32	90			

Sample No.	HClO ₄ Pb ppm	HClO ₄ Zn ppm	Sample No.	HClO ₄ Pb ppm	HClO ₄ Zn ppm
36S	28	160	28S	34	135
40S (R)	28	100	32S	37	130
160E-BL	30	150	36S	35	145
4N (R)	34	41	40S	35	145
8N (R)	37	170	180E-BL	39	175
11N (R)	28	83	4N	29	160
4S	29	105	8N (R)	25	100
8S	29	100	10N (R)	31	100
12S	20	95	4S	31	105
16S (R)	38	24	8S	34	140
20S	34	120	180E-12S (R)	34	23
24S	29	135	16S	30	115
28S	34	170	20S	27	145
32S	31	190	24S	29	170
36S	31	190	28S	24	130
40S	49	270	32S	29	115
170E-BL (R)	22	84	36S	25	110
170E-4N (R)	21	84	40S	28	140
8N (R)	27	175	190E-BL	32	165
11.5N (R)	29	64	4N	30	110
4S	28	92	8N (R)	33	68
8S	29	125	10N (R)	32	76
12S	27	110	8S	25	110
16S	34	100	12S	32	150
20S	31	150	16S	27	175
24S	29	130	20S	34	190

Sample No.	HClO ₄ Pb ppm	HClO ₄ Zn ppm		Sample No.	HClO ₄ Pb ppm	HClO ₄ Zn ppm			
14W-36S	37	140		26S (R)	31	62			
16W-28S (R)	30	91		BL	29	110			
32S (R)	34	65		30W-4NX	34	125			
20W-BL	37	100		4N	34	140			
4S	33	110		8N	31	140			
8S	31	69		12N	32	115			
12S	32	140		16N	27	120			
16S (R)	31	69		20N	29	165			
20S (R)	30	75		24N	30	120			
20W-24S	26	87		28N	27	67			
28S	40	100		40W-4S	32	110			
8N (R)	27	91		8S (R)	26	93			
12N	NS	NS		12S (R)	27	105			
16N	27	82		16S	NS	NS			
20N	30	120		20S (R)	25	78			
24N	29	77		24S (R)	20	87			
28N	27	73		26S (R)	11	34			
32N	32	125		BL (R)	27	120			
36N	29	85		4N	33	120			
40N	31	96		8N	37	120			
30W-4S (R)	35	80		12N	28	89			
8S	34	130		40W-16N	33	100			
12S	40	140		20N	31	120			
16S (R)	24	65		24N	36	130			
20S (R)	30	74		28N	29	115			
24S (R)	24	70		32N	27	105			

Sample No.	HClO ₄ Pb ppm	HClO ₄ Zn ppm	Sample No.
36N	26	110	16S (R)
50W-4S (R)	26	76	20S
8S (R)	35	110	24S (R)
12S (R)	23	67	28S (R)
16S	25	74	32S (R)
20S (R)	37	135	36S (R)
24S (R)	27	115	40S (R)
28S (R)	19	94	BL
32S (R)	30	62	60W-4N
36S (R)	37	88	8N
40S (R)	38	18	12N
BL (R)	25	67	16N
4N	NS	NS	20N
8N	32	120	24N
50W-12N	34	100	28N
16N (R)	32	88	32N
20N	30	84	36N (R)
24N	28	69	40N
28N	30	85	70W-8S
32N	30	130	12S
36N	28	86	14.5S
40N	29	110	20S (R)
60W-4S (R)	27	93	24S (R)
8S (R)	24	120	28S
12S (R)	24	70	32S (R)

Sample No.	HClO ₄ Pb ppm	HClO ₄ Zn ppm			
	20	63			
	25	70			
	28	160			
	33	110			
	24	58			
	44	110			
	27	65			
	22	73			
	29	165			
	25	110			
	27	115			
	28	140			
	24	110			
	24	79			
	20	70			
	20	80			
	23	85			
	30	110			
	61	100			
	27	125			
	28	100			
	31	66			
	32	89			
	28	115			
	27	64			

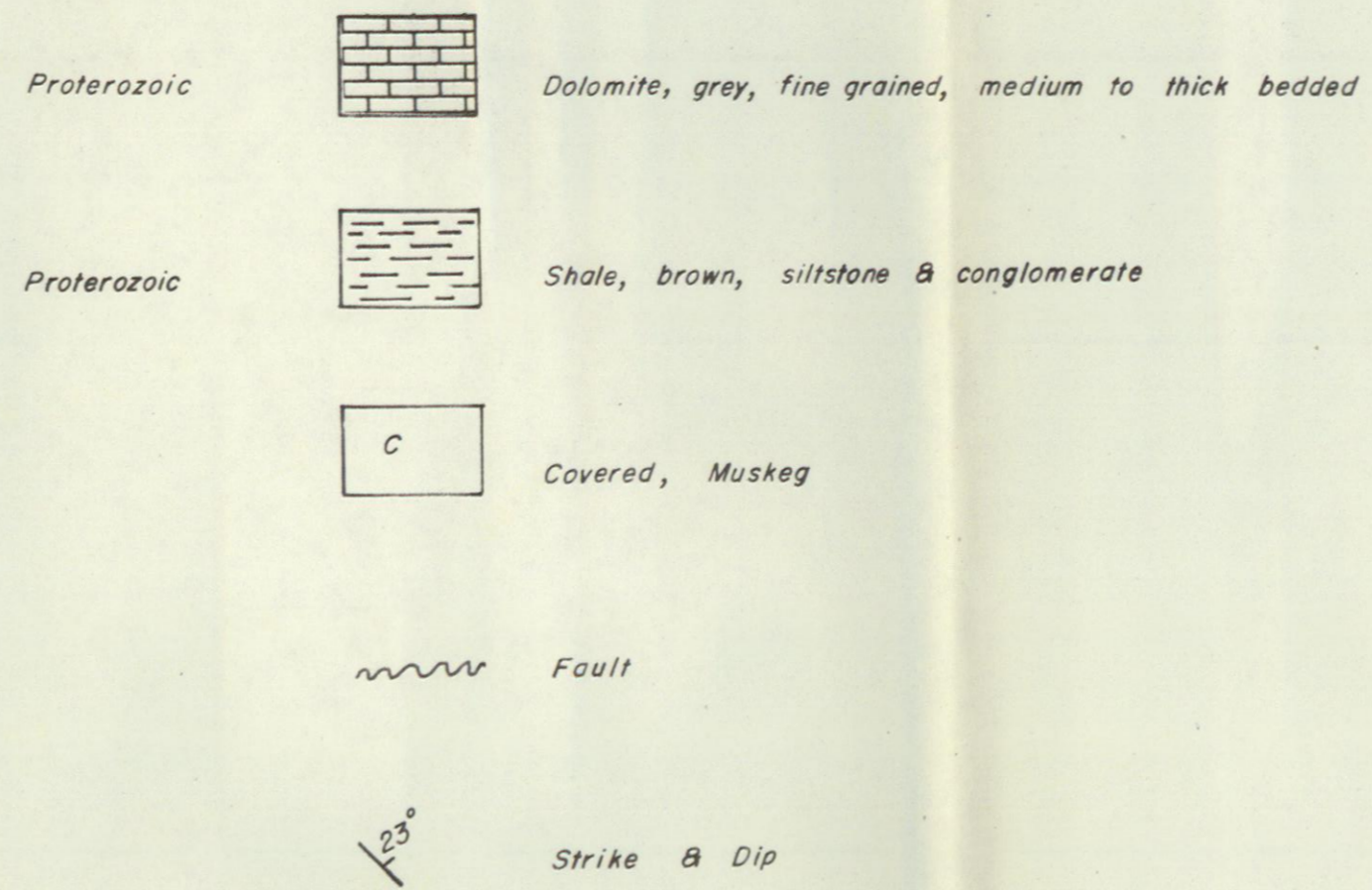

Geology after G. S. C. with local additions by J. J. Oberbillig

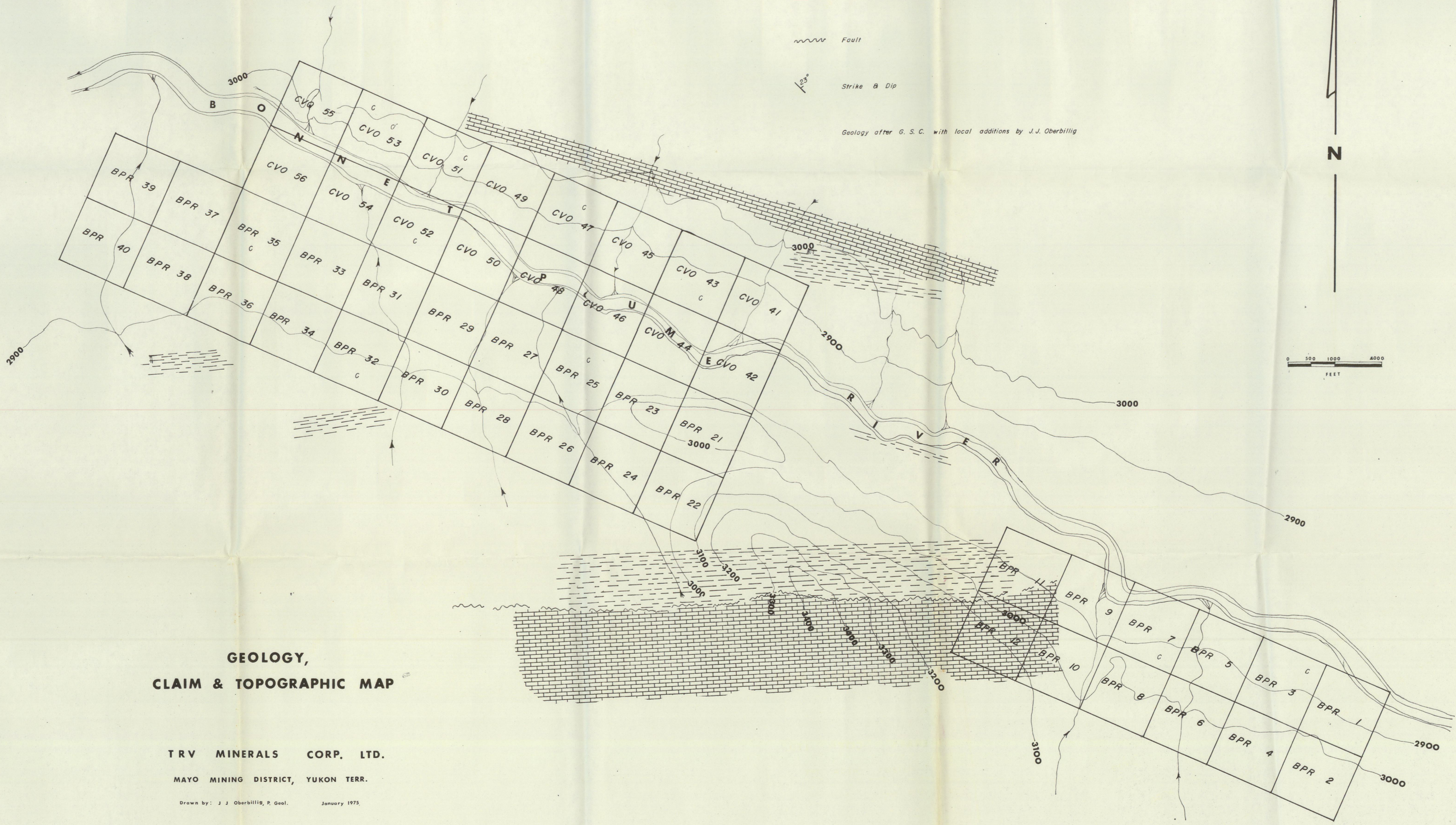

**GEOLOGY,
CLAIM & TOPOGRAPHIC MAP**

TRV MINERALS CORP. LTD.

MAYO MINING DISTRICT, YUKON TERR.

Drawn by: J. J. Oberbillig, P. Geol. January 1975

James J. Oberbillig

Lead

Background ----- 70 ppm
Threshold ----- 140 ppm
Anomalous ----- 180 ppm
Strongly Anomalous ----- 200 ppm

Zinc

Background ----- 140 ppm
Threshold ----- 280 ppm
Anomalous ----- 350 ppm
Strongly Anomalous ----- 500 ppm

Note:

1. Soil samples taken from B horizon, where possible
2. Rock geochemical samples marked as "R"
3. Analyst: Barringer Research Ltd., Whitehorse, Yukon
4. Values below background were not plotted nor contoured

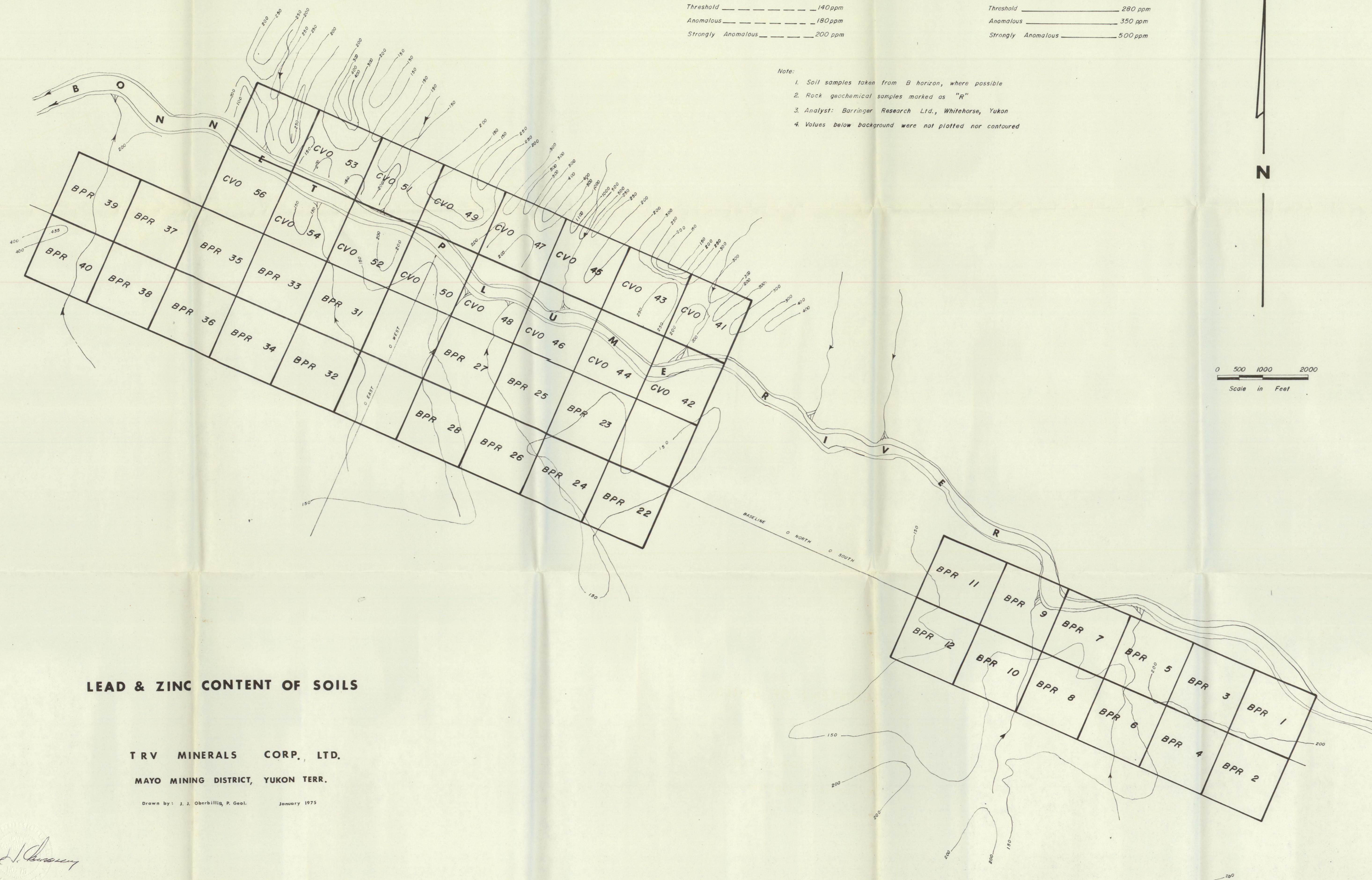

LEAD & ZINC CONTENT OF SOILS

TRV MINERALS CORP., LTD.

MAYO MINING DISTRICT, YUKON TERR.

Drawn by: J. J. Oberbillig, P. Geol. January 1973

J. J. Oberbillig