



GEOLOGICAL & GEOCHEMICAL  
REPORT

ON THE

BOX (1 - 21) CLAIM GROUP

MAYO MINING DISTRICT

YUKON TERRITORY

CLAIM SHEET 106-C-7

LATITUDE: 64° 25' N

LONGITUDE: 132° 50' W

FOR

JUNEX RESOURCES LTD.

\$ 6300.00

BY

D.H. WAUGH, GEOLOGIST

D.H. WAUGH & ASSOCIATES LTD.

WHITEHORSE, YUKON

JULY, 1974

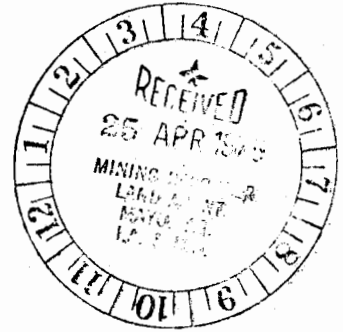

This report has been examined by the Geological Evaluation Unit and is recommended to the Commissioner to be considered as representation work in the amount of

\$6300.00

*D.R. Craig*

Resident Geologist or  
Resident Mining Engineer

Considered as representation work under Section 53 (4) Yukon Quartz Mining Act.

*[Signature]*

D.R. BAXTER  
Supervising Mining Recorder

Commissioner of Yukon Territory

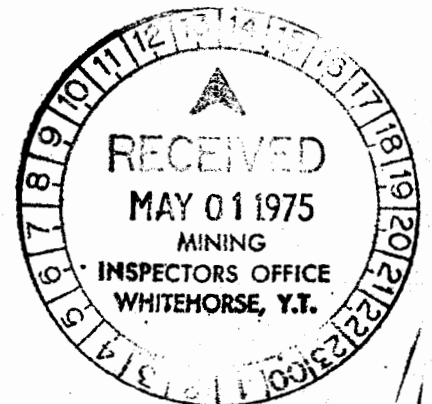

TABLE OF CONTENTS

1)	INTRODUCTION . . . . .	Page	1
2)	LOCATION AND ACCESS . . . . .		3
3)	PROPERTY AND OWNERSHIP . . . . .		4
4)	TOPOGRAPHY . . . . .		5
5)	CLIMATE AND VEGETATION . . . . .		6
6)	HISTORY . . . . .		7
7)	GEOLOGY		
	GENERAL . . . . .		8
	PROPERTY . . . . .		8
8)	GEOCHEMICAL SURVEY		
	SURVEY METHOD . . . . .		10
	DISCUSSION OF RESULTS . . . . .		11
9)	CONCLUSIONS AND RECOMMENDATIONS . . . . .		13

APPENDICES

- I List of Personnel
- II Statement of Expenditures and Affidavit
- III Assay Certificate
- IV Certification

ILLUSTRATIONS

- |    |                        |                |            |
|----|------------------------|----------------|------------|
| 1) | Location Map           | 1" = 120 miles | After p. 3 |
| 2) | Claim Sketch           | 1" = ½ mile    | After p. 4 |
| 3) | Geology & Geochemistry | 1" = 500 feet  | Envelope   |

BOX (1 - 21) CLAIM GROUP

CLAIM SHEET 106-C-7

MAYO MINING DISTRICT

YUKON TERRITORY

JUNEX RESOURCES LTD.

JULY, 1974

D.H. WAUGH

### INTRODUCTION

This report is based on the results of a geological mapping, prospecting and geochemical soil sampling program conducted by D.H. Waugh & Associates Ltd. for Junex Resources Ltd. The program was recommended by Mr. G.C. Gutrath, P. Eng., in his report dated June, 1974. The field work was conducted during the period July 7<sup>th</sup> - 16<sup>th</sup>, 1974, on the Box (1 - 21) mineral claims.

The property is located in the Bonnet Plume River - Goz Creek area of the Wernecke Mountains, Yukon Territory. Several new zinc discoveries were made in the Bonnet Plume Range by Barrier Reef Resources Ltd. and Cypress Resources Ltd. during the summer of 1973. At the time this report was written, drilling was in progress on two of the zinc discoveries, one by Barrier Reef and one by Cypress Resources.

The Box claims are situated adjoining the Great Plains - Barrier Reef, Harrison Creek property to the south, the Cypress Resources property to the west and the Conwest - Sicintine property to the east. A drill program is planned for the Great Plains, Harrison Creek property in August, 1974.

A field crew consisting of a geologist (D. Waugh), and a prospector (M. Callaghan), mapped, prospected and soil sampled the Box claims. The crew was mobilized from Whitehorse to Mayo by company truck, and from Mayo to Rackla Lake by float plane. Transportation from Rackla Lake to base camp, located 12 miles northeast of Rackla Lake, was by Terr-Air, Bell 206B-Jet Ranger, helicopter. The crew was transported from the base camp to the property by helicopter. On completion of the field work, the crew demobilized via Rackla Lake and Mayo.

This report is a description of the work, a discussion of results, and conclusions based on the geological mapping, prospecting and geochemical soil sampling program conducted on the Box (1 - 21) mineral claims.

LOCATION AND ACCESS

The property is located about 3 miles north of the confluence of the Bonnet Plume River and Goz Creek, in the Wernecke Mountains, on the Nadaleen River map sheet (N.T.S. 106C), claim sheet 106-C-7, in the Mayo Mining District, Yukon Territory. The claims are situated approximately 80 miles northeast of the nearest all-weather road that terminates at Keno City, Yukon, and approximately 110 miles from the community of Mayo. The nearest fixed wing and helicopter base is located at Mayo. Co-ordinates of the property are; latitude 64° 25' N, longitude 132° 50' W.

Access to the property was by float plane to Rackla Lake and by helicopter from Rackla Lake to the property. A Terr-Air Bell 206B-Jet Ranger, based at the Cypress Resources camp, was utilized to ferry the crew, supplies and equipment from Rackla Lake to the base camp on the Bonnet Plume River and from the base camp to the property.

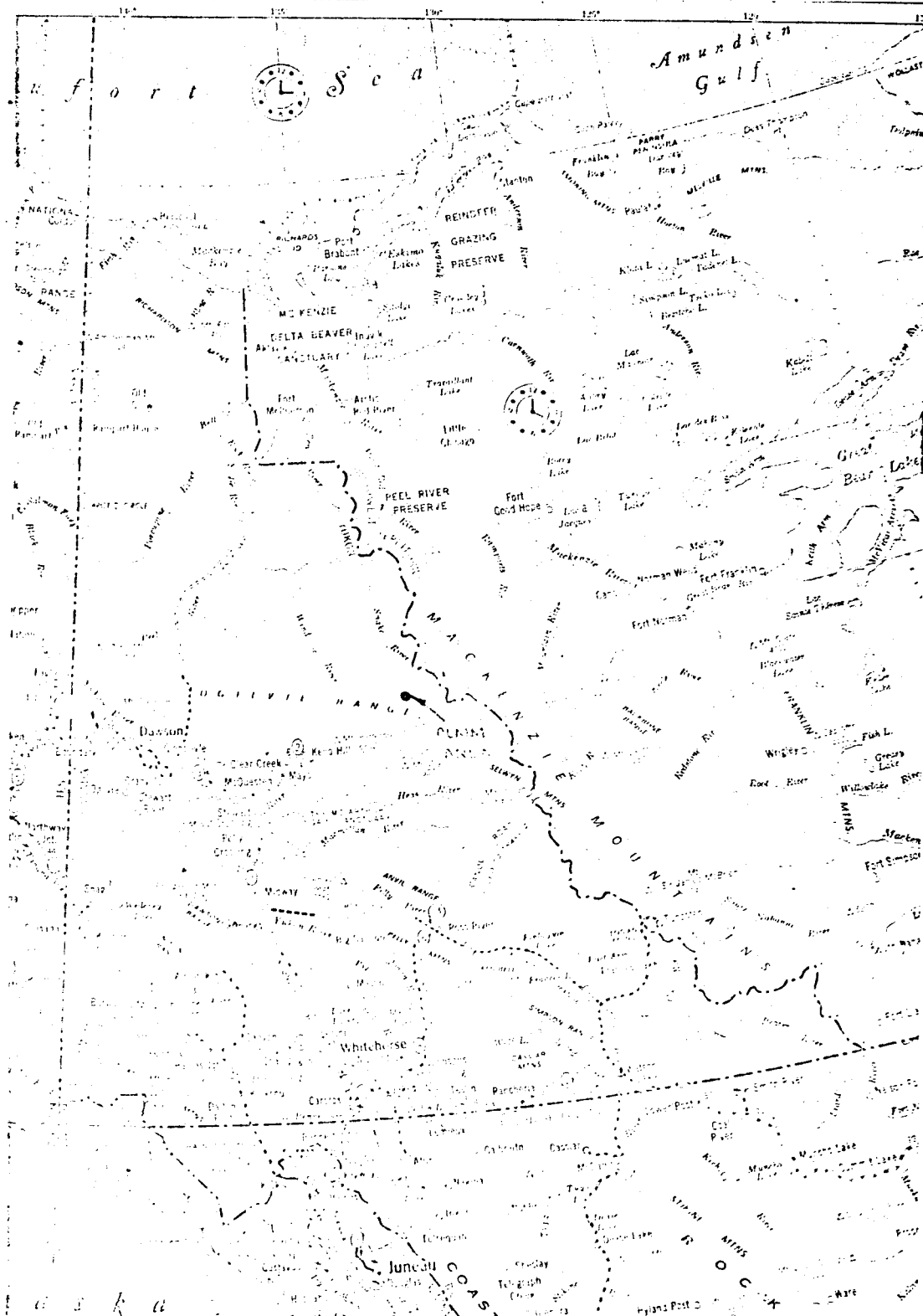

**LOCATION MAP**

Scale: 1" = 120 miles

Fig. 1

PROPERTY AND OWNERSHIP

The Box 1-21 mineral claims were staked on March 26<sup>th</sup>, 1974 and June 5<sup>th</sup> and 6<sup>th</sup>, 1974. The claims are beneficially owned by Junex Resources Ltd. of Suite 617, 837 West Hastings Street, Vancouver, B.C. The claims are located on claim sheet 106-C-7, Mayo Mining District, Yukon Territory and are more particularly described as follows:

<u>CLAIM NAME</u>	<u>RECORD NUMBER</u>	<u>DATE STAKED</u>	<u>DATE RECORDED</u>
Box # 1-8	Y88398-Y88405	March 26/74	April 18/74
Box # 9	Y88719	June 6/74	June 11/74
Box # 10-15	Y88406-Y88411	March 26/74	April 18/74
Box # 16	Y88720	June 6/74	June 11/74
Box # 17	Y88721	June 5/74	June 11/74
Box # 18-21	Y88722-Y88725	June 6/74	June 11/74

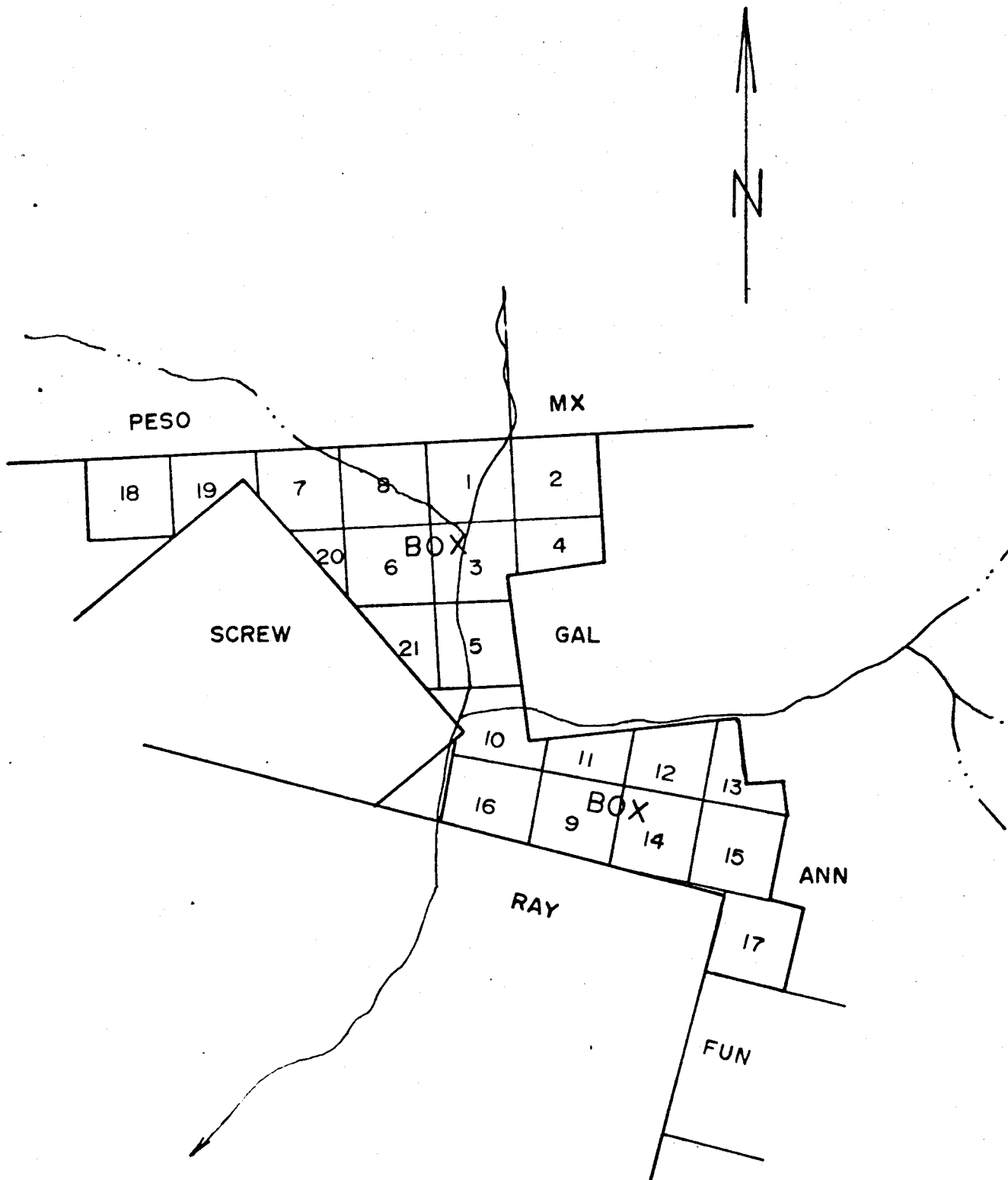

BOX CLAIMS  
CLAIM SHEET 106C-7

Scale: 1" = 1/2 mile

TOPOGRAPHY

The Wernecke Mountains, in the project area, are characterized by irregular, jagged ridges and have relief in excess of 4000 feet with some peaks exceeding 7000 feet in elevation.

The Box claims are located in the Harrison Creek (locally named) valley. The property elevations range between 2900 feet in the creek valley, to 4100 feet on the ridges. The valley is generally broad in the location of the claims and slopes are moderate.

CLIMATE AND VEGETATION

The area has a continental climate characterized by low precipitation and a wide temperature range. The winters are cold and long but the short summer is generally mild with almost continuous daylight during June and July.

The summer weather in the area is extremely variable and sudden changes from warm and sunny to cool and overcast occur. Afternoon rain showers are common particularly in areas of higher elevation, and storms with snow are common in late August and early September.

Lakes generally freeze by late October and breakup occurs during the first week of June with the highest runoff resulting in June.

Temperatures and precipitation compare generally with the Mayo area although summer days are not as warm and the total precipitation is higher. The annual mean temperature is approximately 23 degrees fahrenheit and there is a total precipitation of about 20 inches. Snow cover varies with altitude and averages between 3 feet and 4 feet.

Heavy forest growth is restricted mainly to the valley floors with sparse growth extending up to 4500 feet above sea level. Areas above 4500 feet are generally devoid of timber. The property is mainly forest covered with spruce, balsam, some alpine fir and abundant willows. Areas above 3700 feet in elevation on the property are mainly covered by moss and thick willow growth.

## HISTORY

During a 1973 regional exploration program in the Wernecke Mountains area of the Yukon Territory, Barrier Reef Resources Ltd. discovered a significant zinc occurrence in the Goz Creek - Bonnet Plume River area. The Barrier Reef discovery resulted in extensive staking and the discovery of additional zinc and lead mineralization along a belt of Paleozoic carbonate rocks extending from Duo Creek, on the southeast, to the headwaters of Corn Creek, on the northwest.

Barrier Reef discovered stratiform pyrite-lead-zinc mineralization on their Harrison Creek property that adjoins the Box claims on the south. Cypress Resources Ltd. discovered stratiform zinc mineralization with minor lead in a carbonate unit over a strike length of 22,000 feet on their claims to the west of the Box group.

The exploration activity in this district was very limited prior to 1973. No previous work had been conducted on the Box claims prior to this survey except for a chain and compass survey by the author in June, 1974.

The geology of the Goz Creek - Bonnet Plume area was sketch mapped by Dr. J.O. Wheeler of the G.S.C. in 1952. The G.S.C. recently completed a mapping program of this area in 1972 and preliminary geological maps were released in June, 1974.

GEOLOGY

GENERAL

The property is situated on the Nadaleen River and Goz Creek preliminary geological map sheets, mapped by the Geological Survey of Canada in 1972, and released on open file in June, 1974. The Goz Creek map area is underlain by thick sequences of sedimentary rocks ranging from Proterozoic to Mesozoic in age. The Goz Creek area of the Bonnet Plume Range is characterized by irregular, jagged ridges of resistive carbonate rocks and generally smoother ridges and valleys of less resistive shales. The general strike of the formation is northwesterly with an average dip of around 55° northeast and varies between 20° to 70°.

PROPERTY

Rock exposures on the Box claims are confined mainly to the Harrison Creek channel where the creek cuts through beds of carbonate and shale units. Small, isolated rock exposures of shale and limestone were located in only a few locations off the creek channel. The rocks in the Harrison Creek channel form steep sided canyon walls that cut across the east-west trending formation.

The carbonate unit is exposed in the creek canyon almost continuously from 15 North to 45 North. Discontinuous exposures of brownish weathering shale are found in the southern section of the property along the creek channel and in isolated exposures, of very limited extent, located on the smoothly eroded ridge between 40 East and 58 East of the base line.

The carbonate unit is comprised predominantly of massive, light grey to dark grey coloured limestone and limestone breccia with minor platy, calcareous shale and chert breccia. The limestone is a fine grained, grey weathering rock and is cemented by white calcite where brecciated. Fossil limestone is poorly exposed in the northwest section of the property near line 48 West.

The shale unit includes argillaceous, phyllitic, siliceous and calcareous beds and bands. The shales are grey to grey-brown coloured and weather to a brown or mottled grey-brown colour. The shales are fine grained and generally exhibit distinct bedding or fissility in thinly laminated layers.

The bedding of the limestone and shale unit generally strikes east-west and dips north between 20° to 60° with some local folding exhibited in the phyllitic shale found in the creek channel exposures.

Mineralization is absent in all units but the chert breccia exposed at 36 North on line O East. The chert is exposed in the creek bed over a thickness of approximately thirty feet with minor pyrite and rare galena mineralization found as cavity and fracture fillings with white quartz in a light to dark grey chert breccia. No visible zinc mineralization was associated with this localized pyrite-galena occurrence. The chert bed is underlain by massive limestone and limestone breccia and overlain by a platy, black coloured, calcareous shale and massive limestone breccia. The Vangeochem zinc indicator was tested on many of the rock exposures examined with no positive results indicated.

### GEOCHEMICAL SURVEY

A total of 529 soil samples and 5 silt samples were collected from the grid lines and base line during the July, 1974 geochemical survey on the Box claim group. The samples were sent to the Whitehorse Assay Office, Whitehorse, Yukon to be analyzed for lead and zinc by the hot acid extraction and atomic absorption method.

### SURVEY METHOD

An easterly trending base line, bearing  $105^{\circ}$ , was established along the Box 10 - 15 claim location line between Harrison Creek and the eastern Boundary of the property. The base line was chained at 100 foot intervals and stations marked by grid co-ordinates on flagging. Chain and compass grid lines were turned off the base line at right angles at intervals of 400 feet and the lines were extended to the north and south boundaries of the property. Compass bearings of  $15^{\circ}$  North and  $195^{\circ}$  South were used on the southeast grid lines and North-South bearings for the lines located in the north central section. Lines OE to 64E were sampled at 100 foot intervals south of the base line. Line 8E was sampled at 100 foot intervals north of the base line with the balance of the grid lines sampled at 200 foot intervals north of the base line.

The property is extensively covered by moderate to heavy overburden consisting of moss, soil, glacial deposits, regolith and some talus.

The soil is generally of the skeletal or azonal

variety consisting of a moss layer, underlain by the "A" horizon composed of a black, organic rich layer, the "B" horizon is usually absent or occurs as a poorly developed thin brownish sandy-clay layer, the "C" horizon consists of a light coloured sandy-clay material that commonly contains abundant rock fragments. Poorly drained areas of the property usually contained organic layers in excess of one to two feet in thickness.

Most samples were taken from the "C" horizon at depths of 6 inches to 18 inches below the moss surface. Samples from poorly drained areas or swampy ground usually consisted of organic material from the "A" horizon. Mattocks were used to collect the samples and the soil was placed in water resistant Kraft bags and labeled by grid co-ordinates.

The samples were dried and sieved to a minus 80 mesh and a one gram sample of the minus 80 mesh fraction was digested in hot nitric acid and potassium perchloric acid bath. The digested sample was bulked to 20 c.c. and analysis made for lead and zinc by the atomic absorption method with readings reported in parts per million.

#### DISCUSSION OF RESULTS

The lead and zinc values were reported in parts per million and are plotted on the plan map accompanying this report. The median values for the lead and zinc were calculated by arithmetic means. Lead values ranged between 4 ppm. and 105 ppm. with a calculated median value of 22 ppm. Zinc values ranged from a low of 16 ppm. to a high of 1536 ppm. with a calculated median value of 140 ppm.

The lead values are generally low over the survey area and no distinct anomalous zones were indicated by the results of the soil sampling. Lead values have a background range fairly consistent with soils derived from sedimentary rocks containing average amounts of this element. Isolated spot highs are randomly distributed over the survey area and are not considered significant due to their singular occurrence, relatively low contrast and absence of zoning.

Zinc values are distributed over a broad background range with 25 samples exceeding the tentative threshold value of 500 ppm. An anomalous east-west trending zone (Zone # 1) occurs on lines 4W, 8W and 12W at 32 North, situated on the west side of Harrison Creek. A moderately anomalous zone (Zone # 2) occurs in the southeast section of the property and trends east-northeast. Both anomalous zones are extensively overburden covered.

CONCLUSIONS AND RECOMMENDATIONS

From the limited rock exposures and results of the geochemical survey the property does not appear to host mineralization of economic importance. Pyrite and galena mineralization in the chert breccia are minor constituents of the small quartz filled cavities and fractures. The shale and limestone units are poorly exposed over most of the property. The Harrison Creek canyon offers fairly continuous cross section exposure of the bedrock geology and infers that the property is predominately underlain by shales in the southeast section and limestone in the northeast section.

The moderately anomalous zinc zones are not considered to be strongly significant and are possibly derived from sedimentary beds carrying higher than average trace amounts of zinc.

No further work is recommended on the property at this time.

Respectfully submitted



D.H. Waugh

D.H. WAUGH & ASSOCIATES LTD.

July, 1974

LIST OF PERSONNEL EMPLOYED ON SURVEY

The following is a list of personnel employed on the geological and geochemical survey conducted on the Box 1 - 21 group of mineral claims, map sheet 106-C-7, Yukon Territory, during the period July 7<sup>th</sup> to 16<sup>th</sup>, 1974.

D:H. WAUGH 84 Teslin Road Whitehorse, Y.T.	-----	Project supervision, geological mapping, sampling & report prep.
M. CALLAGHAN 13 Aishihik Road Whitehorse, Y.T.	-----	Prospecting & sampling
TERRITORIAL AIRWAYS LTD. Ross River, Y.T.	-----	Fixed & Rotary wing aircraft charter service
WHITEHORSE ASSAY OFFICE Whitehorse, Y.T.	-----	Analytical service
D.H. WAUGH & ASSOC. LTD. Rm. 10, Airport Terminal Whitehorse, Y.T.	-----	Project management, equipment rental & camp maintenance, report preparation.

STATEMENT OF EXPENDITURES

LABOUR

GEOLOGIST - 11 man days @ \$100.00/day	\$1,100.00	
PROSPECTOR/SOIL SAMPLER -		
11 man days @ \$ 60.00/day	<u>660.00</u>	
	\$1,760.00	\$1,760.00

TRANSPORTATION

ROTARY WING - 4.0 hours @ \$330.00/hr.		
Fuel and crew expenses incl.	\$1,320.00	
FIXED WING - Beaver and Husky trips		
Rackla Lake to Mayo, Return	499.20	
HIGHWAY - Company truck rental	<u>150.00</u>	
	\$1,969.20	1,969.20

ASSAYING

594 soil samples @ \$1.50/sample		891.00
----------------------------------	--	--------

FIELD SUPPORT

CAMP MAINTENANCE -		
22 man days @ \$15.00/day	\$ 330.00	
EQUIPMENT RENTAL -		
11 days @ \$15.00/day	165.00	
EXPEDITING SERVICES -	<u>100.00</u>	
	\$ 595.00	595.00

DATA PREPARATION, DRAFTING, REPORT

Geologists report		<u>500.00</u>
-------------------	--	---------------

TOTAL EXPENDITURES		\$5,715.20
--------------------	--	------------

AFFIDAVIT

I, DAVID H. WAUGH, of D.H. Waugh & Associates Ltd. of Room 10, Airport Terminal Building, Whitehorse, Yukon Territory make oath and state:

1. That I personally supervised the geological and geochemical survey conducted by D.H. Waugh & Associates Ltd. on behalf of JUNEX RESOURCES LTD., 617 - 837 West Hastings Street, Vancouver, B.C. on the Box 1 - 21 mineral claims during the period July 7<sup>th</sup> to 16<sup>th</sup>, 1974.
2. That the expenditures incurred on the said survey, as outlined on the statement of expenditures herewith attached, are, to the best of my belief and knowledge, true and exact.

Sworn and subscribed before me  
at WHITEHORSE in the  
YUKON TERRITORY this  
20th day of AUGUST, 1974.

  
DAVID H. WAUGH

\_\_\_\_\_  
NOTARY PUBLIC

CERTIFICATION

I, DAVID H. WAUGH, of residential address 24 Teslin Road, in the city of Whitehorse, Yukon Territory, do hereby state:

1. I am a self employed geologist and president of D.H. WAUGH & ASSOCIATES LTD., with business address Room 10, Airport Terminal Building, Whitehorse, Yukon Territory.
2. I was educated in the geological sciences at Michigan College of Mining and Technology.
3. I have practised my profession as a geologist in the field of mining exploration and development for the past 9 years.
4. The information in this report represents the findings of the survey conducted under my direction on the Box 1 - 21 mineral claims during the period July 7<sup>th</sup> to July 16<sup>th</sup>, 1974.

Dated at WHITEHORSE in the YUKON TERRITORY  
this 20th day of AUGUST, 1974.

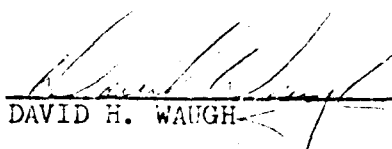
  
\_\_\_\_\_  
DAVID H. WAUGH

# ATLED EXPLORATION MANAGEMENT LTD.

420 - 475 HOWE STREET • VANCOUVER, B.C. V6C 2B3  
TELEPHONE 688-0471

## TO WHOM IT MAY CONCERN

Re: Junex Resources Ltd.  
Box Claim Group  
Mayo Mining District - Yukon Territory  
Claim Sheet 106 - C - 7

I, Gordon C. Guttrath, hereby certify that Mr. D. H. Waugh has completed the Geological and Geochemical surveys on the Box Claim Group as recommended in my report of June, 1974, and that the work has been done in a satisfactory manner.

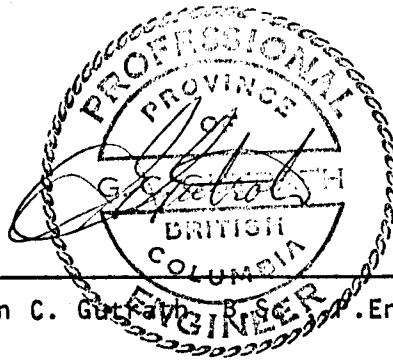

---

Gordon C. Guttrath, Eng., Geologist

WHITEHORSE ASSAY OFFICE  
 BOX 4518  
 WHITEHORSE, YUKON



Samples from: D. Waugh & Associates

Lot. No.: A-653-672

	Pb	Zn		Pb	Zn	
BL-2E	28	96		BL-50E	20	128
3E	24	96		51E	20	128
4E	16	112		52E	16	136
6E	16	80		53E	16	112
7E	16	88		54E	20	96
8E	28	96		55E	16	72
9E	28	88		56E	20	128
10E	16	104		57E	20	72
11E	20	152		58E	36	168
12E	24	96		59E	24	96
13E	24	96		60E	18	96
17E	36	144		61E	20	72
18E	24	96		62E	24	160
19E	12	64		63E	24	136
20E	12	104		64E	28	152
21E	12	104				
22E	16	96		4E-2N	32	96
24E	24	88		4N	16	64
25E	24	144		6N	16	88
26E	24	112		8N	32	112
27E	20	96		10N	28	80
28E	24	112		12N	20	80
29E	20	104		14N	20	88
30E	20	104		16N	24	128
31E	20	104		18N	32	80
32E	16	88		20N	24	64
36E	20	120		22N	20	80
37E	20	112		24N	28	96
38E	24	144		26N	28	136
39E	20	112		28N	24	88
40E	28	152		30N	20	88
41E	20	40		32N	20	88
42E	24	80		34N <sup>#1</sup>	24	120
43E	28	120		34N <sup>#2</sup>	20	112
44E	28	152		38N	20	112
45E	20	96		40N	20	104
46E	20	104		42N	16	88
47E	16	64		44N	16	136
48E	16	112		46N	20	104
49E	24	152		50N	20	88

BL-23E 8 72  
 BL-5E 20 48

ORGANIC - 0

Date: July 24, 1974

Assayer: H. Hayward

WHITE ASSAY OFFICE  
 BOX 346  
 WHITEHORSE, YUKON

Samples from: D. WAUGH + ASSOCIATES

Lot. No.: A-653-672

	Pb	Zn		Pb	Zn
4E-15	60	104	8E-5N	20	88
2S	28	104	6N	20	56
3-S#1	36	152	7N	16	56
3-S#2	24	88	8N	20	64
4-S	24	96	9N	32	128
5-S	20	160	10N	32	112
6-S	16	168	11N	24	88
7-S	20	376	12N	28	80
8-S	20	320	13N	56	176
9-S	20	120	14N	20	72
10-S	24	104	15N	28	120
11-S	32	152	16N	No SAMPLE.	
12-S	28	224	17N	20	72
13-S	36	208	18N	20	64
14-S	24	192	19N	12	48
			20N	28	88
4E-48E	20	104	21N	16	72
4E-52E	20	96	22N	20	88
4E-54E	20	96	23N	20	104
			24N	24	88
4-W-20N	64	576	25N	12	80
22N	24	296	26N	28	72
24N	24	120	27N	20	152
26N	24	200	28N	28	88
28N	8	152	29N	24	88
30N	12	400	30N	28	96
32N	24	1248	31N	20	72
34N	32	1088	32N	24	96
36N	20	496	34N	16	40
38N	20	480	35N	16	48
40N#1	22	720	36N	16	104
40N#2	20	912	37N	16	80
42	12	120	38N	20	104
44	12	104	39N	20	80
46	12	112	40N	16	88
L8E-53N	20	120	41N	16	88
L8E-54N	8	80	42N	16	96
8E-1-N	24	112	43N	12	88
2-N	20	96	44N	20	88
3-N	28	104	45N	<del>20</del> 16	104
4-N	12	80			
4W-57N	8	80	L8E-33N	12	64

#5 ON BAGS

Date: July 24, 1914

Assayer: H. Hayland

HORSE  
 WHITE ASSAY OFFICE  
 BOX 346  
 WHITEHORSE, YUKON

Samples from: D. WAUGH & ASSOCIATES

Lot. No.: A-653-672

	Pb	Zn		Pb	Zn
8E-46N	16	96	12-E-15	32	176
47N	16	80	2S	28	220
48N	16	80	4S	20	80
49N	20	96	5S	20	72
50N	16	96	6-S	24	296
51N	16	88	7-S	24	88
52N	20	120	8-S	20	64
			9-S	24	120
8W-16N	14	96	10-S	24	128
18N	20	88	11-S	20	88
20N	20	88	13-S	24	96
22N	16	96	14-S	20	104
24N	12	104	12E-12W	20	88
26N	8	184	12W-18N	8	120
28N	12	96	20N	8	448
30N	16	112	22N	22	196
32N	24	1216	24N	20	296
34N	16	80	26N	28	168
36N	16	272	28N	108	864
38N	12	240	30N	56	800
40N	12	800	34N	20	1536
42N	12	240	36N	16	72
44N	8	528	38N	16	176
46N	12	80	40N	12	168
48N	12	72	42N	16	712
			44N	20	88
9E-1-S	16	72	46N	16	112
2-S	20	120	12W-32N	36	1312
3-S	20	88	16E-2-S	28	96
4-S	44	128	3-S	28	104
5-S	20	88	4-S	28	104
6-S	24	168	5-S	28	104
7-S	28	264	6-S	28	88
8-S	28	152	7-S	28	96
9-S	12	24	8-S	36	136
10-S	28	144	9-S	24	104
11-S	44	232	10-S	24	88
12-S	20	176	11-S	28	104
13-S	20	160	12-S	20	72
14-S	20	88	13-S	20	120

BAG NO.

Date: July 24, 1974

Assayer: A. Hoyland

WHITEHORSE ASSAY OFFICE  
 BOX 346  
 WHITEHORSE, YUKON

Samples from: D. WAUGH ASSOCIATES

Lot. No.: A-653-672

	Pb	Zn		Pb	Zn	
16E-14-S	16	112		20E-14S	24	144
16E-2N	16	80				
4N	28	120		24E-2N	24	128
5N	32	80		4N	24	120
16E-24N <sup>#1</sup>	20	120		6N	16	96
24N <sup>#2</sup>	16	128				
26N	16	120		24E-1-S	24	136
28N	20	128		2-S	16	80
30N	20	144		3-S	32	128
32N	20	120		4-S	24	96
34N	20	112		5-S	24	104
36N	16	112		6-S	24	128
38N	16	128		7-S	16	96
40N	16	128		8-S	16	112
42N	20	112		9-S	16	112
44N	20	120		10-S	16	64
46N	20	136		11-S	20	104
48N	18	136		12-S	8	56
50N	20	128		13-S	20	120
52N	20	128		14-S	16	96
54N	20	128				
				28E-2N	16	104
20E-2N	24	96		4N	16	96
4N	16	88		6N	16	104
6N	12	96		8N	32	128
				10N	20	80
20E-1-S	16	104				
2-S	20	96		28E-1-S	12	112
3-S	20	80		2-S	22	104
4-S	16	72		3-S	32	120
5-S	12	64		4-S	16	96
6-S	20	120		5-S	16	104
7-S	16	104		6-S	12	72
8-S	16	112		7-S	16	104
9-S	24	136		8-S	20	112
10-S	24	152		9-S	16	104
11-S	16	104		10-S	14	108
12-S	20	104		11-S	16	88
13-S	24	96		12-S	12	64

Date: July 24, 1974.

Assayer: K. Heyland

WHITEHORSE ASSAY OFFICE  
 BOX 346  
 WHITEHORSE, YUKON

Samples from: D. WAUGH & ASSOCIATES

Lot. No.: A-653-672

	Pb	Zn		Pb	Zn.	
28E-13-S	12	96		36E-6-S	22	104
14-S	16	96		7-S	12	80
				8-S	20	120
				9-S	16	96
32E-2N	16	72		10-S	12	64
4N	16	112		11-S	16	88
6N	20	160		12-S	20	96
8N	16	136		13-S	24	96
10N	16	120		14-S	12	48
32E-1-S	16	112		OE-42N	20	720
2-S	24	96		44N	16	208
3-S	24	112		46N	16	200
4-S	20	88		48N	20	68
5-S	20	112				
6-S	20	88				
7-S	20	88		12E-2N	24	96
8-S	16	104		4N	4	16
9-S	24	104		5N	24	152
10-S	20	104				
11-S	20	96		12E-24N	24	128
12-S	28	96		26N	20	136
13-S	28	96		28N	20	152
14-S	20	72		30N	16	144
				32N	16	120
36E-2N	28	144		34N	16	112
4N	20	136		36N	16	96
6N	20	104		38N	16	104
8N	20	112		40N	16	88
36E-10N	20	128		42N	16	88
12N	20	144		44N	16	88
				46N	12	88
				48N	16	96
				50N	16	80
36E-1-S	20	64		52N	12	104
2-S	20	112		54N	12	96
3-S	20	88				
4-S	16	112				
5-S	16	80				

Date: July 24, 1914

Assayer: K. Hayward



WHITEHORSE ASSAY OFFICE  
 BOX 4518  
 WHITEHORSE, YUKON

Samples from: D. WAUGH & ASSOCIATES

Lot. No.: A-653-672

SAMPLE #	Pb	Zn	SAMPLE #	All Results P.P.M.	
				Pb	Zn
L40E-2N	28	136	L44E-11S	20	96
4N	28	152	12S	20	128
6N	28	112	13S	16	152
" 8N	20	104	L44E-14S	16	104
10N	16	128			
12N	12	144			
13N	12	112			
L40E-14N	16	128			
L40E-15	20	128			
2S	32	120			
3S	20	88			
4S	16	104			
5S	16	96			
6S	16	104			
7S	16	112			
" 8S	12	88			
9S	16	96			
10S	12	80			
11S	12	96			
12S	16	120			
13S	16	120			
L40E-14S	8	64			
L44E-2N	8	112			
4N	16	72			
6N	16	96			
8N	16	96			
10N	16	112			
L44E-12N	12	128			
L44E-15	24	96			
2S	20	120			
3S	16	160			
4S	12	104			
5S	32	104			
6S	24	104			
7S	32	160			
8S	24	120			
9S	24	96			
L44E-10S	20	128			

Date: July 24, 1974

Assayer: K. Hayward

WHITEHORSE ASSAY OFFICE  
 BOX 4518  
 WHITEHORSE, YUKON

Samples from: D. WAUGH & ASSOCIATES

Lot. No.: A-653-672

SAMPLE #	Pb	Zn	SAMPLE #	Pb	Zn
L52E-1N	24	104	L56E-19S	32	480
2N	24	120	20S	12	248
3N	20	96	21S	12	304
L52E-4N	24	104	22S	10	196
L52E-1S	20	120	23S	40	296
2S	28	176	L56E-24S	44	624
3S	34	144	25S	40	512
4S	36	152	28S	28	296
5S	24	120	29S	24	176
6S	28	152	30S	16	176
L52E-7S	16	152	L56E-31S	20	224
8S	32	120	32S	16	240
9S	28	160	33S	28	352
10S	28	128	L56E-34S	28	392
11S	28	200	L56E-26S	32	368
12S	28	176	L56E-27S	24	240
13S	64	152	L60E-1N	44	112
L52E-14S	32	352	2N	32	200
L56E-1N	24	96	3N	24	112
" 2N	36	176	L60E-4N	36	176
" 3N	24	88	L60E-1S	24	144
L56E-4N	28	96	2S	20	104
L56E-2S	20	64	3S	20	120
3S	16	88	4S	20	104
4S	14	76	5S	20	256
5S	24	112	6S	32	240
6S	20	164	7S	16	96
7S	20	192	8S	16	208
L56E-8S	28	208	9S	20	136
9S	16	176	10S	20	224
10S	28	216	L60E-11S	24	184
12S	56	416	12S	16	96
13S	20	208	13S	16	168
L56E-14S	36	224	14S	16	200
15S	24	200	15S	20	360
16S	52	448	16S	24	448
17S	28	240	17S	32	864
L56E-18S	28	376	18S	48	624
			19S	44	688
			L60E-20S	56	560

Date:

July 24, 1974.

Assayer:

K. Hogland

WHITEHORSE ASSAY OFFICE  
 BOX 3 ~~4518~~  
 WHITEHORSE, YUKON

Samples from: D. WAUGH + ASSOCIATES

Lot. No.: A-653-672

SAMPLE #	Pb	Zn		SAMPLE #	Pb	Zn	
L60E-21S	44	496		L64E-26S	20	304	
22S	56	512		27S	32	480	
23S	44	512		28S	16	128	0
24S	48	496		29S	24	312	
25S	36	336		30S	24	288	
26S	36	280		31S	32	312	
27S	36	232		32S	34	388	
28S	32	120		33S	20	152	
29S	20	120		L64E-34S	64	544	
30S	18	184					
31S	28	272		#'s ON ORIGINAL BAG:			
32S	20	152		L4E-48E			} DONG
33S	20	136		L4E-52E			
L60E-34S	24	232		L4E-54E			
L64E-1S	84	136		L48N-2W	28	88	
2S	28	168		L48N-4W	24	96	
3S	40	136					
4S	20	152					
5S	28	152					
L64E-6S	24	240					
7S	32	336					
8S	36	280					
9S	20	160					
10S	20	104					
11S	32	288					
12S	32	256					
13S	16	120					
14S	32	296					
15S	68	688					
L64E-16S	32	248					
17S	28	224					
18S	52	464					
19S	36	320					
20S	44	320					
21S	44	336					
22S	32	256					
23S	32	280					
24S	28	240					
L64E-25S	28	368					

Date: July 24, 1974

Assayer: K. Heyland

48W

12W 8W 4W OW 4E 8E 12E 16E

55N

50N

45N

40N

35N

30N

25N

20N

15N

10N

5N

0

5S

10S

15S

20S

25S

30S

35S

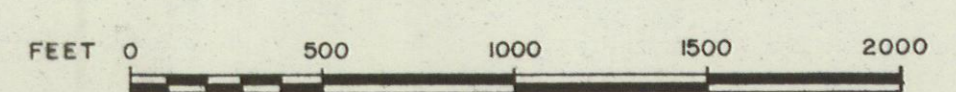
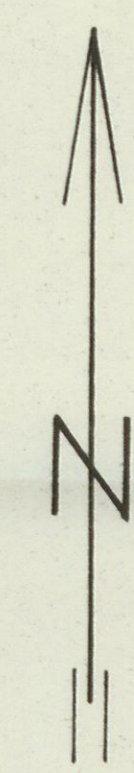

SCALE: 1 inch = 500 feet

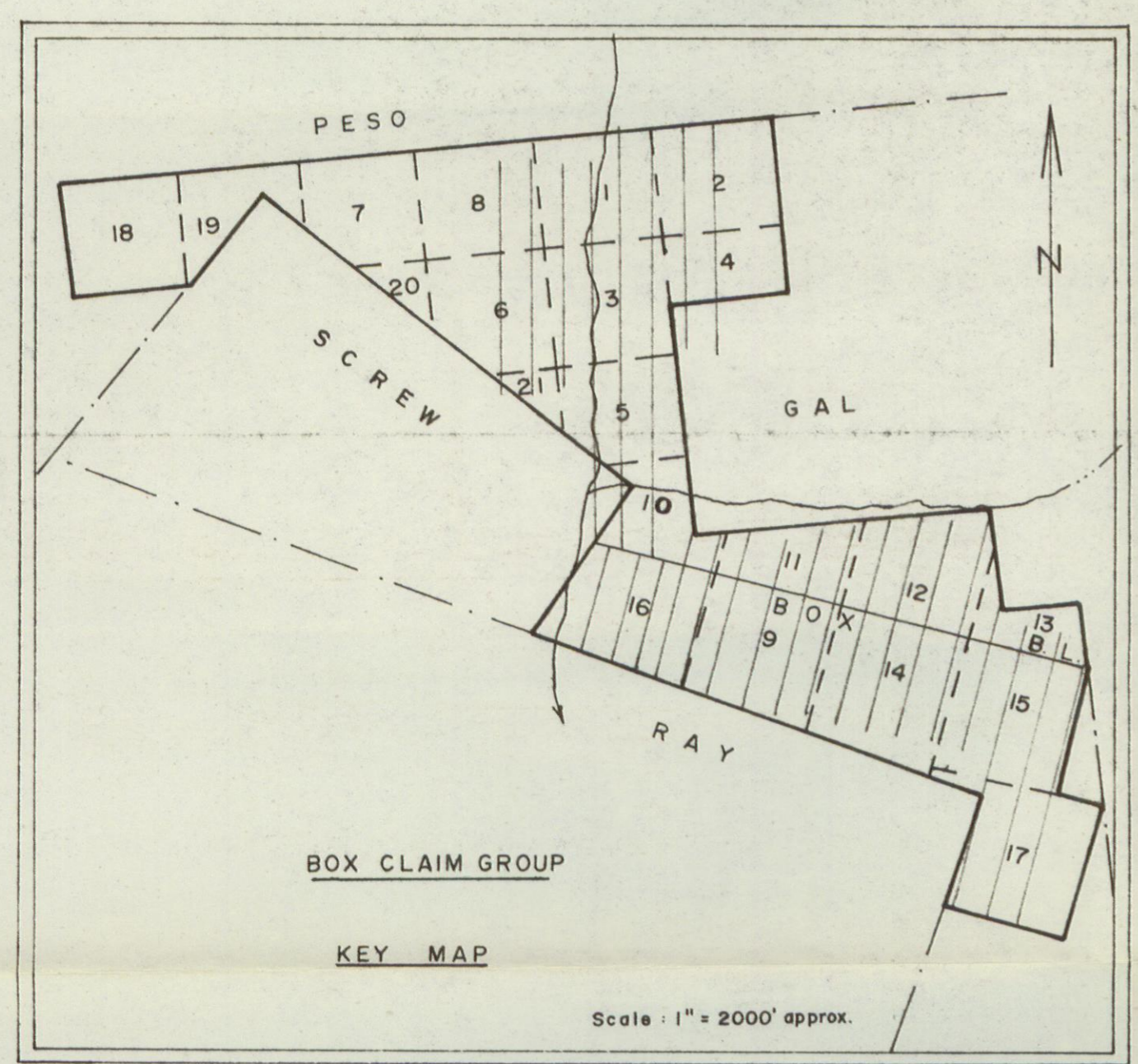

Scale: 1" = 2000' approx.

**LEGEND**

$\frac{24}{128}$   $\frac{Pb}{Zn}$  Lead and zinc values in parts per million

$\frac{24}{128}$   $\frac{Pb}{Zn}$  Silt sample location

Ax Location of outcrop

--- Geological contact

46° Strike and dip of formation

500 Zilic contours (500ppm Interval)

**GEOLOGY**

A Shale

B Limestone

C Calcareous shale

D Chert

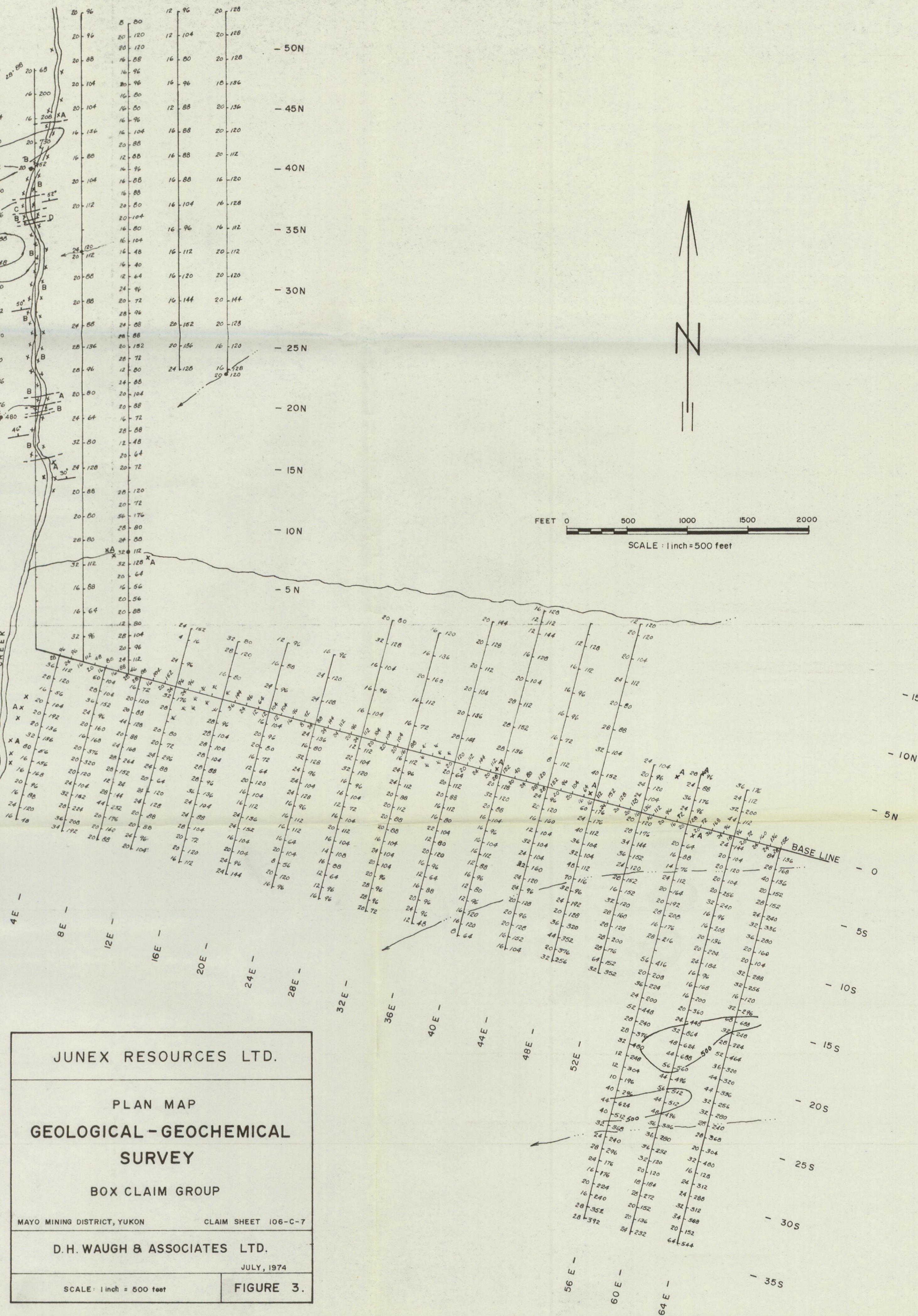

JUNEX RESOURCES LTD.

PLAN MAP

GEOLOGICAL - GEOCHEMICAL SURVEY

BOX CLAIM GROUP

MAYO MINING DISTRICT, YUKON CLAIM SHEET 106-C-7

D.H. WAUGH & ASSOCIATES LTD.

JULY, 1974

SCALE: 1 inch = 500 feet

FIGURE 3.