

This is ELC Geophysics Ltd. Report No. 75-501
Geophysical and Geochemical Surveys
ELC - SUZANNE Claims Group.
Yukon Territory area, about 124 miles North of Watson Lake.
For Dual Resources Ltd. (NPL)
July 1, 1974 to January 1975.

	<u>TABLE OF CONTENTS</u>	<u>PAGE</u>
Purpose:		1
Location:		1
Presentation:		1
Instrumentation:		2
Personnel:		2
ELC Claim Group:		3
Summary:		4
Suzanne Claims Group:		4
Summary:		5
Conclusions:		5
Suzanne Claims Area:		5
Certificate		6

PLANS

Location Plan 75-501-L

Claims and Geochem Plans ELC 75-501-GC-A
SUZANNE 75-501-GC-B

Mag and Anomalies Plans ELC 75-501-A
Suzanne 75-501-A-B

ELC GEOPHYSICS LTD.
250 N. Grosvenor Ave.
Burnaby 2, B.C.

298-9619

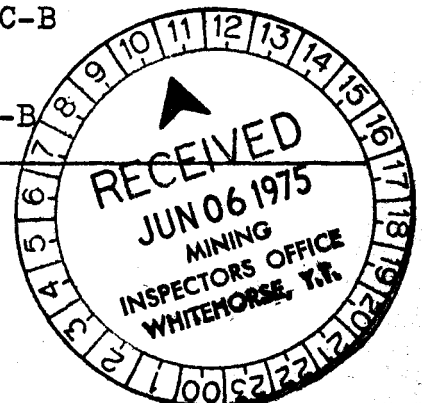

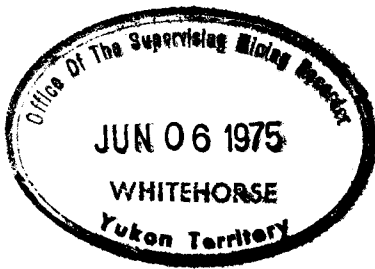

This report has been examined by the Geological Evaluation Unit and is recommended to the Commissioner to be considered as representation work to the amount of

~~\$14,889.47~~

A handwritten signature in cursive script, appearing to read "D. R. Craig".

~~Resident Geologist or
Resident Mining Engineer~~

Considered as representation work under Section 53 (4) Yukon Quartz Mining Act.

A handwritten signature in cursive script, appearing to read "B. R. Baxter".

B. R. BAXTER
Supervising Mining Recorder

~~for~~ Commissioner of Yukon Territory

ELC GEOPHYSICS LTD. REPORT NO. 75-501 COVERING GEOPHYSICAL AND GEOCHEMICAL SURVEYS FOR DUAL RESOURCES LTD. (N.P.L.) OVER THE ELC AND SUZANNE CLAIMS GROUP WATSON LAKE MINING DIV. YUKON TERRITORY. LONG. 128°45' W - LAT. 61°13' N. JULY 1, 1974 to JANUARY 1975.

Purpose:

These surveys were recommended as an extension of previous surface investigations of the area. The ELC claims cover the area previously reported as the ACE claims by A.F. Roberts, June 22, 1973, wherein he recommends this survey to extend the surface investigation.

This work includes the Suzanne claims reported upon by A.F. Roberts, May 6, 1974, recommending geophysical and geochemical survey work.

Location:

The ELC Suzanne claims are approximately 7 miles apart and are 10 and 17 miles respectively West of Mile 47 on the Cantung Highway or about 124 miles North of Watson Lake, Y.T. See enclosed location map 75-501-L.

Presentation:

The claims, survey grid layout, stations and co-ordinates are shown on ELC plans 75-501-A, 75-501-GC-A Suzanne 75-501-A-B, 75-501-GC-B.

The geochemical plan (GC) shows the values found at each station in parts per million of Lead, Zinc, and Silver, taken from the B. horizon.

The magnetometer results are shown in profile form along the grid lines and sealed as indicated on the plans.

The geochemical anomalies are in contour form on the anomalies plans, and the magnetometer anomalies are shown in linear form.

Instrumentation:

Magnetometer:

The magnetometer survey was conducted with a vertical field fluxgate self levelling magnetometer, model M110 manufactured by Sabre Electronics of Vancouver, B.C.

Geochemical soil determinations were taken from the B. horizon, by first removing the overlying debris, then digging a hole with a round mouthed spade to an approximate depth of 15 inches below the surface. A sample from the bottom of the hole was packaged in a standard Kraft soil bag supplied by Acme Analytical Labs., Ltd., Burnaby, B.C.

Personnel:

K. Pettersen
Fred Pelkey
John Krysveld.

EIC Claim Group:

A series of linear contours are first shown for areas having a continuity of values in excess of 200 PPM of Zinc, 100 PPM of Lead and .5PPM of Silver.

The second contour value signifies the values exceeding these values by 3.X. or more.

The third contour is for values in excess of 10X the first contours. Refer to enclosed EIC plan 75-501-A.

The background mean values are approximately

- Pb. 35 PPM.

-Zn. 100 PPM.

-AG. .15 PPM.

The values are less in the swamp areas to the east.

The anomalies are indicated by the letters GC followed by a number for each area.

GC-1 shows a N.E.-S.W. trend associated with L2 linear anomaly, GC-2 strikes N.W.-S.E. with a small contour to the N.E. and follows the Northwest end of the magnetometer linear anomaly L-4. Two additional geochem anomalies GC-2A and GC-3A are also on the linear L-4. The GC-3 anomaly on lines 32&00 W. and 36&00W maybe associated with GC-2A.

The central North area has a large anomaly GC-4, open to the North. There appears to be an association with GC-4A along the Mag linear L-7.

The geochem anomalies GC-5 - GC-6 extend from the GC-4 - L-7 trend to the East and parallel the drainage pattern to the Northeast.

The small but strong anomaly GC-7 on the line 44 & 00 East is open to the East.

The GC-8 anomaly extends from lines 52 & 00W to 64 & 00W and is South and parallel to the creek within 250 ft. GC-9 is an East-West narrow anomaly from lines 48 & 00W to 56 & 00W.

The GC-10 anomaly is small but strong and crosses lines 16 & 00E and 20 & 00E on the East side of the swamp.

Summary: (ELC Claims)

The geochemical anomalies follow the map linears L-2 -L-4 - L-7 to the North and are South of the linear L-1. The convergence of L-1 - L-2 with L-4 - L-7 would appear to have good anomalous possibilities and probably prove to be an extension of GC-1 - GC-2 and GC-4 anomalies.

Suzanne Claims Group:

There are only two unrelated geochem anomalies between 8 & 00 S. and 16 & 00 S. The GC-1 - B high is on the base line and is strong, extending over several hundred feet in a Northwesterly strike.

The small but definite anomaly GC-2 - B seems unrelated on the East end of line 14 & 00 S.

The cluster of weak magnetometer anomalies L-1 - B, - L-2 - B, - L-3 - B, L-4 -B and L-5 - B suggest a fracture zone in association with the geochem anomaly GC-1 - B.

Summary: (Suzanne Anomalies)

The stronger Mag anomalies in the Northeast area of the claims are not supported by significant enrichment.

The weak Mag anomaly L-4 - B strikes along the GC-1 - B enrichment to line 10 & 00 S. to 4 & 00 W. No determinations were taken on the West end stations of line 6 & 00 S. due to the absence of soil coverage.

Conclusions:

The ELC area of interest warranting surface investigation is bound on the South by geochem anomalies GC-1, - GC-2, and GC-4 - Work to the North of these anomalies is warranted.

Suzanne Claims Area:

The GC-1 - B geochem anomaly may be indicative of a mineralized shear zone to the Northwest. Surface work is warranted in the light coverage.

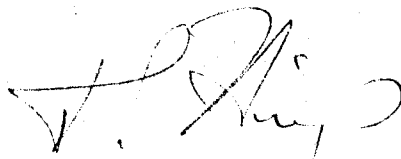

D.C. Hings, P. Eng.
Geophysicist

A statement of Costs for ELC Geophysics Ltd.
Report No. 75-501
ELC and Suzanne Claims Group
Yukon Territory Area
For Dual Resources Ltd.
July 1, 1974 to January 1975.

Field Crew

K. Pettersen	2 months @ 1800.00	3600.00
F. Felkey	2 months @ 1000.00	2000.00
J. Krygsveld	1 month @ 1000.00	<u>1000.00</u>

\$ 6600.00

Transportation

Air Fares	181.00	181.00
4 X 4 Truck	60 days @ 14.00	840.00
4000 miles @ 12¢		480.00
Gas and Expenses		299.27
Helicopter		<u>943.35</u>

\$ 2743.62

Camp & Living Costs

Motel		372.25
150 Man Days @ 8.00		1200.00
Camp supplies	150 days @ 10.00	<u>1500.00</u>

\$ 3072.25

Instruments & Equipment

Magnetometer	60 days @ 10.00	600.00
Misc. Supplies	60 days @ 5.00	<u>300.00</u>

\$ 900.00

Plotting & Drafting

D. Cramer	10 days @ 60.	<u>600.00</u>
-----------	---------------	---------------

\$ 600.00

Report & Interpretation

D.L. Hings	7 days @ 125.00	875.00
C. Bowman	3 days @ 30.00	<u>90.00</u>

\$ 965.00

(N.E.) Geochem Determination. Paid by Dual Res.

TOTAL

14,880.87

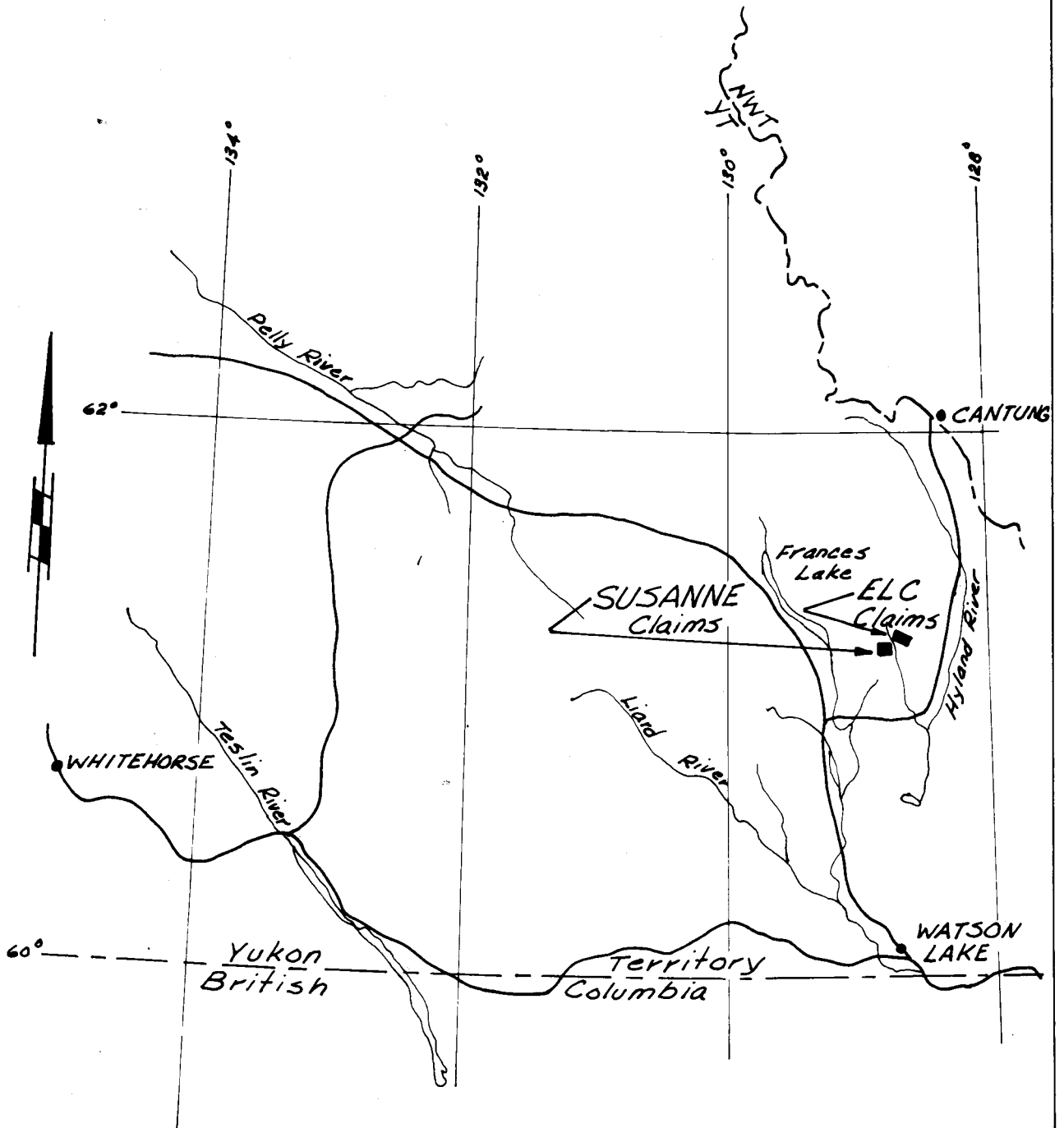

Location Map

Scale :- 1" = 40 miles

dwg. no. :- 75-501-L

V. P. King

C E R T I F I C A T E

This is to certify that:

1. I, DONALD LEWIS HINGS am a resident of Burnaby, B.C., and live at 250 N. Grosvenor Avenue.
2. I am a member of the Professional Engineers of British Columbia and Ontario and a registered Professional Geophysicist of Alberta.
3. I have practised my profession since November 1938 in British Columbia.
4. I have not received any interest or expect to receive any interest, directly or indirectly, in the property of DUAL RESOURCES LTD, ELC AND SUSANNE GROUPS, or benefit by ownership directly or indirectly of the company securities or any affiliate.
5. This report is based on information received from field survey notes and geochem analysis from E.L.C. Geophysics Ltd.



D. L. HINGS, P. Eng.
Geophysicist.

BURNABY, B.C.

MARCH 27th, 1975

16+00W 12+00W 8+00W 4+00W 0+00 4+00E 8+00E 12+00E 16+00E 20+00E 24+00E 28+00E

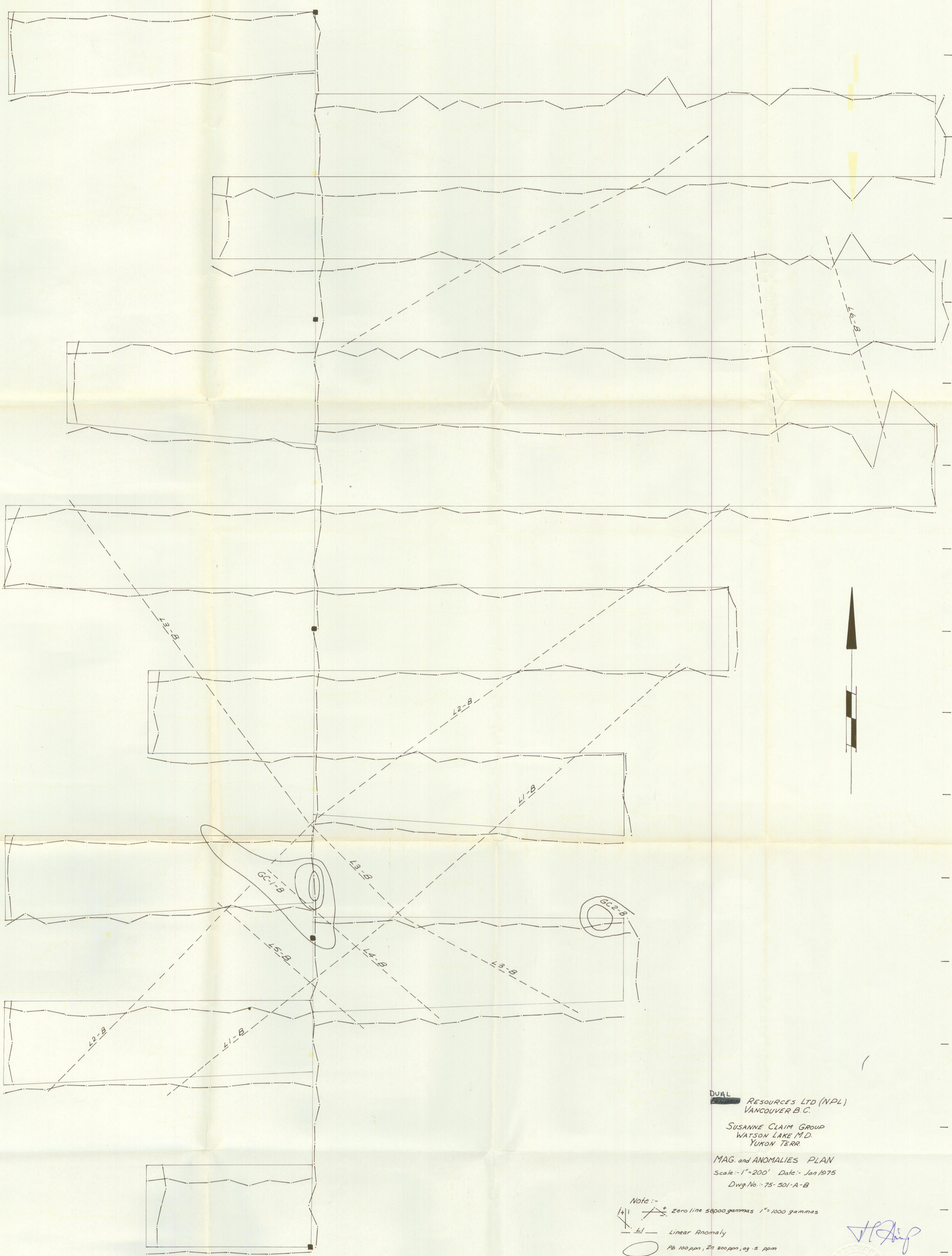
28+00N
24+00N
20+00N
16+00N
12+00N
8+00N
4+00N
0+00
4+00S
8+00S
12+00S
16+00S
20+00S
24+00S
28+00S
30+00S



DUAL
RESOURCES LTD (NPL)
VANCOUVER B.C.
SUSANNE CLAIM GROUP
WATSON LAKE M.D.
YUKON TERR.
MAG. and ANOMALIES PLAN
Scale: 1"=200' Date: Jan 1975
Dwg. No.: 75-501-A-B

Note :-
Zero line 5000 gammas 1"=1000 gammas
LI - Linear Anomaly
○ Pb 100 ppm, Zn 200 ppm, ag 5 ppm
○ Pb 300 ppm or Zn 600 ppm or ag 15 ppm
○ Pb 1000 ppm or Zn 2000 ppm or ag 50 ppm

V.P. King

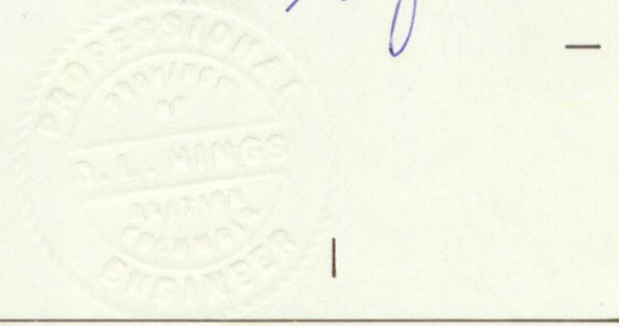



DJAL RESOURCES LTD (NPL)
VANCOUVER B.C.

SUSANNE CLAIM GROUP
WATSON LAKE M.D.
YUKON TERR.

CLAIM and GEOLOGICAL PLAN

Scale: 1" = 200' Date: Jan. 1975

Dwg. No.: 75-501-GC-B

Note:-
 - - - grid line & stations
 - - - claim line
 - - - claim post
 ■ ppm lead (pb)
 ■ ppm Zn (zn)
 ■ ppm Silver (ag)

J. G. Aug



DUAL RESOURCES LTD (NPL)
VANCOUVER B.C.

ELC CLAIM GROUP
WATSON LAKE M.D.
YUKON TERR.

CLAIM and GEOCH. PLAN
Scale: 1"=200' Date: Jan 1975
Dwg. No.: 75-501-GC-A

Note:-
 — grid line of stations
 — claim line
 ■ claim post
 — drainage line (dotted)
 — drainage line (solid)

J.P. King



DUAL
 RESOURCES LTD (NPL)
 VANCOUVER B.C.
 ELC CLAIM GROUP
 WATSON LAKE M.D.
 YUKON TERR.
 CLAIM and GEOCH. PLAN
 Scale - 1" = 200' Date - Jan 1975
 Dwg. No. - 75-501-GC-A

Note:-
 — grid line & stations
 — claim line
 ■ claim post
 70' diam lead (pb)
 80' diam zinc (zn)
 14' diam silver (ag)

J. Philip