

Document Number 061189.



REPORT ON THE
SEL 1-212 MINERAL CLAIMS
WATSON LAKE MINING DISTRICT, YUKON,
FOR
TRIDENT RESOURCES INC. (NPL).

This report has been examined by the Geological Evaluation Unit and is recommended to the Commission to be considered as representation work in the amount of \$ 10,854.73

J.B. Craig

Resident Geologist
Regional Mining Inspector

Considered as representation work under Section 53 (c) Yukon Quartz Mining Act.

Phillipie

Commissioner of Yukon Territory
ADMINISTRATOR OF THE YUKON TERRITORY

October 2, 1974.
Vancouver, B.C.

J.R. Deighton, Geologist.

TABLE OF CONTENTS

	Page
1-00 Summary...1
2-00 Conclusions2
3-00 Recommendations.2
4-00 Introduction4
4-10 Ownership and Title4
4-20 History...4
5-00 Geography.5
5-10 Location and Access5
5-20 Physiography and Climate6
7-00 Geology7
7-10 Regional Geology7
7-20 Property Geology7
8-00 Mineralization8
9-00 Geochemistry9
10-00 Sample Analysis11
11-00 Certification12

MAPS AND ILLUSTRATIONS

Cumulative percent frequency plot - lead

Cumulative percent frequency plot - zinc

Location Map 1" = 80 miles, 1" = 1 mile

Geochemical map, zinc values 1" = 400 feet

Geochemical map, lead values 1" = 400 feet

Geology map 1" = 1/4 mile

REPORT ON THE
SEL 1-212 MINERAL CLAIMS
WATSON LAKE MINING DISTRICT, Y.T.

for

TRIDENT RESOURCES INC. (NPL)

1-00

SUMMARY

The Sel 1-212 mineral claims are located in the Watson Lake Mining District on Sheet 105-I-13. They are situated 110 miles east of Ross River, Yukon Territory. The co-ordinates of the property are 62°51' N. Latitude and 129°53' W. Longitude. The property was located on behalf of the Selwyn Syndicate to cover zinc soil anomalies and gold quartz veins found by prospecting during the summer of 1973. A small reconnaissance soil sampling survey was initiated that year and indicated several soil anomalies in zinc.

A program consisting of geological mapping, soil sampling and claim tagging was conducted over part of the claim group from August 14 to August 30, 1974. The following report is based on the above work.

2-00 CONCLUSIONS

The Sel claims are underlain by a sedimentary sequence, Devonian to Mississippian in age.

A granodiorite stock lies to the north and west of the claim group. This intrusive underlies the extreme northwest corner of the claim block.

Several geochemical anomalies exist on the property. One anomaly has a peak value of 16,400 ppm zinc.

The geochemical anomalies lie along the westerly base of the central ridge of the claims.

The geochemical anomalies are associated with red soils and iron springs. The red soils and iron springs are postulated to be along a fault trace. The trace of the springs and red soils cross-cut the bedding of the surrounding rocks at a low angle.

Further work is recommended to investigate the zinc anomalies and the uninvestigated gold showings.

3-00 RECOMMENDATIONS

The geochemical anomalies should be investigated. Because of their location at the base of a steep ridge and in one instance close to a swamp, trenching may not be practical. Drilling of the anomalies is therefore recommended.

The unmapped portion of the claim group should be mapped.

The gold showings should be investigated by trenching and sampling. Drilling should be considered if the surface sampling proves positive.

Vancouver, B.C.
October 2, 1974.

4-00 INTRODUCTION

This report is based on a review of the 1973 work and work carried out on the property from August 15 to 30, 1974. The property work consisted of a reconnaissance soil sampling program, a re-sampling and fill in soil sampling program, geological mapping and claim tagging. The Sel 1-212 mineral claims are located 110 miles east of Ross River in the Watson Lake Mining District, Yukon Territory.

4-10 Ownership and Title:

The property consists of 212 contiguous mineral claims located in the Watson Lake Mining District, Yukon Territory. The claims were staked on behalf of the Selwyn Syndicate during the summer and late fall of 1973.

The property consists of the following mineral claims:

<u>Claim Name</u>	<u>Record Number</u>	<u>Date Recorded</u>
SEL 1-24	Y73933-56	August 2, 1973
SEL 25-110	Y74134-219	August 30, 1973
SEL 111-212	Y74429-530	October 1, 1973

4-20 History:

The first major discovery in the general area of the SEL claims was the McMillan Pass base metal deposit approximately 24 miles north of the property. Hudson Bay Explorations and Development Co. Ltd., conducted extensive exploration from 1951 to 1970 and outlined ore reserves of 7 million tons grading 8% lead, 8% zinc and 2.7 ounces silver per ton.

There are two ore zones on the property. The west zone is concordant with the bedding of the sediments. The host rock is a barite rich limestone which passes along strike into black graphitic argillites within a few hundred feet of the mineralized zone. The east zone is considered to be a mineralized fault zone. The same company investigated a copper-zinc zone five miles south of the SEL claims. This showing is associated with a small intrusive stock.

During 1973, the Selwyn Syndicate was formed to prospect the Selwyn Basin area for sedimentary sulphide deposits. A two man party was engaged in prospecting and regional silt and soil sampling using a total heavy metal kit. The discovery of gold bearing quartz veins and total heavy metal anomaly lead to more detailed exploration and the staking of the SEL mineral claims.

5-00

GEOGRAPHY5-10 Location and Access:

The property is located on the divide of the headwater of the Ross and Pelly River some 110 miles east of the community of Ross River, Yukon Territory.

Co-ordinates of the claim group are 62°51' N. Latitude and 129°53' W. Longitude.

Access to the mineral claims are by gravel roads from Whitehorse or Watson Lake to Ross River, and by scheduled airline from Whitehorse to Ross River, and then by helicopter to the property, a distance of 110 miles. The Canol Road runs approximately 15 miles north of the property via a timbered valley.

5-20 Physiography and Climate:

The gold showing is exposed on the north flank of a ridge from elevations of 5,000 to 6,100 feet. The heavy metal and zinc soil anomaly lies along the southern extension of the same ridge at the break of the slope at an elevation of about 4,500 feet.

The entire claim group lies above tree line with light brush along the southern boundary of the property. Topography in the area is generally steep, occasionally precipitous. A wide open valley lies immediately south of the claim group.

The mineral claim group lies near the central portion of the Yukon-Northwest Territories border, close to the northern tree line. Temperatures are extremely cold during winter with snow cover from October to mid June. Summers are mild with moderate precipitation. Snow fall during early and late summer is common but seldom lasts for more than a few days.

7-00 GEOLOGY7-10 Regional Geology:

The property area has been mapped by the Geological Survey of Canada and information has been published on Sheet 8-1967 Geology of the Nahanni. The area is shown to be underlain by Devonian and Mississippian black shales, argillites, chert pebble conglomerate, chert sandstone and siltstone with minor brown sandstone, siltstone and banded chert. A three to four mile diameter Cretaceous intrusive stock of medium grained granodiorite cuts the sediments.

Copper-zinc mineralization is reported to be associated with a small intrusive stock 5 miles south of the property.

7-20 Property Geology:

Geology was done on the western portion of the property. The rock formations consist mainly of black argillaceous shale, limy shale with minor limestone and sandstone-grit. These rocks all belong to an unnamed unit of Devonian and ? Mississippian age.

The formations all appear to dip moderately to steeply to the west and generally have a northerly strike. On the western portion of the property, a tightly folded syncline plunging gently northward occurs. Structure on the property is complicated by faulting.

The rock units are well foliated, having northwesterly strikes and steep westerly dips. Foliation along the main ridge generally follows the bedding planes of the

shales but on several occasions it was noted to cross-cut bedding.

A regional fault is presumed to run in a northwesterly direction along the break in slope, on the southwest side of the main ridge. This fault is traced out by a series of iron springs and iron stained soils. The trace of the springs and red soil cross-cut the general strike of the formations at a low angle.

There may be a very open anticline plunging gently northwards with the axis occupying the creek valley covered by SEL claims 5-8. This could not be confirmed as snow prevented access to the area at the time the work on the property took place.

8-00

MINERALIZATION

Pyrite occurs as disseminations and on bedding planes in black argillites in the northwestern portion of the claim group. In some cases the shales have been bleached to a cream color by the pyrite and metamorphism. The pyrite content in the shales and argillites does not exceed 15%, but in places solid knots of fine grained pyrite, up to three inches in diameter, occur. Eleven rock samples of shales containing pyrite were taken during the geological mapping and were submitted for analysis. A tabulation of these results follows:

Sample No.	SEL No.	PPM Cu.	PPM Lead	PPM Zinc	SILVER oz/ton	PPM Silver	PPB Gold
22775	1	220	113	211	.01	0.5	<30
76	2	124	16	131	.04	1.5	<30
77	3	72	24	16	.23	8.0	<30
78	4	108	44	55	1.28	44.0	<30
79	5	52	12	60	.01	0.5	<30
80	6	62	10	18	.02	1.0	<30
81	7	58	8	20	.01	0.5	<30
82	8	80	6	62	Tr	0.5	<30
83	9	200	30	55	.24	8.5	<30
84	10	94	18	13	.04	1.5	<30
85	11	76	20	47	Tr	0.5	<30
22786	12	96	28	7	.02	1.0	<30

An occurrence of quartz veining with pyrite and arsenopyrite was seen on top of the ridge in SEL #5 claim. Here veinlets of quartz from 1/16 to 1/2" wide cut rusty black shales. The general trend of the quartz veining appears to be north-south. The width of the veining is 1 1/2 feet. A sample, (22778), of this material returned an assay of Tr. oz Au, 1.28 oz Ag.

9-00 GEOCHEMISTRY

A soil sampling survey was conducted over a portion of the claim group. This survey was conducted to fill in and extend the coverage on the anomalies found last year. The remainder of the soil survey was of a reconnaissance nature along claim lines. One hundred and eighty one soil samples were collected. Of these samples several are duplicates of last years sampling. This was done to correlate the two sampling programs.

The soil samples collected were submitted for analysis for total lead and zinc. Chemex Labs. Ltd., 212 Brooksbank Avenue, North Vancouver, B.C. did the sample preparation and analysis.

A frequency distribution plot was made of the entire population (both this and last years samples) to determine background and anomalous value ranges for lead and zinc. For this the accumulated frequency percent was plotted against the range of values in parts per million, on arithmetic probability paper.

	<u>Number of Samples</u>	<u>Range PPM</u>	<u>Background %</u>	<u>Anomalous %</u>
Pb	826	2-100	35 94.96	60 1.49
Zn	820	2-16,400	500 90.05	1000 7.05

The geochemistry done this year confirms the anomalies of last year. No new anomalies were found.

The geochemical anomalies were investigated and found to occur where there were red soil or iron springs. These springs or soils roughly form a line that cross-cut the general bedding trend of the surrounding rocks. These anomalies and springs are presumed to mark the trace of a regional fault. This fault occurs along the western base of the central ridge in the claim group.

Respectfully submitted,



J.R. Deighton, Geologist.

Vancouver, B.C.
October 2, 1974

SAMPLE ANALYSISZINC

<u>Interval</u>	<u># of Sample</u>	<u>%</u>	<u>Cumulative %</u>
1-200	563	68.15	68.15
201-400	121	14.64	82.79
401-600	50	6.05	88.84
601-800	20	2.42	91.26
801-1000	12	1.45	92.71
1001-1200	2	.24	92.95
1200-1400	4	.48	93.43
1400-1600	3	.36	93.79
1600-1800	3	.36	94.15
1800 +	37	4.47	98.62

LEAD

<u>Interval</u>	<u># of Samples</u>	<u>%</u>	<u>Cumulative %</u>
0-10	250	30.26	30.26
11-20	287	34.74	65.00
21-30	230	27.84	92.84
31-40	35	4.23	97.07
41-50	6	.72	97.79
51-60	4	.48	98.27
61-70	2	.24	98.51
71-80	1	.12	98.63
80 +	1	.12	98.75

CERTIFICATION

I, JOHN RAYMOND DEIGHTON, of 3250 West 33rd Avenue,
Vancouver, British Columbia, do hereby certify that:

I am a graduate of the University of British
Columbia, with a Bachelor of Science Degree in
Geology, 1965.

Since graduation I have been engaged in Mineral
Exploration in British Columbia, Yukon,
Northwest Territories, Washington, Arizona
and California.

I am a Fellow of the Geological Association of
Canada and of the Canadian Institute of
Mining and Metallurgy.

I am a Geologist.

Vancouver, B.C.
October 2, 1974

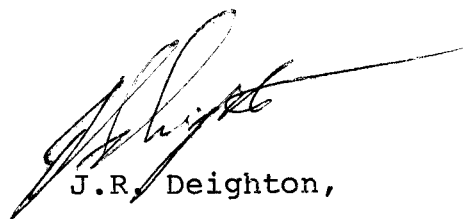

J.R. Deighton,
Geologist.



CHEMEX LABS LTD.

212 BROOKSBANK AVE.
NORTH VANCOUVER, B.C.
CANADA V7J 2C1
TELEPHONE: 985-0648
AREA CODE: 604

• ANALYTICAL CHEMISTS • GEOCHEMISTS • REGISTERED ASSAYERS

CERTIFICATE OF ANALYSIS

CERTIFICATE NO. 28408

INVOICE NO. 12549

RECEIVED Sept. 12/74

ANALYSED S Sept. 18/74

TO: Agilis Exploration Services Ltd.,
#107 - 325 Howe St.,
Vancouver 1, B. C.

ATTN:

SAMPLE NO. :	PPM Lead	PPM Zinc
56N 132E	8	20
134	14	70
136	22	123
138	4	7
140	4	5
142	14	72
144	2	5
146	4	4
418	22	65
150	4	7
152	12	43
154	24	41
156	14	55
158	4	7
160	6	22
162	4	9
164	2	2
166	8	7
168	12	25
170	8	11
172	20	112
174	4	7
176	2	5
178	6	4
180	36	123
182	14	65
184	2	4
186	6	13
188	20	92
190	4	5
192	6	11
56N 194E	2	7
53S 0E	4	4
2	2	5
4	2	5
6	4	13
8	18	148
10	2	5
12	4	7
53S 14E	18	169
Std.	60	52



MEMBER
CANADIAN TESTING
ASSOCIATION

CERTIFIED BY:



CHEMEX LABS LTD.

212 BROOKSBANK AVE.
 NORTH VANCOUVER, B.C.
 CANADA V7J 2C1
 TELEPHONE: 985-0648
 AREA CODE: 604

- ANALYTICAL CHEMISTS
- GEOCHEMISTS
- REGISTERED ASSAYERS

CERTIFICATE OF ANALYSIS

TO: Agilis Exploration Services Ltd.,
 #107 - 325 Howe St.,
 Vancouver 1, B. C.

CERTIFICATE NO. 28409
 INVOICE NO. 12549
 RECEIVED Sept. 12/74
 ANALYSED Sept. 18/74

ATTN:

SAMPLE NO. :	PPM Lead	PPM Zinc
53S 16E	8	13
18	8	225
20	2	9
22	4	24
24	4	9
26	4	7
28	2	7
53S 30E	18	305
53S 76E	8	43
53S 78E	10	500
53S 80E	14	275
28E ON	14	375
2	14	1920
4	14	155
6	28	392
8	32	285
28E 10N	26	600
28E 2S	14	305
4	14	305
6	10	375
8	14	285
10	24	733
12	30	179
14S	26	140
32E ON	14	155
2	12	123
4	28	305
6N	10	9
26S	8	7
28	6	5
30	8	5
32	4	5
34	6	7
36	8	11
38	24	95
40	8	11
42	20	164
44	10	11
46	14	98
32E 48S	10	9
Std.	60	50



MEMBER
 CANADIAN TESTING
 ASSOCIATION

CERTIFIED BY:

B. L. Swaine



CHEMEX LABS LTD.

212 BROOKSBANK AVE.
 NORTH VANCOUVER, B.C.
 CANADA V7J 2C1
 TELEPHONE: 985-0648
 AREA CODE: 604

• ANALYTICAL CHEMISTS • GEOCHEMISTS • REGISTERED ASSAYERS

CERTIFICATE OF ANALYSIS

CERTIFICATE NO. 28410

TO: Agilis Exploration Services Ltd.,
 #107 - 325 Howe St.,
 Vancouver 1, B. C.

INVOICE NO. 12549

RECEIVED Sept. 12/74

ANALYSED Sept. 18/74

ATTN:

SAMPLE NO. :	PPM	
	Lead	Zinc
32E 50S	14	25
32E 52S	8	5
36E 0N	14	330
2	20	152
36E 4N	12	108
40E 0N	14	800
2N	18	184
40E 4N	6	83
44E 0N	16	1840
2	6	92
44E 4N	30	550
48E 0N	10	>4000
2	18	392
48E 4N	20	434
52E 0N	8	680
2	4	11
52E 4N	22	218
56E 0N	4	>4000
56E 4N	22	189
60E 0N	6	50
64E 0N	12	>4000
64E 2N	12	>4000
68E 0N	4	127
68E 2N	4	330
72E 0N	4	>4000
2N	8	>4000
28S	2	43
30	2	11
32	4	9
34	14	155
36	4	13
38	18	174
40	6	25
42	14	155
44	4	9
46	20	189
48	2	7
50	32	233
52	12	45
72E 53S	14	135
Std.	60	50



MEMBER
 CANADIAN TESTING
 ASSOCIATION

CERTIFIED BY:

R. Swaites



CHEMEX LABS LTD.

212 BROOKSBANK AVE.
NORTH VANCOUVER, B.C.
CANADA V7J 2C1
TELEPHONE: 985-0648
AREA CODE: 604

• ANALYTICAL CHEMISTS • GEOCHEMISTS • REGISTERED ASSAYERS

CERTIFICATE OF ANALYSIS

TO: Agilis Exploration Services Ltd.,
#107 - 325 Howe St.,
Vancouver 1, B. C.

CERTIFICATE NO. 28411
INVOICE NO. 12549
RECEIVED Sept. 12/74
ANALYSED Sept. 18/74

ATTN:

SAMPLE NO. :	PPM	PPM
	Lead	Zinc
84E ON	20	218
2	34	67
4	18	233
84E 6N	8	950
84E 2S	6	89
4	6	47
6	2	16
8	16	248
10	4	14
12	12	62
84E 14S	16	112
108E ON	10	80
2	6	9
4	10	30
6	22	77
8	6	14
10	4	5
14	4	13
108E 16N	26	275
112E ON	12	28
2	2	4
4	24	120
6	10	83
8	14	95
10	10	305
112E 14N	6	248
116E ON	2	9
2	20	92
4	8	28
6	6	9
8	14	482
10	18	72
12	14	194
14	14	131
116E 16N	28	50
120E ON	14	92
2	8	18
4	20	39
6	4	16
120E 8N	4	4
Std.	60	50



MEMBER
CANADIAN TESTING
ASSOCIATION

CERTIFIED BY:



CHEMEX LABS LTD.

212 BROOKSBANK AVE.
NORTH VANCOUVER, B.C.
CANADA V7J 2C1
TELEPHONE: 985-0648
AREA CODE: 604

• ANALYTICAL CHEMISTS • GEOCHEMISTS • REGISTERED ASSAYERS

CERTIFICATE OF ANALYSIS

CERTIFICATE NO. 28413
INVOICE NO. 12564
RECEIVED Sept.12/74
ANALYSED Sept.19/74

TO: Agilis Expl. Services Ltd.,
107 - 325 Howe St.,
Vancouver 1, B.C.

ATTN: Rocks

SAMPLE NO. :	PPM Copper	PPM Lead	PPM Zinc	PPM Silver	PPB Gold
22775	220	113	211	0.5	< 30
76	124	16	131	1.5	< 30
77	72	24	16	8.0	< 30
78	108	44	55	44.0	< 30
79	52	12	60	0.5	< 30
80	62	10	18	1.0	< 30
81	58	8	20	0.5	< 30
82	80	6	62	< 0.5	< 30
83	200	30	55	8.5	< 30
84	94	18	13	1.5	< 30
85	76	20	47	< 0.5	< 30
22786	96	28	7	1.0	< 30
22787	160	36	482	0.5	30
22788		60	550		



MEMBER
CANADIAN TESTING
ASSOCIATION

CERTIFIED BY

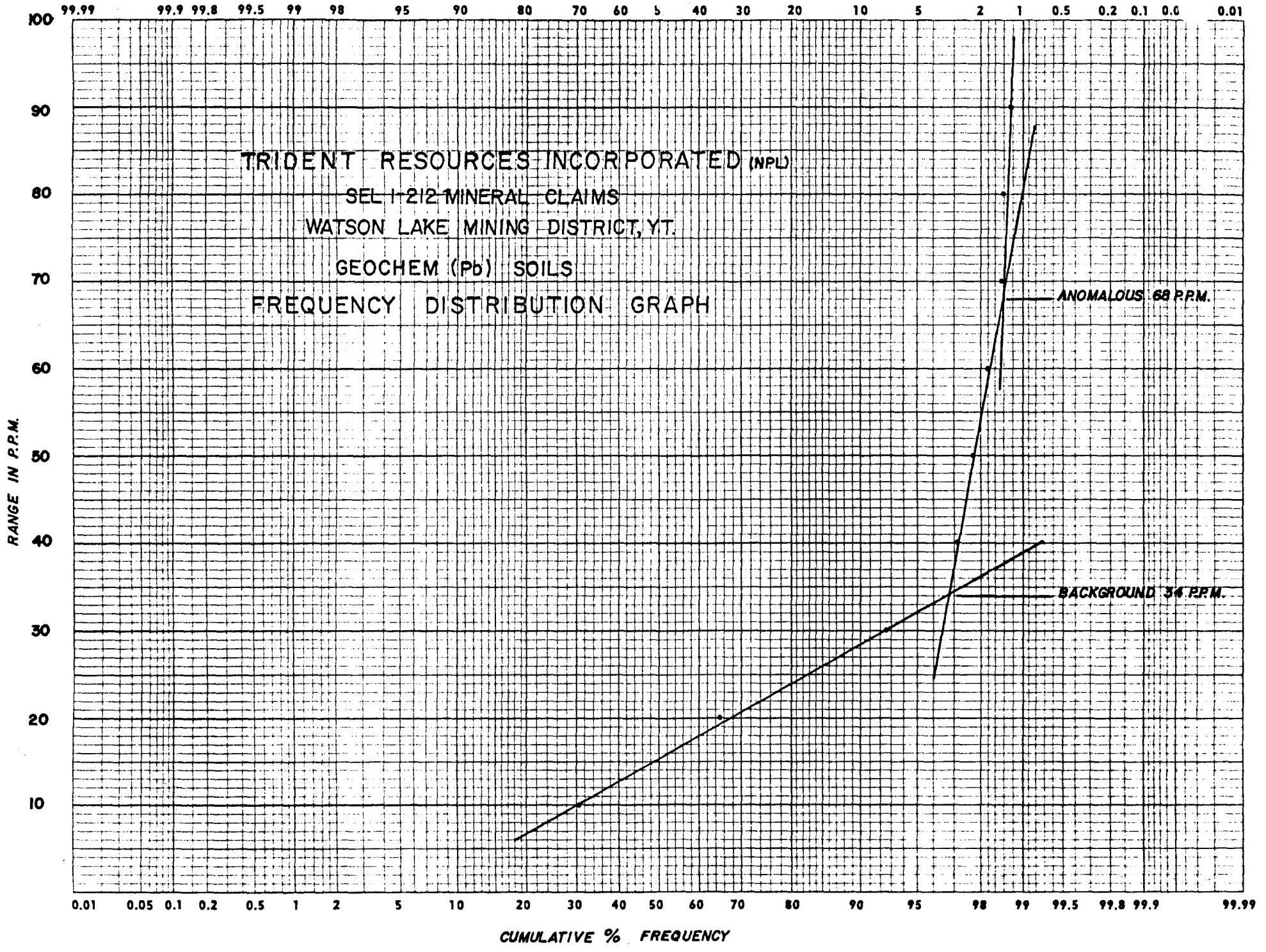

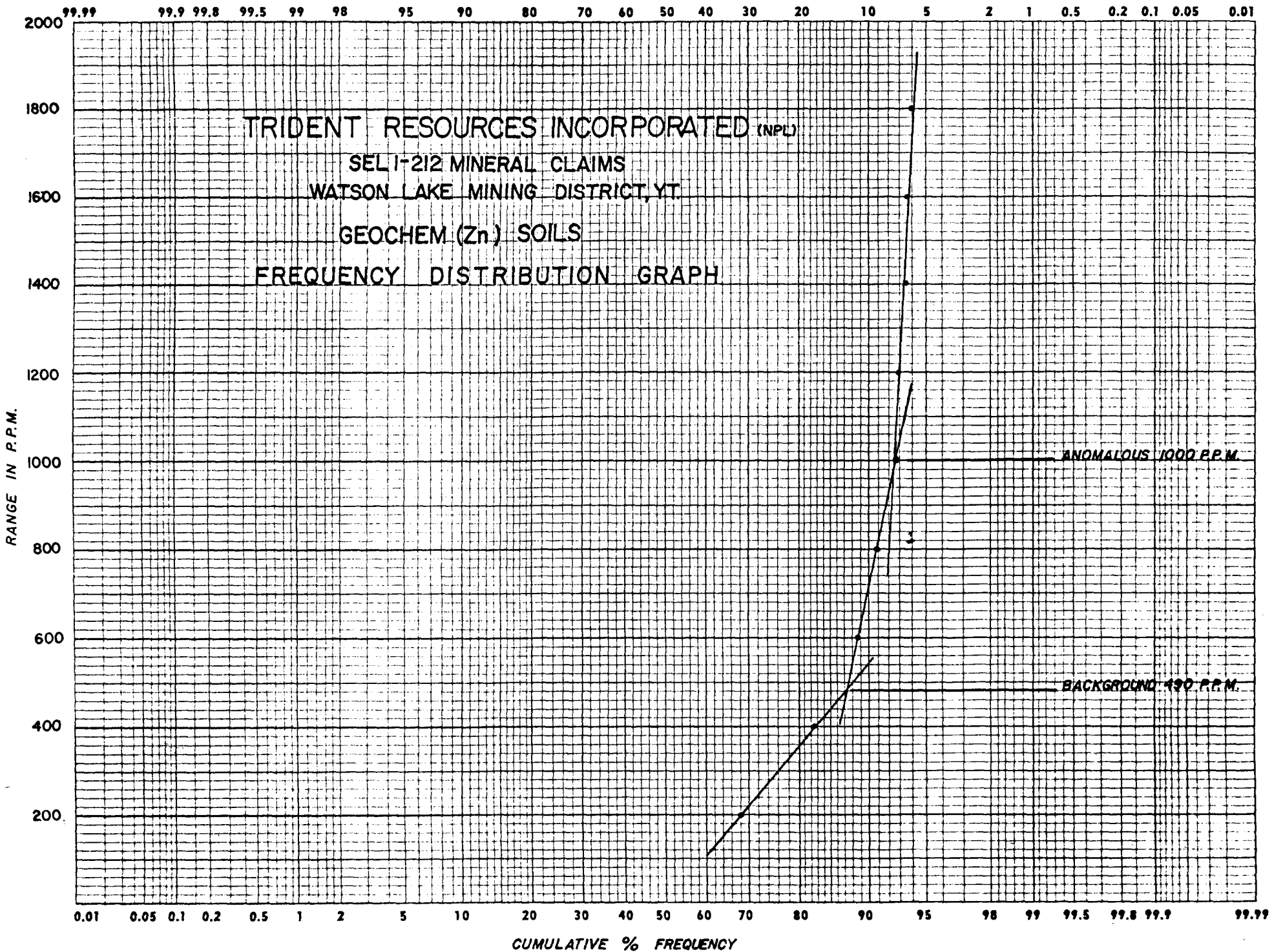

YUKON TERRITORY

TRIDENT RESOURCES INCORPORATED (NPL)

SEL CLAIMS
ROSS RIVER AREA

PROPERTY LOCATION MAP

WATSON LAKE MINING DISTRICT, Y.T.

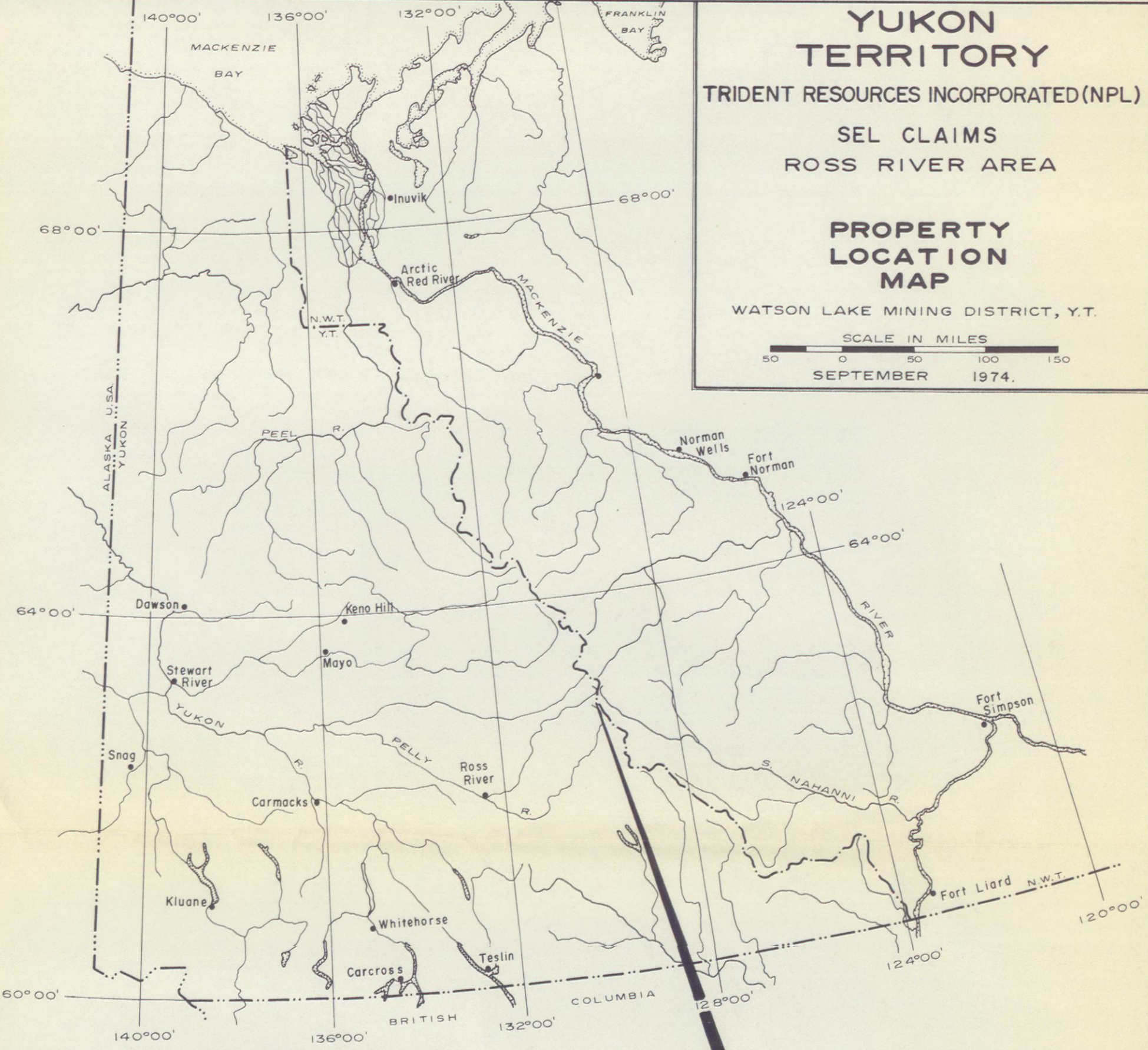
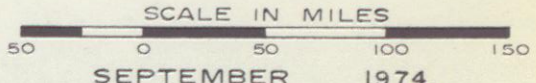

SEL CLAIMS

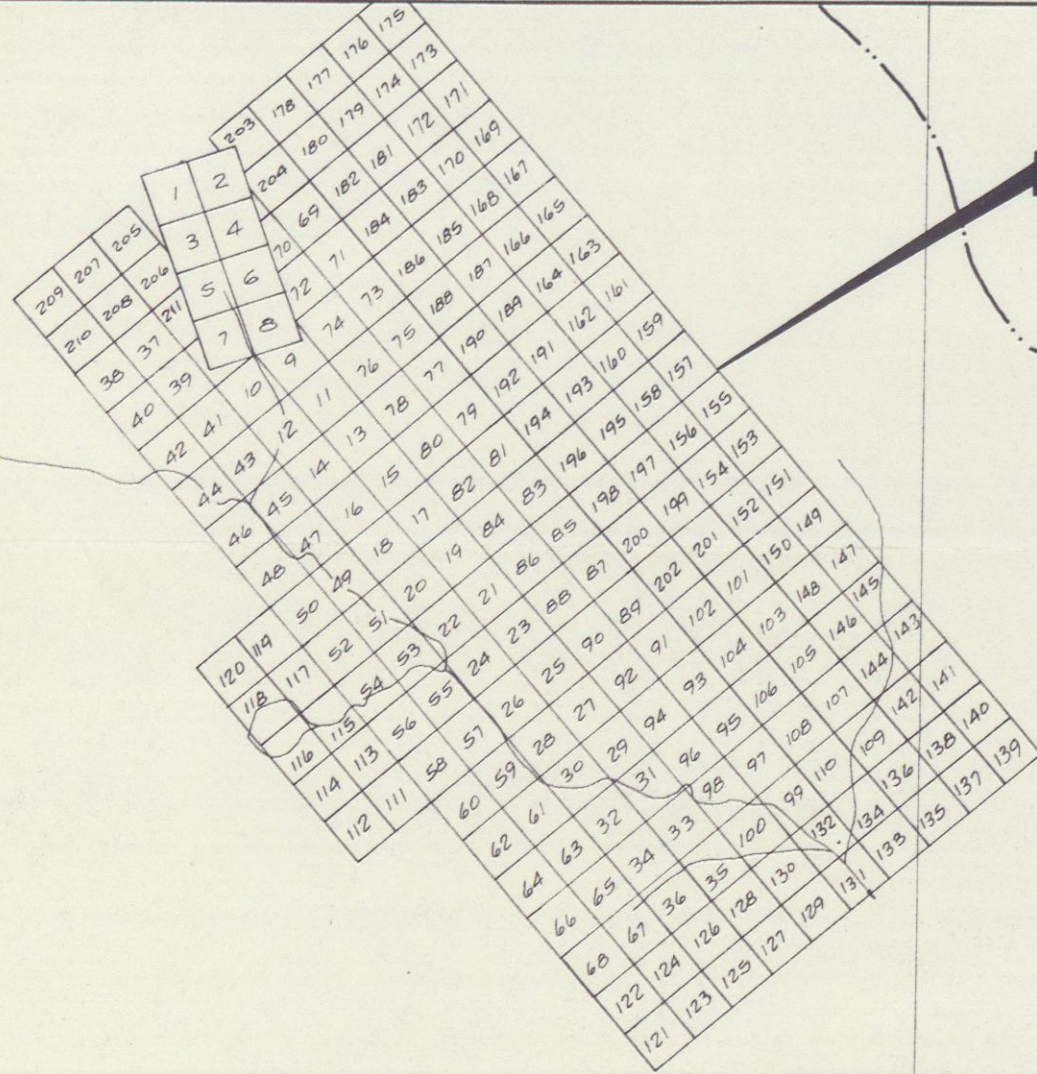

Scale 1" = 1 Mile

Handwritten signature and a circular official seal of a professional surveyor.

129°45'
62°45'

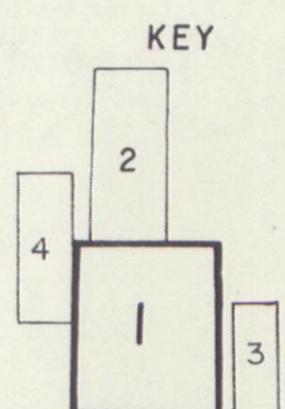
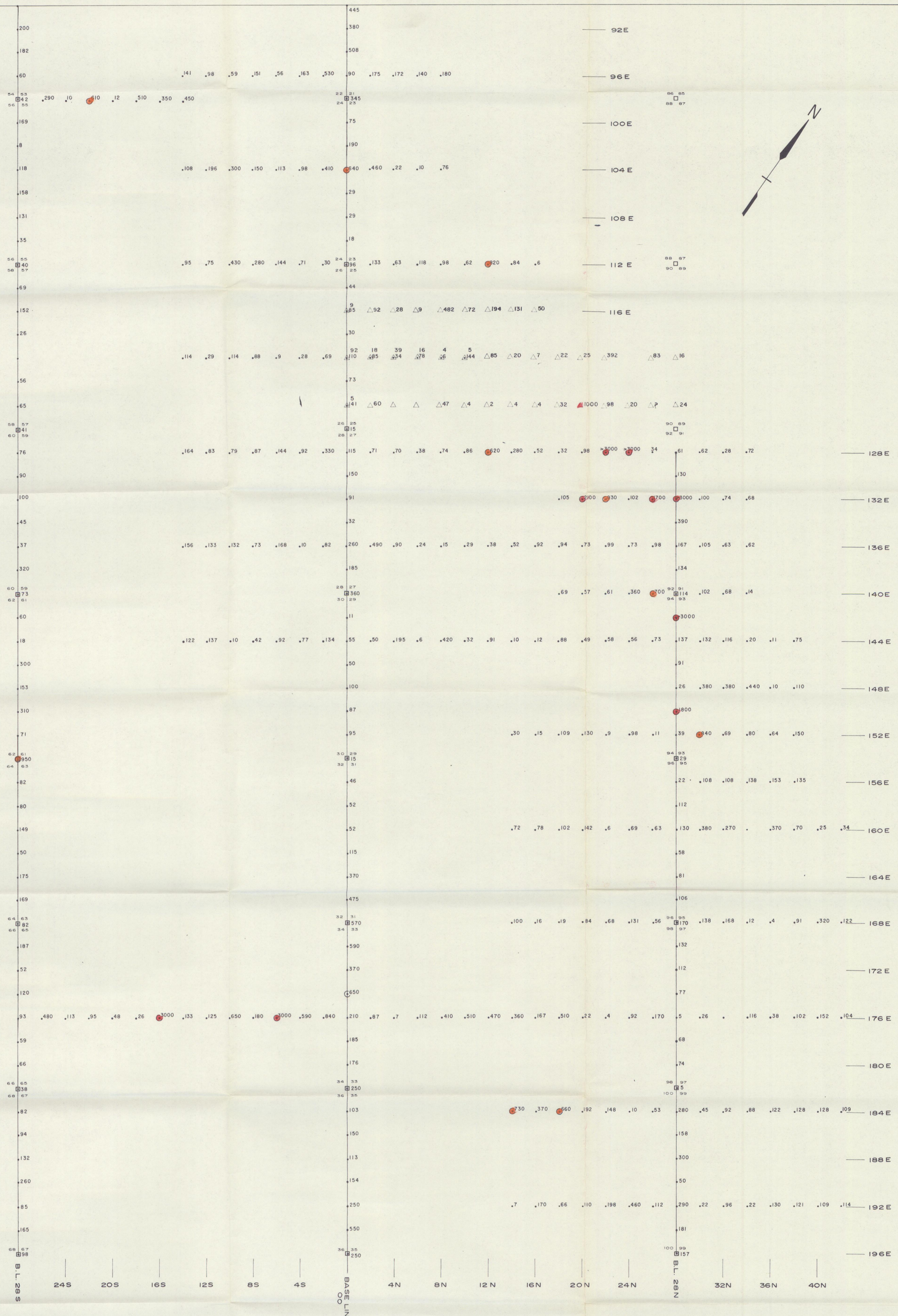

- 600-999 P.P.M. Zinc
- 1000+ P.P.M. Zinc
- * 1973 SURVEY VALUE
- △ 1974 SURVEY VALUE
- △ 92-1974 SURVEY VALUE
- △ 110-1973 SURVEY VALUE

TRIDENT RESOURCES INCORPORATED (NPL)
SEL CLAIMS, ROSS RIVER AREA
WATSON LAKE MINING DISTRICT, Y.T.

GEOCHEMICAL SURVEY

ZINC IN P.P.M.



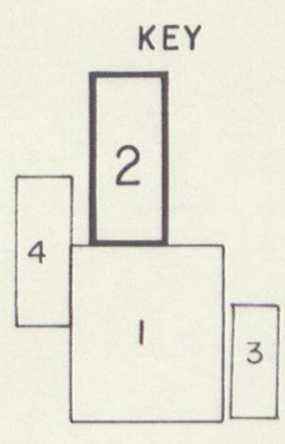
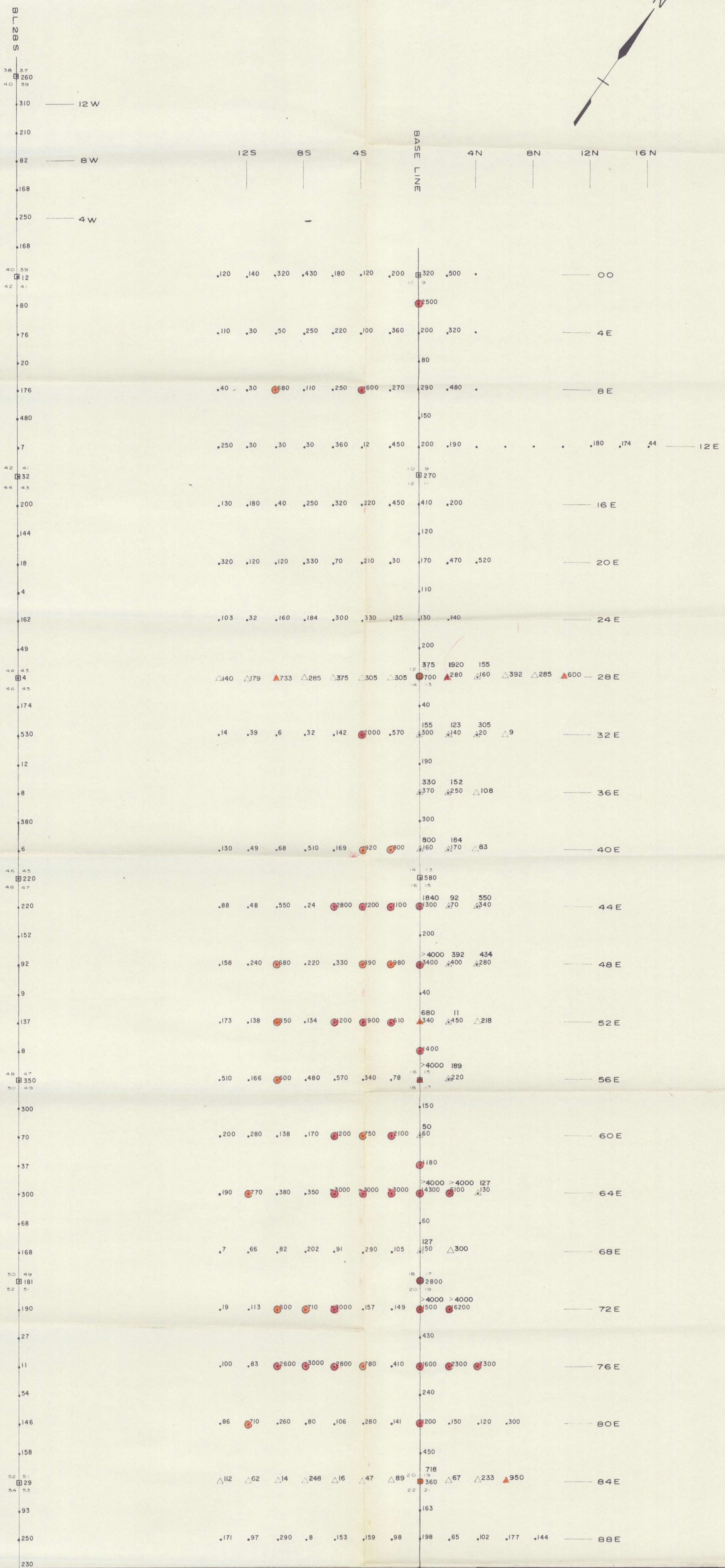
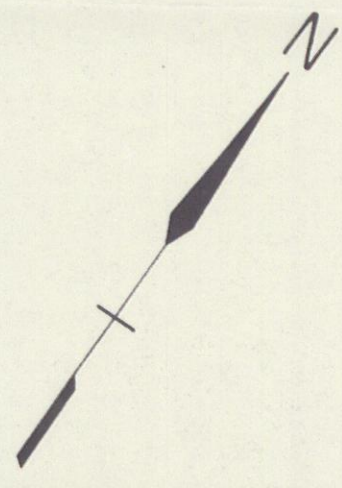

- 600-999 P.P.M. Zinc
- 1000 + P.P.M. Zinc
- 1973 SURVEY VALUE
- △ 1974 SURVEY VALUE
- △392 - 1974 SURVEY VALUE
- △400 - 1973 SURVEY VALUE

TRIDENT RESOURCES INCORPORATED (NPL)
 SEL CLAIMS, ROSS RIVER AREA
 WATSON LAKE MINING DISTRICT, Y.T.

GEOCHEMICAL SURVEY

ZINC IN P.P.M.

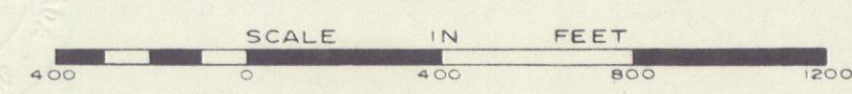

56N BASELINE

132E _____
 136E _____
 140E _____
 144E _____
 148E _____
 152E _____
 156E _____
 160E _____
 164E _____
 168E _____
 172E _____
 176E _____
 180E _____
 184E _____
 188E _____
 192E _____
 196E _____

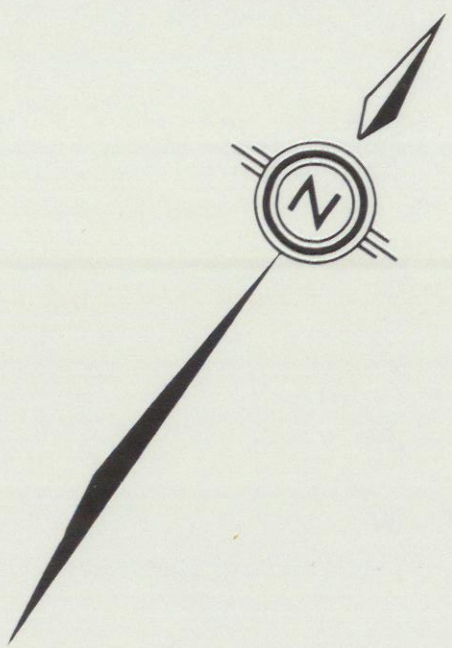
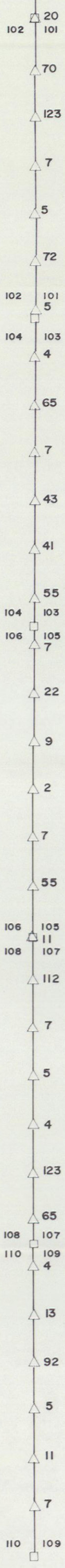

△ 1974 SURVEY VALUE

KEY

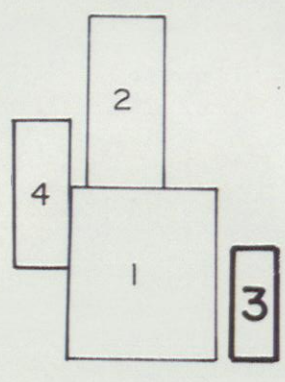

[Handwritten signature]
 AGILIS ENGINEERING LTD.
 19061619

TRIDENT RESOURCES INCORPORATED (NPL)
 SEL CLAIMS, ROSS RIVER AREA
 WATSON LAKE MINING DISTRICT, Y.T.

GEOCHEMICAL SURVEY
 ZINC IN P.P.M.

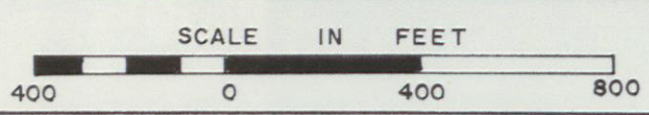

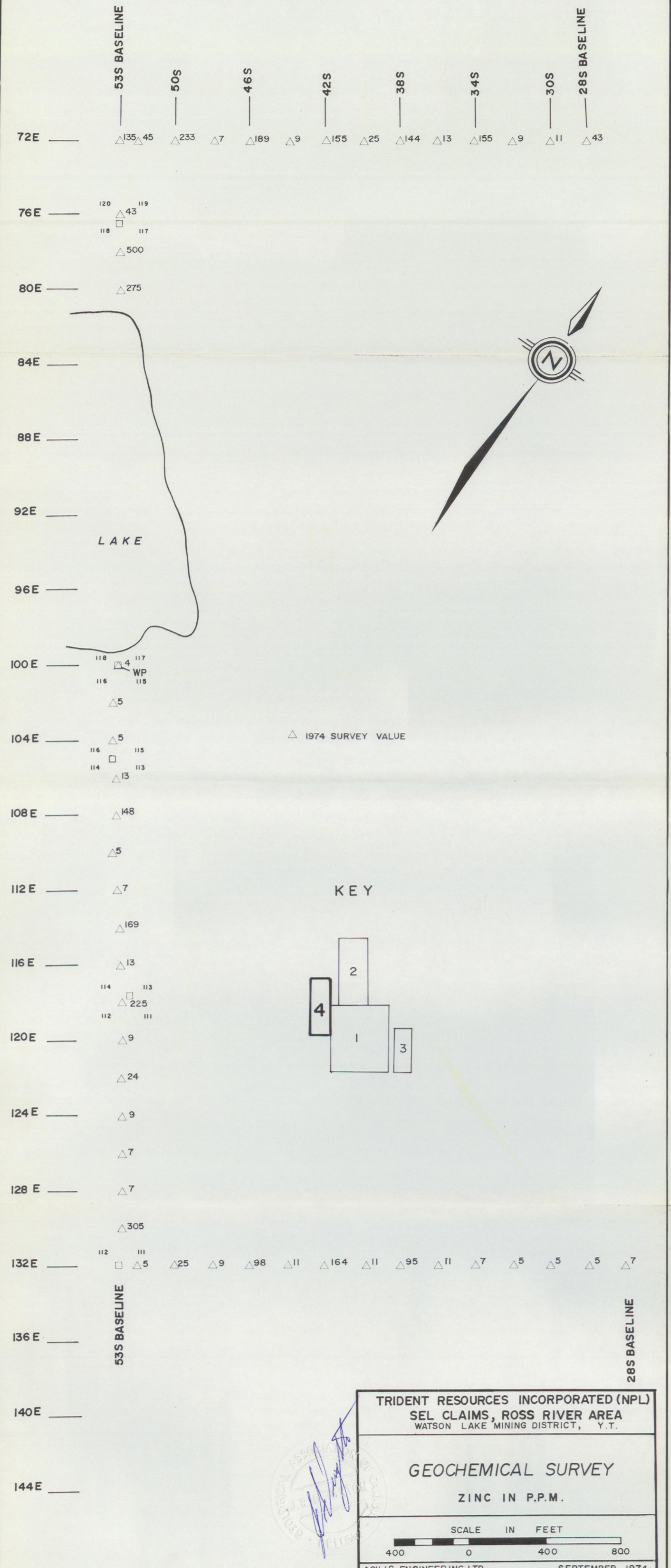

72E — 135, 45 50S — 233 46S — 189 42S — 155 38S — 144 34S — 155 30S — 11 28S BASELINE — 43

76E — 120, 119, 118, 117, 500

80E — 275

84E —

88E —

92E —

96E —

100E — 118, 117, 116, 115, 4, WP, 5

104E — 116, 115, 114, 113, 5, 13 \triangle 1974 SURVEY VALUE

108E — 148, 5

112E — 7, 169

116E — 13, 114, 113, 112, 111, 225

120E — 9, 24

124E — 9, 7

128E — 7, 305

132E — 112, 111, 5, 25, 9, 98, 11, 164, 11, 95, 11, 7, 5, 5, 5, 7

136E — **53S BASELINE**

140E —

144E — **28S BASELINE**

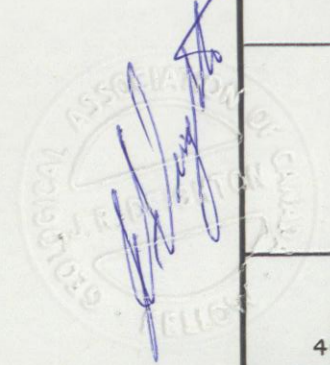

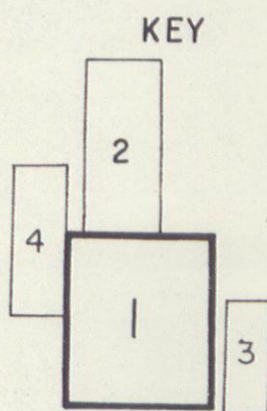
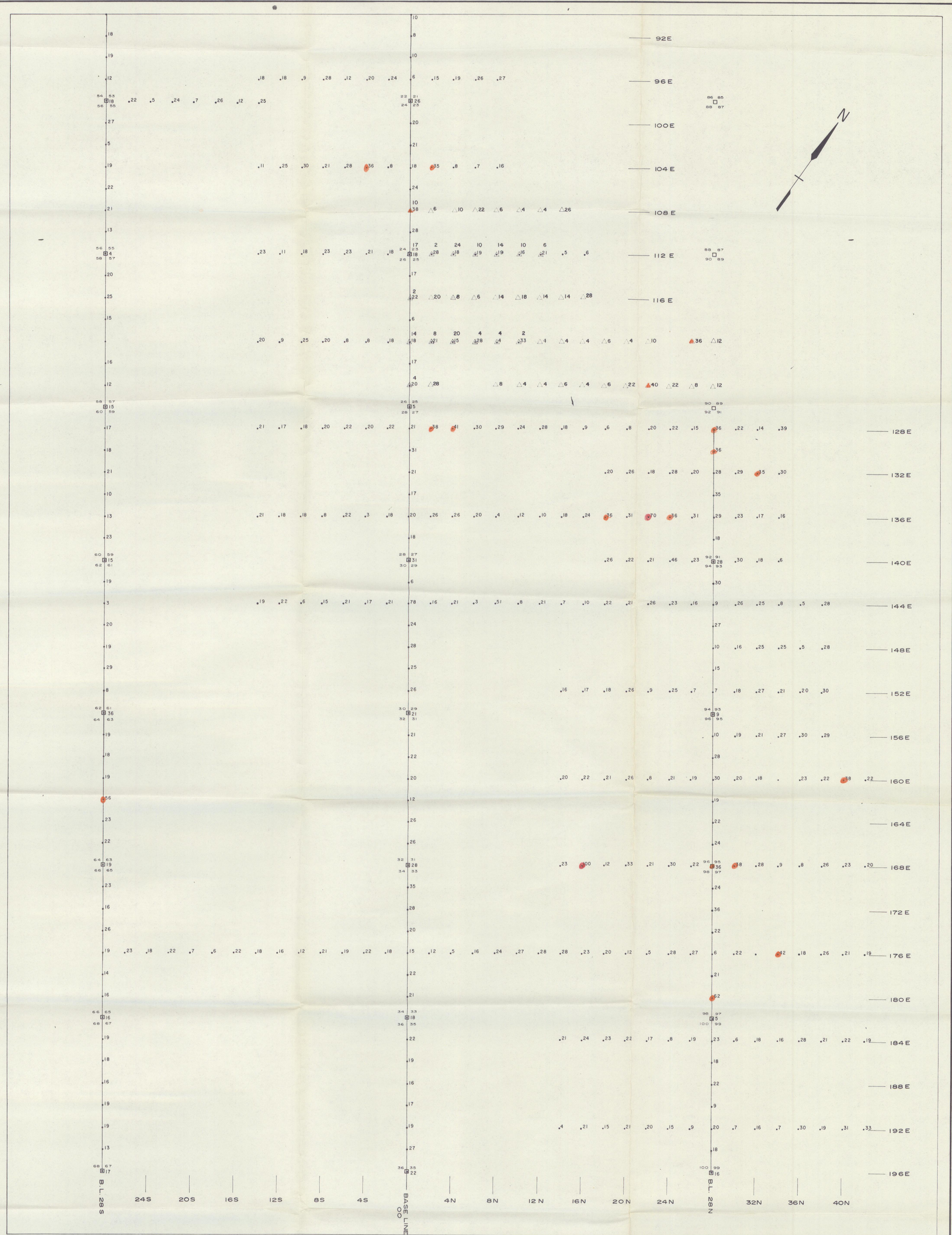

- 1973 SURVEY VALUE
- △ 1974 SURVEY VALUE
- ▲ 17-1974 SURVEY VALUE
18-1973 SURVEY VALUE

TRIDENT RESOURCES INCORPORATED (NPL)
SEL CLAIMS, ROSS RIVER AREA
WATSON LAKE MINING DISTRICT, Y.T.

GEOCHEMICAL SURVEY

LEAD IN P.P.M

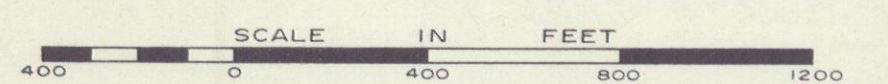

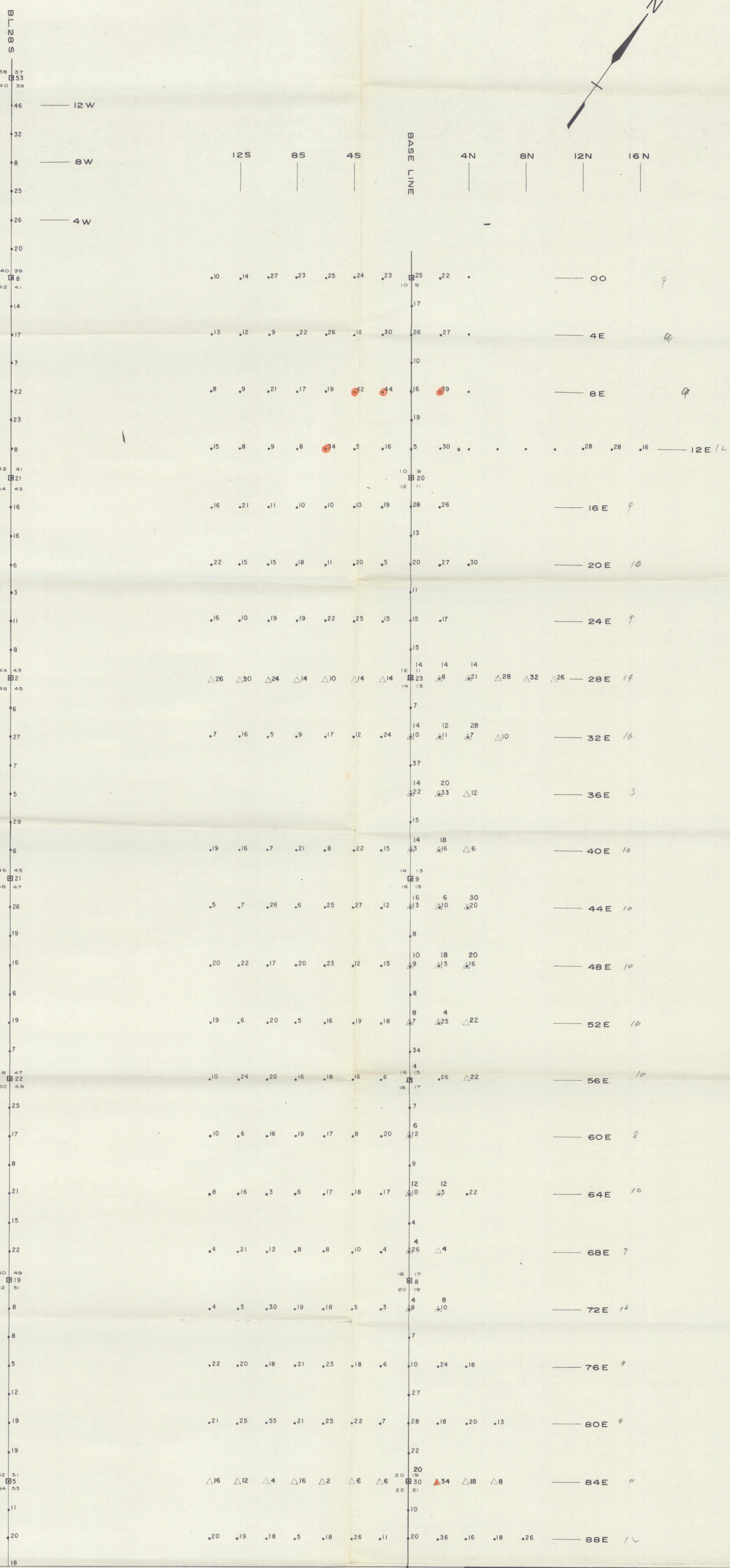
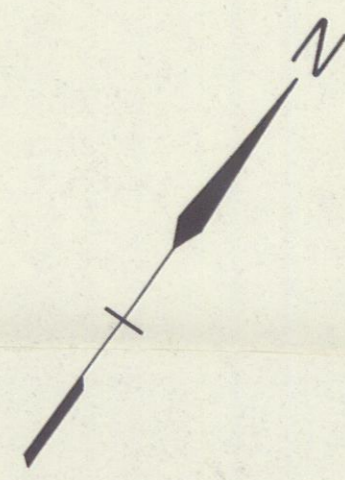

KEY

- 1973 SURVEY VALUE
- △ 1974 SURVEY VALUE
- △ 18 - 1974 SURVEY VALUE
15 - 1973 SURVEY VALUE

TRIDENT RESOURCES INCORPORATED (NPL)
SEL CLAIMS, ROSS RIVER AREA
WATSON LAKE MINING DISTRICT, Y.T.

GEOCHEMICAL SURVEY

LEAD IN P.P.M.

SCALE IN FEET
400 0 400 800 1200

AGILIS ENGINEERING LTD. SEPTEMBER 1974

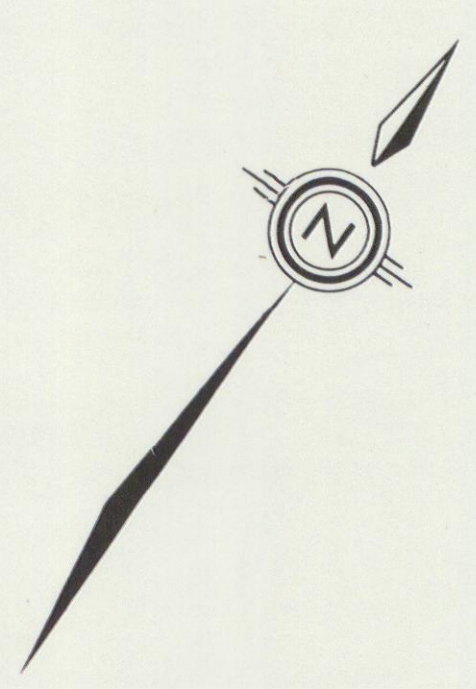
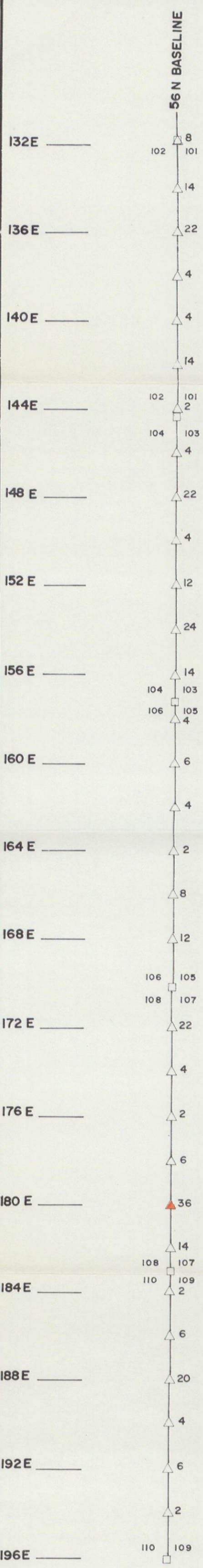

△ 1974 SURVEY VALUE

KEY

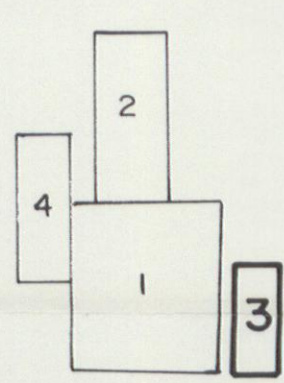

TRIDENT RESOURCES INCORPORATED (NPL)
 SEL CLAIMS, ROSS RIVER AREA
 WATSON LAKE MINING DISTRICT, Y.T.

GEOCHEMICAL SURVEY
 LEAD IN P.P.M.

SCALE IN FEET
 400 0 400 800

AGILIS ENGINEERING LTD. SEPTEMBER 1974.

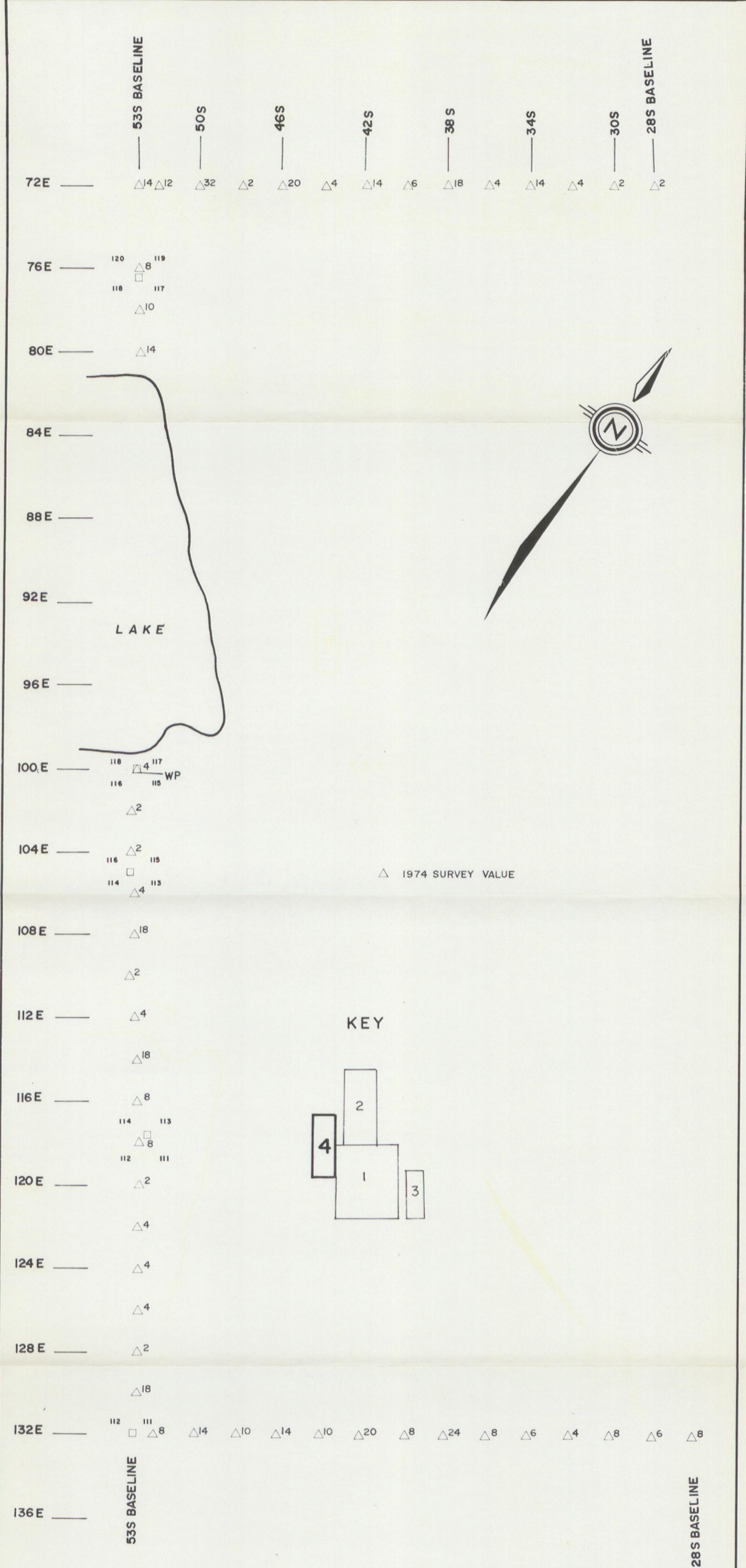

TRIDENT RESOURCES INCORPORATED (NPL)
 SEL CLAIMS, ROSS RIVER AREA
 WATSON LAKE MINING DISTRICT, Y.T.

GEOCHEMICAL SURVEY
 LEAD IN P.P.M.

SCALE IN FEET
 400 0 400 800

AGILIS ENGINEERING LTD. SEPTEMBER 1974.



129° 52'

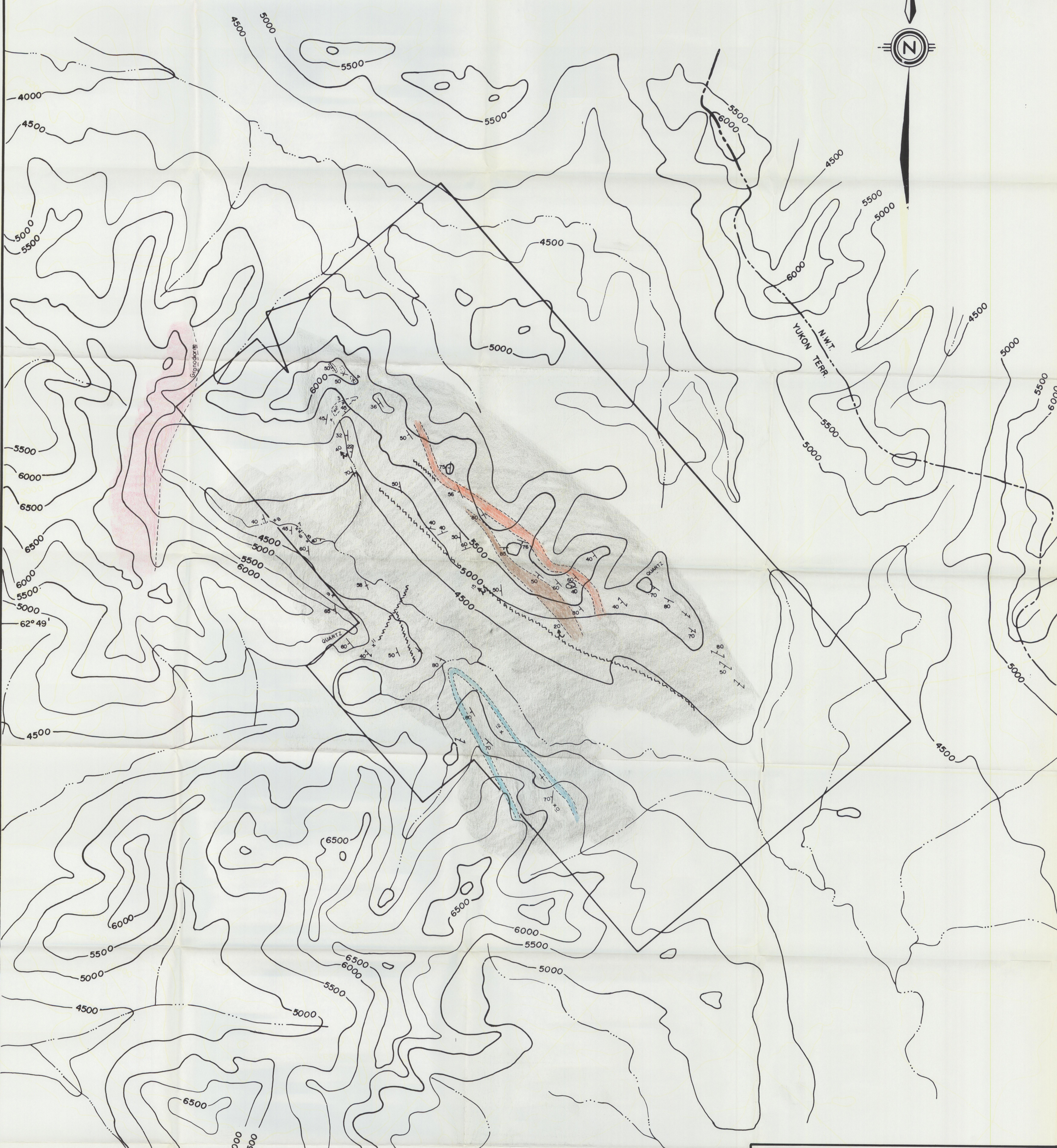

LEGEND

- Grey weathering thin platy black shale
- Black shale
- Limestone
- Granodiorite
- Sandstone grit

SYMBOLS

- Bedding; inclined, vertical
- Foliation; inclined, vertical
- Plunge of axial fold
- Fault
- Sample station
- Claims boundary
- Creek
- 5000 Topographic contour - CONTOUR INTERVAL - 500 feet
- Provincial Boundary

TRIDENT RESOURCES INCORPORATED (NPL)
 SEL 1-212 MINERAL CLAIMS
 ROSS RIVER AREA
 WATSON LAKE MINING DISTRICT, Y.T.

GEOLOGY MAP

MAP REF NTS 105 1

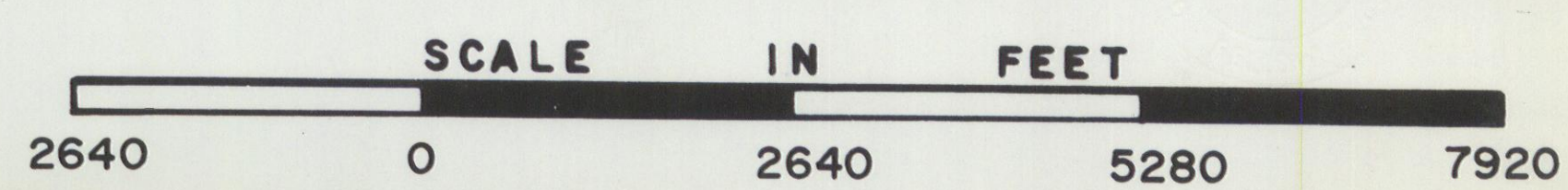

AGILIS ENGINEERING LTD.

SEPTEMBER, 1974.