

This report has been examined by
the Geological Evaluation Unit.
Approved as to technical worth by:

D. J. ...
RESIDENT GEOLOGIST

Approved as to cost in the amount
of: \$ 7200.00

H. P. ...
RESIDENT MINING ENGINEER

Accepted as representation work
under Section 53(4) Yukon Quartz
Mining Act.

[Signature]
COMMISSIONER OF YUKON

GEOCHEMICAL SOIL SAMPLING SURVEY

DUB and ZOT MINERAL CLAIM GROUPS

FYRE LAKE AREA
Watson Lake Mining Division
Yukon Territory

Long. 130° 30' West
Lat. 61° 15' North

by

John S. Brock
Atlas Explorations Limited

June 23 - July 30, 1966

GEOLOGICAL SURVEY

[Signature]
FEB 13/67

Resident Geologist
Whitehorse, Y. T.

GEOCHEMICAL SOIL SAMPLING SURVEY
DUB and ZOT MINERAL CLAIM GROUPS

TABLE OF CONTENTS

	<u>Page</u>
KEY MAP	
LIST OF CLAIMS	
INTRODUCTION	1
LOCATION AND ACCESS	2
GEOLOGY	3
TOPOGRAPHY AND GROUND CONDITIONS	6
DUB I Area	6
DUB II Area	7
SURVEY TECHNIQUES	9
Linecutting	9
Soil Sampling	9
Method of Analysis	10
Treatment of Data	10
GEOCHEMICAL OBSERVATIONS	11
DUB I Zone	11
DUB II Zone	13
GEOCHEMICAL INTERPRETATIONS	16
CONCLUSIONS	18
 <u>APPENDICES</u>	
Log of Daily Progress - Party Chief's Weekly Reports . .	I
Personnel	II
Bibliography	III
Summary of Costs	IV
Affidavit Supporting Summary of Costs	V
DUB I Zone - Development Map	VI
DUB I Zone - 1) Zinc Geochem. Map	VII
2) Copper Geochem. Map	
DUB II Zone - 1) Zinc Geochem. Map	VIII
2) Copper Geochem. Map	
DUB II Zone - 1) Development Map	IX
2) Geologic Map	

KEY MAP



KEY MAP FYRE LAKE AREA
 Grid Location: DUB Mineral Claims

ATLAS EXPLORATIONS LIMITED

0 5000 ft.

LIST OF CLAIMS

<u>Claim No.</u>	<u>Grant Nos.</u>	<u>Date Recorded</u>
DUB 1 - 48	89964 - 90011	January 31, 1966
49 - 118	Y7411 - Y7480	April 27, 1966
119 - 148	Y13173 - Y13202	July 4, 1966
149 - 154	Y13662 - Y13667	August 30, 1966
155 - 164	Y13507 - Y13516	August 10, 1966
165 - 167	Y13756 - Y13758	September 9, 1966
ZOT 11 - 12	Y13517 - Y13518	August 10, 1966

ATLAS EXPLORATIONS LIMITED

(N. P. L.)

330 MARINE BUILDING
355 BURRARD STREET
VANCOUVER 1, B.C.

INTRODUCTION

Under an agreement with G. E. "Bud" Stephens, prospector, the DUB Mineral Claims 1 to 48, were acquired by Atlas Explorations Limited. The DUB Claim Group covered a known zone of copper mineralization that had previously been held and developed by Cassiar Asbestos Corporation Ltd. It was proposed by Atlas Explorations that the potential of the area be first assessed by airborne electromagnetic and magnetic methods. During March of 1966, Lockwood Survey Corporation was contracted to work under the direction of Atlas Explorations in conducting an extensive airborne geophysical survey over the claims and surrounding area. Encouraging results were obtained and additional staking was carried out, thus enlarging the DUB group to 121 mineral claims. Commencing in July 1966 a ground follow-up crew consisting of geologic, geophysical and geochemical survey personnel, were placed on the property to detail airborne geophysical anomalies and obtain new results over the known copper showing. The purpose of the ground surveys was to correlate the known mineralization and

airborne anomalies with geophysics and geochemistry in the hopes that possible extensions and new targets for diamond drilling could be outlined. Survey data obtained appeared to warrant drilling and a drill program was started in October of 1966.

LOCATION AND ACCESS

The Fyre Lake properties are located at latitude $61^{\circ}15'$ North and longitude $130^{\circ}30'$ West on the slopes facing the eastern shores of the lake. Fyre Lake is situated at the mid-point of the North River, shown on the Finlayson Lake topographic sheet. The anomalies investigated are described as the DUB I and DUB II anomalies. The DUB I is at an elevation of 3500 feet and approximately 1200 feet east of the southeastern shores of Fyre Lake. The DUB II is some four miles east of Fyre Lake and at an elevation of 4800 feet.

Access to the properties was made with the aid of aircraft only. Fyre Lake is suitable for all aircraft equipped with floats and skis. For investigation of the DUB I zone a base camp was established on the eastern shore of the lake. Another camp was set up on location for examination of the DUB II; this camp was usually serviced by helicopter but access could also be made by trail from the lake. Work on each of the properties was administered from field offices at Ross River, 82 miles northwest of Fyre Lake; constant

communications were kept with Ross River and Whitehorse exploration offices via single sideband radios.

GEOLOGY

The geology of the Fyre Lake groups is identical to that of Grass Lakes, consisting of a general sequence of quartz-biotite-chlorite schists that strike northwestward and dip gently to the northeast. At Fyre Lake the staked schist band is about six miles in width, lying between sizable stocks of intrusive granodiorite both to the northeast and southwest. It is postulated that a major fault or fracture system underlies the valley of Fyre Lake, through the middle of the claim groups, and is a branch of the Tintina system five miles to the southwest. Generally speaking the geological setting at Fyre Lake is identical to that at Vangorda-Dynasty, with airborne anomalies occurring within the favoured schist formation, adjacent to intrusive granodiorite bodies. A pyrite-chalcopyrite showing was staked by Cassiar Asbestos Corporation Ltd. in 1960. This surface showing consists of a 50 ft. wide northwesterly trending pyritic zone that contains narrow chalcopyrite bands along it. The showing was trenched and drilled by that company in 1961. Drilling indicated that the zone was a replaced flat layer of quartzose schist approximately 30 feet in thickness, conformable with the schists, with the upper 20

feet comprised of pyrite and quartz and the lower 10 feet comprised of pyrite, chalcopyrite, pyrrhotite and some sphalerite disseminated in quartz schist. The sulphide zone as determined by Cassiar Asbestos is about 400 feet long and 150 feet wide. Drilling of another anomaly 600 feet to the west revealed a similar sulphide body.

From a photo-geologic interpretation by W. Walker, the following geology was outlined:

The general geology of the area largely includes the Fyre Lake area. Clastic schists with minor limestone, clastic gneisses, and ultrabasic rocks all of indeterminate age, and greenstones of Mississippian or earlier age are described. In some areas on the photographs one can readily see the bedding of the schists and gneisses and more lumpy terrain of the volcanics. Commonly, however, glacial scouring and plucking, talus slopes and soil creep, and glacial deposits make both structural interpretation and rock typing difficult. No fold pattern, for example, becomes apparent.

Within the clastic metasediments there are commonly both sharp and vaguely defined fault traces. The latter are regarded as old faults, later annealed.

Most of the larger valleys appear to be fault

controlled, and lineation in the recent deposits is regarded as evidence of recent movement or differential deposition and compaction on bedrock faults.

One may anticipate that many faults in the area were initiated by horizontal (folding) pressures, and re-used when the acidic and basic rocks were intruded.

The deposit northeast of Fyre Lake is in clastic metasediments at the west end of a granitic intrusive. There are no major faults in the vicinity, but minor faults are numerous.

A comparison with this and the Anvil Mountain base metal area is readily drawn. Both are underlain principally by clastic meta-sediments intruded by granite, on the northeast side of the Tintina fault. In the Anvil Mountains most deposits are in the meta-sediments near the intersections of N.W. and N.E. faults, principally along a fault 5 miles northwest of the Tintina. The North River - Fyre Lake structure and intersecting N.E. faults provide a strictly comparable environment.

Faulting, rather than rock type, is considered most likely to control ore deposition. Most major fault intersections are covered by alluvium, and airborne geophysics provides the most convenient exploration approach.

Geologic mapping has been carried out in the area by Atlas Explorations but, at the time this report was compiled, a report on the geology as done by Atlas was not available.

TOPOGRAPHY AND GROUND CONDITIONS

DUB I Area

This portion of the DUB mineral claims lies in a glaciated terrain of rolling relief on the southeastern slopes running into Fyre Lake. Slopes are to the west, generally at 5 to 10 degrees. Elevations range from 3600 to 4200 feet above sea level, immediately to the east elevations rise to 6000 feet. The general direction of glaciation is northwest to ⁵⁰⁰ northeast, accumulations of glacial till are not to excess as being representative of lateral moraines remnant of the valley-type of glaciation in this area. Some morainal features are observed to the south end of Fyre Lake, however, no estimates of their thickness has been attempted. Soils are probably an accumulation of glacial and colluvial deposition, the colluvium is from steeper slopes directly to the east and boulders found in the glacial till appear to have been derived from ultra basic formations found to the north and northwest of Fyre Lake. Colluvium is comprised of detrital sediment, up slope material is made up of geologic rock types common to the area.

Little of the soil is probably remnant, however, some development of soil horizons is apparent. A thick layer of muskeg in some areas provides generation of a well defined A or organic zone. The B horizon is partially developed and the C horizon comprised of parental material of unknown source is well developed. Due to some irregularities in local topography, vegetational cover and drainage systems, soil types are not common over the survey area. Heavy organic content and some permafrost in places prevented proper soil sampling over some zones.

Vegetation consists of heavy second growth spruce over most of the survey area with dense patches of dwarf birch predominating in more open regions. Much of the ground, especially in swampy regions in topographic depressions, is covered with muskeg.

Local drainage in most cases is poorly defined and commonly consists of swampy depression. There is no major drainage pattern other than generally down slope to the west-southwest due to minor channels formed by seasonal run-off conditions.

DUB II Area

The DUB II grid covers a large portion of the "floor" area of a high cirque (elevation 4700 feet) two miles northeast of Fyre Lake. Some moraine and eskers estimated to be up to fifty feet in thickness, strike across the grid area.

Topography is irregular within the grid area due to broken rock formations and glacial features. Steep walls of the cirque surrounding the survey grid, except for the western end, are in such a position as to provide large accumulations of talus and colluvial deposition throughout the survey area. Soils within the survey area are variable due to accumulations of glacial material, however, some residual soils appear to be present due to some areas of exposed outcrop that provide parental material directly. In general a C type of soil horizon was common to the major portion of the grid. The B horizon was only partially developed in most areas sampled, organic zones were usually common only to soils found in topographic depressions or regions of heavy vegetational cover.

Vegetation consists of sparse clusters of spruce, some jackpine and dwarf brush. The elevation of the property provides conditions typical of the Yukon sub-alpine and vegetation is such.

Local drainage is well defined with two streams converging near the lower end of the grid to form the major drainage channel westward to Fyre Lake. Both streams follow good channels and alluvial deposition occurs only in bench areas near the stream banks.

SURVEY TECHNIQUES

Linecutting

The soil sampling survey was conducted over the same grids as used for the geophysical surveys, no extra linecutting was required other than that done for the magnetic and electromagnetic work¹.

Soil Sampling

The soil sampling survey was carried out in conjunction with the electromagnetic and magnetic survey. One soil sampler was employed for the entire survey.

The samples were obtained by use of a prospector's grub hoe which was found adequate as a tool for cutting through heavy layers of organic material overlying the soil. Samples were taken at 100 foot stations over the same grid area as geophysical data was obtained from.

Due to the inconsistency of specific soil horizons as well as variable depths to favorable horizons, samples were taken from an average depth of approximately one and one-half feet. Soils of the upper B horizon were usually encountered except in areas of much glacial till and overburden. Soils of large organic content were not sampled, in areas of immature soils the C horizon was sampled. Approximately 100 grams of soil from each sample site were placed in Kraft bags which were then periodically shipped to the soil testing laboratory at Ross River.

1. See Report "Magnetic & Electromagnetic Geophysical Surveys, DUB and ZOT Mineral Claim Groups."

Method of Analysis

All samples were analysed at a complete testing laboratory at Ross River. When the samples were received, each was dried while in its Kraft bag, then screened to 80 mesh, weighed out to 0.5 grams and digested in hot aqua regia. Samples were then diluted, clarified for 20 hours and then tested for copper, lead and zinc content on an atomic absorption spectrophotometer. The 'AA' unit used was a Perkins Elmer Model 290 and accuracy of the instrument ideally is 1% of the amount of metal present. Individual cathode lamps were used for each element determination, a direct readout is given of the element being tested and two determinations per minute can be made with ease.

Treatment of Data

All results of geochemical tests were returned to the field as soon as possible. Results in parts per million (ppm) were plotted on field data sheets kept by the field soil sampler. The field data sheets were kept as a record of each sample taken, noting particulars concerning drainage, topography, physiography, soil type and depth of sample. This information was compiled for use in further detailed geochemical studies.

Separate maps were prepared¹ using a scale of 1":200', as was used for geophysical data, showing values

1. See Appendix:Map File

obtained for copper, lead and zinc, profiles of values and contoured values. Contour intervals varied according to results obtained in parts per million. Maps for each element were compiled separately in order to aid in comparative study of geophysical, geologic and geochemical results. A development map for each area has also been prepared showing general compilation of geochemical-geophysical data.

GEOCHEMICAL OBSERVATIONS

DUB I Zone

Examination of copper geochemical results on a statistical evaluation of the grid plot shows that a threshold value for this zone would be in the order of 80 - 100 ppm. The most distinctive trend of anomalous copper 'highs' appears between lines 4S and 16S where a maximum value of 375 ppm is coincident with the western peak of a major magnetic anomaly delineated over this grid. At the eastern end of this magnetic anomaly, line 28S a 365 ppm Cu high can be matched with the magnetics at station 13+00E. At station 10+00E on line 28S a 460 ppm Cu anomaly occurs. On line 40S, a 480 ppm value with a build up above threshold over 300 feet width is located south of a magnetic expression at L32S - 5+00E. The same magnetic anomaly also appears to have some geochemical coincidence on the base line between line 32S and line 28S.

A 760 ppm Cu value is located on Line 4N - 11+00E, a location immediately on strike although upslope from a strong magnetic response. The highest Cu response was obtained on Line 0 at 22+00E for over 600 feet, the values were all obtained from this one line.

Copper anomalies with respect to their coincidence with electromagnetic survey results is not as pronounced as with magnetic results. However, at the eastern extremities of line 12N and 8N a geochemical buildup in excess of 200 ppm copper occurs in proximity to a well defined electromagnetic anomaly that has no magnetic coincidence.

Zinc threshold value for the DUB II zone has been determined as being approximately 100 - 120 ppm. A 300 ppm zinc anomaly occurs at line 0, 8+00E, another zinc 'high' is found at line 6, 25+00E, where values in excess of 600 ppm occur over 200 feet. Some geochemical response is obtained over the major magnetic anomaly at line 8S - 12+00E, with 176 ppm, 480 ppm at L12S - 11+00E, and line 20S - 12E with 1500 ppm. Down slope from the peak of this magnetic anomaly and offset from another localized magnetic response 740 ppm zinc is obtained at line 28S - 5E. On the baseline near line 24S zinc is above background over a magnetic closure. Zinc values above threshold are noted near most of the EM-magnetic coincidences with outlines of anomalous zinc areas usually corresponding to zones of higher conductivity.

DUB II ZONE

Geochemical copper results are complex and scattered in nature, analysis of results was done by general outlining of areas above threshold value. Threshold was determined to be over 200 ppm with background below 100 ppm copper. Four areas of over 500 ppm and three others in which copper reached values of 300 ppm were outlined. These zones of geochemical highs occur at the following grid co-ordinates.

Over 500 ppm	(A)	Line 16N-36N	at	6+00W
	(B)	Line 16N-10N	at	5+00E
	(C)	Line 8N- 6S	at	4+00E
	(D)	Line 6S-12S	at	21+00E
Over 300 ppm	(E)	Line 8N-0	at	11+00W
	(F)	Line 12N- 4N	at	35+00W
	(G)	Line 16S-20S	at	1+00W

Anomaly 'A' occurs over an area of no outcrop on a gently sloping hill to the southwest. Anomaly 'B' is over known sulphide mineralization and possible extension of a known ore zone. Anomaly 'C' has its northern portion over known surface sulphide mineralization, the southern portion is in a topographic low and area of drainage accumulation. 'D' is over known surface mineralization, 'E' is within an area of drainage accumulation, 'F' is in a swamp found on a bench at the lower reaches of the valley leaving the cirque and 'G' occurs on a talus slope that is steeply dipping to the north-east.

Zinc results were examined with a chosen background value of 150 ppm and a threshold value of 200 ppm. Six areas of over 500 ppm were noted at the following coordinates:

- (A) Line 0, 28+00W
- (B) Line 4S, 5+00E
- (C) Base Line, Line 16S - 20S
- (D) Line 24S - 32S, 13+00W
- (E) Line 40S, 11+00E
- (F) Line 8S - 10S, 21+00E

The presence of copper mineralization within the grid area emphasises the study of copper geochemical features and coincident geochemical-geophysical anomalies. A table has been prepared to aid in comparison of geochemical anomalies and their associated characteristics:

<u>Cu Anomaly</u>	<u>Cu Location</u>	<u>Cu Peak Value</u>	<u>Zn Coincidence</u>	<u>Zn Peak Value</u>	<u>Geophysical Coincidence</u>	<u>Topographic Features</u>
(A)	Line 16N-36N at stn. 6W	>500 ppm			Mag at south end. Mag to north.	No outcrop, hillside slopes gently to southwest.
(B)	Line 6N-10N at stn. 5E	>500 ppm			North end of mag anomaly representing ore body.	Over known sulphides and possible extension of ore zone,
(C)	Line 8N-6S at stn. 4E	>500 ppm	Line 4S Stn. 5E	>500 ppm	Northeast portion on mag coin- cidence.	South slopes to topo- graphical low at south end.
(D)	Line 6S-12S at stn. 21E	>500 ppm	Line 8S-10S Stn. 21E	>500 ppm	Magnetic anomaly.	Known mineraliza- tion.

GEOCHEMICAL INTERPRETATION

Good coincidence between copper and zinc geochemical results are obtained at the following co-ordinates on the DUB I grid. In all cases anomalies are not entirely coincident as mobility of zinc and copper ions are recognized as having different characteristics.

Copper Zinc Coincidences:

<u>Line</u>	<u>Station</u>
0S	23+00E - 28+00E
0S	5+00E - 8+00E
4S	11+00E
8S	13+00E
12S	4+00E - 10+00E
16S	13+00E
24S	5+00E
28S	10+00E
24S	0+00
36S	0+00

Coincident geochemical anomalies are coincident or only slightly removed (within 200 feet) from three of the major electromagnetic-magnetic geophysical anomalies. These have centres located at L 16S - 12+00E, L 8S - 4+00E, and L 28S - 5+00E.

As no geologic data is available other than several reported float occurrences in which chalcopyrite mineralization was found, it is assumed that a combination of coincident electromagnetic-magnetic and combined copper-zinc anomalies

are representative of possible zones of economic mineralization.

Some of the anomalies, especially in the vicinity of line 4S - 16S at 11+00E, are thought to be due to hydromorphic action from up slope drainage. The copper-zinc anomaly found on line 0 - 22+00E is 'open' at its southern end and if it does continue to the south, may therefore be a source of its downslope counterpart.

On the DUB II grid areas of high copper (over 500 ppm) geochemistry can be related to known mineralization. In general, lower copper values (less than 300 ppm) appear to be associated with drainage accumulation basins, swampy depressions and topographic lows with the exception of the anomaly at line 16S - 20S, station 1W which is on a talus slope. High (over 500 ppm) zinc anomalies are coincident with high copper results in two areas, both of which have associated magnetic characteristics. Zinc values do not occur over the northern end of the grid where good copper results were obtained, high mobilization characteristics commonly associated with zinc geochemistry are not evident either. The copper results appear to be susceptible to hydromorphic action, however peak values can be correlated to known mineralization and well defined geophysical anomalies thought to represent mineralization.

CONCLUSIONS

Zinc and copper geochemistry when used as a tool to evaluate geophysical results on the DUB I and II grids appears to be useful. With limited geologic information, as on the DUB I grid, geochemistry is the only support in interpretation of geophysics and should be used as such.

In the DUB II area there is much evidence of known mineralization and geochemistry can be used to outline possible extensions of such to the north and southeast.

Respectfully submitted,



John S. Brock,
Assistant Exploration Manager.
Atlas Explorations Limited.

FYRE LAKE AREA

DUB and ZOT MINERAL CLAIMS

GEOCHEMICAL SURVEY

Log of Daily Progress
as per Party Chief Weekly Reports

PROJECT... FYRE LAKE...

ATMS EXPLORATION LIMITED

PERIOD

From... June 20 1966...To... June 26 1966...CLAIM GROUP... ASH, DUB 1, ANT (AKE)PARTY CHIEF... PHIL NIELSEN

PERSONNEL	POSITION	TIME	WAGE
<u>Doug Lima</u>	<u>Cook</u>	<u>7 days</u>	<u>\$450 per month</u>
<u>One Clerk</u>	<u>Lincutter</u>	<u>7 days</u>	<u>\$140 per week</u>
<u>Jim Robinson</u>	<u>"</u>	<u>7 days</u>	<u>\$140 "</u>
<u>Woe Lohse</u>	<u>"</u>	<u>7 days</u>	<u>\$140 "</u>
<u>Sam Smorch</u>	<u>"</u>	<u>7 days</u>	<u>\$140 "</u>
<u>Bill Barclay</u>	<u>Mag Op.</u>	<u>7 days</u>	<u>\$450 per month</u>
<u>Peter Legut</u>	<u>E.M. Op.</u>	<u>7 days</u>	<u>\$495 "</u>
<u>Les L. Hultoot</u>	<u>"</u>	<u>7 days</u>	<u>\$400 per month</u>
<u>Pat Brownsword</u>	<u>Mechan Op.</u>	<u>7 days</u>	<u>\$375 per month</u>
<u>Timothy Brown</u>	<u>Geologist</u>	<u>2 days</u>	

Day Of Week	HELICOPTER		FIXED WING		LINECUTTING		GEOCHEM.		GEOPHYSICS				GENERAL
	Job	Hrs.	Job	Hrs.	Lines	Feet	Lines	No. Samples Taken	E.M.		MAG.		
									Lines	Ft.	Lines	Ft.	
Mon. 20	—	—	—	—	L 94 L 4 B.L. 3	1200 2000 600	RECON. ON CREEK ON ANT GP.	SILT SAMPLES 20-ANT	L 8 L 12 L 40 L 94	500 500 DUB	ASH	1200	LINECUTTERS ON DUB. E.M. ON DUB - TED: PHIL. GEOCHEM + GEOLOGY ON ANT. MAG. ON ASH.
Tues. 21	—	—	—	—	L 29, 12, 30 L 32, 16, 7 + 24	9000 3900	L 84 L 80 L 76	ASH 115	—	—	ASH	9000	MAG. CAUGHT UP ON ASH. LINECUTTERS ON ASH (W) STILL UNDER WATER BE- WEEN L 72 AND L 36
Wed. 22	PICKED UP TIM SADLER	30 MINS FROM OLD GOLD ROUN.	FROM OLD GOLD ROUN.	—	STARTED B.L. OF ANT. GROUP.	—	—	—	—	—	—	—	STORMS ALL DAY. VERY LITTLE WORK DONE. TIM WENT OUT TO RES. BY CHOPPER
Thurs. 23	—	—	BEAVER SUPPLIES	FROM ROSS BACK TO ROSS	B.L. L 0 L 8	4500 2900 1800	DUB 1 BASE- LINE.	DUB 1 38	—	—	DUB 1	2900	LINECUTTERS ON ANT GP. STILL STORMY. SLOW PROGRESS.
Fri. 24	—	—	—	ANT	L 40 W L 24 C L 40 E L 32	2000 900 2000 2220	—	DUB 1 96	L 16 L 20 L 24 L 28	5000 DUB	DUB 1	2000	" " "
Sat. 25	—	—	—	ANT	L 32 L 24 L 0 E L 9 L 16	2000 3100 3000 1400 3600	—	DUB 1 100	L 32 L 36	5000 DUB	DUB 1	3000	LINECUTTERS FINISHED ANT USING OC X-LINES. STILL RAINING.
Sun. 26	—	—	—	DUB 1	L 0 L 48	2000 2000	—	DUB 1 50	L 4 L 0	5000 DUB	DUB 1	2000	ALL WORK ON DUB 1 E.M. US. MORE DAMN! RAIN. VERY DEPRESSING!
TOTAL				24 HRS		174700		419		27500		2700	WATSON MAKE BEAVER LANDED. MEN SAID THEY WERE SHEEP HUNTERS - VERY SUSPICIOUS!

* Peter Legut with Jim Sadler Browns. 2900
Jim worked 1 day on Ant Group (this week) 900

32100
1100

SUMMARY - FINALLY REC'D
GOOD MACHETE'S. WORK
HAMPERED BY 7 DAYS OF
CONTINUAL THUNDER STORMS.

PROJECT FX. LAKE

ATEMS EXPLORATION LIMITED

PERIOD From June 27 To July 3

CLAIM GROUP ASH, DUB 1, ANT

PARTY CHIEF PHIL NIELSEN

PERSONNEL	POSITION	TIME	WAGE
<u>DOUG TIZYA</u>	<u>COOK</u>	<u>Days</u>	<u>\$450 per month</u>
<u>JOE KIEHL</u>	<u>LINECUTTER</u>	"	<u>#140 per week</u>
<u>JIM ATKINSON</u>	"	"	<u>#140 " "</u>
<u>MAC LAQUE</u>	"	"	<u>#140 " "</u>
<u>SAM SMARCH</u>	"	"	<u>#140 " "</u>
<u>BILL BARCLAY</u>	<u>MAG. OP.</u>	"	<u>#450 per month</u>
<u>PETER TEGART</u>	<u>G.M. OP.</u>	<u>2 day less</u>	<u>\$475 " "</u>
<u>TED LIGHTFOOT</u>	"	"	<u>\$400 " "</u>
<u>PAT BROWNSWORD</u>	<u>GEOCHEM OP.</u>	"	<u>#375 " "</u>

Day Of Week	HELICOPTER		FIXED WING		LINECUTTING		GEOCHEM.		GEOPHYSICS				GENERAL	
	Job	Hrs.	Job	Hrs.	Lines	Feet	Lines	No. Samples Taken	E.M.		MAG.			
									Lines	Feet	Lines	Feet		
Mon. 27					STAKED CLAIMS	DUB GP.	L44 L48 DUB 1	50						MORE RAIN. MAG. OP. PLOTTED RESULTS. I TOOK LINECUTTERS STAKING SO NO E.M. DONE.
Tues. 28					ASHGP L36W L29W L29W	1700 1800 2000	68 69,44 60,44 53,48	90 ASH	L20 L8 L16 L34	15 500	B.L. L0,62 L16,124 L34	1700 ANT	LINECUTTERS + GEOCHEM ON ASH E.M. + MAG ON ANT GP.	
Wed. 29					L95, L52 L58, L60 L57	9200 9200	L012, 16, 20 24, 23, 2 36, 40	101 ASH	PLOTTED E.M.		L32 L40 L8	200 ANT	LINECUTTERS + GEOCHEM ON ASH. MAG. ON ANT ANT GP TESSALATED BUT DOCK	
Thurs. 30					L74, L12 L0, 4, 8	5000 ANT 4500 ASH	SLOUGH AREA.	20 ASH.	L32 L40	3000			MAG. PLOTTED RESULTS. GEOCHEM ROUGH GOING DUE TO SWAMP. LINECUTTING ON ASH FINISHED.	
Fri. July 31			SUPPLIES + JOHN BROCK (WENT OUT SAME TRIP)	1 AN FROM ROSS	900 + 1000 ANT	4500 5000	L44, L48 L52, L56 L60.	80 ASH.				ANT	GEOCHEM FINISHED ON ASH.	
Sat. 32			BROUGHT IN VIC WRIGHT + PETER TEGART	1 AN FROM ROSS.	L52 + L56 DUB 1 ANT	7000 4000			ANT	3000	PLOTTED RESULTS OF		SOIL SAMPLER ON E.M. MAG FINISHED ANT GP.	
Sun. 3					CUT WOOD + TOOK IT	EASY	DUB 1	40	ANT DUB 1	3000 5200		ASH	PETER TEGART BACK ON E.M. ALL LINECUTTING FINISHED ON ASH; ANT + DUB 1	
TOTAL				4 HRS				381		87		3300 200	PREPARING FOR CAMP MOVE TO DUB GROUP UP THE HILL	

14
9
560
16
11
10
12
4700 - 1000 Jim
16100
10000

VIC WRIGHT STAYING UNTIL TUES SU-Y 5. CAME IN SAT SU-Y 4 1/2

PROJECT F. VE LAKE

ATEAS EXPLORATION LIMITED

PERIOD From May 30 - 7/1/66
To Sept. 5 - 12/66

CLAIM GROUP ASH + DUB

PARTY CHIEF PHIL NIELSEN

PERSONNEL	POSITION	TIME	WAGE
<u>DOUG TIZYA</u>	<u>COOK</u>	<u>1450</u>	<u>16450/mo.</u>
<u>JOE ETZEL</u>	<u>LINECUTTER</u>	<u>1200/mo.</u>	<u>140/wk.</u>
<u>LIM ATKINSON</u>	<u>"</u>	<u>1200/mo.</u>	<u>140/wk.</u>
<u>MARK LADUE</u>	<u>"</u>	<u>"</u>	<u>140/wk.</u>
<u>SAM SMARCA</u>	<u>"</u>	<u>"</u>	<u>140/wk.</u>
<u>BILL BARCLAY</u>	<u>"</u>	<u>"</u>	<u>140/wk.</u>
<u>PETE TEGART</u>	<u>MAG. OP.</u>	<u>15450/mo.</u>	<u>1450/mo.</u>
<u>TED LIGHTFOOT</u>	<u>E.M. OP.</u>	<u>1375/mo.</u>	<u>1975/mo.</u>
<u>PAT BROWN SWORD</u>	<u>E.M. O.P.</u>	<u>1400/mo.</u>	<u>1200/mo.</u>
	<u>GEOCHEM OP.</u>	<u>1375/mo.</u>	<u>1375/mo.</u>

Day Of Week	HELICOPTER		FIXED WING		LINECUTTING		GEOCHEM.		GEOPHYSICS				GENERAL
	Job	Hrs.	Job	Hrs.	Lines	Feet	Lines	No. Samples Taken	E.M.		MAG.		
									Lines	Ft.	Lines	Ft.	
Mon. 4	-	-	-	-	-	-	-	-	ASH	1200	ASH	1000	LINECUTTERS + I CHECKED CLAIMS + NEW CAMP LOCATIONS. GEOCHEM OP. RECORDED FROM RUST STAIN ON MTN.
Tues. 5	-	-	SUPPLIES + GAS FOR CHOPPER.	2 TRIPS FROM ROSS. WENT TO OLD GOLD ONE TRIP.	-	-	-	PLOTTED GEOCHEM RESULTS - ASH.	ASH	1200	ASH	1500	PREPARED FOR CAMP MOVE. E.M. + MAG. ON ASH SWAMP.
Wed. 6	CAMP MOVE UP TO OLD CASSIAR PROP.	APPROX. 4 HRS.	-	-	-	-	-	DUB 2	ASH	1000	DUB 2	-	E.M. FINISHED ASH GP. REST OF CREW HELPED MOVE CAMP.
THURS. 7	-	-	-	-	LINECUTTERS MADE TENT FRAME FOR COOK HOUSE, ETC.	-	-	DUB 2	DUB 2	-	DUB 2	-	STUDENTS + I LOCATED CLAIM POSTS + DRILL HOLES. CLAIMS ALL BALLED UP. LINECUTTER WORKED ON CAMP.
Fri. 8	-	-	-	-	B.L. - North 2800'	-	-	DUB 2	DUB 2	-	DUB 2	-	SAM SMARCA ILL. E.M. CREW CLEANED UP OLD CAMP + PAINTED BOAT. MAG + GEOCHEM OPS. PLOT I SET UP BASELINE + TURNED CROSS LINES.
Sat. 9	-	-	-	-	LON 3000 L9N 2800 L8N 2800 L12N 2800	-	-	-	-	-	ASH	-	E.M. CREW + SOIL SAMPLER CUT LINE. MOST OF CREW SICK - POSSIBLY FOOD POISONING.
Sun. 10	SUPPLIES + T.S. PROP. RETURN FROM	2 1/2 HRS.	-	-	L5N 3500 L7S 1900	-	-	PLOTTED ASH	DUB 2	1300	DUB 2	1000	SHOCCER-BROWN ARRIVED.
TOTAL		6 1/2 HRS.		2 HRS.		3000				3700		2500	

25
36
50 16000 - MAG

15
25
44

PROJECT FY LAKE

ATEMS EXPLORATIO LIMITED

PERIOD

From July 11, 66
To July 17, 66

CLAIM GROUP DUB 2

PARTY CHIEF PHIL NIELSEN

PERSONNEL	POSITION	TIME	WAGE
<u>DOUG TIZYA</u>	<u>COOK</u>		<u>950/mo</u>
<u>JOE ETZEL</u>	<u>LINECUTTER</u>		<u>120/day</u>
<u>LIM ATKINSON</u>	<u>" "</u>		<u>120/day</u>
<u>MAC LADUE</u>	<u>" "</u>		<u>120/day</u>
<u>SAM SMARCH</u>	<u>" "</u>		<u>120/day</u>
<u>BILL BARLLAY</u>	<u>MAG. OP.</u>		<u>850/mo</u>
<u>PETE LEGART</u>	<u>E.M. OP.</u>		<u>875/mo</u>
<u>TED LIGHTFOOT</u>	<u>" "</u>		<u>400/mo</u>
<u>PAT BROWNSWORD</u>	<u>GEOCHEM OP.</u>		<u>375/mo</u>
<u>TIM SADLER-BROWN</u>	<u>GEOLOGIST</u>		

Day Of Week	HELICOPTER		FIXED WING		LINECUTTING		GEOCHEM.		GEOPHYSICS				GENERAL
	Job	Hrs.	Job	Hrs.	Lines	Feet	Lines	No. Samples Taken	E.M.		MAG.		
Mon. 11	-	-	-	-	B.L. L12N L24N L85	3500S 3600E 4900 4900	DUB 2	140	DUB2	18000	DUB 2	18000	GEOLOGY DONE. I STAKED CLAIMS.
Tues. 12	-	-	SUPPLIES FROM ROSS RIVER	2 HRS	L40S L32 L48	3000W 6000 3000W	DUB 2	155	DUB2	15000	DUB 2	70000	TIM & I LOCATED VEINVEST. LOCATED E.M. ANOMALIES AT SOUTH END OF CLAIM GROUP.
Wed. 13	-	-	SUPPLIES FROM ROSS RIVER	2 HRS	L90S L98S	3000E 3000E	DUB 2	165	DUB 2	-	DUB 2	1	MAG. OP. SE. MACNEILSON LINECUTTER MYSELF
Thurs. 14	-	-	-	-	L12S L10S L65 L25	10000	DUB 2	100	DUB 2	18000	DUB 2	18000	PACKED SUPPLIES FROM LAKE I set up more accurate grid near Shewing. Lino at 200' intervals.
Fri. 15	-	-	-	-	L22N L6N B.L2	7000	DUB 2	110	DUB 2	18000	DUB 2	11000	GEOLOGY DONE. E.M. tagged. GEOLOGY DONE.
Sat. 16	-	-	-	-	L28N L32N L36S L28S	36000 36900	DUB 2	TAGGED CLAIM POSTS	DUB2	000	DUB2	17000	CLAIMS TAGGED. I LOCATED CLAIMS. GEOLOGY DONE.
Sun. 17	SUPPLIES IN FROM ROSS	1 HR.	-	-	L20N L16NS	6000	DUB 2	60	DUB2	18000	DUB2	10000	TIM, JOE & I RESTAKED CLAIMS. LATER CHANGED AGAIN.
TOTAL		1 HR.	2 HRS			71,860		730					

93900

Work progressing smoothly despite rough terrain.

PROJECT FX²E LAKES

THE ENFORM 'S LIMITED

MEMPHIS

From JULY 5/66
To JULY 24/66

CLIENT GROUP DUB 2

PARTY CHIEF PHIL NIELSEN

MURRAY SIMPSON

E.M. OP. (came in July 22/66)

\$950/mo

PERSONNEL DOUG TIZYA

POSITION COOK

TIME

RATE \$950/mo

JOE ETZEL

LINECUTTER

SIM ATKINSON

"

MACK LAQUE

"

SAM SMARCH

"

BILL BARCLAY

MAG. OP.

PETE TEGART

E.M. OP.

TED LIGHTFOOT

E.M. OP.

PAT BROWNSWORD

GEOCHEM OP.

TIM SADLER-BROWN

GEOLOGIST.

\$950/mo

\$475/mo

\$400/mo

\$375/mo

Day of Week	HELICOPTER		FIXED WING		LINECUTTING		GEOCHEM		GEOPHYSICS				GENERAL	
	Job	Hrs	Job	Hrs	Lines	Feet	Lines	No. Samples Taken	E.M.		Mag			
									Lines	Ft	Lines	Ft		
Mon. 18	—	—	—	—	—	—	—	—	—	—	—	—	—	CREW TOOK DAY PETE TEGART OFF LEFT FOR HUNDEGG GROUP
Tues. 19	RECCE. GEOLGY DUB	1/2 HR.	—	—	DUB 2	10,000	SILT SAMPLED CREEK.	30	ONLY ONE E.M. OP. SILT SAMPLED	20	—	—	—	SAM SMARCH ILL. WENT OUT TO WHITEHOR
Wed. 20	—	—	SUPPLIES IN.	2 HRS.	—	—	—	—	DID GEOLGY WITH T.S. BROWN-DUB I	—	DUB 2	10,000	—	PLANE CAME IN WITH JUICE, MEATBALLS & SYRUP ONLY. VERY POOR SHOW!!
Thur. 21	—	—	—	—	2 CUTTERS ON DUB 2	6000	DUB 2	115	SILT SAMPLED	15	DUB 2	8,000	—	ONE LINECUTTER # I STRAIGHTENED OUT DUB 2 CLAIMS #1-#8.
Fri. 22	—	—	SUPPLIES	2 HRS.	DUB 1 EXTENSION	6000	SILT SAMPLED	30	STAKED CLAIMS	DUB 2	PLOTTED DUB 2	—	—	GEOLOGIST & COOK PACKED UP SUPPLIES FROM LAKE. MURRAY SIMPSON STARTED WORK
Sat. 23	—	—	—	—	"	5000	GEOCHEM SOILS & PLOTTED	45	2295; 205; 165; 125; 85-DUB 2	500	STAKED CLAIMS	DUB 2	—	BILL T STAKED DUB CLAIMS #4-6 CREW MOVED TO LAKE (FYRE) IN EVENING.
Sun. 24	—	—	—	—	"	4000	DUB 1 EXTENSION	160	DUB 1 EXTENSION	16,000	DUB 1 EXTENSION	16,000	—	GEOLGY - DUB 2 ALL WEEK.
TOTAL		1/2 HR.		4 HRS.		32,000		380		38,500		39,000		

PROJECT PY E LAKE

ATEMS EXPLORATION LIMITED

PERIOD From JULY 25 '66
To JULY 31/66

CLAIM GROUP TAK
PARTY CHIEF PHIL NIELSEN

PERSONNEL	POSITION	TIME	WAGE
<u>DOUG PIZVA</u>	<u>COOK</u>	<u>\$450/mo</u>	<u>7 days</u>
<u>TIM ATKINSON</u>	<u>LINECUTTER</u>	<u>20/day</u>	<u>"</u>
<u>JOE ETZEL</u>	<u>"</u>	<u>"</u>	<u>"</u>
<u>MACK LAQUE</u>	<u>"</u>	<u>"</u>	<u>"</u>
<u>GEORGE JOHNNY</u>	<u>"</u>	<u>"</u>	<u>6</u>
<u>BILL BARCLAY</u>	<u>MAG. OP.</u>	<u>\$450/mo</u>	<u>7</u>
<u>TED LIGHTFOOT</u>	<u>E.M. OP.</u>	<u>\$400/mo</u>	<u>7</u>
<u>MURRAY SIMPSON</u>	<u>"</u>	<u>\$450/mo</u>	<u>7</u>
<u>PAT BROWNSWORD</u>	<u>GEOCHEM OP.</u>	<u>\$375/mo</u>	<u>7</u>
<u>TIM SADLER-BROWN</u>	<u>GEOLOGIST</u>	<u>-</u>	<u>7</u>

Day Of Week	HELICOPTER		FIXED WING		LINECUTTING		GEOCHEM.		GEOPHYSICS				GENERAL
	Job	Hrs.	Job	Hrs.	Lines	Feet	Lines	No. Samples Taken	E.M.		MAG.		
									Lines	Feet	Lines	Feet	
Mon. 25	-	-	-	-	-	-	-	-	ANT	7000	-	-	CREW WAITED FOR CHOPPER TO FACILITATE CAMP MOVE DID NOT SHOW.
Tues. 26	CAMP MOVE	9 HRS	-	-	-	-	-	-	✓	-	-	-	MOVED CAMP TO TAK GP. FROM DUB II
Wed. 27	-	-	-	-	-	-	-	-	-	-	-	-	WEATHER BAD. IMPROVED CAMP.
Thurs. 28	-	-	-	-	BASE-LINE	7000	-	-	-	-	-	-	GGG CREW IMPROVED CAMP + CUT WOOD.
Fri. 29	-	-	-	-	-	9100	BASE-LINE	70	BASE-LINE	7000	BASE-LINE	7100	GEOLOGIST REC'D.
Sat. 30	SUPPLIES FROM AYRE LACE	3 HRS 20 MINS	SUPPLIES FROM ROSS TO LAKE.	2 HRS	-	12,000	TAK.	150	MAPPED RESULTS of DUB II	-	-	-	HALF-FILLED BEAVER CAME IN - POOR SHOW! VERY EXPENSIVE SUPPLIES CHOPPER IN AGAIN WITH SUPPLIES FORGOTTEN YESTERDAY
Sun. 31	PROPANE TANK	3 HRS	-	-	-	15,000	TAK	210	-	-	-	19,000	GEOLOGY DONE ALL
TOTAL		15 HRS		2 HRS		73,000							WEEK.

GEORGE JOHNNY STARTED WORK TUES JULY 26.

PERSONNELFYRE LAKE GEOLOGICAL, GEOPHYSICAL,
GEOCHEMICAL CREW

SURVEYS: DUB Mineral Claims

Phil Nielsen	Party Chief	1600 Beach Ave., Vancouver, 5, B.C.
Peter Tegart	EM Operator	4438 W. 13th, Vancouver, 8, B. C.
Murray Simpson	EM Operator	c/o General Delivery, Whitehorse, Y.T.
Ted Lightfoot	EM Operator	7081 - 232nd Street, R.R.7, Langley, B.C.
William Barclay	Magnetometer Operator	6040 Iona Dr., Vancouver, 8, B.C.
Patrick Brownsword	Geochemical Sampler	3563 Quebec St., Vancouver, 10, B.C.
Timothy Sadlier-Brown	Geologist	1490 Edgecliffe Ave., Ottawa, 3, Ont.
Douglas Tizya	Cook	c/o General Delivery, Whitehorse, Y.T.
Joe Etzel	Linecutter	c/o General Delivery, Whitehorse, Y.T.
Sam Smarch	Linecutter	c/o General Delivery, Teslin, Y.T.
Mac Ladue	Linecutter	c/o General Delivery, Ross River, Y.T.
Jim Atkinson	Linecutter	c/o General Delivery, Ross River, Y.T.
George Johnny	Linecutter	c/o General Delivery, Ross River, Y.T.

BIBLIOGRAPHY: MAGNETIC AND ELECTROMAGNETIC
GEOPHYSICAL SURVEYS
DUB and ZOT MINERAL CLAIM GROUP

- J. O. Wheeler Sheet 105G, Finlayson Lake Area,
G.S.C. Map 8 - 1960.
- Gabrielse and Wheeler "Tectonic Framework of Southern
Yukon and Northwest British
Columbia (1961)".
- D. Campbell Consultant's Report, Fyre Lake
Area (1966) - A private report to
Atlas Explorations Limited.
- S. H. Pilcher and
W. N. Plumb Cassiar Asbestos Corporation Ltd.
ABEM Magnetometer Survey "E" Zone,
Fyre Lake Area (1961) - A private
report to Cassiar Asbestos
Corporation Ltd.

FYRE LAKE AREA PROJECT
 DUB and ZOT MINERAL CLAIM GROUPS
GEOCHEMICAL SOIL SAMPLING SURVEY

SUMMARY OF COSTS

1.	Wages and Salary June 22, 1966 - July 30, 1966 39 days at \$20.00/day	\$ 780.00
2.	Subsistence, Room and Board in the field at \$12.00/man/day for for 39 days	468.00
3.	Overall Supervision of Sampling Survey at pro rated cost of \$10.00/man/day	390.00
4.	Aircraft Support charges, helicopter move of camp DUB 1 zone to DUB 2 zone, 6 hrs. @ \$110.00/hr contract rate G3B1 Helicopter from Klondike Foothills Aviation	660.00
5.	Aircraft Support Charges, Fixed Wing Service from Ross River to Fyre Lake, Round Trip 172 miles with Beaver Air- craft @ 75¢/mile, 4 trips total x 75¢ x 172 miles	517.00
6.	Total Cost Analysis of Samples for Trace Element Content by Atomic Absorption Photospectrometer Method. 1554 samples at \$2.50/each	3,885.00
7.	Preparation of Report and Presentation of Data	500.00
		<hr/> \$ 7,200.00 <hr/>

TELEPHONE 685-4331

ATLAS EXPLORATIONS LIMITED

(N. P. L.)

330 MARINE BUILDING
355 BURRARD STREET
VANCOUVER 1, B. C.

AFFIDAVIT SUPPORTING SUMMARY OF COSTS:

I, John, S. Brock, Assistant Exploration
Manager of Atlas Explorations Limited, of Ross River,
Yukon Territory, do hereby state that to the best of
my knowledge and belief the statement of costs as
presented in this report "Geochemical Soil Sampling
Survey - DUB and ZOT Mineral Claim Groups" (Appendix IV)
is both correct and true.

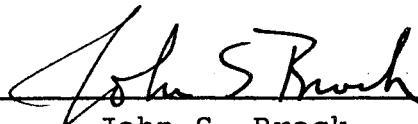

John S. Brock

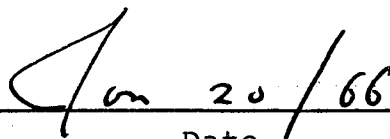

Date



A Commissioner of Oaths
in and for the Yukon
Territory

ATLAS EXPLORATIONS LTD.
 ROSS RIVER, YUKON
 FYRE LAKE AREA
 DUB MINERAL CLAIMS
 GEOCHEMICAL SOIL SAMPLING SURVEY
 ZINC RESULTS BY ATOMIC ABSORPTION
 SPECTROPHOTOMETER ANALYSIS

Scale: 1" = 200'
 1/10" = 25 p.p.m.
 Soil sampler: P. Brownsword
 Party chief: P. Nielson
 Date: August 1966
 Drawn by: *al. Nielsen*

claim posts Dub 53.54

DUB 1 ANOMALY

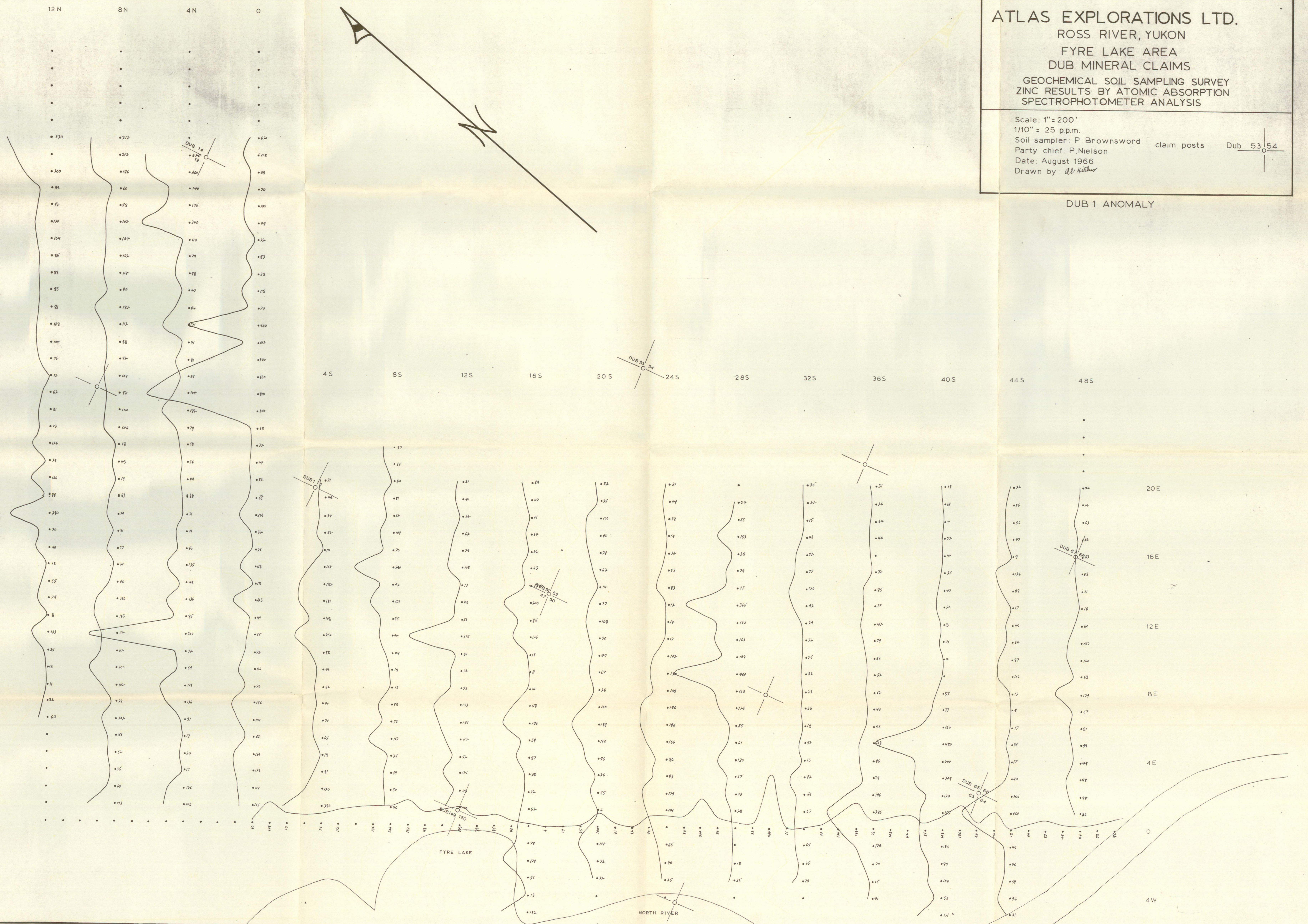

ATLAS EXPLORATIONS LTD.
 ROSS RIVER, YUKON
 FYRE LAKE AREA
 DUB MINERAL CLAIMS

GEOCHEMICAL SOIL SAMPLING SURVEY
 COPPER RESULTS BY ATOMIC ABSORPTION
 SPECTROPHOTOMETER ANALYSIS

Scale: 1" = 200'
 1/10" = 25 p.p.m.
 Soil sampler: P. Brownsword
 Party chief: P. Nielson
 Date: July 1966
 Drawn by: *Al Hillman*

CLAIM POSTS DUB $\frac{67}{65} \frac{68}{66}$

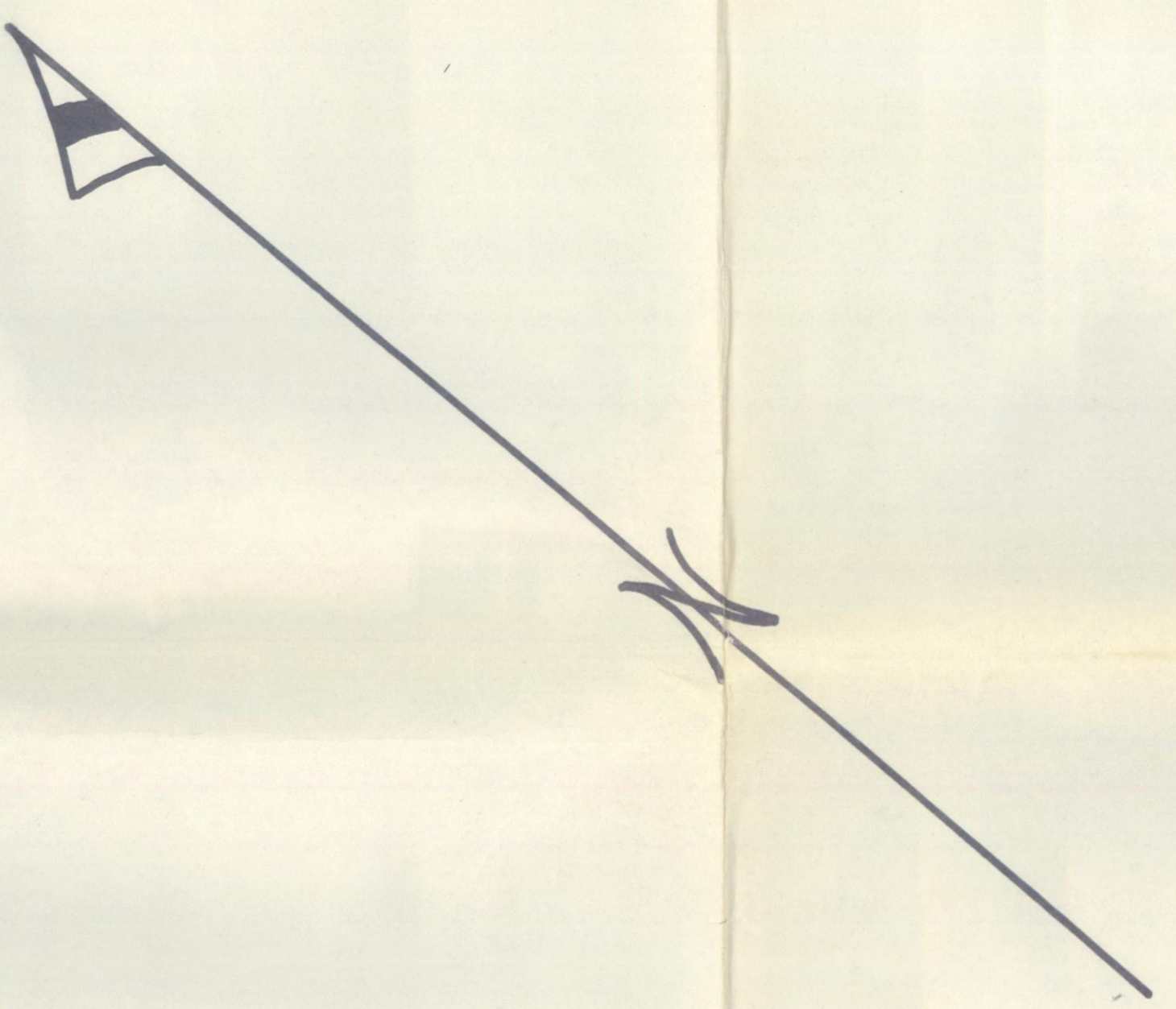

DUB 53 54
 51 52

DUB 14 12

DUB 51 52

DUB 67 68
 65 66

DUB 65 66
 63 64

DUB 45 50
 149 150

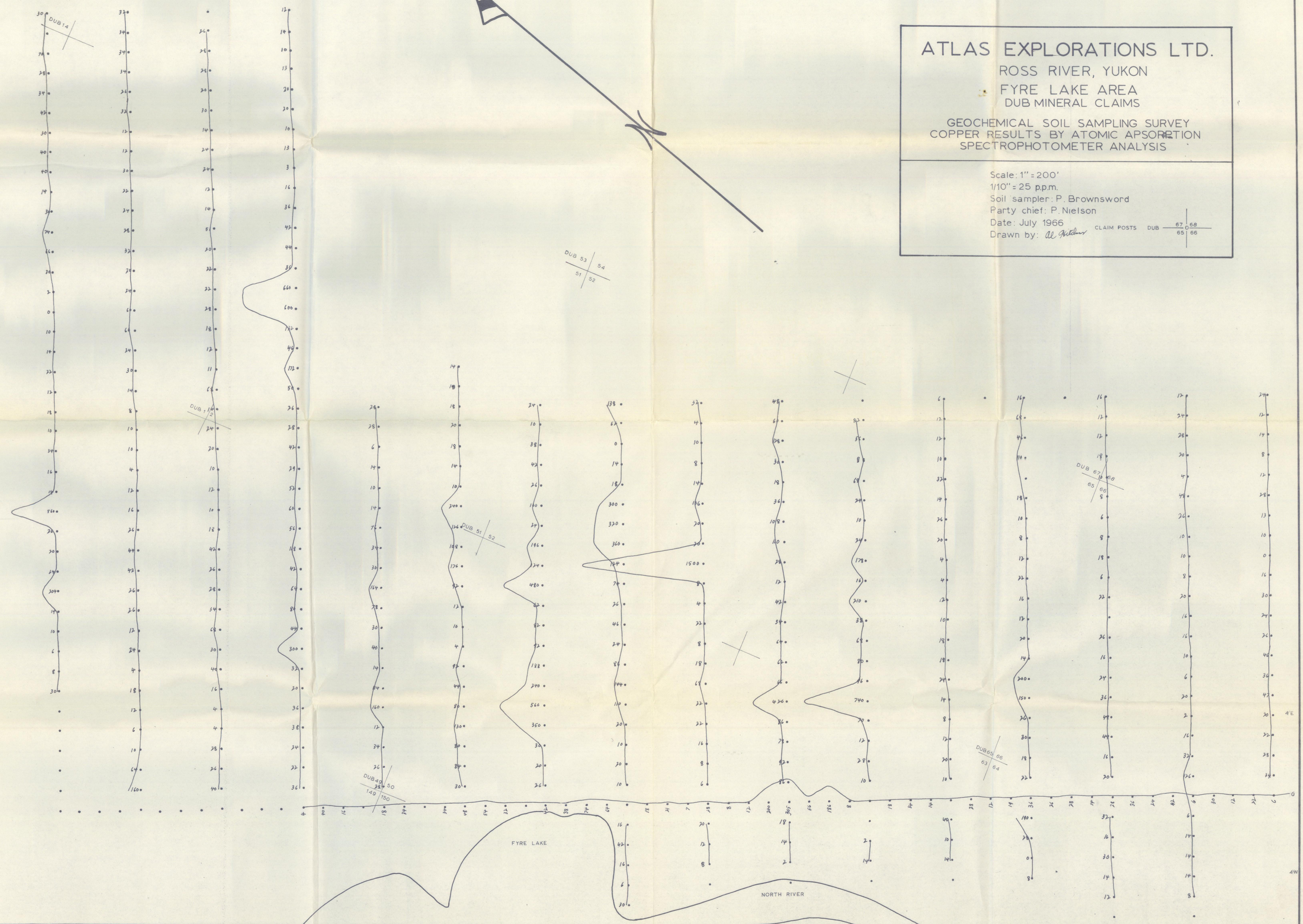

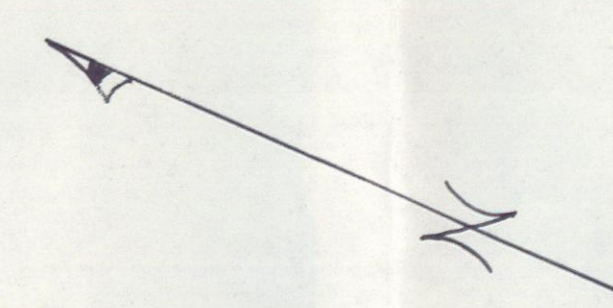
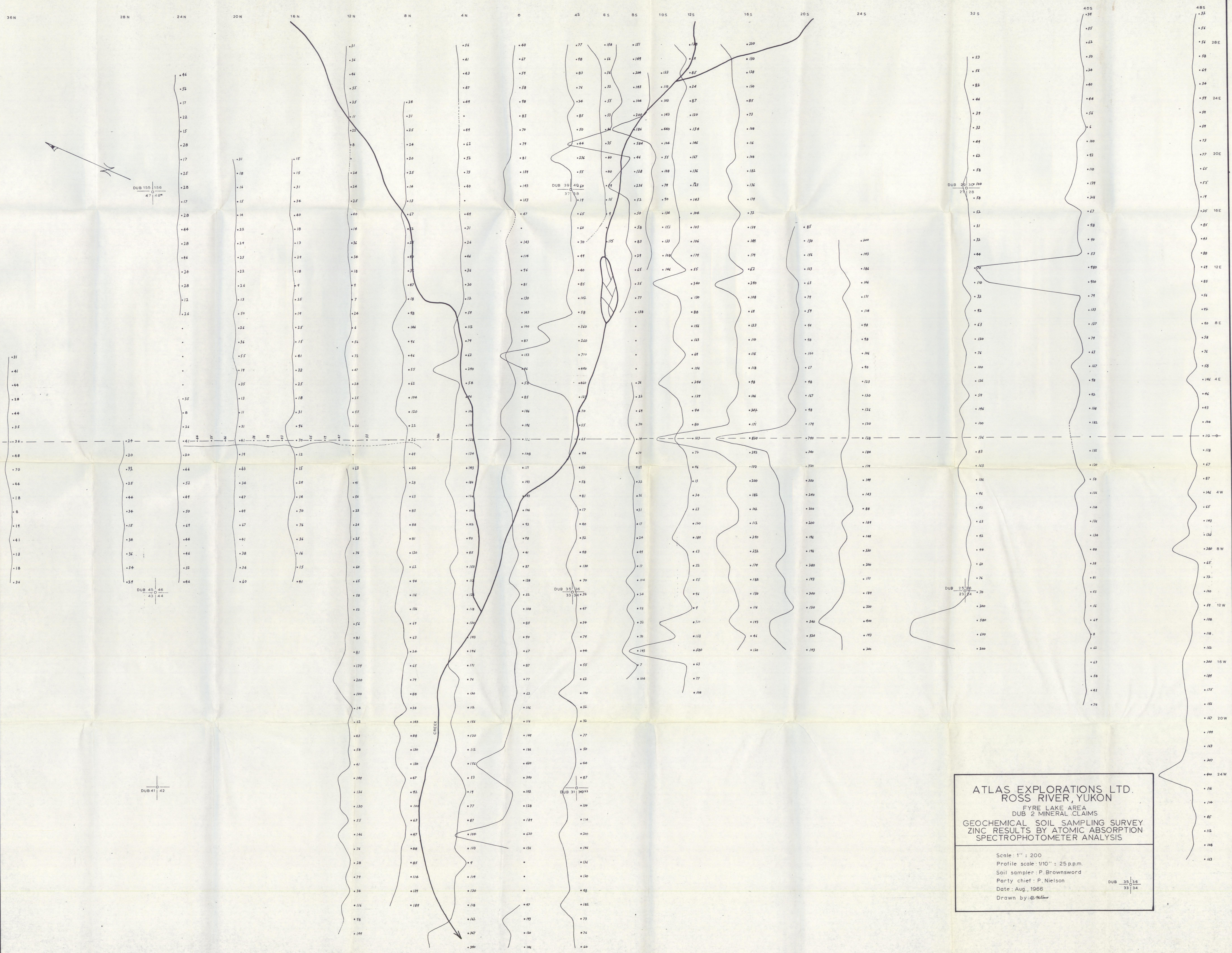

DUB 155 156
47 48

DUB 45 46
43 44

DUB 41 42

DUB 38 39
37 38

DUB 35 36
33 34

DUB 31 30
30 31

DUB 26 27
25 28

DUB 25 26
23 24

ATLAS EXPLORATIONS LTD.
ROSS RIVER, YUKON
FYRE LAKE AREA
DUB 2 MINERAL CLAIMS
GEOCHEMICAL SOIL SAMPLING SURVEY
ZINC RESULTS BY ATOMIC ABSORPTION
SPECTROPHOTOMETER ANALYSIS

Scale: 1" = 200'
Profile scale: 1/10" = 25 p.p.m.
Soil sampler: P. Brownsword
Party chief: P. Nielson
Date: Aug., 1966
Drawn by: *[Signature]*

DUB 35 36
33 34

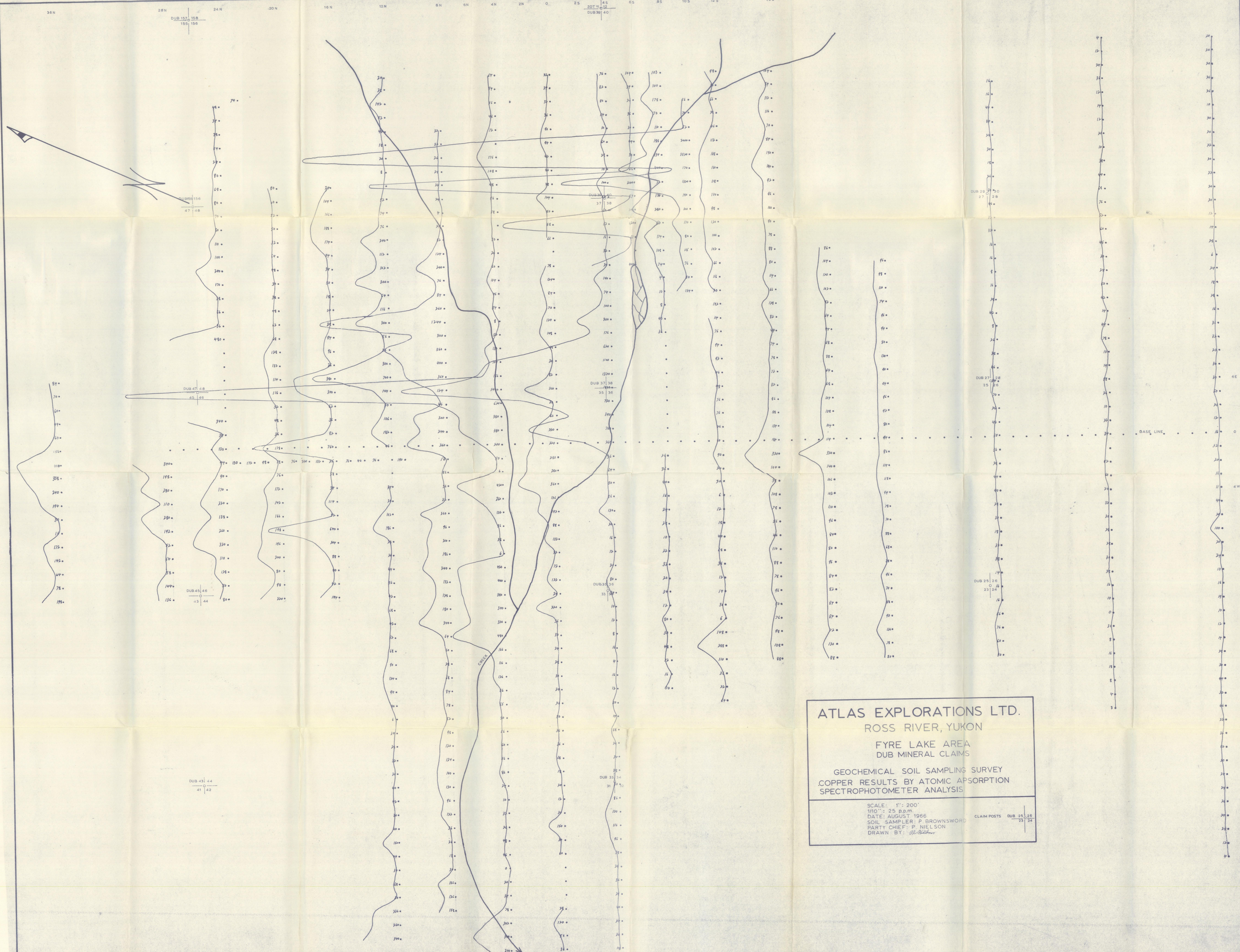



ATLAS EXPLORATIONS LTD.
 ROSS RIVER, YUKON
 FYRE LAKE AREA
 DUB MINERAL CLAIMS

 GEOCHEMICAL SOIL SAMPLING SURVEY
 COPPER RESULTS BY ATOMIC ABSORPTION
 SPECTROPHOTOMETER ANALYSIS

 SCALE: 1" = 200'
 1/10" = 25 p.p.m.
 DATE: AUGUST 1966
 SOIL SAMPLER: P. BROWNSWORD
 PARTY CHIEF: P. NIELSON
 DRAWN BY: *W. Peterson*
 CLAIM POSTS DUB 25 26 27 28 29 30 31 32 33 34 35 36

ATLAS EXPLORATIONS LTD.
 ROSS RIVER, YUKON
 FYRE LAKE AREA
 DUB 1 MINERAL CLAIMS
 DEVELOPMENT MAP

Scale: 1" = 200'

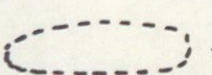
-  — Cu. geochemical anomaly
-  — Magnetometer anomaly
-  — Conductive zone

Date: Sept., 1966
 Drawn by: J. S.B.

12N

8N

4N

0N

45

85

125

165

205

245

285

325

365

405

445

485

525

12

14

7
4
2

51, 52
47, 50

67, 68
65, 66

49, 50
149, 150

65, 67
63, 64

FYRE LAKE

NORTH RIVER

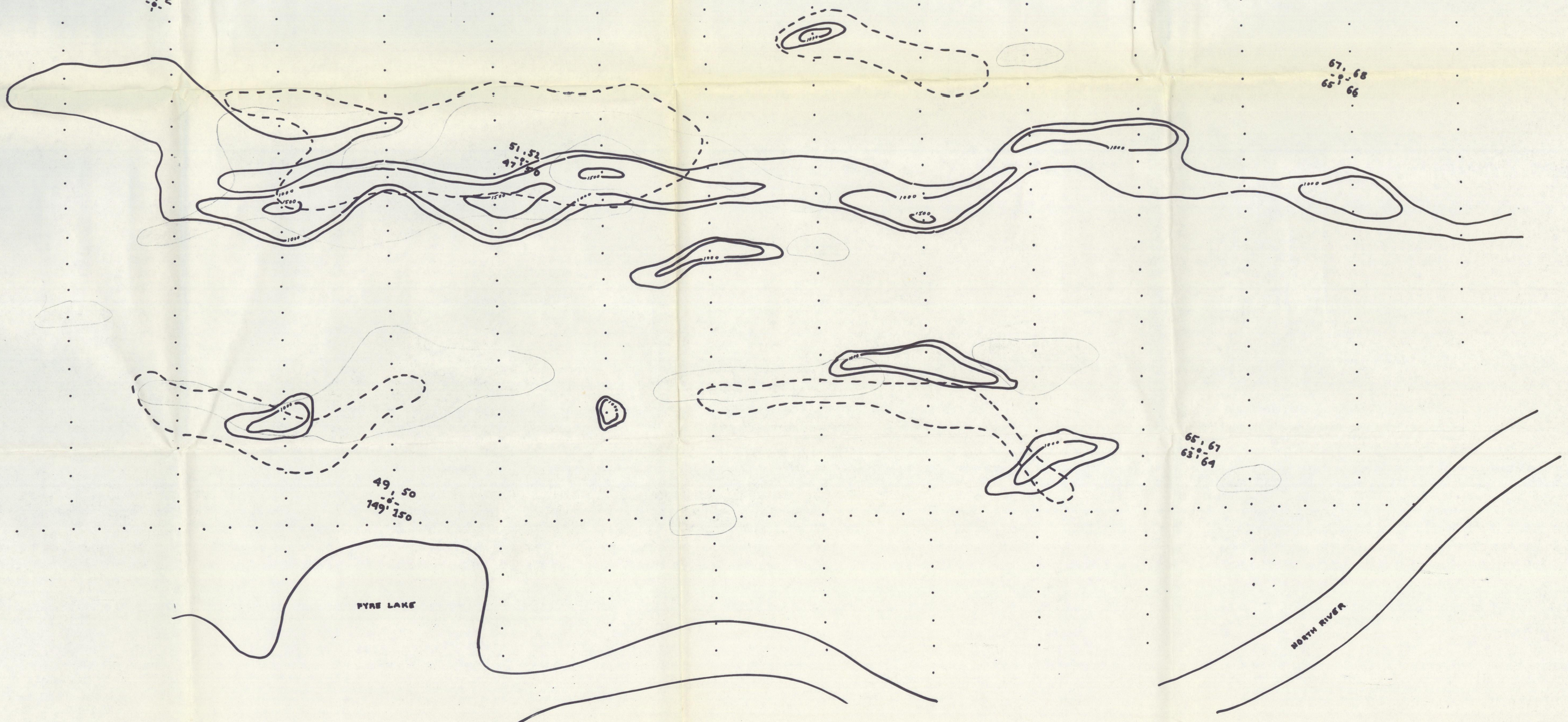
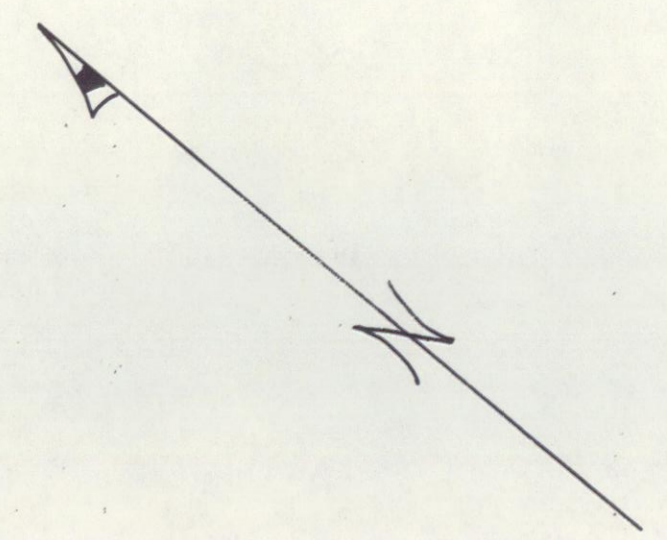

20N 16N 12N 8N 6N 4N 2N 0 2S 4S 6S 8S 10S 12S 16S 20S 24S

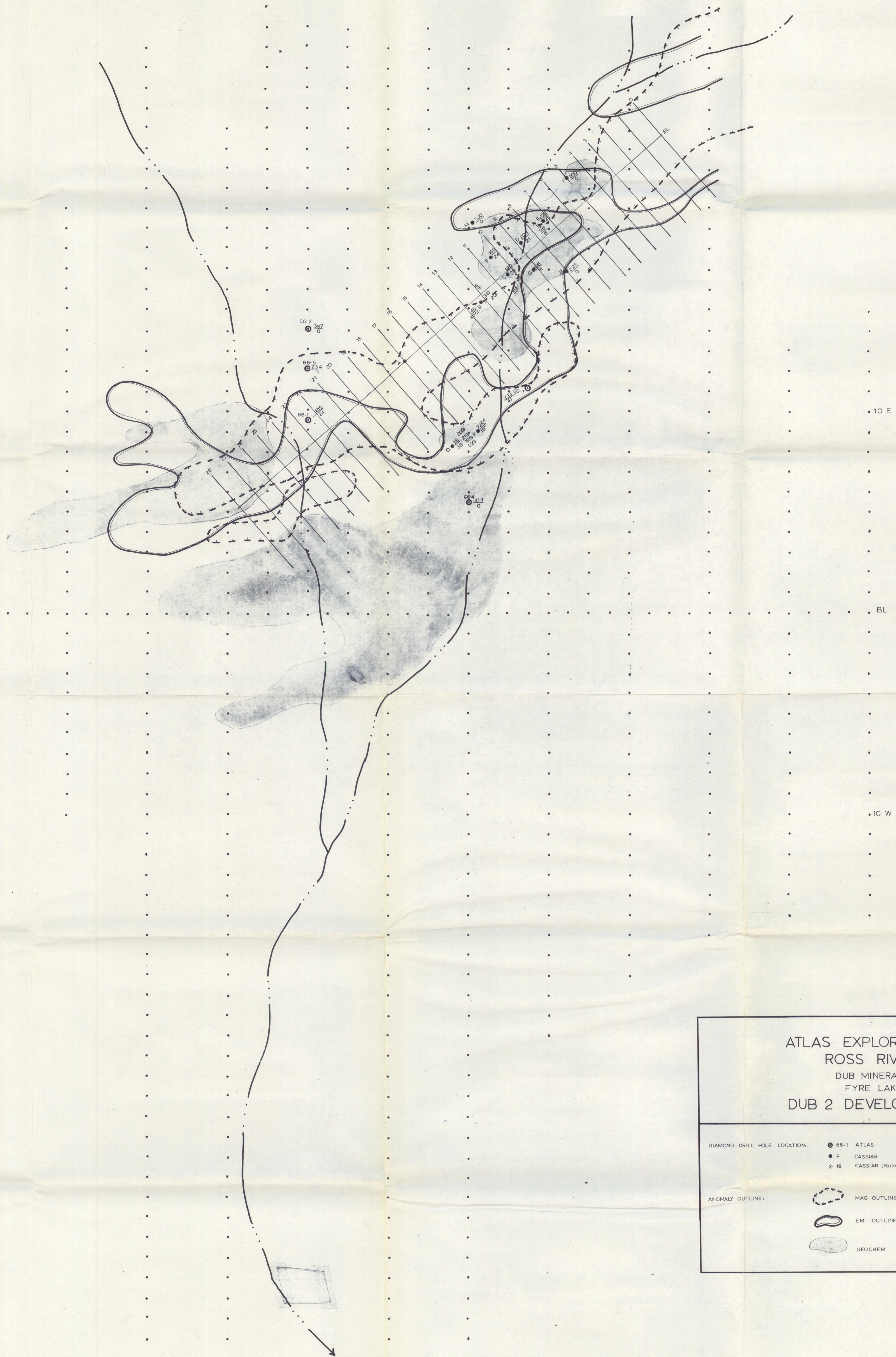

ATLAS EXPLORATIONS LTD.
ROSS RIVER Y.T.
DUB MINERAL CLAIMS
FYRE LAKE AREA
DUB 2 DEVELOPMENT MAP

- DIAMOND DRILL HOLE LOCATION:
- 66-1 ATLAS
 - F CASSIAR
 - 19 CASSIAR (Packsack hole)
- ANOMALY OUTLINE:
- MAG OUTLINE (above 500 f)
 - EM OUTLINE (above -3 degrees high freq)
 - GEOCHEM (above 200 ppm Cu)
- $\frac{300}{25}$ depth of hole mineralized interval



LEGEND

- 5 Mica schist, Sericite schist, Phyllite, Graphitic mica schist. Quartz veining + banding common.
- 4 (A) Massive Pyrite with quartz. (B) Vuggy quartz, sometimes with small amount disseminated pyrite. (C) Fe oxide gossan or cap rock - very porous.
- 3 Magnetite - quartz - biotite schist. Gneissic in places. Often contains chalcocopyrite and pyrite.
- 2 Chlorite schist
- 1 Quartz-hornblende-mica schist and gneiss.

- Trench
- Stream
- Outcrop Area
- Pit
- Height of Land
- Geological Boundary
- Attitude
- Inclined bedding or schistosity
- Horizontal bedding or schistosity
- Quartz veining
- Diamond Drill Hole

DUB MINERAL CLAIMS
DUB 2 AREA

ATLAS EXPLORATIONS LIMITED
SCALE: 1 inch to 400 feet

S 0000 1 0000 5