

4554 WEST 6TH AVENUE  
VANCOUVER 8, B.C.



GEOCHEMICAL REPORT

TASLAR GROUP OF MINERAL CLAIMS

18 Miles Northwest of Carmacks, Whitehorse Mining District,  
Yukon Territory

N.T.S. 115-I-7 Lat. 62°20' Long. 136°37'

For

Taseko Mines Ltd. (NPL)  
& LaRonge Mining Ltd. (NPL)

By

Gavin A. Dirom, P.Eng.  
& John Foster.

This report has been examined by the Geological Evaluation Unit and is recommended to the Commission to be considered as representation work in the amount of \$2035.00

*[Signature]*  
President, Commission  
President, Commission  
Commissioner of Yukon Territory

Ontario of representation work under Section 53 (4) Yukon Quartz Mining Act.

Date of Report - - - - -

October 1, 1971

Date of Field Work - - - - - July 28 to August 21, 1971

June  
*[Signature]*

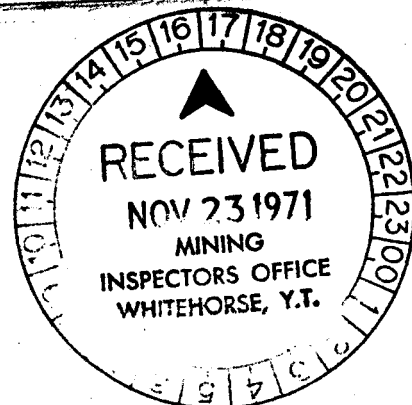

TABLE OF CONTENTS

	<u>Page No.</u>
INTRODUCTION . . . . .	1
GENERAL CONCLUSION . . . . .	1
PROPERTY & OWNERSHIP . . . . .	1
LOCATION, ACCESS & TOPOGRAPHY . . . . .	1
GEOLOGY . . . . .	2
GEOCHEMICAL SURVEY . . . . .	2
Field Work & Procedures . . . . .	2 & 3
Sample Handling & analysis . . . . .	3
Local Conditions . . . . .	3
Results . . . . .	4
Conclusions & Recommendations . . . . .	4

ATTACHMENTS

Appendix #1	Field Crew Details & Survey Costs.	
Appendix # 2	Barringer Research Ltd. Laboratory Reports # 68A & 75A, August 12 & 20, respect., 1971.	
Figure #1	Graph Showing <u>Cu</u> ppm Concentration Frequency.	
Map # 1	Claim Index Map (Part of Claim Sheet 115-I-7) 1" - ½ Mile June 28, 1971	
Map # 2	Geochemical Soil Survey	1" - 400'
Map # 2A	Reduction of Map # 2. Shows Relationship of Survey to the Taslar Group Claims.	1" - 800'.

INTRODUCTION

The following report summarizes a geochemical soil survey completed on the TASLAR GROUP during period ~~July~~ <sup>June</sup> 28 to August 21, 1971. It is submitted for assessment purposes.

The writer recommended the program covered by this report and has acted as Consulting Engineer. The actual field work was supervised by John Foster, field manager for Taseko Mines Ltd. (NPL) and LaRonge Mining Ltd. (NPL), co-owners of this property.

The writer has never been on this ground but is personally familiar with some of the adjoining area. The present report is based on information and maps supplied by John Foster.

The writer considers that Mr. Foster was fully competent to properly carry on this survey. He hereby recommends and certifies the completed program and its results as bona fide assessment work.

GENERAL CONCLUSION

The soil survey indicates some scattered, above-threshold Cu values. Majority of these are only modestly anomalous. Some appear to be in somewhat swampy areas, associated with organic content, and hence may be transported concentrations. However, a number of the areas and soil values warrant some further investigation.

PROPERTY & OWNERSHIP

The TASLAR GROUP consists of Taslar 1 to 60 mineral claims staked in January, 1971 and recorded jointly in the name of Taseko Mines Ltd. (NPL) and LaRonge Mining Ltd. (NPL), which have an office at 248 Second Avenue, Kamloops, B.C. The claims form a continuous block. Their grant numbers are Y60001 to Y60060, inclusive.

LOCATION, ACCESS & TOPOGRAPHY

The property lies in Claim Map Sheet 115 I-7 about 18 miles airline northwest of Carmacks and is in the Whitehorse Mining District. It adjoins the WILL and BOY claims of the Dawson Range Joint Venture which lie to the north.

Access is provided by the recently completed tote road to the BOY, etc. claims. This branches off the Granite Mtn. road about 23 miles from Carmacks. At about 5 miles north along the tote road, Taseko/LaRonge has completed a 4-wheel drive access road a distance of 3.6 miles northeasterly across the property to within 3,000' of the NE boundary.

The TASLAR group, for the most part, covers the high ground between Merrice Creek on the south and Williams Creek on the north. Elevations range from about 2,000' on Merrice Creek to a high of about 3,300' at the ridge crest. Slopes are seldom more than 20° except in the extreme east where the ground drops at 30-40° to Merrice Creek.

The claims are drained by swampy valleys covered by scrub spruce and willow. The higher ground is wooded with spruce, pine and birch, with alder underbrush. Permafrost was encountered in the north-facing valleys but not in the south-facing drainage.

### GEOLOGY

Regional geology is provided by GSC Carmacks Sheet, Map 340A. This indicates that the TASLAR group lies within an area of Jurassic or later granitic intrusives and about 2 miles west of Mesozoic Mt. Nansen volcanics lying along the Yukon River; also that there are remnants of Tertiary Carmacks volcanics in the general area of the property.

On the accompanying geochem survey map ( #2 ) John Foster shows the rock outcrops noted in the course of the present survey. Most of these are confined to the high ground. He describes the majority as "pillow-block" exposures of various granitic rocks--some very coarse-grained (with large phenocrysts of quartz and feldspar); also that these are intruded by a fine-grained, light coloured rock of similar composition, and cut by quartz veins. He notes an outcrop of basalt (Carmacks?) on the Zero Base Line @ 20 South, and scattered basalt float in a large area to the northeast of this. He reports iron staining in some of the granitic outcrops; and also in the overburden at several locations.

### GEOCHEMICAL SURVEY

#### Field Work & Procedures

  
June

The field work was performed during period ~~July~~ June 28 to August 21, 1971 by John Foster, Kamloops, B.C., and a crew of up to five men. Field crew details and survey costs are included in the Certified Appendix attached to this report.

Some 58,400' of taped and picketed base and tie lines were put in; and a further 198,400' of pace & compass crosslines. Aggregate total is just over 50 miles.

Base lines were spaced at 3,200' interval; crosslines, at 400' interval. Samples were taken on all lines at 400' interval. All sample sites were marked with an orange-painted picket; and also by blue flagging on a nearby tree.

John Foster found that the best tool for sampling was a short-handled spade sharpened with a file. This made it possible to cut roots and dig to three feet in depth or more where necessary. Permafrost was encountered occasionally in the peaty Lower "A" horizon and in these cases the "B" horizon could not be reached. Samples taken at these locations are marked as "A" samples.

A record was kept of the type of tree at each sample site; and also the character of the sample area (slope, flat ground, swamp, drainage area, etc.)

Altogether some 664 samples were taken, including a few stream silts.

#### Sample Handling & Analysis

The samples were collected in standard soil sample bags and sun dried. They were then sent to Barringer Research Ltd., Whitehorse, where they were sieved to -80 mesh. A 250 mg sample was then digested in hot perchloric acid and analyzed for Copper by the Atomic Absorption method.

#### Local Conditions

Mr. Foster reports that there are two distinct types of terrain on this property, viz:

- (1) The generally higher ground, where the "B" horizon is found within a foot of the surface. Here the A1 and A3 organic horizons are confined to a few inches. These areas are wooded with spruce, pine, birch and poplar-- and have alder underbrush.
- (2) Areas where the A1 horizon (moss & organic material) is a foot or more in depth, and the A3 horizon (peat) can be 2 to 3' deep. These include all the creek bottoms and wet and permafrost areas. He also includes some areas where little or no moisture is found, and some which are on gentle slopes. All these are wooded with willow and scrub pine.

Mr. Foster refers to all these type (2) areas as "swamps" and so outlines them on the geochem survey map.

A generalized profile would be as follows:

- A1. At surface: Several inches of moss & organic material.
2. Underlain by about 2" to 8" of volcanic ash.
3. Then several inches of organic material (peat).
- B. 6" to 18" of rusty brown soil.

In contrast to this, local erosion has altered the soil profile in the area bounded by 32-60S & 32-48W. For example, at 36S-40W Mr. Foster reports the following profile:

- A1. 4" of moss & peat at the surface.
2. 8" of peat & sand.
3. 2" of gossan-stained sand.
4. 2" of peat.
5. 4" of gossan-stained sand.
6. Mixed sand & peat to 3' depth.

Samples were taken of A2, A4 & A6 at this location.

## Results

The Barringer analytical results (Cu) are attached as Appendix. They consist of Reports Nos. 68A & 75A, of August 12th & 20th, respect., 1971. These results are also shown on the attached Geo chem Survey Map ( #2 ) by John Foster.

Figure 1 is a graph showing the Concentration Frequency of the Copper values. This indicates a general background of 15-20 ppm; and a threshold of about 40 ppm. Only 36 (5.4%) of the samples exceed this threshold; and only nine (1.3%) exceed 80 ppm. Five of these latter are marked as organic "A" horizon samples, and must be discounted accordingly at this time. Also, at least five other "above-threshold" samples are likewise from the organic "A" horizon.

The four remaining better values occur on Tasmar30 & 32 claims in the area 44-56S & 40-48W. All but one of these seems to lie on a poorly drained slope. The highest value is 335 ppm Cu.

The "B" horizon is noted as iron-stained about 1,500-2,000' to west of the above area, but the best sample result here is only 67 ppm Cu.

Mr. Foster made a special effort in these two above areas to reach "B" horizon, however, where there was peat and sand banding it was sometimes difficult to tell when the "B" was reached.

## Conclusions & Recommendations

Although many of the 'above threshold' samples are in so-called swampy areas, and hence possibly in part subject to drainage enrichment, nevertheless all the higher values warrant some further ground checking. Hand trenching is warranted wherever bedrock appears to be shallow; also careful prospecting should be done for mineralized float. The access road and known, etc. outcrop areas also should be geologically examined.

Respectfully submitted,



Gavin A. Dirom, P.Eng.



October 1, 1971.

Appendix "A" Field crew details *Geochemical Survey*

<u>Persons employed</u>	<u>Address</u>	<u>Rate of pay</u>	<u>Dates employed</u>	<u>Total pay</u>
John Foster	248 2nd Ave.	\$750.00 per mo.	June 28 to Aug. 30	\$1500.00
B. Anderson	Ashcroft B.C.	\$600.00 per mo.	June 28 to Aug. 21	\$1200.00
J. Anderson	Ashcroft B.C.	\$600.00 per mo.	June 28 to Aug 21	\$1200.00
R. Craft	Carmacks Y.T.	\$25.00 per day	Aug. 6 to Aug. 13	\$150.00
G. Olchewski	Carmacks Y.T.	\$25.00 per day	Aug. 1 to Aug. 13	\$300.00
C. Foster	Monte Lake B.C.	\$10.00 per day	Aug. 2 to Aug. 13	\$120.00
Total				\$4470.00
Plus 9% U.I.C. W.C.B.				\$402.30
Total wages paid				\$4872.30

*Geochemical*  
Appendix "B" Survey costs

Wages	\$4872.30
Groceries	\$591.99
Truck Rental	\$400.00
Power saw rental	\$210.00
Travel costs	\$436.20
Camp supplies, hardware etc.	\$489.44
Gas, oil repairs	\$837.67
Assays	\$798.00
Consulting (G.A. Diron)	\$400.00
Total costs	\$9035.60

**To Accompany GEOCHEMICAL REPORT**  
**on**  
**TASLAR GROUP of Mineral Claims**  
**by**  
**Gavin A. Diron, P. Eng.**  
**& John Foster.**  
  
**Dated October 1, 1971**

*As submitted by John Foster*

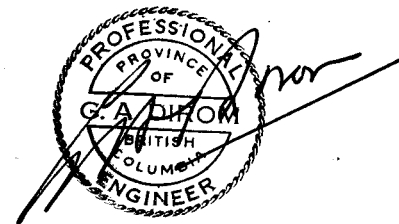

APPENDIX #1

*Nv. 9/71*

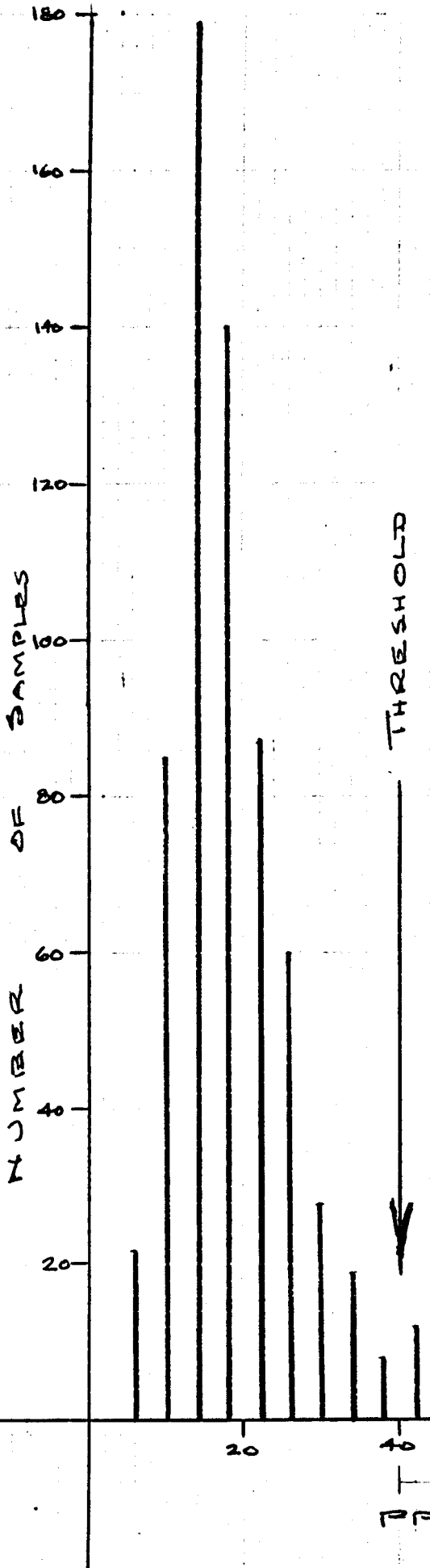

TOTAL NO OF SAMPLES - 664  
 THRESHOLD - 40PPM  
 SAMPLES ABOVE THRESHOLD - 36 = 5.4%  
 ✓ ABOVE 80PPM - 9 = 1.3%

TASLAR GROUP  
 CAAMACKS AREA, WHITEHORSE MIN. DIST  
 YUKON TERRITORY

GEOCHEMICAL SOIL SURVEY  
 GRAPH SHOWING  
CONCENTRATION FREQUENCY  
COPPER PPM

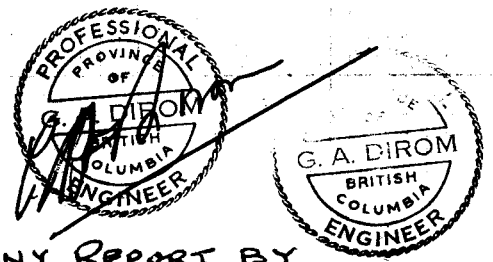

TO ACCOMPANY REPORT BY  
 GAVIN A. DIROM, P. ENG., OCT. 1, 1971

Also { 175 PPM - 1  
 335 ✓ - 1 } →

FIGURE # 1



**BARRINGER RESEARCH LIMITED**

**Geochemical**

**Laboratory  
Report**

304 CARLINGVIEW DRIVE  
REXDALE, ONTARIO, CANADA  
PHONE: 416-677-2491  
CABLE: BARESEARCH

DATE August 12, 1971.

Toseka Mines Limited,  
248-2nd Avenue,  
Kamloops, B.C.

Authority: J. Foster

REPORT NUMBER 68-A

*ymd*

SAMPLE NUMBER	HC10 <sub>4</sub> Cu ppm	Sample Number	HC10 <sub>4</sub> Cu ppm	Sample Number	HC10 <sub>4</sub> Cu ppm	Sample Number	HC10 <sub>4</sub> Cu ppm
4N-32E	37	0-32E 36E	17	4S 4-36E	50	8S- 36E	12
36E	25	40E	20	40E	12	39E	21
44E	23	44E	25	44E	10	40E	34
48E	15	48E	23	48E	28	44E	17
52E	21	52E	8	52E	8	45E	26
56E	30	56E	72	56E	51	52E	27
60E	14	60E	20	60E	19	56E	28
64E	11	64E	20	64E	22	60E	12
68E	12	68E	9	68E	15	64E	15
72E	7	72E	9	72E	15	68E	13
76E	12	76E	12	76E	17	72E	22
0 - 00	10	4S 4-0E	17	8S-00	14	76E	19
0 - 4E	9	4E	28	4E	13	12S- 00	17
8E	28	8E	17	8E	11	4E	13
12E	13	12E	14	12E	11	8E	17
16E	11	16E	12	16E	14	16E	38
20E	8	20E	13	20E	8	12S- 20E	36
24E	5	24E	11	8S- 24E	15	24E	23
28E	11	28E	8	28E	16	28E	15
32E	18	32E	21	32E	37	32E	7

Sample Number	HClO <sub>4</sub> Cu ppm		Sample Number	HClO <sub>4</sub> Cu ppm		Sample Number	HClO <sub>4</sub> Cu ppm		Sample Number	HClO <sub>4</sub> Cu ppm
12S-36E	18		16S-68E	20		24S-16E	10		28S-52E	15
40E	13		72E	16		20E	13		56E	19
44E	13		76E	23		24E	18		60E	24
48E	16		20S-00	16		28E	9		64E	10
52E	15		4E	12		32E	13		68E	29
56E	36		8E	12		36E	34		72E	17
60E	43		12E	28		40E	24		32S-00	15
64E	33		16E	13		44E	21		4E	21
68E	17		20E	14		48E	12		12E	28
72E	30		24E	20		52E	24		16E	25
76E	24		28E	16		56E	11		20E	17
16S-00	26		32E	12		60E	14		24E	14
4E	19		36E	15		64E	14		28E	10
8E	10		40E	115		68E	14		32E	14
16E	14		44E	15		72E	16		36E	15
20E	19		48E	12		28S-00	14		40E	31
24E	6		52E	15		4E	20		44E	46
28E	13		56E	13		8E	13		48E	15
32E	15		60E	14		12E	23		52E	28
36E	8		64E	15		16E	31		60E	12
40E	16		68E	25		20E	40		64E	22
44E	16		72E	19		24E	11		36S-00	21
48E	17		76E	25		28E	16		4E	38
52E	15		24S-00	20		32E	7		8E	25
56E	27		4E	16		36E	34		12E	24
60E	28		8E	26		40E	41		16E	25
64E	73		12E	10		48E	65		20E	12





## BARRINGER RESEARCH LIMITED

304 CARLINGVIEW DRIVE  
REXDALE, ONTARIO, CANADA  
PHONE: 416-677-2491  
CABLE: BARESEARCH

Geochemical

Laboratory  
Report

DATE August 20, 1971.

Taseko Mines Limited,  
248 - 2nd Avenue,  
Kamloops, B.C.

Authority: J. Foster

REPORT NUMBER 75-A

YMH

SAMPLE NUMBER	HClO <sub>4</sub> Cu ppm	Sample Number	HClO <sub>4</sub> Cu ppm	Sample Number	HClO <sub>4</sub> Cu ppm	Sample Number	HClO <sub>4</sub> Cu ppm
00 - 64W	15	4N 44W	99	4S 52W	18	8S- 16W	15
68W	24	48W	22	56W	19	20W	14
72W	13	52W	8	60W	13	24W	18
4N - 00	23	56W	19	64W	21	28W	30
4E	14	60W	21	68W	20	32W	17
8E	17	64BL	22	72W	22	36W	27
12E	25	68W	21	8N 28E	18	40W	17
16E	11	72W	21	32E	36	44W	38
20E	93	4S 4W	15	36E	16	48W	125
24E	11	8W	7	00BL	28	52W	44
4N - 00	20	12W	18	4E	17	56W	26
4W	12	16W	10	8E	15	60W	23
8W	22	20W	16	12E	15	64BL	20
16W	18	24W	175	16E	11	68W	22
20W	41	28W	13	20E	29	72W	12
24W	20	32W	16	ROCK 24E	19	12S- 4W	15
28W	22	36W	27	8S 00BL	18	8W	12
32W	27	40W	12	4W	18	12W	54
36W	43	44W	12	8W	11	16W	15
40W	42	48W	22	12W	8	20W	13

Sample Number	HClO <sub>4</sub> Cu ppm	Sample Number	HClO <sub>4</sub> Cu ppm	Sample Number	HClO <sub>4</sub> Cu ppm	Sample Number	HClO <sub>4</sub> Cu ppm
12S - 24W	16	16S 28W	20	16N-12E	18	20S-72W	15
28W	17	32W	69	14E	16	20N-00BL	14
32W	20	36W	13	20E	18	4E	14
36W	20	40W	29	24E	8	8E	15
40W	17	44W	10	28E	43	12E	20
44W	11	48W	13	20S-A 00	18	14E	12
48W	53	52W	35	4W	10	20E	21
52W	35	56W	25	8W	18	24E	28
58W	18	60W	15	12W	23	28E	26
60W	17	64W	13	16W	17	32E	17
64BL	20	68W	19	20S-4W	19	36E	20
64BL	13	72W	14	8W	24	40E	19
68W	20	16N 32E	24	12W	16	44E	15
72W	14	36E	17	16W	13	48E	24
12N 4E	14	40E	14	20W	17	52E	20
8E	17	44E	12	24W	21	56E	23
12E	38	48E	13	28W	35	60E	17
16E	35	52E	21	32WBL	18	6420E	32
20E	26	56E	14	36W	19	68E	18
24E	10	58E	32	40W	30	72E	20
14N - 60E	17	64E	13	44W	27	76E	26
16S - 4W	13	68E	16	48W	26	24S 4W	14
8W	20	72E	27	52W	19	8W	20
12W	14	76E	18	56W	25	12W	25
16W	19	00BL	14	ROCK 60W	10	16W	14
ROCK 20W	15	4E	16	64W	28	20W	12
24W	14	8E	15	68W	23	24W	25

Sample Number	HClO <sub>4</sub> Cu ppm		Sample Number	HClO <sub>4</sub> Cu ppm		Sample Number	HClO <sub>4</sub> Cu ppm		Sample Number	HClO <sub>4</sub> Cu ppm
24S - 28W	30		28S 40W	20		36S-A 28W	17		36S- 36E	16
32BL	17		44W	16		32W	15		40E	23
36W	10		48W	26		36W	17		44E	24
40W	21		52W	24		40W	20		48E	15
44W	16		56W	14		44W	22		52E	13
48W	23		60W	29		48W	38		56E	19
52W	23		64W	16		36S- 4W	23		60E	20
56W	18		68W	14		8W	23		64E	13
60W	14		72W	28		12W	17		40S- 00BL	11
64W	13		76W	17		16W	18		40S- 00BL	17
68W	16		32S 36W	29		20W	12		40S- 4W	29
72W	12		40W	22		24W	17		8W	19
24N - 00	8		44W	17		28W	15		12W	16
4E	15		48W	16		36W	24		16W	13
8E	8		52W	22		40W-A2	13		20W	11
12E	15		56W	31		40W-A4	12		24W	17
16E	9		60W	67		40W-A6	28		28W	18
20E	29		64W	27		44W	26		32W	24
24E	28		68W	13		48W	36		36W	12
28E	29		72W	15		52W	22		40W	32
32E	11		76W	14		56W	43		44W	28
28S 16W	17		36S-A 4W	13		60W	32		48W	36
20W	14		8W	62		64W	18		52W	26
24W	14		12W	24		68W	27		56W	23
28W	11		16W	14		72W	22		60W	12
32W	15		20W	15		76W	33		64W	17
36W	24		24W	12		36S- 32E	12		68W	20

Sample Number	HClO <sub>4</sub> Cu ppm		Sample Number	HClO <sub>4</sub> Cu ppm		Sample Number	HClO <sub>4</sub> Cu ppm		Sample Number	HClO <sub>4</sub> Cu ppm
40S - 72W	30		44S-36W	12		48S-A 40W	335		56S 00BL	27
76W	22		40W	34		44W	19		4W	22
40S - 4E	20		64W	16		48W	19		8W	19
8E	17		68W	12		52W	21		12W	19
12E	25		72W	18		56W	15		16W	15
16E	17		76W	13		60W	17		20W	18
20E	14		48S-00BL	22		52S-00BL	21		24W	21
24E	15		4W	15		4W	17		25W	16
28E	14		8W	19		3W	27		30W	7
32E	16		12W	27		12W	25		32W	16
36E	14		16W	11		16W	15		36W	31
40E	17		20W	10		20W	15		40W	28
44E	20		24W	23		24W	25		44W	85
48E	16		28W	41		28W	14		48W	135
52E	14		32W	18		32W	18		52W	24
56E	11		36W	31		36W	22		56W	32
60E	19		40W	45		40W	18		60W	15
64E	16		44W	110		44W	19		64W	20
44S - 00BL	21		48W	26		48W	33		60S-00BL	19
4W	23		52W	18		52W	20		ROCK 60S-00	10
8W	17		56W	24		56W	18		4W	18
12W	10		60W	22		60W	28		8W	14
16W	23		64W	11		64WBL	24		12W	12
20W	13		68W	16		64W	28		16W	13
24W	13		72W	16		68W	13		20W	23
28W	18		76W	19		72W	18		24W	14
32W	29		48S-A 36W	30		76W	11		28W	15

Sample Number	HClO <sub>4</sub> Cu ppm	Sample Number	HClO <sub>4</sub> Cu ppm	Sample Number	HClO <sub>4</sub> Cu ppm
60S - 36W	21	F1	15	G 6	17
40W	15	F2	13	G 7	14
44W	13	F3	14	G 8	17
48W	27	F4	21	G 9	22
52W	22	F5	23	G10	19
56W	15	F6	23	G11	43
60W	21	F7	12	G12-A	63
64W	19	F8	14	G13	20
72W	17	F9	17	G14	14
1	12	F10	13	G15	14
2	8	F11	12	G16	16
3	24	F12	16	G17	11
4	22	F14	16	G18	10
5	18	F15	13	ROADS G	42
6	15	F16	12		
7	13	F17	15		
8	5	F18	12		
9	8	F19	21		
10	14	F20	16		
11	9	F21	36		
12	36	F22	10		
13	13	F23	31		
14	32	G 1	25		
15	50	G 2	21		
16	19	G 3	12		
17	41	G 4	17		
18	27	G 5-A	56		

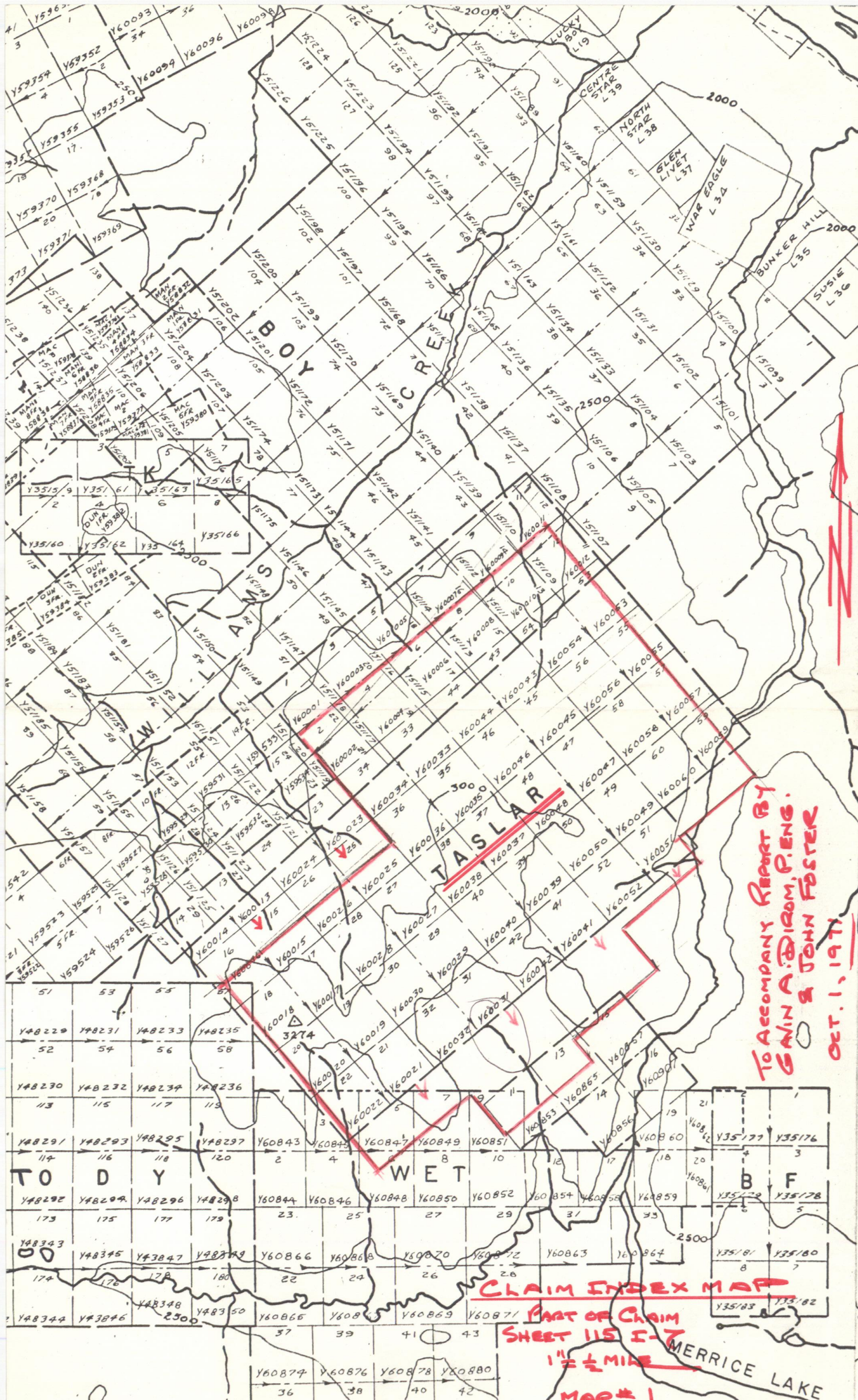

TO ACCOMPANY REPORT BY  
 GAVIN A. DUDOM, P. ENG.  
 & JOHN FOSTER  
 OCT. 1, 1971

CLAIM INDEX MAP

PART OF CHAIN SHEET 115 I-7

1 1/2 MILE

MAP # 1

MERRICE LAKE



LEGEND

- ⊙ 100+ ppm cu
- ⊙ 80-100 ppm cu
- ⊙ 60-80 ppm cu
- ⊙ 30-60 ppm cu
- ⊙ 30- ppm cu
- ppm cu A horizon
- ppm cu stream silt
- picket base line
- pace compass traverse
- claim line

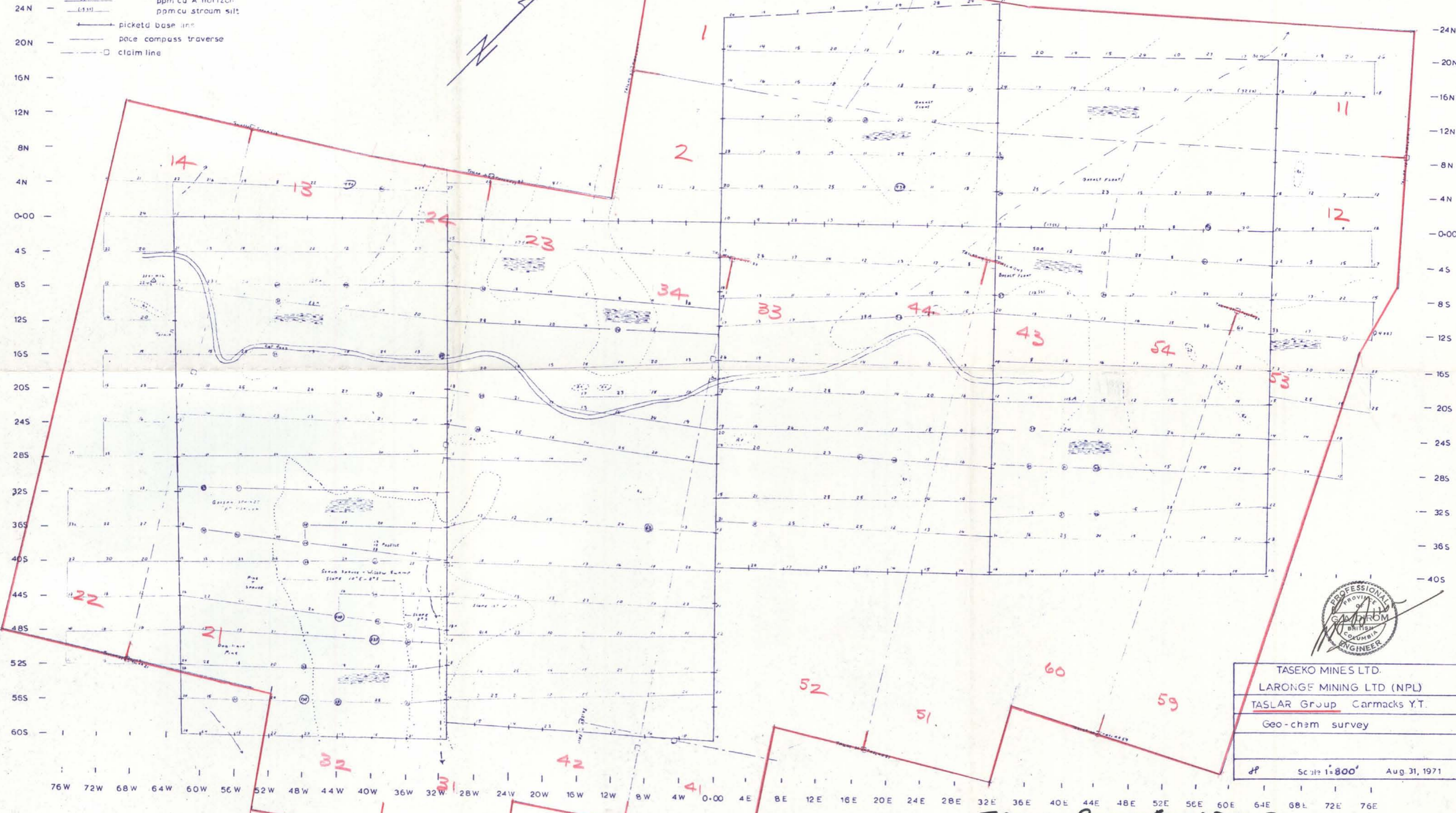

TASEKO MINES LTD.  
 LARONGE MINING LTD (NPL)  
 TASLAR Group Carmacks Y.T.  
 Geo-chem survey  
 Scale 1:800 Aug. 31, 1971

TO ACCOMPANY REPORT BY GAVIN A. DIROM, P. ENG.  
 & JOHN FOSTER. OCT. 1, 1971  
 MAP # 2A.