



1975 Case Claims OB Drilling

The following holes were drilled on the Case 3 Fr. between May 31 and June 3, 1975 inclusive. Hole diameters were 2 3/4" for casing and 2" for rods:

<u>Hole #</u>	<u>T. Depth</u>	<u>Casing</u>	<u>Rods</u>	<u>Bedrock Depth</u>	<u>Dip</u>
A6508	180'	33'	147'	100'	58 degrees
A6509	210'	28'	182'	70'	58 "
A6511	230'	28'	202'	70'	58 "
A6513	230'	29'	201'	73'	58 "
A6538	170'	29'	141'	75'	61 "
A6539	180'	30'	150'	70'	58 "
A6540	210'	30'	180'	75'	56 "
A6541	230'	20'	210'	53'	61 "
A6542	230'	29'	201'	98'	62 "
A6543	230'	29'	201'	98'	57 "
TOTAL	2100'	285'	1815'		

Sample storage at Elsa Assay Lab.

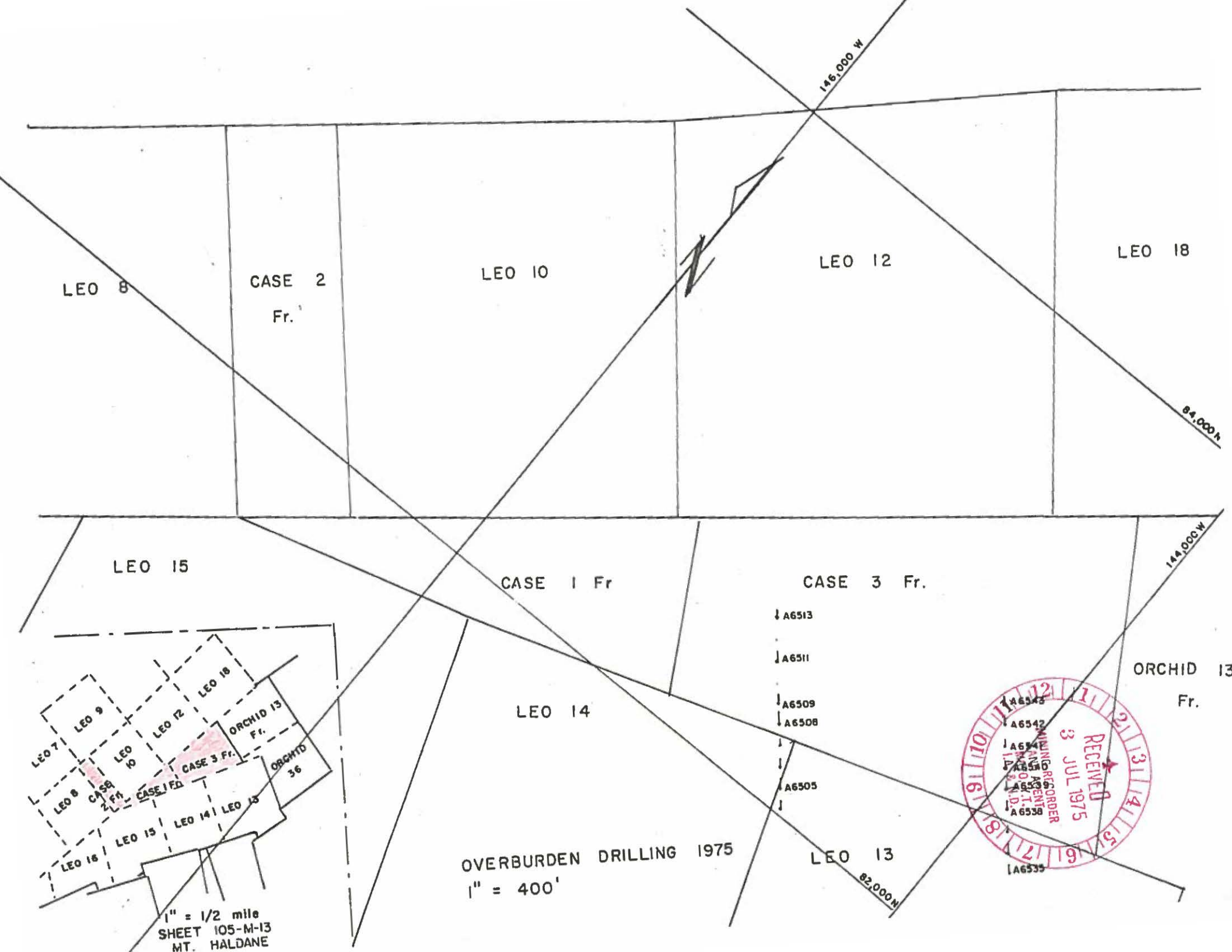

UNITED KENO HILL MINES LTD. OVERBURDEN DRILL HOLE LOG



Location HUSKY SW Latitude _____ Departure _____
 Date Drilled JUNE 2+3/75 Elevation _____ Bearing _____
 Casing Depth 20' Overburden Depth 50-55' Length of Hole 230' Dip 61°
 Page No. 18 Of 5

G.Q. Grey Quartzite; G.S. Graphite Schist; S.S. Sericite Schist; Grnst. Greenstone; Qtz. Quartz; Lim. Limonite; Py. Pyrite; Pbs. Galena; ZnS Sphalerite

Footage		Sample No.	Coarse Material (%) (+14 mesh)						Panning Concentrate Mineral Content (%)		Sample No.	Geochemical Results			Assay Results		
From	To		G.Q.	G.S.	S.S.	Grnst.	Qtz.	Lim	grams	Pb. (ppm)		Ag. (ppm)	Cu (ppm)	Ag. (oz/ton)	Pb. (%)	Zn (%)	
0	10	8809	50	10	20	10	10	T	2.5	8809	20	512	115				
10	15	8810	30	10	T	10	50	T	2.0	8810	28	13	27				
15	20	8811	60	10		10	20	T	2.0	8811	27	9.6	10				
20	25	8812	40	10	T	5	20	T	2.0	8812	24	15	22				
25	30	8813	50	10		30	10	T	1.0	8813	20	14	24				
30	35	8814	50	20		30	10	T	2.0	8814	21	17	20				
35	40	8815	30	30		30	10	T	2.0	8815	1.4	17	17				
40	45	8816	10	30		20	10	T	3.0	8816	21	17	20				
45	50	8817	40	20		20	20	T	3.5	8817	3	12	22				
50	55	8818	50	30		10	10	T	2.0	8818	23	15	20				
55	60	8819	40	20		3	10	T	3.5	8819	20	11	20				

UNITED KENO HILL MINES LTD.

OVERBURDEN DRILL HOLE LOG

Location 110210 S.M. Latitude _____ Departure _____ Hole No. A6541
 Date Drilled 7-15-55 Elevation _____ Bearing _____ Page No. 2 Of 5
 Casing Depth 30 Overburden Depth 27-55 Length of Hole 230' Dip 61°

G.Q. Grey Quartzite; G.S. Graphite Schist; S.S. Sericite Schist; Gmst. Greenstone; Qtz. Quartz; Lim. Limonite; Py. Pyrite; Pbs. Galena; ZnS Sphalerite

Footage		Sample No.	Coarse Material (%) (+14 mesh)						Panning Concentrate Mineral Content (%)		Sample No.	Geochemical Results			Assay Results		
From	To		G.Q.	G.S.	S.S.	Gmst.	Qtz.	Lim	grams	Pb. (ppm)		Ag. (ppm)	Zn (ppm)	Ag. (oz/ton)	Pb. (%)	Zn (%)	
60	65	8820	70	10		10	10	T	3.0	8820	33	10	59				
65	70	8821	60	20	T	5	15	T	2.0	8821	16	29	96				
70	75	8822	50	20		20	10	T	2.5	8822	21	27	59				
75	80	8823	60	30		T	10		2.9	8823	19	27	96				
80	85	8824	70	20			10		3.5	8824	27	27	94				
85	90	8825	50	20			30	T	3.0	8825	29	29	87				
90	95	8826	70	20			10		1.1	8826	14	26	39				
95	100	8827	50	30			20		3.0	8827	19	28	41				
100	105	8828	60	30			10	T	3.0	8828	25	29	96				
105	110	8829	70	10		15	5	T	3.0	8829	39	29	95				
110	115	8830	50	20		20	10		3.5	8830	16	29	53				

UNITED KENO HILL MINES LTD.

OVERBURDEN DRILL HOLE LOG

Location Hesperus Latitude _____ Departure _____ Hole No. A 6541
 Date Drilled Jan 24 1955 Elevation _____ Bearing _____ Page No. 3 Of 5
 Casing Depth 70 Overburden Depth 500 Length of Hole 2300 Dip 61°

G.Q. Grey Quartzite; G.S. Graphite Schist; S.S. Sericite Schist; Gmst. Greenstone; Qtz. Quartz; Lim. Limonite; Py. Pyrite; Pbs. Galena; ZnS Sphalerite

Footage		Sample No.	Coarse Material (%) (+14 mesh)						Panning Concentrate Mineral Content (%)		Sample No.	Geochemical Results			Assay Results		
From	To		G.Q.	G.S.	S.S.	Gmst.	Qtz.	Lim	grams	Pb. (ppm)		Ag. (ppm)	Zn (ppm)	Ag. (oz/ton)	Pb. (%)	Zn (%)	
115	120	8831	70	20			10		3.5	8831	20	9.9	14				
120	125	8832	60	20			20		1.5	8832	19	11	53				
125	130	8833	50	30			20		3.0	8833	13	6.7	37				
130	135	8834	40	30			30		1.5	8834	12	9.9	30				
135	140	8835	80	10			10		3.0	8835	12	3.4	23				
140	145	8836	70	20			10		3.5	8836	13	9.7	47				
145	150	8837	60	30			10		1.5	8837	12	3.5	19				
150	155	8838	60	20			20		1.5	8838	10	7.1	25				
155	160	8839	50	20			30		3.0	8839	13	3.5	27				
160	165	8840	70	20			10		3.5	8840	8	3.4	16				
165	170	8841	70	10			10		3.5	8841	15	2.5	23				

UNITED KENO HILL MINES LTD. OVERBURDEN DRILL HOLE LOG

Location 110500 5 01 Latitude _____ Departure _____ Hole No. A6541
 Date Drilled June 2 1957 Elevation _____ Bearing _____ Page No. 4 of 5
 Casing Depth 20' Overburden Depth 230' Length of Hole 230' Dip 61°

G.Q. Grey Quartzite; G.S. Graphite Schist; S.S. Sericite Schist; Grnst. Greenstone; Qtz. Quartz; Lim. Limonite; Py. Pyrite; Pbs. Galena; ZnS Sphalerite

Footage		Sample No.	Coarse Material (%) (+14 mesh)						Panning Concentrate Mineral Content (%)		Sample No.	Geochemical Results			Assay Results		
From	To		G.Q.	G.S.	S.S.	Grnst.	Qtz.	Lim.	grams	Pb. (ppm)		Ag. (ppm)	Zn (ppm)	Ag. (oz/ton)	Pb. (%)	Z (%)	
172	175	8842	10	10			30		25	100 20 100 20 Fe 10 100 20 100 20	8842	15	10	34			
175	180	8843	50	10	+	10	30		25	100 20 100 20 Fe 10 100 20 100 20	8843	14	10	55			
180	185	8844	50	10	10	20	10		25	100 20 100 20 Fe 10 100 20 100 20	8844	15	27	58			
185	190	8845	50	10	20	10	10		25	100 20 100 20 Fe 10 100 20 100 20	8845	14	27	78			
190	195	8846	30	+	40	20	10		25	100 20 100 20 Fe 10 100 20 100 20	8846	13	27	56			
195	200	8847	30		30	20	20		25	100 20 100 20 Fe 10 100 20 100 20	8847	13	27	54			
200	205	8848	30		30	10	10		25	100 20 100 20 Fe 10 100 20 100 20	8848	14	27	72			
205	210	8849	40		30	10	20		25	100 20 100 20 Fe 10 100 20 100 20	8849	27	27	56			
210	215	8850	30	+	30	10	30		25	100 20 100 20 Fe 10 100 20 100 20	8850	16	27	24			
215	220	8851	30		20	20	30		25	100 20 100 20 Fe 10 100 20 100 20	8851	13	26	53			
220	225	8852	30		30	10	30		25	100 20 100 20 Fe 10 100 20 100 20	8852	16	27	46			

UNITED KENO HILL MINES LTD.

OVERBURDEN DRILL HOLE LOG

Location HUSKY S.W. Latitude _____ Departure _____ Hole No. 46542
 Date Drilled 5/10/75 Elevation _____ Bearing _____ Page No. 2 of 5
 Casing Depth 57' Overburden Depth 135-100' Length of Hole 230' Dip 61°

G.Q. Grey Quartzite; G.S. Graphite Schist; S.S. Sericite Schist; Gmst. Greenstone; Qtz. Quartz; Lim. Limonite; Py. Pyrite; Pbs. Galena; ZnS Sphalerite

Footage		Sample No.	Coarse Material (%) (+14 mesh)						Panning Concentrate Mineral Content (%)	Sample No.	Geochemical Results			Assay Results		
From	To		G.Q.	G.S.	S.S.	Gmst.	Qtz.	Lim			grams	Pb. (ppm)	Ag. (ppm)	Zn (%)	Ag. (oz/ton)	Pb. (%)
60	65	8725	70	10		10	10	T	1.7	Qtz 15 Gmst 40 G.S. 20 Pyrite 25 Zns 5 Fe 20 Fe 20	8725	32	1.9	97		
65	70	8726	50	20		20	10	T	1.6	Qtz 15 Gmst 35 G.S. 20 Pyrite 30 Zns 5 Fe 20 Fe 20	8726	19	0.9	94		
70	75	8727	60	20		10	10	T	1.4	Qtz 15 Gmst 35 G.S. 25 Pyrite 25 Zns 5 Fe 20 Fe 20	8727	16	0.6	84		
75	80	8728	80	10			10		1.5	Qtz 20 Gmst 35 G.S. 20 Pyrite 25 Zns 5 Fe 20 Fe 20	8728	16	0.9	100		
80	85	8729	70	10		10	10	T	1.1	Qtz 20 Gmst 35 G.S. 20 Pyrite 25 Zns 5 Fe 20 Fe 20	8729	28	0.9	90		
85	90	8730	60	20		10	10	T	1.5	Qtz 15 Gmst 35 G.S. 30 Pyrite 30 Zns 5 Fe 20 Fe 20	8730	21	0.6	85		
90	95	8731	60	10		20	10	T	1.4	Qtz 15 Gmst 40 G.S. 25 Pyrite 20 Zns 5 Fe 20 Fe 20	8731	19	0.9	100		
95	100	8732	50	30		10	10		1.5	Qtz 15 Gmst 25 G.S. 35 Pyrite 25 Zns 5 Fe 20 Fe 20	8732	114	11	95		
100	105	8733	50	40			10	T	1.3	Qtz 5 Gmst 15 G.S. 15 Pyrite 65 Zns 5 Fe 20 Fe 20	8733	25	0.9	90		
105	110	8734	60	30			10		1.5	Qtz 5 Gmst 10 G.S. 10 Pyrite 70 Zns 5 Fe 20 Fe 20	8734	19	11	90		
110	115	8735	30	10	50		T	10	1.6	Qtz 15 Gmst 30 G.S. 10 Pyrite 45 Zns 5 Fe 20 Fe 20	8735	16	0.9	95		

UNITED KENO HILL MINES LTD.

OVERBURDEN DRILL HOLE LOG

Location 2880 ft Latitude _____ Departure _____ Hole No. 16542
 Date Drilled _____ Elevation _____ Bearing _____ Page No. 3 Of 5
 Casing Depth _____ Overburden Depth 2300 Length of Hole 2301 Dip _____

G.Q. Grey Quartzite; G.S. Graphite Schist; S.S. Sericite Schist; Grnst. Greenstone; Qtz. Quartz; Lim. Limonite; Py. Pyrite; Pbs. Galena; ZnS Sphalerite

Footage		Sample No.	Coarse Material (%) (+14 mesh)					Panning Concentrate Mineral Content (%)			Sample No.	Geochemical Results			Assay Results	
From	To		G.Q.	G.S.	S.S.	Grnst.	Qtz.	Lim	grams	Pb. (ppm)		Ag. (ppm)	1/1000	Ag. (oz/ton)	Pb. (%)	
		8736	53	40				10	1.1	QTL 5 Gr 20 G.S. 10 Pb. 65 Pbs. 10 Fe 20 SST ZNST	8736	33	11	49		
130	135	8737	40	20				10	1.0	QTL 15 Gr 50 G.S. 10 Pb. 20 Pbs. 10 Fe 20 ZNST	8737	1				
		8738	50	20	20	T		10	1.3	QTL 15 Gr 40 G.S. 20 Pb. 25 Pbs. 10 Fe 20 SST ZNST	8738	19	58	16		
130		8739	30	20	30	T		20	1.3	QTL 20 Gr 30 G.S. 20 Pb. 25 Pbs. 10 Fe 20 SST	8739	17	39			
135	140	8740	30	20	40			10	1.2	QTL 20 Gr 30 G.S. 20 Pb. 20 Pbs. 10 Fe 20 SST ZNST	8740	16	57	60		
		8741	40	10	30	10		10	1.6	QTL 10 Gr 25 G.S. 25 Pb. 40 Pbs. 10 Fe 20 SST ZNST	8741	19	17	50		
145	150	8742	45	10	15	20		10	1.3	QTL 15 Gr 20 G.S. 25 Pb. 35 Pbs. 10 Fe 20 S.S.S ZNST	8742	16	13	74		
150	155	8743	40	10	20				1.2	QTL 15 Gr 20 G.S. 25 Pb. 25 Pbs. 10 Fe 20 S.S.S ZNST	8743	33	29	35		
155	160	8744						10	1.1	QTL 10 Gr 35 G.S. 10 Pb. 25 Pbs. 10 Fe 20 S.S.S ZNST	8744	18	21	50		
160	165	8745	45	10	25	20			1.2	QTL 15 Gr 40 G.S. 20 Pb. 20 Pbs. 10 Fe 20 S.S.S ZNST	8745	35	13	91		
		8746	40	20	20	10		10	1.1	QTL 15 Gr 10 G.S. 10 Pb. 65 Pbs. 10 Fe 20 SST Pbs. 10	8746	19	27			

UNITED KENO HILL MINES LTD. OVERBURDEN DRILL HOLE LOG

Location 110000 SW Latitude _____ Departure _____ Hole No. 46542
 Date Drilled 2-21-55 Elevation _____ Bearing _____ Page No. 4 Of 5
 Casing Depth 27' Overburden Depth 35-120' Length of Hole 230' Dip 45°

G.Q. Grey Quartzite; G.S. Graphite Schist; S.S. Sericite Schist; Gmst. Greenstone; Qtz. Quartz; Lim. Limonite; Py. Pyrite; Pbs. Galena; ZnS Sphalerite

Footage		Sample No.	Coarse Material (%) (+14 mesh)						Panning Concentrate Mineral Content (%)		Sample No.	Geochemical Results			Assay Results		
From	To		G.Q.	G.S.	S.S.	Gmst.	Qtz.	Lim.	grams	Pb. (ppm)		Ag. (ppm)	Zn (%)	Ag. (oz/ton)	Pb. (%)	Z (%)	
170	175	8747	30	30	20	10	10	1.0	Qtz 15 Gmst 40 Gs 15 Py 20 Fe 20 Pbs 15 S.S. 20 ZNBT	8747	16	11	85				
175	180	8748	45	30	15	10	10	1.3	Qtz 15 Gmst 25 Gs 15 Py 25 Fe 20 Pbs 15 S.S. 5 ZNBT	8748	120	1.8	120				
180	185	8749	40	20	20	10	10	1.3	Qtz 10 Gmst 25 Gs 15 Py 25 Fe 20 Pbs 15 S.S. 5 ZNBT	8749	44	13	84				
185	190	8750	50	10	10	20	10	1.4	Qtz 15 Gmst 35 Gs 10 Py 25 Fe 20 Pbs 10 S.S. 20 ZNBT	8750	24	1.2	59				
190	195	8801	30	10	30	10	20	1.2	Qtz 20 Gmst 30 Gs 15 Py 20 Fe 20 Pbs 15 S.S. 10 ZNBT	8801	15	0.8	69				
195	200	8802	30	20	20	20	10	1.5	Qtz 5 Gmst 15 Gs 10 Py 70 Fe 20 Pbs 15 ZNBT	8802	18	2.2	115				
200	205	8803	30	25	15	20	10	1.3	Qtz 10 Gmst 20 Gs 15 Py 65 Fe 20 Pbs 15 S.S. 10 ZNBT	8803	20	1.2	79				
205	210	8804	50	20	15	5	10	1.4	Qtz 10 Gmst 25 Gs 15 Py 20 Pbs 15 S.S. 20 ZNBT	8804	17	1.2	172				
210	215	8805	50	30	5	5	10	1.5	Qtz 15 Gmst 20 Gs 30 Py 35 S.S. 15 ZNBT	8805	22	0.9	149				
215	220	8806	4	40	10	7	10	1.2	Qtz 15 Gmst 35 Gs 15 Py 25 Fe 20 Pbs 15 S.S. 20 ZNBT	8806	16	0.5	58				
220	225	8807	35	30	15	10	10	1.3	Qtz 20 Gmst 35 Gs 20 Py 25 Fe 20 Pbs 15 S.S. 10 ZNBT	8807	44	0.7	82				

#130

UNITED KENO HILL MINES LTD. OVERBURDEN DRILL HOLE LOG

Location HUSKY SW Latitude _____ Departure _____ Hole No. AG543
 Date Drilled JUNE 2/75 Elevation _____ Bearing _____ Page No. 1 Of 2
 Casing Depth 29' Overburden Depth 981 Length of Hole 230' Dip 57°

G.Q. Grey Quartzite; G.S. Graphite Schist; S.S. Sericite Schist; Gmst. Greenstone; Qtz. Quartz; Lim. Limonite; Py. Pyrite; Pbs. Galena; ZnS Sphalerite

Footage		Sample No.	Coarse Material (%) (+14 mesh)					Panning Concentrate Mineral Content (%)			Sample No.	Geochemical Results			Assay Results		
From	To		G.Q.	G.S.	S.S.	Gmst.	Qtz.	Lim	grams	Pb. (ppm)		Ag. (ppm)	Zn (ppm)	Ag. (oz/ton)	Pb. (%)	Zn (%)	
0	10	8669	70	T		20	10		1.1	Gmst 20 Qtz 10 G.S. 55 G.S. 15 Pyrite Znst	8669	127	46	150			
										LIMIT							
10	15	8670	20		20	10	50	T	1.4	Gmst 55 Qtz 10 G.S. 40 G.S. 15 Pyrite Znst	8670	37	10	11			
										LIMIT							
15	20	8671	70			10	20	T	1.3	Gmst 40 Qtz 10 G.S. 40 G.S. 10 Pyrite Znst	8671	325	190	151			
										FE 20% T LIMIT							
20	25	8672	50	10		30	10	T	1.7	Gmst 40 Qtz 15 G.S. 30 G.S. 15 Pyrite Znst	8672	27	97	100			
										FE 20% T LIMIT							
25	30	8673	30	10		50	10	T	2.1	Gmst 50 Qtz 10 G.S. 30 G.S. 10 Pyrite Znst	8673	35	10	95			
										FE 20% T LIMIT							
30	35	8674	40	20		30	10	T	1.9	Gmst 55 Qtz 10 G.S. 30 G.S. 10 Pyrite Znst	8674	57	36	110			
										FE 20% T LIMIT							
35	40	8675	60	10		20	10	T	1.6	Gmst 45 Qtz 10 G.S. 30 G.S. 15 Pyrite Znst	8675	13	07	90			
										LIMIT							
40	45	8676	60			30	10	T	1.4	Gmst 40 Qtz 10 G.S. 30 G.S. 15 Pyrite Znst	8676	15	09	05			
										LIMIT							
45	50	8677	50			40	10	T	1.3	Gmst 45 Qtz 10 G.S. 30 G.S. 20 Pyrite Znst	8677	20	09	09			
										LIMIT							
50	55	8678	40			30	30	T	2.1	Gmst 45 Qtz 15 G.S. 25 G.S. 15 Pyrite Znst	8678	15	09	07			
										LIMIT							
55	60	8679	70			10	20	T	2.4	Gmst 45 Qtz 15 G.S. 25 G.S. 15 Pyrite Znst	8679	15	09	07			
										LIMIT							

UNITED KENO HILL MINES LTD. OVERBURDEN DRILL HOLE LOG

Location 1102500 5001 Latitude _____ Departure _____ Hole No. A6543
 Date Drilled Jan 21 1957 Elevation _____ Bearing _____ Page No. 2 Of 5
 Casing Depth 20' Overburden Depth 98' Length of Hole 230' Dip 57°

G.Q. Grey Quartzite; G.S. Graphite Schist; S.S. Sericite Schist; Grnst. Greenstone; Qtz. Quartz; Lim. Limonite; Py. Pyrite; Pbs. Galena; ZnS Sphalerite

Footage		Sample No.	Coarse Material (%) (+14 mesh)						Panning Concentrate Mineral Content (%)		Sample No.	Geochemical Results			Assay Results	
From	To		G.Q.	G.S.	S.S.	Grnst.	Qtz.	Lim	grams	Pb. (ppm)		Ag. (ppm)	Fe (ppm)	Ag. (oz/ton)	Pb. (%)	
60	65	8680	50	10		20	20	T	1.2	Grnst 20 Qtz 15 Gc 40 G.S. 15 Py. 10 Znst LIMIT	8680	11	94	52		
65	70	8681	90	T		10	10	T	2.1	Grnst 15 Qtz 10 Gc 45 G.S. 15 Py. 15 Znst Fe Asst LIMIT	8681	16	94	52		
70	75	8682	90			10	10		1.6	Grnst 15 Qtz 15 Gc 45 G.S. 15 Py. 10 Znst Fe Asst LIMIT	8682	13	95	52		
75	80	8683	95			5	10	T	1.5	Grnst 15 Qtz 15 Gc 45 G.S. 30 Py. 15 Znst Fe Asst LIMIT	8683	15	94	51		
80	85	8684	70			20	10	T	2.4	Grnst 10 Qtz 15 Gc 45 G.S. 20 Py. 10 Znst Fe Asst	8684	17	95	61		
85	90	8685	60	20		10	10	T	1.7	Grnst 15 Qtz 10 Gc 50 G.S. 15 Py. 10 Znst Fe Asst	8685	91	97	93		
90	95	8686	50	20		20	10	T	1.3	Grnst 5 Qtz 15 Gc 45 G.S. 20 Py. 15 Znst Fe Asst	8686	10	94	52		
95	100	8687	50	30		T	20	T	2.1	Grnst 15 Qtz 15 Gc 50 G.S. 15 Py. 20 Znst Fe Asst	8687	15	97	93		
100	105	8688	60	10	20		10	T	1.6	Qtz 15 Gc 35 G.S. 15 Py. 35 Fe Asst Fe Asst	8688	11	94	52		
105	110	8689	60	30			10		1.5	Qtz 10 Gc 40 G.S. 15 Py. 35 Fe Asst Fe Asst	8689	13	95	76		
110	115	8690	60	10	20		10		1.4	Qtz 5 Gc 15 G.S. 35 Py. 45 Fe Asst	8690	17	105	100		

UNITED KENO HILL MINES LTD.

OVERBURDEN DRILL HOLE LOG

Location 11 Latitude _____ Departure _____ Hole No. AG543
 Date Drilled _____ Elevation _____ Bearing _____ Page No. 3 of 5
 Casing Depth _____ Overburden Depth _____ Length of Hole 230' Dip 57°
 G.Q. Grey Quartzite; G.S. Graphite Schist; S.S. Sericite Schist; Grnst. Greenstone; Qtz. Quartz; Lim. Limonite; Py. Pyrite; Pbs. Galena; ZnS Sphalerite

Footage		Sample No.	Coarse Material (%) (+14 mesh)					Panning Concentrate Mineral Content (%)			Sample No.	Geochemical Results			Assay Results		
From	To		G.Q.	G.S.	S.S.	Grnst.	Qtz.	Lim	grams	Pb. (ppm)		Ag. (ppm)	Zn (%)	Ag. (oz/ton)	Pb. (%)	Z (%)	
		8691	50		40		10		1.1	Qtz. 55 Gr 10 G.S. 10 Py. 25 Fe 25	8691	23	16	144			
120	125	8692	30	10	30	20	10		1.2	Qtz. 55 Gr 10 G.S. 10 Py. 25 Fe 25		17	9.8	96			
135	140		50	10	20	10	10		1.3	Qtz. 55 Gr 5 G.S. 10 Py. 20 Fe 25	8693	16	11	49			
130	135		40	20	20	15	5		1.5	Qtz. 5 Gr 15 G.S. 10 Py. 20 Fe 25		16	13	130			
135		8695	40	40	T		T		1.3	Qtz. 15 Gr 25 G.S. 10 Py. 50 Fe 25			16	14			
140	145	8696		20	40	10	10		1.4	Qtz. 15 Gr 30 G.S. 15 Py. 20 Fe 25	8696	14	9.9	59			
145		8697	40	10	30	20	T		1.5	Qtz. 10 Gr 30 G.S. 15 Py. 20 Fe 25	8697	15	9.3	51			
150	155	8698			30	T	10		1.3	Qtz. 10 Gr 25 G.S. 15 Py. 40 Fe 25	8698	10	5	75			
			30	40	10				1.2	Qtz. 10 Gr 25 G.S. 10 Py. 55 Fe 25	8699	13	9.7	62			
		100							1.3	Qtz. 15 Gr 25 G.S. 10 Py. 50 Fe 25	8700	14	9.5	76			
		1							1.4	Qtz. 10 Gr 25 G.S. 15 Py. 50 Fe 25	8701	17	9.7	76			

UNITED KENO HILL MINES LTD.

OVERBURDEN DRILL HOLE LOG

15705

Location HUSKY SW1 Latitude _____ Departure _____ Hole No. A6508
 Date Drilled MAY 31/75 Elevation _____ Bearing _____ Page No. 1 OF 4
 Casing Depth 33' Overburden Depth 100' Length of Hole 130' Dip 58°

G.Q. Grey Quartzite; G.S. Graphite Schist; S.S. Sericite Schist; Grnst. Greenstone; Qtz. Quartz; Lim. Limonite; Py. Pyrite; Pbs. Galena; ZnS Sphalerite

Footage		Sample No.	Coarse Material (%) (+14 mesh)						Panning Concentrate Mineral Content (%)	Sample No.	Geochemical Results			Assay Results		
From	To		G.Q.	G.S.	S.S.	Grnst.	Qtz.	Lim			grams	Pb. (ppm)	Ag. (ppm)	Zn (ppm)	Ag. (oz/ton)	Pb. (%)
7	10	8503	80	10			10	T	1.3	G.S. 20 S.S. 10 GRNST 10 FeAsST GQ 30 QTZ 20 PyT	8503	15	1.5	61		
10	15	8504	20	20		10	50	T	1.3	G.S. 20 S.S. 10 GRNST 10 FeAsST GQ 30 QTZ 30 PyT ZnST	8504	20	1.2	69		
15	20	8505	60	20		10	10	T	1.2	G.S. 20 S.S. 10 GRNST 10 FeAsST GQ 20 QTZ 20 PyT	8505	19	1.1	61		
20	25	8506	60	15		5	20	T	1.3	G.S. 20 S.S. 10 GRNST 10 FeAsST GQ 20 QTZ 30 FeAsST	8506	18	0.8	67		
25	30	8507	70	10		10	10	T	1.6	G.S. 20 S.S. 10 FeAsST PyT GQ 30 QTZ 30 ZnST	8507	21	1.4	80		
30	35	8508	55	20		20	5		1.3	G.S. 20 S.S. 10 GRNST 10 PyT GQ 20 QTZ 40 FeAsST	8508	42	2.7	79		
35	40	8509	50	20		30	T	T	1.5	G.S. 30 S.S. 20 GRNST 10 PyS GQ 20 QTZ 20 FeAsST	8509	19	1.6	87		
40	45	8510	70			20	10	T	1.5	G.S. 20 S.S. 10 GRNST 10 FeAsST GQ 20 QTZ 40 PyT FeAsST	8510	17	1.7	75		
45	50	8511	10	10		20	10	T	2.0	G.S. 20 S.S. 10 Py 20 FeAsST GQ 20 QTZ 30 FeAsST ZnST	8511	15	1.1	68		
50	55	8512	60	T		30	10	T	1.5	G.S. 20 S.S. 10 Py 10 FeAsST GQ 30 QTZ 20 FeAsST ZnST	8512	17	1.1	55		
55	60	8513	10	10		20	10	T	1.5	G.S. 10 S.S. 10 Py 10 FeAsST GQ 20 QTZ 50 FeAsST ZnST	8513	16	1.2	61		

UNITED KENO HILL MINES LTD.

OVERBURDEN DRILL HOLE LOG

105

Location HMS 5.01 Latitude _____ Departure _____ Hole No. A6508
 Date Drilled 12/21/15 Elevation _____ Bearing _____ Page No. 2 Of 4
 Casing Depth 25' Overburden Depth 120' Length of Hole 180' Dip 58°

G.Q. Grey Quartzite; G.S. Graphite Schist; S.S. Sericite Schist; Grnst. Greenstone; Qtz. Quartz; Lim. Limonite; Py. Pyrite; Pbs. Galena; ZnS Sphalerite

Footage		Sample No.	Coarse Material (%) (+14 mesh)						Panning Concentrate Mineral Content (%)		Sample No.	Geochemical Results			Assay Results		
From	To		G.Q.	G.S.	S.S.	Grnst.	Qtz.	Lim	grams	Py.		Pbs.	Zn	Ag. (oz/ton)	Pb. (%)	Zn (%)	
60	65	8514	70	10		10	10	T	1.0	G.S. 10 PY 10 Fe ASS 10 G.G. 20 GT 20 ZNS T	8514	17	1.4	64			
65	70	8515	65	5		20	10	T	1.0	G.S. 20 PY 10 Fe ASS 10 G.G. 20 GT 20 ZNS T	8515	12	1.1	37			
70	75	8516	90				10		1.5	G.S. 10 PY 10 Fe ASS 10 G.G. 20 GT 20 ZNS T	8516	9	0.7	7			
75	80	8517	80	10			10		1.5	G.S. 20 PY 30 Fe ASS 10 G.G. 10 GT 20 ZNS T	8517	13	1.0	14			
80	85	8518	80			10	10		1.5	G.S. 10 PY 20 Fe ASS 10 G.G. 30 GT 20 ZNS T	8518	10	1.3	29			
85	90	8519	90	10				T	1.5	G.S. 10 PY 20 Fe ASS 10 G.G. 20 GT 20 ZNS T	8519	11	0.9	24			
90	95	8520	90				10		1.5	G.S. 20 PY 40 Fe ASS 10 G.G. 10 GT 20 ZNS T	8520	8	1.2	12			
95	100	8521	60	30			10		2.0	G.S. 10 PY 50 Fe ASS 10 G.G. 10 GT 20 ZNS T	8521	12	1.3	57			
100	105	8522	70	20			10		2.5	G.S. 10 PY 70 Fe ASS 10 G.G. 10 GT 20	8522	17	1.7	76			
105	110	8523	60	40				T T	2.5	G.S. 10 PY 70 G.G. 10 GT 20	8523	27	1.0	72			
110	115	8524	60	30			10		2.0	G.S. 10 PY 70 G.G. 10 GT 20	8524	26	1.4	73			

UNITED KENO HILL MINES LTD.

OVERBURDEN DRILL HOLE LOG

105

Location NIISKY SW Latitude _____ Departure _____ Hole No. AG508
 Date Drilled Mar 31/75 Elevation _____ Bearing _____ Page No. 3 of 4
 Casing Depth 9.8 Overburden Depth 1.5 Length of Hole 180' Dip 58°

G.Q. Grey Quartzite; G.S. Graphite Schist; S.S. Sericite Schist; Grnst. Greenstone; Qtz. Quartz; Lim. Limonite; Py. Pyrite; Pbs. Galena; ZnS Sphalerite

Footage		Sample No.	Coarse Material (%) (+14 mesh)					Panning Concentrate Mineral Content (%)		Sample No.	Geochemical Results			Assay Results		
From	To		G.Q.	G.S.	S.S.	Grnst.	Qtz.	Lim	grams		Pb. (ppm)	Ag. (ppm)	Zn (ppm)	Ag. (oz/ton)	Pb. (%)	Zn (%)
115	120	8525	70	20			10	1.5	G.S. 70 PY 40 Fe 25.1 G.G. 10 QTZ 30	8525	21	1.1	77			
120	125	8526	30	70				2.0	G.S. 10 PY 70 Fe 25.1 G.G. 10 QTZ 10	8526	16	1.1	51			
125	130	8527	60	30			10	1.5	G.S. 10 PY 50 Fe 25.1 G.G. 10 QTZ 30	8527	12	0.7	31			
130	135	8528	70	30			T	2.0	G.S. 10 PY 60 Fe 25.1 G.G. 10 QTZ 20	8528	13	0.9	32			
135	140	8529	80	10			10	1.0	G.S. 10 PY 30 Fe 25.1 G.G. 30 QTZ 40	8529	12	0.8	21			
140	145	8530	70	20			10	1.5	G.S. 10 PY 20 G.G. 20 QTZ 50	8530	10	0.6	23			
145	150	8531	50	40			10	1.0	G.S. 10 PY 10 G.G. 30 QTZ 50	8531	8	1.1	12			
150	155	8532	40	50			10	1.0	G.S. 10 PY 40 G.G. 20 QTZ 30	8532	5	1.1	14			
155	160	8533	50	40			10	1.0	G.S. 10 PY 30 G.G. 25 QTZ 20	8533	4	0.8	25			
160	165	8534	60	30			10	1.5	G.S. 10 PY 40 G.G. 20 QTZ 30	8534	11	1.0	32			
165	170	8535	50	40			10	1.5	G.S. 10 PY 30 G.G. 20 QTZ 40	8535	9	1.0	30			

UNITED KENO HILL MINES LTD.

OVERBURDEN DRILL HOLE LOG

Location ADUSKY SW Latitude _____ Departure _____ Hole No. 6509
 Date Drilled JUNE 2/75 Elevation _____ Bearing _____ Page No. 1 Of 4
 Casing Depth 2.8' Overburden Depth 70' Length of Hole 219' Dip 58°

G.Q. Grey Quartzite; G.S. Graphite Schist; S.S. Sericite Schist; Gmst. Greenstone; Qtz. Quartz; Lim. Limonite; Py. Pyrite; Pbs. Galena; ZnS Sphalerite

Footage		Sample No.	Coarse Material (%) (+14 mesh)						Panning Concentrate Mineral Content (%)			Sample No.	Geochemical Results			Assay Results		
From	To		G.Q.	G.S.	S.S.	Gmst.	Qtz.	Lim	grams	Fe	Ca		Mg	Pb. (ppm)	Ag. (ppm)	Cu	Ag. (oz/ton)	Pb. (%)
0	10	8538	40	10		10	40	T	0.3	GQ 40 G.S. 5 Gmst 20 Qtz 35 Fe 20 Py 25 Lim 10	8538	21	14	15				
10	15	8539	80	10			10		1.5	GQ 50 G.S. 5 Gmst 10 20 Py Qtz 25 Py T Lim T	8539	10	13	10				
15	20	8540	85	5		5	5	T	1.0	GQ 50 G.S. 10 Gmst 10 Lim T Qtz 20 Py T 25 T	8540	98	115	14				
20	25	8541	80	5		5	10	T	0.3	GQ 60 G.S. 10 Gmst 15 25 Py Qtz 15 Py T	8541	169	22	14				
25	30	8542	70	15		5	10	T	0.4	GQ 40 G.S. 10 Qtz 30 Py T Gmst 10	8542	45	22	25				
30	35	8543	30	20		30	20	T	0.5	GQ 30 Gmst 20 Qtz 40 G.S. 10 Py T 25 T	8543	11	14	70				
35	40	8544	40	10		30	20	T	0.2	GQ 30 G.S. 5 Gmst 10 Qtz 25 Py T 25 T Lim T	8544	10	11	44				
40	45	8545	40	20		20	20	T	0.6	GQ 50 G.S. 10 Gmst 25 Qtz 15 Py T 25 T Lim T	8545	18	11	10				
45	50	8546	10	20		40	30	T	0.5	GQ 30 Gmst 15 Qtz 20 G.S. 10 Py T 25 T Lim T	8546	10	34	40				
50	55	8547	40	20		20	20	T	0.5	GQ 40 G.S. 10 Gmst 20 Qtz 10 Py T	8547	15	10	14				
55	60	8548	30	30		10	30	T	1.0	GQ 30 G.S. 15 Gmst 20 Qtz 15 Py 10 25 T	8548	12	10	14				

UNITED KENO HILL MINES LTD. OVERBURDEN DRILL HOLE LOG

Location M15KLS01 Latitude _____ Departure _____ Hole No. A6504
 Date Drilled 15 June 2/55 Elevation _____ Bearing _____ Page No. 2 of 4
 Casing Depth 116' Overburden Depth 55' Length of Hole 210' Dip 58°

G.Q. Grey Quartzite; G.S. Graphite Schist; S.S. Sericite Schist; Grnst. Greenstone; Qtz. Quartz; Lim. Limonite; Py. Pyrite; Pbs. Galena; ZnS Sphalerite

Footage		Sample No.	Coarse Material (%) (+14 mesh)						Panning Concentrate Mineral Content (%)		Sample No.	Geochemical Results			Assay Results				
From	To		G.Q.	G.S.	S.S.	Grnst.	Qtz.	Lim	grams			Pb. (ppm)	Ag. (ppm)	Zn (ppm)	Ag. (oz/ton)	Pb. (%)	Zn (%)		
60	65	85549	40	40			5	5	T	1.5	GQ35 GS 20 PY 120 Limonite Qtz 15	85549	20	15	15				
65	70	85550	10	30				10		0.8	GQ 20 GS 50 Qtz 20 ZnS Py	85550	20	12	45				
70	75	85551	5	90				5	T	0.2	GQ 10 GS 10 Qtz 20 PY 50	85551	11	12	60				
75	80	85552		95				5	T	2.5	GQ 10 GS 30 Qtz 20 PY 20	85552	9	11	50				
80	85	85553	15	65				20	T	1.5	GQ 10 GS 20 Qtz 20 PY 10	85553	10	10	50				
85	90	85554	5	90				T	5	T	1.3	GQ 10 GS 30 Qtz 20 PY 40	85554	12	10	60			
90	95	85555	25	70				5	T	1.4	GQ 30 GS 20 Qtz 20 PY 30 FeS2 ZnS	85555	10	10	70				
95	100	85556	70	25				5	T	1.8	GQ 30 GS 20 Qtz 15 PY 35 ZnS	85556	9	10	40				
100	105	85557	30	40				10		1.5	GQ 25 GS 30 Grnst 10 Qtz 10 PY 25	85557	11	10	40				
105	110	85558	35	10				5	T	3.1	GQ 20 GS 15 Qtz 20 PY 45	85558	9	11	30				
110	115	85559	20	50				30	T	3.3	GQ 15 GS 15 Qtz 20 PY 50	85559	15	10	60				

UNITED KENO HILL MINES LTD. OVERBURDEN DRILL HOLE LOG

Location HILSKY SWM Latitude _____ Departure _____ Hole No. A6509
 Date Drilled June 1955 Elevation _____ Bearing _____ Page No. 3 of 4
 Casing Depth 28' Overburden Depth 70' Length of Hole 210' Dip 65°

G.Q. Gray Quartzite; G.S. Graphite Schist; S.S. Sericite Schist; Grnst. Greenstone; Qtz. Quartz; Lim. Limonite; Py. Pyrite; Pbs. Galena; ZnS Sphalerite

Footage		Sample No.	Coarse Material (%) (+14 mesh)						Panning Concentrate Mineral Content (%)	Sample No.	Geochemical Results			Assay Results		
From	To		G.Q.	G.S.	S.S.	Grnst.	Qtz.	Lim			grams	Pb. (ppm)	Ag. (ppm)	Zn (ppm)	Ag. (oz/ton)	Pb. (%)
115	120	8570	30	30			40	T	1.5	Gr 25 Gs 25 Qtz 20 ZnS T PY 30	8570	14	12	52		
120	125	8571	20	40			40	T	1.2	Gr 45 Gs 15 Qtz 20 PY 20	8571	13	22	44		
125	130	8572	40	40	1/4		20	T	8.5	Gr 10 Gs 30 Qtz 10 PY 50	8572	13	39	39		
130	135	8573	70	10			20		2.6	Gr 45 Gs 15 Qtz 10 PY 30	8573	10	11	33		
135	140	8574	20	70	1/4		5		1.2	Gr 20 Gs 15 Qtz 15 PY 50	8574	14	10	53		
140	145	8575	70	20	1/4		10	T	5.5	Gr 30 Gs 20 Qtz 20 PY 30	8575	9	25	46		
145	150	8576	10	85			5	T	4.0	Gr 30 Gs 10 Qtz 10 PY 50	8576	8	0.7	20		
150	155	8577	30	40	1/4		30	T	3.5	Gr 20 Gs 10 Qtz 10 PY 30	8577	13	14	35		
155	160	8578	20	70			10	T	2.0	Gr 25 Gs 15 Qtz 20 PY 40	8578	13	10	38		
160	165	8579	20	90			20		2.5	Gr 10 Gs 10 Qtz 50 PY 20	8579	13	10	32		
165	170	8580	75	5			20		1.4	Gr 25 Gs 15 Qtz 30 PY 30	8580	9	0.7	46		

UNITED KENO HILL MINES LTD. OVERBURDEN DRILL HOLE LOG

#100

Location HUSKY SW Latitude _____ Departure _____ Hole No. A6511
 Date Drilled JUNE 2/75 Elevation _____ Bearing _____ Page No. 1 Of 5
 Casing Depth 28' Overburden Depth 70' Length of Hole 230' Dip 58°

G.Q. Grey Quartzite; G.S. Graphite Schist; S.S. Sericite Schist; Gmst. Greenstone; Qtz. Quartz; Lim. Limonite; Py. Pyrite; Pbs. Galena; ZnS Sphalerite

Footage		Sample No.	Coarse Material (%) (+14 mesh)						Panning Concentrate Mineral Content (%)		Sample No.	Geochemical Results			Assay Results		
From	To		G.Q.	G.S.	S.S.	Gmst.	Qtz.	Lim	grams	Pb. (ppm)		Ag. (ppm)	Zn (ppm)	Ag. (oz/ton)	Pb. (%)	Zn (%)	
0	10	8579	75	5		10	10	T	0.9	4030 G.S. 10 Gmst 25 Qtz 25 Pyt 100T	8579	37	19	71			
10	15	8580	60	10		20	10	T	0.5	4025 G.S. 10 Gmst 20 Qtz 25 Pyt 100T	8580	70	59	130			
15	20	8581	70			20	10	T	0.3	4040 G.S. 30 Gmst 10 Qtz 20 Pyt 100T	8581	17	16	80			
20	25	8582	90				10	T	0.6	4030 G.S. 15 Gmst 20 Qtz 35 Pyt 100T	8582	20	15	80			
25	30	8583	60			30	10	T	0.3	4030 G.S. 15 Gmst 35 Qtz 20 ZnS Pyt 100T	8583	43	14	78			
30	35	8584	50			40	10	T	0.8	4035 G.S. 10 Gmst 30 Qtz 25 ZnS Pyt 100T	8584	21	13	71			
35	40	8585	60			30	10	T	0.9	4040 G.S. 10 Gmst 25 Qtz 25 ZnS Pyt 100T	8585	16	11	70			
40	45	8586	50			40	10	T	0.8	4025 G.S. 10 Gmst 25 Qtz 20 ZnS Pyt 100T 100T	8586	16	14	68			
45	50	8587	50	10		30	10	T	0.9	4020 G.S. 15 Gmst 50 Qtz 25 ZnS Pyt Fe3O4T	8587	16	15	76			
50	55	8588	70			20	10		0.6	4030 G.S. 10 Gmst 20 Qtz 20 ZnS Pyt Fe3O4T	8588	60	14	69			
55	60	8589	60			30	10	T		4030 G.S. 10 Gmst 35 Qtz 20 ZnS Pyt 100T	8589	17	11	71			

UNITED KENO HILL MINES LTD. OVERBURDEN DRILL HOLE LOG

Location 11150' 50" Latitude _____ Departure _____ Hole No. A65111
 Date Drilled 2-1-75 Elevation _____ Bearing _____ Page No. 2 Of 5
 Casing Depth 20' Overburden Depth 20' Length of Hole 230' Dip 65°

G.Q. Grey Quartzite; G.S. Graphite Schist; S.S. Sericite Schist; Gmst. Greenstone; Qtz. Quartz; Lim. Limonite; Py. Pyrite; Pbs. Galena; ZnS Sphalerite

Footage		Sample No.	Coarse Material (%) (+14 mesh)						Panning Concentrate Mineral Content (%)		Sample No.	Geochemical Results			Assay Results		
From	To		G.Q.	G.S.	S.S.	Gmst.	Qtz.	Lim	grams			Pb. (ppm)	Ag. (ppm)	Zn (ppm)	Ag. (oz/ton)	Pb. (%)	Zn (%)
60	65	8590	60	10		30	10	T	0.3	GQ 40 GS 15 Gmst 20 Qtz 15 ZnS T PHO	8590	11	97	59			
65	70	8591	55	5		30	10	T	0.3	GQ 25 GS 10 Gmst 20 Qtz 25 ZnS PY 20	8591	14	12	76			
70	75	8592	90				10	T	0.5	GQ 30 GS 10 Gmst 15 Qtz 20 ZnS PY 15	8592	10	97	39			
75	80	8593	70	30				T	0.8	GQ 40 GS 20 Gmst 10 Qtz 20 PY ZnS T	8593	6	35	127			
80	85	8594	50	40				T	1.1	GQ 25 GS 15 Qtz 20 PY 40 ZnS T FeS 2 T	8594	13	10	152			
85	90	8595	60	30				T	0.2	GQ 30 GS 10 Qtz 5 PY 10	8595	12	13	147			
90	95	8596	50	40				T	0.5	GQ 20 GS 10 Qtz 40 FeS 2 T PY 30 Gmst 10	8596	15	97	145			
95	100	8597	70	20				T	0.8	GQ 20 GS 10 Qtz 20 PY 50	8597	15	97	15			
100	105	8598	60	30				T	1.0	GQ 10 GS 25 Qtz 10 PY 55	8598	12	11	37			
105	110	8599	50	40				T	0.6	GQ 20 GS 30 Qtz 20 PY 30	8599	11	13	152			
110	115	8600	40	50				T	0.5	GQ 20 GS 20 Qtz 10 PY 50	8600	12	12	52			

UNITED KENO HILL MINES LTD. OVERBURDEN DRILL HOLE LOG

Location 11214 310 Latitude _____ Departure _____ Hole No. A6511
 Date Drilled July 1965 Elevation _____ Bearing _____ Page No. 3 of 5
 Casing Depth _____ Overburden Depth 20 Length of Hole 230' Dip _____

G.Q. Grey Quartzite; G.S. Graphite Schist; S.S. Sericite Schist; Grnst. Greenstone; Qtz. Quartz; Lim. Limonite; Py. Pyrite; Pbs. Galena; ZnS Sphalerite

Footage		Sample No.	Coarse Material (%) (+14 mesh)						Panning Concentrate Mineral Content (%)		Sample No.	Geochemical Results			Assay Results		
From	To		G.Q.	G.S.	S.S.	Grnst.	Qtz.	Lim.	grams			Pb. (ppm)	Ag. (ppm)		Ag. (oz/ton)	Pb. (%)	Z (%)
115	120	8601	40	10			T		1.5	40% G.S. 20 Qtz 25 Py 15 Pbs	8601	10	10	51			
120	125	8602	60	20			10		0.6	40% G.S. 5 Qtz 20 Py 45 Feasst Pbs	8602	10	0.8	30			
125	130	8603	40	60			T		4.1	40% G.S. 20 Py 50 Pbs Qtz 20	8603	10	0.8	50			
130	135	8604	50	30	10		10		1.0	40% G.S. 10 Qtz 25 Py 50 Feasst	8604	15	0.7	49			
135	140	8605	40	15	40		5		0.8	40% G.S. 10 Qtz 30 Py 50 Feasst ZnS Pbs	8605	10	11	100			
140	145	8606	35	10	50		5		1.0	40% G.S. 10 Qtz 30 Py 45 Feasst	8606	10	0.7	15			
145	150	8607	50	10	40		T		0.6	40% G.S. 5 Qtz 50 Py 20 Feasst	8607	15	10	50			
150	155	8608	30	20	50		T		0.3	40 G.S. Qtz Py Feasst	8608	29	9.8	90			
155	160	8609	30	30	40		T		0.5	40% G.S. 10 Qtz 50 Py 10 Feasst Ss	8609	15	11	100			
160	165	8610	40	T	50	T	10		0.6	40% G.S. 10 Qtz 55 Ss Feasst Py 15	8610	29	0.7	150			
165	170	8611	40	20	30	10	T		0.2	40% G.S. 5 Ss Qtz 50 Feasst Py 20	8611	24	1.0	25			

UNITED KENO HILL MINES LTD.

OVERBURDEN DRILL HOLE LOG

Location Hillside 544 Latitude _____ Departure _____ Hole No. A6510
 Date Drilled June 1955 Elevation _____ Bearing _____ Page No. 4 of 5
 Casing Depth 21' Overburden Depth 10' Length of Hole 230' Dip 18'

G.Q. Grey Quartzite; G.S. Graphite Schist; S.S. Sericite Schist; Grnst. Greenstone; Qtz. Quartz; Lim. Limonite; Py. Pyrite; Pbs. Galena; ZnS Sphalerite

Footage		Sample No.	Coarse Material (%) (+14 mesh)					Panning Concentrate Mineral Content (%)				Sample No.	Geochemical Results			Assay Results		
From	To		G.Q.	G.S.	S.S.	Grnst.	Qtz.	Lim	grams	Grst.	Qtz.		Py.	Pb.	Ag.	Other	Ag. (oz/ton)	Pb. (%)
170	175	8612	30	20	40		10		0.5	Gr 15	Ls 10	Ss 5	Qtz 25	Py 20	Fe Asst	25	19	112
175	180	8613	40	20	30	T	10		0.5	Gr 10	Gr 20	Qtz 20	Py 30	Ss		49	29	131
180	185	8614	40	10	30	10	10		0.5	Gr 10	Ls 10	Qtz 25	Ss 10	Py 20		45	29	119
185	190	8615	50	10	30	T	10		0.7	Gr 25	Ls 10	Qtz 20	Ss 20	Py 15	Zn Asst	36	19	114
190	195	8616	40	10	40	T	10		0.9	Gr 20	Ls 10	Ss 10	Qtz 50	Py 10	Zn Asst	37	29	112
195	200	8617	40	10	30	10	10		0.5	Gr 15	Ls 5	Qtz 25	Ss 20	Py 10	Fe Asst	34	32	119
200	205	8618	30	20	40	T	10		0.9	Gr 10	Ls 10	Qtz 40	Ss 20	Py 20		31	25	112
205	210	8619	30	20	30	10	10		1.2	Gr 20	Ls 10	Ss 20	Qtz 35	Py 15		39	32	115
210	215	8620	40	10	40	10	T		1.4	Gr 15	Ls 15	Ss 25	Qtz 25	Py 10		34	29	112
215	220	8621	30	20	40	T	10		0.8	Gr 10	Ls 5	Ss 30	Qtz 40	Py 15		37	27	111
220	225	8622	40	20	20	10	10		0.9	Gr 20	Ls 10	Ss 25	Qtz 35	Py 10		36	26	115

UNITED KENO HILL MINES LTD.

OVERBURDEN DRILL HOLE LOG

#162

Location HUSKY SW Latitude _____ Departure _____ Hole No. 46513
 Date Drilled JUNE 21 1955 Elevation _____ Bearing _____ Page No. 1 Of 5
 Casing Depth 28' Overburden Depth 70-75' Length of Hole 230' Dip 59°

G.Q. Grey Quartzite; G.S. Graphite Schist; S.S. Sericite Schist; Grnst. Greenstone; Qtz. Quartz; Lim. Limonite; Py. Pyrite; Pbs. Galena; ZnS Sphalerite

Footage		Sample No.	Coarse Material (%) (+14 mesh)						Panning Concentrate Mineral Content (%)		Sample No.	Geochemical Results			Assay Results	
From	To		G.Q.	G.S.	S.S.	Grnst.	Qtz.	Lim	grams			Pb. (ppm)	Ag. (ppm)		Ag. (oz/ton)	Pb. (%)
0	10	8624	50	10		20	20	T	2.0	Grst 45.5 Limst 30 Qtz 2.0 Pyt Znst Fe3O4 Limit	8624	25	35	20		
10	15	8625	50	T		10	40	T	2.3	Grst 45.15 Limst 15 Qtz 2.30 Znst Pyt	8625	22	11	95		
15	20	8626	60	T		10	30	T	2.0	Grst 45.10 Limst 20 Qtz 2.00 Pyt Znst	8626	180	110	10		
20	25	8627	50	10		20	20	T	0.9	Grst 45.5 Limst 25 Qtz 2.25 Pyt Znst Limit	8627	36	16	20		
25	30	8628	40	10		10	40		0.8	Grst 45.20 Limst 20 Qtz 2.20 Znst Pyt Limit	8628	30	14	50		
30	35	8629	20	10		30	40	T	0.5	Grst 45.15 Limst 20 Qtz 2.25 Limit Znst Pyt	8629	49	15	70		
35	40	8630	40	10		20	30	T	1.9	Grst 45.20 Limst 25 Qtz 2.35 Pyt Znst Limit	8630	20	18	90		
40	45	8631	60	10		10	20	T	2.2	Grst 45.15 Limst 20 Limit Qtz 2.30 Pyt Znst	8631	22	16	55		
45	50	8632	60	10		10	20	T	1.5	Grst 45.20 Limst 30 Qtz 2.25 Pyt Znst Limit	8632	22	13	20		
50	55	8633	70	5		5	20	T	1.5	Grst 45.10 Limst 25 Qtz 2.20 Pyt Znst Limit Fe3O4	8633	37	16	15		
55	60	8634	50	10		20	20	T	1.3	Grst 45.20 Limst 35 Limit Qtz 2.25 Pyt Znst Fe3O4	8634	26	08	20		

UNITED KENO HILL MINES LTD. OVERBURDEN DRILL HOLE LOG

Location 11150m S.M.S. Latitude _____ Departure _____ Hole No. A 6513
 Date Drilled 10-21-57 Elevation _____ Bearing _____ Page No. 2 Of 5
 Casing Depth 2' Overburden Depth 10-35' Length of Hole 230' Dip _____

G.Q. Grey Quartzite; G.S. Graphite Schist; S.S. Sericite Schist; Grnst. Greenstone; Qtz. Quartz; Lim. Limonite; Py. Pyrite; Pbs. Galena; ZnS Sphalerite

Footage		Sample No.	Coarse Material (%) (+14 mesh)					Panning Concentrate Mineral Content (%)			Sample No.	Geochemical Results			Assay Results		
From	To		G.Q.	G.S.	S.S.	Grnst.	Qtz.	Lim.	grams	Pb. (ppm)		Ag. (ppm)	Zn (ppm)	Ag. (oz/ton)	Pb. (%)	Zn (%)	
65	70	8635	50	10		10	30	T	1.7	Gr 20 G.S. 10 Grnst 5 Qtz 20 PY 7 ZNST LIMIT	8635	14	17	45			
65	70	8636	60	10		5	25		0.8	Gr 50 G.S. 10 Grnst 20 Qtz 20 PY 7 ZNST LIMIT	8636	20	17	29			
70	75	8637	60	10		10	20	T	1.5	Gr 10 G.S. 15 Grnst 15 Qtz 30 PY 30 ZNST LIMIT	8637	15	11	51			
75	80	8638	70	10		10	10		3.0	Gr 20 G.S. 15 Grnst 20 Qtz 10 PY 20 ZNST LIMIT	8638	15	17	46			
80	85	8639	50	20		10	20		2.8	Gr 15 G.S. 10 Grnst 20 Qtz 30 PY 25 ZNST LIMIT	8639	14	13	47			
85	90	8640	50	20		20	10		2.0	Gr 30 G.S. 10 Grnst 30 Qtz 15 PY 15 ZNST LIMIT Fe 54 T.	8640	17	0.8	51			
90	95	8641	40	20		30	10		3.2	Gr 20 G.S. 10 Grnst 20 Qtz 30 PY 20 ZNST LIMIT	8641	13	11	49			
95	100	8642	50	20		20	10		0.5	Gr 30 G.S. 10 Grnst 30 Qtz 20 PY 10 ZNST LIMIT	8642	13	10	51			
100	105	8643	30	10	30	30	10		2.9	Gr 15 G.S. 15 S.S. 20 Grnst 10 Qtz 20 PY 20 ZNST Fe 55 T.	8643	12	0.7	54			
105	110	8644	20	20	30	30	10		3.0	Gr 10 G.S. 10 Grnst 10 S.S. 25 Fe 55 T. Qtz 25 PY 20 ZNST	8644	11	0.6	53			
110	115	8645	50	20	5	5	20		4.3	Gr 20 G.S. 15 Qtz 25 G.S.T. PY 40 Fe 55 T.	8645	6	0.7	42			

UNITED KENO HILL MINES LTD. OVERBURDEN DRILL HOLE LOG

Location HINKU 501 Latitude _____ Departure _____ Hole No. 46513
 Date Drilled July 1957 Elevation _____ Bearing _____ Page No. 3 Of 5
 Casing Depth 28' Overburden Depth 80-75' Length of Hole 230' Dip 59°

G.Q. Grey Quartzite; G.S. Graphite Schist; S.S. Sericite Schist; Grnst. Greenstone; Qtz. Quartz; Lim. Limonite; Py. Pyrite; Pbs. Galena; ZnS Sphalerite

Footage		Sample No.	Coarse Material (%) (+14 mesh)					Panning Concentrate Mineral Content (%)			Sample No.	Geochemical Results			Assay Results	
From	To		G.Q.	G.S.	S.S.	Grnst.	Qtz.	Lim	grams	Pb. (ppm)		Ag. (ppm)	Zn (ppm)	Ag. (oz/ton)	Pb. (%)	Z (%)
115	120	8646	50	40	5		5	2.0	4015 4550 Qtz 15 PY20 ZnST	8646	4	25	25			
125	135	8647	50	30			20	7.5	4020 45 50 Qtz 15 PY15 SST	8647	12	39	90			
135	130	8648	30	20			10	5.5	4020 46 40 Qtz 10 PY30 LIMST ZnST	8648	12	39	110			
130	135	8649	60	30	T		10	3.5	4020 45 10 Qtz 20 PY50 LIMST	8649	12	39	69			
135	140	8650	50	40			10	2.5	4020 66 30 Qtz 25 PY25 Grnst	8650	15	16	115			
140	145	8651	40	50			10	7.5	4025 45 25 Qtz 10 PY20 FeSST	8651	12	11	17			
145	150	8652	45	45			10	9.0	4015 46 20 Qtz 15 PY50	8652	13	39	160			
150	155	8653	50	20	20		10	6.0	4015 45 15 Qtz 20 PY50 ZnST	8653	19	39	119			
155	160	8654	60	10	15	5	10	2.2	4025 46 5 Qtz 30 PY30 FeSST SS 10 ZnST	8654	13	11	175			
140	145	8655	10	10	5	5	20	1.5	4020 45 10 Qtz 30 PY30 FeSST SS 10 ZnST	8655	6	67	14			
165	170	8656	40	T	30	20	10	4.9	4020 46 5 SS Qtz 30 PY40 FeCO3 PbST ZnST	8656	4	39	52			

UNITED KENO HILL MINES LTD. OVERBURDEN DRILL HOLE LOG

Location 111520 500 Latitude _____ Departure _____ Hole No. AG513
 Date Drilled Jan 21/55 Elevation _____ Bearing _____ Page No. 4 Of 5
 Casing Depth 20' Overburden Depth 20-25' Length of Hole 230' Dip 55°

G.Q. Grey Quartzite; G.S. Graphite Schist; S.S. Sericite Schist; Grnst. Greenstone; Qtz. Quartz; Lim. Limonite; Py. Pyrite; Pbs. Galena; ZnS Sphalerite

Footage		Sample No.	Coarse Material (%) (+14 mesh)						Panning Concentrate Mineral Content (%)		Sample No.	Geochemical Results			Assay Results		
From	To		G.Q.	G.S.	S.S.	Grnst.	Qtz.	Lim	grams			Pb. (ppm)	Ag. (ppm)	Zn (%)	Ag. (oz/ton)	Pb. (%)	Zn (%)
170	175	8657	20		40	30	10		1.5	GR10 GS10 SS20 QTZ30 ZNST FeASST PY30	8657	4	0.9	55			
175	180	8658	35		30	30	5		4.0	GR10 GS10 SS30 QTZ30 PY20 ZNST	8658	4	0.5	66			
180	185	8659	50		10	20	20		2.0	GR25 GS10 SS15 QTZ20 PY30	8659	10	3.7	61			
185	189	8660	40	30	10		20		3.5	GR20 GS20 QTZ20 SST PY30	8660	9	0.5	63			
185	185	8661	40	10	30	5	15		6.5	QTZ35 GR20 GS5 PY30 SS10	8661	14	9.6	91			
185	200	8662	30	T	40	20	10		5.6	GR10 LST QTZ30 PY50 SS10 ZNST	8662	11	9.1	111			
200	205	8663	20		30	30	20		1.9	GR10 SS40 QTZ20 LST PY30 ZNST	8663	20	0.5	69			
205	210	8664	20	10	20	30	20		2.7	GR20 GS15 SS10 QTZ30 PY25 ZNST	8664	19	3.5	71			
210	215	8665	30	20	10	20	20		2.3	GR20 GS10 QTZ40 SST PY30 ZNST	8665	17	0.9	76			
215	220	8666	40	20	5	10	25	T	2.1	GR15 GS10 SS5 QTZ50 FRASST PY25	8666	21	0.9	76			
220	235	8667	30	20	20	10	20	T		GR20 GS10 QTZ40 PY20 SS10	8667	29	0.4	74			

UNITED KENO HILL MINES LTD.

OVERBURDEN DRILL HOLE LOG

Location HUSKY SW Latitude _____ Departure _____ Hole No. A 6538
 Date Drilled JUNE 3/75 Elevation _____ Bearing _____ Page No. 1 Of 3
 Casing Depth _____ Overburden Depth 75' Length of Hole 170' Dip 61°

G.Q. Grey Quartzite; G.S. Graphite Schist; S.S. Sericite Schist; Gmst. Greenstone; Qtz. Quartz; Lim. Limonite; Py. Pyrite; Pbs. Galena; ZnS Sphalerite

Footage		Sample No.	Coarse Material (%) (+14 mesh)						Panning Concentrate Mineral Content (%)		Sample No.	Geochemical Results			Assay Results	
From	To		G.Q.	G.S.	S.S.	Gmst.	Qtz.	Lim	grams	Pb. (ppm)		Ag. (ppm)	Zn (ppm)	Ag. (oz/ton)	Pb. (%)	
0	10	8880	50	20		20	10		2.0	8880	40	27	77			
10	15	8881	30	20	T	10	40	T	1.5	8881	21	14	83			
15	20	8882	40	20	10	10	20	T	2.0	8882	27	20	83			
20	25	8883	40	15	T	15	30	T	2.0	8883	38	13	78			
25	30	8884	40	20	T	20	20	T	1.5	8884	26	18	26			
30	35	8885	60	10		30		T	2.5	8885	33	16	73			
35	40	8886	40	20		20	10	T	1.5	8886	24	13	75			
40	45	8887	50	20		20	10	T	2.0	8887	23	14	54			
45	50	8888	30	20	10	10	10	T	2.0	8888	40	15	59			
50	55	8889	30	20	20	20	10	T	2.5	8889	22	12	68			
55	60	8890	40	25	5	10	20	T	2.5	8890	22	13	59			

UNITED KENO HILL MINES LTD.

OVERBURDEN DRILL HOLE LOG

Location Map A-50 Latitude _____ Departure _____ Hole No. A6538
 Date Drilled 2-28-51 Elevation _____ Bearing _____ Page No. 2 of 3
 Casing Depth _____ Overburden Depth _____ Length of Hole 170' Dip 61°

G.Q. Grey Quartzite; G.S. Graphite Schist; S.S. Sericite Schist; Grnst. Greenstone; Qtz. Quartz; Lim. Limonite; Py. Pyrite; Pbs. Galena; ZnS Sphalerite

Footage		Sample No.	Coarse Material (%) (+14 mesh)						Panning Concentrate Mineral Content (%)	Sample No.	Geochemical Results			Assay Results		
From	To		G.Q.	G.S.	S.S.	Grnst.	Qtz.	Lim			grams	Pb. (ppm)	Ag. (ppm)	Zn (ppm)	Ag. (oz/ton)	Pb. (%)
30	35	8891	30	30	T	20		T	2.0	1.2	1.2	63				
65	70	8892	60	20	T	10	10	T	1.5	1.3	58					
70	75	8893	30	30	T	20	20	T	2.0	1.1	82					
75	80	8894	40	40			20	T	2.0	1.3	54					
80	85	8895	40	45		5	10	T	2.0	1.5	65					
85	90	8896	40	20			10	T	1.5	1.3	56					
90	95	8897	60	30			10		2.0	1.3	70					
95	100	8898	50	40			10		2.0	1.4	48					
100	105	8899	80	10			10	T	1.5	0.7	76					
105	110	8900	85	10			5		1.0	0.7	22					
110	115	8901	60	30			10		2.0	0.8	81					

UNITED KENO HILL MINES LTD. OVERBURDEN DRILL HOLE LOG

Location H1134-311 Latitude _____ Departure _____ Hole No. A6538
 Date Drilled JUNE 27 1955 Elevation _____ Bearing _____ Page No. 2 Of 3
 Casing Depth 39' Overburden Depth 93' Length of Hole 170' Dip 61°

G.Q. Grey Quartzite; G.S. Graphite Schist; S.S. Sericite Schist; Grnst. Greenstone; Qtz. Quartz; Lim. Limonite; Py. Pyrite; Pbs. Galena; ZnS Sphalerite

Footage		Sample No.	Coarse Material (%) (+14 mesh)						Panning Concentrate Mineral Content (%)		Sample No.	Geochemical Results			Assay Results		
From	To		G.Q.	G.S.	S.S.	Grnst.	Qtz.	Lim	grams	Pb. (ppm)		Ag. (ppm)	Zn (%)	Ag. (oz/ton)	Pb. (%)	Zr (%)	
115	120	8902	50	20			10		1.5	8902	16	1.3	24				
120	125	8903	50	30		10	10	T	1.5	8903	12	1.0	22				
125	130	8904	70	20			10	T	1.5	8904	11	0.9	11				
130	135	8905	40	30		20	10		1.5	8905	10	0.9	9				
135	140	8906	70	20			10		1.5	8906	11	1.1	9				
140	145	8907	85	5			10		1.5	8907	15	1.0	21				
145	150	8908	80				20		1.5	8908	10	1.3	11				
150	155	8909	80	10			10		1.5	8909	8	0.9	16				
155	160	8910	90				10		1.5	8910	13	0.8	15				
160	165	8911	70	20			10		2.0	8911	11	1.1	36				
165	170	8912	80	10			10	T	1.5	8912	10	1.2	12				

UNITED KENO HILL MINES LTD.

OVERBURDEN DRILL HOLE LOG

Location Huskey SW Latitude _____ Departure _____ Hole No. AG539
 Date Drilled JUNE 3/75 Elevation _____ Bearing _____ Page No. 1 Of 4
 Casing Depth 30' Overburden Depth 70' Length of Hole 180' Dip 58°

G.Q. Grey Quartzite; G.S. Graphite Schist; S.S. Sericite Schist; Grnst. Greenstone; Qtz. Quartz; Lim. Limonite; Py. Pyrite; Pbs. Galena; ZnS Sphalerite

Footage		Sample No.	Coarse Material (%) (+14 mesh)					Panning Concentrate Mineral Content (%)			Sample No.	Geochemical Results			Assay Results		
From	To		G.Q.	G.S.	S.S.	Grnst.	Qtz.	Lim	grams	Pb. (ppm)		Ag. (ppm)	Cu (ppm)	Ag. (oz/ton)	Pb. (%)	Zn (%)	
0	10	8795	70			5	35	T	1.5	GRNST 10 QTZ 10 G.S. 25 G.S. 15 Py. 10 ZNST LIMIT	8795	103	46	52			
10	15	8796	60			5	35	T	1.3	GRNST 45 QTZ 15 G.S. 20 G.S. 10 Py. 10 ZNST LIMIT	8796	165	21	31			
15	20	8797	60			10	30	T	1.5	GRNST 30 QTZ 10 G.S. 20 G.S. 15 Py. 5 ZNST LIMIT	8797	101	32	34			
20	35	8798	80	10			10	T	2.9	GRNST 45 QTZ 15 G.S. 25 G.S. 10 Py. 5 ZNST LIMIT	8798	442	153	44			
35	30	8799	80				30	T	4.8	GRNST 20 QTZ 15 G.S. 40 G.S. 20 Py. 5 ZNST SST LIMIT	8799	195	124	43			
30	35	8800	30	15		10	45	T	3.9	GRNST 40 QTZ 10 G.S. 30 G.S. 15 Py. 5 ZNST SST LIMIT	8800	33	10	26			
35	40	8851	20	20		20	40	T	4.9	GRNST 20 QTZ 10 G.S. 40 G.S. 25 Py. 5 ZNST LIMIT	8851	36	17	34			
40	45	8852	30	20		20	30	T	5.2	GRNST 35 QTZ 15 G.S. 35 G.S. 15 Py. 5 ZNST LIMIT	8852	21	12	23			
45	50	8853	20	30		30	20	T	4.4	GRNST 40 QTZ 10 G.S. 25 G.S. 15 Py. 10 ZNST LIMIT	8853	44	14	24			
50	55	8854	20	20		30	30	T	3.9	GRNST 35 QTZ 15 G.S. 25 G.S. 15 Py. 10 ZNST LIMIT	8854	44	17	24			
55	60	8855	60	10		10	20	T	2.8	GRNST 35 QTZ 10 G.S. 20 G.S. 20 Py. 15 ZNST LIMIT	8855	73	15	23			

UNITED KENO HILL MINES LTD. OVERBURDEN DRILL HOLE LOG

Location HILL 4 Latitude _____ Departure _____ Hole No. A6539
 Date Drilled 2-10-59 Elevation _____ Bearing _____ Page No. 2 of 4
 Casing Depth _____ Overburden Depth 70' Length of Hole 180' Dip 58°

G.Q. Grey Quartzite; G.S. Graphite Schist; S.S. Sericite Schist; Gmst. Greenstone; Qtz. Quartz; Lim. Limonite; Py. Pyrite; Pbs. Galena; ZnS Sphalerite

Footage		Sample No.	Coarse Material (%) (+14 mesh)					Panning Concentrate Mineral Content (%)		Sample No.	Geochemical Results			Assay Results		
From	To		G.Q.	G.S.	S.S.	Gmst.	Qtz.	Lim	grams		Pb. (ppm)	Ag. (ppm)	Zn (%)	Ag. (oz/ton)	Pb. (%)	Zn (%)
60	65	8856	30	10		40	20	T	2.9	Gmst 40 Qtz 10 Gs 20 G.S. 15 Py. 15 ZnS LIMIT	8856	25	10	55		
65	70	8857	5	90		5	10	T	2.2	Gmst 20 Qtz 10 Gs 35 G.S. 15 Py. 20 ZnS LIMIT	8857	29	16	55		
70	75	8858		75		5	20	T	2.1	Qtz 10 Gs 35 Gs 20 Py. 35 ZnS LIMIT	8858	21	23	20		
75	80	8859	80	10			10	T	2.5	Qtz 15 Gs 25 Gs 20 Py. 40 ZnS LIMIT	8859	19	15	40		
80	85	8860	80				20	T	2.7	Qtz 20 Gs 35 Gs 20 Py. 25 ZnS LIMIT	8860	20	13	40		
85	90	8861	70	10			20	T	2.8	Qtz 20 Gs 50 Gs 25 Py. 15 ZnS LIMIT	8861	15	28	30		
90	95	8862	30	60	7		10	T	2.8	Qtz 15 Gs 25 Gs 20 Py. 40 ZnS	8862	18	13	39		
95	100	8863	85	10			5	T	2.4	Qtz 20 Gs 25 Gs 25 Py. 30 ZnS Fe Asst	8863	16	28	29		
100	105	8864	40	5			5	T	2.0	Qtz 20 Gs 30 Gs 25 Py. 25 ZnS Fe Asst	8864	11	11	15		
105	110	8865	100				T	T	2.7	Qtz 20 Gs 30 Gs 25 Py. 25 ZnS Fe Asst	8865	10	12	19		
110	115	8866	75	5			20		3.2	Qtz 20 Gs 25 Gs 30 Py. 25 ZnS	8866	15	11	25		

UNITED KENO HILL MINES LTD.

OVERBURDEN DRILL HOLE LOG

Location 174 Latitude _____ Departure _____ Hole No. A6539
 Date Drilled _____ Elevation _____ Bearing _____ Page No. 3 Of 4
 Casing Depth _____ Overburden Depth _____ Length of Hole 180' Dip 58°

G.Q. Grey Quartzite; G.S. Graphite Schist; S.S. Sericite Schist; Gmst. Greenstone; Qtz. Quartz; Lim. Limonite; Py. Pyrite; Pbs. Galena; ZnS Sphalerite

Footage		Sample No.	Coarse Material (%) (+14 mesh)						Panning Concentrate Mineral Content (%)		Sample No.	Geochemical Results			Assay Results			
From	To		G.Q.	G.S.	S.S.	Gmst.	Qtz.	Lim	grams	Qtz		G.S.	Pb. (ppm)	Ag. (ppm)	Zn (ppm)	Ag. (oz/ton)	Pb. (%)	Zn (%)
135	140	8867	45				5	7	4.1	Qtz 20 G.S. 40 G.S. 25 Pb. 15 Zn 25	8867	12	22	10				
140	145	8868	40				10	T	2.3	Qtz 15 G.S. 40 G.S. 30 Pb. 10 Zn 25	8868	11	22	15				
145	150	8869	MISSING SAMPLE															
140	145	8870	70	20			10	T	3.5	Qtz 20 G.S. 25 G.S. 30 Pb. 30 Zn 25	8870	13	22	31				
135	140	8871	35	60			5	T	3.0	Qtz 10 G.S. 20 G.S. 15 Pb. 55 Zn 25	8871	11	14	51				
140	145	8872	60	20	12		20	T	1.3	Qtz 15 G.S. 20 G.S. 10 Pb. 55 Zn 25	8872	24	13	50				
145	150	8873	30	10			40	T	2.5	Qtz 15 G.S. 40 G.S. 15 Pb. 30 Zn 25	8873	10	14	24				
150	153	8874	80	10			10	T	1.9	Qtz 10 G.S. 40 G.S. 15 Pb. 35 Zn 25	8874	11	16	20				
135	140	8875	70	10			20	T	2.9	Qtz 20 G.S. 35 G.S. 15 Pb. 30 Zn 25	8875	15	12	15				
160	165	8876	50				T	20	T	1.6	Qtz 15 G.S. 25 G.S. 15 Pb. 45 Zn 25 LIMIT	8876	25	10	22			
145	170	8877	85				5	10	T	2.1	Qtz 15 G.S. 30 G.S. 20 Pb. 35 Zn 25 LIMIT	8877	18	22	25			

UNITED KENO HILL MINES LTD. OVERBURDEN DRILL HOLE LOG

Location Latitude Departure Hole No. A6540
 Date Drilled Elevation Bearing Page No. 2 Of 4
 Casing Depth Overburden Depth Length of Hole 210' Dip 35.56°

G.Q. Grey Quartzite; G.S. Graphite Schist; S.S. Sericite Schist; Gmst. Greenstone; Qtz. Quartz; Lim. Limonite; Py. Pyrite; Pbs. Galena; ZnS Sphalerite

Footage		Sample No.	Coarse Material (%) (+14 mesh)						Panning Concentrate Mineral Content (%)		Sample No.	Geochemical Results			Assay Results		Z (%)
From	To		G.Q.	G.S.	S.S.	Gmst.	Qtz.	Lim	grams	Py.		Pb.	Ag.	Zn	Ag. (oz/ton)	Pb. (%)	
60	65	8765	90			10	20	T	1.5	GR 20 Py. 15 G.S. 30 G.S. 20 Py. 15 Fe. 10 LIMT ZNST	8765	23	12	39			
65	70	8766	80			10	10	T	3.1	GR 10 G.S. 15 G.S. 30 G.S. 25 Py. 10 Fe. 10 LIMT ZNST	8766	15	26	9			
70	75	8767	90			5	5	T	2.8	GR 10 G.S. 35 G.S. 35 Py. 15 Fe. 10 ZNST LIMT	8767	11	24	14			
75	80	8768	95				5	T	2.9	GR 10 G.S. 40 G.S. 30 Py. 20 ZNST LIMT	8768	16	24	49			
80	85	8769	85	5			10	T	2.9	GR 15 G.S. 25 G.S. 25 Py. 35 ZNST LIMT	8769	16	29	96			
85	90	8770	70	20	14		10		4.5	GR 10 G.S. 25 G.S. 20 Py. 45 ZNST LIMT	8770	22	22	63			
90	95	8771	85	5			10		5.5	GR 10 G.S. 35 G.S. 25 Py. 30 ZNST	8771	13	26	60			
95	100	8772	75	20			5		4.6	GR 15 G.S. 30 G.S. 30 Py. 25 ZNST	8772	11	24	63			
100	105	8773	95	5					2.9	GR 10 G.S. 30 G.S. 30 Py. 30 ZNST P.S. 5	8773	10	25	68			
105	110	8774	60	30	14		10		2.6	GR 15 G.S. 30 G.S. 20 Py. 35 ZNST	8774	14	26	63			
110	115	8775	10	85			5		5.2	GR 10 G.S. 25 G.S. 25 Py. 40 ZNST	8775	12	25	59			

UNITED KENO HILL MINES LTD.

OVERBURDEN DRILL HOLE LOG

Location 111111 500 Latitude _____ Departure _____ Hole No. 16540
 Date Drilled 7-2-75 Elevation _____ Bearing _____ Page No. 3 of 4
 Casing Depth 30 Overburden Depth 75' Length of Hole 210' Dip 58°

G.Q. Grey Quartzite; G.S. Graphite Schist; S.S. Sericite Schist; Gmst. Greenstone; Qtz. Quartz; Lim. Limonite; Py. Pyrite; Pbs. Galena; ZnS Sphalerite

Footage		Sample No.	Coarse Material (%) (+14 mesh)						Panning Concentrate Mineral Content (%)		Sample No.	Geochemical Results			Assay Results		
From	To		G.Q.	G.S.	S.S.	Gmst.	Qtz.	Lim	grams	Qtz. 25 Gm 35 GS 25 Pys. 15 Zn 25		Pb. (ppm)	Ag. (ppm)	120' (ppm)	Ag. (oz/ton)	Pb. (%)	Zn (%)
115	120	8776	80	20					3.8	Qtz. 25 Gm 35 GS 25 Pys. 15 Zn 25	8776	15	0.5	94			
120	125	8777	40	10					2.1	Qtz. 20 Gm 35 GS 25 Pys. 20	8777	11	0.4	96			
125	130	8778	70	20			10		3.0	Qtz. 20 Gm 35 GS 25 Pys. 20	8778	17	0.5	88			
130	135	8779	10	30	1		10		3.5	Qtz. 10 Gm 30 GS 25 Pys. 35	8779	21	0.2	101			
135	140	8780	5	90			5		6.0	Qtz. 10 Gm 25 GS 20 Pys. 45	8780	15	0.3	98			
140	145	8781	30	40	1		30		5.7	Qtz. 10 Gm 25 GS 20 Pys. 45	8781	12	0.4	95			
145	150	8782							3.6	Qtz. 15 Gm 25 GS 25 Pys. 35	8782	07	0.2	125			
150	155	8783	85	10			5	T	4.8	Qtz. 20 Gm 20 GS 30 Pys. 30	8783	19	0.9	94%			
155	160	8784	30	40			30	T	6.9	Qtz. 15 Gm 20 GS 30 Pys. 35	8784	17	0.6	122			
160	165	8785	30	30	1		40	T	5.1	Qtz. 15 Gm 20 GS 25 Pys. 40	8785	15	1.0	97			
165	170	8786	40	20	1		40		4.8	Qtz. 15 Gm 35 GS 25 Pys. 25	8786	14	1.0	97			

UNITED KENO HILL MINES LTD. OVERBURDEN DRILL HOLE LOG

Location 111510 201 Latitude _____ Departure _____ Hole No. A6540
 Date Drilled 7-11-57 Elevation _____ Bearing _____ Page No. 4 Of 4
 Casing Depth 30' Overburden Depth 25' Length of Hole 210' Dip 56°

G.Q. Grey Quartzite; G.S. Graphite Schist; S.S. Sericite Schist; Grnst. Greenstone; Qtz. Quartz; Lim. Limonite; Py. Pyrite; Pbs. Galena; ZnS Sphalerite

Footage		Sample No.	Coarse Material (%) (+14 mesh)					Panning Concentrate Mineral Content (%)			Sample No.	Geochemical Results			Assay Results				
From	To		G.Q.	G.S.	S.S.	Grnst.	Qtz.	Lim	grams	Qtz.		Py.	ZnS	Pb. (ppm)	Ag. (ppm)	Zn (ppm)	Ag. (oz/ton)	Pb. (%)	Z (%)
170	175	8787	60	20			20		4.8	Qtz 15 Py. 25	G 25 S 30	GS 20	8787	16	10	85			
175	180	8788	75	20			5		5.5	Qtz 15 Py. 25	G 25 S 25	GS 35	8788	12	10	84			
180	185	8789	50	40			10		2.5	Qtz 15 Py. 25	G 30 S 30	GS 30	8789	12	9.6	84			
185	190	8790	50	30			20	T	2.2	Qtz 15 Py. 20	G 30 S 25	GS 35	8790	10	9.6	82			
190	195	8791	40	20			40		5.9	Qtz 10 Py. 15	G 35 S 15	GS 40	8791	17	9.9	83			
195	200	8792	40	10			50		4.6	Qtz 15 Py. 25	G 25 S 25	GS 35	8792	15	9.6	82			
200	205	8793	40	20			40		2.9	Qtz 15 Py. 30	G 25 S 25	GS 30	8793	13	12	85			
205	210	8794	65	10			5	T	6.5	Qtz 15 Py. 45	G 30 S 25	GS 10	8794	16	9.5	82			