

A REPORT

ON

A GRAVITY SURVEY

Rose Lake Area, Watson Lake M.D.

Yukon Territory



FOR

ANVIL MINING CORPORATION LIMITED

Faro, Yukon Territory

This report has been examined by the Geological Evaluation Unit and is recommended to the Commissioner to be considered as representation work in the amount of \$ 13,177.00

J.B. Craig
Resident Geologist or

~~Resident Mining Engineer~~

Considered as representation work under Section 53 (4) Yukon Quartz Mining Act.

BY

[Signature]
Commissioner of Yukon Territory

PETER E. WALCOTT & ASSOCIATES LIMITED

Vancouver, British Columbia

MARCH 1974

INTRODUCTION

Between August 29th and September 16th, 1973, Peter E. Walcott & Associates Limited carried out a gravity survey over part of a property, located near Rose Lake, Yukon Territory, held by Anvil Mining Corporation Limited.

The survey was carried out over a "compass and chain" grid on lines 400 feet apart.

Measurements of relative gravity were made every 200 feet along the lines using a CG-2 gravity meter. In addition elevations at each of the gravity stations were obtained using a Wild T-1A theodolite and rod.

The data was then processed and presented in profile and contour form on Maps W-169-1 to 4 that accompany this report.

PROPERTY, LOCATION & ACCESS

The property, consisting of the MM claims is located in the Watson Lake Mining District of the Yukon Territory.

The claims are situated around the 5000 foot level on the west side of Seagull Creek some 18 miles south of the settlement of Ross River.

Access is obtained by helicopter from the Canol Road.

PURPOSE

The purpose of the survey was to try and locate the presence of any mineralized deposits by the gravimetric method, possible occurrences of which having been suggested by mineralized outcroppings on the property.

GEOLOGY

The reader is referred to a report by the staff of Anvil Mining Corporation Limited.

PREVIOUS WORK

Previous work on the property consisted of geological mapping and prospecting, geochemical surveying and magnetic surveying carried out by the staff of Anvil Mining Corporation Limited during the 1973 field season.

SURVEY SPECIFICATIONS

The gravity survey was carried out using a Scintrex CG-2 gravity meter, which measures variations in the earth's gravitational field to an accuracy of ± 0.01 milligals.

7 Base stations were established at suitable locations within the area to be surveyed. The closure on these was 0.015 milligals.

Values of observed gravity were then obtained every 200 feet along the lines. Corrections for meter drift were made by tying-in to these previously established base stations at intervals not exceeding 2 to 3 hours. Drifts of over 0.10 milligals per hour were not allowable.

Elevations of the gravity stations were determined by rod and transit (Wild T-1A theodolite) using the stadia method. Errors in the tying-in of loops were kept to a minimal, this being dependent on the severity of the topography but was less than 0.5 feet per loop.

The density to be used in applying corrections for differences in elevation was determined by calculating the Bouguer gravity for a line using various densities and determining the gravity profile and subsequently the density least reflecting the topography. A density of 2.55 gm/cc was then used in the computation.

Corrections were then applied to the observed gravity values for differences in elevation and latitude. Terrain corrections were calculated from the contoured elevation maps and supplementary field observations using a standard three circle template.

The final Bouguer gravity values were then plotted and contoured.

DISCUSSION OF RESULTS

The contoured Bouguer gravity (Map W-169-4) exhibited numerous highs and lows as was expected due to the severity of the topography and underlying rocks of different specific gravity, as evidenced by the large low occurring around the edge of the cliff.

Three reasonably strong Bouguer highs - Anomalies A, B & C respectively on Map W-169-4 - appeared to be roughly coincident with magnetic and geochemical anomalies and were considered worthy of further investigation, as it was thought that they could be indicative of sulphide occurrences.

Since then two of them - Anomalies A and C - have been investigated by borehole technique with positive results i.e. sulphides were encountered in the holes.

SUMMARY, CONCLUSIONS AND RECOMMENDATIONS

Between August 29th and September 16th, 1973, Peter E. Walcott & Associates Limited carried out a gravity survey over part of a property held by Anvil Mining Corporation Limited.

The property is located near Rose Lake, Yukon Territory.

The survey indicated the presence of three gravity anomalies roughly coincident with previously obtained magnetic and geochemical anomalies.

As a result the writer considered them worthy of further investigation.

He therefore recommended verbally at the time that the results be carefully studied in conjunction with those of previous work in particular with the geology and should they appear encouraging then they should be investigated by borehole techniques. (Since then two of them have been drilled with positive results).

Respectfully submitted,

PETER E. WALCOTT & ASSOCIATES LIMITED

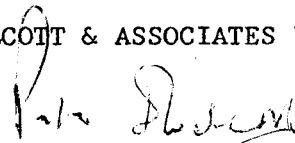

Peter E. Walcott, P.Eng.
Geophysicist

Vancouver, B.C.
March 1974

ROSE LAKE FIELD CREW

Gary MacMillan	Geophysical Operator	Peter E. Walcott & Associates Ltd.
Leo Perreault	Geophysical Operator	605 Rutland Court
Phil Borsos	Helper	Coquitlam, B.C.
Jim Makichuk	Helper	

A P P E N D I X

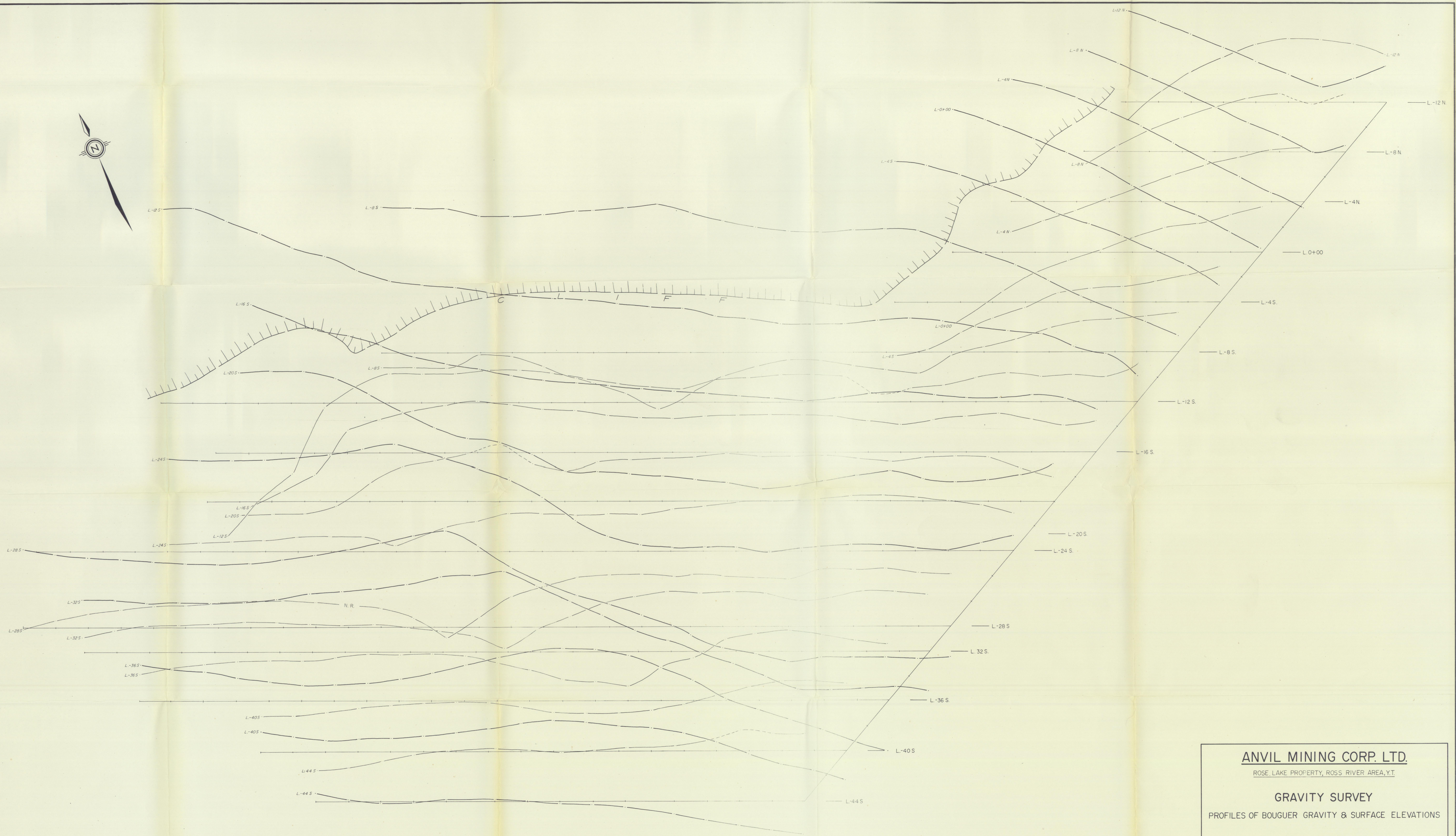
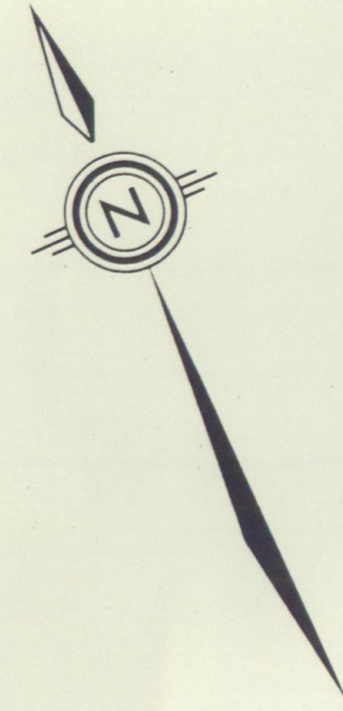

ANVIL MINING CORP. LTD.
ROSE LAKE PROPERTY, ROSS RIVER AREA, Y.T.

GRAVITY SURVEY
PROFILES OF BOUGUER GRAVITY & SURFACE ELEVATIONS

SCALE: 1 INCH = 200 FEET

MAP NO. W-169-1
TO ACCOMPANY A REPORT BY
PETER E. WALCOTT P. Eng., DATED MARCH-74

PETER E. WALCOTT & ASSOC. LTD.
ALTAIR drafting

Peter Walcott

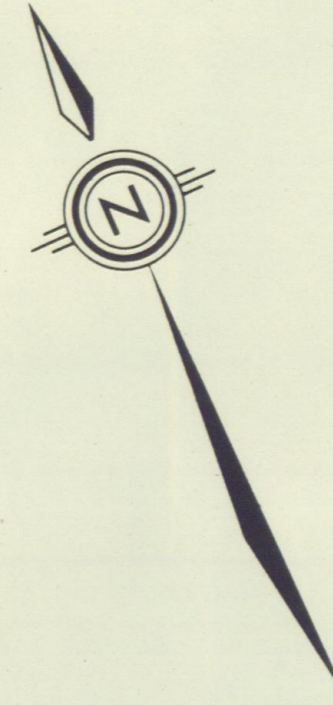

ANVIL MINING CORP. LTD.

ROSE LAKE PROPERTY, ROSS RIVER AREA, Y.T.

GRAVITY SURVEY
PROFILES OF BOUGUER GRAVITY
(INNER CIRCLE CORRECTED)

SCALE: 1 INCH = 200 FEET

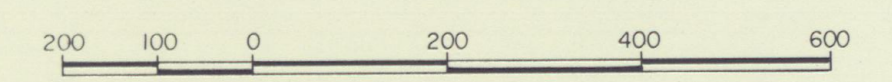

MAP NO. W-169-2
TO ACCOMPANY A REPORT BY
PETER E. WALCOTT P. Eng., DATED MARCH-74

PETER E. WALCOTT & ASSOC. LTD.

P. E. Walcott

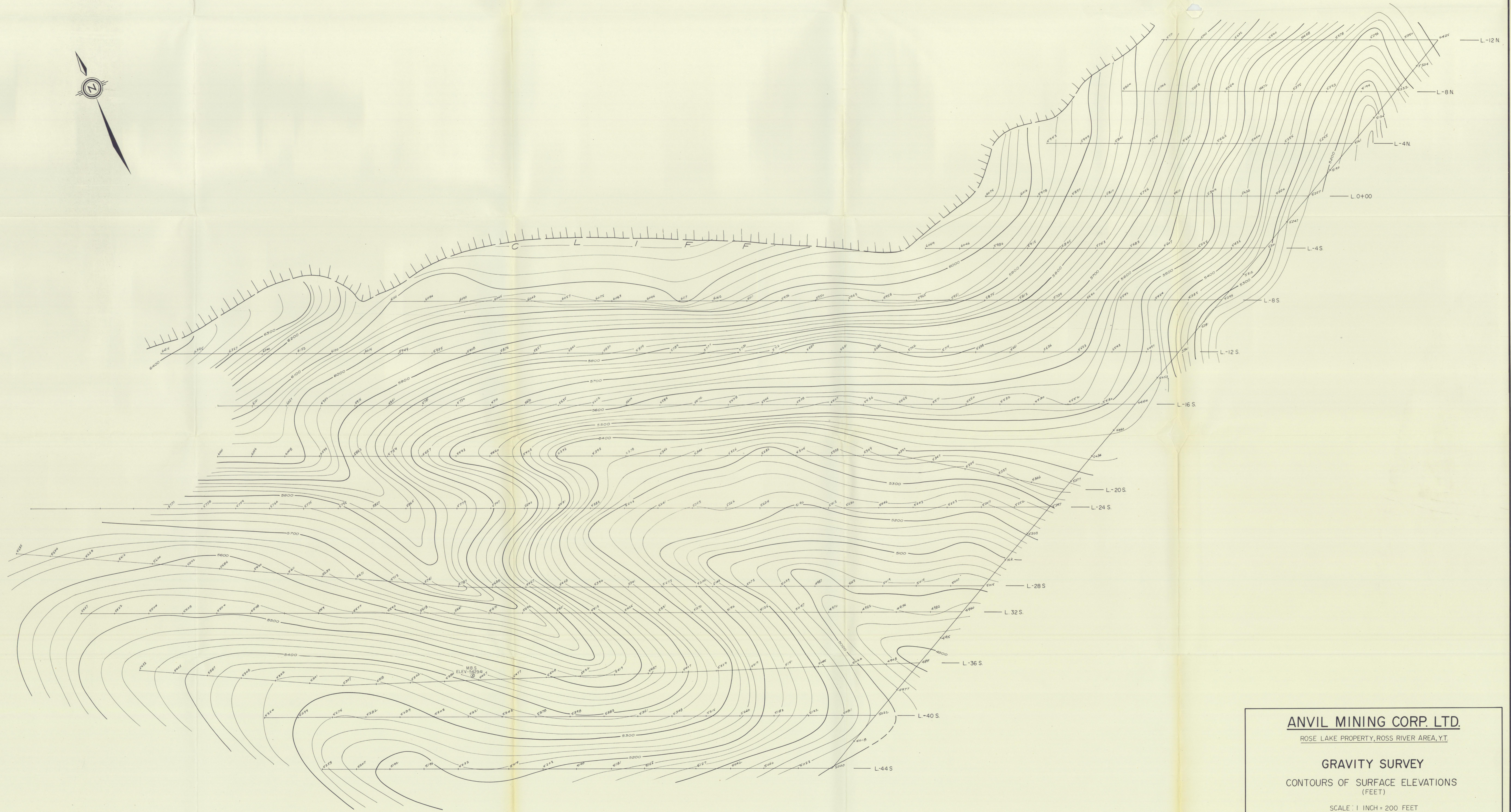
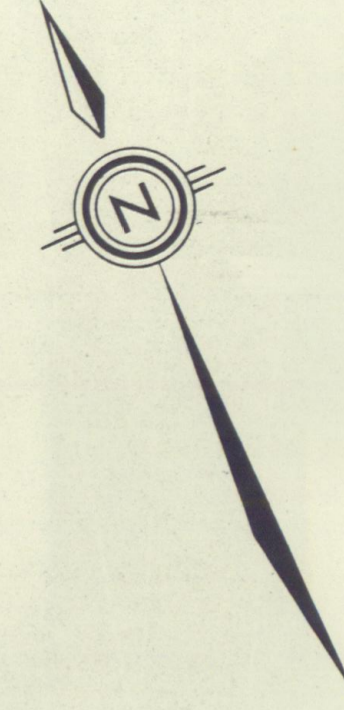

ANVIL MINING CORP. LTD.
ROSE LAKE PROPERTY, ROSS RIVER AREA, Y.T.

GRAVITY SURVEY
CONTOURS OF SURFACE ELEVATIONS
(FEET)

SCALE: 1 INCH = 200 FEET

MAP NO. W-169-3
TO ACCOMPANY A REPORT BY
PETER E. WALCOTT P. Eng., DATED MARCH-74

PETER E. WALCOTT & ASSOC. LTD.

P. E. Walcott

ALTAIR drafting

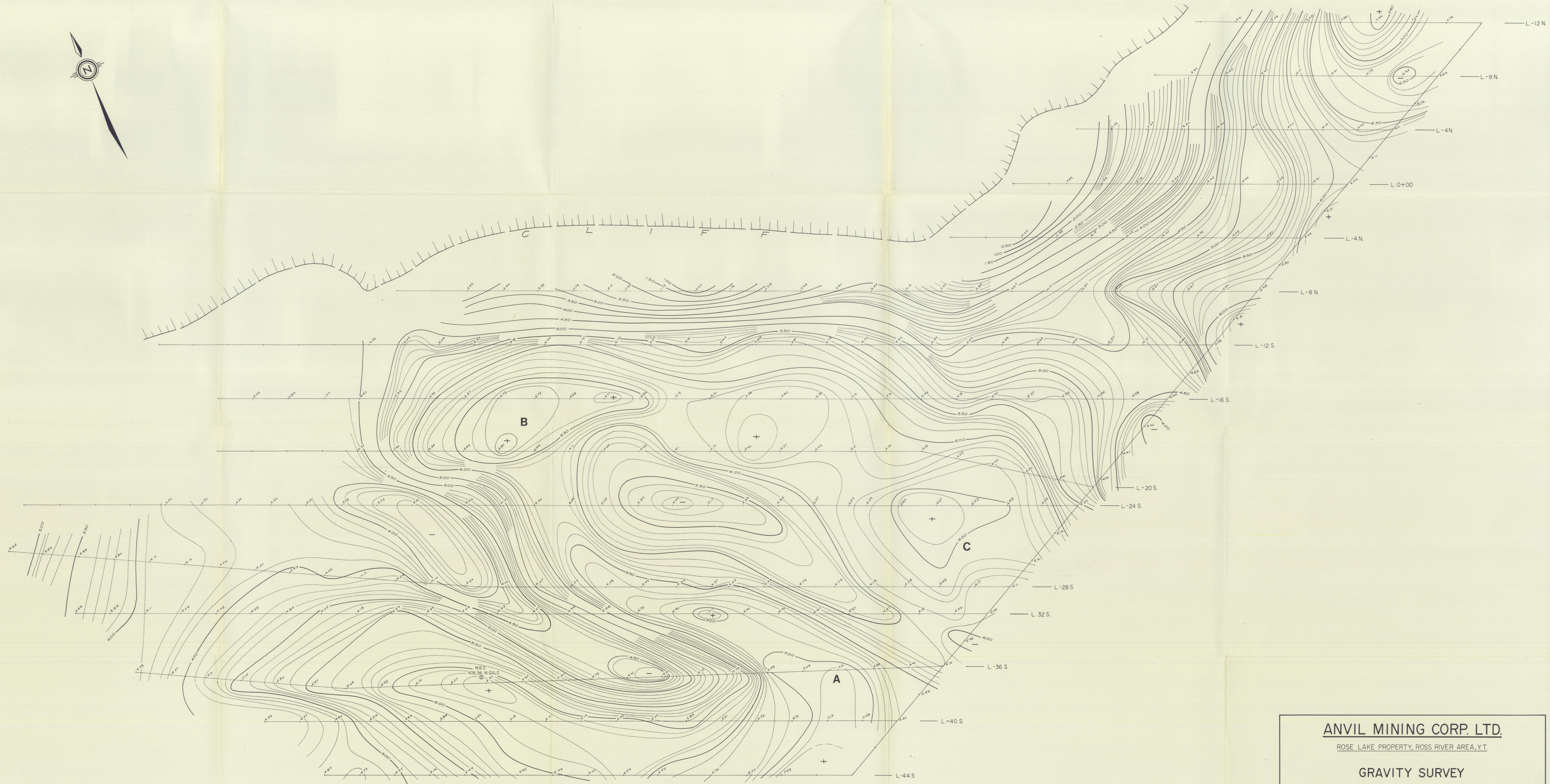
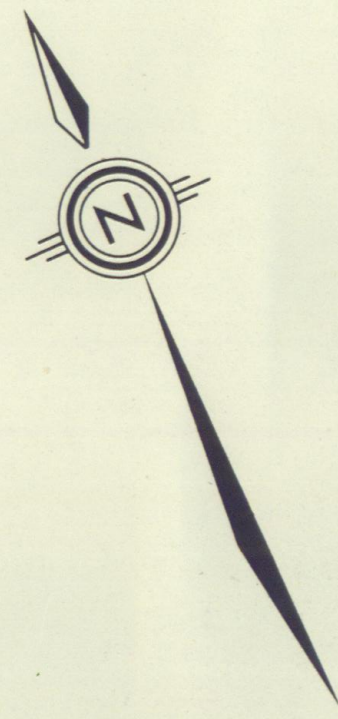

N.B. 40000 MILLIGALS TO BE ADDED TO ALL READINGS.

ANVIL MINING CORP. LTD.
ROSE LAKE PROPERTY, ROSS RIVER AREA, Y.T.

GRAVITY SURVEY
CONTOURS OF BOUGUER GRAVITY
(MILLI-GALS)

SCALE: 1 INCH = 200 FEET

MAP NO. W-169-4
TO ACCOMPANY A REPORT BY
PETER E. WALCOTT P. Eng., DATED MARCH-74

PETER E. WALCOTT & ASSOC. LTD.

P. E. Walcott