

REPORT on the
 GEOLOGICAL SURVEY
 on the
TRY CLAIMS, VANGORDA AREA,
 Whitehorse Mining Division,
 Yukon Territory,

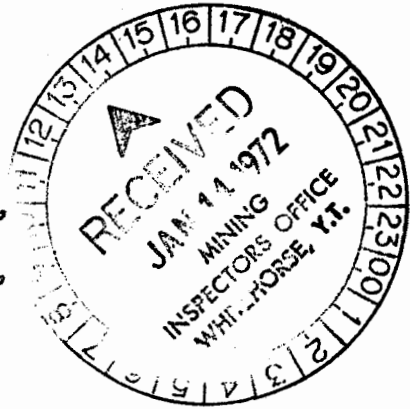

62° N. - 133° W.
 62° 28' 133° 21' *W.M.M.*

for
 SPARTAN EXPLORATIONS LTD.

by

John S. Vincent, P. Eng.

This report has been examined by the Geological Evaluation Unit and is recommended to the Commissioner to be considered as representation work in the amount of
\$6477.61

D.B. Craig
 District Geologist or
 Registered Mining Engineer

Considered as representation work under Section 53 (2) Yukon Quartz Mining Act.

[Signature]
 Commissioner of Yukon Territory

TABLE of CONTENTS

	<u>P A G E NOS.</u>
INTRODUCTION	1
PREVIOUS WORK	1
PROPERTY, LOCATION, and ACCESS	1 & 2
GEOLOGY	2 & 3
GEOCHEMISTRY	3
GEOPHYSICS	3 & 4
CONCLUSIONS and RECOMMENDATIONS	4

LIST of ILLUSTRATIONS

	<u>FIGURE NOS.</u>
Property Sketch Map and Grid Location	6
Geology	13

INTRODUCTION

The Try 1 - 96 claims were staked in June of 1971, to cover an area opposite the Faro ore body and underlain by a favourable stratigraphic section of meta-sediments. Claims 1 - 8 were not recorded as it was discovered at a later date that the ground was held by another group. A substantial Turair survey was planned by Seigel and Associates Ltd. along the southwest flank of the Anvil Range, and it was intended to include the area underlain by the Try claims in the latter stage of the survey. However, as logistical problems developed the survey was terminated, and the property had to be evaluated by ground techniques.

Later in the field season geological mapping and an induced polarization survey was carried out over a grid located as shown in Figure 6. This area was chosen because there is more outcrop, and a maximum amount of geological information could be obtained.

PREVIOUS WORK

Although previous work has been done, the information is not available from Government assessment files because the MX 1 - 8 claims are still in good standing.

PROPERTY, LOCATION, AND ACCESS

The property consists of 88 contiguous mineral claims in the Whitehorse Mining Division, and are located on Claim Sheet 105K-6 at approximately 133° W. by 62° N. The claims lie along the upper limits of Anvil Creek, and

are accessible by helicopter from the Anvil air strip, 7 miles to the southwest, or by tractor road across country. The elevation on the property is 4,000 feet.

The claim names, record numbers, and expiry date are as follows, and the configuration of the block is shown on Figure 6.

Try 9 - 96 inclusive, Grant Numbers Y60953 - Y61040 inclusive,
Expiry date: July 6, 1972.

G E O L O G Y

As previously explained, the property was located to cover an area underlain by a stratigraphic assemblage of meta-sedimentary rocks as established by D. Templeman-Kluit of the Geological Survey of Canada. The sequence is very similar to, and appears to be the same time-rock units as host the Faro and Vangorda deposits on the southwest flank of the range.

The most prominent stratigraphic unit underlying the grid in Figure 13 is a bluish sericitic quartz phyllite which strikes northwesterly and dips at 20° to 35° to the northeast. Occasional graphitic zones are noted, and minor disseminated pyrite and pyrrhotite was reported from outcrops in the lower section and south of the creek.

The phyllitic schists are underlain by biotite-muscovite schists, but bedrock exposure is limited south of the creek, and the contact was not found. Further up-hill to the north large outcrops of andesitic flows with tuffaceous zones are mapped overlying the phyllites.

No significant structural features were recorded, and this portion of the area does not appear to be structurally complex.

No significant faulting was recorded, although the off-set between the phyllites and volcanics in the area of lines 32 E. and 40 E. looks suspicious. A major north easterly - trending fault may occur to the northwest along the other arm of Anvil Creek, but the mapping was not carried that far.

GEOCHEMISTRY

A soil survey was not undertaken because it was concluded that soil development was insufficient to produce reliable results. The field season had also progressed to the point where it was decided the remaining time could be more profitably spent on geological mapping.

GEOPHYSICS

An induced polarization survey was conducted over all the lines shown on Figure 13, and lines 0 and 16 E. were extended to the north where the phyllites outcrop further up the hill.

For a detailed presentation of the survey and results the reader is referred to the report by McPhar Geophysics Ltd.

Anomalies were located on all lines, and McPhar has distinguished 3 zones. The sources are regarded as broad and strong, and defined as either graphite and/or massive sulphides. Since both disseminated sulphides and graphite were noted, it is reasonable to conclude that the source of the I.P.

TABLE OF GEOLOGIC FORMATIONS

AGE	PROBABLE THICKNESS		
TERTIARY	14b	14b - FINELY LAMINATED, LIGHT GREY, RHYOLITIC TUFF. (913)	
	14a	14a - APHANITIC, LIGHT GREENISH TO REDDISH QUARTZ FELDSPAR PORPHYRY. (926)	
CRETACEOUS TO TERTIARY	13	13 - SAUSSURITIZED PORPHYRITIC HORNBLENDE DIORITE. (942)	
	INTRUSIVE		
	12	12 - WEATHERING RUSTY BROWN, MEDIUM GRAINED, DARK GREEN-GREY, EQUIGRANDULAR ALTERED PYROXENITE AND HORNBLENDE DIORITE. (928)	
	INTRUSIVE		
CRETACEOUS	11	11 - ANVIL BATHOLITH MEDIUM GREY, EQUIGRANDULAR BUT LOCALLY PORPHYRITIC AND FOLIATED, HYPIDIOMORPHIC, MEDIUM GRAINED QUARTZ MONZONITE BUT RANGES FROM BIOTITE QUARTZ MONZONITE TO BIOTITE GRANODIORITE. (929)	
TRIASSIC	300'	10a - THIN BEDDED, PLATY, MEDIUM GREY CALCAREOUS SLATE, WITH LOCALLY INTERBEDDED FINE GRAINED ARGILLACEOUS LIMESTONE.	
TRIASSIC	2000'	10 - BROWN WEATHERING CONGLOMERATE WITH QUARTZITE, SCHIST GRANITE GNEISS, BASALT, CHERT AND LIMESTONE PEBBLES. (944)	
U. PERMIAN TO TRIASSIC	9	9 - DARK GREEN TO BLACK SERPENTINITE AND RELATED PERIDOTITE. (907)	
	8c	8c - ANVIL RANGE GROUP ORIGINALLY LIGHT GREY CRINOIDAL OR BIOCLASTIC LIMESTONE, NOW RECRYSTALLIZED. WEATHERS BUFF, CONTAINS MINOR QUARTZ, ESSENTIALLY A SPARITE. (906)	
PERMIAN	1500'	8b - MEDIUM TO DARK GREEN, MASSIVE, BASALTIC VARIETIES INCLUDING TUFFS, MASSIVE AMYGDALOIDAL FLOWS, PILLOWS AND PYROCLASTIC TYPES. (908)	
L. PERMIAN	2000'	8a - PALE GREEN, GREENISH BROWN, LIGHT GREY MASSIVE TO THIN BEDDED ARGILLACEOUS AND TUFFACEOUS CHERT, WEATHERS OFF-WHITE. LOCALLY BRICK RED DUE TO HEMATITE (JASPER), LOCALLY BRECCIATED. (925)	
U. DEVONIAN TO MISSISSIPPIAN	7	7 - DARK GREY TO BLACK, MASSIVE TO THICK BEDDED, GRAPHITIC CHERT, ASSOCIATED DARK GREY GRAPHITIC CHERTY ARGILLITE AND ARGILLACEOUS SILTSTONE, MINOR ARGILLACEOUS LIMESTONE, GREY WACKE AND CHERT PEBBLE CONGLOMERATE. (918)	
M. DEVONIAN	100'	6 - THIN BEDDED, PLATY, BLACK, CARBONACEOUS FETID CRINOIDAL LIMESTONE TO MASSIVE BUFF WEATHERING GREY BIOCLASTIC DOLOMITE. (905)	
SIL. DEVONIAN	50'	5 - MASSIVE MED. TO LIGHT GREY, MED-COARSE GRAINED ORTHOQUARTZITE. (927)	
ORDOVICIAN SILURIAN	400'	4 - GRAPTOLITIC BLACK CARBONACEOUS SLATE, BLACK SILTY SHALE, ARGILLITE, MINOR BLACK CHERT BANDS, MINOR PYRITE. (949)	
	3d	3d - "GREENSTONE" - DARK TO PALE GREEN POLIATED TO MASSIVE AMPHIBOLITE, CHLORITIC TUFF, AND ANDESITE. (911)	
	3c	3c - THINLY LAMINATED SILTY LIMESTONE, ALTERNATING LAMINAE OF PHYLLITE AND SILTY FINE GRAINED GREY LIMESTONE. (941)	
MIDDLE UPPER CAMBRIAN?	4000+	3b - SILVERY GREY WEATHERING, GREY TO BLACK FOLIATED SERICITE CHLORITE, BIOTITE, GRAPHITE PHYLLITE. CAN CONTAIN LARGE GREENSTONE LENSES. (934)	
	3a	3a - LIGHT TO DARK GREY, BLACK QUARTZ SERICITE, BIOTITE, CHLORITE, PHYLLITE. ALSO INCLUDES QUARTZ GRAPHITE PHYLLITE (3ag) AND QUARTZITE (3aq). GENERALLY CONTAINS SMALL GREENSTONE LENSES. (931)	
	2e	2e - DARK GREEN MASSIVE AMPHIBOLITE OCCURRING AS LENSES THROUGHOUT UNIT 2. (921)	
	2d	2d - TAN WEATHERING MEDIUM GRAINED QUARTZ BIOTITE SERICITE (MUSCOVITE) SCHIST WITH ANDALUSITE, GARNETS, AND STAUROLITE. (941)	
LOWER CAMBRIAN?	2000+	2c - MASSIVE WHITE TO CREAMY CRYSTALLINE LIMESTONE TO MARBLE. (903)	
	2b	2b - WHITEISH WEATHERING, BANDED PALE TO DARK GREEN, PURPLISH BROWN BANDED CALC-SILICATES WITH PHYLLITIC AND SCHISTOSE PARTINGS. (918)	
	2a	2a - BROWN WEATHERING, MEDIUM TO COARSE GRAINED QUARTZ BIOTITE SCHIST WITH MINOR MUSCOVITE ANDALUSITE, GARNET, AND STAUROLITE PORPHYROBLASTS COMMON. (947)	
PROTEROZOIC	1	1 - "GRID UNIT" GREY WEATHERING, MEDIUM-DARK GREY, MUSCOVITE METAQUARTZITE LOCALLY COLOUR BANDED, MINOR CHLORITE, TOURMALINE AND CARBONATE INTERFOLIATED BLACK GRAPHITIC QUARTZITE COMMON. (946)	

response is complex and identification at this stage is not possible.

CONCLUSIONS AND RECOMMENDATIONS

It must be concluded that the source of the I. P. available is complex and probably consists of both sulphides and graphite.

It is recommended that the survey be expanded and more detailed I. P. work done to locate the best locations for evaluation by diamond drilling. A careful magnetometer survey should be carried out, and the grid extended westerly to include the low lying area downstream. Gravity profiles should be considered to try and distinguish between graphite and sulphides.

Respectfully,
JUN 25 1960

John S. Vincent

John S. Vincent, P. Eng.,
JOHN S. VINCENT LIMITED.

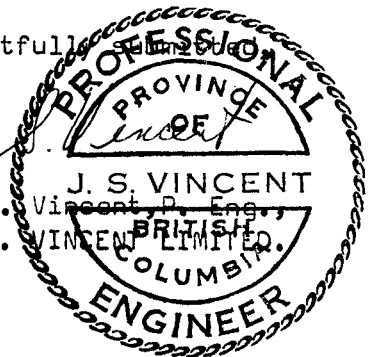

A P P E N D I X I.

SUMMARY OF COSTS

Geological Survey.

Wages, Salaries, Bonuses	\$3,141.61 ✓
Helicopter Support (includes Geophysical)	2,836.00 ✓
Camp Support (includes Geophysical)	500.00 ✓
	<hr/>
	6,477.61
I.P.Survey (refer to McPhar Geophysics Ltd. report)	2,913.22 ✓
	<hr/>
TOTAL:	<u>\$9,390.83</u> ✓

APPENDIX II

AFFIDAVIT

(Supporting Summary of Costs)

I, Dorothy I Hamar, Secretary Treasurer with Spartan Explorations Ltd. (N.P.L.), of Vancouver, British Columbia, do hereby state that to the best of my knowledge and belief the Statement of Costs, as presented in this report covering "Geological and Geophysical Surveys on the TRY Group of Mineral Claims", is both true and correct.

Dated at Vancouver, British Columbia, this 8th day of December, 1971.

SWORN BEFORE ME at Vancouver,)
British Columbia, this ^{8th} day)
of December, 1971.)

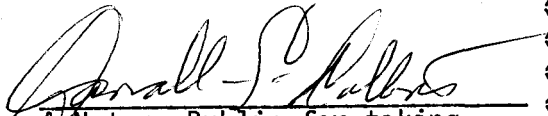
A Notary Public for taking)
Affidavits in British Columbia.)

Dorothy I. Hamar, Sec. Treas.

A P P E N D I X III

PERSONNEL

<u>Name</u>	<u>Position</u>	<u>Address</u>
Gordon E. Cooper	Geologist	Port Coquitlam, B.C.
Dr. G. Herget	Geologist	c/o Preussag AG Metall, West Germany
E. Isaaks	Geology Assistant	Point Roberts, U.S.A.
J. Etzel	Prospector	Ross River, Y.T.
R. Etzel	Prospector	Ross River, Y.T.
S. Cooper	Cook	Port Coquitlam, B.C.



SPARTAN EXPLORATIONS LTD.(N.P.L.)

1035 WEST PENDER STREET · VANCOUVER 1, BRITISH COLUMBIA

TELEPHONE 688-2355

TRY CLAIMS 9 - 96

SUMMARY OF:

Re: Salaries, Wages & Bonuses. (Time Sheets attached)

	<u>Man Days</u>	<u>\$ Amount</u>	<u>\$7.00 day Board Allowance</u>	<u>TOTAL:</u>
Jim Etzel - Prospector	7	140.00	35.00	\$175.00
Ed Isaaks - Geology Assistant	14	373.24	98.00	471.24
Shirley Cooper - Cook	19	475.00	133.00	608.00
Robert Etzel - Prospector	19	380.00	133.00	513.00
Gordon Cooper - Geologist (No time sheets available - consultant)	19	633.27	133.00	766.27
Dr. G. Herget - Geologist (no time sheets available) (consultant)	19	475.00	133.00	608.00
				<u>\$3,141.61</u>

NOTE:

Allowance taken from these two attached expense reports for
Camp Support on TRY Claims

\$500.00

SPARTAN EXPLORATIONS LTD.

NAME Shirley Cooper (N.P.L.) FOR THE MONTH OF Sept. - October 19
 TYPE OF WORK Cook TIME SHEET AREA TR1, MUR CL, MEC CL.
 RATE OF PAY \$1750 per month UIC. NO. TAX EXP.

DATE WORKED	JOB	AREA/CLAIM	PAY CALCULATION	COMPANY	GROSS
1 WED	841	TR1 CL.	1 Mo. @ 1750.00		750.00
2 THU	841	"	3 days @ 241.9		72.57
3 FRI	841	"	Holiday pay		
4 SAT	841	"	4 days @ 331.49		132.60
5 SUN	841	"			
6 MON	841	MUR "	FREE BOARD 33 @ 2.50	FRINGE BENEFITS	82.50
7 TUE	841	"	GROSS PAY	DISTRIBUTABLE PAY	1035.07
8 WED	841	"	DEDUCTIONS		
9 THU	841	"	UIC		30
10 FRI	841	"	CANADA PENSION 17.73		40
11 SAT	841	"	INCOME TAX 237.75		50
12 SUN	841	"	MEDICAL PLAN		60
13 MON	841	"	HOLIDAY PAY		70
14 TUE	841	MEC "	GROUP INS.		
15 WED	841	"	PENSION		
16 THU	841	"	BOARD 82.50		
17 FRI	841	"	ADVANCE		
18 SAT	841	"	COMMISSARY 14.75 (per week)		
19 SUN	841	"	OTHER		
20 MON	841	Loss R.	TOTAL 352.93		
21 TUE	841	"	TOTAL FRINGE BENEFITS		
22 WED	841	"	NET PAY \$ 682.14		20
23 THU	841	"	CHEQUE NO.		
24 FRI	841	"	TOTAL		
25 SAT	841	"			
26 SUN	841	"			
27 MON	823	Loss R. - Non			
28 TUE	823	"			
29 WED	823	"			
30 THU	823	"			
31	823	"			

JOB CLASSIFICATION

01 PRELIMINARY	07 GEOCHEMICAL SURVEYS	13 HAND TRENCHING
02 PROPERTY EXAMINATION	08 GEOPHYSICAL SURVEYS	14 DIAMOND DRILLING
03 PROSPECTING	09 GEOLOGICAL SURVEYS	15 EXPEDITING
04 CLAIM STAKING	10 CLAIM SURVEYS & ASSESS	16 GENERAL SUPERVISION
05 AIRBOURNE SURVEYS	11 ACCESS ROADS	17 EXPLORATION PLANNING
06 LINECUTTING	12 BULLDOZER TRENCHING	

TOTAL 33 days
 REMARKS: No. DEDUCTIONS

KIND	NO.	YR.	MO.	ENTRY	ACCT.	ORG	SUB.	AREA	GROUP	AMOUNT
1-2	3-4	5-6	7-8	11-14	21-23	24-25	26-28	36-37	38-40	71-80
01										
01										
01										
01										
01										
01										
01										
01										
01										
01										
01										
01										

SPARTAN EXPLORATIONS LTD.

NAME SHIRLEY COOPER
 TYPE OF WORK COOK
 RATE OF PAY \$750 PER MONTH

(N.P.L.) FOR THE MONTH OF AUG. 19 91
 AREA BLIND CR. - MUR CI. - TRY CI.
 UIC. NO. 102-216-678 TAX EXP. \$1000

DA	WORKED	JOB	AREA/CLAIM	PAY CALCULATION	COMPANY	GROSS
1	SUN	841	BLIND CR			
2	MON	841	" "	1 Mo. @ 750 ⁰⁰		\$ 750.00
3	TUE	841	" "			\$
4	WED	841	" "			\$
5	THU	841	" "			\$
6	FRI	841	" "	FREE BOARD 310.2 ⁵⁰		\$ 77.50
7	SAT	841	MUR CI.	GROSS PAY		827.50
8	SUN	841	" "	DEDUCTIONS		
9	MON	841	" "	UIC		30
10	TUE	841	" "	CANADA PENSION 14.00		40
11	WED	841	" "	INCOME TAX 1773.90 - 14.00		50
12	THU	841	" "	MEDICAL PLAN		60
13	FRI	841	" "	HOLIDAY PAY		70
14	SAT	841	" "	GROUP INS.		
15	SUN	841	" "	PENSION		
16	MON	841	" "	BOARD 77.50		
17	TUE	841	" "	ADVANCE		
18	WED	841	TRY CI.	COMMISSARY		
19	THU	841	" "	OTHER 265.10		
20	FRI	841	" "	TOTAL		
22	SAT	841	" "	TOTAL FRINGE BENEFITS		\$ 522.10
23	SUN	841	" "	NET PAY		\$ 20
24	MON	841	" "	CHEQUE NO. 84		TOTAL \$

- JOB CLASSIFICATION**
- 01 PRELIMINARY
 - 02 PROPERTY EXAMINATION
 - 03 PROSPECTING
 - 04 CLAIM STAKING
 - 05 AIRBOURNE SURVEYS
 - 06 LINECUTTING
 - 07 GEOCHEMICAL SURVEYS
 - 08 GEOPHYSICAL SURVEYS
 - 09 GEOLOGICAL SURVEYS
 - 10 CLAIM SURVEYS & ASSESS
 - 11 ACCESS ROADS
 - 12 BULLDOZER TRENCHING
 - 13 HAND TRENCHING
 - 14 DIAMOND DRILLING
 - 15 EXPEDITING
 - 16 GENERAL SUPERVISION
 - 17 EXPLORATION PLANNING

KIND	NO.	YR.	MO.	ENTRY	ACCT.	ORG	SUB.	AREA	GROUP	AMOUNT
1-2	3-4	5-6	7-8	11-14	21-23	24-25	26-28	36-37	38-40	71-80
01										
01										
01										
01										
01										
01										
01										
01										
01										
01										
01										
01										
01										
01										

NOTE:

REMARKS:

SPARTAN EXPLORATIONS LTD.

NAME Robert ETZEL (N.P.L.) FOR THE MONTH OF Aug. 19 91
 TYPE OF WORK GEOLOGY ASSISTANT TIME SHEET AREA BLIND CREEK - MUR CL - TRY CL.
 RATE OF PAY \$600 per month UIC. NO. 705-903-995 TAX EXP. 1100

DATE WORKED	JOB	AREA/CLAIM	PAY CALCULATION	COMPANY	GROSS
1 SUN					
2 MON	817	BLIND CR	1 Mo @ 600 ⁰⁰ Mo \$ 600.00		\$
3 TUE	809	" "	@		\$
4 WED	809	" "	@		\$
5 THU	809	" "	FREE BOARD 310 ²⁵⁰ \$ 77.50	FRINGE BENEFITS	\$
6 FRI	817	" "	GROSS PAY 677.50	DISTRIBUTABLE PAY	\$
7 SAT	841	MUR CL.	DEDUCTIONS		
8 SUN	841	" "	UIC 8.60		30
9 MON	807-803	" "	CANADA PENSION 11.30		40
10 TUE	807-803	" "	INCOME TAX 65.25		50
11 WED	807-803	" "	MEDICAL PLAN		60
12 THU	807-803	" "	HOLIDAY PAY		70
13 FRI	809	" "	GROUP INS.		
14 SAT	809	" "	PENSION		
15 SUN			BOARD 77.50		
16 MON	809	" "	ADVANCE		
17 TUE	817	" "	COMMISSARY		
18 WED	841	TRY CL.	OTHER		
19 THU	841	" "			
20 FRI	803-809	" "	TOTAL 160.65		
21 SAT	803-809	" "	TOTAL FRINGE BENEFITS		
22 SUN			NET PAY \$ 516.85		20
23 MON	803-809	" "	CHEQUE NO. 86	TOTAL	\$
24 TUE	803-809	" "			
25 WED	803-809	" "			
26 THU	803-809	" "			
27 FRI	803-809	" "			
28 SAT	803-809	" "			
29 SUN					
30 MON	803-809	" "			
31 TUE	803-809	" "			

- JOB CLASSIFICATION**
- 01 PRELIMINARY
 - 02 PROPERTY EXAMINATION
 - 03 PROSPECTING
 - 04 CLAIM STAKING
 - 05 AIRBOURNE SURVEYS
 - 06 LINECUTTING
 - 07 GEOCHEMICAL SURVEYS
 - 08 GEOPHYSICAL SURVEYS
 - 09 GEOLOGICAL SURVEYS
 - 10 CLAIM SURVEYS & ASSESS
 - 11 ACCESS ROADS
 - 12 BULLDOZER TRENCHING
 - 13 HAND TRENCHING
 - 14 DIAMOND DRILLING
 - 15 EXPEDITING
 - 16 GENERAL SUPERVISION
 - 17 EXPLORATION PLANNING

KIND	NO.	YR.	MO.	ENTRY	ACCT.	ORG	SUB.	AREA	GROUP	AMOUNT
1-2	3-4	5-6	7-8	11-14	21-23	24-25	26-28	36-37	38-40	71-80
01										
01										
01										
01										
01										
01										
01										
01										
01										
01										
01										
01										
01										

REMARKS:

TRAVEL and EXPENSE REPORT

MONTH	DATE	PLACE	MEALS Personal Only	ROOMS Attach Receipts	Entertain- ment	TRANSPORTATION		OTHER		(PROJECT/PROPERTY CHARGE)
						Ticket Fares (Attach Stubs)	Garage Auto Taxi	Telephone Telegraph	Incidentals (Tips, etc.)	
	1									
	2									
	3									
	4									
	5									
	6									
	7									
	8									
	9									
	10									
	11									
	12									
	13									
	14									
	15									
	16									
	17									
	18									
Aug	20	Ross R. - Whitehorse	9.20	10.00			7.50			8.23 - PRUSSIA
	21	Whitehorse - U.N.	6.69			83.00	25.00			"
	22									
	23									
	24									
	25	U.N. - Whitehorse	10.82	14.00			6.00			
	26	Whitehorse - Ross R.	10.60				12.00			
	27									
	28									
	29									
	30									
	31									
Travel Expenses Totals			37.31	24.00		83.00	40.50			Sub Total \$ 184.81

Add: Expenditures other than Travel forward from Reverse Side \$ 134.60

Deduct: Value of unused fares (attach tickets) \$ -

Total Expenditures this Report \$ 153.81

Accounting for Cash Funds	
Cash Advances Received	1691.60
Tickets purchased by Company	83.00
Total to account for	1774.60
Total Expenses as above	1531.04
Balance On hand returned herewith (owing for payment)	243.56

Robert E. Cooper
Signature

OBJECT _____
OF _____
TRIP _____

Approved
RECEIVED
SEP 10 1971

INSTRUCTIONS

1. List all travelling expenses on the front of this form. This will include tickets purchased by the company for your trip.
2. List all other expenditures you have made on behalf of the company on the section on the back of this form.
3. All expenses should be paid from your advance. No expenses should be charged direct to the company.
4. Return all unused tickets with this report and attach all possible receipts for payments you have made.

July	17	Gas, Ross River Motors	Supplies & Misc. Equip.	\$22	6	6
Aug.	6	Propane Gas, Ross River Motors	" " " "	\$22	14	4
"	17	Groceries, Ed's Dept. Store	Camp Support	\$41	179	7
"	17	" , Hergen's	" " -	\$41	15	5
"	17	" , "	" " -	\$41	8	4
"	20	Gas, Ross River Motors	Supplies & Misc. Equip.	\$22	10	2
"	20	Groceries, Yukon H. F. Centre	Camp Support	\$41	14	2
"	24	" , Hancock H. F. Stl.	" " "	\$41	25	3
"	25	Water Containers, etc, Nelson's Ltd	Supplies & Misc. Equip.	\$22	2	1
"	26	Groceries, Taylor & Dwyer Food Fair	Camp Support	\$41	15	0
"	26	" , Yukon H. F. Centre	" " "	\$41	5	0
"	26	Gas, Husky Transit Stl.	Supplies & Misc. Equip.	\$22	6	6
"	26	Groceries, Hergen's	Camp Support	\$41	3	4
"	26	Meals for G. Cooper & 2 I.P. Crew, L.R.	" " "	\$41	9	7
"	26	Groceries, Hergen's	" " -	\$41	12	5
"	26	Gas, Ross River Motors	Supplies & Misc. Equip.	\$22	19	7
"	27	Meals for G. Cooper & 2 I.P. Crew, L.R.	Camp Support	\$41	8	2
"	27	Oil, Ross River Motors	Supplies & Misc. Equip.	\$22	2	5
"	27	Groceries, Hergen's	Camp Support -	\$41	20	9
"	27	Hardware, "	Supplies & Misc. Equip.	\$22	10	9
"	27	Gas, Husky Transit Stl.	" " "	\$22	5	2
"	27	Groceries, Ed's Dept. Store	Camp Support	\$41	36	7
"	27	Berts, Payroll Red. S. Cooper	Wages, Salaries	\$18	14	9
"	27	Groceries, Ed's Dept. Store	Camp Support	\$41	172	3
"	27	Payroll Advance, Ed. check	Wages, Salaries	\$18	200	00
"	27	Travel Allowance, " "	Travel & Accoun.	\$23	100	00
"	29	Stoves, pipes, etc, Ed's Dept. Store	Supplies & Misc. Equip.	\$22	35	79
"	29	Alon Kulon, Car Rental	Equipment Rental	\$30	135	00
"	30	Groceries, Ed's Dept. Store	Camp Support	\$41	20	00
"	31	G. E. Cooper, Truck Rental	Equipment Rental	\$30	215	2
			TOTAL		1346	2

DATE	NATURE OF EXPENDITURE (Receipts must be attached)	NAME OF STORE	PROPERTY	AMOUNT	CASH	BALANCE
JUNE 21	ROSS RIVER MOTORS, BATTERY, PAINTS	Supplies - Misc. Equip.		822	42	
JULY 14	" " " " GAS & OIL	" " "		822	23	
" 14	" " " " " "	" " "		822	8	
AUG. 6	ED'S DEPT. STORE, GROCERIES	CAMP SUPPORT		841	221	
" 7	HUNGER'S, GROCERIES	" " "		841	11	
		TOTAL			308	

Poduq

822 - 74.95
841 - 233.45

308.40

Aug. 19	71	C.P. Air - rock samples to Prusny	Geochanical Services	807	44
Sept. 6	71	Ed's Dept. Store - Groceries	Camp Support	841	33
	71	" " " - "	" " " - "	841	296
7	71	Hougen's Std. - "	" " " - "	841	15
7	71	" " " - Batteries	Supplies & Misc. Equip	822	6
14	71	Ross Ruess Motors - Gas, Oil, Repairs	" " " - "	822	19
14	71	Hougen's Std. - Groceries	Camp Support	841	8
14	71	Ed's Dept. Store - "	" " " - "	841	177
19	71	Ross Ruess Motors - Gas & Oil	Supplies & Misc. Equip	822	17
19	71	" " " - " & "	" " " - "	822	5
20	71	Margaret's Store - Groceries	Camp Support	841	2
21	71	Ross Ruess Motors - Gas	Supplies & Misc. Equip	822	8
21	71	" " " - Headlight	" " " - "	822	4
21	71	Ed's Dept. Store - Groceries	Camp Support	841	5
22	71	" " " - "	" " " - "	841	4
	71	" " " - "	" " " - "	841	8
22	71	" " " - Nails, screws & lock	Supplies & Misc. Equip	822	1
22	71	Hougen's - Groceries	Camp Support	841	47
23	71	Ross Ruess Motors - Gas	Supplies & Misc. Equip	822	9
23	71	Hougen's - Groceries	Camp Support	841	13
23	71	Ed's Dept. Store - "	" " " - "	841	18
23	71	Husky Transit - Gas	Supplies & Misc. Equip	822	6
24	71	" " " - "	" " " - "	822	9
24	71	N.W. Bancorp - meal	Camp Support	841	3
24	71	Ed's Dept. Store - Groceries	" " " - "	841	8
24	71	Hougen's - "	" " " - "	841	9
25	71	Ed's Dept. Store - "	" " " - "	841	22
25	71	" " " - "	" " " - "	841	3
26	71	Ross Ruess Motors	Supplies & Misc. Equip	822	5
26	71	Alan Nelson - Truck Rental	Rental of Equipment	830	142
26	71	Londox Coop - "	" " " - "	830	98
28	71	C. Hergel - Travel Allowance	Travel & Accommodations	823	55
		Londox Coop - Truck Rental	Rental of Equipment	830	25

TRAVEL and BUSINESS EXPENSES

MONTH	DATE	PLACE				TRANSPORTATION		OTHER		(PROJECT/PROPERTY CHARGE)
			MEALS Personal Only	ROOMS Attach Receipts	Entertain- ment	Ticket Fares (Attach Stubs)	Garage Auto Taxi	Telephone Telegraph	Incidentals (Tips, etc.)	
L.	1	J. St. John - P. Lugo	14 00	15 75			12 00			823
"	2	P. Lugo - Memphis	20 75	13 13			11 15			"
"	3	Memphis - Vancouver	11 25				9 55			"
	4									
	5									
	6									
	7									
	8									
	9									
	10									
	11									
	12									
	13									
	14									
	15									
	16									
	17									
	18									
	19									
	20									
	21									
	22									
	23									
	24									
	25									
	26									
Siph.	27	Revel - Whitehorse	6 50	24 00			5 25			823
"	28	Whitehorse - Watson S.	24 15	17 00			11 65			"
"	29	Watson S. - J. Nelson	20 55	14 50			21 15			"
"	30	J. Nelson - J. St. John	21 25	13 00			12 75			"
	31									
Travel Expenses Totals			125 15	100 05			91 50			Sub Total \$ 323 00

Add: Expenditures other than Travel forward from Reverse Side - \$15 17

Deduct: Value of unused fares (attach tickets) - \$284 00

Total Expenditures this Report - \$183 00

Less Credit for 4 bottles of 6-12 from Ed. Roy. Stone (no receipt) \$5 00

Gordon E. Cooper (Signature) \$1835.00

Accounting for Cash Funds	
Cash Advances Received	2000 00
Tickets purchased by Company	
Total to account for	2000 00
Total Expenses as above	1835 00
Balance On hand returned herewith (owing for payment)	1164 91

OBJECT *Travel from P. L. to*

OF

TRIP *Van. 2 people - S. Cooper, G. Cooper*

Approved _____

INSTRUCTIONS

1. List all travelling expenses on the front of this form. This will include tickets purchased by the company for your trip.
2. List all other expenditures you have made on behalf of the company on the section on the back of this form.
3. All expenses should be paid from your advance. No expenses should be charged direct to the company.
4. Return all unused tickets with this report and attach all possible receipts for payments you have made.

NOTE: Rec'd. Receipt from Gordon Cooper

Disputed - 22/10/7

BANK OF BRITISH COLUMBIA

NO. 118

PAID
NOV 16 1971

Nov. 8, 1971

PAY TO THE ORDER OF McPHAR GEOPHYSICS LTD. \$ 5747.25

Vancouver Main Office
B.C.

RECEIVED BY SPARTAN EXPLORATIONS LTD. NOV 22 1971

100 DOLLARS



BANK OF BRITISH COLUMBIA

VANCOUVER MAIN OFFICE
999 WEST PENDER STREET
VANCOUVER, B.C.

Inv. #G11632 Less Cr. Nov. 3/71

SPARTAN EXPLORATIONS LTD. (N.P.L.)

[Signature]
Ronald S. Phillips
00000574725

000020016

FORM 18 BANK CHEQUE SUPPLY

BANK OF BRITISH COLUMBIA

NO. 124

PAID
DEC 16 1971

Dec. 1, 1971

PAY TO THE ORDER OF McPHAR GEOPHYSICS LIMITED \$ 340.70

Vancouver Main Office
B.C.

RECEIVED BY SPARTAN EXPLORATIONS LTD. NOV 22 1971

100 DOLLARS



BANK OF BRITISH COLUMBIA

VANCOUVER MAIN OFFICE
999 WEST PENDER STREET
VANCOUVER, B.C.

Inv. G11700

SPARTAN EXPLORATIONS LTD. (N.P.L.)

[Signature]
Ronald S. Phillips
0000034070

000020016

FORM 18 BANK CHEQUE SUPPLY

McPHAR GEOPHYSICS LIMITED

PHONE 449-5551
TORONTO AREA CODE 416

139 BOND AVENUE, DON MILLS, ONTARIO, CANADA

CABLE-MCPHAR
TORONTO

October 22, 1971

Invoice No. G11632

Spartan Explorations Ltd.
Suite 303,
1035 West Pender Street,
Vancouver, B.C.

Attention: Mr. J.S. Vincent

REFERENCE: Ross River, Yukon Territory - IP Survey
Contract No. V1005

Period: August 23rd - September 27th, 1971

<u>Crew - 2 men: K. Drobot & J. Wowchuk</u>			
19 days	Operating	@ \$265.00 per day	\$5,035.00
5½ days	Travel)		
3 days	Bad Weather)	13 days @ \$100.00 per day	1,300.00
4½ days	Preparation)		
3 days	Standby		N.C.
			<u>\$6,335.00</u>

Expenses received to date

Taxi	5.50	
Vehicle Expense	15.65	
Freight and Brokerage	9.65	
Meals and Accommodation	168.55	
Telephone and Telegraph	17.15	
Supplies	3.73	
	<u>220.23</u>	
Plus 10%	22.02	
	<u>242.25</u>	242.25

Extra Labour \$728.25
Plus 20% 145.65
873.90

873.90
\$7,451.15

McPHAR GEOPHYSICS LIMITED

L.M. Braid
L.M. Braid (Mrs.)
Controller

LMB:sb

Paid
518
8/11/71

McPHAR GEOPHYSICS LIMITED

PHONE 442-5551
TORONTO AREA CODE 416

139 BOND AVENUE, DON MILLS, ONTARIO, CANADA

CABLE-McPHAR
TORONTO

November 3, 1971

Invoice No. G11666

Spartan Explorations Ltd.
Suite 303,
1035 West Pender Street,
Vancouver, B.C.

Attention: Mr. J.S. Vincent

REFERENCE: Contract No. V1005 - IP Survey
Ross River, Yukon Territory

Period: September 20th - 24th, 1971

Credit re Vangorda Test - Charged in error.

2 days	Operating	@ \$265.00 per day	\$530.00	
1 day	Preparation)			
1 day	Bad Weather) 3 days	@ \$100.00 per day	\$300.00	
1 day	Travel)			
			<u>\$830.00</u>	\$ 830.00

Extra Labour
Plus 20%

\$728.25

145.65

873.90

873.90

\$1,703.90

Credit

McPHAR GEOPHYSICS LIMITED

E. M. Woods

LMB:sb

for L.M. Braid (Mrs.)
Comptroller.

McPHAR GEOPHYSICS LIMITED

PHONE 449-5551
TORONTO AREA CODE 416

139 BOND AVENUE, DON MILLS, ONTARIO, CANADA

CABLE-McPHAR
TORONTO

November 17, 1971

Invoice No. G11700

Spartan Explorations Ltd.
Suite 303,
1035 West Pender Street,
Vancouver, B.C.

Attention: Mr. J.S. Vincent

REFERENCE: Contract No. V1005 - IP Survey
Ross River, Yukon Territory

Charges received in October 1971

Freight and Brokerage	173.36	
Plus 10%	<u>17.34</u>	
	190.70	190.70

Extra copies of IP report

6 - Mur Group)		
6 - Mag Group) 18 volumes		150.00
6 - Try Group)		

\$340.70

McPHAR GEOPHYSICS LIMITED

L. Braid
L.M. Braid (Mrs.)
Comptroller.

LMB:sb

Paid
124
11/12/71

Trans. March Turbo Oil Ltd

Total Helicopters Hours - u. TRV Claims

August 18 - Ins. # 7986 - 5.8 hrs

19 - 7987 - 1.5 ✓

27 - 8002 - 3.7 ✓

30 - 8007 - 1.6 ✓

September 6 - 8014 - 1.9 ✓

8 - 8017 - ~~4.0~~ ✓

~~14~~ - ~~8017~~ - ~~1.5~~ ✓

18.3 hrs. @ 155⁰⁰ HR. =

~~2.7~~

2836.50

T
N
T



TRANS NORTH TURBO AIR LTD.

BOX 1977 PHONE 668-2177
WHITEHORSE, YUKON



TO:

Spartan Explorations Ltd.
303 - 1035 West Pender Street
Vancouver, B.C.

RECEIVED
OCT 20 1971

Ramona

Date: September 30, 1971 Invoice No. 753-71

TO: Charge you with the charter of Bell 206-A
Jetranger Helicopter CF-MBT
Crew: Armstrong & Lancaster

FLYING: September 25, 1971
Daily Flight Report No. 1026

4.4 hours at \$248.00 per hour \$1,091.20
(Rate when carrier supplies fuel)

PLUS: Excess cost of fuel at Ross River
Charterer assessed with cost of fuel
over \$.60 per gallon

45 gallons at \$.76 per gallon 34.20

PLUS: Prorated crew expenses at Fare
(Cost of 1 man for 1 day)

14.00

INVOICE TOTAL

\$1,139.40

TERMS: One per cent interest per month will be charged
on all invoices not paid within 30 days of date
issued.

3,217.72 +
1,139.40 +
 .00 +
4,357.12

Paid
116
3/11/71

T
N
T



TRANS NORTH TURBO AIR LTD.

BOX 1977. PHONE 668-2177
WHITEHORSE, YUKON

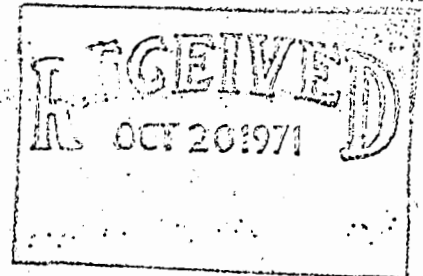

TO:
Spartan Explorations Ltd.
303 - 1035 West Pender Street
Vancouver, B.C.

Date: September 30, 1971 Invoice No. 754-71 *Lawson*

TO: Charge you with the following helicopter charters:
Bell 47G-3B-1 Helicopter CF-UFC
Crew: Vandenbos & Phillips

FLYING: September 6 & 8, 1971
Daily Flight Report No. 8014 & 8017

10.1 hours at \$155.00 per hour \$1,565.50 ✓
(Rate when carrier supplies fuel)

PLUS: Excess cost of fuel at Ross River.
Charterer assessed with cost of fuel over
\$.60 per gallon

182 gallons at \$.54 per gallon 98.28 ✓

PLUS: Prorated crew expenses at Ross River 42.00 ✓
(3/4 cost of 2 men for 2 days)

PLUS: Bell 47G-3B-2 Helicopter CF-QJW
Crew: Vandenbos & Phillips

FLYING: September 15, 20 & 25, 1971
Daily Flight Report Nos. 8681, 8686 & 8692

9.0 hours at \$155.00 per hour 1,395.00 ✓
(Rate when carrier supplies fuel)

PLUS: Excess cost of fuel at following points
Charterer assessed with cost of fuel
over \$.60 per gallon

Ross River
61 gallons at \$.54 per gallon \$32.94 ✓

Faro
100 gallons at \$.56 per gallon \$56.00 ✓ 88.94 ✓

PLUS: Prorated crew expenses at Ross River 28.00 ✓
(Cost of 2 men for 1 day)

INVOICE TOTAL \$3,217.72 ✓

TERMS: One per cent interest per month will be charged
on all invoices not paid within 30 days of date
issued.

NO. 116

Nov. 3, 19 71

BANK OF BRITISH COLUMBIA
PAY TO THE ORDER OF
NOV 15 1971
VANCOUVER MAIN OFFICE
B.C.

TRANS NORTH TURBO AIR LTD.

\$ 4357.12

DOLLARS



BANK OF BRITISH COLUMBIA

VANCOUVER MAIN OFFICE
999 WEST PENDER STREET
VANCOUVER, B.C.

Invs. #753-71 & 754-71

SPARTAN EXPLORATIONS LTD. (N.P.L.)

S. Hamer
General S. Hamer

00020018

FORM 18 BANK CHEQUE SUPPLY

T
N
T



TRANS NORTH TURBO AIR LTD.

BOX 1977 PHONE 668-2177
WHITEHORSE, YUKON



TO:

Spartan Explorations Ltd.
303 - 1035 West Pender Street
Vancouver, B.C.

Date: August 31, 1971 Invoice No. 668-71

P.O. No.

TO: Charge you with the charter of Bell 47G-3B-1
Helicopter CF-UFC
Crew: Vandenberg & Phillips

FLYING: August 7, 18, 19, 27 & 30, 1971
Daily Flight Report No.'s 7975, 7986, 7989,
8002 & 8007

18.4 hours at \$155.00 per hour \$2,852.00 ✓
(rate when carrier supplies fuel)

PLUS: Excess cost of fuel at following points:
Charterer assessed with cost of fuel over
\$.60 per gallon

Ross River
245 gallons at \$.54 per gallon 132.30
Anvil
85 gallons at \$.56 per gallon 47.60

PLUS: Prorated crew expenses at Ross River 80.00
($\frac{1}{2}$ cost of 2 men for 5 days)

INVOICE TOTAL \$3,111.90

TERMS: One percent interest per month will be charged
on all invoices not paid within 30 days of date
issued.

Handwritten: Paid \$1100 30/9/71

NO. 100

BANK OF BRITISH COLUMBIA
LUMEN
OCT 8 1971

Sept. 30, 19 71

PAY TO THE ORDER OF

TRANS NORTH TURBO AIR LTD.

\$ 3111.90

DOLLARS



BANK OF BRITISH COLUMBIA

VANCOUVER MAIN OFFICE
999 WEST PENDER STREET
VANCOUVER, B.C.

Inv. #668-71

SPARTAN EXPLORATIONS LTD. (N.P.L.)

J. Haman
Conrad P. Collins

000200016

FORM 18 BANK CHEQUE SUPPLY

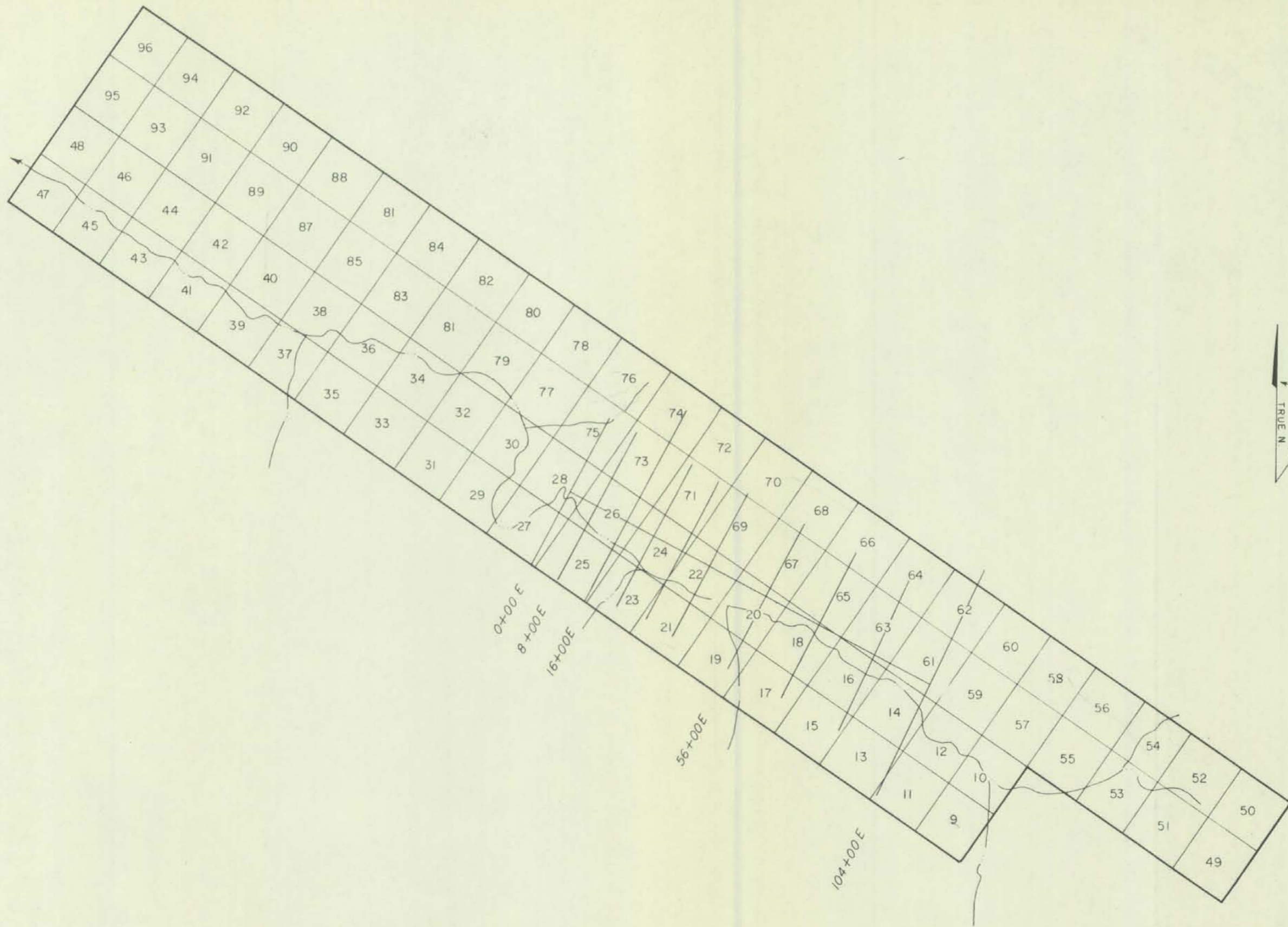
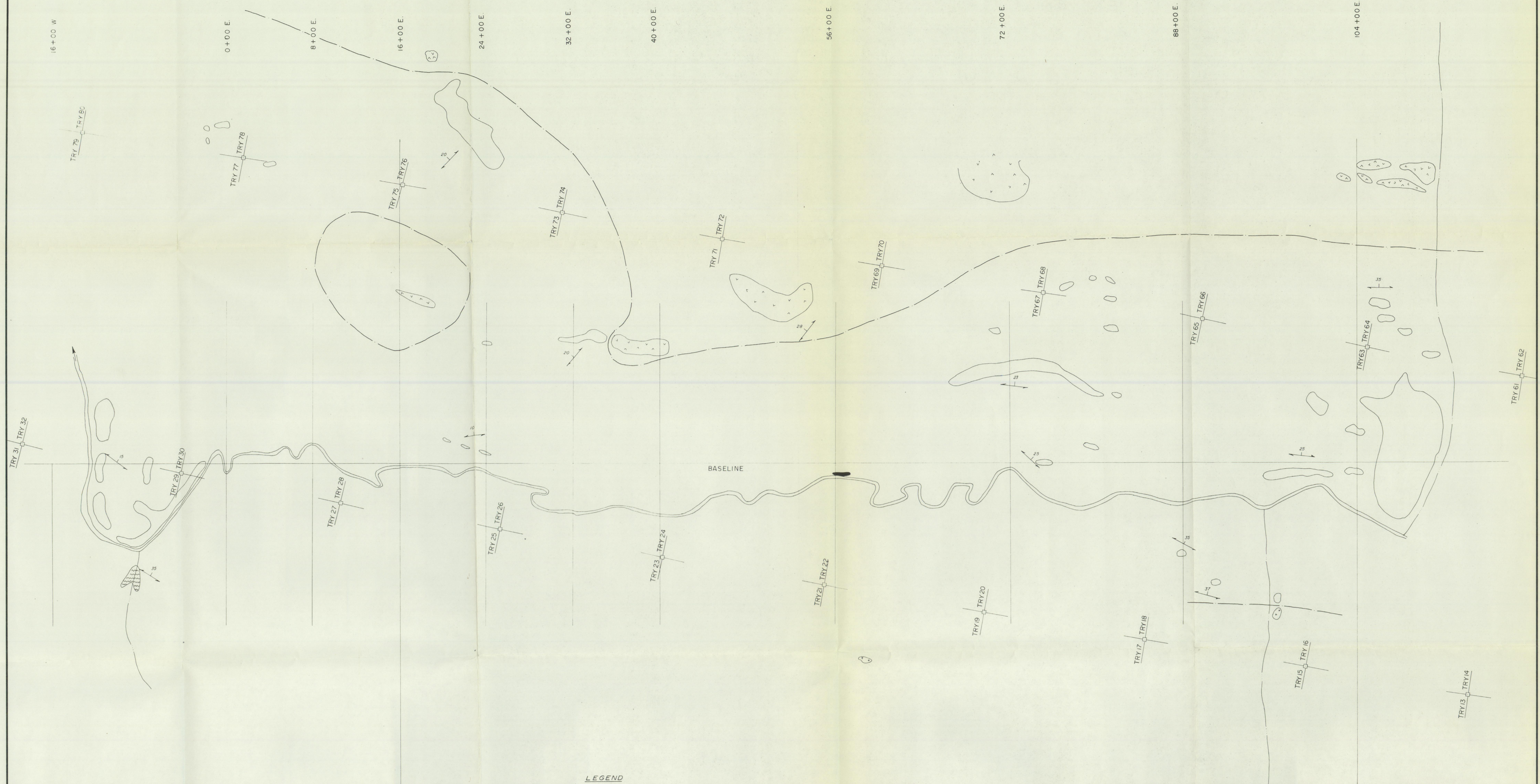
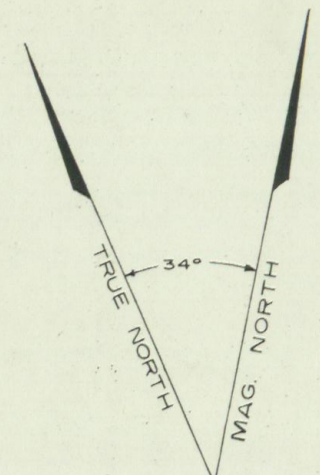

FIG No. 6

SPARTAN EXPLORATIONS LTD (N.P.L.)	
TRY CLAIMS	
PROPERTY SKETCH MAP AND GRID LOCATION	
DRAWN BY:	APPROVED BY:
DATE: OCT. 1971	SCALE: 1 in. = 1/2 mi.



LEGEND

- CRETACEOUS
 - PORPHYRITIC BIOTITE QUARTZ MONZONITE
- PENNSYLVANIAN (?)
 - ▲▲▲▲ ANDESITIC FLOWS AND TUFF
- EOCAMBRIAN - CAMBRIAN
 - BLUE-GREY PHYLITES
 - GRAPHITIC PHYLITES
- PRECAMBRIAN - CAMBRIAN
 - ▨ BIOTITE - MUSCOVITE SCHIST
- / — FOLIATION ATTITUDE KNOWN
- / — GEOLOGICAL CONTACT
- / — OUTCROP
- / — CREEK
- TRY 1 | TRY 2 CLAIM NAME AND NUMBER



FIG No. 13
 SPARTAN EXPLORATIONS LTD (NPL)
TRY CLAIMS
GEOLOGY

DRAWN BY:	APPROVED BY:
DATE OCTOBER, 1971	SCALE 1" = 400 FEET