

GEOCHEMICAL SURVEY
 FOR
 BLACK GIANT MINES LTD. (N.P.L.)
 ON
 THE MIT CLAIM GROUP
 Watson Lake, Mining Division
 Yukon Territory
 Claim Map 105 I - 6
 Latitude 62 Degrees, 23 Minutes North
 Longitude 129 Degrees, 23 Minutes West

BY
 Robert W. Nusbaum
 Geologist

July 12th, 1973 - January 8th, 1974

5283.36

This report has been examined by the Geological Evaluation Unit and is recommended to the Commissioner to be considered as representation work in the amount of \$5283.36

[Signature]
 Resident Geologist or
 Resident Mining Engineer

Considered as representation work under Section 55 (a) Yukon Quartz Mining Act.

[Signature]
 Commissioner of Yukon Territory

TABLE OF CONTENTS

Introduction	Page I
Conclusions	Page I
Recommendations	Page I
Personnel	Page I
Property	Page II
Location & Access	Page II
Soil Sampling Program	Page II
Survey Results	Page II & III
Appendixes	Rear
Certificate	Rear
Location Map	Rear
Claim Map 1" to ½ Mile	Rear
Claim Grid Map 1" to 2,000'	Rear
Geochemical Map 1" to 500'	Pocket
Claim Map 1" to 1000'	Pocket

GEOCHEMICAL SURVEY
FOR
BLACK GIANT MINES LTD. (N.P.L.)
ON
THE MIT CLAIM GROUP
Watson Lake, Mining Division
Yukon Territory

Introduction

Black Giant Mines Ltd. (N.P.L.) acquired the MIT Claim Group in the Spring of 1973, and upon recommendations by the Company Consulting Engineer, a Geochemical Survey was conducted on the Property by Newcastle Explorations, Vancouver, B.C. in July, 1973.

Conclusions

Contouring of all zinc values in excess of 500 parts per million indicates that the values occur as single - sample anomalies forming no definite pattern or trend. Widely scattered anomalous zinc values are a common occurrence in the particular geologic environment of shale host rock, which normally contains high background values of zinc, but not necessarily indicative of significant massive zinc sulfide mineralization.

Recommendations

No further work is recommended on the MIT Claim Group.

Personnel

Newcastle Exploration's Survey Crew

Larry Sostad	Vancouver, B.C.
Garry Baker	Vancouver, B.C.
Jack Bradley	Vancouver, B.C.
David Munns	Vancouver, B.C.

Property

The Property consists of 48 claims recorded on February 7th, 1973, Claim Map 105 I - 6. The following is a list of the claims and their grant numbers.

Name of Claim

Grant Number

MIT 1 - 48

Y 72300 - Y 72347

Location & Access

The Property is located on the northwest end of Summit Lake near the Yukon, Northwest Territories border, Latitude 62 degrees, 34 Minutes North, Longitude 129 degrees, 36 Minutes West, Watson Lake Mining Division, Yukon Territory, Claim Map 105 I - 6.

Access is by fixed wing aircraft to Summit Lake, then by helicopter to the Property. Charter service is available from Watson Lake or Ross River.

Soil Sampling Program

Two baselines were cut and measured, and a grid pattern was layed out on the Claim Group, with lines at 400 feet spacings, and stations at 200 feet intervals. Soil samples were collected from the top of the "B" soil horizon using a hand auger. The samples were packaged in manilla envelopes, code-marked for identification, and sent to Loring Laboratory, Calgary, Alberta for lead-zinc analysis. The samples were screened to minus 80 mesh, digested in aqua regia, and analysed for lead and zinc using the Atomic Absorption method.

Survey Results

Approximately 670 sample results for lead-zinc analysis were received and plotted directly on maps on a scale of 1 inch to 500 feet for contouring and interpretation. About 350

samples were reported missing somewhere between Ross River and the Laboratory in Calgary. Consequently there are several large areas on the Claim Grid devoid of results.

A statistical analysis of the results shows an average background of 15 parts per million in lead. Only one lead value was found which falls in the anomalous category, that is three times background, in this case 45 parts per million. This value was 74 parts per million, and located at co-ordinates 56W 8N, on Grid Map II. No significance is placed on this one anomalous lead value.

Average background zinc values are 185 parts per million, with values of 555 parts per million falling into the anomalous category (i.e. three times background).

Only nine samples with values ranging from 585 to 1335 parts per million zinc were found to fall in the anomalous category. These values are widely scattered over the Claim Grid and do not form an anomalous population. Contouring of all zinc values in excess of 500 parts per million indicates that the anomalous values occur as single - sample anomalies forming no definite pattern or trend. Widely scattered anomalous zinc values are a common occurrence in this particular geologic environment of shale host rock, which normally contains high background values of zinc, but not necessarily indicative of significant massive zinc sulfide mineralization.

January 10th, 1974
Vancouver, B.C.

Robert W. Nusbaum
Robert W. Nusbaum
Geologist

CERTIFICATE OF QUALIFICATIONS

I, Robert W. Nusbaum, do hereby certify:

1. I am a practising Consulting Geologist with residence at 660 Chatsworth Road, Richmond, British Columbia.
2. I am a graduate of the University of Idaho with a Bachelor of Science Degree in Geology.
3. I have been practising my profession since 1959.
4. The accompanying Report is based on analytical data received from Loring Laboratory, Calgary, Alberta, personal experience from working in the Yukon Territory, and information received from the contractor, Newcastle Explorations.
5. I have no interest in the Property, nor in the securities of Black Giant Mines Ltd. (N.P.L.), nor do I expect to receive any.

January 10th, 1974
Vancouver, B. C.

Robert W. Nusbaum
Robert W. Nusbaum
Geologist

LOCATION MAP SHOWING
CANEX DISCOVERY AND STAKING AREA
AND THE MIT CLAIM GROUP
YUKON TERRITORY

Scale: 1 inch to 46 miles

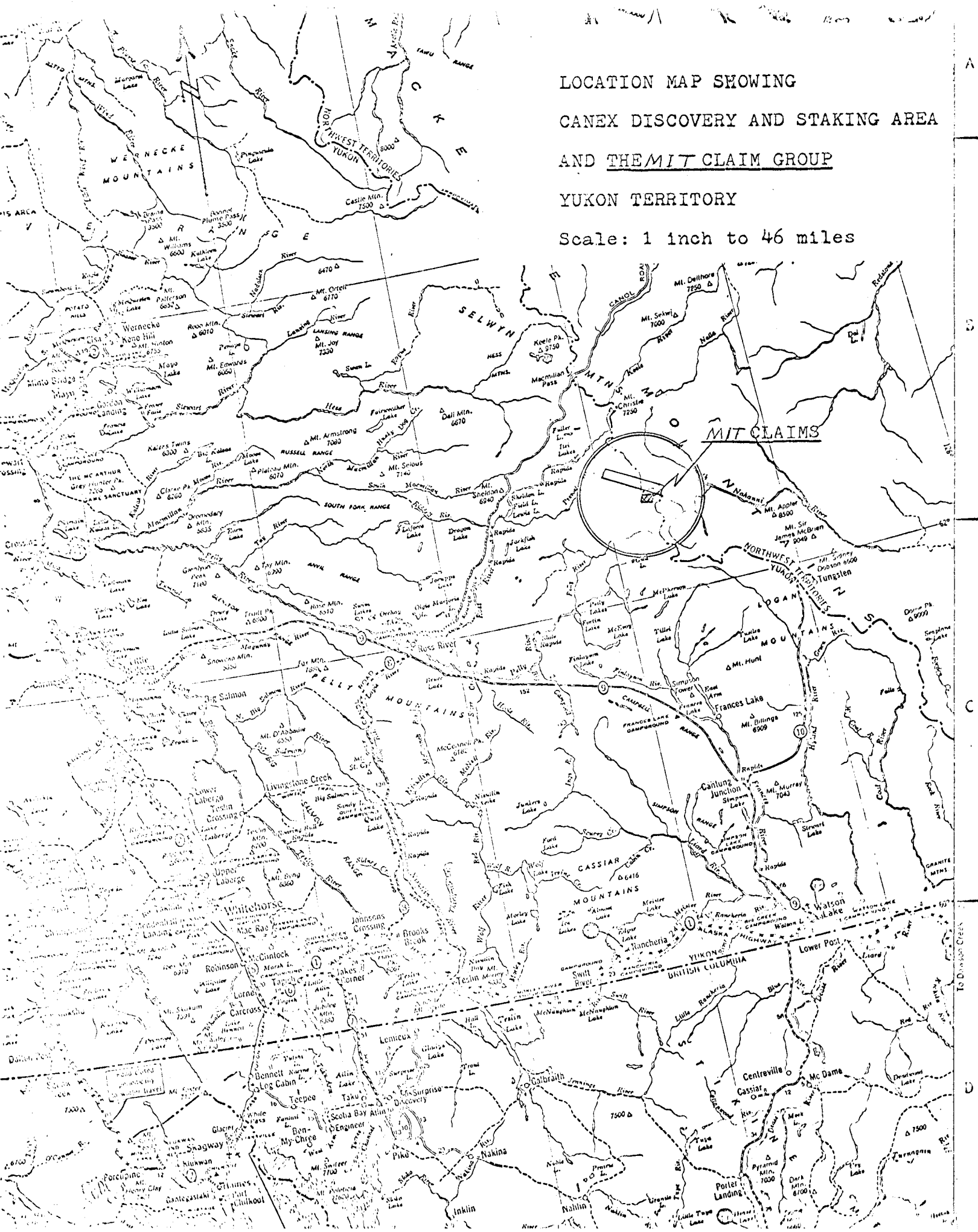

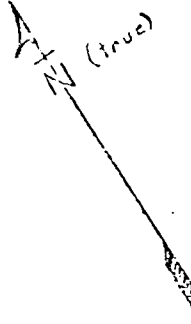

MIT	MIT	MIT	MIT	MIT	MIT	MIT	MIT	MIT	MIT	MIT	MIT
12	10	8	6	4	2	25	27	29	31	33	35
² MIT ¹	² MIT ¹	² MIT ¹	² MIT ¹	² MIT ¹	² MIT ¹	¹ MIT ²	² MIT ¹	² MIT ¹	² MIT ¹	² MIT ¹	² MIT ¹
11	9	7	5	3	1	26	28	30	32	34	36
MIT	MIT	MIT	MIT	MIT	MIT	MIT	MIT	MIT	MIT	MIT	MIT
24	22	20	18	16	14	37	39	41	43	45	47
² MIT ¹	² MIT ¹	² MIT ¹	² MIT ¹	² MIT ¹	² MIT ¹	¹ MIT ²	² MIT ¹	² MIT ¹	² MIT ¹	² MIT ¹	² MIT ¹
23	21	19	17	15	13	38	40	42	44	46	48

N 59° W

N 12° W
10.50'

Black Giant Mine Ltd.

SUMMIT LAKE

Geochemical Survey
MIT Claim Group
Watson Lake Mining District
Yukon Territory

Scale 1" = 1/2 mile
Mineral Chart 105-0-5

10	20	21	22	23	24	25	26	27	28	29	30	31	32	33	34	35
11	20	21	22	23	24	25	26	27	28	29	30	31	32	33	34	35
20	20	21	22	23	24	25	26	27	28	29	30	31	32	33	34	35
25	20	21	22	23	24	25	26	27	28	29	30	31	32	33	34	35

Black Giant Mines Ltd.
 1127 1-48 Claim Group
 Yukon Territory 105 1-6
 Section 615 400 ft. deep, 200 stations
 Sale Price 20000.00 on 11/11/1925 R.M.H.

BLACK GIANT MINES LTD

GEO-CHEMICAL SURVEY
MIT #1-48 CLAIM GROUP

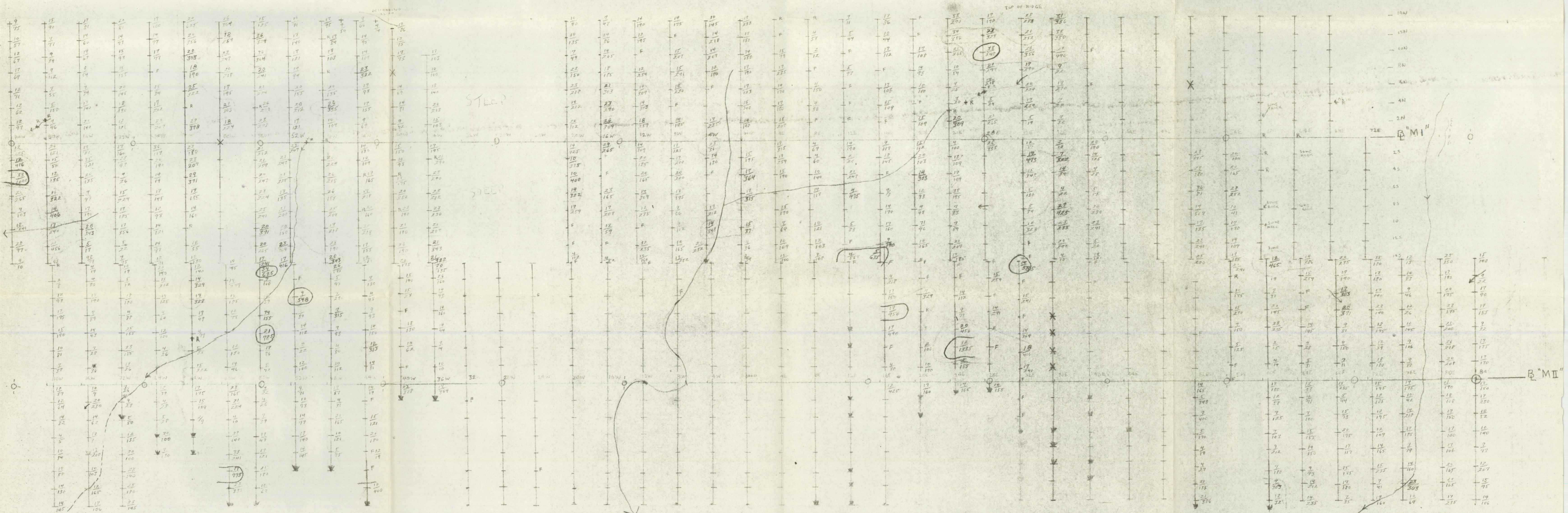
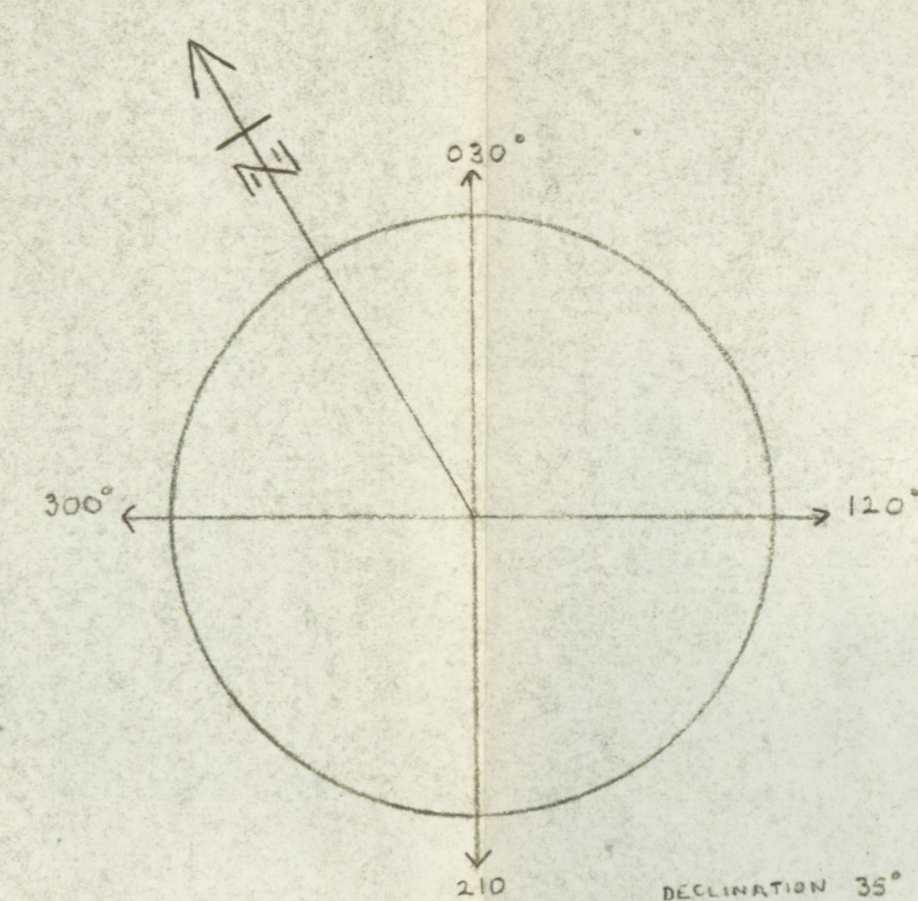

Values in parts per million $\frac{Pb}{Zn}$
Background values 15 ppm lead.
Background values 185 ppm zinc.
Contours for values greater than 500 ppm zinc.

LEGEND	
SAMPLE MISSING	X
NEARBY TRASH	F
ROCK SAMPLE	R
DRY CREEK BED	/
CLAIM POST	⊙

L. R. W. S.

Data compiled, plotted and contoured
by R.W. Nusbaum

CLAIM SHEET 105 1-6

SCALE 1 inch = 500 feet

CLAIM SURVEY
 BLACK GIANT MINES LTD
 M.T. #1-48 MINERAL CLAIMS

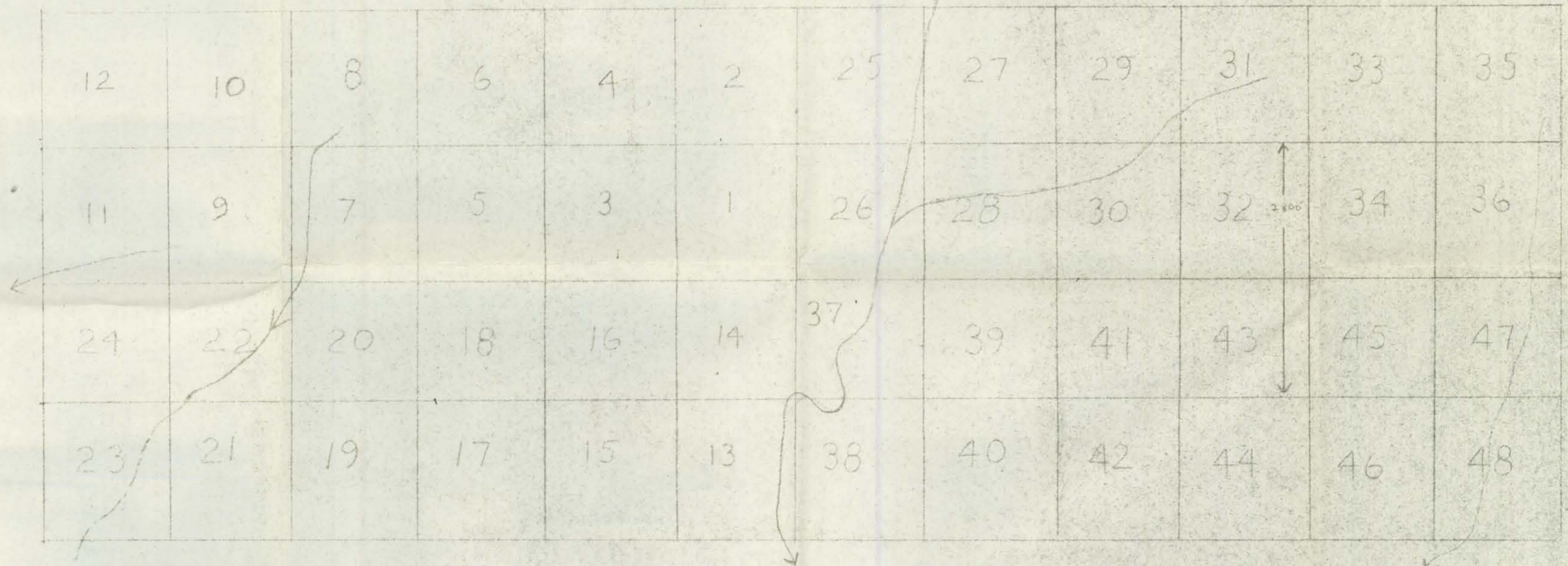

CLAIM SHEET - 105 1-6

L.R.W.S.

SCALE - 1 inch = 1000 feet