

GEOCHEMICAL SURVEY
 FOR
 BLACK GIANT MINES LTD. (N.P.L.)
 ON
 THE NAVAJO CLAIM GROUP
 Whitehorse Mining Division
 Minto Area Yukon Territory
 Claim Map 115 I - 11

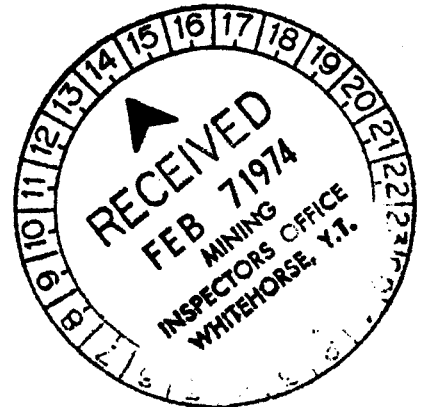

Latitude 62 Degrees, 41 Minutes North
 Longitude 137 Degrees, 15 Minutes West

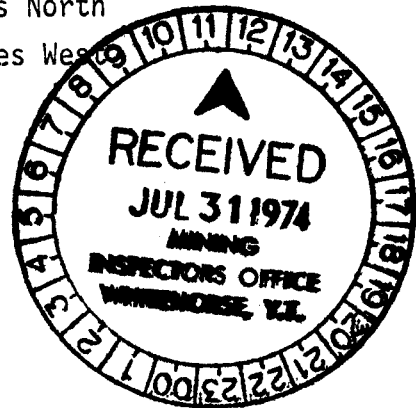

BY
 Robert W. Nusbuam
 Consulting Geologist
 January 17th, 1974

A840-44

This report has been examined by the Geological Evaluation Unit and is recommended to the Commissioner to be considered as representation work in the amount of \$ 4840.44

[Signature]

~~Resident Geologist or
 Resident Mining Engineer~~

Considered as representation work under Section 53 (4) Yukon Quartz Mining Act

[Signature]
 Commissioner of Yukon Territory

TABLE OF CONTENTS

INTRODUCTION	Page I
CONCLUSIONS	Page I
RECOMMENDATIONS	Page I
PERSONNEL	Page II
PROPERTY	Page II
LOCATION & ACCESS	Page II
TOPOGRAPHY	Page III
SOIL SAMPLING PROGRAM	Page III
SURVEY RESULTS	Page III & IV
APPENDIXES	Rear
LOCATION MAP $\frac{1}{2}$ " to 1 mile	Rear
CLAIM GRID MAP 1" to 2,000'	Rear
CERTIFICATE	Rear
GEOCHEMICAL MAP 1" to 500'	Pocket
CLAIM MAP 1" to 1,000'	Pocket

GEOCHEMICAL SURVEY
ON
THE NAVAJO CLAIM GROUP
Whitehorse Mining Division
Minto Area, Yukon Territory

Introduction

The Navajo Claim Group was acquired by Black Giant Mines Ltd. (N.P.L.), in August 1973. Mr. E.O. Chishom P. Eng., wrote a Geological Report on the property which recommended a geochemical survey. Newcastle Explorations, Vancouver, B.C. was contracted to conduct a geochemical survey of the claim group, which involved cutting and measuring baselines and collecting soil samples using a grid pattern on the claims. The field work was conducted from September 15th, to September 24th, 1973. The geochemical results were plotted, contoured and evaluated by the author of this report during November 1973.

Conclusions

The results of the geochemical survey indicate that the background values for the area is about 13 parts per million copper and outlines an area containing discontinuous anomalous values ranging from 40 to 1440 parts per million copper for a distance of 5,000 feet, trending in a northeasterly direction. Another anomalous area contains over 40 parts per million copper for a distance of 600 feet.

Recommendations

Similar geology and the close proximity to a recent copper discovery, 2 miles to the south, makes these geochemical anomalies very significant and warrants geophysical follow-up work to delineate target areas for drilling.

Personnel

Newcastle Exploration's Survey Crew

Larry Sostad	Vancouver, B.C.
Garry Baker	Vancouver, B.C.
Jack Bradley	Vancouver, B.C.
David Munns	Vancouver, B.C.

Property

The property consists of forty claims, which form a rectangular block oriented in a northwesterly direction. The claims were recorded on February 9th, 1973, Whitehorse Mining Division, Mineral Claim Map 115 I -11, Yukon Territory. The following is a list of the claims with their grant numbers.

<u>Name of Claim</u>	<u>Grant Number</u>
Navajo 1 - 8	Y 67883 - Y 67890
Navajo 17 - 24	Y 67899 - Y 67906
Navajo 33 - 40	Y 67915 - Y 67922
Navajo 49 - 56	Y 67913 - Y 67938
Navajo 61 - 68	Y 67943 - Y 67950

Location & Access

The property is located 15 miles northwest of Minto, an old Indian Village situated on the Yukon River, about 50 miles northwest of Carmacks, Yukon Territory, at north 62 degrees 41 minutes latitude, and west 137 degrees 15 minutes longitude, Whitehorse Mining Division. Map Sheet 115 I - 11.

Access is by way of the Alaska Highway or fixed wing aircraft to the Minto airstrip then by helicopter to the property from Carmacks.

Topography

The topography in the area consists of low rolling hills cut by shallow, intermittent streams with frequent swamps and patches of permafrost.

Soil Sampling Program

Five baselines were cut and measured, and a grid pattern was layed out on the claim group with lines at 400' spacings and stations at 200' intervals. Soil samples were collected from the top of the "B" soil horizon using a hand auger. The samples were packaged in manilla envelopes, code-marked with a number for identification and sent to Loring Laboratory, Calgary, Alberta for copper analysis. The samples were screened to minus 80 mesh, digested in aqua regia (HClO4 + HNO3) and analysed for copper using the Atomic Absorption Method.

Survey Results

Approximately 1,100 samples were analysed for copper and the results of the analysis were plotted on maps on a scale of 1 inch to 500 feet for contouring and evaluation. Statistical analysis indicates that the average background value for the area is 13 parts per million in copper. Anomalous values are considered to be three times background, in this case 39 parts per million copper up to a high of 1440 parts per million copper.

In the southern portion of the claim group a series of discontinuous anomalous values ranging from 40 to 1440 parts per million copper are found over a distance of 5,000 feet indicating a northerly to northeasterly trend to an area anomalously high in copper.

Another area in the southeastern part of the claim group contains continuous anomalous values of over 40 parts per million copper for 600 feet. Several scattered, single-value anomalies in the range of 40 to 60 parts per million copper occur on the claim group but are not considered as significant as the two areas containing higher, more continuous values.

Similar geology and the close proximity to a recent copper discovery, 2 miles to the south makes these geochemical anomalies very significant and warrant geophysical follow-up work to ~~be~~ better delineate target areas for drilling.

January 17th, 1974
Vancouver, B.C.

Robert W. Nusbaum
Robert W. Nusbaum
Geologist

CERTIFICATE OF QUALIFICATIONS

I, Robert Wilson Nusbaum, do hereby certify:

1. I am a practising Consulting Geologist with residence at 660 Chatsworth Road, Richmond, B.C.
2. I am a graduate of the University of Idaho with a Bachelor of Science Degree in Geology.
3. I have been practising my profession since 1959.
4. The accompanying report is based on analytical data received from Loring Laboratory, Calgary, Alberta; information from a Geological Report on the Property by E.O. Chisholm, P. Eng.; and information received from the contractor, Newcastle Explorations.
5. I have no interest in the Property, nor in the securities of Black Giant Mines Ltd. (N.P.L.), nor do I expect to receive any.

January 8th, 1974
Vancouver, B.C.

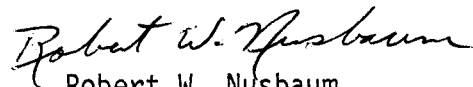
Robert W. Nusbaum
Geologist

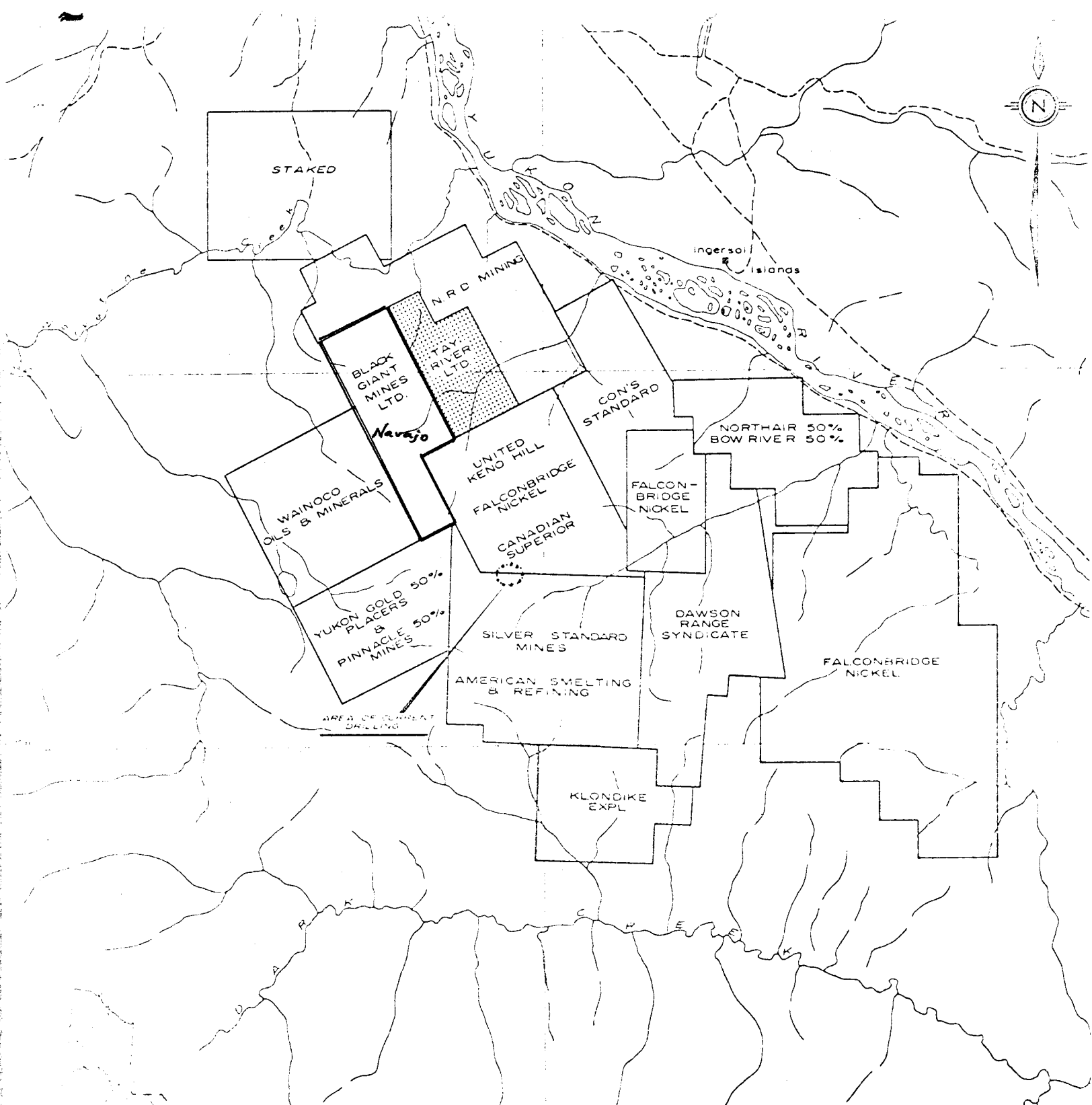

Navajo Claim Group
Black Giant Mines Ltd.
PROPERTY MAP
 OF
MINTO AREA, YUKON TERRITORY

SCALE : 1/2" = 1 MILE



PROPERTY LOCATION

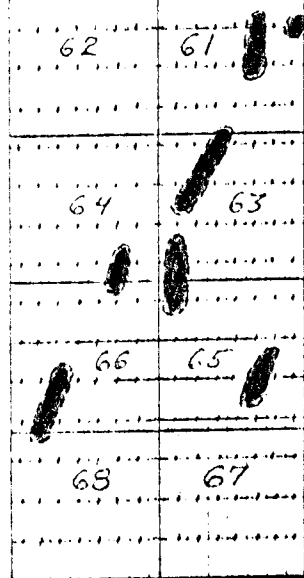
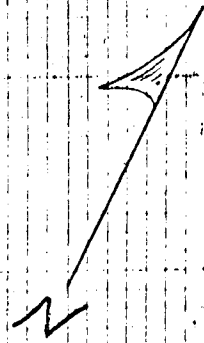
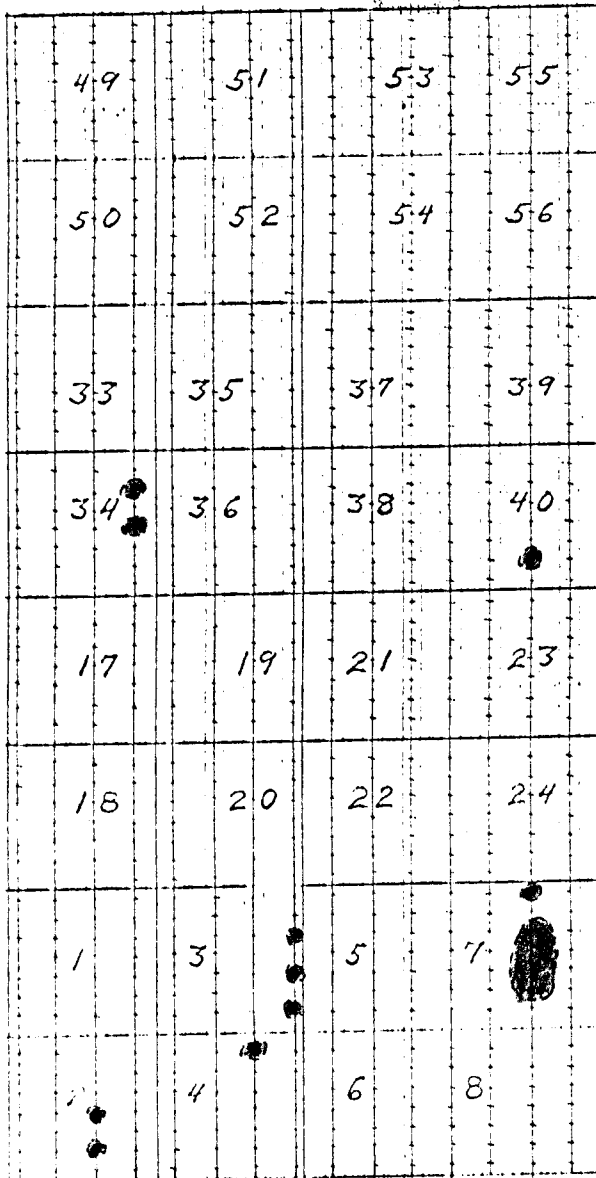

Navajo Claim Group
 Geochemical Survey
 Black Giant Mines Ltd.
 Claim Sheet 115 I-11 Yukon Territory
 Scale 1" to 2000' December, 1973 R.W.N.
 Average Background Value 13ppm Copper
 Greater Than 40ppm Copper
 400' line spacings, 200' Station intervals

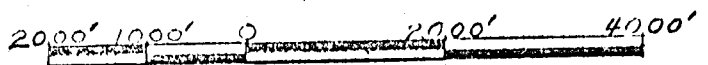

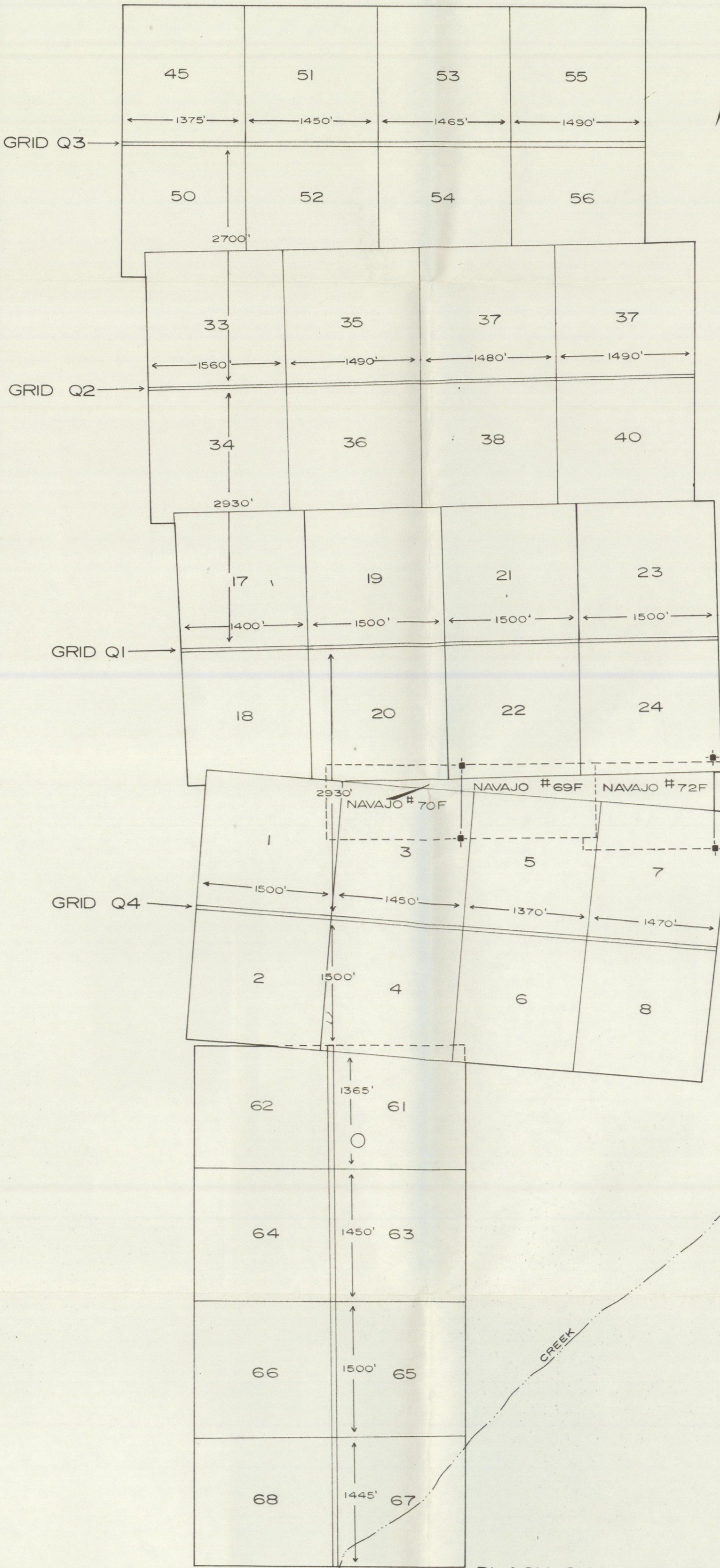

BLACK GIANT MINES LTD.(N.P.L.)
NAVAJO MINERAL CLAIMS
CLAIM MAP

MINTO AREA YUKON TERRITORY
SCALE
0 1000'
FEET FEET

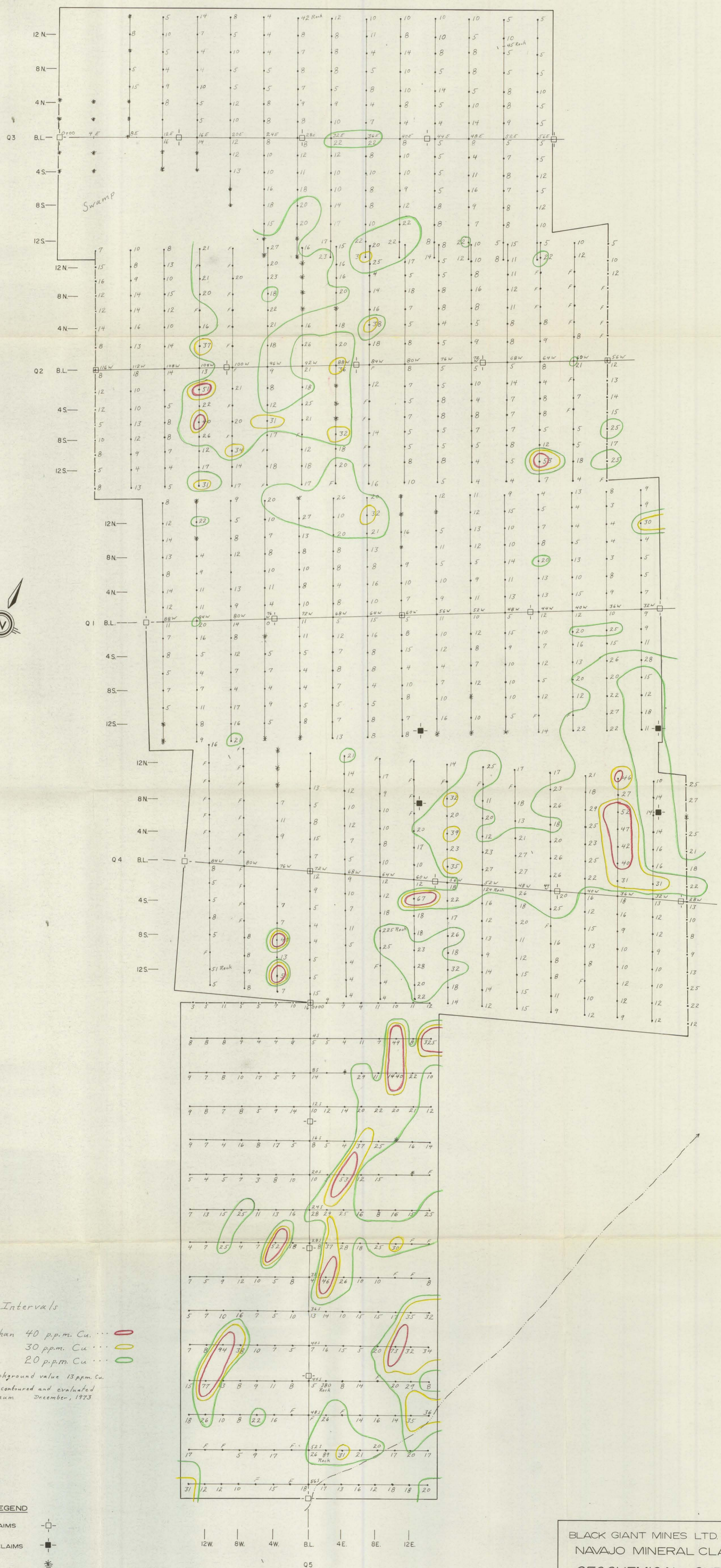

Contour Intervals

- Greater than 40 p.p.m. Cu.
- 30 p.p.m. Cu
- 20 p.p.m. Cu

Average background value 13 p.p.m. Cu.
 Data plotted, contoured and evaluated
 by R.W. Nasbaum December, 1973

LEGEND

- FULL SIZE CLAIMS - □
- FRACTIONAL CLAIMS - ■
- SWAMP PERMAFROST CREEK - F

BLACK GIANT MINES LTD. (NPL.)
 NAVAJO MINERAL CLAIMS
GEOCHEMICAL SURVEY
 COPPER IN P.P.M.
 MINTO AREA YUKON TERRITORY
 SCALE
 1000' 500' 0 500' 1000'
 FEET FEET