

GEOLOGICAL AND GEOCHEMICAL REPORT

ON NS MINERAL CLAIM (1 TO 16 INCLUSIVE) GROUP

62° 20' N, 137° 04' W, BIG CREEK AREA, 115-I-6

WHITEHORSE MINING DISTRICT, YUKON TERRITORY

(The work done between May 27 to 30, 1970)

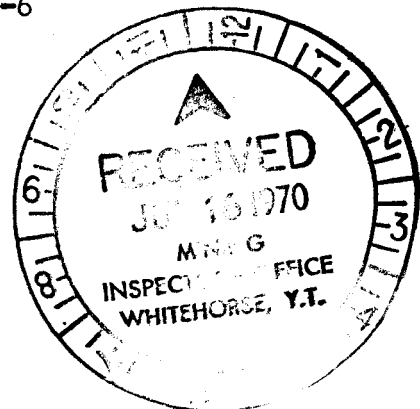
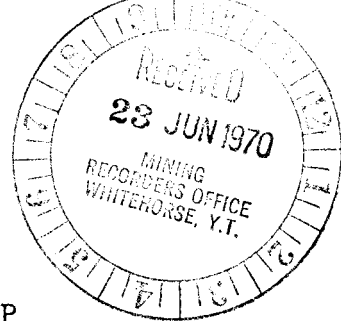

FOR

FOR  
MITSUBISHI METAL MINING CO. LTD.

This report has been examined by the Geological Evaluation Unit and is recommended to the Commissioner to be considered as representative work in the amount of

\$5350.34

*D. B. Craig*  
\_\_\_\_\_  
Inspector

Considered as representative work under Section 83 (1) of the Yukon Mining Act.

*[Signature]*  
\_\_\_\_\_  
Commissioner of Yukon Territory

Toru Kikuchi, P. Eng., Ph.D.  
Consulting Geological Engineer

C O N T E N T S

	Page
I. INTRODUCTION	1
II. GENERAL STATEMENT	1
1) Location, Access and Geographical Features	1
2) History and Mineral Claims	2
3) Work done	3
III. GEOLOGY AND MINERALIZATION	4
IV. GEOCHEMICAL SURVEY	4
V. CONCLUSION AND RECOMMENDATION	9
STATEMENT OF QUALIFICATION	
Toru Kikuchi, P. Eng., Ph.D.	10
Noritaka Sato, B.Sc.	11

Figures:

Fig. 60-1-1	Location Map
Fig. 60-1-2	Claim Map
Fig. 60-1-3	Geological Map
Fig. 60-1-4	Geochemistry Map

Tables:

Table 60-1-1	Mineral Claims
Table 60-1-2	Soil Test Certificate

STATEMENT OF EXPENSES (by N. Sato, Managing Geologist of the work, with an affidavit).

GEOLOGICAL AND GEOCHEMICAL REPORT  
ON NS MINERAL CLAIM (1 to 16 inclusive) GROUP  
62° 20' N, 137° 04' W, BIG CREEK AREA, 115-I-6,  
WHITEHORSE MINING DISTRICT, YUKON TERRITORY

---

I. INTRODUCTION

At the request of Mitsubishi Metal Mining Co. Ltd., which is a mining company legally incorporated in Japan having its main office in Tokyo (No. 6, 1-chome, Ohtemachi, Chiyodaku, Tokyo, Japan) and one of its branch offices in Vancouver (404 - 900 West Hastings Street, Vancouver 1, B.C.), the writer visited the property on May 30, 1970 in the company of Mr. H. Sato, geologist of the said company, and supervised the work herein.

This report is based on the data obtained by the work described in II-3 of this report and on the writer's previous knowledge.

II. GENERAL STATEMENT

1) Location, Access and Geographical Features. (See Fig. 60-1-1.)

The property is situated at about 62° 20' N, 137° 04' W, in Big Creek Area of Claim Sheet 115-I-6, in Whitehorse Mining District, Yukon Territory. It is about 30 air miles NW of Carmacks or just about 4 air miles NW of Granite Mountain.

There is no access road into the property, although there is an exploration road into the property at Granite Mountain. A helicopter, therefore, is the most suitable means of access.

The mineral claim group is at approximately 3,000' to 3,500' elevation in an area of gently rolling hills with some vegetation.

2) History and Mineral Claims. (See Fig. 60-1-2)

There had not been any mineral claim located to the writer's knowledge, and Noritaka Sato and L.M. Thompson located first on May 28, 1969, and transferred to Mitsubishi Metal Mining Co. Ltd. as in the following Table 60-1-1.

Table 60-1-1. Mineral Claims

<u>Claim Name</u>	<u>Date Located</u>	<u>Name of Locator</u>	<u>Date Recorded</u>	<u>Grant Number</u>	<u>Date Transferred to Mitsubishi</u>
NS-1	28 May, 1969	Noritaka Sato	16 June, 1969	Y35254	9 July, 1969
NS-2	ditto	ditto	ditto	Y35255	ditto
NS-3	ditto	ditto	ditto	Y35256	ditto
NS-4	ditto	ditto	ditto	Y35257	ditto
NS-5	ditto	ditto	ditto	Y35258	ditto
NS-6	ditto	ditto	ditto	Y35259	ditto
NS-7	ditto	ditto	ditto	Y35260	ditto
NS-8	ditto	ditto	ditto	Y35261	ditto
NS-9	ditto	L.M. Thompson	11 June, 1969	Y35184	ditto
NS-10	ditto	ditto	ditto	Y35185	ditto
NS-11	ditto	ditto	ditto	Y35185	ditto
NS-12	ditto	ditto	ditto	Y35187	ditto
NS-13	ditto	ditto	ditto	Y35188	ditto
NS-14	ditto	ditto	ditto	Y35189	ditto
NS-15	ditto	ditto	ditto	Y35190	ditto
NS-16	ditto	ditto	ditto	Y35191	ditto

Mitsubishi Metal Mining Co. Ltd., the present owner of the property, did not do any representation work on the said claims during the summer season of 1969, but has carried out a helicopter supported geological and geochemical survey as representation work on the ground of the property by the company geologists and others under the supervision of the writer in May of 1970 before the claim expiration date, June 11, as reported herein. An application will be made to group these sixteen (16) mineral claims, according to the Yukon Quartz Mining Act, before applying for a Certificate of Work.

3) Work Done.

The representation work covered by this report was completed during the period May 27 to 30, 1970, by Mitsubishi Metal Mining Co. Ltd. with field crews as follows:

Toru Kikuchi, P. Eng., Ph.D.	Consulting Geological Engineer Supervising the work. (702 - 402 West Pender St., Vancouver, B.C.)
Noritaka Sato, B.Sc.	Geologist, Mitsubishi Metal Mining Co. Ltd. Managing the work. (19 - 1111 East 27th St., North Vancouver,
Hiroshi Mori, B.Sc.	Geologist, Mitsubishi Metal Mining Co. Ltd. (131 - 5925 Tisdall St., Vancouver, B.C.)
Basant K. Mansinghka, M.Sc.	Temporarily employed geologist Mitsubishi Metal Mining Co. Ltd. (c/o Mitsubishi Metal Mining Co. Ltd. 404 - 900 West Hastings St., Vancouver, B.C.)
William R. Lewis	Temporarily employed prospector, Mitsubishi Metal Mining Co. Ltd. (St. Regis Hotel, 602 Dunsmuir St., Vancouver,
Nairn Grundy	Temporarily employed student helper Mitsubishi Metal Mining Co. Ltd. (2969 Mathers Ave., West Vancouver, B.C.)

(Certificate of Qualification for the first two above mentioned will be found at the end of this report.)

These crew members stayed at a motel in Carmacks, and a helicopter (Klondike Helicopter Ltd. - Bob Murphy, pilot) was used to carry them in every day to the property from/to Carmacks.

A geological survey and a geochemical survey were carried out there at the same time, as described in the following separate items respectively.

### III. GEOLOGY AND MINERALIZATION

The ground surface condition of the property is not good for geological survey because of overburden and vegetation, except for some high elevation parts with some rock outcrop.

The geological survey was made by the geologists along the geochemi soil sampling lines. (See Fig. 60-1-3 and Fig. 60-1-4.)

The general geology of the area surrounding the property is described in Bostock's report (H.S. Bostock: Carmacks District, Yukon, G.S.C. Memoir 189, 1936). According to the work herein, the rock of the property is only a granitic rock which should be called Biotite-hornblende granodiorite, except at the southern swampy area. This granodiorite is coarse to medium grain, bearing much biotite and a small amount of hornblende as mafic minerals, and is intruded by small pegmatite veins. There are some floats of aplitic rock at the northern part of the area, and, in Claim NS-7, an aplite dyke was found which strikes N-S (north to south) having about 5 feet width. Two main directions of joint system of the granodiorite N 30° E and N 40° W, were recognized. Very weak alteration was seen.

A small amount of pyrite in the granodiorite which was found at the northern part is the unique mineralization in the property.

### IV. GEOCHEMICAL SURVEY

A helicopter supported geochemical soil sampling program has been carried out in the NS claim group area by the company crews. Red plastic ribbon has been used to mark the soil sampling point, but no line cutting has been done because the bush was not thick except on part of the ground. The timing of the work was a bit early, especially on the north-facing hill, as there was some winter frost where it was difficult to take a good soil sample. The results are shown in Table 60-1-2, and Fig. 60-1-4.

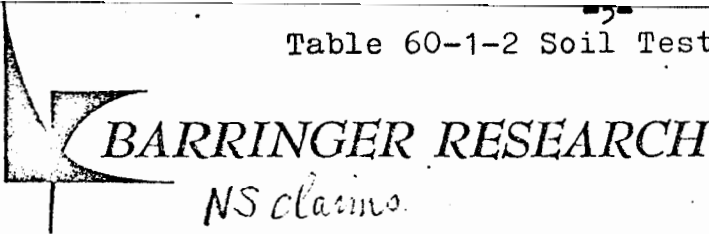

GEOCHEMICAL LABORATORY REPORT NO. 8A

DATE MAY 31/70

SAMPLE NO	Location	TOTAL Cu ppm	SAMPLE NO	Location	TOTAL Cu ppm	SAMPLE NO	Location
BA-1	W300 S300	9	BC-6	W150 S150	3	BE-3	W240 0
2	W270 S300	26	7	W120 S150	11	4	W210 0
3	W240 S300	16	8	W90 S150	17	5	W180 0
4	W210 S300	9	9	W60 S150	15	6	W150 0
5	W180 S300	16	10	W30 S150	18	7	W120 0
BB-1	W300 S225	11	11	W0 S150	11	8	W90 0
2	W270 S225	23	BD-1	W300 S75	13	9	W60 0
3	W240 S225	3	2	W270 S75	15	10	W30 0
4	W210 S225	6	3	W240 S75	75	11	0
5	W180 S225	10	4	W210 S75	10	BF-1	W300 S75
6	W150 S225	6	5	W180 S75	8	2	W270 S75
7	W120 S225	6	6	W150 S75	14	3	W180 S75
8	W90 S225	17	7	W120 S75	17	4	W90 S75
BB-11	0 S225	25	8	W90 S75	13	5	W60 S75
BC-1	W300 S150	13	9	W60 S75	15	6	W30 S75
2	W270 S150	8	10	W30 S75	15	7	W0 S75
3	W240 S150	13	11	0 S75	4	8	W0 S75
4	W210 S150	16	BE-1	W300 0	6	9	W300 S75
5	W180 S150	19	2	W270 0	9	10	W270 S75

*Handwritten signature*

GEOCHEMICAL LABORATORY REPORT NO. 8-A

DATE MAY 31/70

SAMPLE NO.		Total Cu		SAMPLE	Total Cu				
		ppm		NO	ppm				
BF-11	0 N75	8		BH-8	W70 N225	19			
BG-1	W300 N150	6		9	W60 N225	3			
2	W270 N150	4		10	W30 N225	8			
3	W240 N150	9		11	0 N225	9			
4	W210 N150	2		BI-1	W300 N300	I.S.			
5	W150 N150	6		2	W270 N300	6			
6	W150 N150	6		3	W240 N300	3			
7	W120 N150	8		4	W210 N300	17			
8	W90 N150	15		5	W180 N300	13			
9	W60 N150	5		6	W150 N300	3			
10	W30 N150	14		7	W120 N300	13			
11	0 N150	13		8	W90 N300	20			
BH-1	W300 N225	7		9	W60 N300	5			
2	W270 N225	6		10	W30 N300	4			
3	W240 N225	21		11	0 N300	4			
4	W210 N225	10							
5	W180 N225	4							
6	W150 N225	9							
7	W120 N225	23							

*Noted*

GEOCHEMICAL LABORATORY REPORT NO. 8-A

DATE MAY 21/70

SAMPLE NO.	Location	TOTAL Cu ppm	SAMPLE N°	Location	TOTAL Cu ppm	SAMPLE N°	Location	TOTAL Cu ppm
NG-46	E150 0	6	NG-65	E60 N150	I.S.	NG-84	0 N225	2
NG-47	E150 0	2	66	E90 N150	8	85	0 N300	6
48	E210 0	11	67	E120 N150	3	86	E30 N300	6
49	E240 0	3	68	E150 N150	7	87	E60 N300	6
50	E270 0	I.S.	69	E180 N150	4	88	E90 N300	14
51	E300 0	10	70	E210 N150	7	89	E120 N300	I.S.
52	E300 N75	9	71	E240 N150	6	90	E150 N300	9
53	E270 N25	8	72	E270 N150	9	91	E150 N300	I.S.
54	E240 N75	6	73	E300 N150	17	92	E210 N300	7
55	E210 N25	11	74	E300 N225	6	93	E240 N300	3
56	E150 N25	8	75	E270 N225	2	94	E270 N300	5
57	E150 N75	I.S.	76	E240 N225	6	95	E300 N300	6
58	E120 N75	3	77	E210 N225	8	96	0 N300	8
59	E90 N75	4	78	E150 N225	10	97	"	4
60	E60 N75	5	79	E150 N225	12	98	"	5
61	E30 N75	29	80	E120 N225	I.S.	99	"	12
62	0 N75	11	81	E90 N225	8	NG-100	"	8
63	0 N150	16	82	E60 N225	5			
NG-64	E30 N150	5	NG-83	E30 N225	5			

*DR*

GEOCHEMICAL LABORATORY REPORT NO. 8-A DATE MAY 31/70

SAMPLE NO.	Location	TOTAL Cu ppm	SAMPLE N <sup>o</sup> .	Location	Total Cu ppm				
B+10	E 120 S 300	N.S.	B+29	E 120 S 150	10		B+1	E 150 S 300	14
11	E 180 S 300	8	30	E 150 S 150	10		2	E 120 S 300	I.S.
12	E 210 S 300	N.S.	31	E 150 S 150	6		3	E 120 S 300	12
13	E 240 S 300	7	32	E 210 S 150	8		4	E 120 S 300	15
14	E 270 S 300	N.S.	33	E 240 S 150	14		5	E 120 S 300	I.S.
15	E 300 S 300	6	34	E 270 S 150	4		6	E 90 S 300	N.S.
16	E 300 S 225	7	35	E 300 S 150	2		7	E 90 S 300	I.S.
17	E 270 S 225	5	36	E 300 S 225	N.S.		8	E 90 S 300	I.S.
18	E 240 S 225	I.S.	37	E 270 S 75	2		B+9	E 90 S 300	I.S.
19	E 210 S 225	I.S.	38	E 240 S 75	2				
20	E 150 S 225	3	39	E 240 S 75	5				
21	E 150 S 225	4	40	E 210 S 75	4				
22	E 120 S 225	3	41	E 150 S 75	4				
23	E 90 S 225	2	42	E 120 S 75	9				
24	E 60 S 225	4	43	E 90 S 75	5				
25	E 30 S 225	12	44	E 60 S 75	4				
26	E 30 S 150	7	B+45	E 30 S 75	5				
27	E 60 S 150	5							
B+28	E 90 S 150	6							
TOTAL Cu - PERIODIC ACID DESTRUCTION							D. Head		
ATOMIC ABSORPTION									
TOTAL Mo - CARBONATE FUSION - COLUMBIC									

V. CONCLUSION AND RECOMMENDATION

The property is very close to the copper showings of Granite Mountain about 4 miles southeast, and the property area consists of granodiorite, with some indication of mineralization, which is the same as Granite Mountain. Therefore, some further work is recommended. The type of work, its scale and expenses will be studied by the company.

Respectfully submitted,

A handwritten signature in cursive script, appearing to read 'Toru Kikuchi', written in black ink on a white background.

Toru Kikuchi, P. Eng. Ph.D.

STATEMENT OF QUALIFICATIONS

I, Toru Kikuchi of the City of Vancouver, B.C. hereby certify that:

1. I am a graduate of the Hokkaido University, Japan (B.Sc., Geology and Mineralogy, 1946) and of the Tohoku University, Japan (Ph.D., Economic Geology, 1963).
2. I am a "GIJUTSUSHI" (a qualification for a consulting engineer authorized by the Japanese Government) and a member in good standing of The Association of Professional Engineers of the Province of British Columbia and of the Yukon Territory.
3. I am a member of The Society of Mining Geologists of Japan, and of The Canadian Institute of Mining and Metallurgy and of The Engineering Institute of Canada.
4. I have been practising my profession continuously for the past twenty-three years, and am an independent Consulting Geological Engineer with my office at Room 702 - 402 West Pender Street, Vancouver 3, B.C.
5. I have no direct or indirect interest in the property, nor do I anticipate receiving any such interest.
6. This report is based on my personal study and work at the property on May 30, 1970.



Toru Kikuchi, P. Eng.

Vancouver, B.C.  
June 9, 1970.

STATEMENT OF QUALIFICATIONS

I, Noritaka Sato of the City of Vancouver, B.C. hereby certify that:

1. I am a graduate of Tokyo University, Japan (B.Sc., Geology, 1963).
2. I am a member of The Canadian Institute of Mining and Metallurgy, and of The Society of Mining Geologists of Japan.
3. I have been practising my profession continuously for the past seven years as a geologist for Mitsubishi Metal Mining Co. Ltd.
4. I have no direct or indirect interest in the property, nor do I anticipate receiving any such interest.
5. The original data of this report is based on my personal study and work at the property on May 27 and 30, 1970.

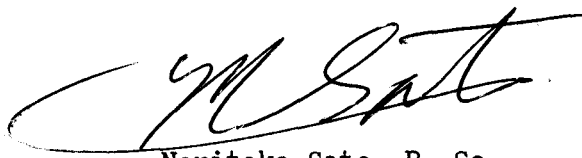

Noritaka Sato, B. Sc.

Vancouver, B.C.

June 9, 1970.

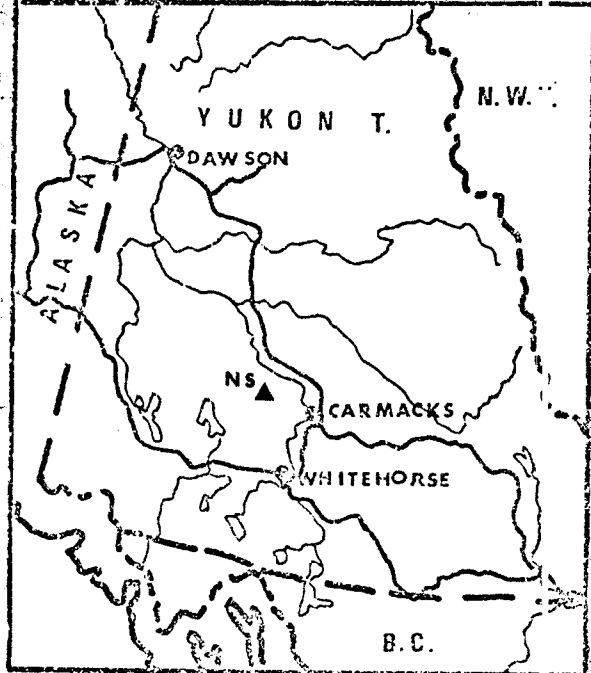
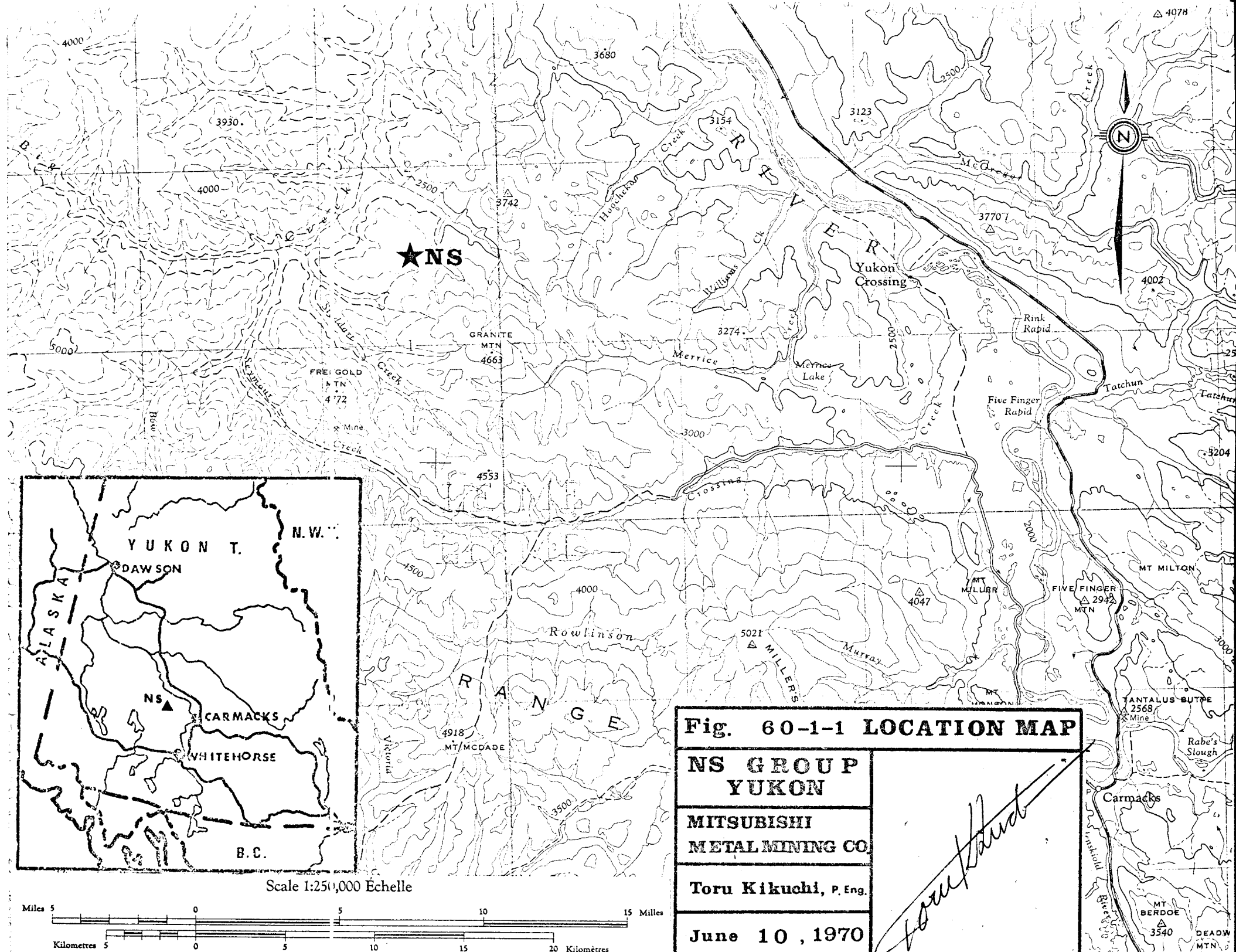

**Fig. 60-1-1 LOCATION MAP**

**NS GROUP  
YUKON**

**MITSUBISHI  
METAL MINING CO.**

**Toru Kikuchi, P. Eng.**

**June 10, 1970**

*Toru Kikuchi*



Claim Sheet, 115-I-6

Scale 0 1500' 3000'

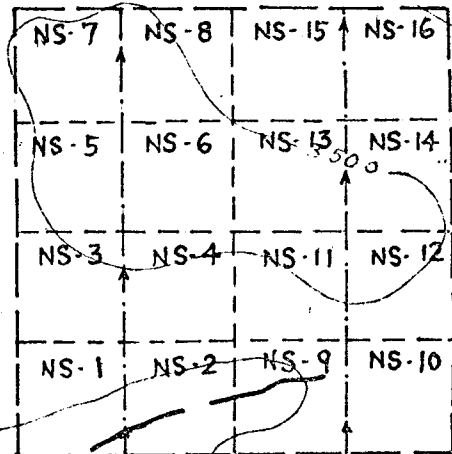
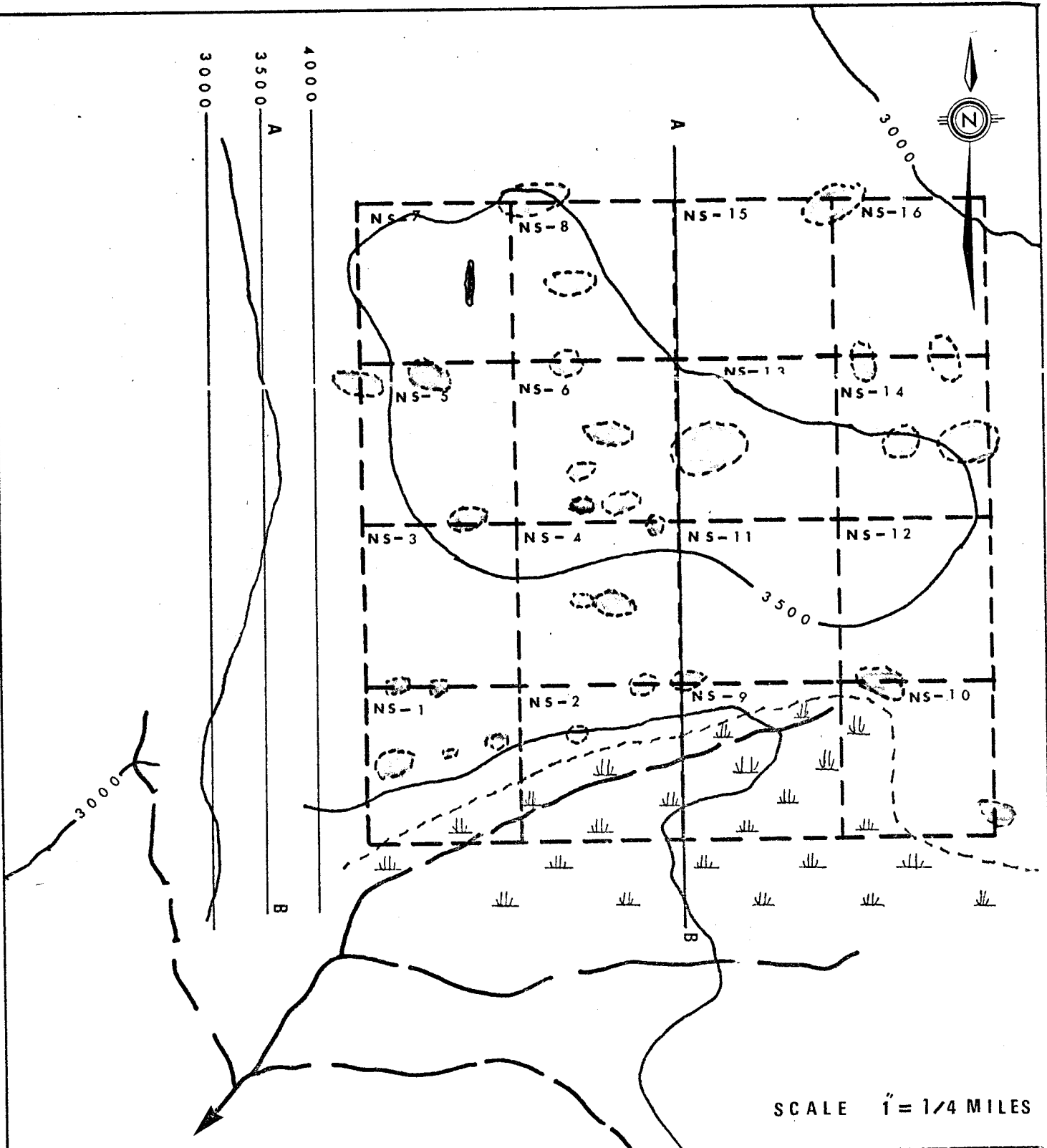

**Fig. 60-1-2 CLAIM MAP**



<b>NS GROUP YUKON</b>
<b>MITSUBISHI METAL MINING CO.</b>
<b>Toru Kikuchi, P. Eng.</b>
<b>June 10, 1970</b>

*Low Trust*

91	92	75	76	9
Y10735	Y10736	Y10719	Y10720	Y107
89	90	73	74	
Y10733	Y10734	Y10717	Y10718	MARCH
87	88	71	72	
Y10731	Y10732	Y10715	Y10716	
85	86	69	70	
Y10729	Y10730	Y10713	Y10714	MARCH
83	84	67	68	
Y10728	Y10729	Y10712	Y10713	



SCALE 1" = 1/4 MILES

-  Aplite dyke
-  Granodiorite
-  Swamp

<b>Fig. 60-1-3 GEOLOGICAL MAP</b>	
<b>NS GROUP YUKON</b>	
<b>MITSUBISHI METAL MINING CO.</b>	
<b>Toru Kikuchi, P. Eng.</b>	
<b>June 10, 1970</b>	

*Toru Kikuchi*

Geology: by H. Mori & N. Sato



 > 50 P.P.M. Cu  
 i.s. ; insufficient sample  
 n.s. ; no sample

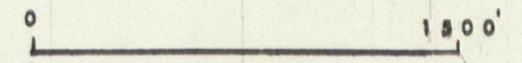

<b>Fig. 60-1-4 GEOCHEMICAL MAP</b>	
<b>NS GROUP YUKON</b>	
MITSUBISHI METAL MINING CO.	
Toru Kikuchi, P. Eng.	
June 10, 1970	

*Toru Kikuchi*

1  
NS

STATEMENT OF EXPENSES

With an affidavit by N. Sato,  
Managing Geologist of the work,  
Mitsubishi Metal Mining Co. Ltd.

PERSONNEL:

N. Sato, B.Sc., Managing Geologist of the work, 4 days in total (2 days on the property and 2 days for management and moving) @ \$50/day	\$ 200.00	
H. Mori, B.Sc., Geologist 4 days in total (2 days on the property and 2 days for report preparation and moving) @ \$50/day	200.00	
B.K. Mansinghka, M.Sc., Geologist 3 days in total (2 days on the property and 1 day for work preparation and moving) @ \$30/day	90.00	
W.R. Lewis, Prospector 3 days in total (2 days on the property and 1 day for work preparation and moving) @ \$35/day	105.00	
-N. Grundy, Helper 3 days in total (2 days on the property and 1 day for work preparation and moving) @ \$20/day	<u>60.00</u>	\$ 655.00

CONSULTING:

T. Kikuchi, Professional Fee	\$1,600.00	1,600.00
------------------------------	------------	----------

TRAVEL, ACCOMODATIONS AND SUPPLIES:  
(Including Helicopter and Pilot)

Consultant's advance	\$ 156.31	
Helicopter (Klondike Helicopters Ltd.)	2,399.90	
Car Rental (Hertz)	50.59	
Hotel Room (Carmacks)	105.00	
Meals, Carmacks)	<u>141.54</u>	2,853.34

ASSAY FEE:

Barringer Research Ltd.	\$ <u>242.00</u>	<u>242.00</u>
-------------------------	------------------	---------------

TOTAL \$5,350.34



Noritaka Sato, B.Sc.,  
Geologist.

June 10, 1970.

This amount, if accepted, is good for 3 years for 16 claims group.

IN ACCOUNT WITH:  
TORU KIKUCHI, Ph.D., P.Eng.  
CONSULTING GEOLOGICAL ENGINEER

702, 402 WEST PENDER ST., VANCOUVER 3, B.C., CANADA

June 4th, 1970.

Statement No. 60-1.

Mr. Yutaka Eda, Manager  
Mitsubishi Metal Mining Co. Ltd.  
404 - 900 West Pender Street  
Vancouver 1, B.C.

To professional services:

Visiting the property, supervision of work,  
preparation of Report No. 60-1 on your NS  
property, Yukon and applying to file the said  
report with the Government Office

\$1,600.00

Travel expenses for the above, details in the  
attached data

156.31

\$1,756.31

PAID

T.K.

NS-

TRAVEL EXPENSES  
(May 26 - 31, 1970, to Yukon)

May 26;	Taxi, Home to Vancouver Airport	2.25
	Supper at Whitehorse	8.55
May 27;	Breakfast at Whitehorse	1.75
	Hotel Room at Whitehorse	10.00
May 28;	Breakfast at Carmacks	1.80
May 31;	Breakfast at Whitehorse	1.50
	Hotel Room at Whitehorse	8.00
	Air Ticket, Vancouver - Whitehorse, return	166.00
	Rent Car, Whitehorse	111.28
	Topo Maps for report	1.50
-----		
	Total	\$312.63

SHARE:	<u>50% for NS(16 Claims) group, \$156.31</u>
	25% for BF( 8 Claims) group, \$78.16
	25% for KL( 9 Claims) group, \$78.16
	-----
	Total            \$312.63

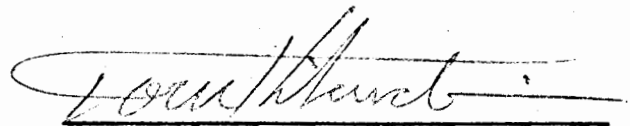
  
-----  
Toru Kikuchi

**CAPITAL HOTELS (YUKON) LTD.**

Received from Mr J. Kikuchi WHITEHORSE, YUKON May 27 1970  
the sum of Ten Dollars  
for Room Acc

\$ 10.00

CASH <input checked="" type="checkbox"/>	CHEQUE <input type="checkbox"/>
--	---------------------------------

CAPITAL HOTELS (YUKON) LTD.  
PER J. Mac Donald

**CAPITAL HOTELS (YUKON) LTD.**

Received from J. Kikuchi WHITEHORSE, YUKON May 31 1970  
the sum of Eight Dollars  
for Room accom

\$ 8.00

CASH <input checked="" type="checkbox"/>	CHEQUE <input type="checkbox"/>
--	---------------------------------

CAPITAL HOTELS (YUKON) LTD.  
PER E. M. Callum

IN ACCOUNT WITH

Nº 4882



# K. IWATA TRAVEL SERVICE

461 EAST HASTINGS STREET VANCOUVER 4 B.C. TEL: 251-5101 RES: 253-3883

May 22, 1970

Dr. T. Kikuchi  
#702, 402 West Pender Street  
Vancouver 3, B.C.

May 26, 1970

Air ticket for \$166.00  
Dr. T. Kikuchi

Re: Vancouver - Tokyo - Vancouver  
May 26, 1970

*TK*





HELICOPTER

May 23; \$668.75 (This is not for this work)

May 25; \$593.30

May 26; \$1,144.70

May 27; \$851.40

May 28; \$851.40

May 29; \$851.40

May 30; \$507.60

Total \$5,468.55 Paid for Klondike Helicopter.

minus \$668.75 (May 23, not for this work)

\$4,799.80 This is net expenses for this work.

No. 35 JUN 1 1970

Received from MITSUBISHI METAL MINING CO.

FIVE THOUSAND FOUR HUNDRED SIXTY <sup>EIGHT.</sup> 100 Dollars

TO COVER INVOICE 3584-3590

BY CHEQUE. KLONDIKE HELICOPTERS LTD.

\$5468.55 MADE IN B.C. R. D. [Signature]

SHARE:- 50% for NS(16 claims) Group, \$2,399.90

25% for BF( 8 claims) Group, \$1,199.95

25% for KL( 9 claims) Group, \$1,199.95

Total \$4,799.80

CALGARY 277-8526

WHITEHORSE 668-2212



SOLD TO • MITSUBISHI METAL MINING CO. LTD.  
 404 - 900 WEST HASTINGS ST.  
 VANCOUVER 1, B.C.

No. 1 HANGAR, McCALL FIELD  
 CALGARY, ALBERTA  
 JUNE 1, 1970

ACCOUNTS DUE WHEN RENDERED PAYABLE AT PAR CALGARY

CUSTOMER'S ORDER NUMBER	SHIP VIA	DATE SHIPPED	AIRCRAFT CF - MFQ	TRIP NO.
QUANTITY	PART NUMBER	DESCRIPTION	PRICE	AMOUNT

PILOT: BOB MURPHY

TO: Charge for charter of one Bell Super G  
 helicopter as per authorized Daily Flight Report  
 #17540 attached.

FLYING: May 23/70 5:00 hrs @ \$130.00 per hour  
 (Fuel supplied by carrier) \$650.00

PLUS: Excess fuel charges out of Canyon Creek 18.75

TOTAL INVOICE ..... \$668.75

Charles E. ...  
 1970

CALGARY 277-8526

WHITEHORSE



No. 1 HANGAR, McCALL FIELD  
 CALGARY, ALBERTA  
 JUNE 1, 1970

SOLD TO .

MITSUBISHI METAL MINING CO. LTD.  
 404 - 900 WEST HASTINGS ST.  
 VANCOUVER 1, B.C.

ACCOUNTS DUE WHEN RENDERED  
 CUSTOMER'S ORDER NUMBER

SHIP VIA

DATE SHIPPED

PAYABLE AT

AIRCRAFT

CF - MFQ

QUANTITY

PART NUMBER

DESCRIPTION

PRICE

PILOT: BOB MURPHY

TO: Charge for charter of one Bell Super G helicopter  
 as per authorized Daily Flight Report #17541 attached

FLYING: MAY 25/70 4:35 hrs @ \$125.00 per hour  
 (Fuel supplied by carrier) \$572.00

PLUS: Excess fuel charges out of Carmacks Y.T. 20.40

TOTAL INVOICE \$593.30

MAY 28 1970  
 R. D. Murphy

R. D. Murphy

Thank You

CALGARY 277-8526

WHITEHORSE



No. 1 HANGAR, McCALL FIELD  
CALGARY, ALBERTA

JUNE 1, 1970

SOLD TO .  
 MITSUBISHI METAL MINING CO. LTD.  
 404 - 900 WEST HASTINGS ST.  
 VANCOUVER 1, B.C.

ACCOUNTS DUE WHEN RENDERED  
 CUSTOMER'S ORDER NUMBER

SHIP VIA

DATE SHIPPED

PAYABLE TO

AIRCRAFT

CF-MRO

QUANTITY

PART NUMBER

DESCRIPTION

PRICE

PILOT: BOB MURPHY

TO: Charge for one Bell Super G helicopter as per authorized  
 Daily Flight Report #17542 attached

FLYING: May 26/70 8:50 hrs at \$125.00 per hour  
 (Fuel supplied by Carrier) \$110

PLUS: Excess fuel charges out of Carmacks Y.T. 40

TOTAL INVOICE ..... \$140

RECEIVED  
 R. D. M.  
 Cashier



SOLD TO .  
 MITSUBISHI METAL MINING CO. LTD.  
 404 - 900 WEST HASTINGS ST.  
 VANCOUVER 1, B.C.

No. 1 HANGAR, McCALL FIELD  
 CALGARY, ALBERTA

JUNE 1, 1970

ACCOUNTS DUE WHEN RENDERED

PAYABLE AT PAR CALGARY

CUSTOMER'S ORDER NUMBER		SHIP VIA	DATE SHIPPED	AIRCRAFT	TRIP NO.
QUANTITY	PART NUMBER	DESCRIPTION	PRICE	AMOUNT	
				CF-MFO	

PILOT: BOB MURPHY

TO: Charge for one Bell Super G helicoptera as per authorized  
 Daily Flight Report #17543 attached

FLYING: May 27/70 6;35 hrs @ \$125.00 per hour  
 (Fuel supplied by carrier) \$822.90

PLUS: Excess fuel charges out of Carmacks Y.T. 28.50

TOTAL INVOICE ..... \$851.40

PAID IN FULL

[Signature]

Thank You

CALGARY 277-8526

WHITEHORSE 668-2212



SOLD TO .  
 MITSUBISHI METAL MINING CO. LTD.  
 404 - 900 WEST HASTINGS ST.  
 VANCOUVER 1, B.C.

No. 1 HANGAR, McCALL FIELD  
 CALGARY, ALBERTA  
 JUNE 1, 1970

ACCOUNTS DUE WHEN RENDERED  
 CUSTOMER'S ORDER NUMBER

PAYABLE AT PAR CALGARY

SHIP VIA

DATE SHIPPED

AIRCRAFT

TRIP NO.

CF-MFQ

QUANTITY

PART NUMBER

DESCRIPTION

PRICE

AMOUNT

PILOT: BOB MURPHY

TO: Charge for one Bell Super G helicopter as per authorized  
 Daily Flight Report # 17544 attached

FLYING: May 28/70 6;35 hrs at \$125.00 per hour  
 (Carrier supplied fuel) \$822.90

PLUS: Excess fuel charges out of Carmacks Y.T. 28.50

TOTAL INVOICE ..... \$851.40

PAID IN FULL

R. D. M.

Thank You

CALGARY 277-8526

WHITEHORSE 668-2212



SOLD TO . MITSUBISHI METAL MINING CO. LTD.  
 404 - 900 WEST HASTINGS ST.  
 VANCOUVER 1, B.C.

No. 1 HANGAR, MCCALL FIELD  
 CALGARY, ALBERTA  
 JUNE 1, 1970

ACCOUNTS DUE WHEN RENDERED      PAYABLE AT PAR CALGARY  
 CUSTOMER'S ORDER NUMBER      SHIP VIA      DATE SHIPPED      AIRCRAFT      TRIP NO.

QUANTITY	PART NUMBER	DESCRIPTION	PRICE	AMOUNT
			CF-119Q	

PILOT: BOB MURPHY

TO: Charge for one Bell Super G helicopter as per authorized  
 Daily Flight Report #17545 attached

FLYING: May 29/70 6;35 hrs. @ \$125.00 per hour  
 (Carrier supplied Fuel) \$822.90

PLUS: Excess fuel charges out of Carmacks Y.T. 28.50

TOTAL INVOICE ..... \$851.40

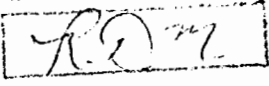
PAID FOR PEOPLE  
  
 Thank You

GARY 277-8526

WHITEHORSE 333 2212



No. 1 HANGAR, McCALL FIELD  
CALGARY, ALBERTA

JUNE 1, 1970

SOLD TO .  
 MITSUBISHI METAL MINING CO. LTD.  
 404 - 900 WEST HASTINGS ST.  
 VANCOUVER 1, B.C.

PAYABLE AT PAR CALGARY

ACCOUNTS DUE WHEN RENDERED CUSTOMER'S ORDER NUMBER		SHIP VIA	DATE SHIPPED	AIRCRAFT	TRIP NO.
QUANTITY	PART NUMBER	DESCRIPTION		PRICE	AMOUNT
				CB-130	

PILOT: BOB MURPHY

TO: Charge for one Bell Super G helicopter as per ~~order~~ authorized  
 Daily Flight Report # 17546 attached

FLYING: MAY 30/70 3;55 hrs. @ \$125.00 per hour  
 (Fuel supplier by carrier) \$489.60

PLUS: Excess fuel charges out of Carmacks Y.T. 18.00

TOTAL INVOICE ..... \$507.60

PAYED IN FULL  
 R.D. 7/7  
 Thank You

16  
RENT CAR (from May 25 to May 30)  
=====

Total payment as the receipt attached;           \$168.61  
but this is for 10 days, from May 21 to May 30.  
6 days in 10 days (60%) is for this work,  
That is,                   \$168.61 x 60% =                   \$101.17

SHARE: 50% for NS(16 claims) Group, \$50.59  
25% for BF( 8 claims) Group, \$25.29  
25% for KL( 9 claims) Group, \$25.29  
-----  
Total                   \$101.17



**YUKON MOTORS LIMITED,**  
 BOX 993,  
 WHITEHORSE, Y. T.

ORIGINAL INVOICE NO. **C463060**  
 NO FACTURE ORIGINALE

(HEREINAFTER CALLED "LESSOR" (CI-APRÈS APPELÉE LOCATEUR))

TO: <b>MITSUBISHI MITSUBISHI</b>	UNIT NUMBER - NO DU VÉHICULE	CAR CHECKED IN AT (CITY) / LIEU DE RETOUR (VILLE)	DATE & TIME - DATE & HEURE
	OWNING CITY - VILLE PROP.	STATION	IN ARRIVÉE
À: <b>Room 404-900-10th Ave W. Whitehorse, Y.T.</b>	CAR MAKE - MARQUE	CAR RENTED AT (CITY) / AUTO LOUÉE À (VILLE)	DATE & TIME - DATE & HEURE
	<b>BUICK 70</b>	STATION	OUT DÉPART <b>MAY 21/70 5PM</b>
LICENSE NO. - PLAQUES	PROV.	CAR TO BE CHECKED IN AT / LIEU DE DESTINATION	STATION
<b>2619</b>	<b>Y.T.</b>	<b>Whitehorse</b>	DATE DAY MONTH YEAR

CHARGE CARD / CARTE DE CRÉDIT	1	2	3	4	5	OTHER:
	HTZ	DIN	AMEX	CB	ATC	

**THIS IS YOUR ORIGINAL INVOICE**  
**CECI EST VOTRE FACTURE ORIGINALE**

SETTLEMENT IS DUE UPON RECEIPT, AS NO STATEMENT WILL BE RENDERED

VEUILLEZ RÉGLER SUR RÉCEPTION DE CETTE FACTURE, AUCUN ÉTAT DE COMPTE NE VOUS SERA ENVOYÉ.

MILEAGE DETERMINED BY READING FACTORY INSTALLED ODOMETER	HOURS @ \$	
PARCOURS DÉTERMINÉ PAR LA LECTURE DE L'ODOMÈTRE POSÉ À L'USINE	4 DAYS @ \$ 1500	6000
MILEAGE IN LECTURE À L'ARRIVÉE <b>4844</b>	1 WEEKS @ \$ 7500	7500
MILEAGE OUT LECTURE AU DÉPART <b>4476</b>		
MILES DRIVEN PARCOURS EN MILLES <b>368</b>	MILES @ 16. ¢ PER MILE	5888
DEPOSIT - DÉPÔT	SUB SOUS - TOTAL	19388
\$	<b>Less 20%</b>	-3877
	SUB SOUS - TOTAL	15511

PLEASE RETURN INVOICE - STUB BELOW WITH YOUR PAYMENT TO INSURE PROPER CREDIT

VEUILLEZ RETOURNER CE TALON AVEC VOTRE REMISE AFIN QUE VOTRE COMPTE SOIT CRÉDITÉ

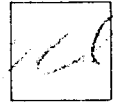

AUTHORISATION FOR COLLISION DAMAGE WAIVER  
 AUTORISATION POUR CLAUSE D'EXONÉRATION DE DOMMAGE PAR COLLISION

**THANK YOU - MERCI**

RENTED BY / LOUÉ PAR:

*[Signature]*

DETACH HERE / VEUILLEZ DÉTACHER ICI

**INVOICE - STUB FACTURE**

PLEASE DETACH AND RETURN THIS STUB WITH YOUR PAYMENT IN THE ENCLOSED ENVELOPE

VEUILLEZ DÉTACHER ET RETOURNER CE TALON AVEC VOTRE REMISE DANS L'ENVELOPPE CI-INCLUSE

TO: →  
 À

ORIGINAL INVOICE NO. / NO FACTURE ORIGINALE

**C463060**

SHOW INVOICE NO. ON ALL CORRESPONDENCE / MENTIONNER LE NO DE FACTURE DANS TOUTE CORRESPONDANCE

NET DUE → IN CANADIAN \$ / FRAIS NET → EN CANADIEN **168.61**

EXCHANGE RATE / TAUX DE CHANGE IN YOUR CURRENCY / MONNAIE ÉTRANGÈRE

REFUND RECEIVED BY / REMBOURSEMENT REÇU PAR (SIGNATURE)

COMPUTED BY - COMPILÉ PAR

PREPARED BY / PRÉPARÉ PAR CASH REFUND - REMBOURSEMENT COMPTANT / GAS · REP · GAZ POSTED - DRB - ENTRÉ / DAY / MONTH / MOIS

RENTER: PLEASE READ TERMS AND CONDITIONS ON PAGE 1 (REVERSE)  
 LOCATAIRE: VEUILLEZ LIRE LES CONDITIONS DE LA PAGE 1 (VERSO)

**4. INVOICE FACTURE**

HOTEL ROOMS at Carmacks (from May 25 to May 30)

1 person for 3 days, @\$10.00      \$30.00

6 person for 6 days, @\$ 5.00      \$180.00

---

Total      \$210.00

SHARE: 50% for NS(16 claims) Group, \$105.00  
25% for BF( 8 claims) Group, \$52.50  
25% for KL( 9 claims) Group, \$52.50

No. \_\_\_\_\_ May 29 1970  
Received from T. Kikuchi  
Thirty 100 Dollars  
3 days, @\$10.00  
\$ 30.00  
MADE IN B.C. Jay Wheeler  
Sunset Motel

No. \_\_\_\_\_ May 29 1970  
Received from R. Murphy (Pilot)  
Thirty 100 Dollars  
Room Rent  
6 days, @\$5.00  
\$ 30.00  
MADE IN B.C. Jay Wheeler  
Sunset Motel

No. \_\_\_\_\_ May 29  
Received from H. Mori  
— Thirty — 100  
Room Rent  
6 days, @\$5.00  
\$ 30.00 Joy Wheeler  
Sunset Motel  
MADE IN B.C.

No. \_\_\_\_\_ May 29  
Received from N. Sato  
— Thirty — 100  
6 days, @\$5.00  
\$ 30.00 Joy Wheeler  
Sunset Motel  
MADE IN B.C.

No. \_\_\_\_\_ May 29  
Received from B. K. Mansinghka  
— Thirty — 100  
6 days, @\$5.00  
\$ 30.00 Joy Wheeler  
Sunset Motel  
MADE IN B.C.

No. \_\_\_\_\_ May 29 1970  
Received from N. Grundy  
Thirty 100 Dollars  
Room Rent  
6 days, @\$5.00  
\$ 30.00 MADE IN B.C. Joy Wheeler  
Sunset Motel

No. \_\_\_\_\_ May 29 1970  
Received from Bill Lewis  
Thirty 100 Dollars  
Room Rent  
6 days, @\$5.00  
\$ 30.00 MADE IN B.C. Joy Wheeler  
Sunset Motel

2/

MEALS in Carmacks ( from May 24 to May 30 )

May 24; for 6 person	\$39.10
May 25; for 6 person	\$38.15
May 26; for 6 person	\$37.60
May 27; for 7 person	\$42.20
May 28; for 7 person	\$44.15
May 29; for 7 person	\$43.70
May 30; for 7 person	\$38.18
<hr/>	
Total	\$283.08

(6 person:- Sato, Mori, Mansinghka, lewis, Grundy and Murphy)  
(7 person:- Above 6 plus Kikuchi)

SHARE:- 50% for NS(16 claims) Group, \$141.54  
25% for BF( 8 claims) Group, \$70.77  
25% for KL( 9 claims) Group, \$70.77

I paid the amount \$283.08 for the company.

June 10 , 1970



Noritaka Sato, B.Sc.  
Geologist.

RECEIVED FROM	BILL TO
<p><i>Mitsubishi Metal Mining Co. Ltd.</i></p>	
AUTHORITY: <i>H. Mori</i>	

QUANTITY		DESCRIPTION	UNIT PRICE	AMOUNT
RECEIVED	ANALYZED			
	220	<i>total copper</i>	.90	198.00
	220	<i>soil sample preparation</i>	.20	44.00
				242.00
		<div style="border: 1px solid black; border-radius: 50%; padding: 10px; display: inline-block;">                     NS-CLAIMS.                 </div>	<i>Paid June 1/70</i> <i>DR.</i>	

DATE COMPLETED..... *5/14/70* .....

INITIALS..... *DR.* .....