

GEOCHEMICAL REPORT

CAB CLAIM GROUP

105-F-14

By:

J. M. BREMNER

ATLAS EXPLORATIONS LIMITED

November, 1969

This report has been examined by  
the Geological Evaluation Unit.  
Approved as to technical worth by:

*J. B. Craig*  
RESIDENT GEOLOGIST

Approved as to cost in the a. m. c. of:  
of: \$ ~~2349.00~~ 2349.00 *R. S. Redden*

*R. S. Redden*  
RESIDENT MINING ENGINEER

Accepted as representation work  
under Section 53(4) Yukon Quartz  
Mining Act.

*[Signature]*  
GEOLOGICAL EVALUATION UNIT  
YUKON TERRITORY

TABLE OF CONTENTS

LIST OF CLAIMS  
KEY MAP  
INTRODUCTION ..... 1  
LOCATION ..... 1  
REGIONAL GEOLOGY ..... 1  
TABLE OF FORMATIONS ..... 2  
LOCAL GEOLOGY ..... 2  
GEOCHEMISTRY ..... 2  
    (a) General Statement..... 2  
    (b) Grid Soil Sampling ..... 3  
    (c) Stream Silt Sampling..... 3  
CONCLUSIONS AND RECOMMENDATIONS..... 4

Table 2 - Proposed Drilling

Appendix I List of Personnel  
Appendix II Summary of Costs  
Appendix III Affidavit Supporting Summary of Costs  
Appendix IV Fig.3-Stream & Grid Tungsten Values (ppm WO<sub>3</sub>)  
                  Fig.4-Grid Soio Sample Results (ppm WO<sub>3</sub>)  
                  Fig.5-Stream Silt Sample Results (ppm WO<sub>3</sub>)  
Appendix V Fig.6-Plan of Proposed Drilling  
                  Fig.7-Drill Sections

LIST OF CLAIMS

<u>Claim No.</u>	<u>Grant Number</u>	<u>Date Recorded</u>
CAB 1-8	25386-25393	July 15, 1968
9-16	25394-25401	July 15, 1968
17-24	25506-25513	July 29, 1968
25-32	25514-25521	July 29, 1968
33-72	25822-25861	Aug. 30, 1968
73-104	25923-25954	Sept. 9, 1968
105-106	26151-26152	Sept. 23, 1968

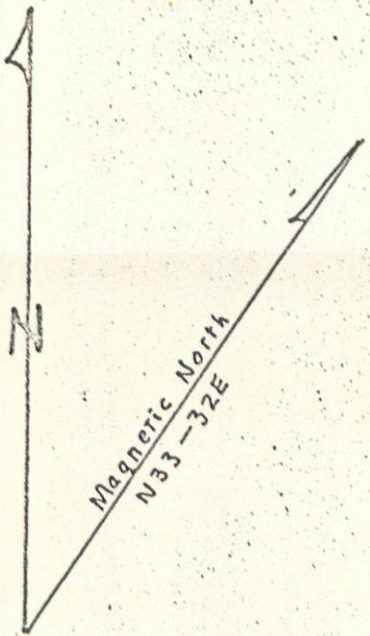

FOX MTN



105-F. 14  
CABLE GROUP

## ATLAS EXPLORATIONS LIMITED

330 MARINE BUILDING  
355 BURRARD STREET  
VANCOUVER 1, B.C.

### INTRODUCTION

Geochemical sampling of the Cab Group was undertaken during the last week of August, 1969, in order to define more precisely the best zones of mineralization.

Two creeks (Dolly and Varden Creeks) which drain the area and run parallel to No. 2 Showing were silt-sampled, and the west side of a grid established over this Showing was soil-sampled.

### LOCATION

The Cab Group is located 36 air miles southwest of Ross River, and is accessible only by air. Dolly Varden Lake, 1½ miles north of the property is suitable for landing float-equipped fixed-wing aircraft.

### REGIONAL GEOLOGY

The area comprises a uniform sequence of sedimentary rocks at least 1000 ft. thick of probable Lower Cambrian age, that have been uplifted to the west by a Cretaceous quartz-monzonite batholith.

The sedimentary unit consists of highly siliceous biotite and chlorite schists containing numerous thin interbedded limy bands. At or close to the intrusive contact, the sediments

have generally been metamorphosed to a pale brownish-green garnet-diopside skarn. No. 1 Showing and the southern part of No. 2 Showing are heavily gossaned.

The intrusive is medium to coarse-grained quartz-monzonite. It becomes progressively more foliated and leucocratic closer in toward the sedimentary contact.

#### TABLE OF FORMATIONS

##### MESOZOIC

CRETACEOUS - medium to coarse grained quartz-monzonite

##### PALEOZOIC

LOWER CAMBRIAN - quartz-biotite and quartz-chlorite schist, minor limestone and quartzite.

#### LOCAL GEOLOGY

No. 1 Showing occurs within a highly gossaned ridge which strikes northeastwards, and is surrounded on three sides by quartz-monzonite intrusive. The ridge has the form of a roof-pendant near the edge of the batholith.

No. 2 Showing outcrops sporadically along another ridge, which strikes northwestwards. The sediments have been little disturbed, and form the eastern flank of the batholith.

#### GEOCHEMISTRY

##### (a) General Statement

A sample frequency curve plotted for all samples containing 0 to 22 ppm  $WO_3$ , showed natural deflections at 5 and 10 ppm (Fig. 3). These values were then taken to represent background, threshold and anomalous values for the Cab Area.

Where ever possible, stream samples were collected from the active mid-stream silt, and soil samples were taken from the B-horizon when present.

All samples were analyzed by Chemex Labs Ltd., of Vancouver.

(b) Grid Soil Sampling

The north and south portions of the grid area exhibit anomalous  $WO_3$  values. The intervening central portion shows significantly lower values, except for a weak indication of mineralization at the base line.

The southern anomalous area shows slight improvement of values southwards, reflecting influence from discontinuous high-grade zones within a large gossan, located immediately south of the grid area. Mineralization here, is associated with skarn, and better grade material is usually found where the skarn has been gossaned.

The northern anomalous area corresponds to a thin, heavily gossaned, quartz-biotite schist horizon located 40 ft. above the intrusive contact. No skarn is present in this area.

The central portion of the grid area is poorly exposed. There appears to be relatively little gossaned skarn, albeit the skarn horizon itself is thick at crossline 0+00.

(c) Stream Silt Sampling

Dolly Creek, on the dip-slope side of No. 2 Showing ridge, produced negligible  $WO_3$  values.

Varden Creek, on the skarp-slope side shows a lengthy anomalous section which corresponds to the southern anomalous area indicated by grid soil sampling.

Single anomalous values above and below the junction of Varden Creek with another creek to the west, reflect the northern anomalous grid area, and an intrusive contact exposure in Varden Creek, respectively.

CONCLUSIONS AND RECOMMENDATIONS

Geochemical sampling has outlined two areas of interest on No. 2 Showing - at the north and south ends of the grid. This together with known mineralization on No. 1 Showing, make the property sufficiently interesting to warrant further examination of grade and tonnage.

A diamond-drill program involving a minimal number of set-ups is proposed. For No. 2 Showing, 14 holes totalling 3000 ft., drilled from 4 locations; and for No. 1 Showing, 6 holes totalling 2000 ft. from 2 locations, would be sufficient to establish preliminary figures on the extent of mineralization (See Figures 6 and 7, and Table 2).

Respectfully submitted,



J. M. Bremner

December, 1969



PROPOSED DRILLING

TABLE 2

No. 2 Showing

<u>Area</u>	<u>Set-up Location</u>	<u>Water Supply</u>	<u>Hole No.</u>	<u>Azimuth</u>	<u>Dip</u>	<u>Length (feet)</u>	<u>Total Length (feet)</u>
North Grid Area	20+00N/ 5+00W	Varden Creek	1	270°	72°	400	1,500
			2	218°	60°	300	
			3		90°	450	
			4	180°	46°	<u>350</u>	
South Grid Area	8+00S/ 1+00E	Varden Creek	5	270°	68°	400	1,600
			6	218°	66°	350	
			7		90°	450	
			8	180°	49°	<u>400</u>	
	16+00S/ 2+00E	Dolly Creek	9	218°	37°	250	500
			10		90°	<u>250</u>	
	24+00S/ 2+00E	Dolly Creek	11	270°	28°	350	1,400
			12	270°	71°	350	
13			218°	27°	350		
14			218°	71°	<u>350</u>		
							<u>5,000</u>

No. 1 Showing

Showing	28+30S/ 9+50W	Varden Creek	15	256°	47°	250	550
			16		90°	<u>300</u>	
Ridge	31+60S/ 16+40W	Varden Creek	17	332°	45°	500	2,450
			18	332°	67°	600	
			19	284°	47°	650	
			20	284°	65°	<u>700</u>	
							<u>3,000</u>

LIST OF PERSONNEL

J. M. Bremner	Geologist-Party Chief	Vancouver, B.C.
H. Atkinson	Sampler	Ross River, Y.T.

SUMMARY OF COSTS  
GEOCHEMICAL - CAB GROUP

A. GEOCHEMISTRY

Salaries & Wages	\$ 1,254.00
Field Expenses	66.00
Assays	306.00
Camp Operation	96.00
Freight & Transportation	<u>627.00</u>
 Total	 <u>\$ 2,349.00</u>

TELEPHONE 685-4331

**ATLAS EXPLORATIONS LIMITED**330 MARINE BUILDING  
355 BURRARD STREET  
VANCOUVER 1, B.C.AFFIDAVIT SUPPORTING SUMMARY OF COSTS

I, J. M. Bremner, Geologist, Atlas Explorations Limited, of Vancouver, British Columbia, do hereby state that, to the best of my knowledge and belief, the statement of costs as presented in this report "Geochemical Report - Cab Claim Group" Appendix II is both correct and true.

J. M. Bremner  
J. M. Bremner  
Dec 5/69  
Date

J. P. L.

A commissioner for Oaths  
in and for the Yukon Territory

CAB  
GRID

STREAM  
WO<sub>3</sub>

AND  
VALUES.

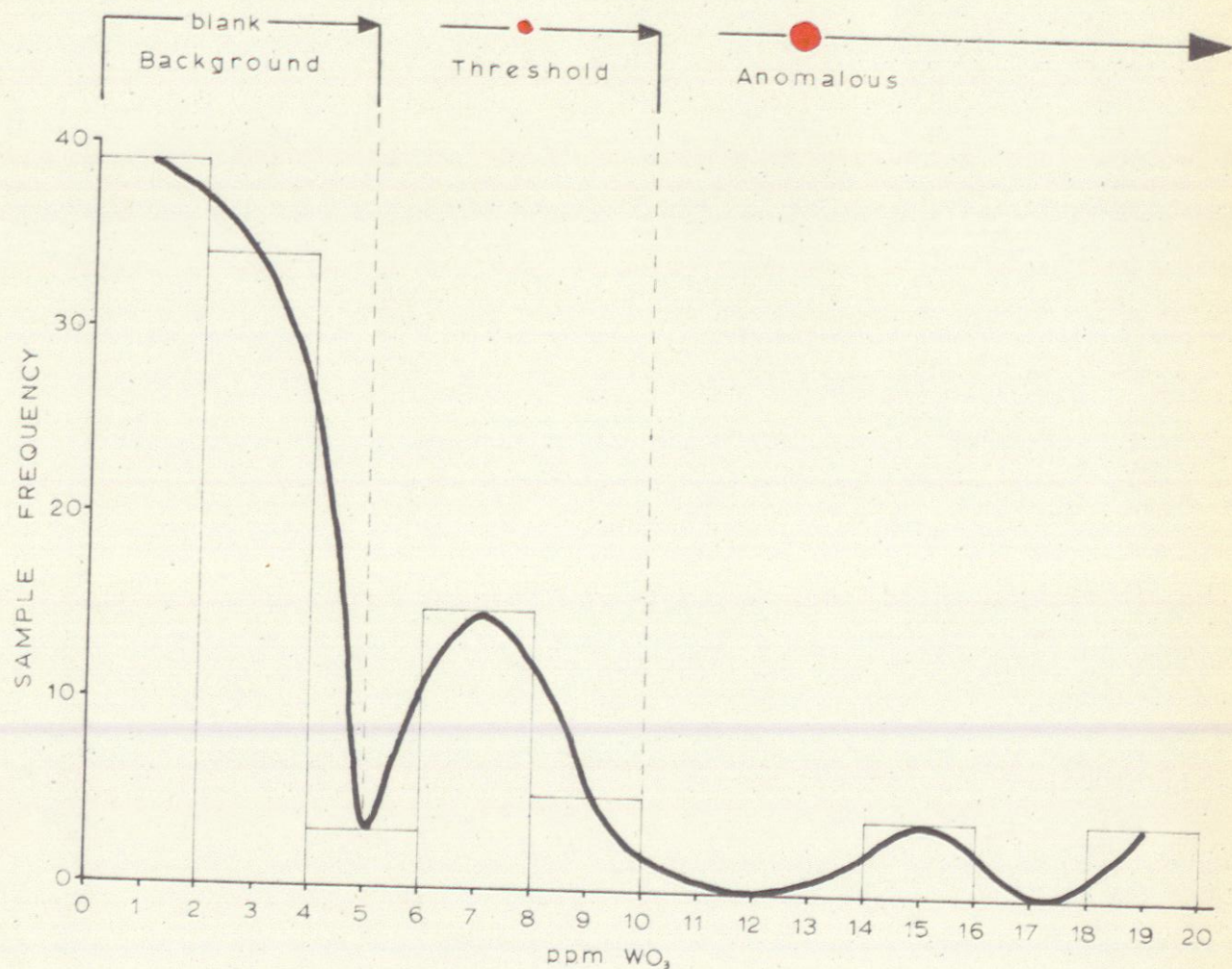

TOTAL NUMBER OF SAMPLES = 153

NUMBER OF SAMPLES > 20 ppm WO<sub>3</sub> = 49

FIGURE 3



ATLAS EXPLORATIONS LTD.  
ROSS RIVER, Y.T.

CAB GROUP  
STREAM SILT SAMPLE  
RESULTS (p.p.m.  $WO_3$ )

COMPILATION FROM:

AIR - PHOTOS A 12178-152, A 12186-225  
TOPO MAP - QUIET LAKE - N.T.S. 105 F

APPROX. SCALE:  $\frac{1}{4}$  mile = 1 inch

AUGUST 1969

J.M.B.

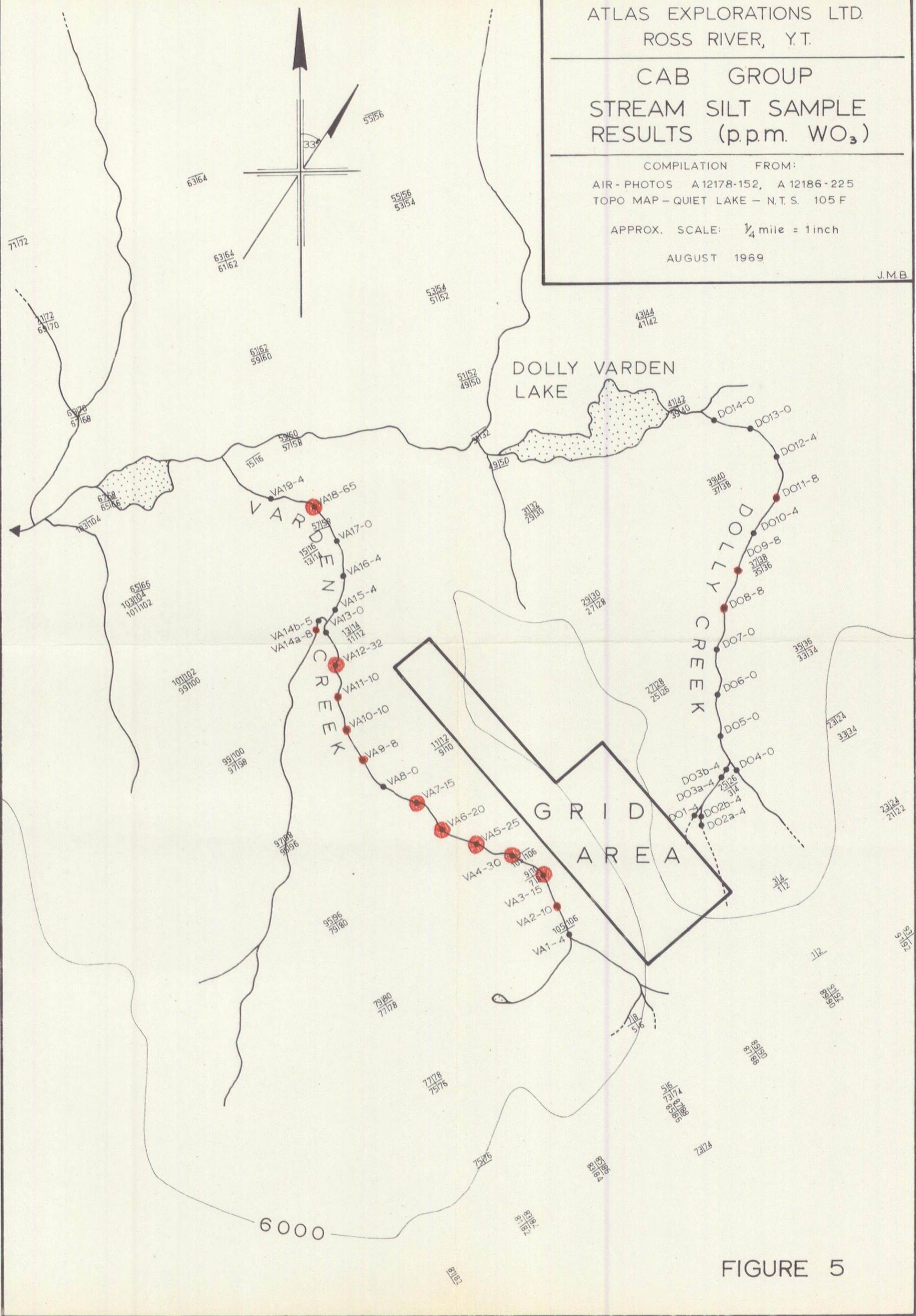
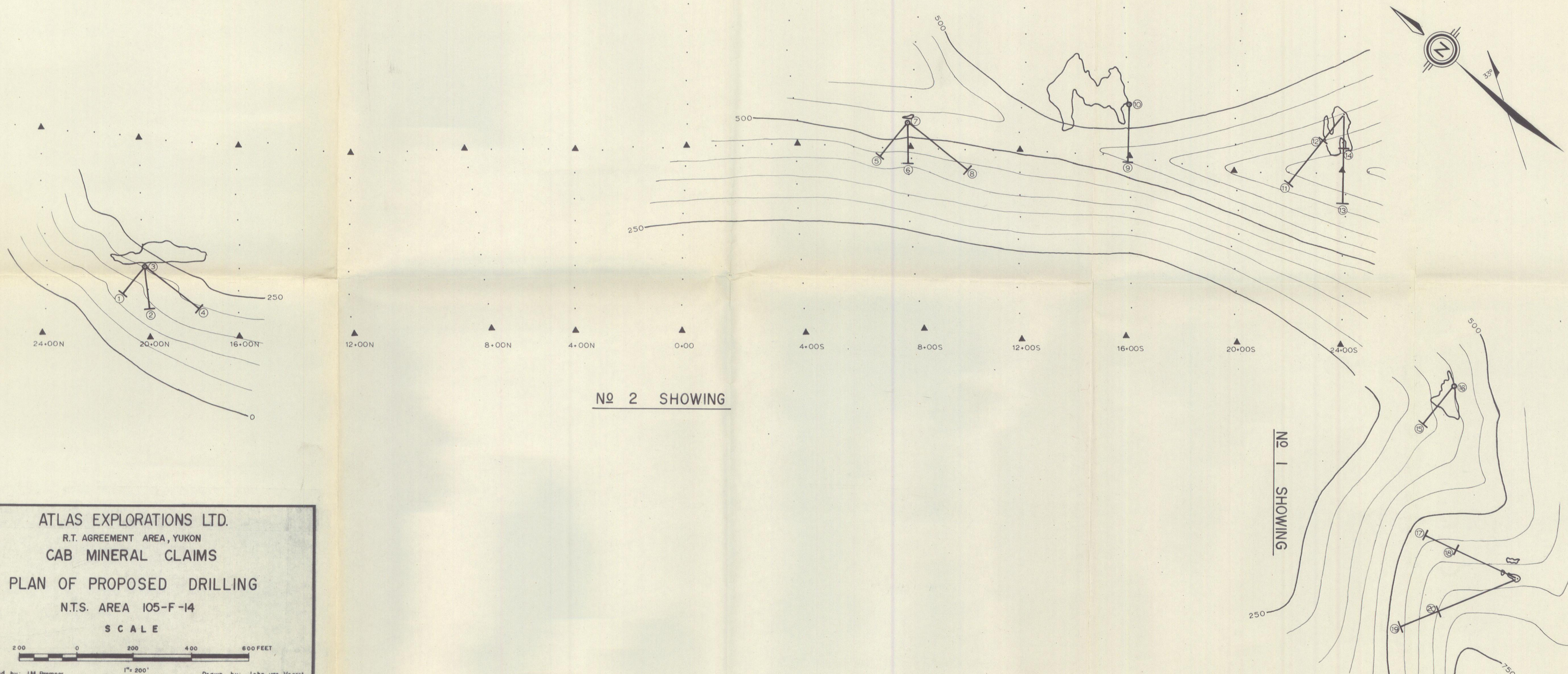

FIGURE 5

# FIGURE 6



No 2 SHOWING

No 1 SHOWING

ATLAS EXPLORATIONS LTD.  
R.T. AGREEMENT AREA, YUKON  
CAB MINERAL CLAIMS  
PLAN OF PROPOSED DRILLING  
N.T.S. AREA 105-F-14  
SCALE  
200 0 200 400 600 FEET  
Mapped by: J.M. Bremner 1" = 200' Drawn by: John van Voorst