

GEOCHEMICAL REPORT

on

TED CLAIM GROUP

(62°40'N, 133°45'W)

at

TEDDY CREEK, YUKON

for

ANVIL MINING CORPORATION LIMITED

REPORT BY:

M.O. Hampton, P. Eng.
Chief of Exploration for
ANVIL MINING CORPORATION LTD.

SAMPLED:

August 16-17, 1967



GEOCHEMICAL SURVEY
TED CLAIM GROUP

TABLE OF CONTENTS

	PAGE
KEY MAP	
INTRODUCTION	1
SURVEY TECHNIQUES	2
LABORATORY ANALYSIS	2
RESULTS & INTERPRETATION	3
CONCLUSIONS & RECOMMENDATIONS	3
 <u>APPENDIX I</u>	
(i) Statement of Costs	4
(ii) Personnel	5
(iii) Affidavit supporting Statement of Costs	6
 <u>APPENDIX II</u>	
Geochemical Results	MAP POCKET

TEDDY

MACK 26	MACK 24	MACK 22	MACK 20	MACK 18	MACK 33	MACK 35	MACK 37	MACK 39	MACK 41	MACK 43	MACK 45	MACK 47
97725	97723	97721	97719	97717	Y5568	Y5565	Y5567	Y5569	Y5571	Y5573	Y5575	Y5577
MACK 25	MACK 23	MACK 21	MACK 19	MACK 17	MACK 34	MACK 36	MACK 38	MACK 40	MACK 42	MACK 44	MACK 46	MACK 48
97724	97722	97720	97718	97716	Y5564	Y5566	Y5568	Y5570	Y5572	Y5574	Y5576	Y5578
MACK 10	MACK 8	MACK 6	MACK 4	MACK 2	TED 48	TED 46	TED 44	TED 42	TED 40	TED 38	TED 36	TED 34
97709	97707	97705	97703	97701	93082	93080	93078	93076	93074	93072	93070	93068
MACK 9	MACK 7	MACK 5	MACK 3	MACK 1	TED 47	TED 45	TED 43	TED 41	TED 39	TED 37	TED 35	TED 33
97708	97706	97704	97702	97700	93081	93079	93077	93075	93073	93071	93069	93067
JOE 12	PAT 8	PAT 6	PAT 4	PAT 2	TED 24	TED 22	TED 20	TED 18	TED 16	TED 14	TED 12	TED 10
97693	97691	97689	97687	97685	93058	93056	93054	93052	93050	93048	93046	93044
JOE 1	PAT 7	PAT 5	PAT 3	PAT 1	TED 23	TED 21	TED 19	TED 17	TED 15	TED 13	TED 11	TED 9
97692	97690	97688	97686	97684	93057	93055	93053	93051	93049	93047	93045	93043

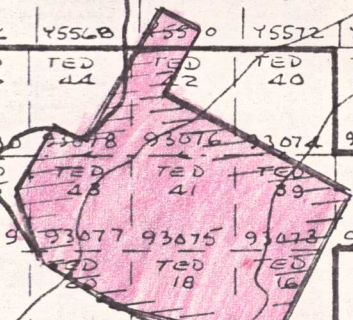

TED CLAIMS

GEOCHEMICAL SURVEY

OCTOBER 1967

105 K 10

132° 45'
62° 37' 30"

3500

3000

3000

3500

INTRODUCTION

A geochemical soil sample survey was carried out on mineral claims TED 16, 18, 20 and TED 39-44 inclusive during the period August 15-18, 1967. These claims are owned by Anvil Mining Corporation Limited. The work, except for the preparatory linecutting, was carried out by company personnel.

Linecutting was done by contract linecutters of White, Hosford and Impey Limited of Whitehorse. Invoices are being submitted with this report in support of linecutting costs.

Access to the property by all people involved with the survey was by helicopter. A Bell 47G 3B1 helicopter is under contract to Anvil Mining and based at Faro Camp, some thirty miles southwest of the TED mineral claim group.

The TED mineral claim group was staked on airborne magnetic and electromagnetic anomalies. The portion of the group worked on this summer was formerly covered by the JAKE group worked on in 1957 by Prospectors Airways Limited. Prospectors Airways' work included some packsack diamond drilling which reportedly found a limited amount of zinc mineralization. The object of the geochemical survey this season was to outline soil area having anomalously high copper, lead and/or zinc content for correlation with planned geophysical work in an attempt to establish a favourable drill target.

The property is underlain by rocks of Pre-Cambrian age (Hedrick & Green 1960) primarily cherts and greywackes. The general strike is N65W. Outcrop is limited in the area of this survey but work to the east suggested a southeasterly plunging synclinal structure.

SURVEY TECHNIQUES

A baseline was laid out with a transit and picket lines were turned off by transit at 400 foot intervals along the baseline. Stations were established at 100 foot intervals along the baseline. Soil samples were taken with mattocks at 100 foot intervals along the picket lines. Where possible the B horizon was sampled. However, if the organic soil layer was excessively thick, it was sampled and if the organic content was low enough, this material was analyzed in the laboratory. In general soil conditions were relatively poor and samples tended to have a relatively high organic content.

LABORATORY ANALYSIS

Test methods used involved a hot aqua regia extraction of heavy metal ions from the soil sample, followed by reaction with dithizone or biquinoline to give colored products. The colored reaction products were then compared to a series of colored solutions representing known metal content, to determine the metal content of the soil sample.

Separate and specific tests for each of the three metals, copper, lead and zinc were carried out on each soil sample.

RESULTS AND INTERPRETATION

Of the three metals analyzed for, only copper values above 50 parts per million and zinc values above 100 parts per million might be considered anomalous. Such sample locations are indicated by colors on the enclosed map. Lead is noticeably lacking in the soil from this area except for one erratic high on line 8+00E 11+00N.

The values obtained were plotted on a 1" = 400' plan but the lack of continuity of anomalous samples prevents any meaningful contouring of the results. The group of high values on line 0+00 and the group at the northerly end of line 8+00E could be caused by concentration in boggy terrain.

CONCLUSIONS AND RECOMMENDATIONS

Geochemical analysis of soil samples taken from the TED claim group during the 1967 season failed to indicate any potentially promising drill target. If the interpretation of the subsequent Induced Polarization survey fails to outline an attractive target, no further work should be done on this property.

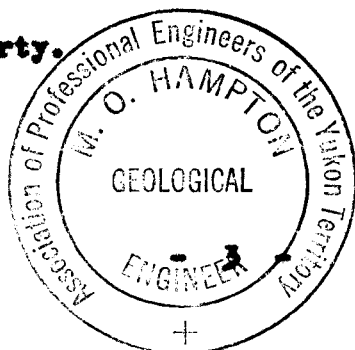

M. O. Hampton
M.O. Hampton, P. Eng.
Chief of Exploration for
ANVIL MINING CORPORATION LTD.

APPENDIX I (1)

STATEMENT OF COSTS

1967 Geochemical Survey TFD Group

(A) Linecutting - Contract: White, Mosford & Incey Ltd.

Invoices submitted	\$ 741.00	
Helicopter - July 26, 28, & 30		
8 hr 05 min @ \$110.00/hr	<u>\$ 889.16</u>	\$ 1630.16

(B) Soil Sampling (256 Samples)

Wages	9 man days @ \$16	\$ 144.00	
Maintenance	9 man days @ \$10	90.00	
Helicopter Aug 15 & 18			
5 hr 45 min			
@ \$110.00/hr		<u>632.90</u>	\$ 866.90

(C) Laboratory Analysis (229 Samples)

229 samples @ \$1.66 =	\$ 380.14	\$ 380.14
------------------------	-----------	-----------

(D) Compilation of Report

Draughting, typing, clerical and printing	\$ 75.00	
Writing	<u>45.00</u>	\$ 120.00

(E) Supervision

M.O. Hampton	1 day @ \$45	\$ 45.00	
D. Mayes	2 days @ \$35	<u>70.00</u>	\$ 115.00

\$ 3111.80

12/10/67

APPENDIX I (ii)

PERSONNEL

(A) Linecutters (White Hosford & Impey)

P. Rashley		Box 1888, Whitehorse, Y.T.
E. Johnson		Box 1888, Whitehorse, Y.T.
S. Johnson		Box 1888, Whitehorse, Y.T.
J. Jackson		Box 1888, Whitehorse, Y.T.
J. Kodwat		Box 1888, Whitehorse, Y.T.

(B) Soil Sampling

G. Macdonald	Soil Sampler	Box 2470, Whitehorse, Y.T.
L. Schmuck	Soil Sampler	Box 2470, Whitehorse, Y.T.
W. Vanderpoll	Soil Sampler	Box 2470, Whitehorse, Y.T.

(C) Laboratory Analysis

L. Olsen	Lab Technician	Box 2470, Whitehorse, Y.T.
M. Knapp	Lab Technician	Box 2470, Whitehorse, Y.T.
G. Paterson	Sample Preparation	Box 2470, Whitehorse, Y.T.
W. Rundle	Lab Assistant	Box 2470, Whitehorse, Y.T.

(D) Compilation of Report

D. Hanson	Draughting	Box 2470, Whitehorse, Y.T.
M. Hampton	Chief of Exploration	Box 2470, Whitehorse, Y.T.

(E) Supervision

M.O. Hampton	Chief of Exploration	Box 2470, Whitehorse, Y.T.
D. Mayes	Geologist	Box 2470, Whitehorse, Y.T.

APPENDIX I (111)

A F F I D A V I T

SUPPORTING STATEMENT OF COSTS
Geochemical Survey
August 15 - 19, 1967

I, Murray O. Hampton, Chief of Exploration for ANVIL MINING CORPORATION LIMITED, have compiled the Statement of Costs as presented in this report "Geochemical Report TED Claim Group", DO MAKE OATH AND SAY AS FOLLOWS:

That to the best of my knowledge and belief, the Statement of Costs as presented is a true and an accurate presentation of expenditures to be applied as representation work on the TED 15-24 inclusive, TED 37, TED 39-48 inclusive mineral claims.



Murray O. Hampton, B.A.Sc., P. Eng.
Chief of Exploration for
ANVIL MINING CORPORATION LIMITED

Sworn before me this OCT 27 1967 day of.....1967,
in the City of Whitehorse in the Yukon Territory.

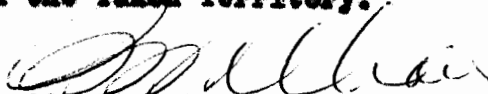

.....
A Commissioner for taking oaths in
and for the Territory of Yukon.

Third Ave.

White, Hosford & Impey Limited

LEGAL SURVEYS :: ENGINEERING

Whitehorse, Yukon

Paul S. White, P. Eng., A.L.S., D.L.S.
A. Denis Hosford, A.L.S., B.C.L.S.
Hugh E. Impey, A.L.S., S.L.S., M.L.S., D.L.S.

28 August 1967

LINE CUTTING

STATEMENT OF ACCOUNT

WITH: ANVIL MINING CORPORATION LTD.,
BOX 2470
WHITEHORSE YT

PAID SEP - 6 1967

TO:

A) Rectifying our Invoice of 22 July 1967.

46.26 Line Miles Picket Line @\$100.00	\$4626.00	
5.8 miles Base Line @\$250.00	1450.00	
	<u>6076.00</u>	
Less payment on Original Invoice	6057.00	
ADDITIONAL THIS INVOICE		\$ 19.00

→ B) TED GROUP

0.76 Miles Base Line @\$250.00	190.00	
29,100 feet-5.51 miles Picket Line @\$100.00	551.00	741.00
		<u>741.00</u>

C) RAM GROUP

14,800 feet base line-2.80 miles @\$250.00	700.00	
60,000 feet Picket line-11.36 miles @\$100.00	1136.00	1836.00
		<u>1836.00</u>

TOTAL AMOUNT THIS INVOICE \$2596.00

P. O. NUMBER.....	
PRICE CHECKED.....	
QUANTITY CHECKED.....	
COMPUTATIONS CHECKED.....	
ACCOUNT NUMBER.....	3M 1088
CHECK NUMBER.....	2-11-19
APPROVED FOR PAYMENT.....	<i>[Signature]</i>



LEGEND
 Cu/Pb/Zn ppm
 ● Cu > 50 ppm
 ○ Zn > 100 ppm

ANVIL MINING CORPORATION	
WEST TED GEOCHEMISTRY	
SCALE 1" = 400'	DATE: AUGUST 25, 1967
SAMPLES TAKEN: 256	SAMPLES ANALYZED: 229
DATE SAMPLED: AUGUST 16-17, 1967	
SAMPLED BY: MACDONALD, SCHMUCK, VAN DER POLL.	
ANALYZED BY: OLSEN, KNAPP.	
DRAWN BY: DJH	CFB-19