

G E O P H Y S I C A L R E P O R T
R O S E C R E E K G R O U P

C O N T E N T S

	Page
I N T R O D U C T I O N	1
P R O P E R T Y & S I T U A T I O N	1
T O P O G R A P H Y	2
C O M M U N I C A T I O N S	2
G E O L O G Y	2
M A G N E T O M E T E R S U R V E Y	2
C O N C L U S I O N	3
R E C O M M E N D A T I O N	3
A F F I D A V I T	4
M A P O F M A G N E T O M E T E R S U R V E Y	
V A N G O R D A O R E B O D Y * M A G N E T I C A N O M A L Y P L A N	
C L A I M M A P W I T H G E O L O G Y	

1st November 1964

DR. A. C. SKERL
A.R.S.M., PH.D., P.ENG.
CONSULTING MINING GEOLOGIST

1758 WESTERN PARKWAY
VANCOUVER 8, B.C.

DICKSON-YUKON SYNDICATE
ROSE CREEK GROUP
GEOPHYSICAL SURVEY
PELLY RIVER AREA
YUKON TERRITORY

INTRODUCTION

At intervals during the period from 23rd of June to 5th of October 1964 the writers - A. C. Skerl and L. Ostensoe - carried out geological, geochemical and geophysical exploration in the valley of Rose Creek. Here the Dickson-Yukon Syndicate had a large group of claims of which 50 are being retained as shown on the accompanying map (1" to 1000').

PROPERTY AND SITUATION

The strip of fifty claims extends northwesterly down the valley of Rose Creek for eight miles. The southeast end adjoins the Vangorda property.

The claim names are as follows :

Tie Nos 1 to 24

Joe Nos 2, 4, 6, 8, 10, 12, 14, 16, 17, 18

Bill Nos 16, 17, 18, 20, 22, 24, 26, 28, 30, 32, 33, 34, 35, 36, 37, 38

They appear on claim sheet No 105 K - 6, lat. $62^{\circ} 15'$, long. $133^{\circ} 30'$.

The claims are in the name of Gordon Dickson of Whitehorse and the current season's work has been done by the Dickson - Yukon Syndicate with Lief Ostensoe as field engineer and A. C. Skerl as geological consultant.

TOPOGRAPHY

Within the claim area the elevation ranges from 3500 to 4500 feet but to the north the side of the Rose Creek valley goes up to 6000 feet.

The valley sides, particularly the south, are characterised by bluffs and dip slopes that have been carved by ice action.

COMMUNICATIONS

The area is remote from any highway and access is gained by aircraft either to Shrimp Lake or to the rough landing strip at Vangorda. It is then one day's journey on foot to camp sites at the northwest end of the claims. To save time and transportation costs a helicopter was employed on several occasions.

GEOLOGY

The general geology of the area is shown on the Tay River Sheet of the Canadian Geological Survey.

A companion geological report for assessment purposes describes the rock types, possible mineralization, etc.

MAGNETOMETER SURVEY

The ore body at Vangorda gives a distinct magnetic anomaly as shown on the accompanying plan (scale 1" to 100'). It was therefore decided to explore the likely areas of the Rose Creek claims with a fluxgate type of magnetometer (M F 1) that was rented from Sharpe Instruments Co. It was set for a background of 1000 γ at the camp site on claim L.O. 11.

The results have been plotted on the accompanying map (scale 1" to 400').

Two magnetic anomalies previously reported by A. Allan (1955) in the Rose Creek area were checked. The first is 3000 feet southwest of Hill 22 claim and a range of 500 γ for a length of 200 feet was found. Some outcrops of graphitic argillite near the centre of the anomaly gave readings of 2000 γ above background. Finely disseminated magnetite in the argillite was the cause of the anomaly.

30' Sensitive
40' Schist

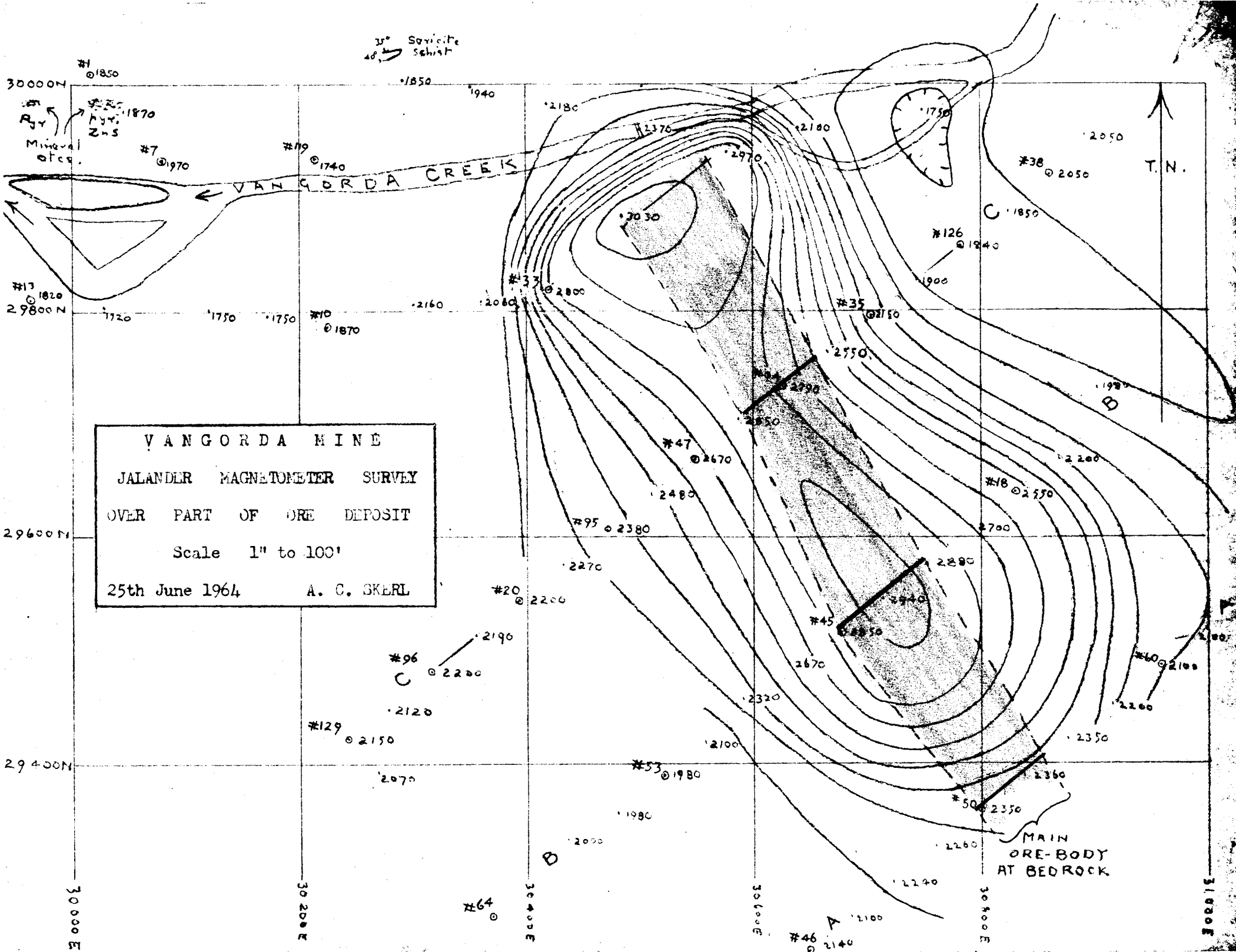

VANGORDA MINE
JALANDER MAGNETOMETER SURVEY
OVER PART OF ORE DEPOSIT
Scale 1" to 100'
25th June 1964 A. C. SKERL

MAIN
ORE-BODY
AT BEDROCK

VANGORDA CREEK

Mineral
ofcs.

T.N.

Nothing significant was found at the supposed position of the second anomaly at 3000 feet to the northwest of the first.

Reconnaissance in the area across the Rose River to the northeast of these two places found interesting readings in the Bill 24 claim so after staking the L.O. group of claims a series of lines were run with tape and compass for 30,000 feet, as shown on the accompanying map. Magnetometer readings were then taken every 100 feet.

Nothing else of note was found, the variation between readings at 100 feet apart rarely being more than 50 γ.

A grid of lines at 100 ft spacing showed that the original finding in the Bill 24 claim was limited to a length of 250 feet and nothing was found on the ground to account for it.

C O N C L U S I O N

The results of the magnetometer survey so far have been disappointing but it should be continued.

The next area that should be investigated in detail is the southeast end of the claims where a continuation of the geological conditions on the Firth zone might be expected.

R E C O M M E N D A T I O N

Make a detailed magnetometer survey of the claims at the southeast end of the group.

A F F I D A V I T

I hereby certify that the proportion of expenses for the Rose Creek investigations in 1964 allocated to the geophysical work were as follows :

Air Transportation	300.00
Salary L. Ostensoe	300.00
Consulting fees A. C. Skerl	200.00
Wages T. Lowery	200.00
Camp equipment	50.00
Supplies	100.00
Magnetometer rental	250.00
Misc. (radio rental etc.)	200.00
	<hr/>
Total	\$ 1,600.00

The addresses of those employed on the work are

Dr. A. C. Skerl, 1758 Western Parkway, Vancouver 8, B. C.

Mr. Leif Ostensoe, 5597 Toronto Road, Vancouver 8, B. C.

Mr. T. Lowery, c/o Mr. K. Macracken, 4429 Angus Drive, Vancouver, B. C.



ROSE CREEK GROUP
 GEOLOGICAL MAP
 SCALE 1" to 1000'
 By A. C. SKERL, P. ENG.
 LEIF OSTENSOE
 NOVEMBER 1964

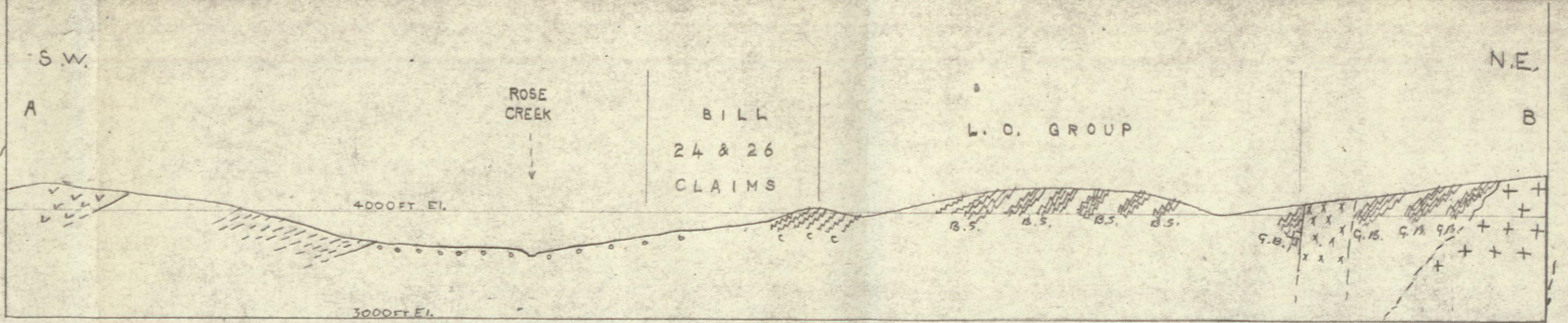

LEGEND

QUATERNARY & RECENT	□ - □ - □	GLACIAL & ALLUVIAL
CRETACEOUS	XXXX	FELDSPAR PORPHYRY GRANITE
PALAEOZOIC	V V V	GREENSTONE & CHLORITE SCHIST
	---	BLACK ARCILLITE
		SERICITE SCHIST
		GARNET BIOTITE SCHIST
		CARBONATE SCHIST

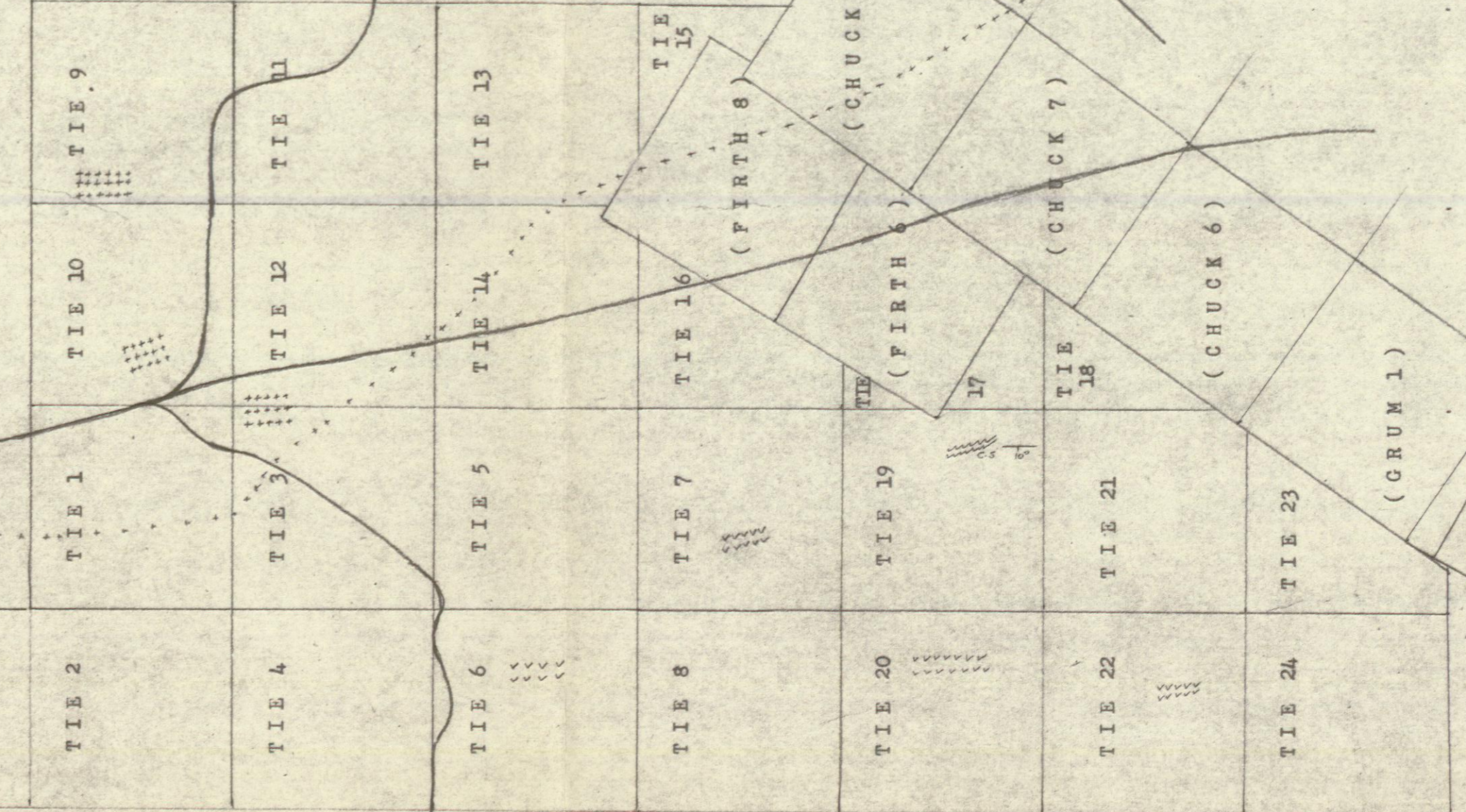

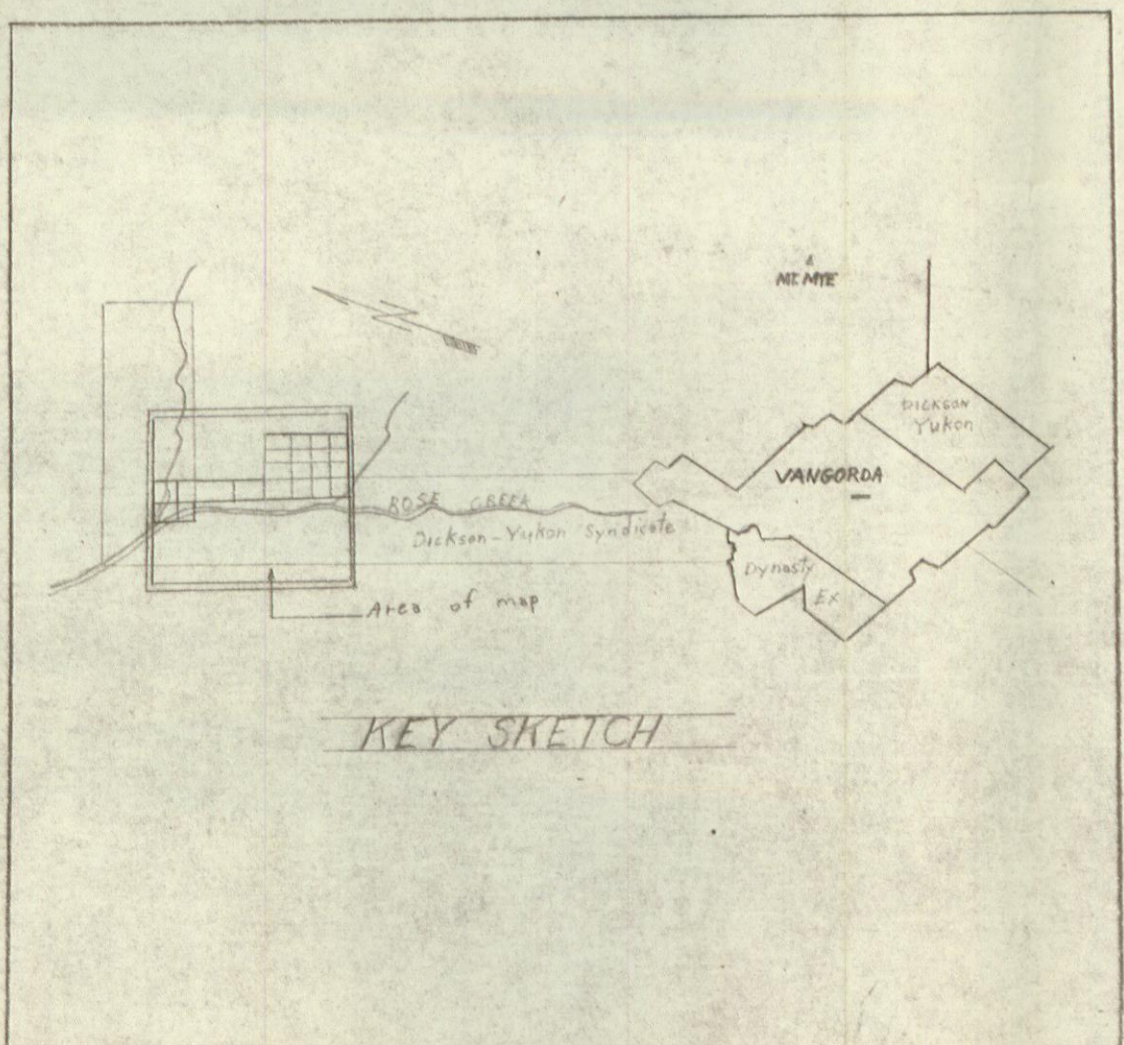

1100	1100	1100	1100	1100	1100	1100	1100	1100	1100
1110	1110	1110	1110	1110	1110	1110	1110	1110	1110
1120	1120	1120	1120	1120	1120	1120	1120	1120	1120
1130	1130	1130	1130	1130	1130	1130	1130	1130	1130
1140	1140	1140	1140	1140	1140	1140	1140	1140	1140
1150	1150	1150	1150	1150	1150	1150	1150	1150	1150
1160	1160	1160	1160	1160	1160	1160	1160	1160	1160
1170	1170	1170	1170	1170	1170	1170	1170	1170	1170
1180	1180	1180	1180	1180	1180	1180	1180	1180	1180
1190	1190	1190	1190	1190	1190	1190	1190	1190	1190
1200	1200	1200	1200	1200	1200	1200	1200	1200	1200
1210	1210	1210	1210	1210	1210	1210	1210	1210	1210
1220	1220	1220	1220	1220	1220	1220	1220	1220	1220
1230	1230	1230	1230	1230	1230	1230	1230	1230	1230
1240	1240	1240	1240	1240	1240	1240	1240	1240	1240
1250	1250	1250	1250	1250	1250	1250	1250	1250	1250
1260	1260	1260	1260	1260	1260	1260	1260	1260	1260
1270	1270	1270	1270	1270	1270	1270	1270	1270	1270
1280	1280	1280	1280	1280	1280	1280	1280	1280	1280
1290	1290	1290	1290	1290	1290	1290	1290	1290	1290
1300	1300	1300	1300	1300	1300	1300	1300	1300	1300
1310	1310	1310	1310	1310	1310	1310	1310	1310	1310
1320	1320	1320	1320	1320	1320	1320	1320	1320	1320
1330	1330	1330	1330	1330	1330	1330	1330	1330	1330
1340	1340	1340	1340	1340	1340	1340	1340	1340	1340
1350	1350	1350	1350	1350	1350	1350	1350	1350	1350
1360	1360	1360	1360	1360	1360	1360	1360	1360	1360
1370	1370	1370	1370	1370	1370	1370	1370	1370	1370
1380	1380	1380	1380	1380	1380	1380	1380	1380	1380
1390	1390	1390	1390	1390	1390	1390	1390	1390	1390
1400	1400	1400	1400	1400	1400	1400	1400	1400	1400

DICKSON - YUKON SYN
 ROSE CREEK AREA
 MAGNETOMETER RESULTS

Reading Relative To 1000 Gammas

1 inch = 400 FT

JUNE-OCT 1964

Dr AC Short R Eng
 L. Costanza