

SPARTAN EXPLORATIONS LTD. (N.P.L.),
303-1035 West Pender Street,
Vancouver 1, B. C.

1968 PROGRESS REPORT

AND

PROPOSED PROGRAM 1969

FORTIN PROJECT,

YUKON TERRITORY

BY

Clyde L. Smith,
Exploration Manager.

OCTOBER 29th ,1968

TABLE OF CONTENTS

Page No.

FORTIN PROJECT

Introduction	
PAL (NORTH) GROUP	2
Geology	
Geochemistry	
PAL (SOUTH) GROUP	3
Geology	
SUN GROUP	3
Geology	
Geochemistry	
PROPOSED WORK	4
LIST OF ILLUSTRATIONS	5



FORTIN PROJECTINTRODUCTION

During the 1967 field season Spartan Explorations Ltd. became interested in the exploration potential of the Fortin Lake region, situated about 70 miles east of Ross River, Yukon Territory. At that time, Atlas Explorations Ltd. was conducting detailed work on a zinc property east of Fortin Lake. It became apparent to Spartan that zinc mineralization occurs in a distinctive sequence of dolomitic argillites and quartzites of probable Ordovician or Silurian age, near an elongate, Cretaceous(?) granitic intrusive, in a region of intersecting major faults. During September and early October, 1967, a total of 156 claims was staked by Spartan personnel, on the northwest and southeast sides of Atlas' Pay group. This staking was done in order to benefit from any extensions of the mineralized zone, as it was then known.

In 1968, geochemical surveys were conducted on the PAL claims located northwest of the Atlas group. In addition, a program of reconnaissance geologic mapping and soil sampling was conducted over a broad area west of Fortin Lake. Reconnaissance mapping showed the existence of favourable host formations in two broad east-west trending bands west of Fortin Lake. Where exposed, the formations were carefully prospected for mineralization and reconnaissance geochemical soil surveys were conducted over the entire extent of the formation. Prospecting was successful in locating only minor occurrences of zinc, but one area of anomalous zinc geochemical values was located and staked as the SUN group.

PAL(NORTH) GROUP

The PAL(NORTH) group of 1-32 claims was staked by Spartan personnel and transferred to the company, with a recording date of September 18th, 1967. Because of complications in staking, the first 16 claims of the PAL(NORTH) group are believed located over previously held claims, so that only the PAL 17-32 have received work by Spartan. Assessment work has recently been completed on the above sixteen claims, and they will be held for at least one more year. The PAL 157-172 were staked adjoining the 1-32 block, recorded and transferred to the company on January 3rd, 1968. These claims will be maintained in good standing through payment in lieu of work for one more year.

Geology

Reconnaissance geologic mapping indicates that the favourable dolomitic argillites and quartzites, which contain low grade zinc mineralization on the Pay claims to the southeast, extend to the northwest into the area of the PAL (NORTH) claims. It is further believed that one of the major controls upon mineralization in the Fortin Lake area is an intersection of regional faults, which occurs near the north end of Fortin Lake and immediately northwest of the PAL(NORTH) claims. This intersection occurs between regional faults which trend north-south and trend northeast, and it is notable that similar intersections, in the eastern Yukon, appear to be related to lead-zinc mineralization.

Geochemistry

The entire area of the PAL(NORTH) claims was recently covered by reconnaissance geochemical soil sampling, and results of the soil samples are currently awaited.

PAL(SOUTH) GROUP

PAL(SOUTH) 33-121 and 123-156 were staked by Spartan personnel and transferred to the company, with a recording date of October 6th, 1967. It is now believed that the claims cover an area of little potential, and the claims will be allowed to lapse.

Geology

Reconnaissance geologic observations on the PAL(SOUTH) claims suggest that most of the claims area is underlain by Middle-Upper Cambrian phyllites. The possibility of dolomitic argillites and quartzites, which are the host rocks on the Pay area, occurring on the PAL(SOUTH) claims is limited. Because of demands on personnel in other project areas during the 1968 season, it was not possible to conduct geochemical work on these claims and the ground will be allowed to lapse.

SUN GROUP

The SUN group of twenty-four claims were staked by Spartan personnel and transferred to the company, with a recording date of July 16th, 1968. The claims cover an area of anomalous zinc geochemistry in a favourable geologic environment and will be held for further evaluation during the 1969 season.

Geology

The SUN claims cover an area of limited outcrop, within which platy dolomites and massive argillites, similar to the host sequence in the Pay area, are exposed. Prospecting of these rocks has disclosed minor amounts of pyrite and, possibly, sphalerite, but no significant mineralization has been found to date.

SUN Group (continued)....Geochemistry

Reconnaissance geochemical soil sampling over the claims area was successful in locating several anomalous values along a trend of about 5,000 feet in length, which bears a general correspondence with the strike of the rock units in the area. Geochemical values in zinc are considered highly anomalous and, in a few locations, are associated also with anomalous lead values. Rock exposures in the area are rare, and it has not been possible, as of this date, to explain the anomalous geochemical values by prospecting.

PROPOSED WORK

It is proposed that a two-man crew conduct detailed geochemical soil sampling and prospecting in the area of previously located anomalous geochemical results on the SUN group during the 1969 season.

The following is a summary of costs for the two-man program working for two weeks on the SUN claims:

1. Transportation	\$ 500.00
2. Personnel	1,500.00
3. Services-Purchases	600.00
4. Contingencies	400.00
	<hr/>
TOTAL	<u>\$3,000.00</u>

Respectfully submitted,

Clyde L. Smith,
Exploration Manager

LIST OF ILLUSTRATIONS
(Enclosed in Pockets)

FORTIN PROJECT

Figure 1F - Western Region of Fortin Lake Geology Map.

Figure 2F - Location Map of Claims and Mineral Showings of Pal Group.

Figure 3F - Location Map of Sun Group.

Figure 4F,
5F & 6F - Geochemical Soil Survey Maps for Region West of Fortin Lake.

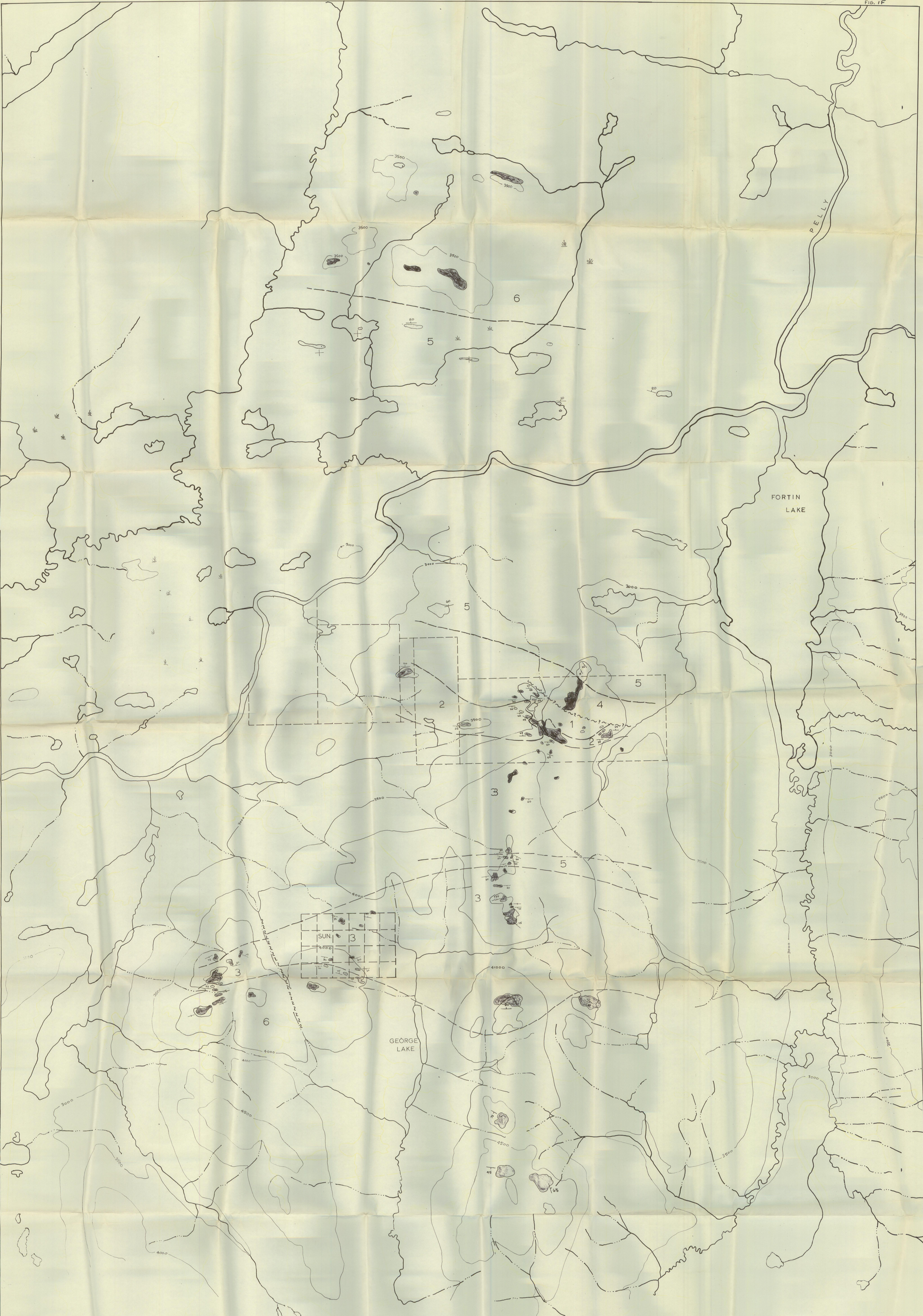

LEGEND

- 6 Very fine to medium sandstone with abundant small rounded quartz pebbles and thin layers of a fine grained matrix.
 - 5 Dark grey sandstone, medium to coarse grained with some areas with coarse shaly part a sandstone with fine grey weathered surface.
 - 4 Very coarse to fine grained, light grey sandstone with large pebbles of white quartzite.
 - 3 Medium to coarse grey fine grained with interbeds of mud shale, siltstone, and clay shale.
 - 2 Medium to coarse grey fine grained with thin clay shales and siltstone with abundant quartz - dolomite (quartz) pebbles and pebbles of quartz.
 - 1 Medium to coarse grey fine grained with detrital and siltstone, shales.
- - Borehole.
 - — — — — Geological Contact.
 - ~ ~ ~ ~ ~ Fault, defined, assumed.
 - — — — — Claim Boundary, Geological Grid Boundary.
 - — — — — Limit of Outcrop.

SPARTAN EXPLORATIONS LTD.
 ROSS RIVER YUKON
 FORTIN PROJECT
 GEOLOGY MAP

GEOLOGY : G. JAMES, W. ROBERTS, C. L. SMITH, DRAWN BY : W. ROBERTS.
 DATE : JULY 13, 1968.

Scale in feet.

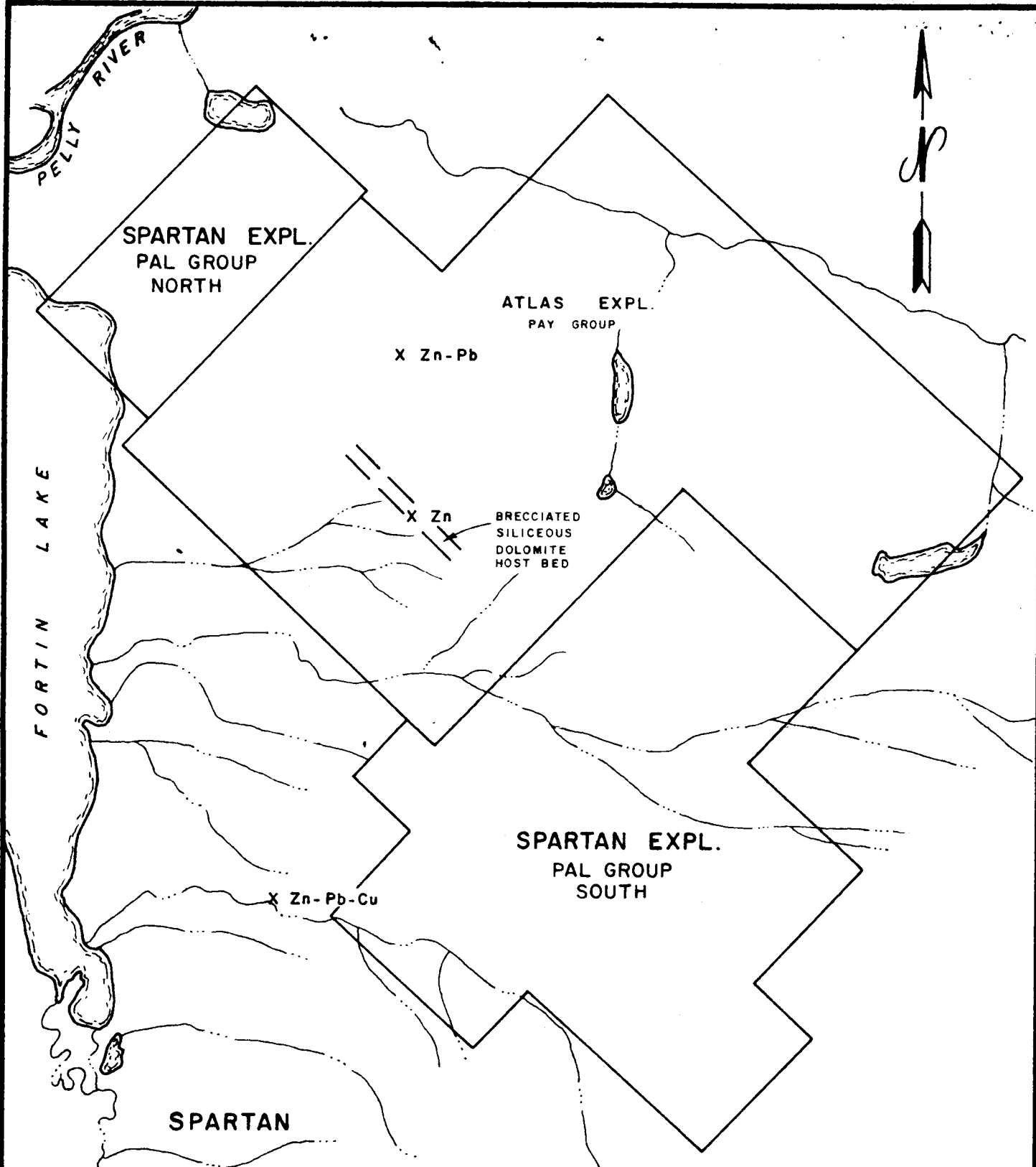

SPARTAN EXPLORATIONS LTD. (N.P.L.)

FORTIN LAKE AREA YUKON TERRITORY

**CLAIM & MINERAL SHOWING MAP
PAL MINERAL CLAIM GROUP**

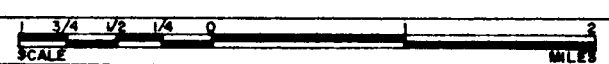

DATE :

BY :

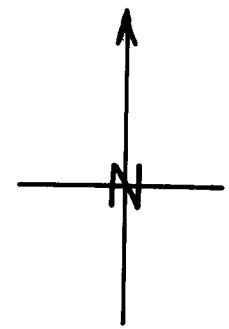
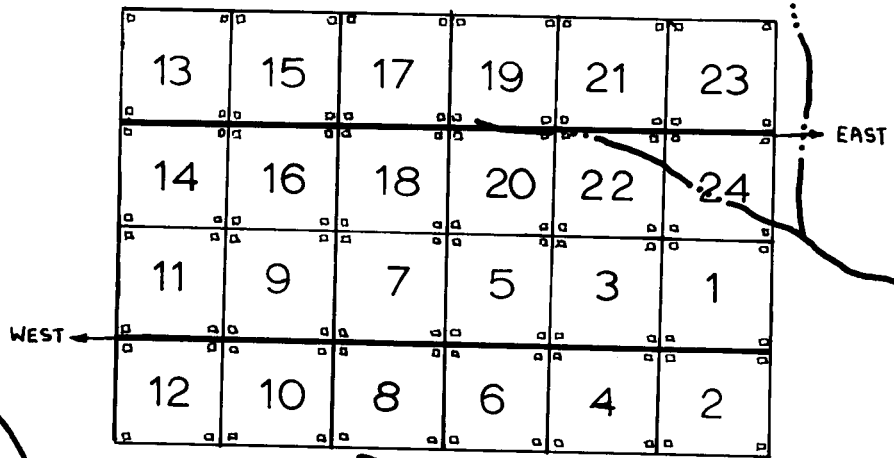

DATE STAKED : JUNE 23, 1968.
 SUN. 1-8, L. JOHNNY.
 SUN. 9-16, C. SMITH.
 SUN. 17-24, C. OLLIE.

8.3 Miles on bearing 061°T to south end of Fortin Lake.

LAKE GEORGE

SPARTAN EXPLORATIONS LTD.
 ROSS RIVER YUKON
 SUN GROUP CLAIMS MAP.

10.1 Miles on bearing 170°T to north end of Finlayson Lake.

STAKED BY : L. JOHNNY, C. OLLIE,
 C. SMITH.

DRAWN BY : N. H. SIMMONS.
 DATE : JUNE 28, 1968.



Scale in feet.

N

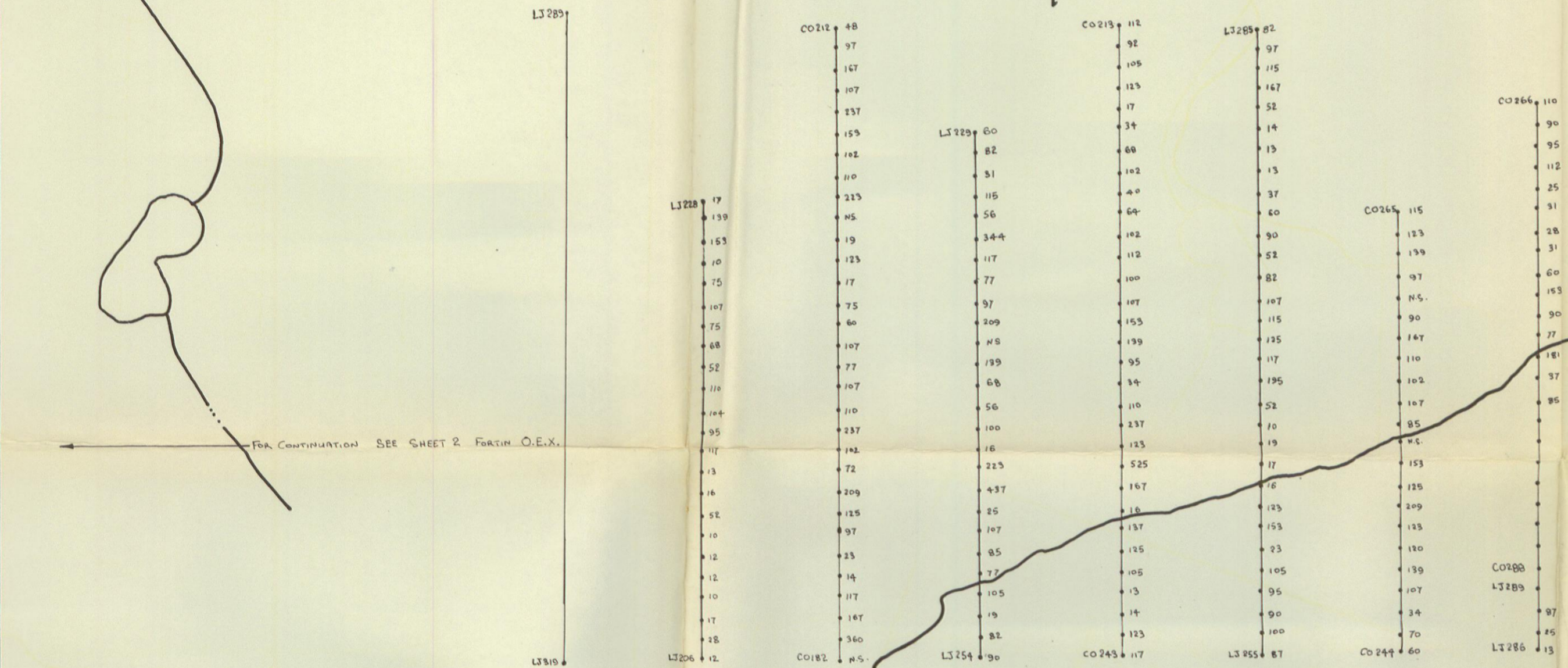

SPARTAN EXPLORATIONS LTD.
 ROSS RIVER YUKON
 FORTIN O.E.X. PROJECT
 GEOCHEMICAL SOIL SURVEY MAP

Values of (Zn) in ppm.

SOIL SAMPLERS : L.JOHNNY, C.COLLIE. DRAWN BY : N.H.SIMMONS.
 DATE : JULY 6, 1968.

Scale in feet. SHEET. 3,

