



Telephone: 261-0638

Joe Sullivan, P. Eng.

Mine Exploration

2766 West 30th Ave.,

Vancouver 8, B.C.

A REPORT ON
THE GLYN GROUP NO. 1

MINERAL CLAIMS

WHITEHORSE M.D.

YUKON TERRITORY

(Lat. 62°12', Long. 133°12')

Submitted to:

GOLDEN GATE EXPLORATIONS LTD.
714 West Hastings Street
Vancouver 1, B. C.

By

Joseph Sullivan, P. Eng.
2766 West 30th Avenue
Vancouver 8, B. C.

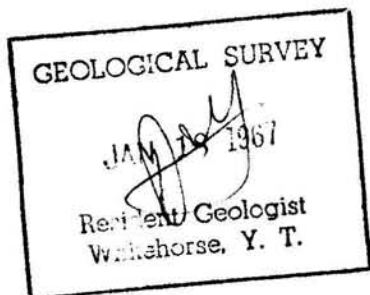

December 12, 1966

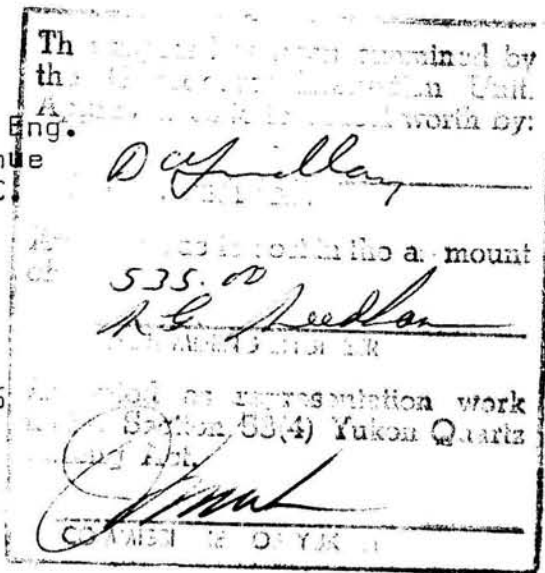

TABLE OF CONTENTS

	<u>Page</u>
INTRODUCTION	1
GENERAL CONDITIONS	2
(1) Location.	2
(2) Accessibility	2
(3) Surface Features.	3
PROPERTY AND OWNERSHIP	3
RECONNAISSANCE METHODS	3
DISCUSSION OF RECONNAISSANCE	4
GEOLOGICAL SUMMARY	5
CONCLUSIONS.	5
RECOMMENDATIONS.	6
 APPENDIX	
 LOCATION SKETCH. (After page 2)	

* * *

A REPORT ON
THE GLYN GROUP NO. 1
MINERAL CLAIMS
WHITEHORSE M.D.
YUKON TERRITORY
(Lat. $62^{\circ}12'$, Long. $133^{\circ}12'$)

INTRODUCTION:

On November 4, 1966 the writer was instructed by Mr. Thomas Lytton of Golden Gate Explorations Ltd., Vancouver, B. C., to conduct a reconnaissance survey on the Glyn Group No. 1 Mineral Claims. The object of this survey was to establish, on the ground, a starting point for a ground magnetometer survey. This was to be the start of a surface exploration program subsequent to a recently conducted airborne magnetometer survey.

The personnel involved in this work are listed in the Appendix at the end of this report.

GENERAL CONDITIONS:

(1) Location: (Lat. $62^{\circ}12'$, Long. $133^{\circ}12'$)

The group is situated in the Whitehorse Mining Division of the Yukon Territory, (claim map 105 K-3). The claim line for Glyn Nos. 7 and 8 lies northwesterly across the "Anvil Camp" road at a point two miles north of the Pelly River crossing. The total distance by road to this line from the cross roads at Ross River settlement is 34.7 miles.

A location sketch follows this page.

(2) Accessibility:

There is easy access to the southeast position of the group via a well graded road from the settlement of Ross River. Two wheel drive car or truck can complete the journey within one hour without difficulty.

In the Spring season the road closes for a few days until the ice leaves the Pelly River and the ferry begins operation. Again, in the Fall season, the road closes to permit the ice to thicken sufficiently into a strong ice budge.

BASE MAP BY ARCHER CATRO & ASSOCIATES.
 REFERENCE POINTS AND MILEAGES BY W.G. STEVENSON
 CROSS ROADS AT ROSS RIVER = MILE "0"

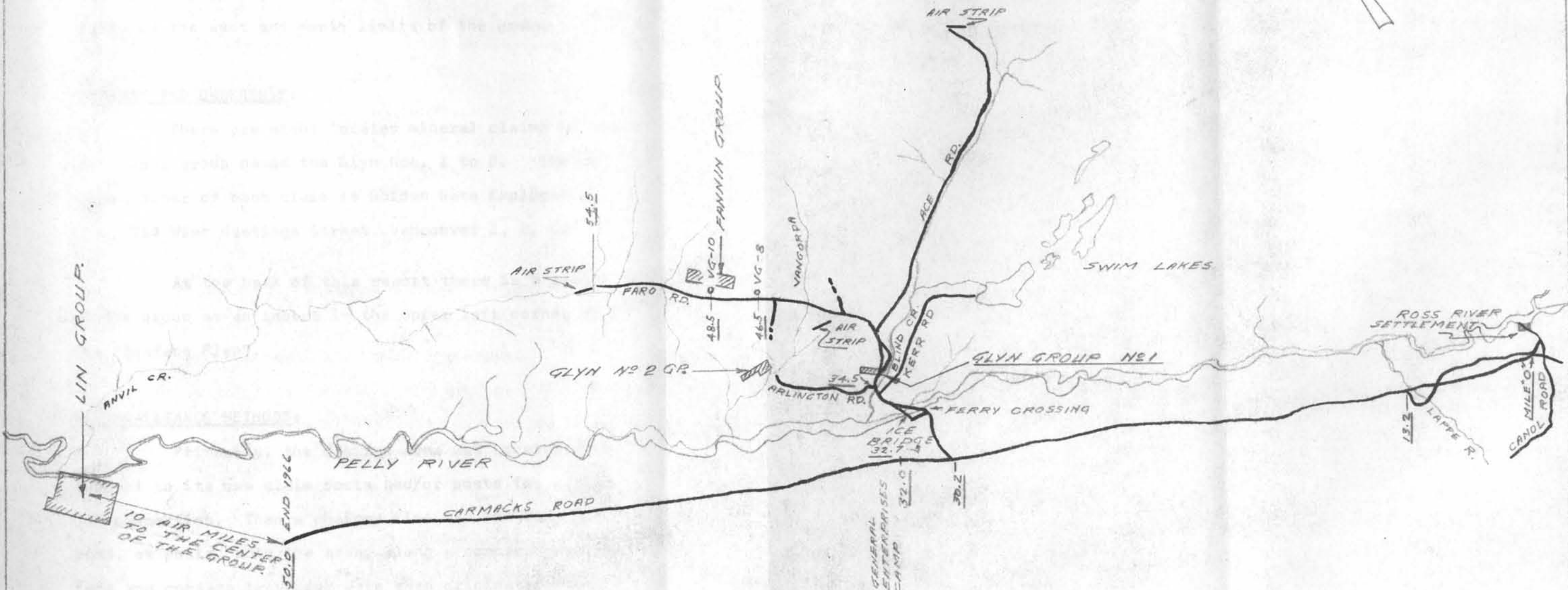
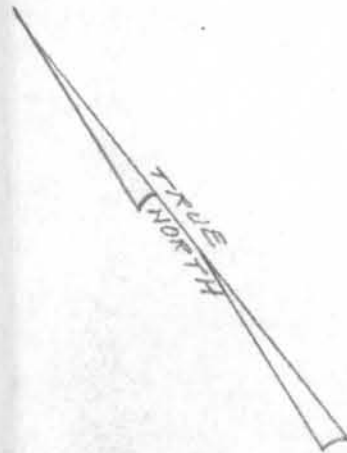

GOLDEN GATE EXPLORATIONS LTD.		
GLYN NO 1 GR.	PELLY RIVER VALLEY.	LOCATION SKETCH
1" = 4 MI. (APP.)	NOV 10, 1966.	J.S.

(3) Surface Features:

The widespread, stunted, timber affords easy passage to one on foot. On the southeast quarter there is a steep, bare hillside rising about 200 feet above the Blind Creek valley. Going northwesterly, wooded, rolling topography gives way to a series of sharp rock bluffs on the west and north limits of the group.

PROPERTY AND OWNERSHIP:

There are eight located mineral claims in one contiguous group named the Glyn Nos. 1 to 8. The recorded owner of each claim is Golden Gate Explorations Ltd., 714 West Hastings Street, Vancouver 1, B. C.

At the back of this report there is a sketch of the group as an insert in the upper left corner of the "Surface Plan".

RECONNAISSANCE METHODS:

Primarily, the desired area was located with respect to its own claim posts and/or posts for adjoining properties. Then a chained line was run from the post, or posts, into the area, along a compass bearing. Pace and compass traverses were then originated from this measured "base" and looped back to some part of the line so that they could be adjusted. Existing claim

lines and lines from older surveys were utilized whenever possible.

Most of the rock outcrops were hidden by the early snow. However, obvious exposures were recorded. Magnetometer readings were taken on at least one traverse across the area being worked. In addition, an aneroid was used to follow contours around the ridges. About 80 percent of the work, after posts had been found, was tied together and plotted on a surface plan. The accuracy of the horizontal distances is expected to be within ± 25 feet.

DISCUSSION OF RECONNAISSANCE:

Very few difficulties were encountered in locating posts on this group but there is some doubt as to whether or not the posts belong to the claims. They are in the approximate location indicated by the claim maps but on the No. 2 posts for what is believed to be Glyn Nos. 7 and 8 the word "Glyn" has been omitted. The other posts along the claim line are illegible.

There is an indication that a northeast trending contact between a diorite body and an andesitic tuff or flow crosses onto the Glyn No. 5 M.C. This is by projecting the contact from a large outcrop some 250 feet north of the No. 5 claims boundary. The highest magneto-

meter reading recorded is 100 feet west of the No. 2 post on the Glyn No. 5 M.C., but in general the magnetic readings are erratic.

The claim lines are short. Two claim lengths are included within a distance of 1900 feet. It is apparent from this short staking that the anomaly indicated from the airborne work will lie east of the group and possibly on open ground, even if the Glyn Nos. 1, 2, 3, and 4 are full-sized claims.

GEOLOGICAL SUMMARY: (G.S.C. Map Sheet 13-1961)

The andesitic unit encountered appears to be part of the Mississippian formation designated as (8) on the G.S.C. map sheet for this area. The diorite intrusive body, not shown in the G.S.C. mapping for this area, could be part of the Cretaceous Intrusives classified as formation (11). The andesitic unit has a faint banding striking northwest and dipping steeply to the west. The size and shape of the intrusive is not known.

CONCLUSIONS:

No good starting point for a ground magnetometer survey was located. The reconnaissance work should be extended easterly to determine the status of the mineral rights about 4500 ft. from the No. 1 post of the Glyn No. 5 M.C.

RECOMMENDATIONS:

It is recommended that no ground magnetometer survey be started in this area until the airborne anomaly has been located and the underlying mineral rights have been acquired.

Respectfully submitted,

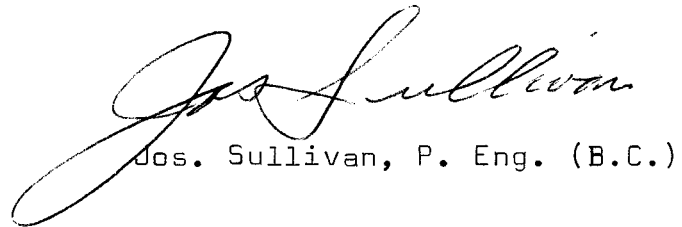

Joe Sullivan, P. Eng. (B.C.)

APPENDIX

GLYN GROUP NO. 1

SCHEDULE OF TIME AND REMUNERATIONS

<u>Name and Address</u>	<u>Occupation</u>	<u>Period (1966)</u>	<u>Total Days</u>	<u>Total Remuneration</u>
W. G. Stevenson 509 Stock Exchange Bldg., Vancouver 1, B. C.	P. Eng. Geology	Nov. 12,	1	\$ 125.00
J. Sullivan, 2766 West 30th Ave., Vancouver 8, B. C.	P. Eng. Geology	Nov. 10, 11	2	250.00
J. Berkosha, Port Moody Inn, Port Moody, B. C.	Geophysics and Survey	Nov. 10, 11	2	150.00
Magnetometer			2	10.00
				<hr/>
				\$ 535.00
				<hr/> <hr/>

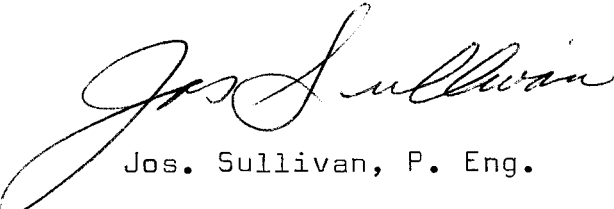
Jos. Sullivan, P. Eng.

Report on an
Airborne Magnetometer Survey
of the
~~_____~~ Glyn I. ~~_____~~ Groups
of Mineral Claims
near Ross River, Y.T.

GEOLOGICAL SURVEY
JAN 23 1967
Resident Geologist
Whitehorse, Y. T.

This report has been examined by
the Geological Evaluation Unit.
Approved as to technical worth by:
[Signature]
RESIDENT GEOLOGIST
Approved as to cost in the amount
of \$ 510.40
[Signature]
REGISTERED MINING ENGINEER
Accepted as representation work
under Section 53(4) Yukon Quartz
Mining Act.
[Signature]
COMMISSIONER OF YUKON

Report on an
Airborne Magnetometer Survey
of the
~~XXXXXX~~, Glyn 1, ~~XXXXXX~~ and ~~XX~~ Groups
of Mineral Claims
near Ross River, Y.T.

for
Golden Gate Explorations Ltd. (N.P.L.)
714 West Hastings Street
Vancouver, B.C.

Survey by
Husky Industries and Services Ltd.
97 - 845 Hornby Street,
Vancouver, B.C.

Interpretation by
Joseph Sullivan, P.Eng.,
201 - 525 Seymour Street
Vancouver, B.C.

September 29, 1966

Introduction:

This report is on the airborne magnetometer surveys of five separate claim groups, all in the same general locality. Husky Industries and Services Ltd., 97 - 845 Hornby Street, Vancouver, B.C. conducted each survey on September 3, 1966. The client, and owner, for each group was the same, namely: Golden Gate Explorations Ltd., 714 W. Hastings Street, Vancouver, B.C.

Properties:

The five group total 60 located mineral claims:

Fannin Group	No's. 1 to 16 (16)
<u>Glyn Group No. 1</u>	<u>No's. 1 to 8 (8)</u>
Glyn Group No. 2	No's. 65 to 80 (16)
OP Group	No's. 17 to 24 (8)
JO Group	No's. 19 to 24, + 43 to 48 (12)

A claim sketch for each grouping has been included at the back of this report.

Location: (Lat. 62° 00', Long. 132° 00' N.W.)

All the claims are in the Whitehorse Mining Division of the Yukon Territory. They lie on the north side of the Pelly River, west of the Ross River townsite, east of Rose Mountain, and south of Mount Mye.

The following location sketch shows group located with respect to its closest topographical feature.

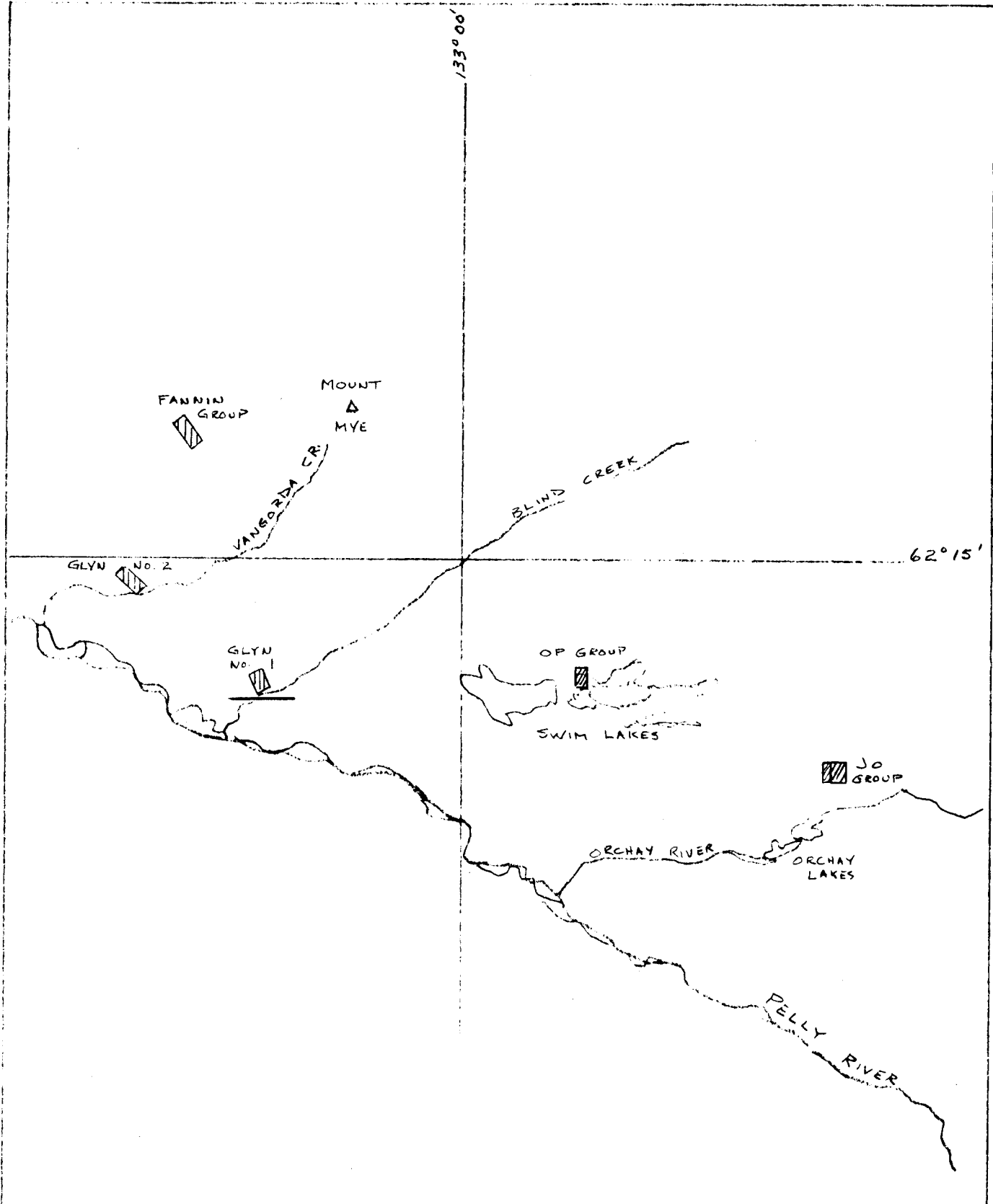

LOCATION SKETCH

Geological Summary: (G.S.C. Map Sheet 13 - 1961)

As might be expected, with so widespread an array of claims, there is considerable variation in the general geology. On the northwest, the Fannin group appears to be underlain by Cretaceous intrusives, classified in the accompanying legend as formations (11). For the area of both the Glyn groups there is a great variety of altered volcanics and sediments of Mississippian age, formations (7), (8), and (9). The OP group is on flatter ground, covered chiefly by glacial deposits. The most likely underlying formations is (7), an altered volcanic-sedimentary complex. The same Cretaceous intrusives associated here with the Fannin group, appear also in the locality of the JO claims and are the most likely underlying rocks, since no other formations are indicated here.

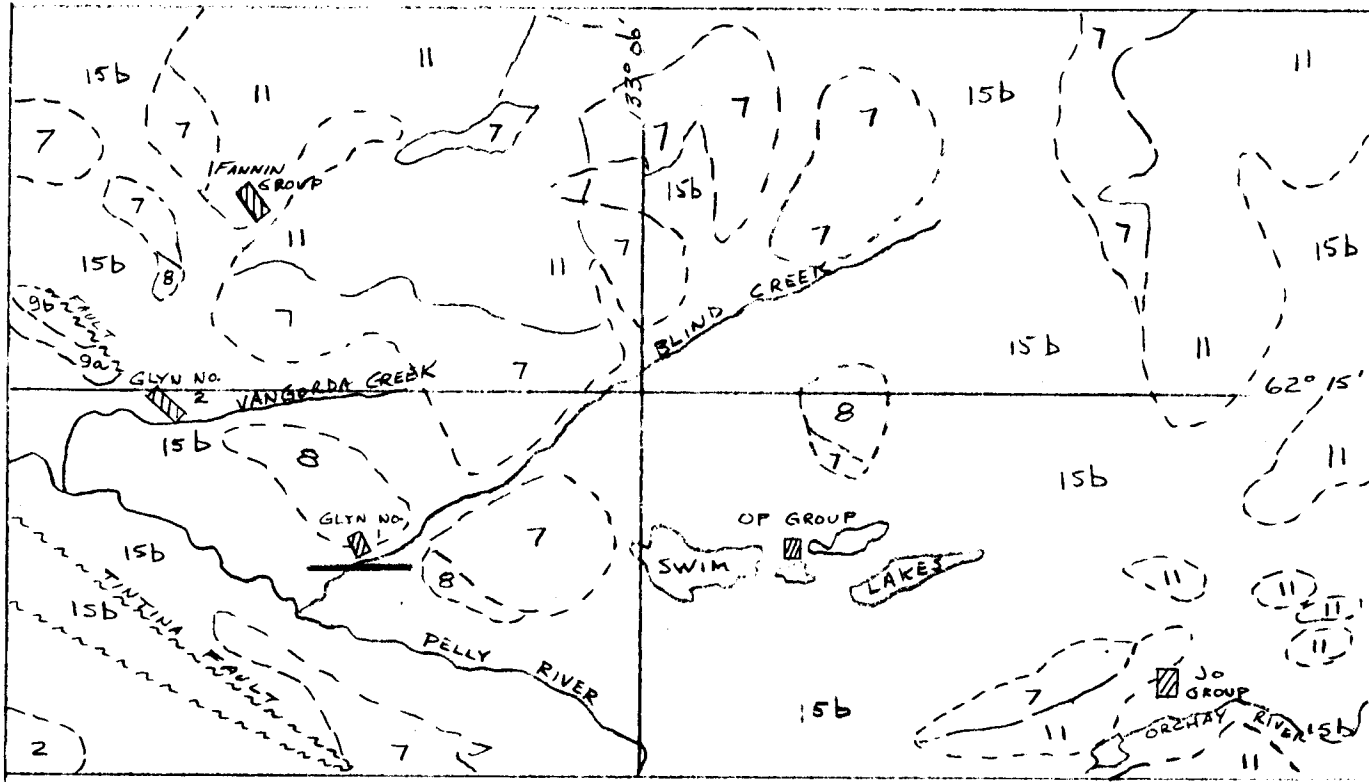

LEGEND

- 2 Buff-and grey-weathering, grey, green, and black shales, slates, and phyllites; silty limestone and siltstone.
- 7 Banded quartzose granulite, green and purplish banded skarn, quartz-sericite schist, hornfels and phyllite; chlorite schist and thin altered andesite (8) common in upper part; minor crystalline limestone.
- 8 Altered, dark green andesite and basalt flows and tuffs, commonly schistose, rarely porphyritic; minor phyllite, dark argillite, and light grey quartzite.
- 9 9a, greenish grey quartzite, commonly thin-bedded; micaceous and silvery graphitic schists; minor dark grey siliceous slate, silty limestone, and grey micaceous quartzite; 9b, conglomerate with pebbles of chert, andesite, quartzite, chlorite schist, and limestone.
- 11 Medium-to coarse-grained quartz monzonite and granodiorite, commonly porphyritic; minor diorite and gneiss.
- 15b Unconsolidated glacial and alluvial deposits.

GEOLOGY

Method of Survey:

A magnetometer built to record the vertical component of the earth's magnetic field was mounted in a Hiller 12E helicopter. The readings were directed through an electric chart recorder, so that a continuous record of the gamma changes was inscribed on the paper charts.

These surveys covered a total of 36.2 line miles at approximately 1,000 foot spacings. Each group had a ground marker, visible from the air, on a claim corner, so that the automatic camera on the helicopter could relate each traverse or flight to a known point.

The operator's field records are included as Appendix 1 at the back of this report.

Interpretation: (See also accompanying recorder charts)

(1) Fannin

All the flights recorded considerable range in the gamma count, with many of the readings beyond the limits of the chart paper. The most pronounced trend noted was a parallel set of magnetic ridges lying east west across the southerly portion of the claims. If the claims are underlain entirely by intrusive rocks, as is suggested in the geological summary, then these magnetic ridges could indicate a relatively more basic intrusive phase with a greater magnetic content, or perhaps a zone of alteration controlled by a wide east-west shear.

(2) Glyn Group No. 1

The trend marked as No. 1 is a drop in the gamma count from a high range into a pronounced magnetic depression. This suggests a rock contact with a more basic unit on the west. The indicated trend No. 2 is a magnet on the northerly ends of lines 2 and 3. There may be no relation between the lines, but the presence of one or more magnetic bodies is indicated.

(3) Glyn Group No. 2

On flight-line 4 is an isolated magnetic high, the only signature of note on the charts. Perhaps the rope-like fashion in which the runs were made explains the unrelated appearance of one chart to the next.

(4) OP Group

An eastwest magnetic high zone predominates over a magnetic gradient, which increases from west to east. This high zone appears on lines 1 and 2, and because it is well pronounced, and does not continue through the survey, is one of the most attractive trends in all of the five projects.

(5) JO Group

Trend No. 1 crossing lines 3, 4, and 5 is a narrow break in the gradients, often caused by a fault or a rise in the topography. However, this trend is normal to the topographic trends, and has a dipole type signature, making it a truly anomalous condition worthy of further investigation.

Recommendations:

(1) Fannin Group:

Investigate the magnetic ridges on the ground by prospecting with a dip-needle.

(2) Glyn Group No. 1:

Prospect the area marked "Trend No. 2" by visual inspection and a dip-needle.

(3) Glyn Group No. 2:

The magnetic peak may not extend into the claims. This can be determined by the use of a dip-needle.

(4) OP Group:

The magnetic zone marked "Trend No. 1" should be outlined on the ground by a magnetometer survey and geological mapping.

(5) JO Group:

The magnetic zone marked "Trend No. 1" should be outlined on the ground by a magnetometer survey and geological mapping.

The various trends discussed are plotted on the flight-line sketches located herein after the claim outlines. Because of the ground markings and camera control, each trend, as plotted, should be a reasonably good starting point for the recommended ground investigations.

Respectfully submitted,

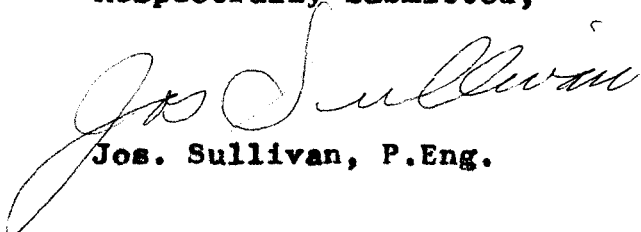
Jos. Sullivan, P.Eng.

September 29, 1966.

Appendix 1
Airborne Magnetic Survey
For Golden Gate Exploration Ltd.
Glyn Group #1 #1 - 8 (8)

<u>Line No.</u>	<u>Direction Flown</u>	<u>No. Pictures</u>	<u>Tape Length</u>	<u>Milage</u>
1	NW - SE	16	6.8"	1.36
2	NW - SE	16	6.5"	1.30
3	NW - SE	15	6.2"	1.24
4	NW - SE	<u>14</u>	6.0"	<u>1.20</u>
Totals		61		5.10

Date Flown - September 3, 1966.

Line Bearings - Approximately S 45° E

Altitude - 700'

Air Speed - 60 M.P.H.

Sensitivity - 1000 gamma full scale

Lines - 1000' apart

Operator - R. Robillard



GLYN GROUP #1

BY D.M.F. DATE 27-3-66 SUBJECT HUSKY INDUSTRIES SERVICES LTD SHEET NO. OF
CHKD. BY DATE AIRBORNE MAGNETOMETER SURVEY FOR JOB NO. 4-A
SCALE 1" = 1/2 MILE GOLDEN GATE EXPLORATIONS LTD. (N.P.L.) GLYN GROUP No. 1

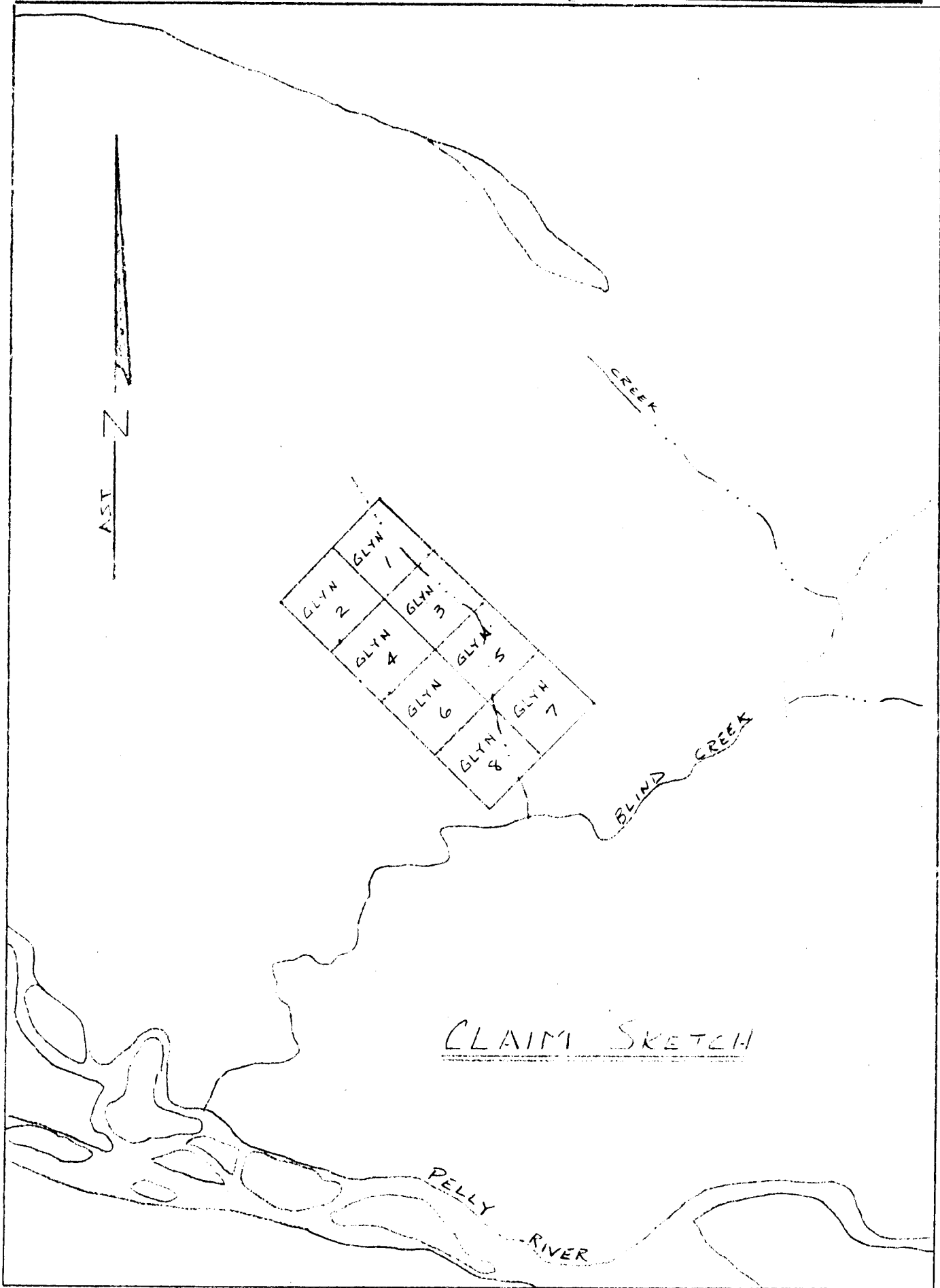

CLAIM SKETCH

