

This report has been examined by
the Geological Evaluation Unit.
Approved as to technical worth by:

D. J. ...
RESIDENT GEOLOGIST

Approved as to cost in the amount of
\$ 3015.95

H. F. ...
DEPUTY MINING ENGINEER

Accepted as representation work
under Section 53(4) Yukon Quartz
Mining Act.

[Signature]
COMMISSIONER OF YUKON

GEOPHYSICAL REPORT

ON

THE CASH GROUP (24 Claims)

ROSE CREEK AREA

CLAIM SHEET 105K-5 @ 62°22'N, 133°31'W

SUPERVISED by S.J.HUNTER P.ENG.

REPORT by D.POLIQVIN P.ENG.

FEB.10 1966 to MAY 30, 1966.

by: *[Signature]*

J. Duane Poliquin, P. Eng.

Vancouver, June 12, 1967.

GEOLOGICAL SURVEY
[Signature]
JUN 19 1967
Resident Geologist
Whitehorse, Y.T.

[Signature]

SUMMARY

In this report, the work done on the Cash Group of 24 claims, Vangorda Creek area, Yukon Territory, under the supervision of S. J. Hunter and associates is reviewed. The airborne magnetometer survey showed up several interesting anomalies which were partly checked out on the ground but which merit a more serious follow-up. Work done consisted of:

Airborne Magnetometer Survey - 30 Line Miles

Line cutting	Base Line	4,800 feet
	Line	33,700 feet

Ground Magnetometer at 100 foot intervals - 38,500 feet

Copies of affidavits, invoices and reports etc., are in an appendix to the report.

INTRODUCTION

The following is a brief report on work done on the Cash Group of claims in the Dynasty - Vangorda Creek area of the Yukon Territory. The work was carried out under the supervision of S. J. Hunter and Associates of 411 - 1033 Davie Street, Vancouver, B.C. Much of the work was subcontracted and, in the absence of a compilation of results by Hunter's, the writer was asked to do so on behalf of Slocan Ottawa Mines Ltd, owner of the claims. This report is based on the various reports of people who carried out the work, G. S. C. map 13-1961, and the writers personal knowledge of the area, gained while prospecting here in 1961.

LOCATION and ACCESS

The Cash Group lies in the foothills north of Rose Creek, with the creek crossing the group in an east west direction near the southern limits. The settlement of Ross River lies 50 miles to the east. Access to the property from Whitehorse is gained by fixed wing aircraft to the Anvil Mines airstrip, or by vehicle east on the Alaska Highway and north on the Canol Road to Ross River. From either of these locations final access is by helicopter at present.

TOPOGRAPHY

The claim group lies on the north slope of Rose Creek Canyon and elevations vary from 3,500 feet to 4,500 feet. There are numerous rock outcrops on the slopes.

PROPERTY HOLDINGS

The Cash Group belonging to Slocan Ottawa Mines consists of 24 claims (see map attached). These are located claims shown on claim map 105 K -5, and adjoin the Hog and Fair groups to the south and west.

Claims	Record No's.
Cash 1 - 24	94590 - 94613.

GEOLOGY

The following is based on G. S. C. Map 13-1961 and personal knowledge of the area. The claim group lies on Mississippian Schists and Quartzites although Kishhout (see appendix) described them as altered andesites. The claims are seven miles north of the Tintina Trench a major earth break to which intrusives, shear zones, and mineral deposits

in the area are directly or indirectly related. Intrusives form a belt on either side of the trench and along it for many tens of miles. Most mineral deposits in the area are within ten miles of the trench and within a few miles of an intrusive body. There are several small granite intrusives around the Cash Group.

Geophysical Program

The geophysical program conducted on the property consisted of two phases;

- 1) An airborne magnetometer survey.
- 2) A ground linecutting and magnetometer program.

1) Airborne Magnetometer Program.

This survey was carried out by Canadian Aero Service Ltd., of 707 - 7th Avenue S.W. Calgary, Alberta. A description of instrumentation, flight plans, and technique by their staff is in the appendix of this report. Thirty Line Miles were flown.

In interpreting this data it is noted that there is a trend of elongated anomalies traversing the claims centrally in a NW - SE direction, with lows along either side of it. This is considered to be the outline of a rock formation, with a fairly high magnetite content, although no data is available on magnetic susceptibilities in this area. This formation could, nevertheless, be interesting as valuable base metal deposits are often found associated with magnetite. It should be noted that the flight plan was dictated by topography rather than structure, and that due to the steep slopes, these anomalies may be considerably distorted. Of greater interest to the writer is the triangular shaped 3,400 gamma anomaly on Cash #5, which is separated from the aforementioned formation by a sharp magnetic low.

2) Ground Magnetometer and Linecutting Program.

This work was carried out between May 17 and May 30, 1966 by W. E. Kleinhout, of 7 Brule Terrace, Toronto 3, Ontario under the supervision of S. J. Hunter. Mr. Kleinhout's report is attached. His work was carried out on the Cash 7,8,9,10,11 and 12 claims. A total of 4,800 feet of base line and 33,700 feet of line were cut (see these on aero mag. map). Mr. Kleinhout checked these lines with an Abem MZ - 4 torsion wire Magnetometer. Readings were taken along the base line, and along the lines at 100 foot intervals. Unfortunately, Mr. Kleinhout has provided neither his readings or a map, and interpretation is not possible. However, he reports no anomalies were found in his survey.

CONCLUSIONS AND RECOMMENDATIONS:

Because of the lack of data and apparent insufficient coverage by the Kleinhout Ground Survey, it is concluded that the anomalies have not been sufficiently checked on the ground.

It is recommended that a combined Ground E. M., Magnetometer and/or Geochemical Sampling program be laid out for consideration.

REPORT

by

W. E. Kleinhout

for

S. J. HUNTER & ASSOCIATES

Magnetometer Survey
Slocan Ottawa Mines Ltd.
Cash Claims
Rose Creek, Y.T.

May, 1966.

This report has been examined by
the Geological Evaluation Unit.
Approved as to technical worth by:

DCY
RESIDENT GEOLOGIST

Approved as to cost in the amount
of \$

RESIDENT ENGINEER

Accepted as representation work
under Section 30(4) Yukon Quartz
Mining Act.

COMMISSIONER OF YUKON

FEE	840.00
Major Rental	70.00
	<hr/>
	910.00
Mobilization	352.00
	<hr/>
	1262.00

INTRODUCTION

A magnetometer survey was carried out in the Rose Creek area for Slocan Ottawa Mines Ltd. on their Cash claims.

The object of this survey was to locate two aeromagnetic anomalies on the ground and to evaluate these anomalies with follow-up drilling in mind.

The area of importance was designated to be the following claims: Cash #7, #10 and #12.

Terrain

The Cash Group of claims covers a steep slope, difficult to traverse because of thick underbrush, north of Rose Creek.

Geology

The area seems to cover an altered andesite. Immediately to the north of the Cash Group, outcroppings of quartz-monzonite were observed.

Survey

The survey was carried out on the Cash #7, 8, 9, 10, 11 and 12 claims.

An Abem MZ-4 (#4592) torsion magnetometer was employed.

Control stations were established along the base line, and the cross lines were surveyed at 100 feet intervals.

Conclusion

The magnetometer survey failed to establish anomalous situations in the above mentioned area.

Consequently, a drill program was not proceeded with at this time.

Respectfully submitted



W. E. Kleinhout
7 Brule Terrace
Toronto 3, Ontario

Daily Report

for

SLOCAN OTTAWA MINES LTD.

May 17 Arrived in Whitehorse
May 18 Arrived in Rose Creek Camp at 7:00 p.m.
May 19 Located upper west-end posts with Mr. Waller;
no location lines. Had the men cut a tie-line from
#1-94612 to the upper location line.
May 20 Located all posts and established the location line;
all posts were tagged.
May 21 Flew to Whitehorse and called Stan Hunter in
Penticton. Had the men cut another tie line to
upper location line from #1-94606.
May 22 Organized the line cutting program.
May 23 Hired a cook, and obtained any necessary supplies.
May 24 Arrived in Rose Creek camp with the line cutters.
Started the Base line.
May 25 Continued the Base line, and ran Control stations.
May 26 Continued line cutting and the Mag Survey.
May 27 Continued line cutting and the Mag Survey.
Cut the program.
May 28 Line cutters left the property.
May 29 All men are now out of the bush.
May 30 Returned to Vancouver.

Respectfully submitted

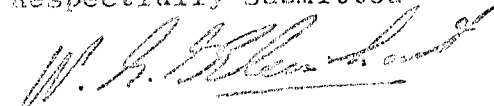
W. E. Kleinhout

7 Brule Terrace
Toronto 3, Ontario

June 2, 1966

W. E. Kleinhout
7 Brule Terrace
Toronto 3, Ontario
June 2, 1966

S. J. Hunter & Associates
406-1033 Davie Street
Vancouver 5, B. C.

Dear Stan

Subject: Slocan Ottawa Mines Ltd.

Services rendered re magnetometer survey

14 days @ \$60. \$840.00

*Paid By S.J. Hunter
& Associates - Ed
he invoiced to Slocan
Ottawa Mines
S.J.H.*

Respectfully submitted



W. E. Kleinhout

SJH:mt

cc. Mr. J. L. Black

1666 West Broadway
Vancouver 9, B. C.
May 31, 1966

Mr. S. J. Hunter
S. J. Hunter & Associates Ltd.
406-1033 Davie Street
Vancouver 5, B. C.

Dear Mr. Hunter

Subject Magnetometer Rental

The rental for Magnetometer (Abem
MZ-4/#4592), obtained from me by W. E. Kleinhout
for the Slocan Ottawa Mines Ltd. Survey on
their Rose Creek, Yukon Territory property
will be:

14 days @ \$5.00 \$70.00

Thanking you in anticipation I remain

Truly yours



D. W. Smellie

Per W. E. Kleinhout

cc. Mr. J. L. Black

*Paid June 9
367A
chge Slocan.*

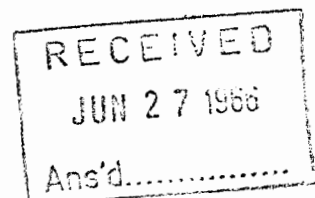

TELEPHONES: 683-3633
681-6815

T.
P.
Y.



TRAVEL SERVICE LTD.
71 EAST PENDER STREET
VANCOUVER 4, B.C.



May 16th 1966

S. J. Hunter & Associates

1033 Davie Street

Vancouver, B. C.

TRANSPORTATION CO. & TICKET NO.	PASSENGER	TRANSPORTATION ETC.	AMOUNT
GPA 018 100 269 782	Mr. W. Keinhout	Vancouver to Whitehorse ov " " "	\$ 75.00 75.00 <hr/> 150.00 202.00 <hr/> 352.00
	"	150 to Van Return	

*May 16
Paid #333*

BOX 1186
Rm. 103 POLARIS BLDG.

TELEPHONE 667-2483

White, Hooford & Impey Limited

LEGAL SURVEYS :: ENGINEERING

Whitehorse, Yukon

W. S. Vane, P.Eng., A.L.S., D.L.S.
A. Earl Hooford, A.L.S.
Hugh E. Impey, A.L.S., S.L.S., M.L.S., D.L.S.

12 July, 1966

Statement of Account

With: Slocan Ottawa.

To; Line Cutting.

Base Line: 4800' = 3/4 mile @ \$250.00/m----- \$187.50

Picket Line: 33,700'=6.38/m @ \$ 77.50/m----- \$494.45

. Helicopter; 1½ hours @ \$104.00/hr.----- \$156.00

Beaver Flight from Whitehorse ½ hr. charter----- \$ 94.00

TOTAL THIS INVOICE-----,----- \$931.95

CANADIAN AERO SERVICE LIMITED

RESOURCES DEVELOPMENT ENGINEERING

HUNT CLUB ROAD, BOX 463, R.R. #5

March 25th, 1966. OTTAWA • CANADA

TELEPHONE 822-0121

Eleon Ottawa Mines Ltd. (S.P.L.),
Suite 934,
518 West Hastings Street,
Vancouver 2, British Columbia.

№ 7830

Progress billing re helicopter
magnetometer survey

\$ 600.00

Payment received with thanks.

PACKING SLIP

CANADIAN AERO SERVICE LIMITED

Photogrammetric Engineers

Box 463-R.R. # 5,

~~XXXXXXXXXXXX~~ OTTAWA, CANADA
TELEPHONE CE 5-1404

Hunt Club Road

SHIP TO:

S.J. Hunter & Associates,
Room 406-1033 Davie Street,
VANCOUVER, B.C.

DATE

June 1/66

DELIVERY

PARTIAL

FINAL

YOUR ORDER NO.

JOB NO 56-102

DATE SHIPPED

VIA Air X W/B 323279

QUANTITY	DESCRIPTION
	<u>CASH GROUP</u>
2	Log sheets flight 1-2
2	rolls film flight 1-2
12	envelopes magnetometer tapes TR 1-12

12256

CUSTOMER'S COPY

CANADIAN AERO
SERVICE LIMITED
AN AFFILIATE OF LITTON SYSTEMS CANADA

CANADIAN AERO SERVICE LIMITED 1080 EAST TOWER ELVEDEN HOUSE · 707-7th AVENUE S.W. · CALGARY, ALBERTA

April 17, 1967

TELEPHONE: AMHERST 3-4730

Mr. John L. Black
Secretary
Slocan Ottawa Mines Ltd.
904 Standard Building
510 West Hastings Street
VANCOUVER 2, British Columbia

Dear John:

If Canadian Aero can be of any assistance in altering the decision of the Resident Geologist, we would be pleased to do what we can, especially if there is a possibility of obtaining a settlement of the overdue account.

I don't completely understand his specific reasons for rejecting your claim, but the matter seems simple to provide:

- (a) locations and descriptions of claims which were filed with the recorder
- (b) a location map which is signified by latitude and longitude, and some planametric detail on the compiled magnetics
- (c) a description of the survey itself without interpretation, as this was not part of the Program.

On the latter point, the only details that I can add that might have been omitted are:

- (1) the instrument used was a Gulf Mark III Fluxgate Magnetometer mounted in a Bell G3B Helicopter complete with AS-5, 35mm. Continuous Strip Camera
- (2) The Survey lines were flown approximately in a Northwest-Southeast direction.

A copy of the original Agreement with these details outlined is attached.

I hope this will be of some use to you in your efforts to settle with the Government.

Yours very truly,

CANADIAN AERO SERVICE LIMITED

John R. Prendegast
John R. Prendegast, P. Geol.
Western Manager

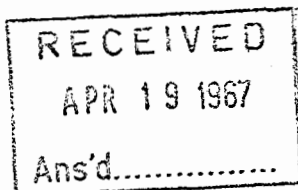

JRP/rmd

770 - 1 Bentall
Centre

March 2nd, 1966.

Mr. S.J. Hunter,
c/- 411, 1033 Davie Street,
VANCOUVER, B.C.

Dear Stan,

Re: Slocan Ottawa Claim Groups - Cash,
Alan - Ann

Well, as you predicted the helicopter mag. business has really caught hold and we are scheduling new work every day.

A month's contract commencing March 7th will tie up the unit during the period you are interested in, but we will gladly schedule your work immediately thereafter, that is, April 8th 1966. We also have a month's work commencing June 8th, 1966 so any other prospects you have (Tay River Mines) should commit fairly soon.

Regarding the Slocan-Ottawa Group, our proposal constitutes the following:-

Instrumentation:

A Mark III Gulf Research and Development total field Fluxgate Magnetometer will be installed in either a Hiller 12E or a Bell G3. A bird will be towed on a cable approximately 84 feet long and the recorded flight data will be supplemented by a 35mm AS-5 Aeropath film strip. All systems will be correlated through an automatic fiducial system.

...continued

Data Presentation and Delivery:

Our operator in the field will develop the film and edit the flight tapes in order to provide you a basic flight path recovery. We request that the customer's designated representative only take delivery of the data and discuss the results of the survey with the operator. We would like to point out that the operator is an electronics specialist and not a geologist or geophysist and though he has a vast background in magnetic surveys, his remarks should not be taken professionally. Any detailed compilation or interpretation is available through our Ottawa office for an additional per line mile fee.

Cost:

To fly the claims, with a slight fringe at 1/8 mile spacing, totals 70 line miles which represents only two to three hours helicopter time. However, because the unit is based at Whitehorse and will have to ferry to the area as well as refuel while on location, you should count on three or four days to complete the flying. In this time you might also incur 15-20 hours of helicopter charges plus fuel, camp costs, and mobilization and demobilization expenses for our man and his equipment. I recommend that your client be responsible for purchasing, locating and returning the drums of 100/130 octane aviation gas required by the helicopter. A Bell G-3 uses about 15 gallons per hour and in the long run it would be cheaper for your people to expedite fuel supplies in the survey area.

In summary, a four day contract would cost approximately:-

(a)	Magnetometer charges	4 days @ \$300.00	- \$1,200.00
(b)	Helicopter Charges	15 to 20 hours @ \$122.50	- \$2,450.00
(c)	Fuel costs	150 to 200 gallons @ 75¢ F.O.B. Ross River	- \$ 150.00
			<u>\$3,800.00</u>

Plus Camp costs, mob and demob of operator

This represents about \$55.00 per claim (72 claims) but would certainly allow ample time to fly additional survey mileage.

Photos:

Aerial photos are essential and as per your instructions have been ordered and will be charged to the Siocan-Ottawa account.

...continued

Payment:

50% of the magnetometer fee upon signing and the balance on completion of the program.

If you are in agreement with the general terms of this letter, please drop me a line authorizing the number of contract days. A deposit of fifty percent (50%) of the daily charges will hold the equipment on schedule for your program. A more formal contract including insurance coverage, contractor liabilities, etc., will be sent to your office for ratification and signing.

Stank, there are two items I failed to mention in my discussion with you and they are royalty charges and materials. For the moment the latter can be overlooked but unfortunately Canadian Aero is required to pay a royalty on every mile flown with the Gulf magnetometer. The amount still has not been resolved but in your discussions with clients, please make them aware of this extra charge. It is not applicable on the Slocan-Ottawa contract but if Tay River Mines decide to go ahead, a 50¢ per line mile royalty should be included in the estimate.

Thank you for your interest and I look forward to hearing from you further on this program.

Very truly yours,
CANADIAN AERO SERVICE LIMITED

JOHN R. PRENDERGAST
WESTERN MANAGER

jrp/ela

CANADIAN AERO SERVICE LIMITED

RESOURCES DEVELOPMENT ENGINEERING

HUNT CLUB ROAD, BOX 468, R.R. #5

OTTAWA - CANADA

July 22nd, 1966.

TELEPHONE 822-0121

Slocan Ottawa Mines Ltd.,
201 - 569 Howe Street,
Vancouver, British Columbia.

No 8376

Compilation of 30 L/M of magnetic
record per S. J. Hunter's letter
of June 21st, 1966:

Cash Claims - 30 L/M @ \$7.50 per L/M

\$ 225.00

Paid by [unclear] # 231

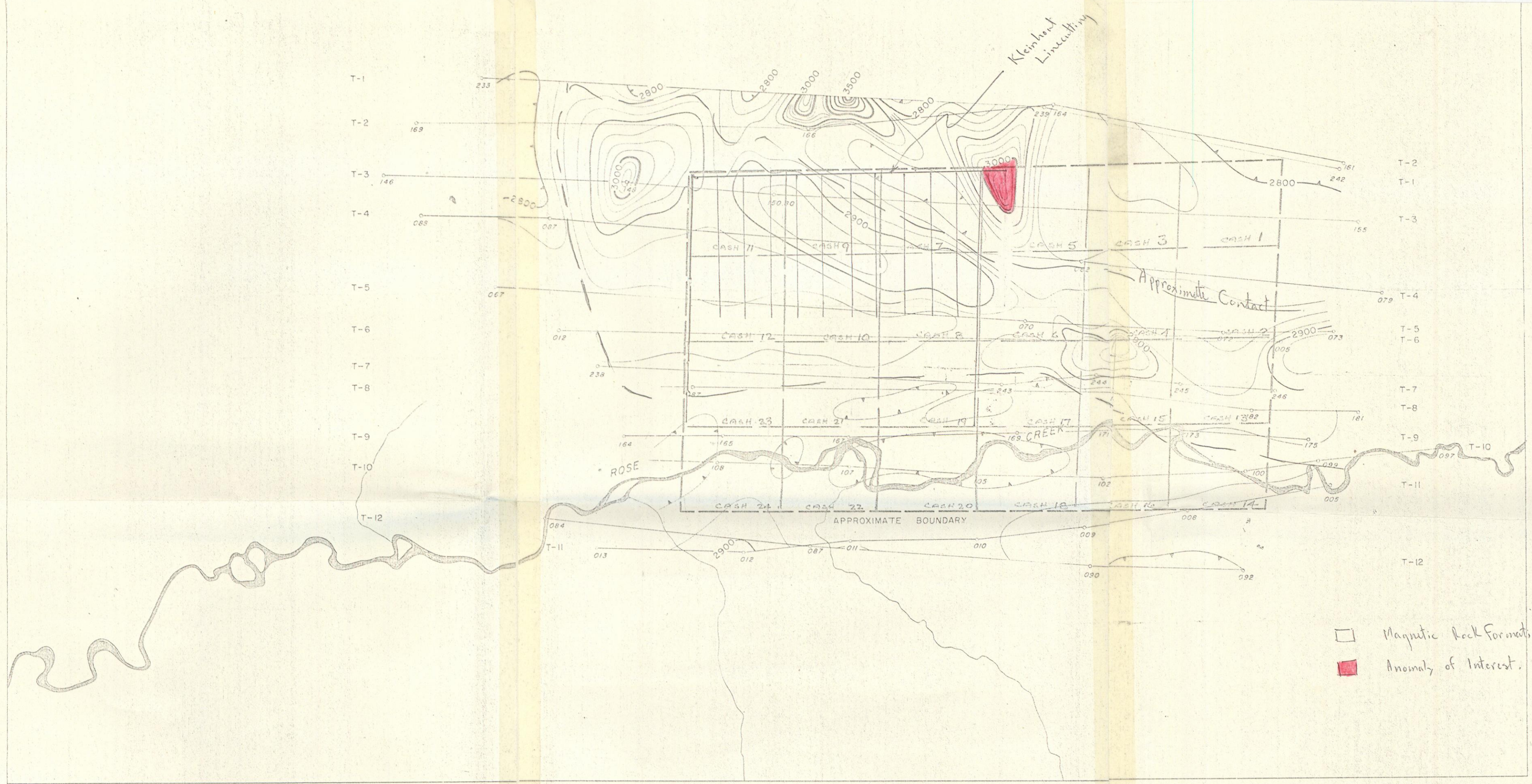

AIRBORNE MAGNETOMETER SURVEY

DYNASTY AREA

YUKON TERRITORY

SLOCAN OTTAWA MINES LIMITED

SCALE 1 INCH TO 1320 FEET (APPROXIMATELY)

FLIGHT ALTITUDE 100 FEET
 TRAVERSE INTERVAL 1/8 MILE
 CONTOUR INTERVAL 25 GAMMAS
 BASE INTENSITY ARBITRARY

CANADIAN AERO SERVICE LIMITED
 OTTAWA, ONTARIO

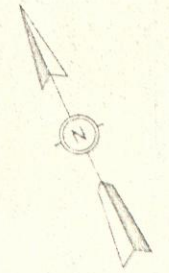

APPROXIMATE

HORIZONTAL CONTROL BASED ON
 PHOTO LAYDOWN

L. G. WHITE & ASSOCIATES LTD.
CONSULTING ENGINEERS
VANCOUVER-BRITISH COLUMBIA

CLAIM GROUPS "CASH-ALAN-ANN" DYNASTY AREA, YUKON.

SCALE 1" = 1/2 MILE

DATE FEB. 9, 1966

PROJECT No. 10

EXAMINED BY S.J. HUNTER.

DRWG. No. 1

APPROVED BY

