

**094208**

**ASSESSMENT REPORT  
SAMPLING, PERCUSSION DRILLING  
completed on the  
DM 8 (YB66283) & DM 11(YC18200)**

**WHITEHORSE MINING DISTRICT  
YUKON TERRITORY**

**Work completed  
between July 25 and August 15, 2000**

**YUKON ENERGY, MINES  
& RESOURCES LIBRARY  
P.O. BOX 2703  
WHITEHORSE, YUKON Y1A 2C6**

**Location:** 1. Fish Lake Road, Whitehorse  
2. NTS 105 D-10  
3. Latitude 60° 44' N  
Longitude 135° 10' W

**Claims:** DM 1-8 (YB66276-YB66283)  
DM 11-12 (YC18200-YC18201)

**For:** **Sid McKeown**  
P.O. BOX 4471  
Whitehorse, Yukon  
Y1A 2R8

**By:** R. Allan Doherty, P. Geo.  
**Aurum Geological Consultants Inc.**  
P.O. Box 4367  
Whitehorse, Yukon  
Y1A 3T5

May 07, 2001

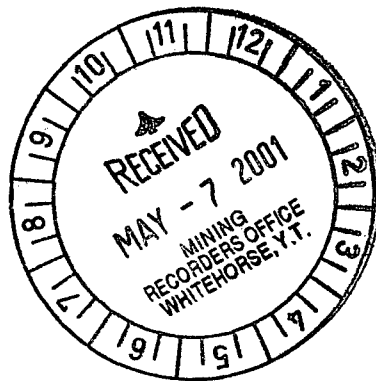

with a view to the  
of the Yukon Territory  
and the Yukon  
Commissioner

This report has been examined by  
the Geological Evaluation Unit  
under Section 53 (4) Yukon Quartz  
Mining Act and is allowed as  
representation work in the amount  
of \$ 900.00.

*M. B. ...*  
Regional Manager, Exploration and  
Geological Services for Commissioner  
of Yukon Territory.

## TABLE OF CONTENTS

TABLE OF CONTENTS	I
INTRODUCTION	1
LOCATION, AND ACCESS	1
TOPOGRAPHY, CLIMATE	1
PROPERTY	3
EXPLORATION HISTORY	3
REGIONAL GEOLOGY	3
PROPERTY GEOLOGY	3
2000 WORK PROGRAM	5
STATEMENT OF COSTS	6
STATEMENT OF QUALIFICATIONS	7
LIST OF FIGURES	
FIGURE 1: LOCATION MAP (1:6,000,000)	2
FIGURE 2: CLAIM MAP (1:30,000)	4

## **INTRODUCTION**

This report describes assessment work completed on the DM 8 and DM 11 claims in June, July and August of 2000. The work was carried out by Sid McKeown during June, July, and August of 2000. The claims cover an area of Upper Triassic Lewes River Group limestone, sandstone, and siltstone intruded by mid-Cretaceous quartz monzonite and granodiorite. Mineralization on the claims is typical of silicate and Fe-rich skarns of the Whitehorse Copper Belt.

The work consisted of drilling three percussion holes using a Pungar hand held drill and extracting a large bloc of granodiorite for cutting with a large rock saw at Sidrock's. A 980 loader and a Volvo loader were used to move the block of rock. The total value of assessment expenditures claimed is \$2,500.00 during the year 2000.

This report is a re-write of a report written by Joe Clarke in March 1998.

## **LOCATION, AND ACCESS**

The DM 1-8 claims are located in the City of Whitehorse, Yukon Territory, east of the Alaska Highway at the crossing of McIntyre Creek. The Fish Lake Road crosses NE-SW along the center of the claim group. The historic Copper King Mine is located 0.5 km east of the claims. Access is possible by car or truck to most areas of the claims.

## **TOPOGRAPHY, CLIMATE**

The DM 1-8 claims occupy a 1km wide valley of Porter and McIntyre Creeks. The elevation of the valley floor is 2500 feet. The north side of the valley rises steeply from the valley floor to an elevation of 3500 feet. Outcrop exposure is approximately 25%.

The climate of the area varies from a high of +30C in the summer to lows of -40C during the winter. Typical are long hot summers (May to September) with up to 18 hours of daylight and moderate to harsh winters (October to April) with less than 7 hours of daylight.

Black spruce is the most common tree species in the area. These favor the NE side of valleys and are a common indicator of local permafrost. More exposed areas have a mixture of white and black spruce with occasional pine. In the most exposed areas aspen colonies are well established. Willows are abundant in the valleys and low areas.

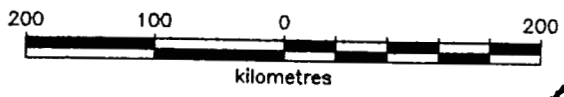
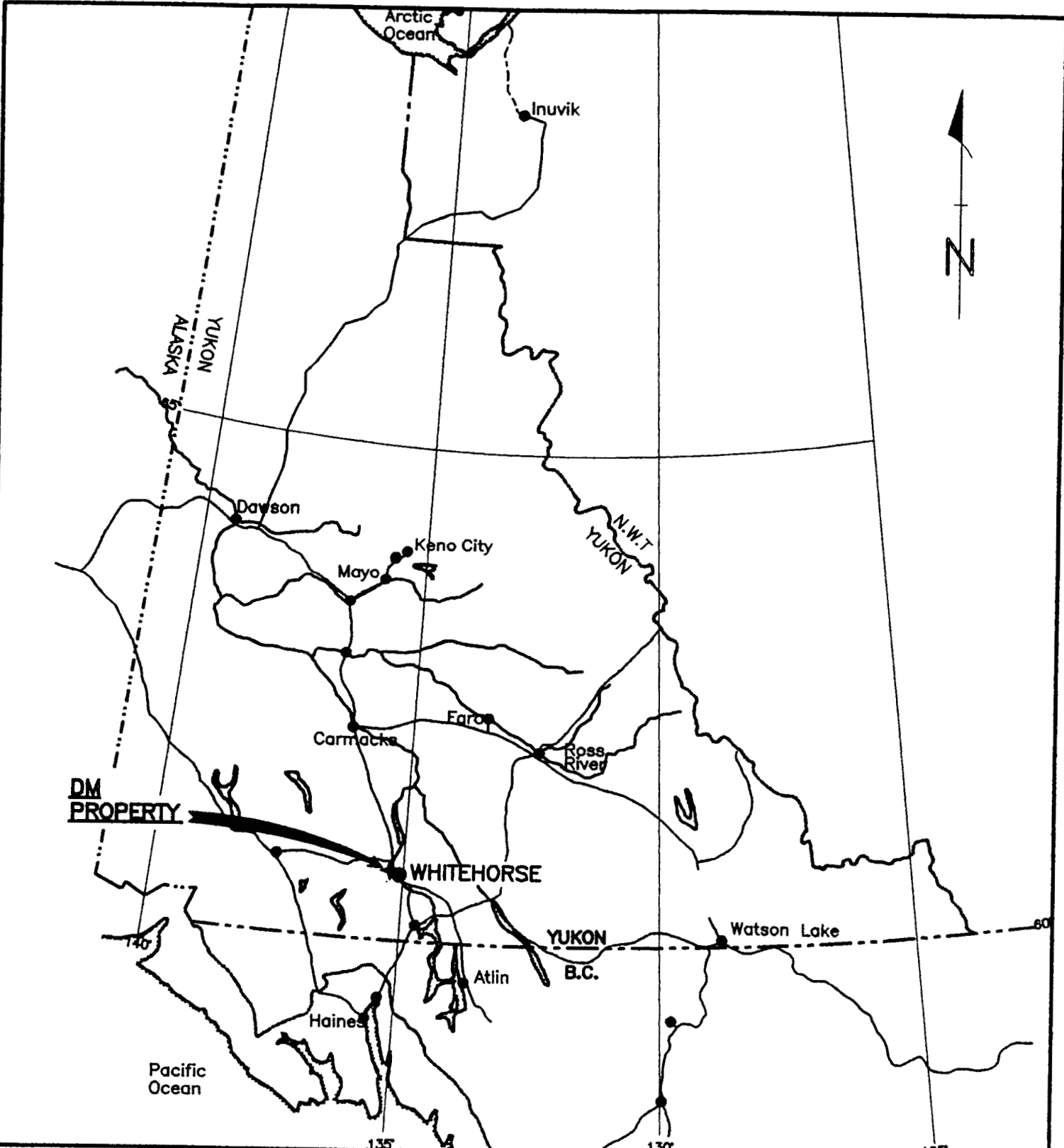

SIDROCK EXPLORATIONS  
 DM 1-8  
 WHITEHORSE MINING DISTRICT, YUKON TERRITORY

**LOCATION MAP**

## PROPERTY

The DM property comprise 8 full and fractional quartz mineral claims that cover an area of Triassic Lewis River Group limestone which has known copper -gold skarn mineral occurrences. The claims are all contiguous and cover some 160 hectares (Figure 2.) Current claim data are as follows:

**TABLE I: JACKSON CREEK Claim Data**

CLAIM NAME	GRANT NUMBERS	MINING DIST.	EXPIRY DATE *
DM 1-8	YB66276-YB66283	WHITEHORSE	2004/09/25
DM 11	YC18200	WHITEHORSE	2004/10/28
DM 12	YC18201	WHITEHORSE	2005/10/28

subject to approval of this assessment report

## EXPLORATION HISTORY

Copper mineralization was reported in the Whitehorse area by miners traveling to the Klondike in 1897. Mr. Jack McIntyre staked the Copper King claim in 1898. Ore was first shipped from the Copper King in 1900. Prospecting in the area generated many mines including the; Arctic Chief, the Pueblo Mine, the Little Chief, War Eagle and others. Mining, milling, the shipping of copper ore continued till the 1980's. Total production from 1898 to 1982 was 10,130,000 tonnes grading 1.5% Cu.

## REGIONAL GEOLOGY

The Whitehorse Copper Belt is located in the Whitehorse Trough a subdivision of the Intermontane Belt. The Whitehorse Trough is a NW trending Island Arc Complex containing clastic and carbonate rocks ranging from upper Paleozoic to Jurassic. Rocks of the Triassic Lewes River Group and lower Jurassic Laberge group are found in the Whitehorse Copper Belt. A Cretaceous quartz monzonite to granodiorite batholith intrudes to the west resulting in the significant copper skarn mineralization of the Whitehorse Copper Belt.



## PROPERTY GEOLOGY

Rocks of two units are exposed on the property (see fig 3). Triassic Lewis River group limestones and rusty weathering pyritic sandstone and siltstone are cut by mid-Cretaceous Whitehorse batholith biotite-hornblende monzonite to granodiorite. The Porter Creek fault bisects the claims and is the locus of malachite and azurite mineralization.

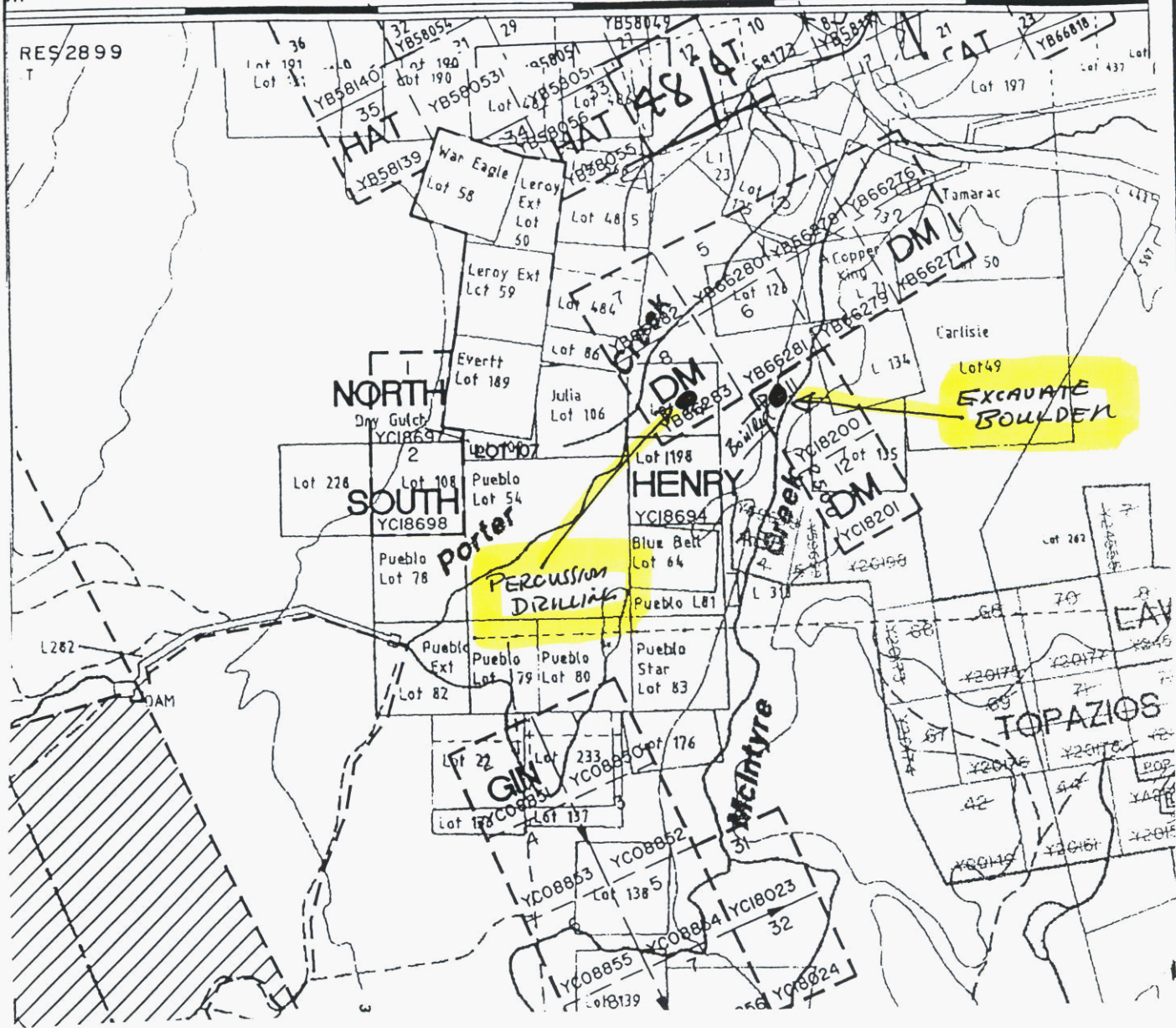
RES 2899  
T



Legend

-  CLAIM #
-  GRANT #

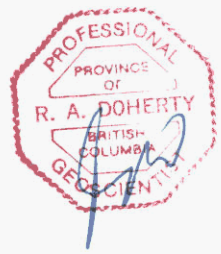
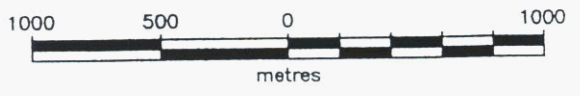

SIDROCK EXPLORATIONS	
DM 1-8	
WHITEHORSE MINING DISTRICT, YUKON TERRITORY	
<b>CLAIM MAP</b>	
Aurum Geological Consultants Inc.	Date: APRIL, 1997
NTS: 105 D/11	Drawn: JC
Scale: 1:30000	Figure:

## 2000 WORK PROGRAM

Work was completed on the DM 8 and DM 11 claims. Work on the DM 8 consisted of 18' of percussion drilling in three holes. Samples of the drilling dust were collected for analyses but were subsequently lost or misplaced. On the DM 11 claim, approximately 7 hours of loader time were used to remove a large boulder for sawing at Sidrock's shop. The location of the work is shown on Figure 2.



## STATEMENT OF COSTS

2000 Assessment Work Valuation; DM 1-8, 11& 12 Claims, Fish Lake Road Lake Claims, 105 D-10. Work completed between July 25 and August 15, 2000 A total of 10 claims and \$2,500.00 of work applied.

### A. Personnel

Sid McKeown, July 25-August 15, 2000	1.5 days @ \$250/day	\$ 375.00
Dean Vollmer, HOE Operator July 25-August 15, 2000	1.5 days @ \$250/day	\$ 375.00

### B. Expenses

980 loader, (4 hrs at \$175/hr)	\$ 700.00
Volvo Loader, (3 hrs @ \$90/hr)	\$ 270.00
Pungar Drill rental ( 1 days @ \$100/day)	\$ 100.00
Saw cross section	\$ 660.00

### C. Report Costs

Report Writing and Drafting	\$ 200.00
<b>Sub-Total</b>	<b>\$2,680.00</b>
GST (7% of \$2,680)	\$ 187.60
<b>TOTAL ASSESSMENT VALUE</b>	<b>\$2,867.60</b>

## STATEMENT OF QUALIFICATIONS

I, R. Allan Doherty, with business address:  
Aurum Geological Consultants Inc.  
P.O. Box 4367  
Whitehorse, Yukon  
Y1A 3T5

1. I am a geologist with AURUM GEOLOGICAL CONSULTANTS INC., P.O. Box 4367, Whitehorse, Yukon.
2. I am a graduate of the University of New Brunswick, with a degree in geology (Hons.B.Sc., 1977) and that I attended graduate school at Memorial University of Newfoundland (1978-81). I have been involved in geological mapping and mineral exploration continuously since then.
3. I am a member of the Association of Professional Engineers and Geoscientists of the Province of British Columbia, Registration No. 20564.
4. I have based this report on property work completed between July 25 and August 15, 2000. Work was supervised by Sid McKeown. I visited the property on August 10, 2000.
5. I consent to the use of this report by Sidrock Ltd., for assessment purposes only.

May 7, 2001

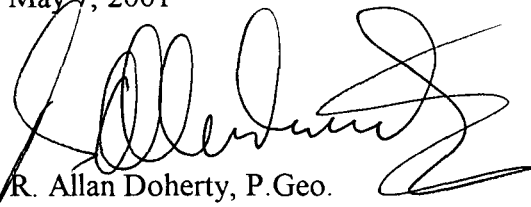
  
R. Allan Doherty, P. Geo.