

REPORT ON THE 1998  
ASSESSMENT WORK  
ON THE PEEL 32-35 CLAIMS

Whitehorse Mining District, Yukon Territory  
NTS 105 D/11  
May 22-September 20, 1998  
Yukon Quartz Claims

Peel 32-35 - YB66855-858

093905

For: Brian Scott  
Box 66  
Tagish, Yukon  
Y0B 1T0

By: Joseph A. J. Clarke  
Whitehorse, Yukon

November 5, 1998

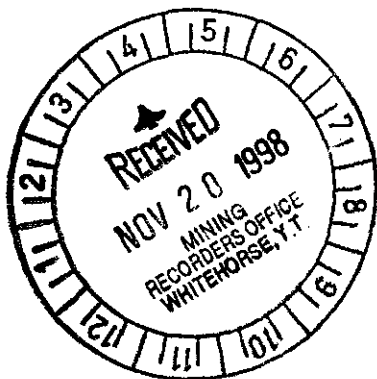

This permit has been examined by  
the Geological Evaluation Unit  
under Section 53 (4) Yukon Quartz  
Mining Act and is allowed as  
representation work in the amount  
of \$ 800.00.

*M. B. ...*  
Regional Manager, Exploration and  
Geological Services for Commissioner,  
Yukon Territory.

<b>INTRODUCTION .....</b>	<b>3</b>
<b>LOCATION AND ACCESS .....</b>	<b>3</b>
<b>PROPERTY .....</b>	<b>3</b>
<b>HISTORY.....</b>	<b>3</b>
<b>PHYSIOGRAPHY .....</b>	<b>4</b>
<b>GEOLOGY AND EXPLORATION.....</b>	<b>4</b>
<b>Geology .....</b>	<b>4</b>
<b>Work Program - 1998 .....</b>	<b>4</b>
<b>CONCLUSIONS AND RECCOMENDATIONS .....</b>	<b>5</b>
<b>REFERENCES .....</b>	<b>6</b>
<b>STATEMENT OF QUALIFICATIONS .....</b>	<b>7</b>
<b>STATEMENT OF COSTS.....</b>	<b>8</b>
<b>DRILL LOGS .....</b>	<b>10</b>

## INTRODUCTION

This report was prepared at the request of Mr. Brian Scott, owner of the Peel 32-35 claims. It describes work done over the spring and summer of 1998 to satisfy assessment requirements under the Yukon Quartz Mining Act.

The Peel 32-35 is located 15 kilometers west of Whitehorse and is accessible by road.

Work completed by Mr. Scott included prospecting, mechanized auger drilling, and stream sediment collection. Total expenditures were \$887.50.

## LOCATION AND ACCESS

The Banana Property is located 15 kilometers southwest of the City of Whitehorse (Figure 1). The Property is accessible by a 4 wheel drive road leading past Louise and Franklin Lakes. Winter access may require the use of snowmobile if the road is unplowed.

The approximate geographical center of the Property is located at 60 42' N and 135 20' W.

## PROPERTY

The Peel 32-35 claim group consist of 4 contiguous quartz mining claims on map sheet 105 D/11. The claims are unsurveyed. The claims can be considered to part of the Banana Property also owned by Mr. Scott but as they are not contiguous with that Property they will be considered as a separate for purposes of this report. The present claim holder obtained the property by way of transfer in May, 1998.

## HISTORY

Copper mineralization was reported in the Whitehorse area by miners traveling to the Klondike in 1897. Mr. Jack McIntyre staked the Copper King claim in 1898. Ore was first shipped from the Copper King in 1900. Prospecting in the area generated many mines including the; Arctic Chief, the Pueblo Mine, the Little Chief, War Eagle and others. Mining, milling, the shipping of copper ore continued till the 1980's. Total production from 1898 to 1982 was 10,130,000 tonnes grading 1.5% Cu. A significant amount of gold was also recovered from mining operations.

Property history is taken from Yukon Minfile 105D #076. The Peel 32-35 claims occupy the ground formally staked as the Ruth Roy and other claims claims.

*"Staked as Grouse, etc cl (Y63484) in Jul/70 by S. Takacs and E. Kreft, who added small blocks of fringe claims annually, including Gear cl (Y91133) in Sep/74. Explored with hand trenching and bulldozer trenching in 1970-72; with mapping, mag survey and 6 holes (445 m) by New Jersey Zinc (Grouse #4 and Ray #2 claims) under a brief option in 1972; and with more mapping, geochem surveys and bulldozer trenching in 1974, a magnetic survey and 6 holes (427 m) on the Gear claims in 1975 and 4 holes (472.4 m) in 1976 by Whitehorse Copper ML under option. Takacs drilled one hole (34.7 m) in 1979, 6 holes (36.0 m) in 1981, trenched in 1982, drilled 3 holes (92.4 m) in 1983, trenched and drilled 3 holes (35 m) in 1984 and added the Raven cl (YA93376) to the south in Sep/85. Kreft tied on the Ruth (YA94118) and Beaver cl (YA93146) in Aug/85 and Jan/86, respectively, and together with Takacs performed geological mapping, bulldozer trenching and 4 drill holes (455 m) on the Ruth cl. A. Olsson staked Dianne cl (YB27625) in Jul/90 and trenched in 1991. S.J. Takacs restaked the occurrence as Marie 1-4 cl (YB37478) in Sep/92. The Falcon 1-10 cl (YB46474) were staked nearby by R. Voisine in Oct/93."*

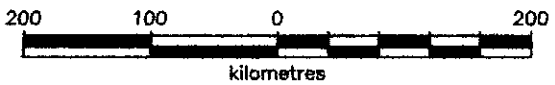
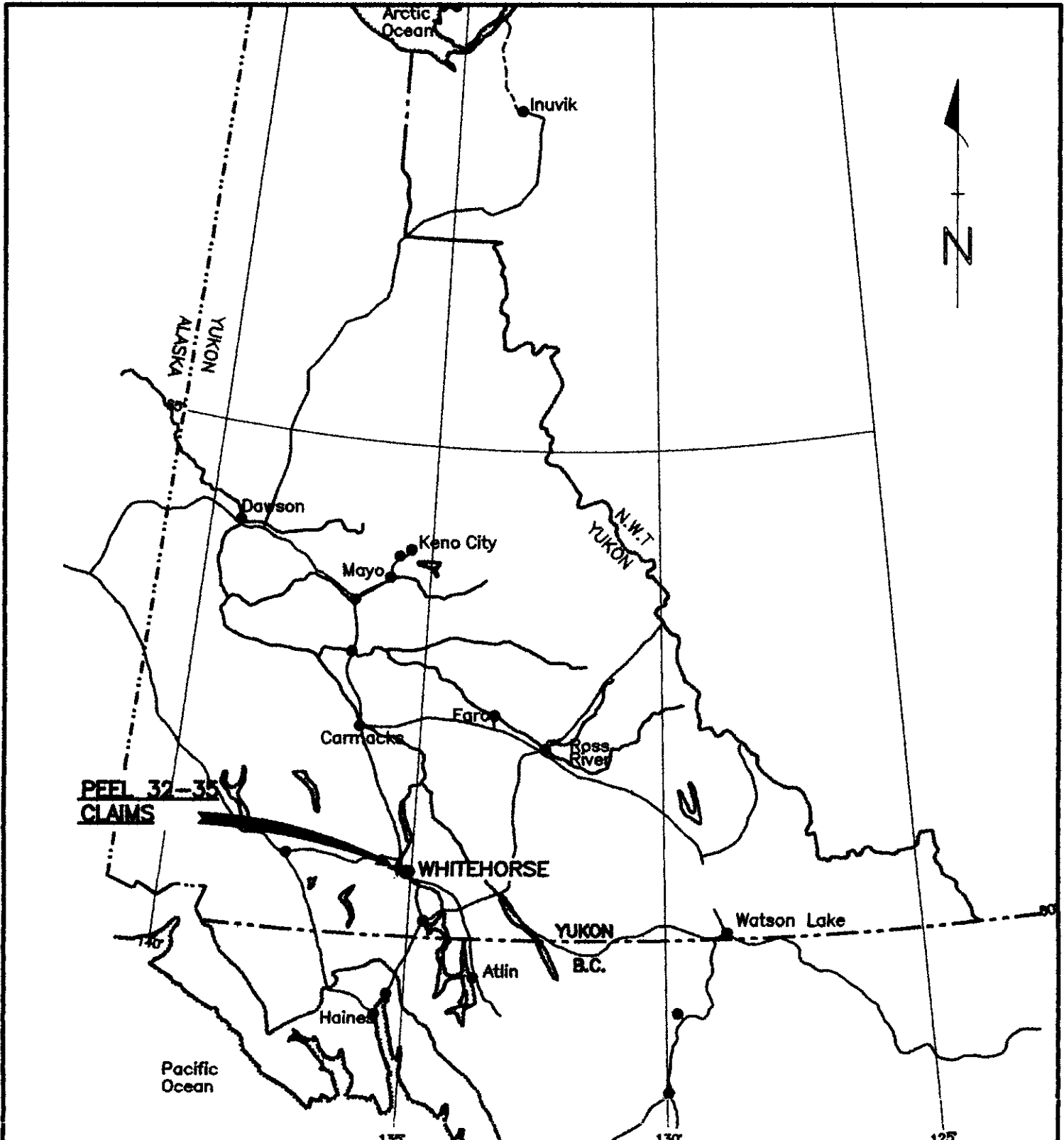

<b>BRIAN SCOTT</b>	
<b>PEEL 32-35 CLAIMS</b>	
WHITEHORSE MINING DISTRICT, YUKON TERRITORY	
 <b>LOCATION MAP</b>  	
<i>Aurum Geological Consultants Inc.</i>	Date: NOVEMBER, 1998
NTS: 105 D/11 Drawn: JC	Scale: 1:600000 Figure: 1

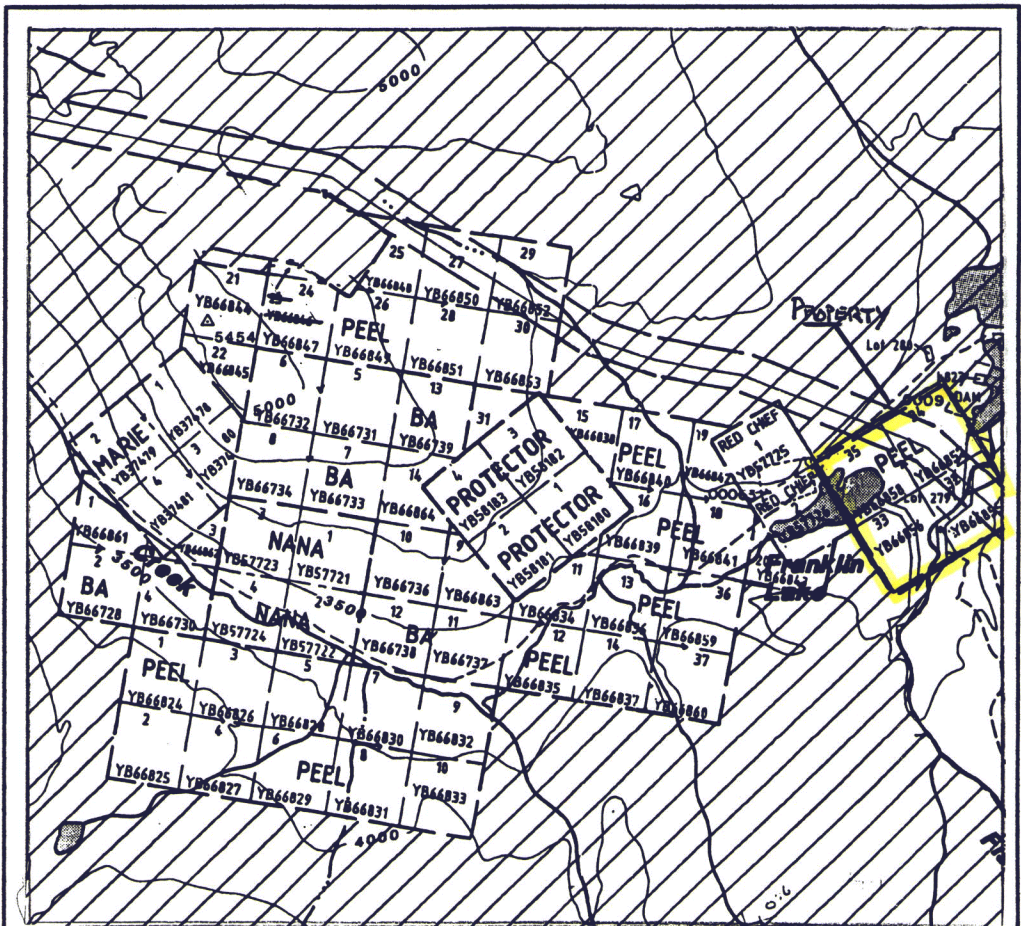

Legend

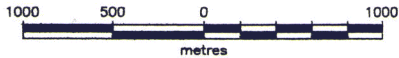

BRIAN SCOTT	
PEEL 32-35 CLAIMS	
WHITEHORSE MINING DISTRICT, YUKON TERRITORY	
<b>CLAIM MAP</b>	

A total of 6303 feet of diamond drilling has been performed on the nearby Banana Property between 1972 and 1986. Results include; 20.1 feet @ 5.6% Cu, 7.9 opt Ag and 1.3 feet @2.55 opt Au, 5.8% Bi (Whitehorse Copper Mines, 1975,76), 4.3 feet @ 0.20 opt Au (M. Nichiporek, 1983).

## **PHYSIOGRAPHY**

The Peel 32-35 occupy the valley and the north side Jackson Creek. Elevation ranges from 4150' to 5000'. Outcrop exposure is approximately 25%.

The climate of the area varies from a high of +30C in the summer to lows of -40C during the winter. Typical are long hot summers (May to September) with up to 18 hours of daylight and moderate to harsh winters (October to April) with less than 7 hours of daylight.

Black spruce is the most common tree species in the area. These favor the NE side of valleys and are a common indicator of local permafrost. More exposed areas have a mixture of white and black spruce with occasional pine. In the most exposed areas aspen colonies are well established. Willows are abundant in the valleys and low areas. Wildlife in the area is typical of the Southern Yukon and includes moose, black and grizzly bear.

## **GEOLOGY and EXPLORATION**

### ***Geology***

The Whitehorse Copper Belt is located in the Whitehorse Trough a subdivision of the Intermontane Belt. The Whitehorse Trough is a NW trending Island Arc Complex containing volcanic, clastic and carbonate rocks ranging from upper Paleozoic to Jurassic. Rocks of the Triassic Lewes River Group and lower Jurassic Laberge group are found in the Whitehorse Copper Belt. A Cretaceous quartz monzonite to granodiorite batholith intrudes to the west resulting in the significant copper skarn mineralization of the Whitehorse Copper Belt.

Property geology is taken from Keyser 1997 describes the nearby Banana Property ;

“Exploration carried out on the Banana Property since 1970 has identified irregular calc-silicate and magnetite skarn developed along the intrusive contact between Lewes River Group carbonate rocks and Eocene granite and granodiorite. Skarn zones up to 30m thick have been identified at intrusive-carbonate, intrusive-silicate, and siltstone-carbonate contacts. Metallic minerals are dominated by chalcopyrite, magnetite, bornite, and pyrrhotite, with the best copper mineralization associated with actinolite-diopside-magnetite skarn.”

Outcrop exposure is minimal on the Peel 32-35 claims. It is expected that rocks similar to those found on the Banana Property occur as sub-crop. It should be noted that at elevations below 1200 meter outcrop exposure is rare or non-existent due to thick debris cover.

### ***Work Program - 1998***

Fieldwork performed in 1998 consisted of a modest overburden drill program, reconnaissance prospecting, and stream sediment collection.

The Spring, 1998 program consisted of drilling 3- 3' auger drill holes to test overburden depth and obtain samples for soil analysis. A “Minuteman” mobile auger drill capable of drilling 30 feet in unconsolidated material was used in an area on the north side of Franklin Lake on the Peel 35 claim. The site is located approximately 35 meters south of the access road. Permafrost was encountered in all holes with the deepest hole being 4 meters. No outcrop or significant mineralized soils was discovered.

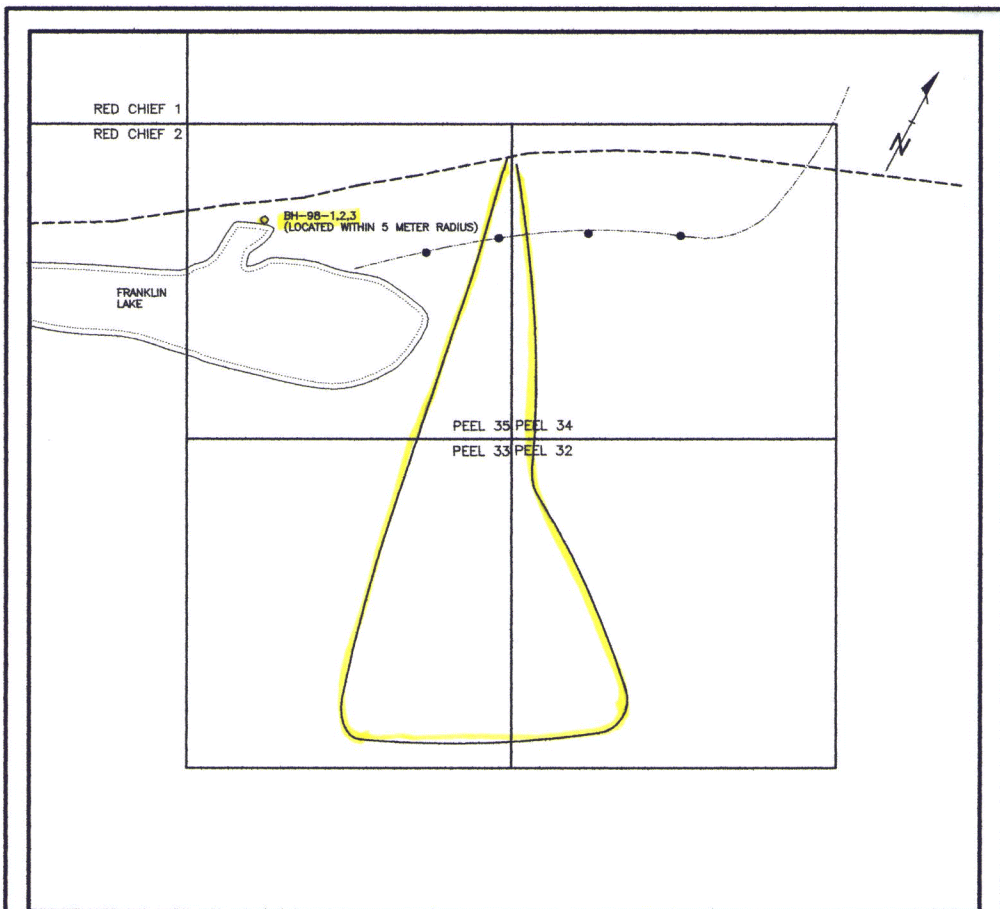

### LEGEND

- CREEK
- - - ROAD
- LAKE
- STREAM SEDIMENT SAMPLE (ASSAYS PENDING)
- ▬ TRAVERSE LINE

<b>BRIAN SCOTT</b>	
<b>PEEL 32-35</b>	
WHITEHORSE MINING DISTRICT, YUKON TERRITORY	
<b>DRILL HOLE LOCATION EXPLORATION WORK</b>	
<i>Aurum Geological Consultants Inc.</i>	Date: NOVEMBER, 1998
NTS: 105 D/11 Drawn: JC	Scale: Figure: 3



On September 22, 1998 a reconnaissance traverse was conducted over the claim group and four stream sediment samples were collected from upper Jackson Creek. Assay results are pending. No outcrop was encountered on the traverse.

## **CONCLUSIONS AND RECCOMENDATIONS**

The Peel 32-35 claims are located within the Whitehorse Copper Belt and historical copper and gold mineralization discovered to date on the nearby Banana Property consists of both skarn and possible low grade-bulk tonnage gold and copper types. Location and access of the Peel 32-35 claims allow lower cost exploration. With the close proximity of the Banana Property and the potential for on strike mineralization it is recommended that further work continue on the Peel 32-35 claims. The following exploration work is recommended.

Further reconnaissance prospecting should be conducted to located any possible outcrop. A flagged grid should be established at a 100 meter interval. Use of a handheld GPS with an "averaging feature" should assist in better locating topographical and geological features. Further hand and/or mechanical auger drill should be conducted to located sub-crop or mineralized soils.

If a flagged grid is established then a magnetometer/VLF survey should be conducted with 25 meter station. This survey may result in the discovery of anomalies that would warrant testing with the "Minuteman" auger drill.

Results from existing and future exploration work should be compiled digitally and merged with data from the Banana property.

## **REFERENCES**

**The Whitehorse Copper Belt: Mining, Exploration, and Geology (1967-1980)**  
by D. Tenny  
DIAND Bulletin 1

**The Whitehorse Copper Belt - A Compilation**  
Exploration and Geological Services Division-Yukon,  
Indian and Northern Affairs, Canada,  
Open File, 1:25000 scale map with marginal notes

**Yukon Territory**  
**Selected Field Reports of the GSC 1898 to 1933**  
Compiled and Annotated by H.S. Bostock  
GSC Memoir 284

**Report on the 1996 Geochemical Assessment Work on the Banana Property**  
Assessment Report by Harmen J. Keyser

Thanks also to conversations with the staff of Aurum Geological Consultants Inc., the staff of the Whitehorse MDA office, and many local prospectors.

## STATEMENT OF QUALIFICATIONS

I, Joseph A. J. Clarke, of Marsh Lake Yukon Territory with mailing address of General Delivery, Whitehorse, Yukon hereby certify:

I am writing this report at the request of Mr. Brian Scott of Tagish, Yukon and have no direct or indirect interest in the Banana Property;

That I have graduated from the Haileybury School of Mines in 1985 with a diploma in Mining Engineering Technology;

That I have been engaged in prospecting in the Yukon on a full time basis since May of 1993 and have been engaged in prospecting and in the mineral industry for 12 years elsewhere in Canada;

That I have a commitment to prospect in a gentlemanly manner with respect for others who use the land.

Signed at Whitehorse, Yukon Territory on the 2 day of Nov, 1998 .

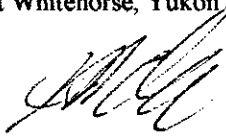

Joseph A. J. Clarke

## **STATEMENT OF COSTS**

Jackson Lake, May 22/98	Peel 32 - 35 Claims	0.5	Days
	<b>Item</b>	<b>Amount</b>	
<b>Wages</b>	B. Scott 0.5 day @ \$200/day	\$ 100.00	
	B. Carter 0.5 day @ \$200/day	100.00	
<b>Drill Rental</b>	Minuteman Auger Drill @ \$200/day	200.00	
<b>Support Costs</b>		50.00	
<b>Total</b>		<b>\$ 450.00</b>	
Jackson Lake, Sept. 22/98	Peel 32 - 35 Claims	1.0	Days
	<b>Item</b>	<b>Amount</b>	
<b>Wages</b>	B. Scott 1.0 day @ \$200/day	\$ 200.00	
	B. Carter 1.0 day @ \$200/day	200.00	
<b>Support Costs</b>		37.50	
<b>Total</b>		<b>\$ 437.50</b>	

## **DRILL LOGS**

**Peel 32-35 Claims, Whitehorse Mining District, 105 D/11. 1998 Auger Drill Program**

<b>Drill Logs</b>			
<b>Hole</b>	<b>Footage</b>	<b>Description</b>	
BH-98-1	0-3'	black muck	
	3-6'	light brown clay	
	6-8'	light brown clay	
			Drill refusal @8' due to permafrost
BH-98-2	0-5'	black muck	
			Drill refusal @5' due to permafrost
BH-98-3	0-2'	black muck	
	2-11'	gray sticky clay	
	11-12'	rusty clay	
			Drill refusal @12' due to permafrost
Note: No auger cuttings deemed suitable for geochemical analysis were obtained.			