

ASSESSMENT REPORT

ON THE

093734

MOON 1, 2 MINERAL CLAIMS

(Grant Nos: YB70836 - YB70837)

LOCATED AT

MCCONNELL RIVER

ON

NTS CLAIM SHEET 105 F - 10

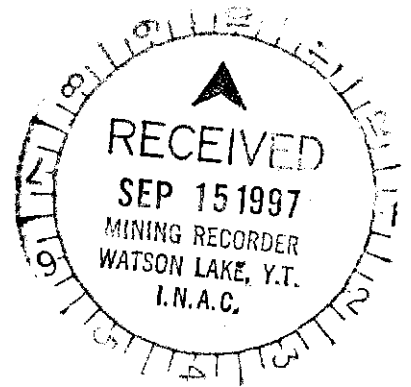

BY

GLEN C. MACDONALD, P. GEOL.

JUNE 15, 1997

This report has been examined by
the Geological Evaluation Unit
under Section 53 (4) Yukon Quartz
Mining Act and is allowed as
representation work in the amount
of \$ 200.00.

M. Burke
for Regional Manager, Exploration and
Geological Services for Commissioner,
of Yukon Territory.

TABLE OF CONTENTS

Introduction

1996 Soil Geochemical Survey

Summary and Conclusions

LIST OF FIGURES

- Figure 1: Location Plan
- Figure 2: Claim Plan
- Figure 3A: Soil Geochemical Survey Grid, Gold
- Figure 3B: Soil Geochemical Survey Grid, Silver

APPENDIX

- Appendix 1: Statement of Qualification
- Appendix 2: Statement of Costs
- Appendix 3: Assay Worksheets
- Appendix 4: List of Personnel

INTRODUCTION

During the 12th - 13th July, 1996, a four-man exploration crew, based from Ross River, conducted a soil geochemical survey over part of the Moon 1,2 claims. The survey was undertaken to try to locate the source of gold-silver bearing float mineralization located earlier. Soil samples were taken at 25 meter stations on grid lines spaced at 100 meter intervals.

GEOCHEMICAL SURVEY, 1996

A total of 35 soil samples were taken at 25 meter stations on grid lines spaced at 100 meter intervals. Samples were obtained by digging with a mattock to the "B" horizon, and placing approximately 250 grams of soil into a Kraft soil sample bag marked with the sample grid coordinates. Samples were sent to Cantech Laboratories in Calgary for analysis. Results are presented as FIGURE 3 of this report. Two samples returned anomalous values for gold and one sample was weakly anomalous in silver content.

SUMMARY AND CONCLUSION

A small soil sample grid was placed over the site of float boulders containing anomalous gold values. Only "spot" anomalies were detected and an apparent source for the float has yet to be located. Additional exploration to trace the gold-bearing float should include prospecting as the primary exploration tool.

GLEN MACDONALD, P. GEOL.

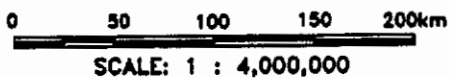
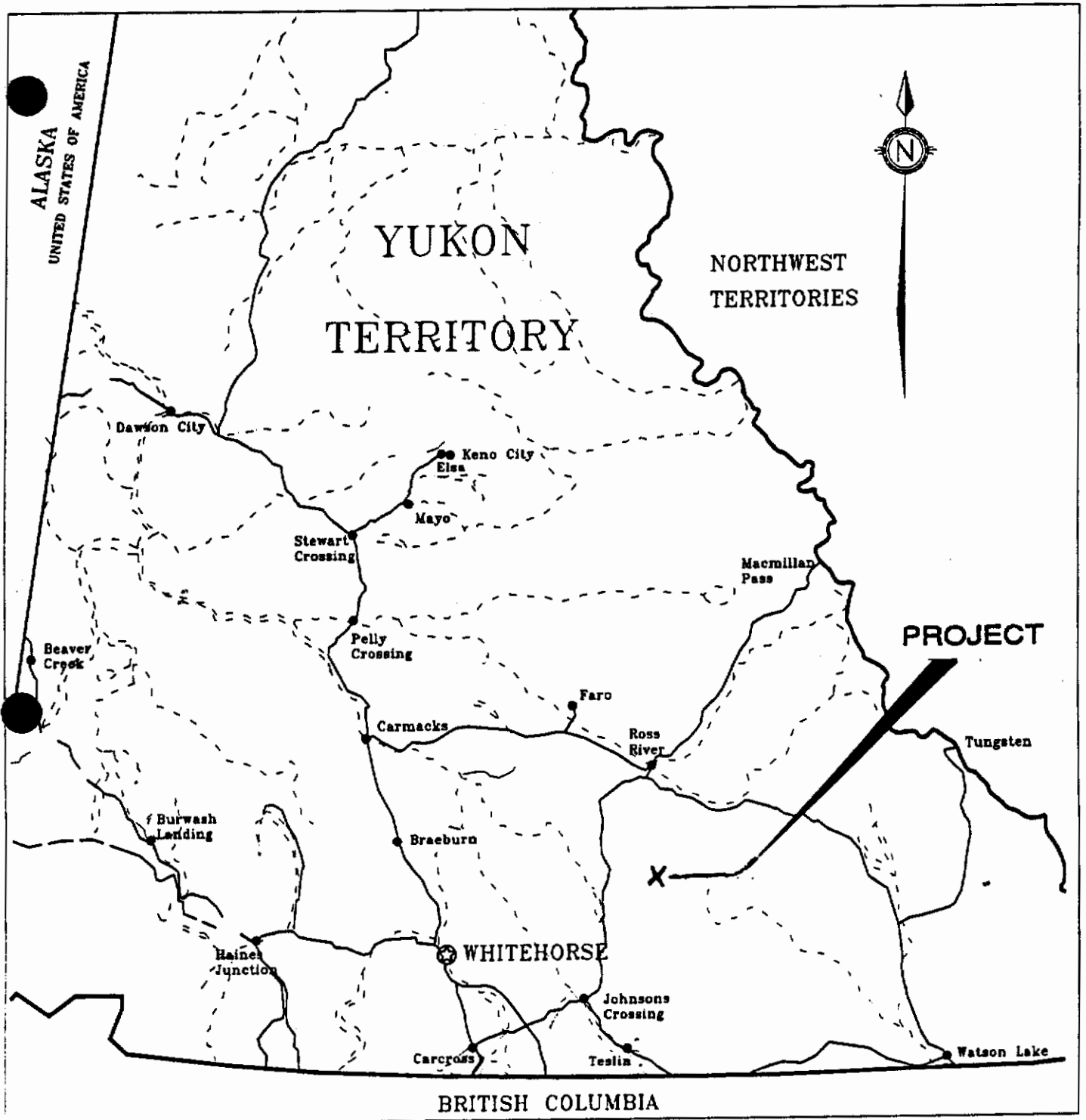

LOCATION MAP

LOCATION:	
DATE:	SCALE: 1 : 4,000,000
DRAWN: TerraCAD 96208	GEOLOGIST:
DATA:	FIGURE: 1

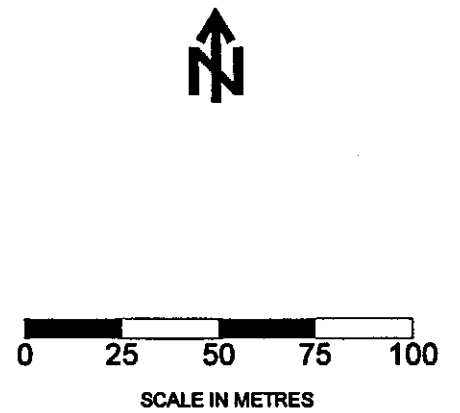
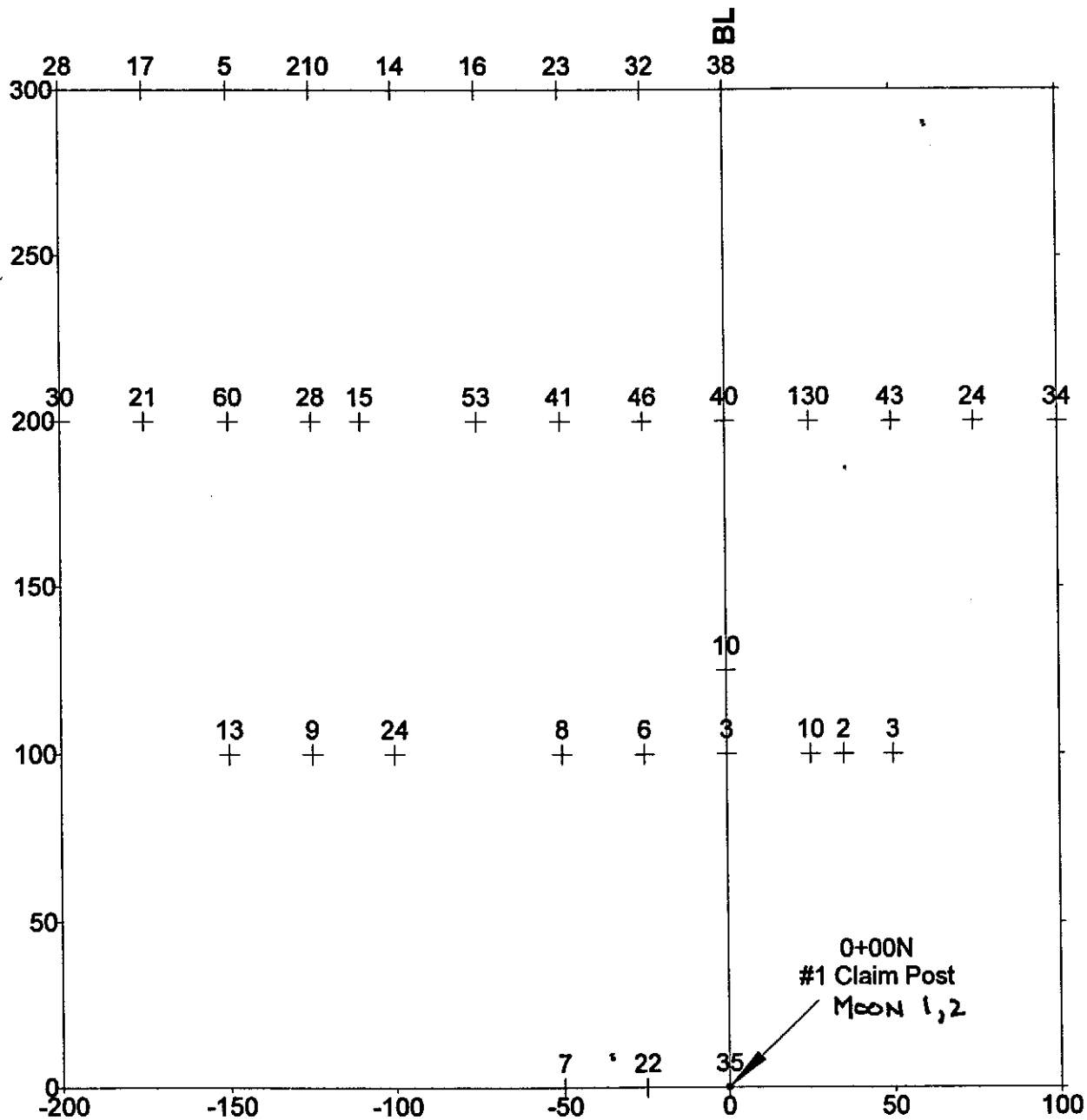

SOIL GEOCHEMISTRY GOLD (PPB)

1:2000

April 30, 1997

FIG 3A

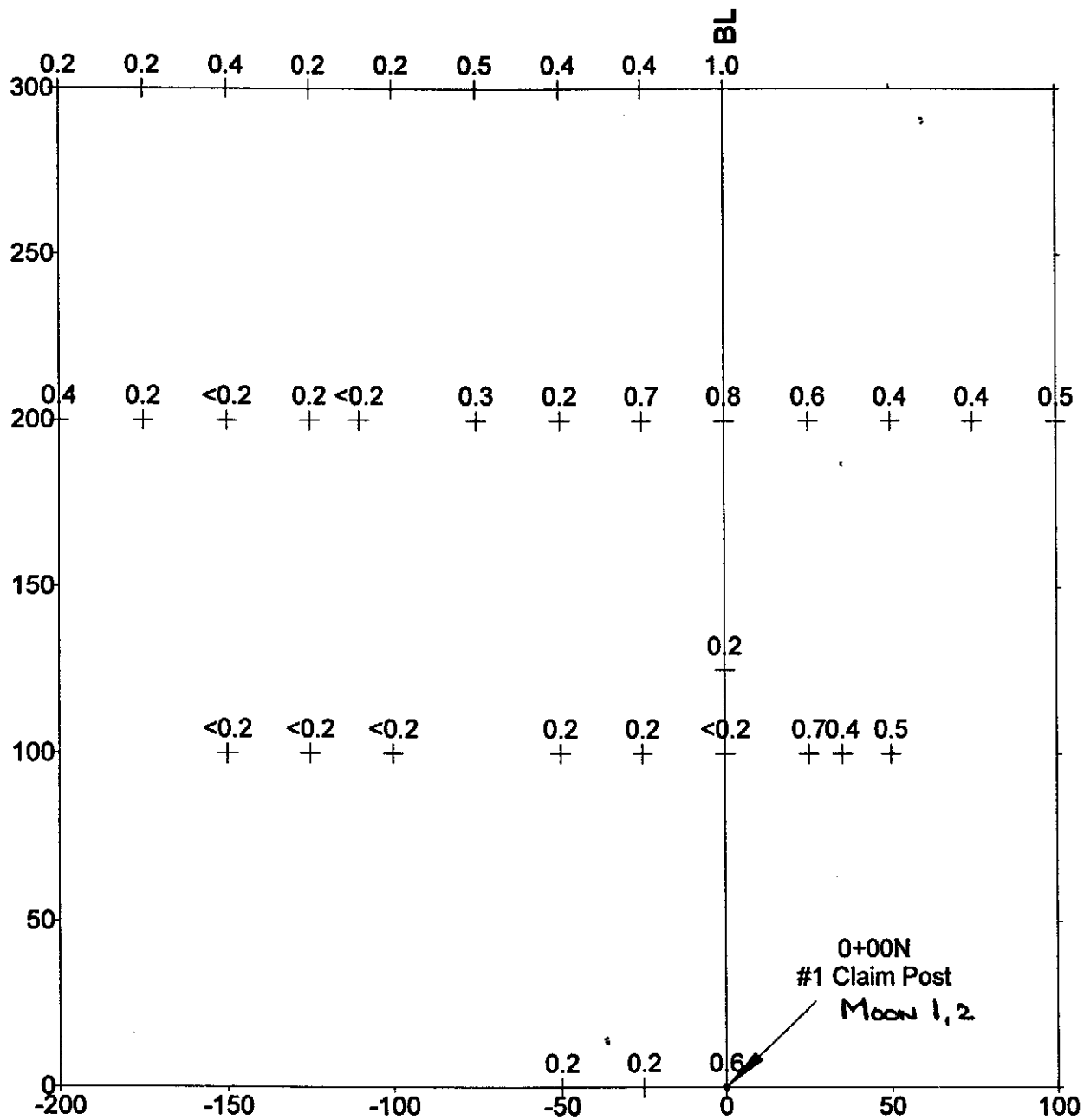

**SOIL GEOCHEMISTRY
SILVER (G/T)**

1:2000 April 30, 1997

Fig. 3B

APPENDIX 1

STATEMENT OF QUALIFICATION

I, Glen C. Macdonald, hereby confirm:

1. I am a graduate of the University of British Columbia (1973) with a B. Sc. degree in Geology.
2. I am a member of the Alberta Professional Engineers, Geologists and Geophysicists Association.
3. I am a member of the Association of Professional Engineers and Geoscientists of British Columbia.

G Macdonald

APPENDIX 2

STATEMENT OF COSTS

COSTS

Airfare (Charter)	\$ 1251.58
Labour	800.00
Room and Board (Ross River)	<u>400.00</u>
	\$ 2451.58



REMIT PAYMENT TO:
TRANS NORTH AIR
 TRANS NORTH TURBO AIR LTD
 AIRPORT HANGAR "C" • WHITEHORSE • YUKON • Y.A. 3E4
 TELEPHONE (403) 668-2177 FAX (403) 668-3420

GLENN MACDONALD
 CHARTERER
 40 KETZA ENT
 BILLING ADDRESS

ACCOUNT NUMBER	KETZA ENT		
INVOICE NUMBER	10862		
INVOICE DATE	26	07	96
A/C TYPE	2063	A77NS	
FLIGHT DATE	13	07	96
PURCHASE ORDER NO.			

FUEL & OIL-X TNTA CUST.	TNTA FUEL USED	PAS LITRES	FROM
<input checked="" type="checkbox"/>	JP-4	1.5	ML

FROM	HOURS	REMARKS - NO. OF PASS - FREIGHT Kg
ML	1.5	SEABULL LOCALS

SUB	GL	AMOUNT			
1609	502	1050.00	1.5	@ 700 ⁰⁰	1050.00
1600	131	119.70		@	
0000	323	81.88			

TERMS: PAYABLE UPON RECEIPT OF INVOICE.
 2% INTEREST PER MONTH (24% PER ANNUM) WILL BE CHARGED ON ALL OUTSTANDING AMOUNTS OVER 30 DAYS. IF INTEREST IS NOT PAID, FUTURE FLIGHTS WILL BE ON A CASH BASIS.

X. *Glenn Macdonald*
 CHARTERER'S SIGNATURE

CHARTERER'S NAME (PRINTED)

INITIALS *GM*
 PILOT'S SIGNATURE

ENGINEER'S NAME
 MXW WEEKS

BKL BRENT

HOLDING TIME:	@	/ HR.	
FUEL	@	/ LITRE	
FUEL	171L	@ .70 / LITRE	119.70
MEALS & LODGINGS			
OTHER			
OTHER			
SUB TOTAL			1169.70
GOODS & SERVICES TAX			
REGISTRATION NO. R121483135			81.88

TOTAL \$ 1251.58

CARRIAGE SUBJECT TO TERMS OF PUBLISHED TARIFF.
 TARIFF AVAILABLE TO PUBLIC VIEW AT TRANS NORTH OFFICE.
THIS IS YOUR ONLY INVOICE - PAY UPON RECEIPT

APPENDIX 3

ASSAY WORK SHEETS



Attention: Glen Macdonald

Certificate of Analysis

Work Order: 9782-96
Date: July 23, 1996

KETZA GROUP
Suite 609
475 Howe Street
Vancouver, B.C. V6C 2B3

Sample Type - SOILS

Sample ID	Au ppb	Ag g/t	Sample ID	Au ppb	Ag g/t
0+00N, BL	35	0.6	2+00N, 0+75W	53	0.3
0+00N, 25W	22	0.2	2+00N, 1+10W	15	<0.2
0+00N, 50W	7	0.2	2+00N, 1+25W	28	0.2
1+00N, BL	3	<0.2	2+00N, 1+50W	60	<0.2
1+00N, 0+25E	10	0.7	2+00N, 1+75W	21	0.2
1+00N, 0+35E	2	0.4	2+00N, 2+00W	30	0.4
1+00N, 0+50E	3	0.5	3+00N, 0+00	38	1.0
1+00N, 0+25W	6	0.2	3+00N, 0+25W	32	0.4
1+00N, 0+50W	8	0.2	3+00N, 0+50W	29	0.4
1+00N, 1+00W	24	<0.2	3+00N, 0+75W	16	0.5
1+00N, 1+25W	9	<0.2	3+00N, 1+00W	14	0.2
1+00N, 1+50W	13	<0.2	3+00N, 1+25W	210	0.2
1+25N, BL	10	0.2	3+00N, 1+50W	5	0.4
2+00N, BL	40	0.8	3+00N, 1+75W	17	0.2
2+00N, 0+25E	130	0.6	3+00N, 2+00W	28	0.2
2+00N, 0+50E	43	0.4			
2+00N, 0+75E	24	0.4			
2+00N, 1+00E	34	0.5			
2+00N, 0+25W	46	0.7			
2+00N, 0+50W	41	0.2			

CanTech Laboratories, Inc.

Signed
Richard Wagner
Laboratory Supervisor

APPENDIX 4

LIST OF PERSONNEL

<u>NAME</u>	<u>RATE / DAY</u>
Glen Macdonald, Geologist 3789 West Island Highway Qualicum Beach, B.C. V9K 2C7	\$ 350
J.P.Loisselle, Prospector c/o 320 - 475 Howe Street Vancouver, B.C. V6C 2B3	\$ 200
Barclay Macdonald, Field Assistant 3789 West Island Highway Qualicum Beach, B.C. V9K 2C7	\$ 125
Dylan Godwin, Field Assistant 665 Gatensbury Street Coquitlam, B.C.	\$ 125