

OMNI RESOURCES INC.

TRUMPETER YUKON GOLD INC.

SKUKUM CREEK PROJECT



Wheaton River Area, Yukon Territory, Canada
N.T.S. 105D/3
Minfile # 105D-022
WH5 CLAIM
WHITEHORSE MINING DISTRICT

Assessment Report:
1996 TUNNELLING PROJECT

093638

To be applied for renewal of the Kid, Omni, Tex and Ern claims, filed 20 Sept., 1996
and the TM, Kuku and LB claims filed 22 April, 1997

Prepared by:
William D. Mann, M.Sc.
Chief Geologist

William D. Mann

TABLE OF CONTENTS

Summary	3
Statement of Expenses	6

FIGURES

Location Map - 1:30,000	4
1996 Drift and Drillhole Plan - 1:1,000	5

APPENDICES

Expenses Receipts	Appendix I
-------------------	------------

Skukum Creek Project
1996 Development Work
Assessment Report Summary

The Skukum Creek Mine (minfile # 105D-022) is located on Mt. Reid in the Wheaton River mining district, on NTS 105D-3 (see Location Map, page 4). Substantial mine development was undertaken in 1987 and 1988, and the project came close to production at that time. The project has two deposits which are accessed by workings and host proven and probable ore reserves, the Rainbow and Kuhn zones. The Skukum Creek mine workings were reopened in June 1996. Approximately 1100 cubic metres of ice were blasted from the 1300 Level near the portal by Main Street Mining Ltd. of Whitehorse. The ramp which provides access to the lower levels of the mine was dewatered from about 1260m elevation to about 1215m elevation, near the bottom of the ramp. Timbering was conducted at the 1225 Level where it crosses the ore zone. A drill access drift was driven 94.6 metres in the hangingwall of the Rainbow Zone from the 1225 crosscut at 3m by 3m minimum size in July (see Drift Plan, page 5). Three drill stations were slashed and screened at 25m intervals along the drift. The total excavation in rock was 1069 cubic metres, or about 2800 Tonnes. A report on the results of the 1996 diamond drilling program conducted from this drift is presented under separate cover. The mine workings are located on Quartz Mining Claims WH5, WH7 and Omni 2 fraction. The drill drift extension is located on the WH5 claim. The cost of the tunnelling work was \$403,629.21.

Geology of the 1225 Drill Drift

The drill drift was driven in the hangingwall of the Rainbow Zone, entirely within granodiorite of the Mt. Reid formation, and was not expected to intersect mineralization. The granodiorite has variable textures and composition. In this location the unit is cut by numerous minor faults with variable orientations. The fault surfaces tend to be irregular and non-planar. Fault and fracture surfaces are typically coated with sericite, with minor local clay. The rock in this area is moderately phyllic-altered, with abundant sericite and weak to moderate pyrite, quartz and clay. Relict propylitic alteration is locally present, characterized by chlorite and minor epidote. The rock is commonly calcareous. The only mineralization of interest noted was a one centimetre wide, steeply dipping quartz-calcite-galena-chalcopyrite veinlet located at the central drill station.

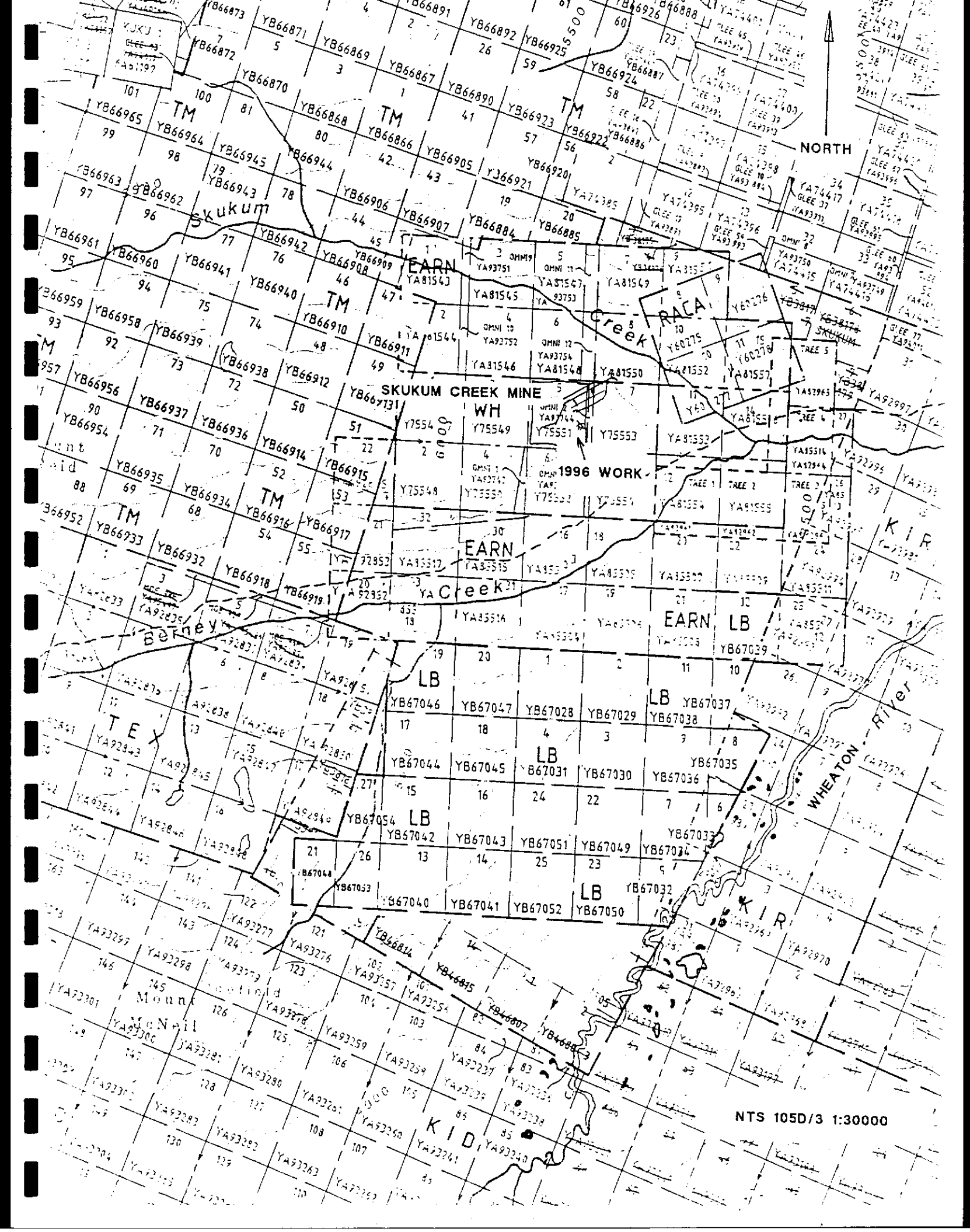

NORTH

SKUKUM CREEK MINE
WH
1996 WORK

Creek RACA

WHEATON RIVER

NTS 105D/3 1:30000

Skukum Creek Mine
1996 Drilling Plan

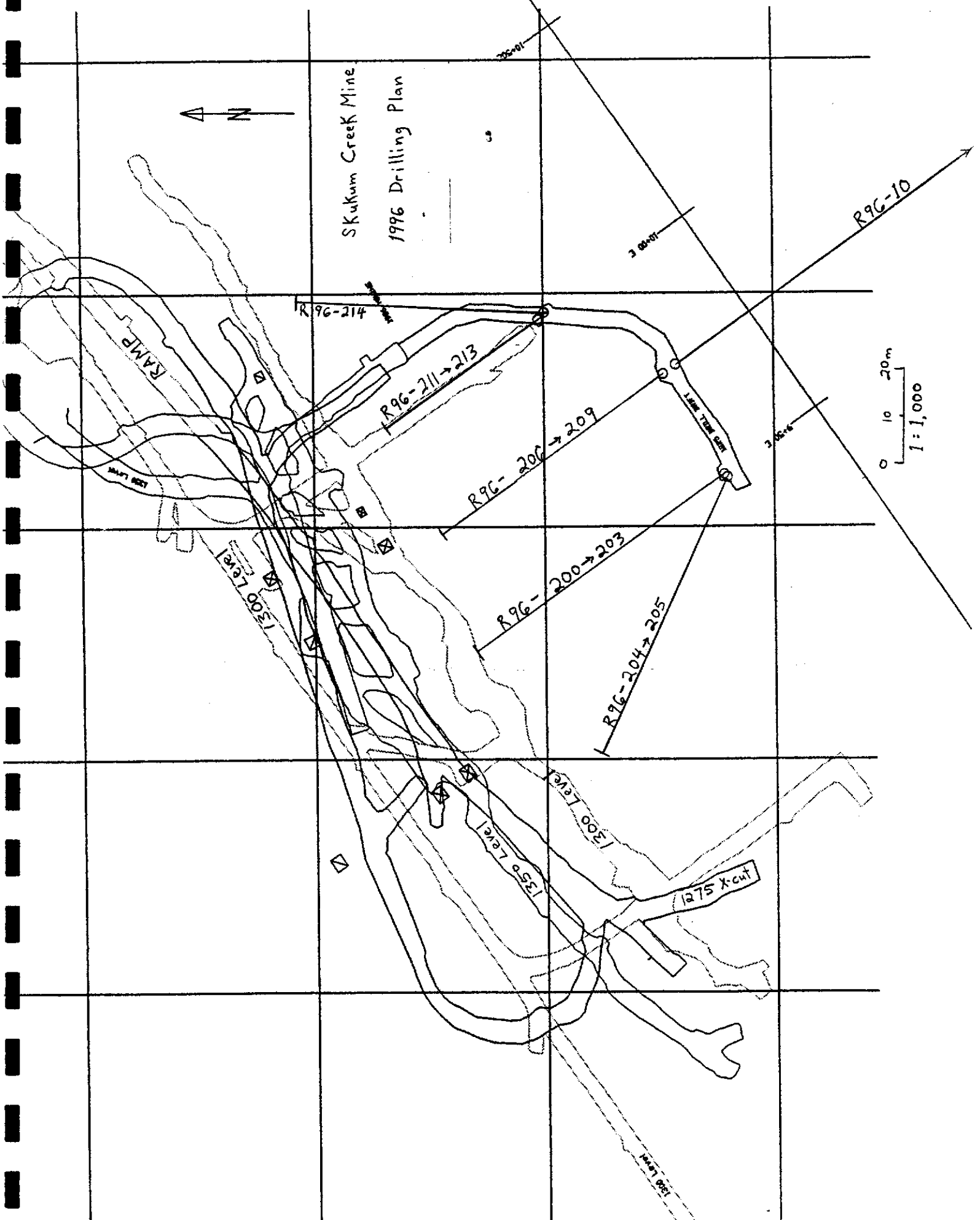
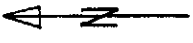

0 10 20m
1:1,000

