

**1996 GEOCHEMICAL
ASSESSMENT REPORT
ON THE 093529
BOS 1-32 AND STOCK 1-32 CLAIMS**

Located in the Pyroxene Mountain Area
Dawson Mining District
Yukon Territory, Canada
NTS 115/O/1

63°02' North Latitude
138°25' West Longitude

-prepared for-

BOSTOCK HOLDINGS LIMITED
Whitehorse, Yukon

-prepared by-

PAMICON DEVELOPMENTS LIMITED
Michael A. Stammers, P. Geo.

DATE WORK PERFORMED: July 19, 1996

DATE OF REPORT: December, 1996



**1996 GEOCHEMICAL ASSESSMENT REPORT
ON THE BOS 1-32 AND STOCK 1-32 CLAIMS**

TABLE OF CONTENTS

	<u>Page</u>
1.0 INTRODUCTION	1
2.0 LIST OF CLAIMS	1
3.0 LOCATION, ACCESS AND PHYSIOGRAPHY	1
4.0 EXPLORATION HISTORY	2
5.0 1996 WORK PROGRAM	2
6.0 GEOCHEMISTRY	2
6.1 Rock Samples	2
6.2 Soil Samples	3
7.0 CONCLUSIONS AND RECOMMENDATIONS	3

APPENDICES

Appendix A	List of Personnel
Appendix B	Statement of Expenditure
Appendix C	Rock Sample Descriptions
Appendix D	Analytical Procedures and Certificates of Analyses
Appendix E	Geologist Certificate

LIST OF FIGURES

	<u>Following Page</u>	
Figure 1	Location Map	1
Figure 2	Claim Map	1
Figure 3	Sample Location Map	2

1.0 INTRODUCTION

This geochemical assessment report describes work conducted on the Bos and Stock (Bostock group) quartz mining claims completed on July 19, 1996. The property is located in west central Yukon, about 125 kilometres south of Dawson (Figure 1). This gold and platinum group metals property is owned by Bostock Holdings of Whitehorse, Yukon and field work and reporting was completed by Pamicon Developments of Vancouver, B.C. on behalf of Newmont Exploration Limited of Denver, Colorado. Newmont completed this work on behalf of Ronald McPhee (deceased), an associate of the ownership group.

Results for this one day field program were not encouraging enough to warrant additional work by Newmont at this time. However, a work program is recommended in this report to the property ownership.

2.0 LIST OF CLAIMS

The Bostock group comprising 64 quartz claims is located in the Dawson Mining District (Figure 2) and is owned by Bostock Holdings of Box 4006, Whitehorse, Yukon. The following is a list of claim information as supplied by the Mining Recorder, Dawson Mining District:

<u>Claim Name</u>	<u>Record Numbers</u>	<u>Record Date</u>	<u>Expiry Date</u>	<u>NTS Map</u>	<u>No. of Claims</u>
Bos 1-32	YB53565-596	11/25/95	11/25/97*	115/O/1	32
Stock 1-32	YB53597-628	11/25/95	11/25/97*	115/O/1	32

* Subject to the approval of work filed in this assessment report.

3.0 LOCATION, ACCESS AND PHYSIOGRAPHY

The Bostock claims are located 125 kilometres south of Dawson, immediately west of Pyroxene Mountain (elevation 4551 feet) and south of Wahalla Creek. Approximate coordinates for the property are 63° 02' North latitude and 138° 25' West longitude. Access to the property in 1996 was by helicopter from Dawson City. An overgrown cat trail, reportedly originating 120 kilometres away at Pelly Crossing traverses along Walhalla Creek within 5.0 kilometres of the claim group. Two placer miner airstrips, whose conditions are unknown, are located within 20 kilometres of the property on Scroggie Creek.

Elevations on the claims range from 700 metres above sea level (ASL) in creek valleys to 1387 metres ASL at Pyroxene Mountain. Relief is gentle to moderate but traversing is difficult in the part of the property which was examined due to windfall and thick areas of buckbrush present in an old burn. Vegetation comprises dense second growth black spruce, willow, aspen and dwarf alder except at the highest elevations where a small portion of the property lies above tree line. Climate in the area is characterized by warm, short summers and long, cold winters with moderate amounts of precipitation, mainly in the form of snow.

PAMICON DEVELOPMENTS LTD.

BOSTOCK HOLDINGS

PYROXENE MOUNTAIN PROJECT

BOS 1-32 & STOCK 1-32 CLAIMS

YUKON TERRITORY

YUKON LOCATION MAP

DAWSON MINING DISTRICT

N.T.S.: 115-0-1

FIGURE 1

DATE: NOV 1996

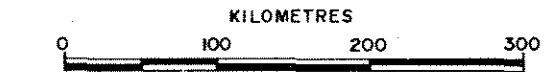

PROPERTY LOCATION

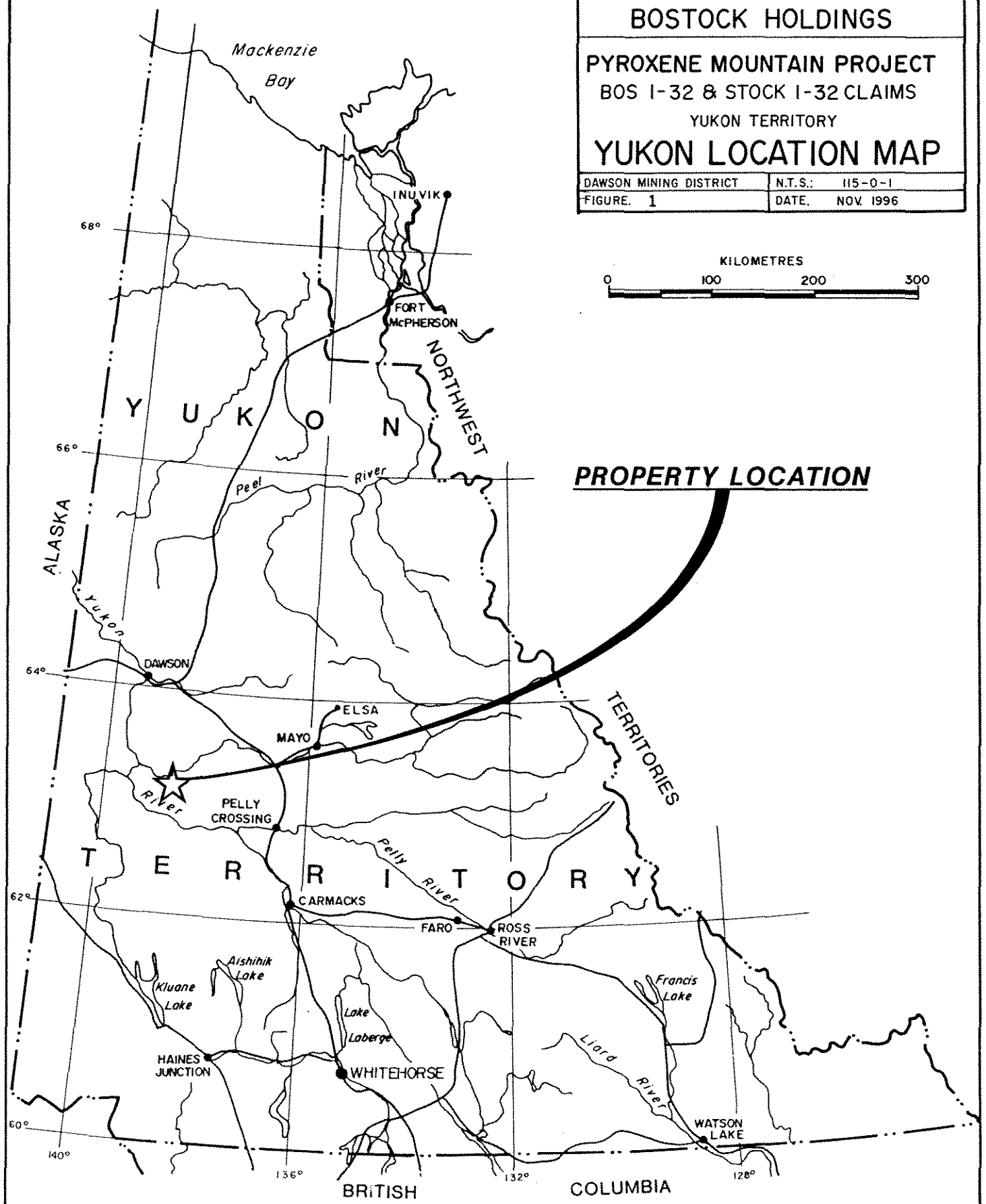



63°02'

CLAIM BOUNDARY

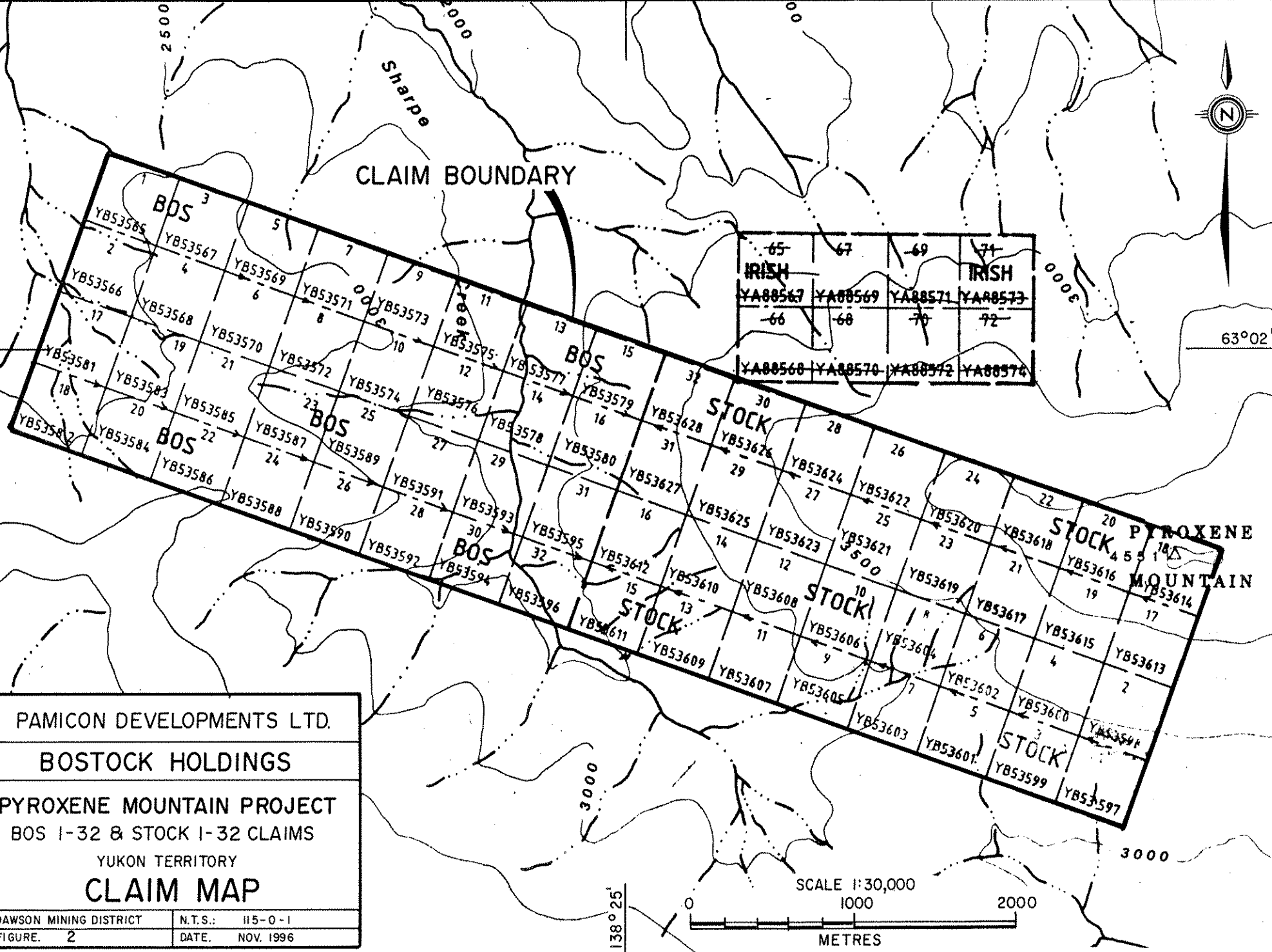

65	67	69	71
IRISH			IRISH
YA88567	YA88569	YA88571	YA88573
66	68	70	72
YA88568	YA88570	YA88572	YA88574

PAMICON DEVELOPMENTS LTD.	
BOSTOCK HOLDINGS	
PYROXENE MOUNTAIN PROJECT	
BOS 1-32 & STOCK 1-32 CLAIMS	
YUKON TERRITORY	
CLAIM MAP	
DAWSON MINING DISTRICT	N.T.S.: 115-0-1
FIGURE. 2	DATE. NOV. 1996

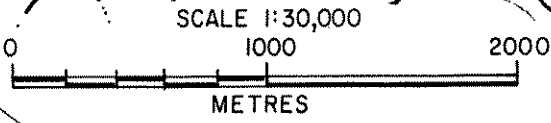

138°25'

4.0 EXPLORATION HISTORY

The most comprehensive exploration work was completed on a previously held claim group in 1987. This geochemical and geophysical work and a description of the regional geology, property geology and other historical reports is adequately described in DIAND Assessment Report 092088 by D.H. Waugh for M.J. Brady in a report dated January 1988.

The anomalous gold-platinum-palladium values obtained from rock and soil samples in 1987 were encouraging enough to warrant the 1996 property examination and field work program.

5.0 1996 WORK PROGRAM

The geochemical work program was completed on the property on July 19, 1996 utilizing a four man crew comprising two geologists and two samplers. A total of 10 rock samples and 27 soil samples were collected on this one day program on the Stock 25-30 and 32 claims. One geochemical standard reference sample was submitted along with the soil samples.

The two soil lines (L5000N at 050° and L7000E at 140°) were run perpendicular to each other with the start point for lines centred within 75 metres of the 1987 soil site (Station 10+625N, Line 1+200W) which returned a highly anomalous gold value of >10,000 ppb Au. This 1987 sample station, although not on the 1996 grid was located and resampled by geologists in an effort to duplicate the highly anomalous value (soil 1569). Line 5000N extended for 1300 metres, while L7000E ran 1700 metres. Sample intervals were 100 metres near the anomaly, increasing to 200 metres away from the area of interest. Every effort was made to collect 'B' horizon material with a soil mattock.

Ten rock samples were collected by geologists from outcrop and near source float material to ascertain precious metal content. The two float samples were collected near the 1987 anomalous gold soil pit of which one was stained with malachite.

Both rock and soil samples were shipped by truck to Chemex Labs in North Vancouver, B.C., dried and prepared and analyzed by fire assay (30 gm sample) for gold, platinum and palladium and for 24 element conventional ICP. Analytical procedures and complete results are presented in the appendices of this report.

6.0 GEOCHEMISTRY

6.1 Rock Samples

Sample locations are plotted on Figure 3 and rock description forms follow in the appendix. Eight of ten rock samples collected comprised pyroxenite. These brown-grey weathering, coarsely crystalline ultramafic rocks invariably contained magnetite and were commonly stained with both iron and manganese oxides along fracture planes and jointing. Alteration comprised

Summary of Results

Rocks (PPB)				Soils (PPB)			
Sample	Au	Pt	Pd	Sample	Au	P	Pd
23816	2	40	28	1517	2	1	12
23817	2	55	6	1518	2	5	18
23818	<2	10	2	1519	2	1	10
23819	<2	5	12	1520	2	5	22
23820	<2	35	4	1521	2	1	10
23821	12	25	40	1522	2	1	28
23822	<2	25	14	1523	39	<	<4
23823	<2	<5	<2	1524	6	1	22
23824	<2	10	2	1537	4	5	14
23825	<2	5	2	1538	2	2	2
				1539	<	1	4
				1540	<	1	4
				1541	4	1	16
				1542	<	6	4
				1543	4	5	8
				1561	<	1	18
				1562	<	1	14
				1563	<	1	<2
				1564	<	2	16
				1565	<	<	2
				1566	<	<	<2
				1567	<	<	4
				1568	<	<	4
				1569	2	1	16
				1570	1	<	<1
				1571	<	<	2
				1572	<	1	<2
				1573	<	2	2

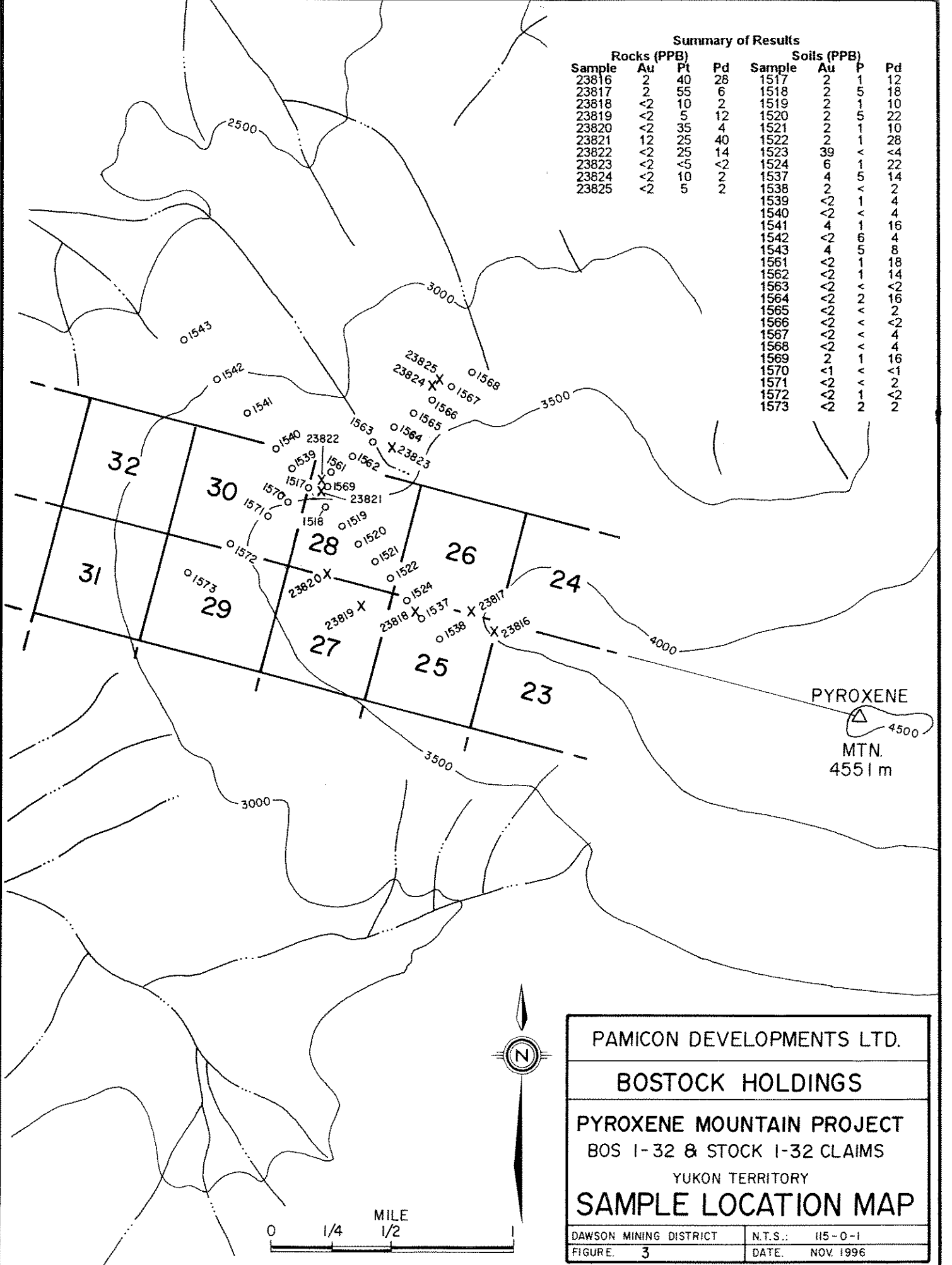

PYROXENE
MTN.
4551 m

PAMICON DEVELOPMENTS LTD.	
BOSTOCK HOLDINGS	
PYROXENE MOUNTAIN PROJECT	
BOS I-32 & STOCK I-32 CLAIMS	
YUKON TERRITORY	
SAMPLE LOCATION MAP	
DAWSON MINING DISTRICT	N.T.S.: I15-0-1
FIGURE 3	DATE: NOV. 1996

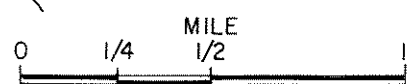

minor chlorite and rare carbonate. Two samples (23824, 825) were taken from coarse grained, feldspar rich pegmatite. Sample 23821 located near the anomalous (1987) soil pit was weakly stained with malachite and returned copper and gold values of 987 ppm and 12 ppb respectively. All other gold values were at or below detection limit (2 ppb). As expected from this pyroxenite rock type both chromium and nickel values are high with top values of 882, 1370 and 2050 ppm Cr; and 130, 160 and 355 ppm Ni. Platinum and palladium values were lower than expected with maximum values of 35, 40 and 55 ppb Pt; and 14, 28 and 40 ppb Pd.

6.2 Soil Samples

Soil results for gold-platinum-palladium are plotted on Figure 3 along with the sample number. All other elements can be cross referenced in the appendix. Gold values are not considered anomalous peaking out at only 4, 4, and 6 ppb. The high gold value of 396 ppb on the assay certificate (1523) is from an analytical standard. Platinum values are slightly higher, peaking at 15 ppb, but are still not considered anomalous. Palladium values contain some weakly anomalous results including 18, 22 and 28 ppb. Other elements associated with an ultramafic sequence of rocks including chromium, copper and nickel are moderately anomalous. Maximum values include 576, 457, and 316 ppm Cr; 205, 141 and 125 ppm Cu; and 110, 80 and 74 ppm Ni.

Soil sample 1569 with a gold result of 2 ppb was collected from a soil pit (Station 10+625N, Line 1+200W) that returned a value of >10,000 ppb Au in 1987. The absence of gold in this year's sampling may indicate the presence of coarse gold or a spurious result from the 1987 work.

7.0 CONCLUSIONS AND RECOMMENDATIONS

The 1996 work program on the Bostock property focused on a small portion of the property where the best results for gold-platinum-palladium were returned from the extensive 1987 geochemical sampling program. The positive results from the 1987 survey could not be duplicated in 1996. This may be in part to the limited nature of this most recent survey or perhaps is due to a sporadic distribution of gold and platinum group metals in the part of the property.

Further work on the Pyroxene Mountain property should comprise stream sediment sampling in all drainages. If warranted, followup of anomalous drainages with prospecting and soil sampling may lead to new areas favourable for detailed evaluation including geological mapping and trenching.

Respectively Submitted,

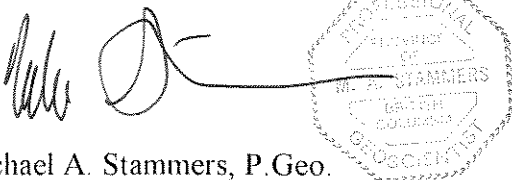

The image shows a handwritten signature in black ink, which appears to be 'M. A. Stammers'. To the right of the signature is a circular professional stamp. The stamp contains the text: 'PROFESSIONAL GEOLOGIST', 'M. A. STAMMERS', and 'GEOLOGICAL SOCIETY OF CANADA'. The stamp is partially overlapping the signature.

Michael A. Stammers, P. Geo.
PAMICON DEVELOPMENTS LIMITED

APPENDIX A
LIST OF PERSONNEL

APPENDIX A
LIST OF PERSONNEL

Mike Stammers (P. Geo.)
611-675 West Hastings Street
Vancouver, BC V6B 1N2

Richard Gorton (Geologist)
One United Bank Centre
1700 Lincoln Street
Denver, Colorado
USA 80203

Ed Sinnott (Sampler) -
Box 224
Mayo, Yukon Y0B 1M0

Kevin Hanson (Sampler)
611-675 West Hastings Street
Vancouver, BC V6B 1N2

APPENDIX B
STATEMENT OF EXPENDITURE

**APPENDIX B
STATEMENT OF EXPENDITURES**

CANADA -- In the matter of geochemical assessment work filed on the BOS 1-32 and STOCK 1-32 Claims

I, Michael A. Stammers agent for Bostock Holdings Limited, Box 4006, Whitehorse, Yukon, do solemnly declare that a program consisting of geochemical survey work was carried out on the Stock 25 - 30 and 32 Mineral Claims on July 19, 1996.

The following expenses were incurred during the course of this work and in the compilation and reporting of the results:

WAGES:	Mike Stammers (Senior Geologist)	1.5 days @ \$425	\$637.50	
	Richard Gorton (Senior Geologist)	1.5 days @ \$425	\$637.50	
	Ed Sinnott (Senior Sampler)	1 day @ \$275	\$275.00	
	Kevin Hanson (Junior Sampler)	1 day @ \$225	<u>\$225.00</u>	
				\$1,775.00
HELICOPTER:	Charter	2.9 h @ \$650/h	\$1,885.00	
	Fuel	2.9h @ \$75/h	<u>\$217.50</u>	
				\$2,102.50
TRUCK RENTAL:	Pamicon Truck	1 day @ \$75/d		\$75.00
ANALYSES:	Rocks	10 @ \$23.70	\$237.00	
	Soils	28 @ \$20.89	<u>\$584.85</u>	
				\$821.85
SUPPORT:	Dawson hotel	3 rooms @ \$90/d	\$270.00	
	Dawson meals	5 men @ \$50/d	\$150.00	
	Crew Positioning	travel/expenses est.	\$500.00	
	FM radios	4 @ \$10/day	\$40.00	
	Telephone/Fax	estimated	\$50.00	
	Base Maps	purchase/enlargement	\$100.00	
	Freight (samples out)	prorated	\$80.00	
	Field Supplies	estimated	<u>\$50.00</u>	
				\$1,240.00
REPORT:	Geologist	1.5 days @ \$425	\$637.50	
	Secretarial & Product	estimated	<u>\$362.50</u>	
				<u>\$1,000.00</u>
SUBTOTAL				\$6,939.35
PROJECT MANAGENT				
	10% on expenses	\$4,090.00		\$409.00
	5% on subcontracts	\$2,924.35		<u>\$146.22</u>
GRAND TOTAL				<u>\$7,494.57</u>

And I make this solemn declaration conscientiously believing it to be true and knowing that it is of the same force and effect as if made under oath and by virtue of the Canada Evidence Act.

Dated at Vancouver in the Province of British Columbia this 11 day of December, 1996.



Michael A. Stammers, P. Geo.

APPENDIX C
ROCK SAMPLE DESCRIPTION

P. IC DEVELO. AENTS LIMITED

Geochemical Data Sh - ROCK SAMPLING

NTS 115/0/1

Sampler M. STAMMERS, R. GORTON
Date JULY 19/96

Project NEWMONT
Property PYROXENE MOUNTAIN

Location Ref CHEX A9625971
Air Photo No

SAMPLE NO.	LOCATION	SAMPLE TYPE	Sample Width / True Width	DESCRIPTION			ADDITIONAL OBSERVATIONS	ASSAYS					
				Rock Type	Alteration	Mineralization		Au	Pt	Pd	Cr	Ni	Cu
23816	115/0-1	GRAB	25m	Pyroxenite	Mn Ox Fe Ox	Magnetite	Taken over 2 benches	2	40	28	1370	104	17
817	"	CHIP	0.6m	"	"	"	Strong FeOx on Joint Planes	2	55	6	657	96	3
818	"	CHIP	3m	"	"	"	Abundant Magnetite	2	10	2	2050	130	9
819	"	CHIP	2m	"	Mn+Fe Ox Chlor-CaCO3	"	Coarse Grain Pyroxenite	2	5	12	377	45	55
820	"	CHIP	2m	"	Limonite	"		2	35	4	810	355	4
821	"	CHIP	3m	"	Mn+Fe Oxides	Magnetite	ONLY METRES AWAY FROM SOIL PIT THAT RAN > 10K Au	2	25	40	892	160	987
822	"	CHIP	3m	"	"	Magnetite Magnetite	OLD GRID 10625N, 1200W SOIL 1569	2	25	14	263	50	127
823	"	CHIP	3m	FINE GRAIN PYROXENITE	LIMONITE	WK MAGNT.	POSSIBLE GABBRO OR OTHER BASIC RX	2	25	2	59	20	41
824	"	CHIP	2m	PEGMATITE	LIMONITE SERICITE-CHLOR	WK MAGNT.	PEGMATITE CUTS GABBRO? DYKELETS, FSBAR RICH	2	10	2	303	45	21
825	"	CHIP	3m	PEGMATITE XCRUS PYXENITE	RED Fe Oxides	none	Coarse Grain Pegmatite.	2	5	2	33	14	104

APPENDIX D

ANALYTICAL PROCEDURES
AND
CERTIFICATES OF ANALYSES



Chemex Labs Ltd.

Analytical Chemists * Geochemists * Registered Assayers

212 Brooksbank Ave., North Vancouver
British Columbia, Canada V7J 2C1
PHONE: 604-984-0221 FAX: 604-984-0218

To: PAMICON DEVELOPMENTS LIMITED
ATTN: MIKE STAMMERS
711 - 875 W. HASTINGS ST.
VANCOUVER, BC
V6B 1N4

A9625971

Comments: ATTN:MIKE STAMMERS FAX:R.GORTON CC:OWEN LAVIN

CERTIFICATE

A9625971

(BM S) - PAMICON DEVELOPMENTS LIMITED

Project: ALASKON
P.O. #:

Samples submitted to our lab in Vancouver, BC.
This report was printed on 6-AUG-96.

SAMPLE PREPARATION

CHEMEX CODE	NUMBER SAMPLES	DESCRIPTION
205	10	Geochem ring to approx 150 mesh
226	10	0-3 Kg crush and split
3202	10	Rock - save entire reject
285	10	ICP - HF digestion charge

ANALYTICAL PROCEDURES

CHEMEX CODE	NUMBER SAMPLES	DESCRIPTION	METHOD	DETECTION LIMIT	UPPER LIMIT
975	10	Au ppb: ICP-fluorescence package	FA-ICP-AFS	2	10000
976	10	Pt ppb: ICP-Fluorescence package	FA-ICP-AFS	5	10000
977	10	Pd ppb: ICP-fluorescence package	FA-ICP-AFS	2	10000
578	10	Ag ppm: 24 element, rock & core	AAS	0.2	200
573	10	Al %: 24 element, rock & core	ICP-AES	0.01	25.0
565	10	Ba ppm: 24 element, rock & core	ICP-AES	10	10000
575	10	Be ppm: 24 element, rock & core	ICP-AES	0.5	1000
561	10	Bi ppm: 24 element, rock & core	ICP-AES	2	10000
576	10	Ca %: 24 element, rock & core	ICP-AES	0.01	25.0
562	10	Cd ppm: 24 element, rock & core	ICP-AES	0.5	500
563	10	Co ppm: 24 element, rock & core	ICP-AES	1	10000
569	10	Cr ppm: 24 element, rock & core	ICP-AES	1	10000
577	10	Cu ppm: 24 element, rock & core	ICP-AES	1	10000
566	10	Fe %: 24 element, rock & core	ICP-AES	0.01	25.0
584	10	K %: 24 element, rock & core	ICP-AES	0.01	10.00
570	10	Mg %: 24 element, rock & core	ICP-AES	0.01	15.00
568	10	Mn ppm: 24 element, rock & core	ICP-AES	5	10000
554	10	Mo ppm: 24 element, rock & core	ICP-AES	1	10000
583	10	Na %: 24 element, rock & core	ICP-AES	0.01	10.00
564	10	Ni ppm: 24 element, rock & core	ICP-AES	1	10000
559	10	P ppm: 24 element, rock & core	ICP-AES	10	10000
560	10	Pb ppm: 24 element, rock & core	AAS	2	10000
582	10	Sr ppm: 24 element, rock & core	ICP-AES	1	10000
579	10	Ti %: 24 element, rock & core	ICP-AES	0.01	10.00
572	10	V ppm: 24 element, rock & core	ICP-AES	1	10000
556	10	W ppm: 24 element, rock & core	ICP-AES	10	10000
558	10	Zn ppm: 24 element, rock & core	ICP-AES	2	10000



Chemex Labs Ltd.

Analytical Chemists * Geochemists * Registered Assayers
 212 Brooksbank Ave., North Vancouver
 British Columbia, Canada V7J 2C1
 PHONE: 604-984-0221 FAX: 604-984-0218

To: PAMICON DEVELOPMENTS LIMITED
 ATTN: MIKE STAMMERS
 711 - 675 W. HASTINGS ST.
 VANCOUVER, BC
 V6B 1N4

Page Number : 1-A
 Total Pages : 1
 Certificate Date: 06-AUG-96
 Invoice No. : 19625971
 P.O. Number :
 Account : BM S

Project : ALASKON
 Comments: ATTN:MIKE STAMMERS FAX:R.GORTON CC:OWEN LAVIN

CERTIFICATE OF ANALYSIS A9625971

SAMPLE	PREP CODE	Au ppb AFS	Pt ppb AFS	Pd ppb AFS	Ag ppm AAS	Al % (ICP)	Ba ppm (ICP)	Be ppm (ICP)	Bi ppm (ICP)	Ca % (ICP)	Cd ppm (ICP)	Co ppm (ICP)	Cr ppm (ICP)	Cu ppm (ICP)	Fe % (ICP)
23816	205 226	2	40	28	< 0.2	1.30	30	< 0.5	< 2	9.39	< 0.5	33	1370	17	4.09
23817	205 226	2	55	6	< 0.2	1.32	20	< 0.5	< 2	10.30	< 0.5	37	657	3	4.50
23818	205 226	< 2	10	2	< 0.2	1.96	40	< 0.5	< 2	10.10	< 0.5	51	2050	9	5.48
23819	205 226	< 2	5	12	< 0.2	5.87	60	< 0.5	< 2	8.88	0.5	35	377	55	7.13
23820	205 226	< 2	35	4	< 0.2	0.88	30	< 0.5	< 2	5.42	< 0.5	101	810	4	8.27
23821	205 226	12	25	40	0.4	1.07	20	< 0.5	< 2	10.50	< 0.5	43	882	987	5.08
23822	205 226	< 2	25	14	< 0.2	4.50	100	< 0.5	< 2	7.29	< 0.5	43	263	127	8.42
23823	205 226	< 2	< 5	< 2	< 0.2	6.36	70	< 0.5	< 2	5.53	< 0.5	31	59	41	8.80
23824	205 226	< 2	10	2	< 0.2	8.11	50	< 0.5	< 2	10.40	1.5	32	303	21	6.43
23825	205 226	< 2	5	2	< 0.2	6.01	80	< 0.5	< 2	6.14	0.5	39	33	104	8.90

CERTIFICATION:

Hart Buchler



Chemex Labs Ltd.

Analytical Chemists * Geochemists * Registered Assayers

212 Brooksbank Ave., North Vancouver
British Columbia, Canada V7J 2C1
PHONE: 604-984-0221 FAX: 604-984-0218

To: PAMICON DEVELOPMENTS LIMITED
ATTN: MIKE STAMMERS
711 - 675 W. HASTINGS ST.
VANCOUVER, BC
V6B 1N4

Page Number : 1-B
Total Pages : 1
Certificate Date: 06-AUG-96
Invoice No. : I9625971
P.O. Number :
Account : BM S

Project: ALASKON
Comments: ATTN:MIKE STAMMERS FAX:R.GORTON CC:OWEN LAVIN

CERTIFICATE OF ANALYSIS

A9625971

SAMPLE	PREP CODE	K % (ICP)	Mg % (ICP)	Mn ppm (ICP)	Mo ppm (ICP)	Na % (ICP)	Ni ppm (ICP)	P ppm (ICP)	Pb ppm AAS	Sr ppm (ICP)	Ti % (ICP)	V ppm (ICP)	W ppm (ICP)	Zn ppm (ICP)
23816	205 226	0.02	7.81	895	< 1	0.21	104	30	20	34	0.14	130	70	94
23817	205 226	< 0.01	8.97	895	< 1	0.14	96	< 10	< 2	27	0.15	129	20	30
23818	205 226	0.09	9.38	1260	< 1	0.45	130	60	< 2	44	0.22	145	90	42
23819	205 226	0.21	5.08	940	< 1	0.90	45	240	< 2	240	0.63	408	50	44
23820	205 226	0.02	13.25	1595	< 1	0.13	355	< 10	< 2	19	0.10	86	60	64
23821	205 226	< 0.01	8.81	975	< 1	0.17	160	30	< 2	27	0.15	171	60	26
23822	205 226	0.33	6.21	990	< 1	1.09	50	< 10	< 2	118	0.70	436	< 10	50
23823	205 226	0.34	3.15	1605	< 1	2.70	20	1470	< 2	119	1.47	393	50	104
23824	205 226	0.23	4.94	1195	< 1	1.16	45	1150	< 2	340	0.58	257	40	60
23825	205 226	0.33	3.80	1110	< 1	1.16	14	380	< 2	185	0.93	468	50	70

CERTIFICATION: Hank Buchler



Chemex Labs Ltd.

Analytical Chemists * Geochemists * Registered Assayers

212 Brooksbank Ave., North Vancouver
British Columbia, Canada V7J 2C1
PHONE: 604-984-0221 FAX: 604-984-0218

To: PAMICON DEVELOPMENTS LIMITED
ATTN: MIKE STAMMERS
711 - 675 W. HASTINGS ST.
VANCOUVER, BC
V6B 1N4

A9625972

Comments: ATTN:MIKE STAMMERS FAX:R.GORTON CC:OWEN LAVIN

CERTIFICATE

A9625972

(BM S) - PAMICON DEVELOPMENTS LIMITED

Project: ALASKON
P.O.#:

Samples submitted to our lab in Vancouver, BC.
This report was printed on 6-AUG-96.

SAMPLE PREPARATION

CHEMEX CODE	NUMBER SAMPLES	DESCRIPTION
201	28	Dry, sieve to -80 mesh
202	28	save reject
285	26	ICP - HF digestion charge

ANALYTICAL PROCEDURES

CHEMEX CODE	NUMBER SAMPLES	DESCRIPTION	METHOD	DETECTION LIMIT	UPPER LIMIT
975	28	Au ppb: ICP-fluorescence package	FA-ICP-AFS	2	10000
976	28	Pt ppb: ICP-Fluorescence package	FA-ICP-AFS	5	10000
977	28	Pd ppb: ICP-fluorescence package	FA-ICP-AFS	2	10000
578	26	Ag ppm: 24 element, rock & core	AAS	0.2	200
573	26	Al %: 24 element, rock & core	ICP-AES	0.01	25.0
565	26	Ba ppm: 24 element, rock & core	ICP-AES	10	10000
575	26	Be ppm: 24 element, rock & core	ICP-AES	0.5	1000
561	26	Bi ppm: 24 element, rock & core	ICP-AES	2	10000
576	26	Ca %: 24 element, rock & core	ICP-AES	0.01	25.0
562	26	Cd ppm: 24 element, rock & core	ICP-AES	0.5	500
563	26	Co ppm: 24 element, rock & core	ICP-AES	1	10000
569	26	Cr ppm: 24 element, rock & core	ICP-AES	1	10000
577	26	Cu ppm: 24 element, rock & core	ICP-AES	1	10000
566	26	Fe %: 24 element, rock & core	ICP-AES	0.01	25.0
584	26	K %: 24 element, rock & core	ICP-AES	0.01	10.00
570	26	Mg %: 24 element, rock & core	ICP-AES	0.01	15.00
568	26	Mn ppm: 24 element, rock & core	ICP-AES	5	10000
554	26	Mo ppm: 24 element, rock & core	ICP-AES	1	10000
583	26	Na %: 24 element, rock & core	ICP-AES	0.01	10.00
564	26	Ni ppm: 24 element, rock & core	ICP-AES	1	10000
559	26	P ppm: 24 element, rock & core	ICP-AES	10	10000
560	26	Pb ppm: 24 element, rock & core	AAS	2	10000
582	26	Sr ppm: 24 element, rock & core	ICP-AES	1	10000
579	26	Ti %: 24 element, rock & core	ICP-AES	0.01	10.00
572	26	V ppm: 24 element, rock & core	ICP-AES	1	10000
556	26	W ppm: 24 element, rock & core	ICP-AES	10	10000
558	26	Zn ppm: 24 element, rock & core	ICP-AES	2	10000



Chemex Labs Ltd.

Analytical Chemists * Geochemists * Registered Assayers

212 Brooksbank Ave., North Vancouver
British Columbia, Canada V7J 2C1
PHONE: 604-984-0221 FAX: 604-984-0218

To: PAMICON DEVELOPMENTS LIMITED
ATTN: MIKE STAMMERS
711 - 675 W. HASTINGS ST.
VANCOUVER, BC
V6B 1N4

Page Number : 1-A
Total Pages : 1
Certificate Date: 06-AUG-96
Invoice No. : I9625972
P.O. Number :
Account : BM S

Project: ALASKON
Comments: ATTN:MIKE STAMMERS FAX:R.GORTON CC:OWEN LAVIN

CERTIFICATE OF ANALYSIS A9625972

SAMPLE	PREP CODE	Au ppb AFS	Pt ppb AFS	Pd ppb AFS	Ag ppm AAS	Al % (ICP)	Ba ppm (ICP)	Be ppm (ICP)	Bi ppm (ICP)	Ca % (ICP)	Cd ppm (ICP)	Co ppm (ICP)	Cr ppm (ICP)	Cu ppm (ICP)	Fe % (ICP)
1517	201 202	2	10	12	< 0.2	5.04	520	0.5	2	4.08	< 0.5	39	316	27	4.86
1518	201 202	2	5	18	< 0.2	5.35	570	0.5	2	3.97	0.5	31	259	110	4.49
1519	201 202	2	15	10	< 0.2	5.16	600	0.5	6	3.24	0.5	29	260	125	4.19
1520	201 202	2	5	22	< 0.2	5.80	710	0.5	4	2.11	0.5	25	136	205	3.93
1521	201 202	2	10	10	< 0.2	6.34	780	0.5	4	2.55	0.5	22	158	105	3.92
1522	201 202	2	15	28	< 0.2	5.65	620	0.5	2	2.89	0.5	20	171	44	4.26
1523	201 202	396	< 10	< 4	< 0.2	7.48	740	1.5	< 2	1.23	< 0.5	11	63	68	3.01
1524	201 202	6	15	22	< 0.2	5.55	680	0.5	6	2.59	0.5	20	166	60	4.45
1537	201 202	4	5	14	< 0.2	6.11	700	0.5	2	1.93	1.0	20	132	77	4.21
1538	201 202	2	< 5	2	< 0.2	5.98	770	1.0	4	2.67	0.5	19	234	27	3.65
1539	201 202	< 2	15	4	< 0.2	5.31	560	0.5	6	3.61	1.5	25	233	18	4.58
1540	201 202	< 2	< 5	4	< 0.2	6.30	610	0.5	6	3.31	1.0	22	151	61	4.90
1541	201 202	4	105	16	< 0.2	5.56	400	< 0.5	< 2	5.78	1.0	43	168	141	8.59
1542	201 202	< 2	6	4	< 0.2	6.61	440	0.5	< 2	3.98	0.5	23	113	90	5.12
1543	201 202	4	5	8	< 0.2	7.05	630	0.5	2	2.75	< 0.5	20	86	109	4.60
1561	201 202	< 2	15	18	< 0.2	5.23	480	0.5	6	3.90	0.5	39	288	51	5.97
1562	201 202	< 2	15	14	< 0.2	4.53	390	< 0.5	4	4.48	0.5	32	287	97	4.17
1563	201 202	< 20	< 50	< 20	not/ss	not/ss	not/ss	not/ss	not/ss	not/ss	not/ss	not/ss	not/ss	not/ss	not/ss
1564	201 202	< 2	25	16	< 0.2	4.94	470	0.5	< 2	2.87	0.5	38	118	101	7.37
1565	201 202	< 2	< 5	2	< 0.2	6.46	490	0.5	< 2	4.42	1.5	27	139	34	4.74
1566	201 202	< 2	< 5	< 2	< 0.2	8.41	520	0.5	< 2	3.62	2.0	28	68	94	5.06
1567	201 202	< 2	< 5	4	< 0.2	6.29	560	0.5	2	3.05	0.5	19	120	71	4.32
1568	201 202	< 2	< 5	4	< 0.2	6.78	420	0.5	6	4.59	2.0	23	136	72	5.60
1569	201 202	2	15	16	< 0.2	5.45	670	0.5	6	2.83	0.5	29	208	90	4.00
1570	201 202	< 12	< 30	< 12	not/ss	not/ss	not/ss	not/ss	not/ss	not/ss	not/ss	not/ss	not/ss	not/ss	not/ss
1571	201 202	< 2	< 5	2	< 0.2	6.08	750	0.5	2	2.06	1.5	17	145	21	3.88
1572	201 202	< 2	15	< 2	< 0.2	5.44	520	< 0.5	4	3.57	0.5	26	457	19	5.08
1573	201 202	< 2	20	2	< 0.2	4.65	350	< 0.5	6	5.40	1.5	38	576	26	6.14

CERTIFICATION:

Hart Bickler

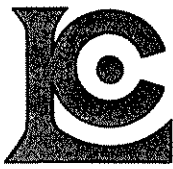

Chemex Labs Ltd.

Analytical Chemists * Geochemists * Registered Assayers

212 Brooksbank Ave., North Vancouver
British Columbia, Canada V7J 2C1
PHONE: 604-984-0221 FAX: 604-984-0218

To: PAMICON DEVELOPMENTS LIMITED
ATTN: MIKE STAMMERS
711 - 875 W. HASTINGS ST.
VANCOUVER, BC
V6B 1N4

Page Number : 1-B
Total Pages : 1
Certificate Date: 06-AUG-96
Invoice No. : I9625972
P.O. Number :
Account : BM S

Project : ALASKON
Comments: ATTN:MIKE STAMMERS FAX:R.GORTON CC:OWEN LAVIN

CERTIFICATE OF ANALYSIS A9625972

SAMPLE	PREP CODE	K % (ICP)	Mg % (ICP)	Mn ppm (ICP)	Mo ppm (ICP)	Na % (ICP)	Ni ppm (ICP)	P ppm (ICP)	Pb ppm AAS	Sr ppm (ICP)	Ti % (ICP)	V ppm (ICP)	W ppm (ICP)	Zn ppm (ICP)
1517	201 202	0.76	3.65	895	< 1	1.28	64	410	2	186	0.40	197	20	54
1518	201 202	0.81	3.35	880	< 1	1.32	66	560	4	202	0.39	177	10	56
1519	201 202	0.90	2.95	770	< 1	1.31	61	490	4	189	0.37	160	10	58
1520	201 202	0.86	1.75	1035	< 1	1.26	56	1010	6	199	0.35	146	< 10	62
1521	201 202	1.14	2.19	570	< 1	1.60	46	460	8	229	0.44	159	10	58
1522	201 202	0.94	2.52	590	< 1	1.31	39	710	6	191	0.42	165	10	52
1523	201 202	1.93	0.78	645	3	1.25	26	670	20	249	0.36	95	10	88
1524	201 202	1.01	2.44	585	< 1	1.28	41	360	6	180	0.42	171	10	50
1537	201 202	1.13	1.87	545	< 1	1.44	38	320	6	192	0.38	139	< 10	54
1538	201 202	1.13	2.31	610	< 1	1.62	46	680	8	233	0.42	143	10	54
1539	201 202	0.87	3.06	680	< 1	1.33	50	260	4	187	0.43	207	10	52
1540	201 202	0.96	2.46	700	< 1	1.55	38	190	4	216	0.46	235	10	56
1541	201 202	0.64	4.01	1055	< 1	1.15	65	300	4	199	0.71	509	30	84
1542	201 202	0.71	2.31	855	1	1.43	25	320	2	229	0.48	237	10	62
1543	201 202	0.98	1.82	750	1	1.60	30	430	6	226	0.41	246	< 10	66
1561	201 202	0.77	3.85	885	< 1	1.14	80	380	4	157	0.43	243	20	68
1562	201 202	0.56	3.58	1075	< 1	0.95	72	680	2	175	0.33	161	10	58
1563	201 202	not/ss	not/ss	not/ss	not/ss	not/ss	not/ss	not/ss	not/ss	not/ss	not/ss	not/ss	not/ss	not/ss
1564	201 202	0.76	3.19	705	< 1	1.10	70	280	4	120	0.64	390	10	64
1565	201 202	0.79	3.61	710	< 1	1.48	47	420	2	216	0.53	228	10	54
1566	201 202	0.82	1.91	900	< 1	2.06	32	420	4	291	0.52	189	10	138
1567	201 202	0.87	2.25	710	< 1	1.69	38	630	4	226	0.56	192	< 10	76
1568	201 202	0.73	2.81	1090	< 1	1.98	36	690	2	270	0.77	243	10	102
1569	201 202	0.90	2.52	925	< 1	1.40	56	610	2	208	0.37	153	< 10	54
1570	201 202	not/ss	not/ss	not/ss	not/ss	not/ss	not/ss	not/ss	not/ss	not/ss	not/ss	not/ss	not/ss	not/ss
1571	201 202	1.11	1.76	565	< 1	1.55	36	380	10	213	0.42	165	10	56
1572	201 202	0.82	3.53	730	< 1	1.20	74	240	2	171	0.39	164	20	56
1573	201 202	0.54	5.02	950	< 1	0.98	110	210	< 2	155	0.41	216	30	46

CERTIFICATION:

Hart Bickler

APPENDIX E
GEOLOGIST'S CERTIFICATE

GEOLOGIST'S CERTIFICATE

I, Michael A. Stammers, of 941 Kennedy Avenue, North Vancouver, in the Province of British Columbia, DO HEREBY CERTIFY:

1. THAT I am a Consulting Geologist with offices at Suite 611, 675 West Hastings Street, Vancouver, British Columbia.
2. THAT I have practised in my profession with various mining companies in Yukon, British Columbia, Northwest Territories, Nova Scotia, Oregon, Venezuela and the Southwest Pacific for 23 years.
3. THAT I am a graduate of McMaster University (1977) and hold a combined Honours B.A. in Geology and Geography.
4. THAT I am duly registered as a Professional Geoscientist in the Province of British Columbia (#18883).
5. THAT I am a Fellow of the Geological Association of Canada.
6. THAT this report is based in part on property work I personally completed and supervised on July 19, 1996.
7. THAT I have no interest in the property described herein, nor in any securities of any company associated with the property, nor do I expect to receive any such interest.

DATED at Vancouver, British Columbia, this _____ day of _____, 1996.

Michael A. Stammers, P.Ge., FGAC