

ARCHER, CATHRO
 & ASSOCIATES (1981) LIMITED
CONSULTING GEOLOGICAL ENGINEERS

1016 - 510 WEST HASTINGS STREET, VANCOUVER, B.C. V6B 1L8 TEL (604) 688 - 2568 • FAX (604) 688 - 2578

ASSESSMENT REPORT

describing

PROSPECTING

on the

TOUCHDOWN PROPERTY

Touchdown 1-30 YB60062-YB60091
31-70 YB75546-YB75585

Latitude 60°23' N; Longitude 130°49' W

NTS 105B/7

in the

WATSON LAKE MINING DISTRICT

YUKON TERRITORY

Prepared by

Archer, Cathro & Associates (1981) Limited

for

NORDAC RESOURCES LTD.



093507

W.A. Wengzynowski, B.A.Sc.
April, 1996

TABLE OF CONTENTS

	<u>PAGE</u>
INTRODUCTION	1
HISTORY	2
PROPERTY, LOCATION AND ACCESS	3
GEOMORPHOLOGY	4
GEOLOGY	5
1995 PROGRAM	6
CONCLUSIONS AND RECOMMENDATIONS	8
REFERENCES	9

APPENDICES

- I AUTHOR'S STATEMENT OF QUALIFICATIONS
- II CERTIFICATES OF ANALYSIS

FIGURES

<u>NO.</u>	<u>DESCRIPTION</u>	<u>LOCATION</u>
1	Location Map	Following Page 3
2	Claim Map	Following Page 3
3	Geology	Following Page 5
4	Sample Location	Following Page 6

INTRODUCTION

Nordac Resources Ltd. has a 100% interest in the Touchdown property which protects previously discovered lead-zinc-silver mineralization and strong soil geochemical response. The Touchdown 1-30 claims subject to this report were staked in July 1995. Forty claims were added in February 1996, bringing the total to seventy.

Field work totalled two mandays of prospecting on September 19, 1995. The work was managed by Archer, Cathro & Associates (1981) Limited and supervised by the author.

Appendix I contains the author's Statement of Qualifications.

HISTORY

The property was staked by various groups between 1947 and 1967. Field work during this period was limited to prospecting and minor hand trenching with the focus on lead-zinc-silver vein mineralization.

In 1972 Wolf Lake Joint Venture staked the Lampon claims and performed minor grid and contour soil sampling plus geological mapping. Exploration was directed toward tungsten-bearing skarns however samples were routinely analyzed for other metals, including lead, zinc, copper and silver. Geochemical response for lead and zinc is uniformly strong with values up to 3500 and 6900 ppm, respectively. Silver values are sporadic while copper is generally subdued. Mineralized samples reportedly returned up to 8.4% zinc, 1.3% lead, 4.5% copper and 0.93% molybdenum. No follow-up work was done.

Parts of the area were restaked between 1974 and 1984 and received additional soil sampling, trenching and VLF-EM surveys. Most of the work was completed by B.A. Resources Limited which optioned the claims to West-Mar Resources Limited in 1988. Samples of massive sphalerite and lesser galena taken from a quartz vein reportedly assayed 33.5% zinc, 0.62% lead and 655 g/t silver.

PROPERTY, LOCATION AND ACCESS

The Touchdown property is located in southeast Yukon at latitude 60°23'N, longitude 130°49'W on NTS map sheet 105B/7 (Figure 1). It is comprised of seventy contiguous mineral claims registered with the Watson Lake Mining Recorder in the name of Archer, Cathro & Associates (1981) Limited which holds them in trust for Nordac Resources Ltd. Claim registration data is listed below while locations are shown on Figure 2.

<u>Claim Name</u>	<u>Grant Number</u>	<u>Expiry Date*</u>
Touchdown 1-30	YB60062-YB60091	July 4, 1996
31-70	YB75546-YB75585	February 15, 1997

*Expiry dates do not reflect 1995 work filed for assessment credit but not yet accepted.

In 1995 the claims were accessed by helicopter from Watson Lake some 115 km due east. Access to the property is possible by road from Whitehorse which lies 250 km west-northwest. A summer four-wheel drive road leaves the Alaska Highway at Kilometre 1160 some 330 km southeast of Whitehorse and extends 43 km north to the claim block.

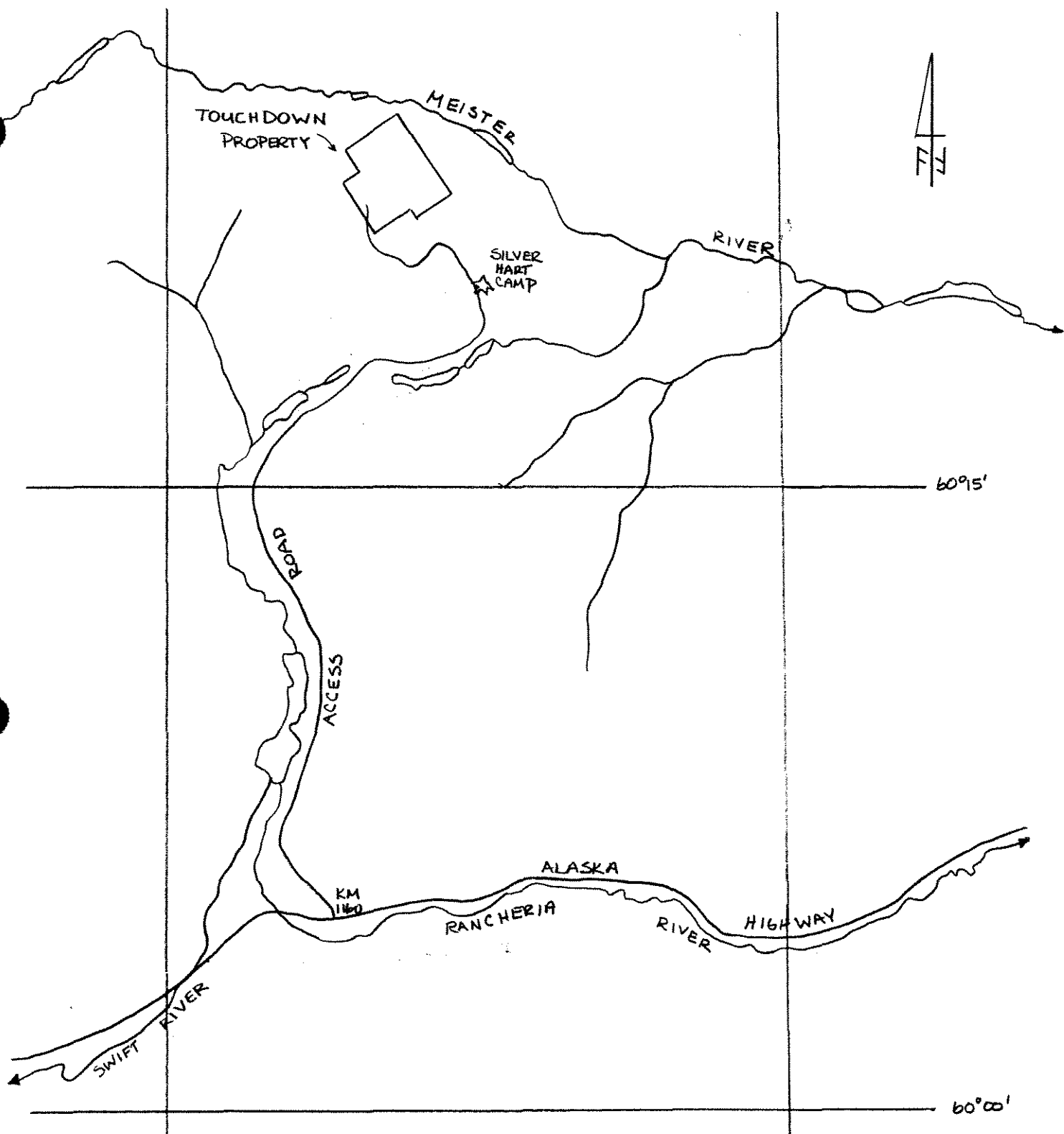
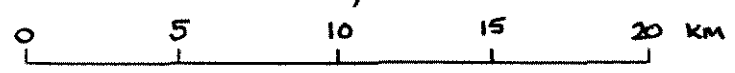

FIGURE 1
 ARCHER, CATHRO & ASSOCIATES (1981) LIMITED
LOCATION MAP

TOUCHDOWN CLAIMS
 TOUCHDOWN PROPERTY
 NORDAC RESOURCES LTD.

SCALE
 1:250,000



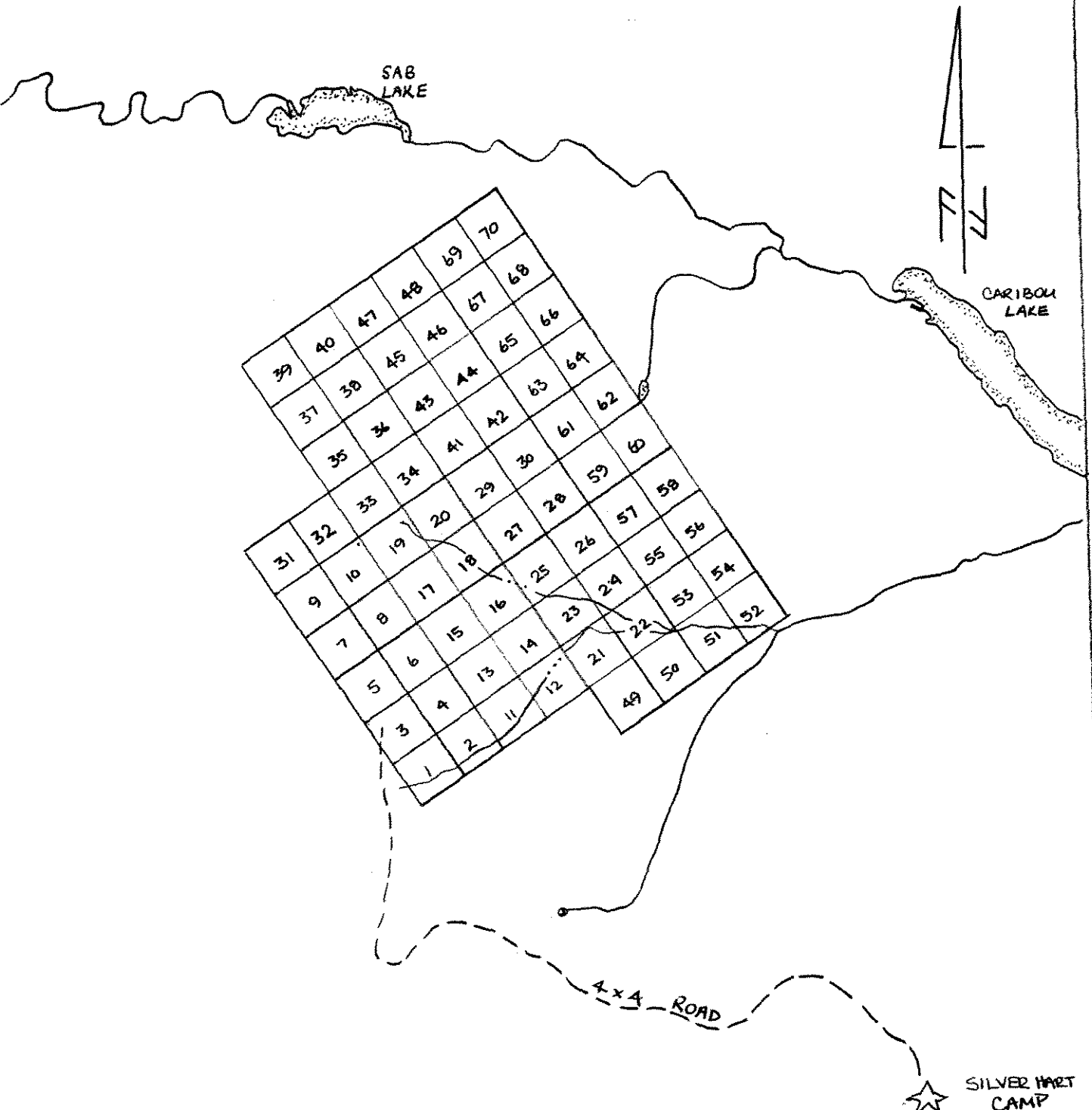

FIGURE 2

ARCHER, CATRO + ASSOCIATES (1981) LIMITED

CLAIM MAP

TOUCHDOWN CLAIMS
 TOUCHDOWN PROPERTY
 NORDAC RESOURCES LTD.
 SCALE
 1:50,000



GEOMORPHOLOGY

The claims lie 50 km southwest of the Tintina Trench and cover an upland region within the Cassiar Mountains. Creeks draining the property flow into the Meister and Rancheria Rivers which are part of the Liard River watershed.

Local elevations range from 1100 m near the Meister River to 1750 m on a ridge crest in the centre of the property. Topographic relief is moderate to steep, averaging 20°. Slopes in the west part of the claim block exceed 30°. Pleistocene valley glaciers deposited thick accumulations of glacial till in valley bottoms and lateral moraines up to 1300 m. Hillsides above 1300 m usually exhibit a thin cover of talus.

About 70% of the property is above treeline (1350 m). Vegetation consists of dense growths of black spruce, balsam and alder to 1200 m, giving way to isolated stands of stunted black spruce interspersed with buckbrush and willow to 1350 m. Sparse buckbrush, moss and lichen predominate above 1350 m.

GEOLOGY

Geology in the vicinity of the property is illustrated in Figure 3 and briefly summarized in the following paragraph. A more detailed geological description is present in Amukun and Lowey, 1986.

The main units are medium- to coarse-grained granitic rocks of the Cassiar Batholith and Lower Cambrian schist, quartzite, gneiss and limestone. Metasediments typically exhibit lower greenschist facies regional metamorphism. Local foliation trends northwest and dips moderately to the northeast. Limy horizons within this package are often skarnified adjacent to intrusions. Northeast-trending block faults juxtapose metasediments with younger granitic rocks. Although the metasediments are assigned a Lower Cambrian age they are lithologically similar to Devonian-Mississippian metavolcanics and metasediments which host volcanogenic massive sulphide mineralization in the Finlayson Lake area some 40 km to the north.

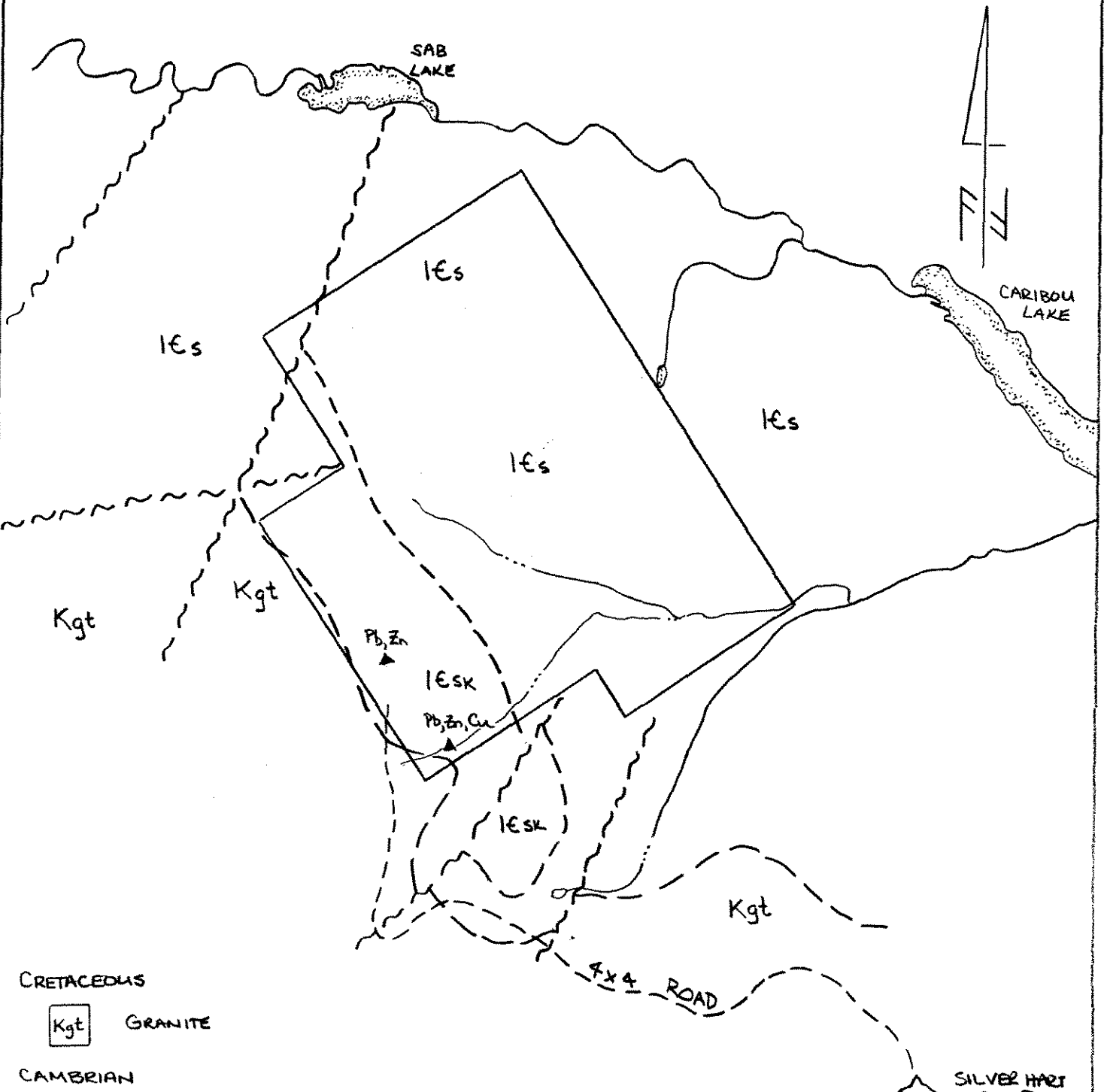

- CRETACEOUS**
- Kgt** GRANITE
- CAMBRIAN**
- IEs** QUARTZITE
SCHIST
GNEISS
- IEsK** SKARN

- GEOLOGICAL CONTACT, INFERRED
- ~~~~ FAULT TRACE, INFERRED
- ▲ **Pb, Zn** MINERAL OCCURRENCE

FIGURE 3
 ARCHER, CATHRO + ASSOCIATES (1981) LIMITED

GEOLOGY

TOUCHDOWN CLAIMS
 TOUCH DOWN PROPERTY
 NORDAC RESOURCES LTD.
 SCALE
 1:50,000

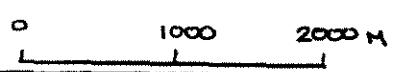

1995 PROGRAM

Detailed prospecting was performed in a creek cut in the southeast part of the claim block where sphalerite-bearing metasediments were reportedly discovered in 1972 by Wolf Lake Joint Venture (Cathro, 1972). The showing, as described in old traverse reports, was not relocated however, sulphide-bearing mineralization was traced upstream to a vein showing exposed in an old hand trench. cursory prospecting in the northwest part of the property located copper-zinc bearing float in a talus fan.

Four types of mineralization have now been discovered on the property and are described below.

- I Quartz siderite breccia float containing up to 20% coarse-grained sphalerite with traces of galena and chalcopyrite.
- II Quartz ± carbonate vein comprised a 0.35 m wide core of massive sphalerite and galena and 0.5 m wide selvages that are strongly manganese stained and contain up to 30% sphalerite, galena, chalcopyrite and pyrite combined.
- III Skarn float is moderately foliated and oxidized with malachite staining and up to 10% residual blebby chalcopyrite.
- IV Quartz biotite schist creek float with foliaform limonite boxwork and disseminated pyrite.

Eight rock samples were collected (locations shown on Figure 4) and sent to Chemex Labs Ltd. in North Vancouver where they were analyzed geochemically for 32 elements by Induced Coupled Plasma (ICP) technique. Ore grade analyses for copper, lead, zinc, silver and gold were performed on select samples. Results are presented in the following table and Certificates of Analysis are listed in Appendix II.

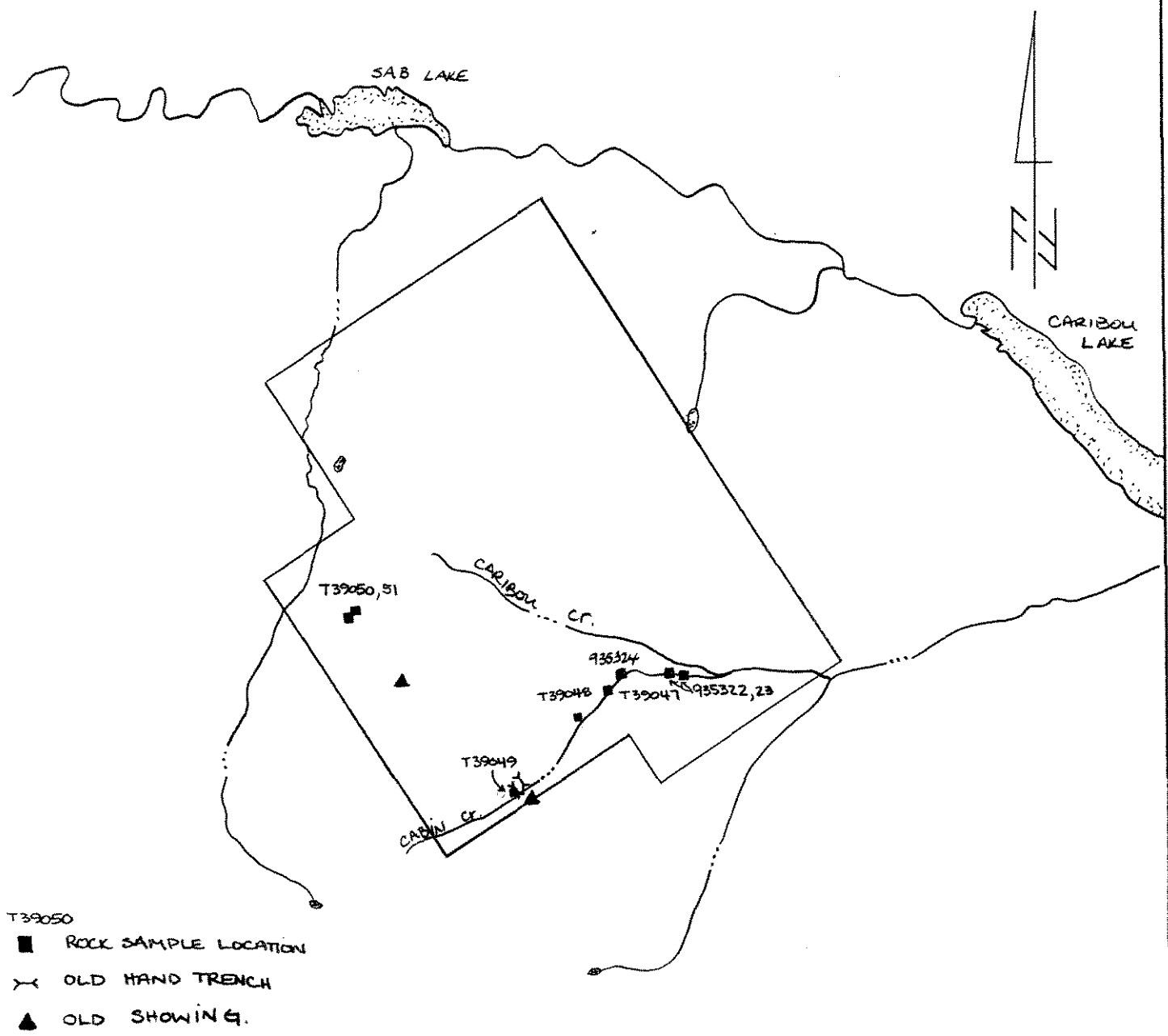

FIGURE 4

ARCHER, CATHRO & ASSOCIATES (1981) LIMITED

SAMPLE LOCATION

TOUCHDOWN CLAIMS
 TOUCHDOWN PROPERTY
 NORDAC RESOURCES LTD.
 SCALE
 1:50,000

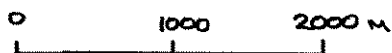

TABLE 1
ASSAY RESULTS

<u>Sample Number</u>	<u>Mineralization Type</u>	<u>Copper (%)</u>	<u>Lead (%)</u>	<u>Zinc (%)</u>	<u>Silver (%)</u>	<u>Gold (%)</u>
T39047	I	0.25	0.83	6.83	37.0	0.01
T39048	II	0.24	2.78	5.56	37.0	0.06
T39049	II	0.05	12.30	44.60	95.0	1.48
T39050	III	3.13	0.02	0.42	127.0	<0.01
T39051	III	<0.01	0.02	2.59	1.4	<0.01
935322	IV	<0.01	<0.01	0.01	<0.01	<0.01
935323	IV	0.01	<0.01	0.01	<0.01	<0.01
935324	IV	<0.01	<0.01	<0.01	<0.01	<0.01

No soil geochemical sampling was conducted in 1995. Previous contour sampling on three lines located between Cabin Creek and Caribou Creek returned uniformly high values for lead, zinc and silver. Peak values for these elements were 3500 ppm, 6900 ppm and 20 ppm, respectively. Copper values are subdued.

CONCLUSIONS AND RECOMMENDATIONS

The Touchdown property is largely underlain by metasedimentary rocks that are lithologically similar to those hosting the recently discovered Kudz Ze Kayah and Wolverine volcanogenic massive sulphide deposits in the Finlayson Lake area. Previous contour soil geochemical sampling outlined a 1300 by 300 m area of very strong lead-zinc-silver response. The anomaly is open in all directions. Copper-lead-zinc-silver showings have also been identified on the property but not thoroughly examined.

Further exploration should focus on volcanogenic massive sulphide potential and consist of grid soil sampling, geological mapping and prospecting. Pending favourable results, ground geophysical surveys should be carried out with follow-up excavator trenching and drilling if necessary.

Respectfully submitted,

ARCHER, CATHRO & ASSOCIATES (1981) LIMITED



W.A. Wengzynowski, B.A.Sc.

REFERENCES

Amukun, S.E. and Lowey, G.W.

1986 Geology of Sab Lake map area (105B/7), Rancheria District, Southern Yukon, DIAND Open File 1987-1.

Cathro, R.J.

1972 Final Report, Wolf Lake Joint Venture, November 30, 1972.

APPENDIX I

AUTHOR'S STATEMENT OF QUALIFICATIONS

STATEMENT OF QUALIFICATIONS

I, William A. Wengzynowski, geological engineer, with business addresses in Whitehorse, Yukon Territory and Vancouver, British Columbia and residential address in Vancouver, British Columbia, do hereby certify that:

1. I graduated from the University of British Columbia in 1993 with a B.A.Sc. in geological engineering, option 1, mineral and fuel exploration.
2. From 1983 to present, I have been actively engaged in mineral exploration in the Yukon Territory and am presently employed with Archer, Cathro & Associates (1981) Limited.
3. I have personally participated in and supervised the field work reported herein.

W.A. Wengzynowski, B.A.Sc.

APPENDIX II

CERTIFICATES OF ANALYSIS



Chemex Labs Ltd.

Analytical Chemists * Geochemists * Registered Assayers

212 Brooksbank Ave., North Vancouver
British Columbia, Canada V7J 2C1
PHONE: 604-984-0221 FAX: 604-984-0218

To: NORDAC RESOURCES LTD.
C/O ARCHER, CATHRO
BOX 4127, 2054 SECOND AVE.
WHITEHORSE, YT
Y1A 3S9

Project: CODE TOUCHDOWN
Comments:

Page Number : 1
Total Pages : 1
Certificate Date: 28-OCT-95
Invoice No. : 19532054
P.O. Number :
Account : MTT

CERTIFICATE OF ANALYSIS

A9532054

SAMPLE	PREP CODE		Zn %									
39051	244	--	2.59									

CERTIFICATION:



Chemex Labs Ltd.

Analytical Chemists * Geochemists * Registered Assayers

212 Brooksbank Ave., North Vancouver
British Columbia, Canada V7J 2C1
PHONE: 604-984-0221 FAX: 604-984-0218

To: NORDAC RESOURCES LTD.
C/O ARCHER, CATHRO
BOX 4127, 2054 SECOND AVE.
WHITEHORSE, YT
Y1A 3S9

Project : CODE TOUCHDOWN
Comments:

Page Number : 1-A
Total Pages : 1
Certificate Date: 12-OCT-95
Invoice No. : 19530173
P.O. Number :
Account : MTT

CERTIFICATE OF ANALYSIS

A9530173

SAMPLE	PREP CODE		Au ppb	Ag ppm	Al %	As ppm	Ba ppm	Be ppm	Bi ppm	Ca %	Cd ppm	Co ppm	Cr ppm	Cu ppm	Fe %	Ga ppm	Hg ppm	K %	La ppm	Mg %	Mn ppm
	FA+AA																				
39051	205	226	< 5	1.4	0.49	512	30	< 0.5	2	0.22	47.5	12	< 1	51	>15.00	10	< 1	0.28	10	0.03	>10000

CERTIFICATION: *Y. H. D. M.*



Chemex Labs Ltd.

Analytical Chemists * Geochemists * Registered Assayers
212 Brooksbank Ave., North Vancouver
British Columbia, Canada V7J 2C1
PHONE: 604-984-0221 FAX: 604-984-0218

to: NORDAC RESOURCES LTD.
C/O ARCHER, CATHRO
BOX 4127, 2054 SECOND AVE.
WHITEHORSE, YT
Y1A 3S9

Project : CODE TOUCHDOWN
Comments:

Page Number : 1-B
Total Pages : 1
Certificate Date: 12-OCT-95
Invoice No. : I9530173
P.O. Number :
Account : MTT

CERTIFICATE OF ANALYSIS

A9530173

SAMPLE	PREP CODE		Mo	Na	Ni	P	Pb	Sb	Sc	Sr	Ti	Tl	U	V	W	Zn
			ppm	%	ppm	ppm	ppm	ppm	ppm	ppm	%	ppm	ppm	ppm	ppm	ppm
39051	205	226	38	0.02	11	320	172	6	3	300	< 0.01	< 10	70	27	30	>10000

CERTIFICATION:



Chemex Labs Ltd.

Analytical Chemists * Geochemists * Registered Assayers

212 Brooksbank Ave., North Vancouver
British Columbia, Canada V7J 2C1
PHONE: 604-984-0221 FAX: 604-984-0218

To: NORDAC RESOURCES LTD.
C/O ARCHER, CATHRO
BOX 4127, 2054 SECOND AVE.
WHITEHORSE, YT
Y1A 3S9

Project: CODE TOUCHDOWN
Comments:

Page Number : 1-A
Total Pages : 1
Certificate Date: 20-OCT-95
Invoice No. : I9530172
P.O. Number :
Account : MTT

CERTIFICATE OF ANALYSIS A9530172

SAMPLE	PREP CODE	Au ppb FA+AA	Ag ppm AAS	Al % (ICP)	Ba ppm (ICP)	Be ppm (ICP)	Bi ppm (ICP)	Ca % (ICP)	Cd ppm (ICP)	Co ppm (ICP)	Cr ppm (ICP)	Cu ppm (ICP)	Fe % (ICP)	K % (ICP)	Mg % (ICP)
39047	205 226	10	37.0	1.05	< 100	< 10	< 20	0.20	210	10	190	2490	7.65	0.2	0.10
39048	205 226	60	37.0	1.60	< 100	< 10	< 20	0.05	120	< 10	150	2380	3.65	0.6	0.05
39049	205 226	1480	95.0	0.05	< 100	< 10	< 20	< 0.05	970	40	70	560	1.80	< 0.1	< 0.05
39050	205 226	< 5	127.0	3.70	< 100	< 10	< 20	17.20	10	< 10	70	33200	14.45	< 0.1	0.45

CERTIFICATION: Hart Buchler



Chemex Labs Ltd.

Analytical Chemists * Geochemists * Registered Assayers
 212 Brooksbank Ave., North Vancouver
 British Columbia, Canada V7J 2C1
 PHONE: 604-984-0221 FAX: 604-984-0218

To: NORDAC RESOURCES LTD.
 C/O ARCHER, CATHRO
 BOX 4127, 2054 SECOND AVE.
 WHITEHORSE, YT
 Y1A 3S9

Project: CODE TOUCHDOWN
 Comments:

Page Number: 1-B
 Total Pages: 1
 Certificate Date: 20-OCT-95
 Invoice No.: I9530172
 P.O. Number:
 Account: MTT

CERTIFICATE OF ANALYSIS A9530172

SAMPLE	PREP CODE	Mn ppm (ICP)	Mo ppm (ICP)	Na % (ICP)	Ni ppm (ICP)	Pb % AAS	Sr ppm (ICP)	Ti % (ICP)	V ppm (ICP)	Zn ppm (ICP)	Cu %	Pb %	Zn %		
39047	205 226	24700	20	< 0.05	< 10	0.797	10	< 0.05	10	66300	0.24	0.83	6.83		
39048	205 226	3020	< 10	< 0.05	< 10	2.71	< 10	< 0.05	< 10	54600	0.23	2.78	5.56		
39049	205 226	1650	< 10	< 0.05	< 10	>10.00	< 10	< 0.05	< 10	>100000	0.05	12.30	44.6		
39050	205 226	15770	10	0.05	< 10	0.025	390	0.05	60	4220	3.13	-----	-----		

CERTIFICATION: Walt Buchler

ARCHER, CATHRO

& ASSOCIATES (1981) LIMITED

CONSULTING GEOLOGICAL ENGINEERS

Box 4127, 2054 SECOND AVENUE, WHITEHORSE, Y.T. Y1A 3S9 Tel (403) 667 - 4415

AFFIDAVIT

I, Joan Mariacher, of WHITEHORSE, YUKON make oath and say:

That to the best of my knowledge the attached Statement of Expenditures for exploration work on the TOUCHDOWN 1-30 mineral claims on Claim Sheet 105 B/7 is accurate.



Joan Mariacher

Sworn before me at WHITEHORSE, YUKON

this 2ND day of

JULY, 1996



Notary, Yukon Territory

**Statement of Expenditures
Touchdown 1-30 Claims
July 1, 1996**

Labour

Bill Wengzynowski, geologist - 8 hrs @ \$40/hr, September 19, 1995	\$342.40	
Brad Wengzynowski, field assistant - 1 day @ \$165/day September 19, 1995	<u>176.55</u>	\$ 518.95

Expenses

Field room and board, 2 mandays @ \$60/day	\$ 128.40	
Frontier Helicopter - 2.8 hrs @ \$615/hr, plus fuel	2,067.63	
Belvedere Hotel	343.38	
Chemex Labs	<u>197.77</u>	<u>2,737.18</u>
		<u>\$3,256.13</u>

FRONTIER

FRONTIER HELICOPTERS
 A division of Conair Aviation Ltd.
 P.O. BOX 220, ABBOTSFORD, B.C. V2S 4N9
 TELEPHONE (604) 855-1190 FAX (604) 855-1017 - ABBOTSFORD, B.C.
 TELEPHONE (403) 536-7766 FAX (403) 536-7705 - WATSON LAKE, YT

FLIGHT TICKET
 No 43505

CUSTOMER ARCITER CASTRO JOB # _____ CUST # _____
 ADDRESS _____ PH () _____
 POSTAL CODE _____
 PILOT R HODGKINSON ENGINEER R CLIFFORD
INITIAL LAST NAME INITIAL LAST NAME
 AIRCRAFT TYPE BELTZUB AIRCRAFT REGISTRATION FFHX
 DATE SEPT 19 BASE/LOCATION WATSON

UP	DOWN	ITINERARY	TIME
0745	0911	DROP OFF BILL + BRAD	1.4
		SW OF CARBON LIS + PICKUP	
			1.4
1700	1824		-
			MINIMUMS
LONG LINE HOURS		TOTAL FLIGHT HOURS	
		2.8	

CHECK ONLY THE MEALS TO BE BILLED TO THE CUSTOMER

Pilot Exp. Cl.# _____ Engineer Exp. Cl.# _____

B L D B L D

OF DROPS _____ FOAM: YES NO

Flying 2.8 hours @ 615 /hr. = \$ 1722.00

Fuel supplied: by FRONTIER CUSTOMER

306 litres from _____ @ \$.66 /L = \$ 201.96

_____ litres from _____ @ \$ _____ /L = \$ _____

2.8 hours oil @ \$ 3.00 /hr. = \$ 8.40

GST #R101084044 Misc. Charges \$ 1937.36

Cash Charge GST \$ 135.27

TOTAL THIS REPORT \$ 2067.63

Pre-flight information received by undersigned

B. Wengysowski
 Customer Signature

Approved By (Print Name) _____

Agency Flight Report # / or Purchase Order # _____

[Signature]
 Pilot Signature

THE CARRIAGE OF PASSENGERS, BAGGAGE AND GOODS BY FRONTIER HELICOPTERS IS SUBJECT TO THE TERMS, CONDITIONS AND LIMITATIONS OF LIABILITY SET FORTH IN ITS TARIFF ELIGIBILITY FOR LOSS OR DAMAGE TO GOODS IS LIMITED TO 50¢ PER POUND, WHICH IS AVAILABLE FOR EXAMINATION AT THE OFFICE OF FRONTIER HELICOPTERS, ABBOTSFORD AIRPORT, ABBOTSFORD, B.C.

Terms: Net due upon receipt of invoice. Interest charged on overdue accounts at 2.0% per month (24% per annum)

Belvedere Motor Hotel
 Box 288
 Watson Lake, YT Y0A 1C0

INVOICE
 039305

DATE
SEPT 26/95

SOLD TO: BILL/BRAD
ARCHER CATRO

SHIPPED TO:

CUSTOMER ORDER NO.	OUR ORDER NO.	SALESPERSON	TERMS	FOB	DATE SHIPPED	SHIPPED VIA

ORDERED	SHIPPED	DESCRIPTION	UNIT PRICE	UNIT	AMOUNT
		Accommod.			1349.45
		Spn B-to incl.			+ 24.08
		Normal - F			<u>1373.53</u>
		1283.67			
		89.86			
		<u>1373.53</u>			
		TOTAL:			1349.45 1373.53

BEST ATTAINABLE
 IMAGE



Chemex Labs Ltd.

Analytical Chemists * Geochemists * Registered Assayers
212 Brooksbank Ave., North Vancouver
British Columbia, Canada V7J 2C1
PHONE: 604-984-0221

To: NORDAC RESOURCES LTD.
C/O ARCHER, CATHRO
BOX 4127, 2054 SECOND AVE.
WHITEHORSE, YT
Y1A 3S9

INVOICE NUMBER **I 9 5 2 1 3 5 9**

BILLING INFORMATION

Date: 17-JUL-95
Project: TOUCHDOWN
P.O. No.:
Account: MTT

Comments:

Billing: For analysis performed on
Certificate A9521359

Terms: Payment due on receipt of invoice
1.25% per month (15% per annum)
charged on overdue accounts

Please Remit Payments to:

CHEMEX LABS LTD.
212 Brooksbank Ave.,
North Vancouver, B.C.
Canada V7J 2C1

# OF SAMPLES	ANALYSED FOR CODE - DESCRIPTION	UNIT PRICE	SAMPLE PRICE	AMOUNT
3	205 - Geochem ring to approx 150 mesh	2.50		
	226 - 0-3 Kg crush and split	2.60		
	3204 - Save 1 Kg reject for 90 days	0.00		
	ICP-32	7.00		
	100 - Au ppb FA+AA	8.50	20.60	61.80
Total Cost \$				61.80
Client Discount (25%) \$				-15.45
Net Cost \$				46.35
(Reg# R100938885) GST \$				3.24
TOTAL PAYABLE (CDN) \$				49.59

Joli - 396.75
field - 46.35
MTT - 31.01

474.11

Jul July 31/95
#120



Chemex Labs Ltd.

Analytical Chemists * Geochemists * Registered Assayers
212 Brooksbank Ave., North Vancouver
British Columbia, Canada V7J 2C1
PHONE: 604-984-0221

To: NORDAC RESOURCES LTD.
C/O ARCHER, CATHRO
BOX 4127, 2054 SECOND AVE.
WHITEHORSE, YT
Y1A 3S9

INVOICE NUMBER

I 9 5 3 0 1 7 2

BILLING INFORMATION

Date: 20-OCT-95
Project: CODE TOUCHDOWN
P.O. No.:
Account: MTT

Comments:

Billing: For analysis performed on
Certificate A9530172

Terms: Payment due on receipt of invoice
1.25% per month (15% per annum)
charged on overdue accounts

Please Remit Payments to:

CHEMEX LABS LTD.
212 Brooksbank Ave.,
North Vancouver, B.C.
Canada V7J 2C1

# OF SAMPLES	ANALYSED FOR CODE - DESCRIPTION	UNIT PRICE	SAMPLE PRICE	AMOUNT
3	205 - Geochem ring to approx 150 mesh	2.50		
	226 - 0-3 Kg crush and split	2.60		
	3204 - Save 1 Kg reject for 90 days	0.00		
	A-3 Cu,Pb,Zn assay group	18.75		
	A-22 ICP Package	16.50		
100 - Au ppb	FA+AA	8.50	48.85	146.55
1	205 - Geochem ring to approx 150 mesh	2.50		
	226 - 0-3 Kg crush and split	2.60		
	3204 - Save 1 Kg reject for 90 days	0.00		
	A-22 ICP Package	16.50		
100 - Au ppb	FA+AA	8.50		
301 - Cu	%	8.00	38.10	38.10

Total Cost \$	184.65
Client Discount (25%) \$	-46.16
Net Cost \$	138.49
(Reg# R100938885) GST \$	9.69

TOTAL PAYABLE (CDN) \$ 148.18

ARCHER, CATHRO & ASSOCIATES (1981) LIMITED

In Account With

Project —

NORDAC - FIELD ACCOUNT

Date —

SEPTEMBER 30, 1995

LABOUR			
Field	A. ARCHER - 5 HRS AT 60/HR	300.00	
	R. CARNE - 63 HRS AT 50/HR	3150.00	
	D. EATON - 22 HRS AT 50/HR	1100.00	
	B. WENZLYNOWSKI - 131 HRS AT 40/HR	5240.00	
	BRAD WENZLYNOWSKI - 16 DAYS AT 165/DAY	2640.00	
Office	M. COOKE - 5 1/4 HRS AT 30/HR (OVR)	105.00	
Accounting & Expediting	J. MARIACHEL - 43 1/4 HRS AT 44.50/HR	1838.13	14373.13
OTHER SERVICES:			
	Room & Board In Whitehorse 3 DAYS AT 60/DAY	180.00	
	Field equipment from AC stock 32 MANDAYS AT 10/DAY + 39.90 + 250.03	709.93	
	Photocopies, 899 copies at 25¢/copy	224.75	
	Rentals from AC. SEPT 14-27 - 56X11 AT 10/DAY	160.00	
	RENT & OFFICE SUPPLY - OCTOBER	1000.00	
Blueprinting	sq.ft. Ozalid at \$/ft, plus sq.ft. Dilar at \$/ft.		
Drafting	15 hrs at \$33.75/hr. (OVR-84.38 + DV-441.87)	506.25	
LOOMIS COURIER	1 AT 14.50 EA	14.50	2793.43
EXPENSES			
Petty Cash			
Telephone	4.10 + 106.53 + 13.08	123.71	
R. CARNE - XP TR	944.06 DV + 157.72 DV + 221.50 F (FRESNO/RUEL)	1323.28	
CARMACKS HOTEL		47.80	
SECOND AVENUE CHEYRON	- 38.51 + 32.71	71.22	
CARL	- 115.55 + 20.10	135.65	
RECEIVED GENERAL MAPS		57.40	
FRONTIER HELICOPTERS	- 444.80 DV + 3381.30 + 2069.82	5895.92	
B. WENZLYNOWSKI - XP TR	- 212.27 DV + 110.28 DV	322.55	
YVON BILLINE SUPPLIES		215.23	
ALKAN AIR		86.85	
MAC'S BOOKS		11.58	
BELVEDERE MOTOR HOTEL		1483.67	
NORCAN LEASING		880.00	
CAMP - GROUND SERVICES		204.66	10658.02
MANAGEMENT 6% - ON EXPENSES		639.48	
- ON FIELD AC		1504.26	2143.74
			27968.32
ST (R100247667)	7% ON 27968.32		2097.78
- GST Exempt			32066.10