



MAP NO.: ASSESSMENT REPORT X
105 D 5 PROSPECTUS
CONFIDENTIAL X
OPEN FILE

DOCUMENT NO: 093058
MINING DISTRICT: WHITEHORSE
TYPE OF WORK: GEOCHEMISTRY
Your file *Votre référence*

REPORT FILED UNDER: J. PETER ROSS

Our file *Notre référence*

DATE PERFORMED: SEPT 15, 1991, JULY 7-22, 1992 DATE FILED: DECEMBER 23, 1992

LOCATION: LAT.: 60°21'N

AREA: ROSE LAKE

LONG.: 135°51'W

VALUE \$: 8600

CLAIM NAME & NO.: PUPPY 2 (YB36280), PUPPY 4-8 (YB36283-86), PUPPY 10 (YB36288)
PUPPY 12 (YB36290), PUPPY 16 (YB36294), LOVE 1, 3, 5, 7, 9, 11, 15 (YB36295, 97, 99, 301, 303
305, 309)

WORK DONE BY: J. PETER ROSS

WORK DONE FOR: J. PETER ROSS

DATE TO GOOD STANDING:

REMARKS: FIFTY-SIX SOIL SAMPLES WERE COLLECTED. TRENCHES WERE
CLEANED OUT. THE PROPERTY COVERS AN OLD KENO HILL SKARN OCCURRENCE
OF PB, ZN, AG.



TRANSMITTAL FORM

M.R. file no.
R.M.M.R. file no.
Date forwarded <i>23 Dec '92</i>

From ► Mining Recorder at: *Whitehorse*

To ► Regional Manager, Mineral Rights at Whitehorse, Y.T.

For action are:

<input type="checkbox"/> NEW APPLICATION FOR PLACER LEASE TO PROSPECT	Name	
<input type="checkbox"/> RENEWAL APPLICATION PLACER LEASE TO PROSPECT	Name	Lease no.
<input type="checkbox"/> AFFIDAVIT OF EXPENDITURE ON PLACER LEASE	Name	Lease no.
<input type="checkbox"/> SECURITY DEPOSIT		
<input type="checkbox"/> FINANCIAL ABILITY		
<input type="checkbox"/> ASSIGNMENT OF PLACER LEASE NO.	From	
<input type="checkbox"/> GROUPING APPLICATION UNDER SEC. 52(2) PLACER MINING ACT.	Owner	
<input type="checkbox"/> DIAMOND DRILL LOGS	Claims	Claim sheet no.
<input checked="" type="checkbox"/> QUARTZ ASSESSMENT REPORT	Claims <i>Puppy 2,4,5,6-8,10,12,16 Love 1,3,5,7,9,11,15</i>	Claim sheet no. <i>105-D-5</i>
	Type of report <i>Prospecting, Geochem</i>	Submitted by <i>J.P. Ross</i>
	Clas. work performed on <i>Puppy, Love</i>	\$ req. for ren. application <i>8400.00</i>

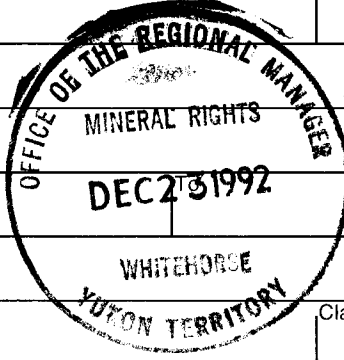

A Southwick
Signature

REPLY ACTION Date returned

093058

Signature

Geochemical and Prospecting Report
on the PUPPY and LOVE Claims

Whitehorse Mining District

by

J. Peter Ross, Prospector



N.T.S. 105 D/5

Latitude 60° 21' N

Longitude 135° 51' W

Dates: 15-Sep-91, 07-Jul to 22-Jul-92

Dated: December, 1992

093058

This report has been examined by
the Geological Evaluation Unit
under Section 53 (4) Yukon Quartz
Mining Act and is allowed as
representation work in the amount
of \$ 8600.

for 
Regional Manager, Exploration and
Geological Services for Commissioner
of Yukon Territory.

TABLE OF CONTENTS

Chapter One: Summary and Recommendations	
1.1 Summary and Conclusions	3
1.2 Recommendations	3
Chapter Two: Introduction	
2.1 Introductory Statement	6
2.2 Location and Access	6
2.3 History	6
Chapter Three: Property Description	7
Chapter Four: Geochemical Survey	
4.1 General	9
4.2 Interpretation	9
Chapter Five: Prospecting	14

LIST OF FIGURES

Figure 1: Location Map	4
Figure 2: Claim Location Map	5
Figure 3: Regional Geology	8
Figure 4: Location of Rock Samples	10
Figure 5: Soil Sample Locations	11
Figure 6: Lead Geochemistry - ppm	12
Figure 7: Zinc Geochemistry - ppm	13

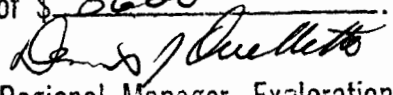
APPENDICES

Appendix 1: References	
Appendix 2: Statement of Costs	
Appendix 3: Statement of Qualifications, J. Peter Ross	
Appendix 4: Soil Geochemistry - Assay Results	
Appendix 5: Rock Samples - Assay Results	

Chapter One: SUMMARY and RECOMMENDATIONS

1.1 Summary and Conclusions

The PUPPY 1-16 and LOVE 1-16 were staked from 30 July to 12 August 1991 by J. Peter Ross.

The property was discovered in 1978 by United Keno Hill Mines Limited (UKHM). Following this, they staked and explored this interesting lead-zinc-silver occurrence.

The property is underlain by Cretaceous granodiorite, Precambrian limestone, and schists.

Fifty six soil samples were taken, trenches on the UKHM showings were cleaned out, and prospecting of the claims was done.

No new showings were found, but new areas that are anomalous in Pb and Zn were located.

1.2 Recommendations

More soil samples should be taken to the northwest. New soil anomalies should be trenched by hand. A few of the UKHM anomalies were not trenched, they should be located, and trenched, if possible.

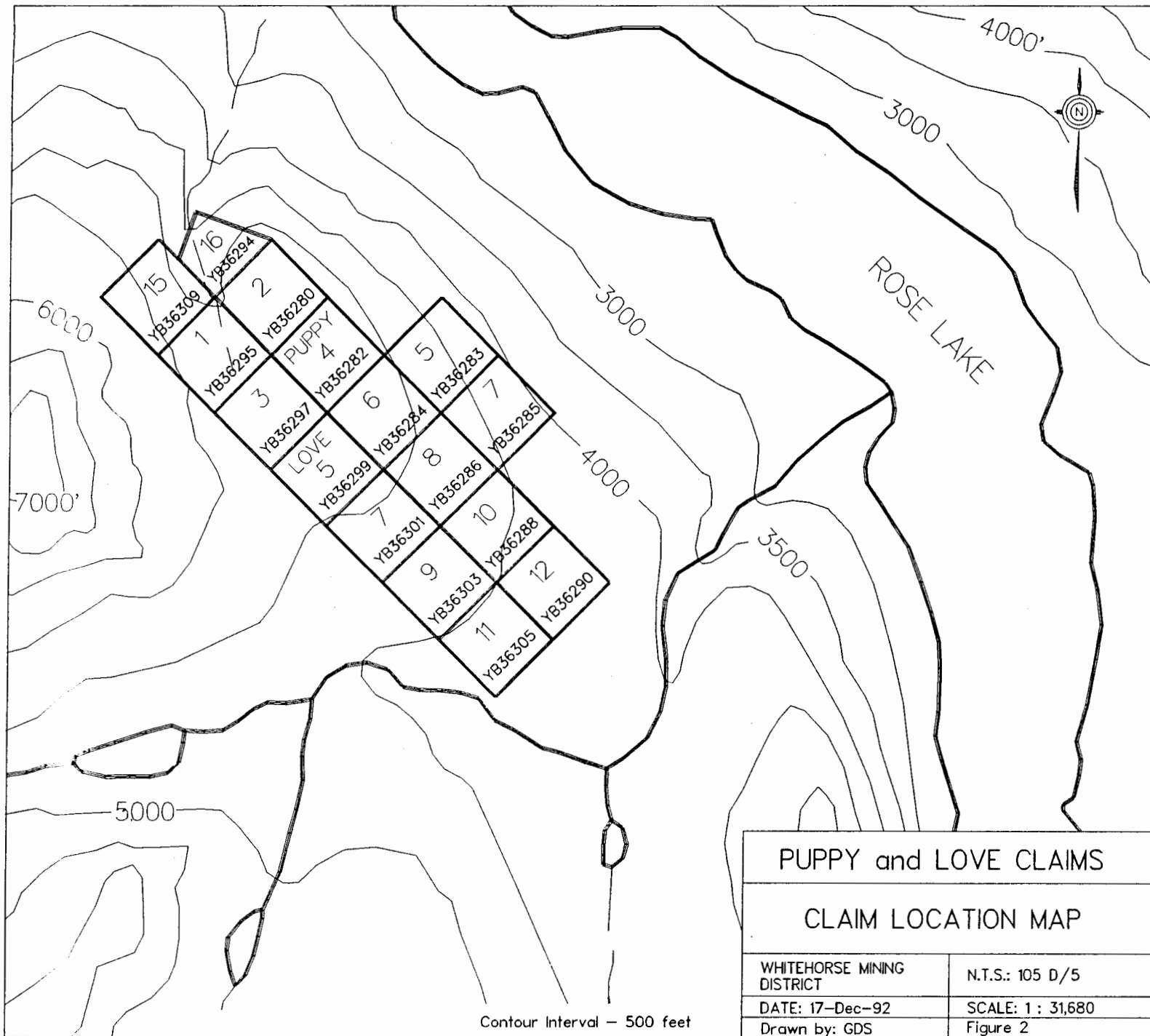

Chapter Two: INTRODUCTION

2.1 Introductory Statement

On September 15, 1991, J. Peter Ross, accompanied by Cameron Reed and Gregg Jilson of Curragh Resources Inc. inspected the property. One rock sample (composite bedrock) was taken.

From July 7 to July 22, 1992, J. Peter Ross camped on the claims and did prospecting, soil sampling, and cleaned out some of the old UKHM trenches.

2.2 Location And Access

The PUPPY 2,4,5,6,7,8,10,12,16 and LOVE 1,3,5,7,9,11,15 claims are located approximately 64 km (40 miles) southwest of Whitehorse, Yukon, and 2.4 km (1.5 miles) west of Rose Lake, N.T.S. 105 D/5, latitude 60° 21' N, longitude 135° 51' W.

Access is by charter helicopter from Whitehorse.

2.3 History

The PUPPY and LOVE claims are located in the Whitehorse map area (NTS 105 D). Reconnaissance geology was by Wheeler, 1948-1951.

United Keno Hill Mines Limited discovered a new Pb-Zn-Ag showing and staked the DEB 1-28 claims on 22 August 1978. The claims were soil sampled, except for areas of steep terrain. Geological mapping was done and the central claims had geophysical work performed on them. The main showing was blasted, trenched by hand, and sampled.

UKHM did physical work to keep the claims to 1988. Payments in lieu were then made until the claims were allowed to lapse in 1990.

Prior to the reorganization of UKHM in early 1990, the company had budgeted \$300,000 to diamond drill the property.

Chapter Three: PROPERTY DESCRIPTION

<u>Claim Name</u>	<u>Grant No.</u>	<u>Date Staked</u>	<u>Date Recorded</u>	<u>Expiry Date</u>
PUPPY 2	YB36280	30-Jul-91	14-Aug-91	14-Aug-97
PUPPY 4	YB36282	30-Jul-91	14-Aug-91	14-Aug-97
PUPPY 5	YB36283	04-Aug-91	14-Aug-91	14-Aug-97
PUPPY 6	YB36284	04-Aug-91	14-Aug-91	14-Aug-97
PUPPY 7	YB36285	05-Aug-91	14-Aug-91	14-Aug-97
PUPPY 8	YB36286	05-Aug-91	14-Aug-91	14-Aug-97
PUPPY 10	YB36288	06-Aug-91	14-Aug-91	14-Aug-97
PUPPY 12	YB36290	07-Aug-91	14-Aug-91	14-Aug-97
PUPPY 16	YB36294	12-Aug-91	14-Aug-91	14-Aug-97
LOVE 1	YB36295	31-Jul-91	14-Aug-91	14-Aug-97
LOVE 3	YB36297	02-Aug-91	14-Aug-91	14-Aug-97
LOVE 5	YB36299	02-Aug-91	14-Aug-91	14-Aug-97
LOVE 7	YB36301	04-Aug-91	14-Aug-91	14-Aug-97
LOVE 9	YB36303	05-Aug-91	14-Aug-91	14-Aug-97
LOVE 11	YB36305	06-Aug-91	14-Aug-91	14-Aug-97
LOVE 15	YB36309	10-Aug-91	14-Aug-91	14-Aug-97

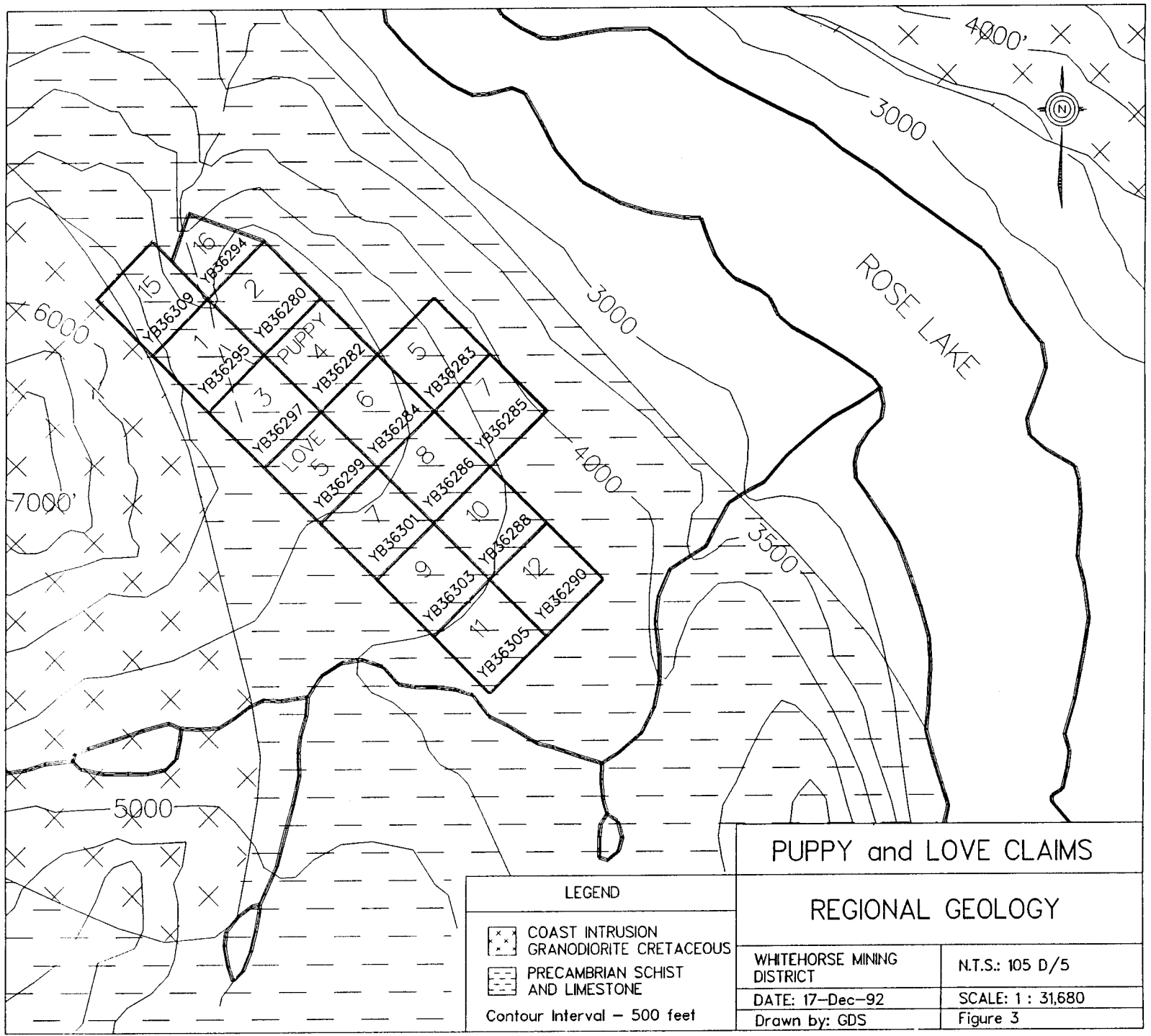

LEGEND	
	COAST INTRUSION GRANODIORITE CRETACEOUS
	PRECAMBRIAN SCHIST AND LIMESTONE
Contour Interval - 500 feet	

PUPPY and LOVE CLAIMS	
REGIONAL GEOLOGY	
WHITEHORSE MINING DISTRICT	N.T.S.: 105 D/5
DATE: 17-Dec-92	SCALE: 1 : 31,680
Drawn by: GDS	Figure 3

Chapter Four: GEOCHEMICAL SURVEY

4.1 General

The northwest end of UKHM's 1978 soil grid was located. Two new soil lines were run from this location to try to extend the Pb-Zn anomalies.

Lines were 300 feet apart and on 100 foot intervals. Soil sample pits were marked with fluorescent tape and were 0-10 cm deep. Soil was mostly brown, and from the B horizon.

4.2 Interpretation

An extension of the existing Pb-Zn anomaly was located.

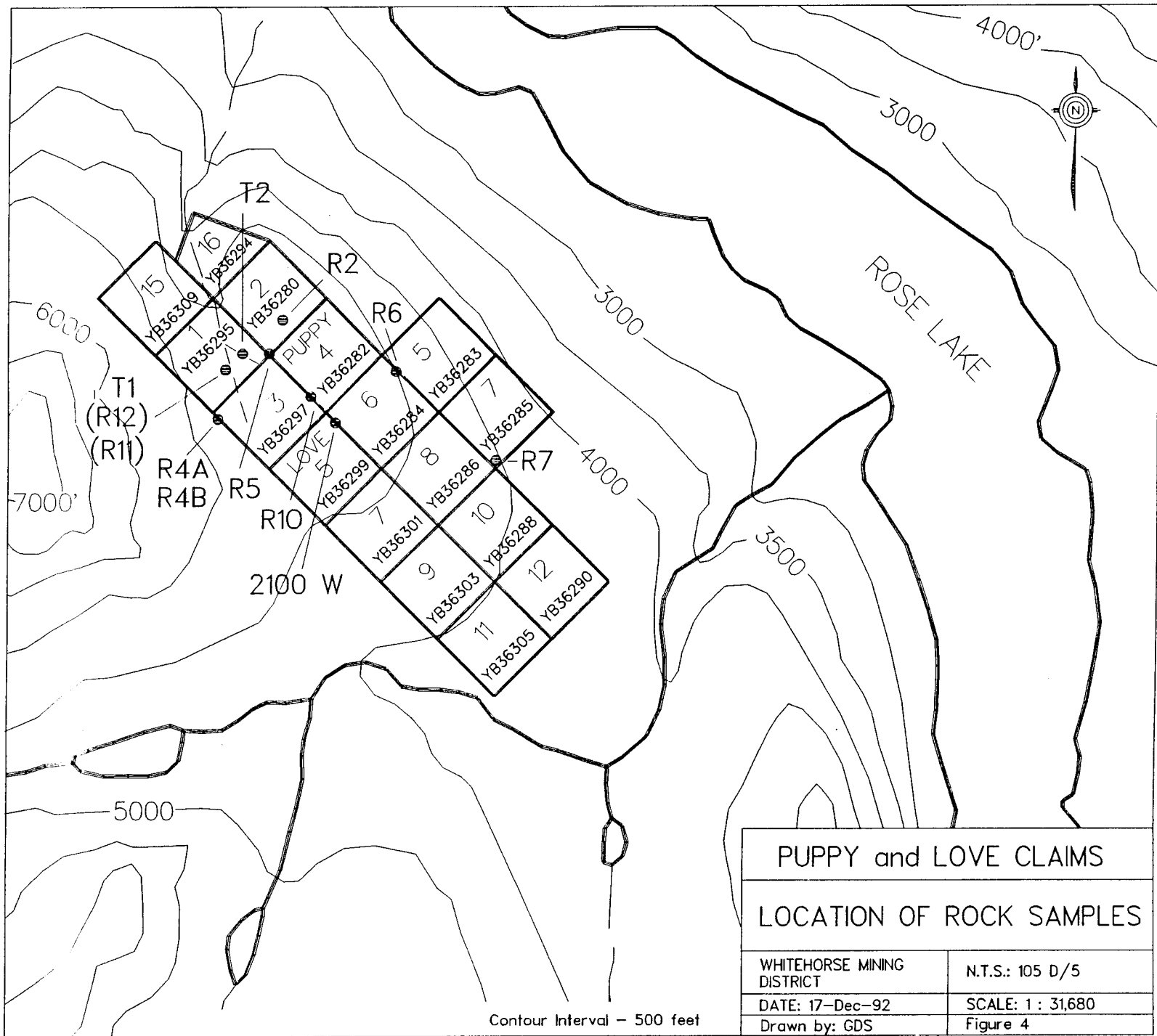

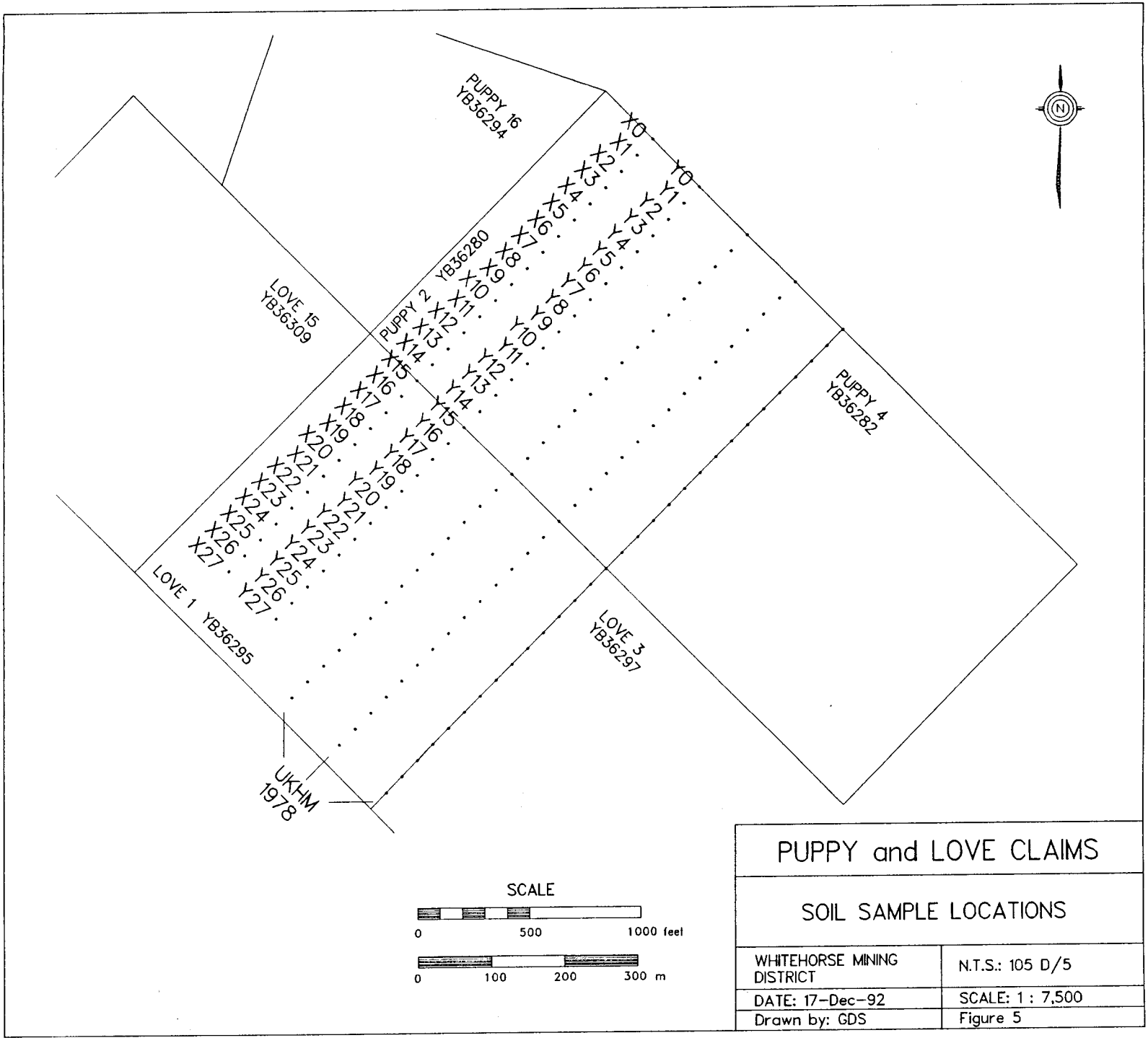

LOVE 15
YB36309

PUPPY 16
YB36294

PUPPY 2
YB36280

PUPPY A
YB36282

LOVE 1
YB36295

LOVE 3
YB36297

UKFM
1978

SCALE

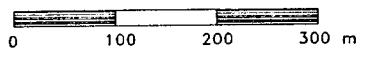
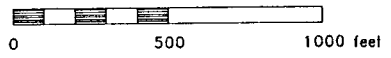

PUPPY and LOVE CLAIMS

SOIL SAMPLE LOCATIONS

WHITEHORSE MINING
DISTRICT

N.T.S.: 105 D/5

DATE: 17-Dec-92

SCALE: 1 : 7,500

Drawn by: GDS

Figure 5

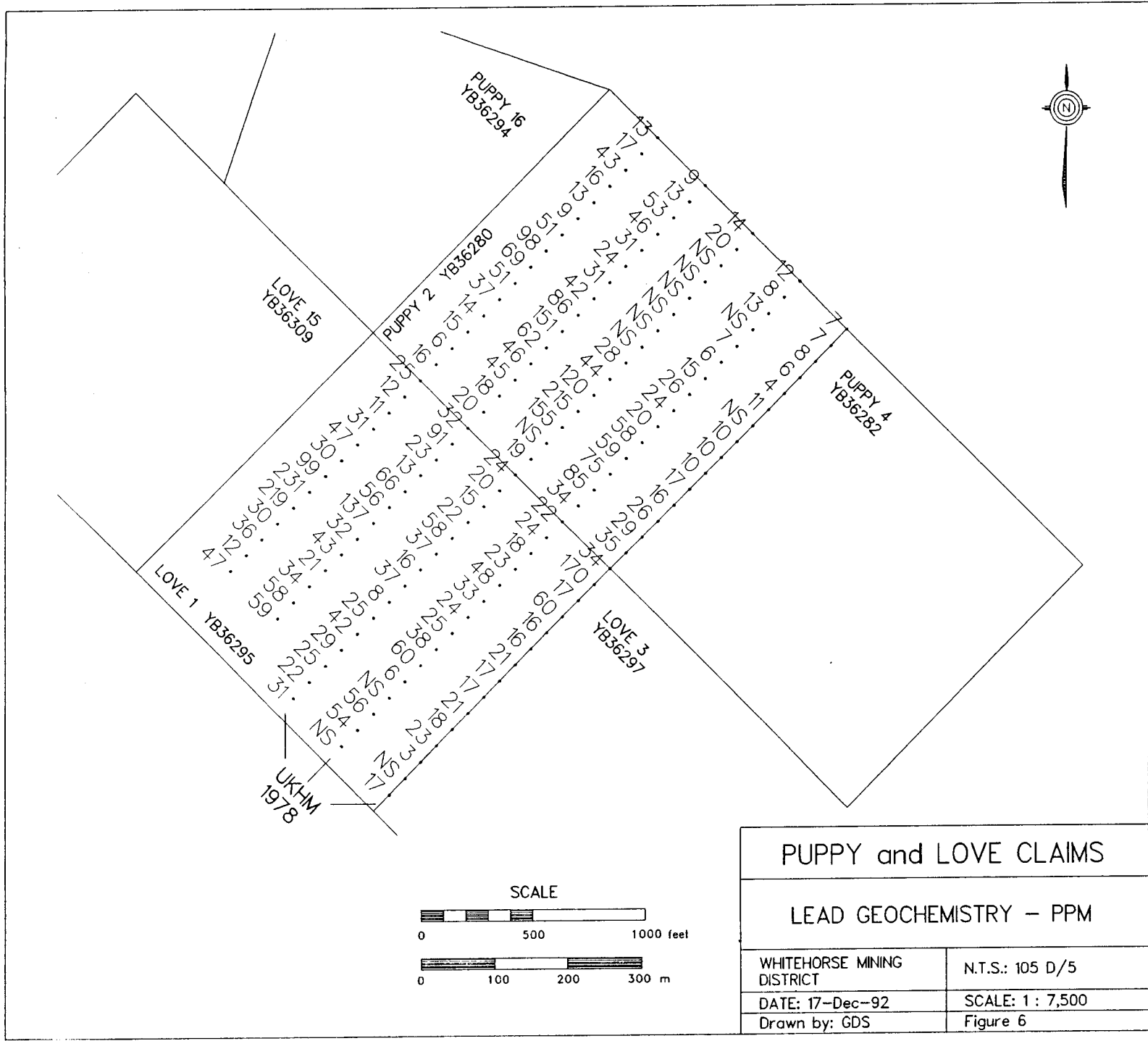

LOVE 15
YB36309

PUPPY 16
YB36294

PUPPY 2
YB36280

PUPPY 4
YB36282

LOVE 1
YB36295

LOVE 3
YB36297

UKHM
1978

SCALE

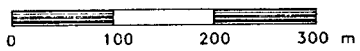
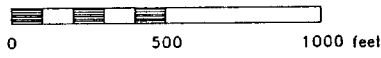

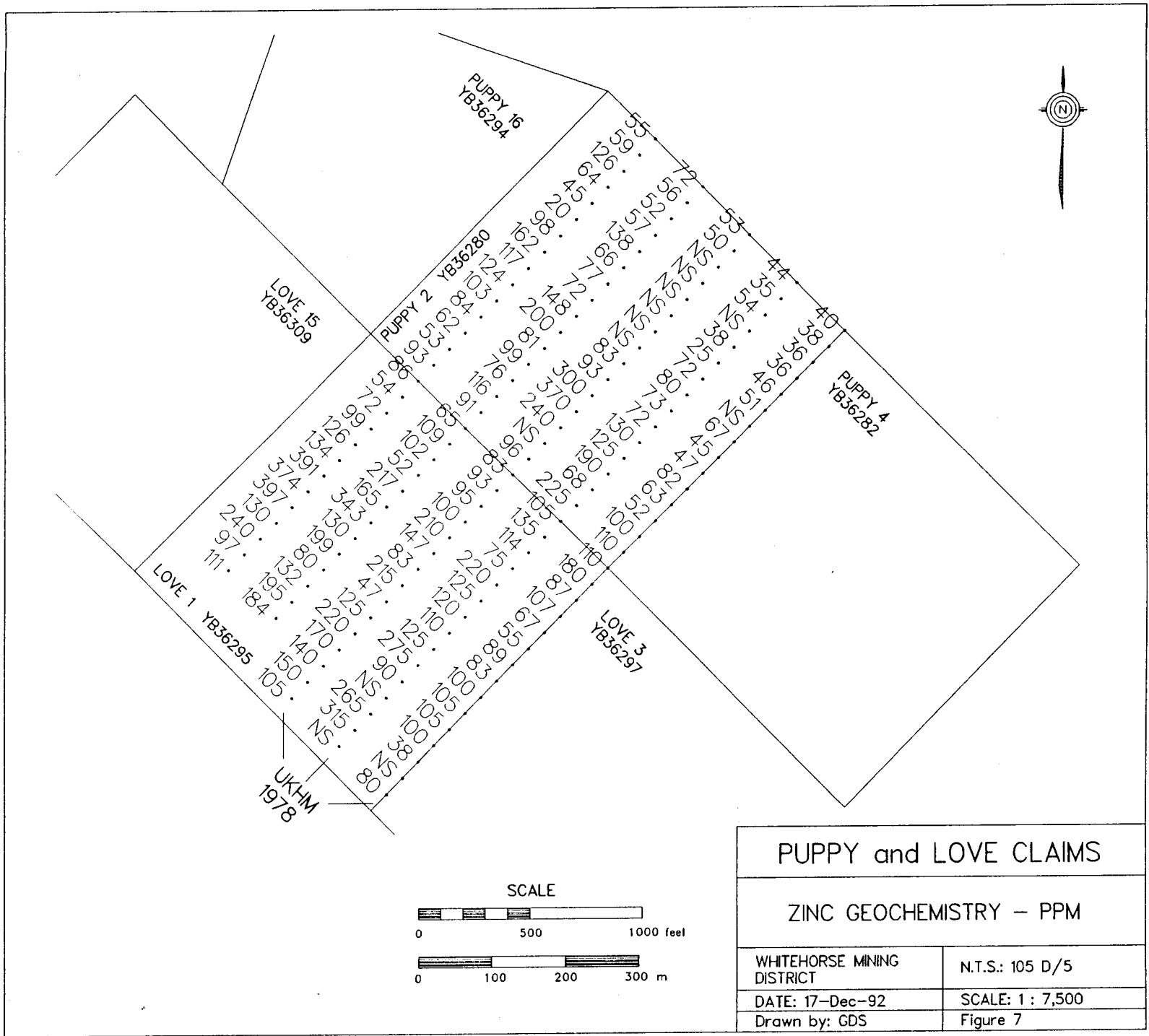

PUPPY and LOVE CLAIMS

ZINC GEOCHEMISTRY – PPM

WHITEHORSE MINING DISTRICT	N.T.S.: 105 D/5
DATE: 17-Dec-92	SCALE: 1 : 7,500
Drawn by: GDS	Figure 7

Chapter Five: PROSPECTING

All of the showings found by UKHM were located and marked. The trenches on the best showings were cleaned out (material was removed and the trenches swept clean to hard bedrock).

The area of Cu-Ag float found by UKHM was not located.

UKHM's anomalous areas for Pb-Zn were prospected.

No new showings were located.

Ten samples of float material were taken for assay.

Appendix 1

References

Watson, P., Joy, R.J., 1978
United Keno Hill Mines Limited
Report on the DEB Claim Group
NTS 105 D/5
Whitehorse Mining District

Joy, R.J., 1979
United Keno Hill Mines Limited
Report on the DEB Claim Group
NTS 105 D/5
Whitehorse Mining District

Wheeler, J.O., 1960
Whitehorse Map Area
Geological Survey of Canada
Memoir 312

Appendix 2

Statement Of Costs

Claims: PUPPY 2,4,5,6,7,8,10,12,16 - YB36280, YB36282, YB36283, YB36284,
YB36285, YB36286, YB36288, YB36290, YB36294

LOVE 1,3,5,7,9,11,15 - YB36295, YB36297, YB36299, YB36301, YB36303,
YB36305, YB36309

<u>Labour:</u>	J.Peter Ross	16 days @ \$200/day 07-Jul to 22-Jul-92	\$3,200.00	
	Gregg Jilson	15-Sep-91	200.00	
	Cameron Reed	15-Sep-91	200.00	
	J.Peter Ross	15-Sep-91	<u>200.00</u>	
		Subtotal	3,800.00	3,800.00
<u>Camp Costs</u>		17 days @ \$52.85/day		898.45
<u>Transportation</u>	Helicopter	Curragh, 15-Sep-91	1,084.70	
		Ross, 1992	<u>1,356.92</u>	
		Subtotal	2,441.62	2,441.62
<u>Assay</u>	1 rock (Curragh)		20.00	
	10 rocks		200.00	
	56 soils @ \$5.89	Pb, Zn	<u>329.56</u>	
	Subtotal		549.56	549.56
<u>Report Preparation</u>				800.00
	TOTAL			\$8,489.63

STATEMENT OF QUALIFICATIONS

I, John Peter Ross, do hereby certify that I:

1. am a qualified prospector with mailing address;

Box 4842
Whitehorse, Yukon
Canada Y1A 4N8

2. graduated from McGill University in 1970 with a B.Sc. General Science
3. have attended and finished completely the following courses;
1974 - BC & Yukon Chamber of Mines, Prospecting Course
1978 - United Keno Hill Mines Limited, Elsa, Yukon, Prospecting Course
1987 - Yukon Chamber of Mines, Advanced Prospecting Course
4. did all the work and the writing of this report
5. have been on the Yukon Prospectors' Assistance and Yukon Mining Incentive Program 1986 - 1992
6. have been on the British Columbia Prospectors' Assistance Program 1989 - 1990
7. have a 100% interest in the claims described in this report at the present time

John Peter Ross
Nov. 30, 1992

YUKON CHAMBER OF MINES

This Certifies That J. PETER ROSS

has completed the

ADVANCED PROSPECTING COURSE

Whitehorse, Yukon Territory

1987

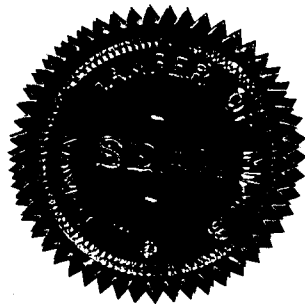

M. Howett

Chairman, Prospectors Course
Committee

Wayne Reil

President

Appendix 4

Soil Geochemistry - Assay Results



14-Aug-92 date

Assay Certificate

page 1

Peter Ross

WO#13649

Sample #	Pb ppm	Zn ppm
X 0	9	72
X 1	13	56
X 10	62	81
X 11	46	99
X 12	45	76
X 13	18	116
X 14	20	91
X 15	32	65
X 16	91	109
X 17	23	102
X 18	13	52
X 19	66	217
X 2	53	52
X 20	56	165
X 21	137	343
X 22	32	130
X 23	43	199
X 24	21	80
X 25	34	132
X 26	58	195
X 27	59	184
X 3	46	57
X 4	31	138
X 5	24	66
X 6	31	77
X 7	42	72
X 8	86	148
X 9	151	200
Y 0	13	55
Y 1	17	59
Y 10	37	103
Y 11	14	84
Y 12	15	62
Y 13	6	53
Y 14	16	93
Y 15	25	86
Y 16	12	54
Y 17	11	72

Certified by *Chyolka*





14-Aug-92 date

Assay Certificate

page 2

Peter Ross

WO#13649

Sample #	Pb ppm	Zn ppm
Y 18	31	99
Y 19	47	126
Y 2	48	57
Y 20	30	134
Y 21	99	391
Y 22	231	374
Y 23	219	397
Y 24	30	130
Y 25	36	240
Y 26	12	97
Y 27	47	111
Y 3	16	64
Y 4	13	45
Y 5	9	20
Y 6	51	98
Y 7	98	162
Y 8	69	117
Y 9	51	124

Certified by

Chyolki



Appendix 5

Rock Samples - Assay Results

ACME ANALYTICAL LABORATORIES LTD.

852 E. HASTINGS ST. VANCOUVER B.C. V6A 1R6

PHONE(604)253-3158 FAX(604)253-1716



GEOCHEMICAL ANALYSIS CERTIFICATE



Northern Analytical Labs. Ltd. PROJECT WO#13335 File # 91-3927

105 Copper Road, Whitehorse YT Y1A 2Z7

SAMPLE#	Mo ppm	Cu ppm	Pb ppm	Zn ppm	Ag ppm	Ni ppm	Co ppm	Mn ppm	Fe %	As ppm	U ppm	Au ppm	Th ppm	Sr ppm	Cd ppm	Sb ppm	Bi ppm	V ppm	Ca %	P %	La ppm	Cr ppm	Mg %	Ba ppm	Ti %	B ppm	Al %	Na %	K %	W ppm
R-2	1	230	7	19	.2	22	9	71	1.67	2	9	ND	9	977	.4	2	2	15	14.18	.028	14	24	.25	48	.06	5	4.35	.12	.17	1
R-4A	1	11	4	9	.1	2	1	109	.13	7	5	ND	3	107	.2	3	2	1	14.87	.044	2	5	6.16	19	.01	17	.11	.01	.01	1
R-4B	1	24	14	24	.1	2	1	137	.15	11	5	ND	1	87	.2	2	2	1	14.22	.029	2	3	7.32	49	.01	16	.06	.01	.01	1
R-5	5	54	49	100	10.3	11	5	173	1.16	5	5	ND	8	11	.2	2	2	8	.57	.027	26	61	.65	58	.05	3	.63	.01	.07	1
R-6A	1	85	2	35	.1	78	34	394	7.35	2	5	ND	1	22	.3	2	2	157	.34	.012	3	183	1.79	233	.17	2	3.97	.08	.63	1
R-7	5	65	5	31	.1	16	9	899	6.96	8	5	ND	11	23	.2	2	2	34	.19	.103	22	58	1.75	44	.01	2	3.21	.07	.05	1
R-10	2	307	11	925	2.1	5	9	2604	4.06	4	5	ND	2	165	10.5	2	2	16	4.07	.034	7	24	1.05	30	.01	2	1.26	.01	.01	1
RE R-7	5	66	9	50	.1	14	9	941	7.00	9	5	ND	12	25	.2	2	2	34	.24	.106	23	56	1.80	40	.01	2	3.20	.07	.05	1
R-11	13	9	5	13	.2	5	2	92	.54	3	5	ND	1	2	.2	2	2	2	.04	.004	2	134	.06	5	.01	4	.13	.01	.01	1
R-12	9	24	5	29	.1	5	2	91	.91	2	5	ND	1	5	.2	2	2	3	.11	.005	2	96	.10	10	.01	3	.21	.01	.01	1

ICP - .500 GRAM SAMPLE IS DIGESTED WITH 3ML 3-1-2 HCL-HNO3-H2O AT 95 DEG. C FOR ONE HOUR AND IS DILUTED TO 10 ML WITH WATER.
 THIS LEACH IS PARTIAL FOR MN FE SR CA P LA CR MG BA TI B W AND LIMITED FOR NA K AND AL. AU DETECTION LIMIT BY ICP IS 3 PPM.
 - SAMPLE TYPE: PULP Samples beginning 'RE' are duplicate samples.

DATE RECEIVED: AUG 28 1991

DATE REPORT MAILED: *Sept 3/91*SIGNED BY: *C. Leong* D. TOYE, C. LEONG, J. WANG; CERTIFIED B.C. ASSAYERS



August 29, 1991

Work Order # 13335

Peter Ross

Assay Certificate For Samples Provided

Sample #	Au ppb
R-2	15
R-4A	12
R-4B	16
R-5	14
R-6	<5
R-7	<5
R-10	9
R-11	<5
R-12	<5

Certified by CHyoki





October 1, 1991

Work Order # 13440

Curragh Resources Inc.
117 Industrial Rd.
Whitehorse, Yukon
Y1A 2T8

File # 13440

P.O. # 400364

Assay Certificate For Samples Provided

Sample #	Au ppb	Ag ppm	Pb ppm	Zn ppm
2100 W	41	1.6	29	30

Certified by Chyoki

