

MAP NO.: ASSESSMENT REPORT X
115 H 04 PROSPECTUS
CONFIDENTIAL X
OPEN FILE

DOCUMENT NO: 093054
MINING DISTRICT: WHITEHORSE
TYPE OF WORK: SOIL SAMPLING

REPORT FILED UNDER: J. PETER ROSS

DATE PERFORMED: AUGUST 22-25, 1992

DATE FILED: OCTOBER 6, 1992

LOCATION: LAT.: 61°31'N

AREA: RUBY RANGE

LONG.: 137°45'W

VALUE \$: 1,800

CLAIM NAME & NO.: MALOU 1-6 (YB35901-906)

WORK DONE BY: J. PETER ROSS

WORK DONE FOR: J. PETER ROSS

DATE TO GOOD STANDING:

REMARKS: SOIL SAMPLING WAS DONE BETWEEN MALOU 1 AND 2 CLAIMS
RESULTING IN SEVERAL ANOMALIES IN GOLD AND ARSENIC.
A TOTAL OF 40 SOIL SAMPLES WERE COLLECTED.

Geochemical Report
on the
Malou 1-6 Claims

J.P. Ross



093 05 4

NTS 115 H14
Latitude 61 11'
Longitude 137 45'
Dates August 22-29/1991

This report has been examined by
the Geological Evaluation Unit
under Section 53 (4) Yukon Quartz
Mining Act and is allowed as
representation work in the amount
of \$ 1800

for 
Regional Manager, Exploration and
Geological Services for Commissioner
of Yukon Territory.

TABLE OF CONTENTS

	Page #
1. Summary and Conclusions	3
2. Recommendations	4
3. Introduction	4
4. Location and Access	5
5. History	5
6. Property	6
7. Geochemical Survey	
a. General	6
b. Interpretation	6
8. Figure 1: Location Map	7
9. Figure 2: Claim Location Map	8
10. Figure 3: Regional Geology	9
11. Soil Geochemistry (Gold/Arsenic)	10
12. Appendix A: References	11
13. Appendix B: Project Costs	12
14. Appendix C: Statement of Qualifications	13
- Yukon Chamber of Mines Prospecting Course Certification	14
15. Appendix D: Soil Sample Results	15-19

1. Summary and Conclusions

The Malou 1-6 claims were staked in June 1991. A government open file geochemical survey in the past showed the area to be anomalies in gold and arsenic.

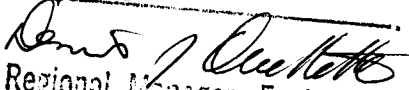
The property is underlain by paleozoic hornfels schist.

Forty (40) soil samples.

Interesting Au and As soil anomalies were found.

2. Recommendations

More soil sampling should be carried out.

3. Introduction

J. Peter Ross camped at the Malou 1-6 claims from August 22/91 to August 29/91 and took 40 soil samples (tested for Au and As). One rock was tested for Au and 31 elements. Bad weather including snow allowed only 2 days of work.

4. Location and Access

The Malou 1-6 claims are located 48 kilometers by air northwest of Haines Junction on NTS 115 H/4 at latitude 61 11' and longitude 137 45' (figure 1). The claims are on a ridge northwest of Killermum Lake. Access was with Trans North helicopter from Haines Junction.

5. History

The Malou claims are located in the Aishihik Lake map area (NTS 115H), Reconnaissance Geology by Tempelman-Kluit 1974.

United Keno Hill Mines (UKHM) staked the Ruby 7-12 claims in 1986 after a government open file release showed the area to be anomalies in Au and As. UKHM did minor soil sampling and prospecting. They found no signs of previous activity. Report by Lori Walton 1988.

The Ruby Range has many small to medium gold placer producing creeks. Ruby Creek and Fourth of July Creek are close to the area. Debicki and Gilbert 1986.

Gold has been located to the north in float and to the east in veins on the LIB Claim.

6. Property

Claim Name	Record Number	Location Date	Recording Date	Expiry Date
Malou 1-6	YB35901-906	June 6/91	June 6/91	June 6/95

7. Geochemical Survey

7.1. General:

Two soil lines were taken 50 yds. apart on 25 yd. intervals. Sample pits were marked with flourescent tape. Sample pits were from 0-10 cm. deep and soil was mostly brown B horizon.

7.2. Interpretation:

Interesting anomolies for Au and As were found in the western area of the lines.



Malou Claims
 Location Map
 Mining District Whitehorse
 NTS 115H
 Scale 1:2,500,000

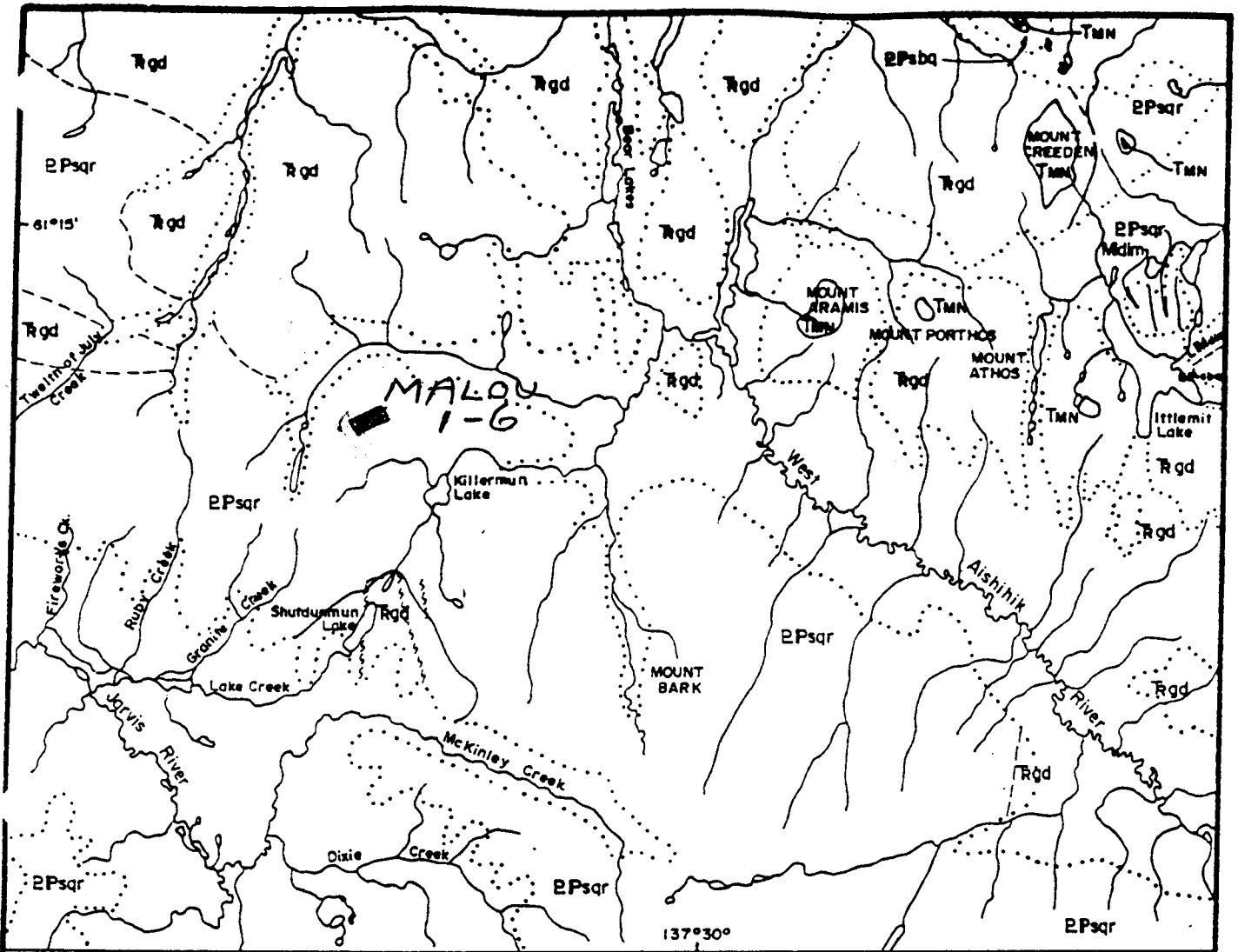

LEGEND

EOCENE

TMN Mount Nansen Group volcanic rocks

CRETACEOUS

LMDm Hornblende Diorite

TRIASSIC

Rgd Ruby Range Granodiorite

PALEOZOIC

EPsqr Hornfelsed Schist

EPsba Biotite Schist

Figure 3

Regional Geology
 Malou Project
 Mining District Whitehorse
 NTS 115 H4
 Scale 1:250,000

From Tempelman-Kluit (1974)

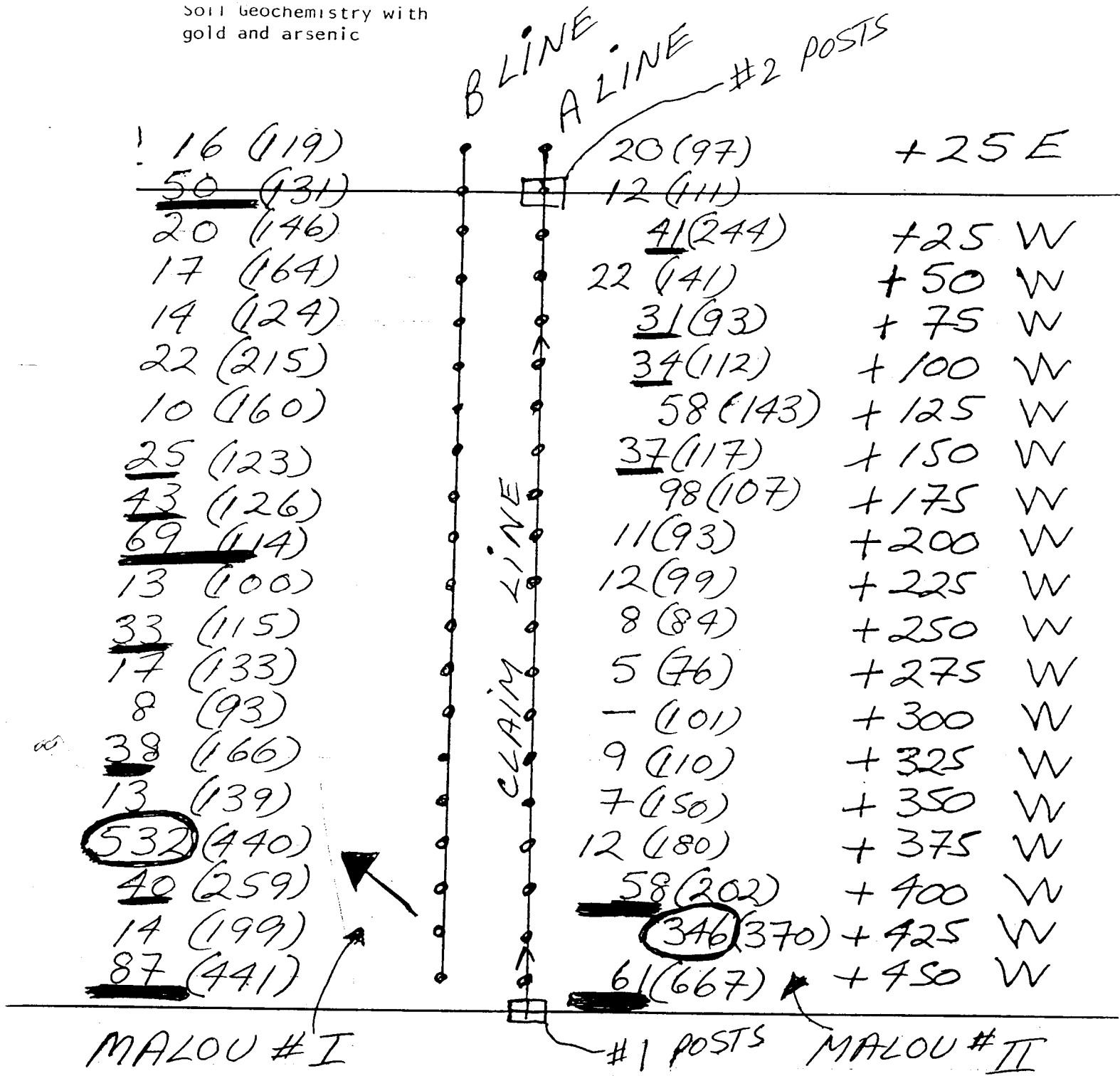

MALOU # I

#1 POSTS MALOU # II

- SOIL SAMPLE SITE
- ▣ CLAIM POSTS
- ▲ NORTH
- 16 (119) 16 Au PPB
- 119 As PPM
- Au 25-49
- Au 50-99
- Au 100+

INTERVALS

- ① A-B Lines 50 YARDS
- ② SAMPLES 25 YARDS

APPENDIX "A"

REFERENCES

Bostock, H.S., 1948, Physiography of the Canadian Cordillera with special reference to the area north of the 55th parallel: Geological Survey of Canada, Memoir 247.

Cockfield, W.E., 1927, Aishihik Lake District, Yukon: Canada Department of Mines, Summary Report, 1926, Part A.

Debicki, R.L. and Gilbert, G.W., 1986, Yukon Placer Mining Industry 1983-1984: Placer Mining Section and Mining Engineering Division, DIAND, Yukon p. 7-17

Tempelman-Kluit, D.J. 1974, Reconnaissance Geology of Aishihik Lake, Snag and part of Stewart River maps-areas, west-central Yukon: Geological Survey of Canada Paper 73-41.

APPENDIX "B"
PROJECT COSTS

Assay:

40 soils Au/As \$ 510.00

Vehicle:

220 miles at .46 101.20

Helicopter:

2 Trips 841.69

2 Days Labour 400.00

2 Days diem/Camp 105.60

Subtotal \$ 1,958.49

Report and Write Up (10%) 190.00

Total \$ 2,148.49

APPENDIX "C"

STATEMENT OF QUALIFICATIONS

I, J. Peter Ross, do hereby certify that I:

- am a qualified prospector with mailing address:

Box 4842
Whitehorse, Yukon Territory
Y1A 4N8
- graduated from McGill University in 1970 with a b.Sc.
General Science
- have attended and finished completely the following
courses:
 - 1974 - BC & Yukon Chamber of Mines,
Prospecting Course
 - 1978 - United Keno Hill Mines, Elsa, Yukon
Prospecting Course
 - 1987 - Yukon Chamber of Mines,
Advanced Prospecting Course
- did all the work on the claims and the writing of
this report
- have been on the Yukon Prospectors' Assistance and Yukon
Mining Incentive Program 1986-1992
- have been on the British Columbia Prospectors' Assistance
Program 1989-1990
- have a 100% interest in the claims described in this
report at the present time

John Peter Ross
OCT 6/92
John Peter Ross
October 6th, 1992

YUKON CHAMBER OF MINES

This Certifies That J. PETER ROSS

has completed the

ADVANCED PROSPECTING COURSE

Whitehorse, Yukon Territory

1987

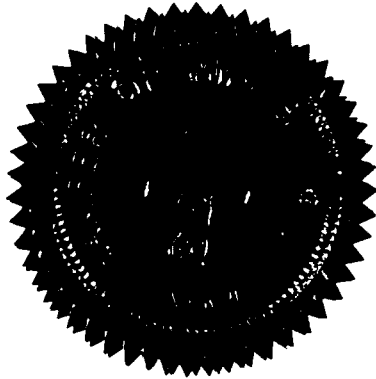

D. Howard
Chairman, Prospectors Course
Committee

Wayne Paul
President

APPENDIX "D"
SOIL SAMPLE RESULTS

October 29, 1991

Work Order # 13486

Placer Dome Exploration Limited
103 Platinum Road
Whitehorse, Yukon
Y1A 5M3

File # 13486a

Project # Lib 1W

Assay Certificate for Samples Provided

Sample #	Au ppb
A + 25E	20
A + 00	12
A + 25W	41
A + 50W	22
A + 75W	31
A + 100W	34
A + 125W	58
A + 150W	37
A + 175W	98
A + 200W	11
A + 225W	12
A + 250W	8
A + 275W	5
A + 300W	<5
A + 325W	9
A + 350W	7
A + 375W	12
A + 400W	58
A + 425W	346
A + 450W	61
B + 25E	16
B + 00	50
B + 25W	20
B + 50W	17
B + 75W	14
B + 100W	22
B + 125W	10
B + 150W	25
B + 175W	43
B + 200W	69

Certified by Chyokki



October 29, 1991

Work Order # 13486

Placer Dome Exploration Limited
103 Platinum Road
Whitehorse, Yukon
Y1A 5M3

File # 13486b

Project # Lib 1W

Assay Certificate for Samples Provided

Sample #	Au ppb
B + 225W	13
B + 250W	33
B + 275W	17
B + 300W	8
B + 325W	38
B + 350W	13
B + 375W	532
B + 400W	40
B + 425W	14
B + 450W	87
X-5	10
X-6	24
X-7	14

Certified by Chyokki



November 20, 1991

Work Order # 13507

Peter Ross

Assay Certificate For Samples Provided

Sample #	As ppm
A + 25E	97
00	111
25W	244
50W	141
75W	93
100W	112
125W	143
150W	117
175W	107
200W	93
225W	99
250W	84
275W	76
300W	101
325W	110
350W	150
375W	180
400W	202
425W	370
450W	667
B + 25E	119
00	131
25W	146
50W	164
75W	124
100W	215
125W	160
150W	123
175W	126
200W	114
225W	100

Certified by Chyolka



November 20, 1991

Work Order # 13507

Peter Ross

Assay Certificate For Samples Provided

Sample #	As ppm
B +225W	100
250W	115
275W	133
300W	93
325W	166
350W	139
375W	440
400W	259
425W	199
450W	441

Certified by Chyoki



