

MAP NO.: 105 D 2  
ASSESSMENT REPORT X  
PROSPECTUS  
CONFIDENTIAL X  
OPEN FILE

DOCUMENT NO: 092777  
MINING DISTRICT: Whitehorse  
TYPE OF WORK: Trenching, Road Construction

REPORT FILED UNDER: Omni Resources Inc.

DATE PERFORMED: 6-10 October, 1989  
DATE FILED: 18 December, 1989

LOCATION: LAT.: 60°06'N  
LONG.: 137°44'W  
AREA: Montana Mountain  
VALUE \$: 6 100.00

CLAIM NAME & NO.: AFI 57-59,100,102 (YA85709-11,752,754)

WORK DONE BY: H.F. MacKinnon

WORK DONE FOR: Omni Resources Inc.

DATE TO GOOD STANDING:

REMARKS: ADJOINS #9 BIG THING (ARCTIC)  
Three trenches in 1989 exposed vuggy, banded quartz veins up to 50 cm thick, cutting altered granodiorite. The vein minerals include arsenopyrite, galena and pyrite. Assays returned values up to 532.1 g/t Ag and 9.63 g/t Au.



# OMNI RESOURCES INC.

ROAD CONSTRUCTION

AND

TRENCHING

AFI 57,58,59 YA85709,710,711  
AFI 100,102 YA85752,754

Mineral Claims

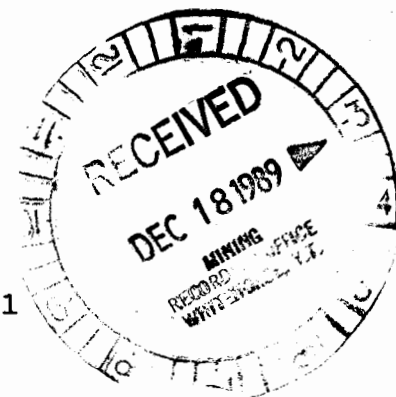

Montana Mountain and Brute Mountain Area

WHITEHORSE MINING DISTRICT  
YUKON TERRITORY

N.T.S. : 105D/2

LATITUDE: 60 Degrees 06 Minutes North  
LONGITUDE: 135 Degrees 44 Minutes West

OCTOBER 6 to 10, 1989

By

HUGH F. MACKINNON B.Sc.

DECEMBER 15, 1989

For

Omni Resources Inc.  
990 - 840 Howe St.  
Vancouver, B.C.  
V6Z 2L2

092777

This report has been examined by  
the Geological Evaluation Unit  
under Section 53 (4) Yukon Quartz  
Mining Act and is allowed as  
representation work in the amount  
of \$6100.00.

*J. J. Freeman*  
for Regional Manager, Exploration and  
Geological Services for Commissioner  
of Yukon Territory.

Approved as  
physical work. *J. J. B.*

**STATEMENT OF EXPENDITURES**

OMNI RESOURCES INC.

AFI 37-64, 86-92, 99-106, 114-118 & 121-125.

NTS: 105D/2

**Labour Costs:**

H. MacKinnon; October 7 to 10, 1989	
4 days project supervision	
at \$220 per day.....	\$880.00

E. Bergvinson: October 6, 1989	
0.5 days at 175.00 per day.....	\$ 87.50

Total Labour Costs	\$967.50
--------------------	----------

**Road Construction Costs:**

Mobilization and demobilization of D7G CAT.....	\$570.00
Road Construction 6.5 hours at \$120.00 per hr...	\$780.00

Total Road Construction Costs	\$1350.00
-------------------------------	-----------

**Trenching Costs Calculation (Weighted average depths used):**

**Trench 89-1:**

71.1 yds x 1.0 yds x 5.5 yds = 391.05 cu yds	
at \$1.00 per cu yd.....	\$391.05
65.6 yds x 1.2 yds x 5.5 yds = 432.96 cu yds	
at \$1.50 per cu yd .....	\$649.44
	\$1040.49

**Trench 89-2:**

45.9 yds x 0.9 yds x 5.5 yds = 227.21 cu yds	
at \$1.00 per cu yd .....	\$227.21
39.4 yds x 0.5 yds x 5.5 yds = 108.35 cu yds	
at \$1.50 per cu yd .....	\$108.35
	\$389.74

**Trench 89-3A:**

65.6 yds x 1.2 yds x 5.5 yds = 432.96 cu yds	
at \$1.00 per cu yd .....	\$432.96
30.6 yds x 0.3 yds x 5.5 yds = 50.49 cu yds	
at \$1.50 per cu yd .....	\$ 75.70
	\$508.66

Trench 89-3B:

43.7 yds x 1.1 yds x 5.5 yds = 264.39 cu yds	
at \$1.00 per cu yd.....	\$264.39
35.0 yds x 2.2 yds x 5.5 yds = 423.50 cu yds	
at \$1.50 per cu yd.....	\$635.25
	-----
	\$899.64

Trench 89-4:

37.2 yds x 1.0 yds x 5.5 yds = 204.60 cu yds	
at \$1.00 per cu yd .....	\$204.60
35.0 yds x 0.4 yds x 5.5 yds = 77.0 cu yds	
at \$1.50 per cu yd .....	\$115.50
	-----
	\$320.10

Total Trenching Costs	\$3158.63
-----------------------	-----------

Miscellaneous Costs:

Truck rental: 4.5 days at \$60.00 per day	\$270.00
CAT diesel fuel: 3.5 days at \$150.00 per day	\$525.00
	-----
Total Miscellaneous Costs	\$795.00

Total 1989 expenditures applied toward assessment:	<u>\$6,271.13</u>
--	-------------------

STATEMENT OF QUALIFICATIONS

I, Hugh Francis MacKinnon of P.O. Box 1785, Rossland, B.C., hereby certify that:

- 1) I graduated with a Bachelor of Science Degree with Honours in Geology from Carleton University, Ottawa, Ontario, in 1986.
- 2) I have been engaged in mineral exploration since 1980 in Ontario, Saskatchewan, The Northwest Territories, British Columbia, Nova Scotia and The Yukon Territory.
- 3) I was the project geologist for Omni Resources regional claims program.
- 4) I was involved in the work performed on the AFI claims in the summer of 1989 and am the author of this report.

Dated this eighteenth day of November, 1989

  
-----  
Hugh F. MacKinnon, B.Sc.

SAMPLE DESCRIPTIONS - SKUKUM GOLD INC.

10C-

PROJECT: MONTANA MTN. AFI

SAMPLER: HUGH MACKINNON

SAMPLE #	DATE	LOCATION	SAMPLE DESCRIPTIONS
89-10C-SF1	Oct. 7/89	Trench 89-1	Fine grained aspy (2%(?), py (1%), diss in arg. alt'd gd.
-SF2	"	"	Prop. alt'd <del>strong</del> gd w 1cm qtz vein w tr galena (limonite/hedral xhals)
-SF3	"	"	Tr. aspy in coarsely xtaline vuggy qtz vein
-SF4	"	"	Weakly alt'd gd w pyritic fractures, rusty weathered
-SF5	"	"	Argillie alt'd gd w limonite after py. disseminated as $\leq 3\%$ 1mm cubes.
-551-3	Oct. 8/89	"	Soils at N. end of trench.
-SR1	"	"	Propylitic alt'd med-gr. bi-gd. w tr to 0-2% diss py.
-SR2	"	"	Strong prop. alt'n, white vuggy qtz vein, limonitic vugs. tr-0.3% diss py, tr galena
-SR3	"	"	Phyllie (?) & prop. alt'd gd. 1% diss 0.2mm euhedral py, tr galena tr to normalise?
-SR4	"	"	Grab during trenching: tr gl, tr py, tr aspy. Honey yellow to greyish white veins, coxcomb textured same w limonitic vugs.
-SR5	"	"	Strongly alt'd gd (arg & ser), finely diss. py (2%) & aspy (1%) also along fractures.
-SR6	"	"	50cm qtz vein w $\approx 3\%$ aspy, 2% py, 0.2% galena. Banded coxcomb vein.
-SR7	"	"	As above grab.
-SR8	"	"	Very pyritic strongly alt'd gd w $\leq 6$ mm euhedral py, 0.3% diss aspy, tr galena.
-SR9	"	"	White qtz vein, massive, w minor vugs, minor wed, yellowish green stain, tr py, tr galena.
-SF6 <del>SF10</del>	"	Trench 89-2	2.5cm crypto crystalline qtz vein w minor frosted vugs. tr py.
-SR10	Oct. 9/89	Trench 89-3	Crypto crystalline qtz vein network. Veins $\leq 5$ cm in arg & ser alt'd gd - Rusty stained & weathered.
-SR11	"	"	Tr-0.2% aspy, tr gl, tr cpy, tr py in vuggy 15cm banded vein
-SR12	"	"	10cm vein, honey coloured minor vugs in arg. alt'd gd.
-SR13	"	"	coarsely xtaline vein, w minor light grey fine grained qtz bands w tr aspy.
-SR14	"	"	As above.
-SR15	"	"	Yellowish light green coloured, fine grained 7cm qtz vein w tr aspy.
-SR16	"	"	coarsely xtaline vein w tr aspy

ASME ANALYTICAL LABORATORIES LTD.  
 852 E. HASTINGS ST. VANCOUVER B.C. V6A 1R6  
 PHONE(604)253-3158 FAX(604)253-1716

DATE RECEIVED: OCT 17 1989

DATE REPORT MAILED: *Oct 24/89*

**GEOCHEMICAL/ASSAY CERTIFICATE**

.500 GRAM SAMPLE IS DIGESTED WITH 3ML 3-1-2 HCL-HNO3-H2O AT 95 DEG.C FOR ONE HOUR AND IS DILUTED TO 10 ML WITH WATER.  
 THIS LEACH IS PARTIAL FOR MN FE SR CA P LA CR MG BA TI B W AND LIMITED FOR NA K AND AL. AU DETECTION LIMIT BY ICP IS 3 PPM.  
 - SAMPLE TYPE: P1 ROCK P2 SOIL AG\*\* + AU\*\* BY FIRE ASSAY FROM 1/2 A.T. *Aur MIBK EXTRACTION from 10g, analysis by Ad.*

SIGNED BY *C. Leong*. D.TOYE, C.LEONG, J.WANG; CERTIFIED B.C. ASSAYERS

Skukum Gold Inc. PROJECT 10C-AFI FILE # 89-4318 Page 1

SAMPLE#	Cu PPM	Pb PPM	Zn PPM	As PPM	Ag** OZ/T	Au** OZ/T
89-10C-5F1	13	686	167	13425✓	.20	.005
89-10C-5F2	23	1286	728	71	.22	.001
89-10C-5F3	21	132	117	2284	.07	.012
89-10C-5F4	199	3106	8730	50	.56	.016
89-10C-5F5	24	1847	178	546	.92	.001
89-10C-5F6	10	136	49	1246	.47	.008
89-10C-5R1	5	121	59	53	.06	.001
89-10C-5R2	237	4986	8708	1202	1.37	.011
89-10C-5R3	41	2919	3192	212	.55	.001
89-10C-5R4	66	2454	878	4061	.82	.029
89-10C-5R5	68	2458	517	4512	.50	.007
89-10C-5R6	22	5384	1887	14562✓	.86	.027
89-10C-5R7	38	8569	1552	32563✓	2.61	.054
89-10C-5R8	17	1813	206	6380	.30	.004
89-10C-5R9	35	2425	477	19716✓	.94	.011
89-10C-5R10	20	765	209	1061	.21	.001
89-10C-5R11	101	30005✓	524	4355	15.52	.281
89-10C-5R12	9	379	91	339	.09	.001
89-10C-5R13	42	5157	136	6114	1.72	.024
89-10C-5R14	17	916	121	2895	.44	.011
89-10C-5R15	100	9566	297	2664	2.47	.008
89-10C-5R16	11	607	135	1060	.29	.028
STD C	59	39	134	40	-	-

✓ ASSAY RECOMMENDED



SAMPLE#	Cu PPM	Pb PPM	Zn PPM	Ag PPM	As PPM	Au* PPB
89-10C-5S1	15	68	324	.5	449	12
89-10C-5S2	21	200	367	.6	484	15
89-10C-5S3	24	156	306	.4	396	19
STD C/AU-S	57	43	132	7.1	43	50

ACME ANALYTICAL LABORATORIES LTD.

DATE RECEIVED: OCT 24 1989

852 E. HASTINGS ST. VANCOUVER B.C. V6A 1R6

PHONE(604)253-3158 FAX(604)253-1716

DATE REPORT MAILED:

*Nov. 2/89*

### ASSAY CERTIFICATE

-100 MESH AU BY FIRE ASSAY FROM 1 A.T.

- SAMPLE TYPE: ROCK PULP

SIGNED BY..... *C. Leong* D.TOYE, C.LEONG, J.WANG; CERTIFIED B.C. ASSAYERS

SKUKUM GOLD FILE # 89-4318R

SAMPLE#	SAMPLE AU-100 NATIVE		AVG.	
	wt. gm	oz/t	Au mg	oz/t
89-10C-5R11	223	.128	.05	.134

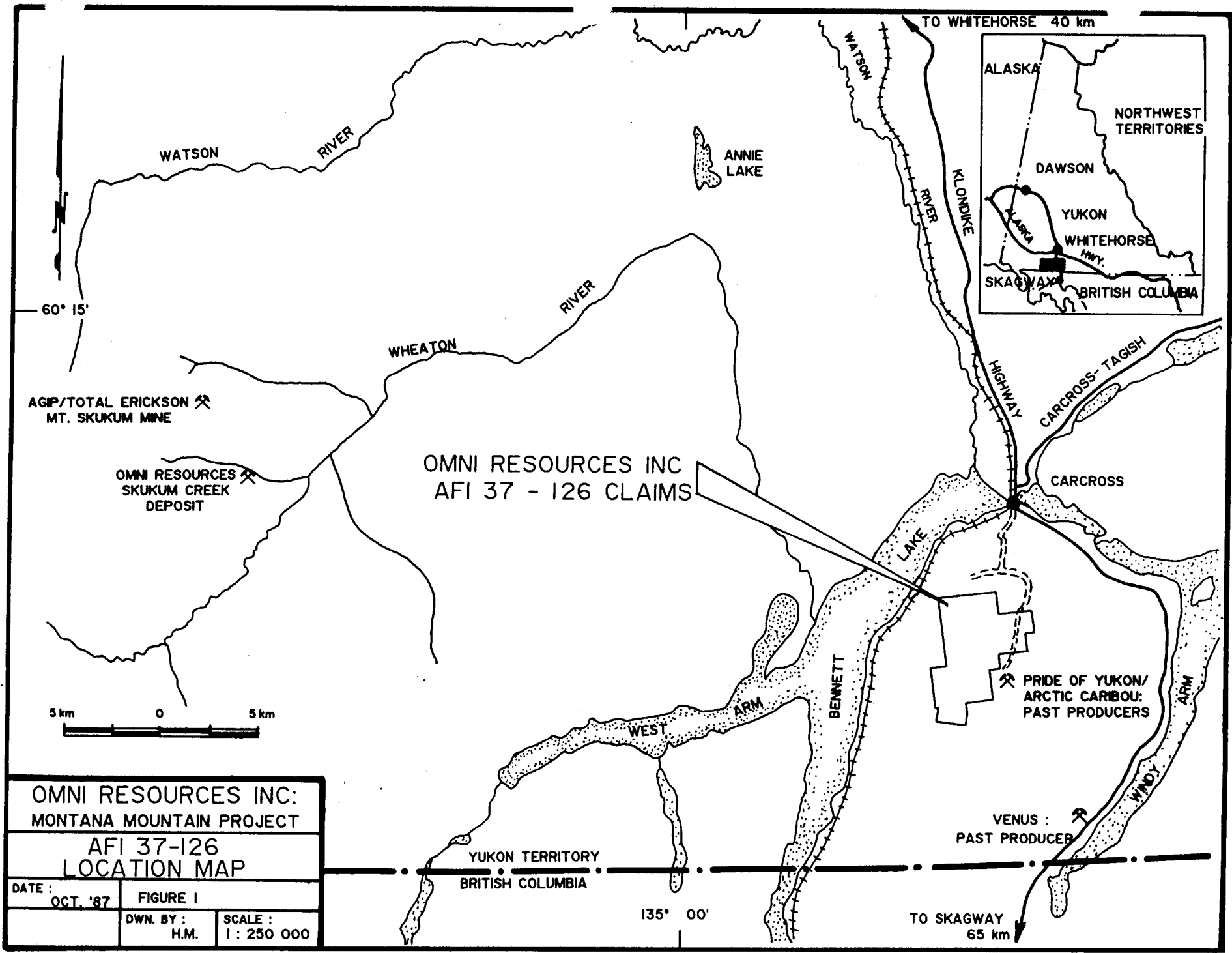

OMNI RESOURCES INC:  
 MONTANA MOUNTAIN PROJECT  
 AFI 37-126  
 LOCATION MAP  
 DATE: OCT. '87      FIGURE I  
 DWN. BY: H.M.      SCALE: 1:250 000

INTEGRAPHICS LTD.

134° 43'

AFI

TO CARCROSS

MCDONALD CREEK

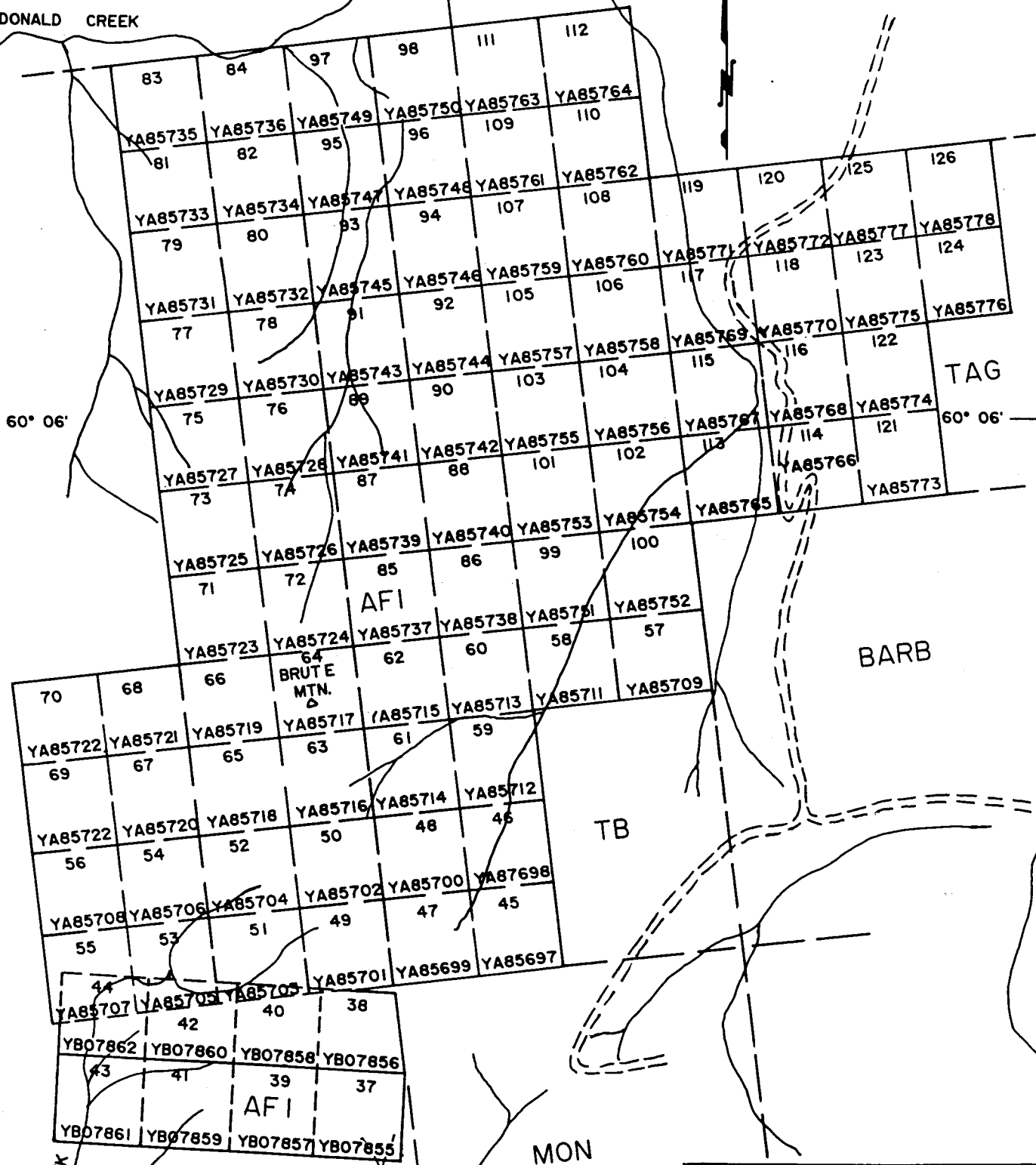

60° 06'

TAG

60° 06'

BARB

TB

MON

KNOB CREEK

BRUTE MTN.

OMNI RESOURCES INC.		
MONTANA MOUNTAIN PROJECT		
<b>CLAIM MAP</b>		
DATE:	OCT. '87	
NTS: 1/5 D/2	DWN. BY:	SCALE:
	H.M.	1:30 000

FIGURE 2

SCALE: 1:30 000

134° 43'

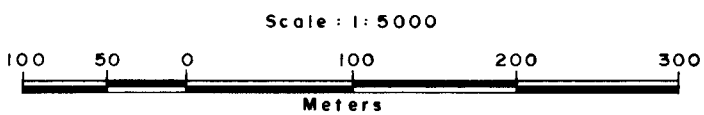
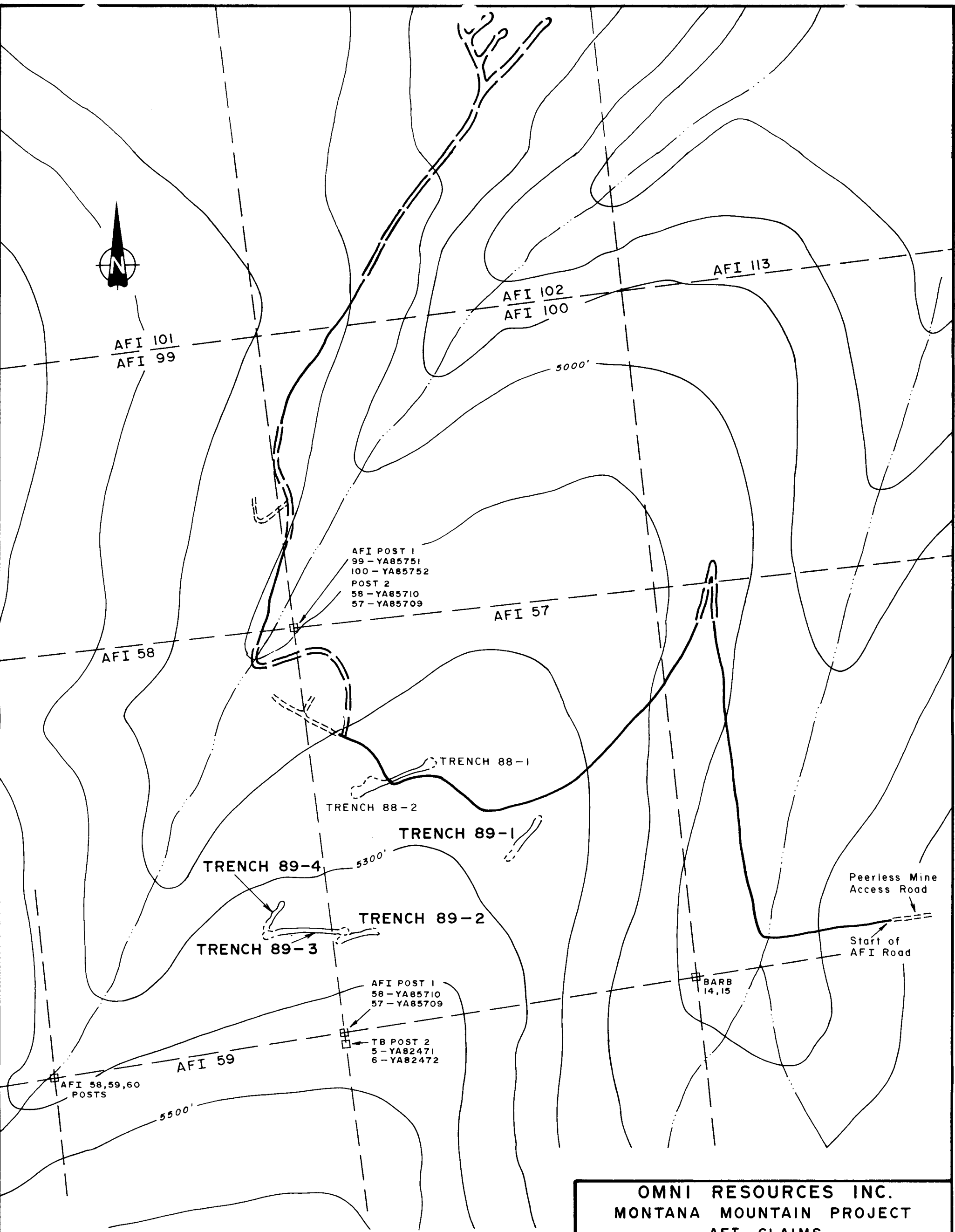

**NOTE**  
 Dashed road indicates new or upgraded road constructed in 1989.

<p>OMNI RESOURCES INC.  MONTANA MOUNTAIN PROJECT  AFI CLAIMS</p>	
<p><b>1989 TRENCHING  &amp;  ROAD CONSTRUCTION  AFI CLAIMS</b></p>	
<p>N.T.S. 105D/2</p>	<p>Map No. 1</p>
<p>DRAWN BY: H.M., T.M.</p>	<p>DATE: NOV. 1989</p>

**LEGEND**

**Lithologies**

- Pgd** Paleocene: medium grained hornblende - biotite granodiorite, with minor chlorite altered and wad stained sections.
- Pgdp** Propylitic altered (chlorite, calcite, minor epidote) granodiorite; weak to strong.
- Argillic and or sericitic altered granodiorite, commonly as a halo around quartz veins.
- x x x** Gossanous zone: rusty weathered, limonitic, wad stained.
- Quartz or quartz sulphide vein.

**SYMBOLS**

- Geological contact.
- 22 72 Vein attitude; shear attitude.
- △5F1 Float sample.
- ▲5R1 Rock grab sample.
- 5S1 Soil sample.
- Trench: depth and overburden depth.  
3.3m (1.2m o/b)

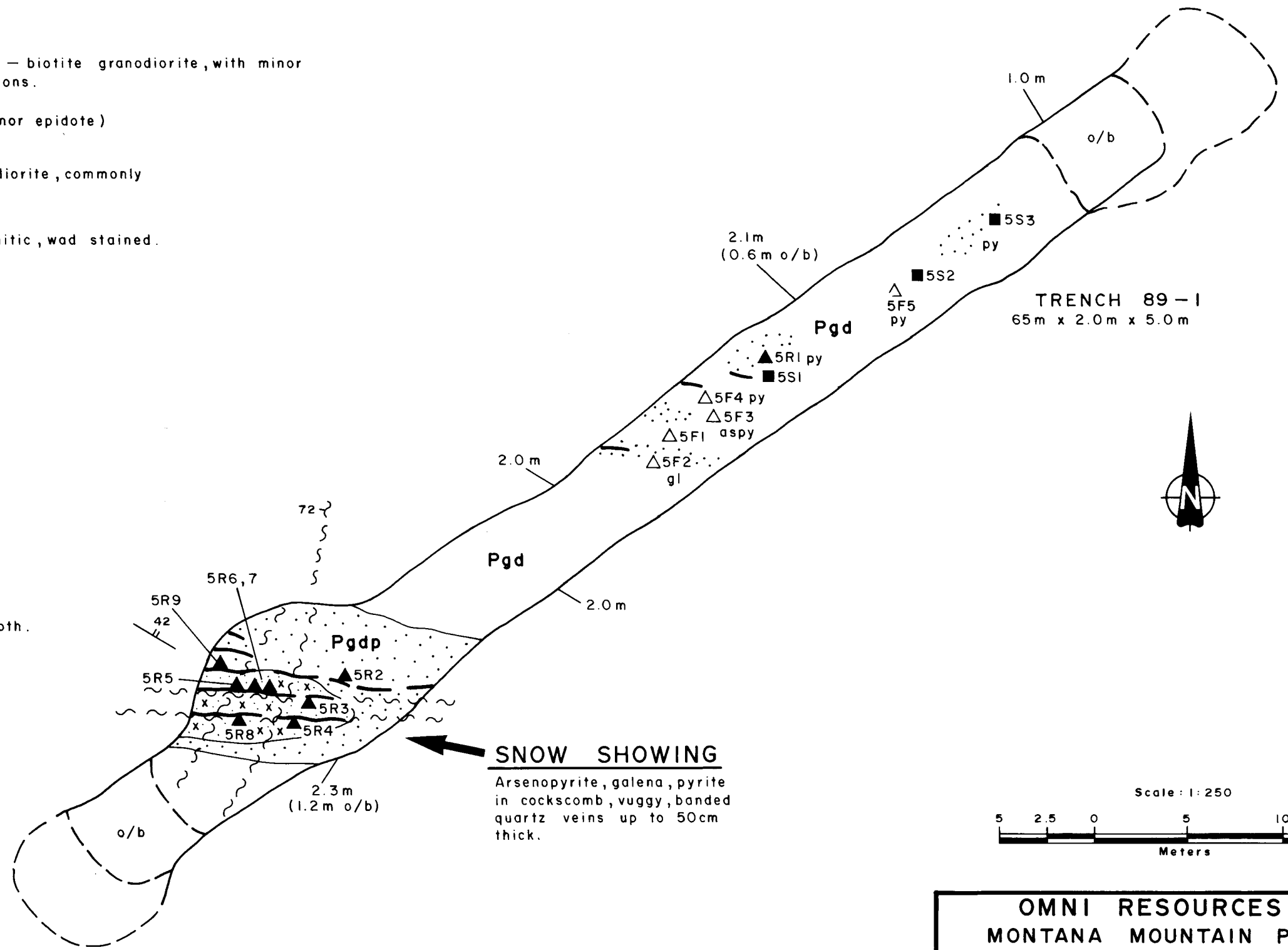

**SNOW SHOWING**  
 Arsenopyrite, galena, pyrite  
 in cockscomb, vuggy, banded  
 quartz veins up to 50cm  
 thick.

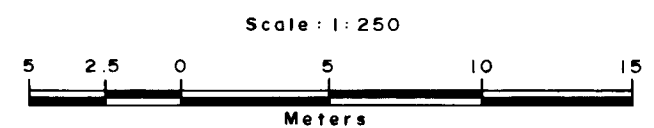

OMNI RESOURCES INC. MONTANA MOUNTAIN PROJECT AFI CLAIMS	
<b>TRENCH 89-1</b> <b>SNOW SHOWING</b> <b>GEOLOGY AND</b> <b>SAMPLE LOCATIONS</b>	
N.T.S. 105 D/2	FIGURE No. 3
DRAWN BY: H.M., T.M.	DATE: NOV. 1989

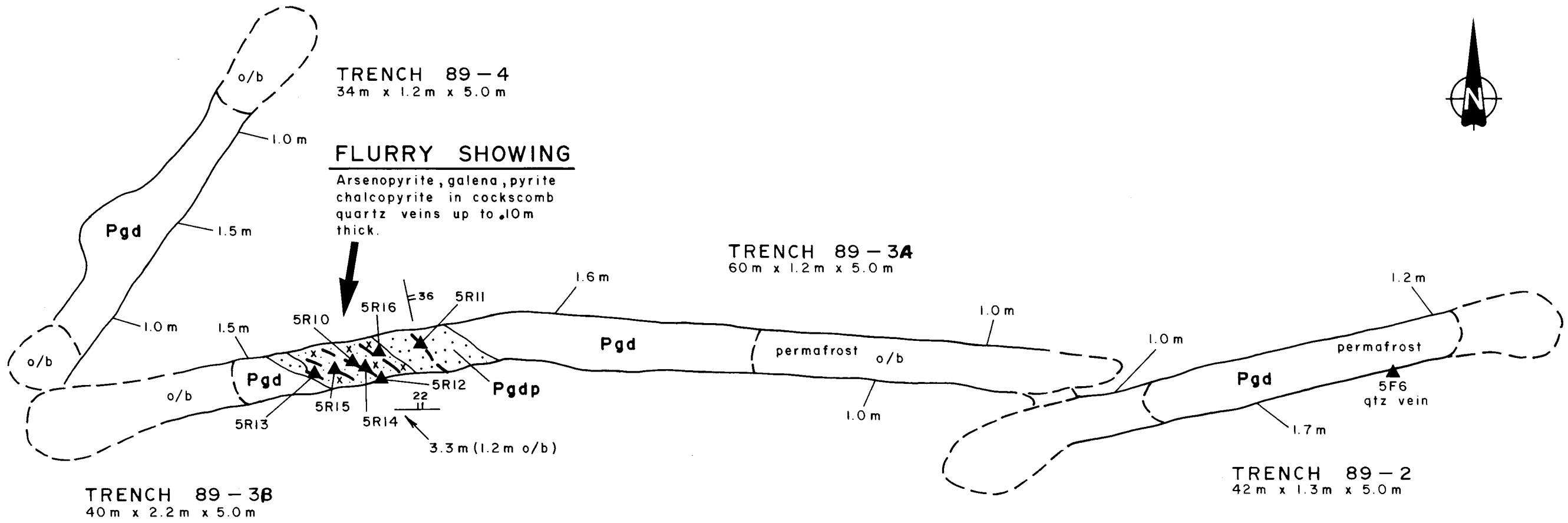

**LEGEND**

- Lithologies**
- Pgd Paleocene : hornblende - biotite granodiorite.
  - PgdP Propylitic altered granodiorite.
  - Argillic and or sericitic altered granodiorite.
  - x  
x Gossanous zone.
  - Quartz vein.

**SYMBOLS**

- Geological contact.
- 22 Vein attitude.
- Grab sample location.
- o/b Overburden.
- 3.3 m (1.2 m o/b) Trench : depth and overburden depth.

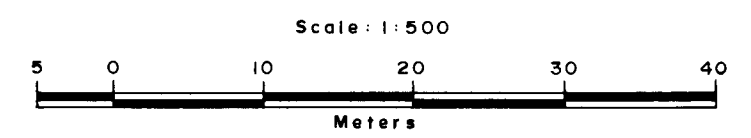

<b>OMNI RESOURCES INC.</b> <b>MONTANA MOUNTAIN PROJECT</b> <b>AFI CLAIMS</b>	
<b>TRENCHES 89-2,3,4</b> <b>GEOLOGY AND</b> <b>SAMPLE LOCATIONS</b>	
N.T.S. 105 D/2	FIGURE No. 4
DRAWN BY: H.M., T.M.	DATE: NOV. 1989

**H. COYNE & SONS LTD.**  
 14 MacDonald Road  
 Whitehorse, Yukon Y1A 4L2

# INVOICE

No 3117

Phone: 633-3677  
 Fax: 633-3641

INVOICE DATE October 31, 1989	SALESMAN
SHIP TO Montana Mountain	

TO Omni Resources Inc.  
706, 595 Howe Street  
Vancouver, B.C.

YOUR ORDER NO.	DATE SHIPPED	SHIPPED VIA	F.O.B. POINT	TERMS	QUANTITY	DESCRIPTION	UNIT PRICE	TOTAL
						Mob & Demob		\$ 570. 00
					10 hours	D7G - Oct. 7	120.00	1,200. 00
					10 hours	D7G - Oct. 8	120.00	1,200. 00
					10 hours	D7G - Oct. 9	120.00	1,200. 00
					4 hours	B7G - Oct. 10	120.00	480. 00
						less accomodations		<u>-75. 00</u>
						Total		<u>\$4,575. 00</u>

Willow Printers

*Thank You*