

MAP NO.: 105 D 3  
ASSESSMENT REPORT X  
PROSPECTUS  
CONFIDENTIAL X  
OPEN FILE

DOCUMENT NO: 092774  
MINING DISTRICT: Whitehorse  
TYPE OF WORK: Trenching

REPORT FILED UNDER: M.J. Moreau Enterprises Limited

DATE PERFORMED: 16 May, 1989

DATE FILED: 20 December, 1989

LOCATION: LAT.: 60°08'N

AREA: Wheaton River

LONG.: 135°07'W

VALUE \$: 2 600.00

CLAIM NAME & NO.: CRAIG 1-26 (YB13673-98)

WORK DONE BY: J. Moreau

WORK DONE FOR: M.J. Moreau Enterprises Ltd

DATE TO GOOD STANDING:

|  |  |
|--|--|
|  |  |
|  |  |
|  |  |
|  |  |
|  |  |
|  |  |

REMARKS: CRAIG #258

Blast trenching was done on the property in 1989. Rock samples returned values up to 149 ppb Au, 2118.1 g/t Ag, 3.26% Cu, 31% Pb and 9.50% Zn.



**ASSESSMENT REPORT ON THE  
CRAIG 1 - 26 CLAIMS  
WHITEHORSE MINING DISTRICT, YUKON  
MAY 16, 1989**

**Claims:** CRAIG 1 - 26 (YB13673 - YB13698)

**Location:** 39 Miles S.W. of Whitehorse, Yukon  
NTS sheet 105/D-3  
Becker Creek area

**Claim Owner:** Jacques Moreau  
99 - 178 Range Road  
Whitehorse, Yukon  
Y1A 4V1

**Prepared by:** M.J. Moreau Enterprises Ltd.  
P. O. Box 5282  
Whitehorse, Yukon  
Y1A 4Z2

December 20, 1989

092774

Physical Work

**M. J. Moreau Enterprises Ltd.**

- 2 -

**Location and Access**

The CRAIG claims are located on upper Becker Creek, 39 air miles from Whitehorse, Yukon.

Access to the property is by helicopter from Whitehorse.

A local mining road leading to the Becker - Cochrane, comes within 3½ miles of the property.

STATEMENT OF COST

Field work

|                     |           |
|---------------------|-----------|
| Geology             |           |
| C. Hart B.Sc        | \$ 275.00 |
| Trenching           |           |
| J. Moreau - R. John | 500.00    |

Geochemical Analysis 365.21

Support Cost

|                           |               |
|---------------------------|---------------|
| Drill and tools           | 1,000.00      |
| Blasting supplies         | 464.07        |
| Helicopter                | 900.34        |
| Truck rental and expenses | <u>522.00</u> |

**Total Valuation of 1989 Assessment Work** \$ 3,126.62

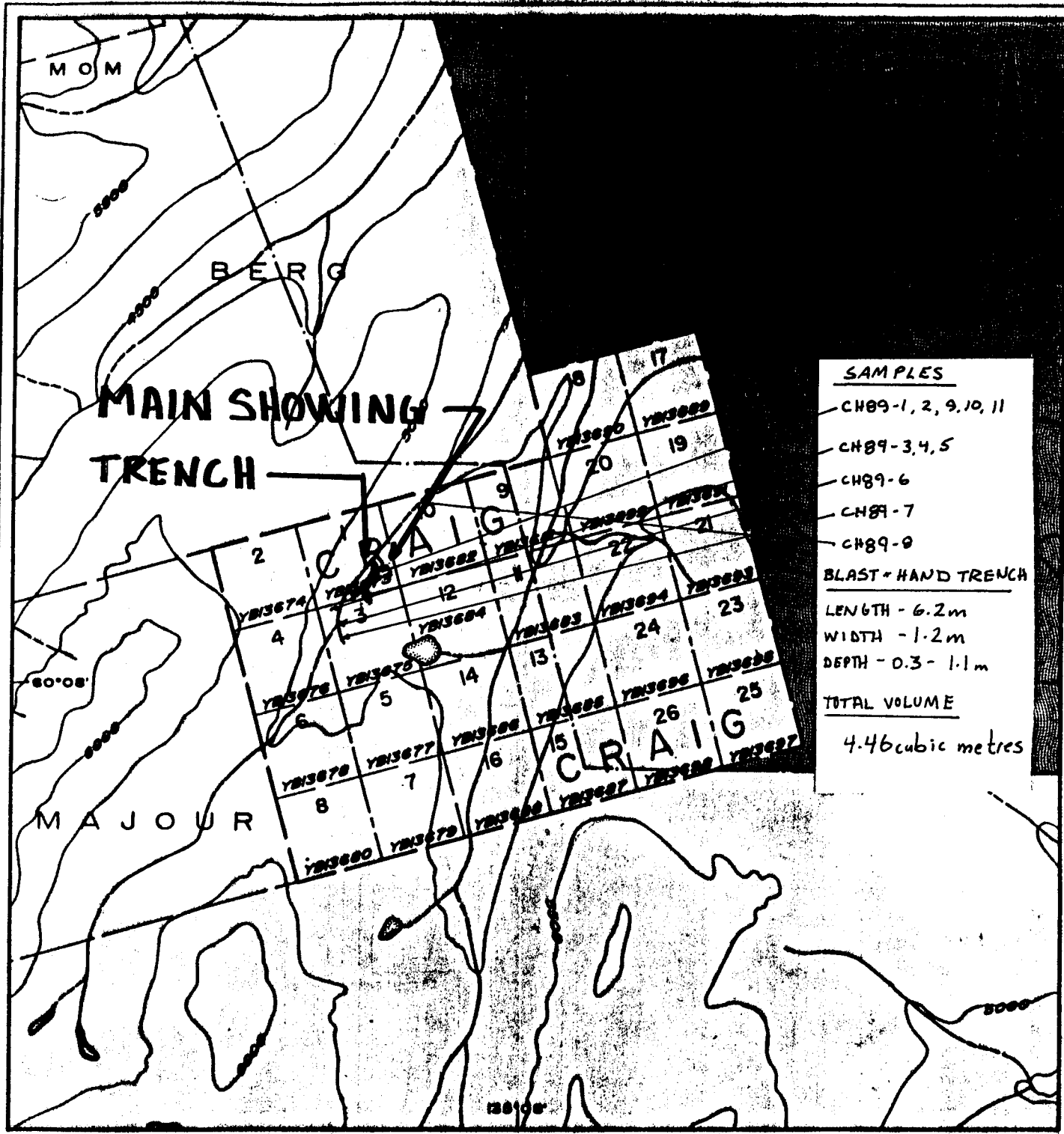

| SAMPLES              |  |
|----------------------|--|
| CH89-1, 2, 9, 10, 11 |  |
| CH89-3, 4, 5         |  |
| CH89-6               |  |
| CH89-7               |  |
| CH89-8               |  |
| BLAST-HAND TRENCH    |  |
| LENGTH - 6.2m        |  |
| WIDTH - 1.2m         |  |
| DEPTH - 0.3 - 1.1m   |  |
| TOTAL VOLUME         |  |
| 4.46 cubic metres    |  |

**LEGEND**

- claim boundary
- claim number
- tag number
- lands withdrawn from staking
- creek, lake
- elevation in feet, contour interval 5000ft.

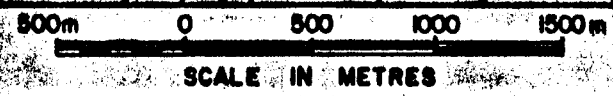

|  |             |                |          |
|--|-------------|----------------|----------|
| M.J. MOREAU ENTERPRISES LTD.                   |             |                |          |
| CRAIG 1-26 CLAIMS                              |             |                |          |
| WHITEHORSE MOUNTAIN DISTRICT - YUKON TERRITORY |             |                |          |
| <b>CLAIM MAP</b>                               |             |                |          |
| Aurum Geological Consultants Inc.              |             | MAY, 1989      |          |
| NTS 105 D/3                                    | DRAWN BY NH | SCALE 1:30,000 | FIGURE 2 |

Note: adapted from D.I.A.N.D. map sheet 105 D-3, revised March 23, 1989

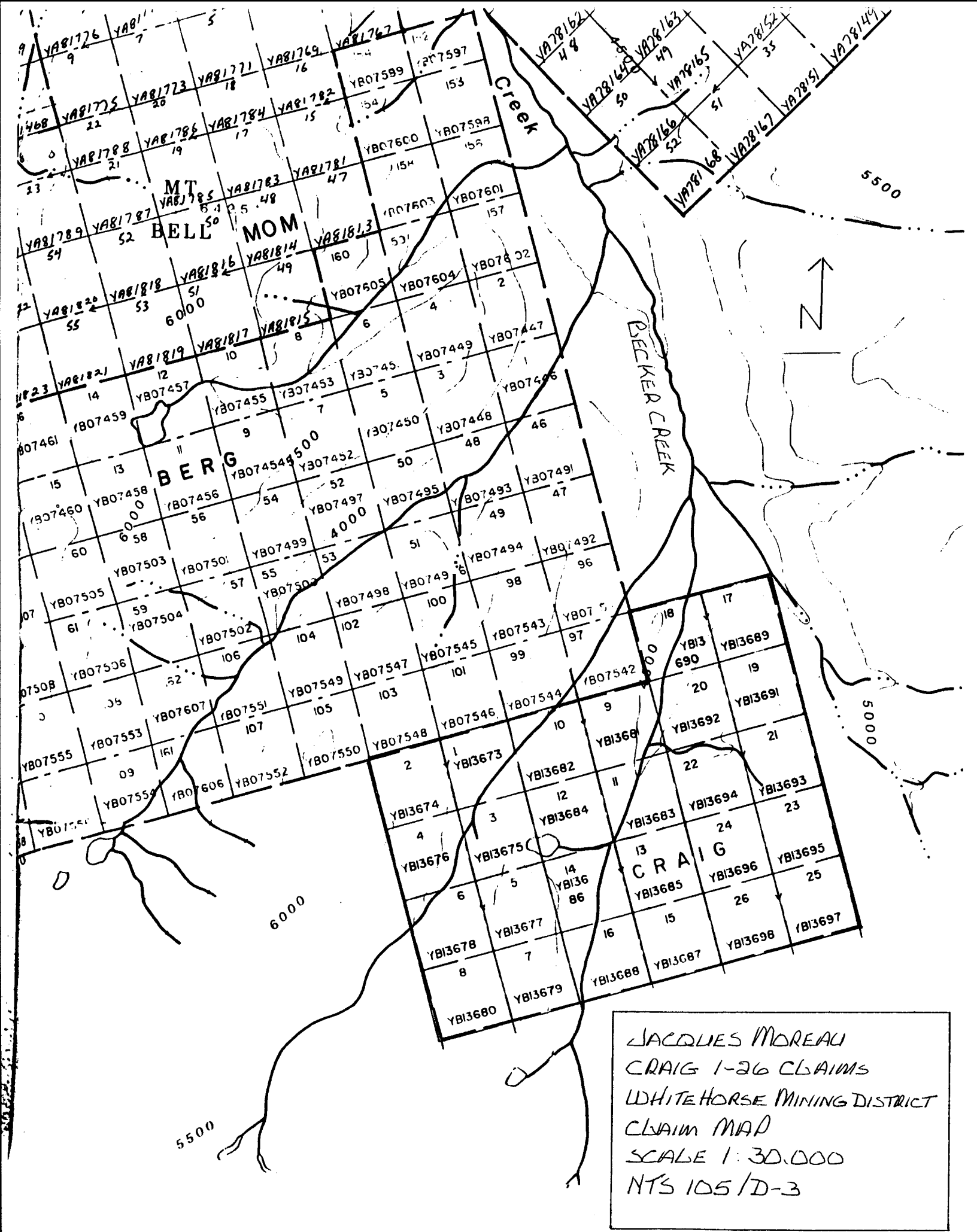

Bondar-Clegg & Company Ltd.  
 130 Pemberton Ave.  
 North Vancouver, B.C.  
 V7P 2R5  
 (604) 985-0681 Telex 04-352667



**Geochemical  
 Lab Report**

REPORT: V89-01925.0 ( COMPLETE )

REFERENCE INFO:

CLIENT: AURUM GEOLOGICAL CONSULTANTS INC.  
 PROJECT: NONE GIVEN

SUBMITTED BY: UNKNOWN  
 DATE PRINTED: 7-JUN-89

| ORDER | ELEMENT | NUMBER OF ANALYSES | LOWER DETECTION LIMIT | EXTRACTION        | METHOD             |
|-------|---------|--------------------|-----------------------|-------------------|--------------------|
| 1     | Au      | 11                 | 5 PPM                 | FIRE-ASSAY        | Fire Assay AA      |
| 2     | Ag      | 11                 | 0.1 PPM               | HN03-HCL HOT EXTR | Atomic Absorption  |
| 3     | Cu      | 6                  | 1 PPM                 | HN03-HCL HOT EXTR | Atomic Absorption  |
| 4     | Pb      | 6                  | 2 PPM                 | HN03-HCL HOT EXTR | Atomic Absorption  |
| 5     | Zn      | 6                  | 1 PPM                 | HN03-HCL HOT EXTR | Atomic Absorption  |
| 6     | As      | 8                  | 1 PPM                 |                   |                    |
| 7     | Sb      | 8                  | 2 PPM                 |                   | X-Ray Fluorescence |

| SAMPLE TYPES       | NUMBER | SIZE FRACTIONS | NUMBER | SAMPLE PREPARATIONS | NUMBER |
|--------------------|--------|----------------|--------|---------------------|--------|
| R ROCK OR BED ROCK | 11     | 2 -150         | 11     | CRUSH,PULVERIZE     | 11     |

REMARKS: Assay of high Ag, Cu, Pb, and Zn to follow on  
 V89-01925.6.

REPORT COPIES TO: MR. R. HULSTEIN  
 MR. CRAIG HART  
 M.J. MOREAU

INVOICE TO: MR. R. HULSTEIN  
 MR. CRAIG HART





REPORT: V89-01925.0

PROJECT: NONE GIVEN

PAGE 1

| SAMPLE NUMBER | ELEMNT UNITS | Au PPB | Ag PPM | Cu PPM | Pb PPM | Zn PPM | As PPM | Sb PPM |
|---------------|--------------|--------|--------|--------|--------|--------|--------|--------|
| R2 CH89-1     |              | 149    | >50.0  | 4780   | >10000 | >20000 | 240    | 1900   |
| R2 CH89-2     |              | 37     | >50.0  | 11510  | >10000 | 4110   | 610    | 2400   |
| R2 CH89-3     |              | 20     | >50.0  | >20000 | 4990   | 884    |        |        |
| R2 CH89-4     |              | 14     | >50.0  | >20000 | 1310   | 333    |        |        |
| R2 CH89-5     |              | 9      | 17.2   | 9610   | 359    | 120    |        |        |
| R2 CH89-6     |              | 20     | 19.0   |        |        |        | 27     | 7      |
| R2 CH89-7     |              | <5     | 1.1    |        |        |        | 2      | 10     |
| R2 CH89-8     |              | 13     | 1.3    |        |        |        | 115    | 16     |
| R2 CH89-9     |              | <5     | 4.7    |        |        |        | 2      | 10     |
| R2 CH89-10    |              | <5     | 1.0    |        |        |        | 1      | 15     |
| R2 CH89-11    |              | 153    | >50.0  | 5400   | >10000 | >20000 | 230    | 1400   |

Bondar-Clegg & Company Ltd.  
 130 Pemberton Ave.  
 North Vancouver, B.C.  
 V7P 2R5  
 (604) 985-0681 Telex 04-352667



**Certificate  
 of Analysis**

A DIVISION OF INCHCAPE INSPECTION & TESTING SERVICES

REPORT: V89-01925.6 ( COMPLETE )

REFERENCE INFO:

CLIENT: AURUM GEOLOGICAL CONSULTANTS INC.  
 PROJECT: NONE GIVEN

SUBMITTED BY: UNKNOWN  
 DATE PRINTED: 16-JUN-89

| ORDER | ELEMENT   | NUMBER OF ANALYSES | LOWER DETECTION LIMIT | EXTRACTION        | METHOD            |
|-------|-----------|--------------------|-----------------------|-------------------|-------------------|
| 1     | Ag Silver | 3                  | 0.02 OPT              |                   | Fire Assay        |
| 2     | Ag Silver | 2                  | 0.02 OPT              | HF-HNO3-HClO4-HCl | Atomic Absorption |
| 3     | Cu Copper | 2                  | 0.01 PCT              |                   | Atomic Absorption |
| 4     | Pb Lead   | 3                  | 0.01 PCT              |                   | Atomic Absorption |
| 5     | Zn Zinc   | 2                  | 0.01 PCT              |                   | Atomic Absorption |

| SAMPLE TYPES       | NUMBER | SIZE FRACTIONS | NUMBER | SAMPLE PREPARATIONS | NUMBER |
|--------------------|--------|----------------|--------|---------------------|--------|
| R ROCK OR BED ROCK | 5      | 2 -150         | 5      | AS RECEIVED, NO SP  | 5      |

REPORT COPIES TO: MR. R. HULSTEIN  
 MR. CRAIG HART  
 M.J. MOREAU

INVOICE TO: MR. R. HULSTEIN  
 MR. CRAIG HART

Bondar-Clegg & Company Ltd.  
130 Pemberton Ave.  
North Vancouver, B.C.  
V7P 2R5  
(604) 985-0681 Telex 04-352667



Certificate  
of Analysis

A DIVISION OF INCHCAPE INSPECTION & TESTING SERVICES

REPORT: V89-01925.6

PROJECT: NONE GIVEN

PAGE 1

| SAMPLE NUMBER | ELEMENT UNITS | Ag OPT | Ag OPT | Cu PCT | Pb PCT | Zn PCT |
|---------------|---------------|--------|--------|--------|--------|--------|
| R2 CH89-1     |               | 42.29  |        |        | 3.00   | 9.50   |
| R2 CH89-2     |               | 61.78  |        |        | 31.00  |        |
| R2 CH89-3     |               |        | 3.76   | 3.26   |        |        |
| R2 CH89-4     |               |        | 1.89   | 2.47   |        |        |
| R2 CH89-11    |               | 32.40  |        |        | 5.75   | 5.08   |

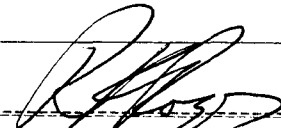
  
Registered Assayer Province of British Columbia