

MAP No.

ASSESSMENT REPORT
PROSPECTUS
CONFIDENTIAL
OPEN FILE



DOCUMENT NO.:

091924

MINING DISTRICT:

WHITEHORSE

TYPE OF WORK:

GEOCHEMICAL

115 J 9, 10

REPORT FILED UNDER: Nordac Mining Corporation

DATE PERFORMED: June 14&28, 1986

DATE FILED: March 16, 1987

LOCATION	LAT.	62°38'N
	LONG.	138°30'W

AREA:
MT. COCKFIELD

CLAIM NAME & NO.	OKE	21-24	YA92184-187	HEN	37-48	YA92276-287	KOKUP	1-8	YA22201-208
	OKE	31-44	YA92194-207	HEN	53-74	YA92292-313	KOKUP	9-24	YA48327-342
	HEN	1-12	YA92240-251	HEN	75-76	YA92314-315	OKE	1-2	YA92164-165
	HEN	19-30	YA92258-269	HEN	77-78	YA92316-317	OKE	15-16	YA92178-179

VALUE \$ 10,800.00

HEN	79-88	YA92318-327	OKE	63-76	YA92226-239
-----	-------	-------------	-----	-------	-------------

WORK DONE BY: R.C. Carne TALIS 1-12 YA95053-064

WORK DONE FOR: Archer, Cathro and Associates (1981) Ltd.

DATE TO GOOD STANDING

REMARKS:

#7 COCKFIELD

ARCHER, CATHRO

& ASSOCIATES (1981) LIMITED

CONSULTING GEOLOGICAL ENGINEERS

1016-510 WEST HASTINGS STREET
VANCOUVER, B. C. V6B 1L8

091924

(604) 688-2568

REPORT ON
GEOCHEMICAL SURVEY
MT. COCKFIELD PROPERTY
MT. COCKFIELD, Y.T.



Hen 1-12	YA92240-YA92251
Hen 19-30	YA92258-YA92269
Hen 37-48	YA92276-YA92287
Hen 53-74	YA92292-YA92313
Hen 75-76	YA92314-YA92315
Hen 77-78	YA92316-YA92317
Hen 79-88	YA92318-YA92327
Kokup 1-8	YA22201-YA22208
Kokup 9-24	YA48327-YA48342
OKE 1-2	YA92164-YA92165
OKE 15-16	YA92178-YA92179
OKE 21-24	YA92184-YA92187
OKE 31-44	YA92194-YA92207
OKE 63-76	YA92226-YA92239
Talus 1-12	YA95053-YA95064

Latitude 62°38'N; Longitude 138°30'W; NTS 115J/9 & 10

NORDAC MINING CORPORATION

R.C. Carne, M.Sc.

February, 1987

Work Done Between June 14 and 28, 1986



This report has been examined by
the Geological Evaluation Unit
under Section 53 (4) Yukon Quartz
Mill Act and is allowed as
representation work in the amount
of \$ 10,800.00.

for *D. Demond*
Regional Manager, Exploration and
Geological Services for Commissioner
of Yukon Territory.

TABLE OF CONTENTS

	<u>PAGE</u>
Summary and Recommendations	1
Introduction	3
Property, Location and Access	4
Geology	5
Structure	7
Mineralization	7
1986 Program	9

LIST OF FIGURES

<u>FIGURE NO.</u>	<u>DESCRIPTION</u>	<u>FOLLOWS PAGE</u>
1	Geology, Mt. Cockfield Property	4
2	Gold Geochemistry, Mt. Cockfield Property	9
3	Sample Locations, Mt. Cockfield Property	9

APPENDICES

- Appendix I Statement of Qualifications
- Appendix II Soil Sample Gold Analyses

SUMMARY AND RECOMMENDATIONS

The Mt. Cockfield property covers a Late Cretaceous acid to intermediate volcanic centre hosted by Mesozoic intrusive rocks and older Paleozoic(?) gneisses and schists. A small and poorly mineralized porphyry copper-molybdenum deposit, situated on the north side of the property, was drilled in 1969 and 1970. Rude Creek, 7 km to the northwest, has been mined for placer gold since 1915.

Kerr Addison's Koe claims, which cover the southern part of the Mt. Cockfield volcanic centre, contain a strong, northwest-trending shear zone with mineralized chalcedonic quartz veins. The Koe shear zone strikes onto the Mt. Cockfield property both to the north and south. The nature and extent of the precious metal mineralization is unknown but is believed to be epithermal in character.

Previous exploration was directed toward the north and east portion of the Mt. Cockfield property in the search for base metals. The only exploration for gold and silver was a rock sampling survey in 1980 that tested an ignimbrite phase of the Casino acid volcanics. Samples from this survey returned anomalous values up to 89 ppb Au and 8.9 ppm Ag but the results were generally inconclusive since the few samples taken were on widely spaced traverses. The best anomalies came from an area underlain by Mt. Nansen volcanics.

The 1986 geochemical survey consisted of ten regional traverses testing the central and southern part of the Mt. Cockfield property. The results indicate the gold background on the property is very low (about 2 or 3 ppb Au) and that a number of results exceed 50 ppb Au, which appears to be clearly anomalous. Interestingly, some of the best results, ranging up to 305 ppb Au,

are situated generally north and south of the Koe shear zone. The sample interval along traverses was 100 m but the traverses are too wide spaced to accurately indicate mineralized trends.

Mt. Cockfield is a Tertiary acid intermediate volcanic centre, similar in setting to the Mt. Skukum Complex in southern Yukon where epithermal gold veins are presently being mined. There is potential for similar epithermal mineralization at Mt. Cockfield, as indicated by the presence of the nearby mineralized Koe shear zone and a number of anomalous gold soil geochemical values.

Detailed grid geochemical sampling for gold and silver, together with prospecting and detailed mapping, is warranted on the south and west side of the property. A budget of \$50,000 is recommended.

Respectfully submitted

ARCHER, CATHRO & ASSOCIATES (1981) LIMITED

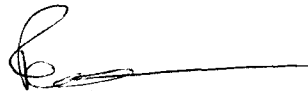

R.C. Carne.

/mc

INTRODUCTION

The Mt. Cockfield property has been held by Archer, Cathro & Associates (1981) Limited almost continuously since 1969. Previous work was performed for Dawson Range Joint Venture (Molycorp, Inc., B.X. Development Ltd., Straus Exploration Inc., Great Plains Development Corporation, and Marietta Resources International Ltd.) in 1969 and optionee Denison Mines Ltd. in 1980.

Rude Creek, 7 km northwest of Mt. Cockfield, was discovered to contain placer gold in 1915. A small galena vein was found in the creek bed in 1921 and there has been sporadic exploration for base metals in this area ever since.

The Mt. Cockfield stock, which lies within the present Mt. Cockfield property, was staked by Newmont in 1969 as a porphyry copper target and drilled by optionee United Keno Hill Mines Ltd. in 1970. The Koe property, partially enclosed within the Mt. Cockfield property, was staked by Kerr Addison in 1983 and subsequently mapped, trenched and sampled in 1984 and 1985 and drilled in 1986.

The present work program, which was performed by Archer, Cathro for optionee Nordac Mining Corporation, was managed by R.C. Carne. Field personnel included B. Wengyzenowski, D. MacBeth and K. Sax.

PROPERTY, LOCATION AND ACCESS

The claims form one irregular contiguous block that almost surrounds the Koe group owned by Kerr Addison. The claims are registered in the Whitehorse Mining District as follows:

<u>Claim Name</u>	<u>Grant Number</u>	<u>NTS</u>	<u>Expiry Date*</u>
Hen 1-12 (12)	YA92240-YA92251	115J/10	June 28, 1987
Hen 19-30 (12)	YA92258-YA92269	115J/10	June 28, 1987
Hen 37-48 (12)	YA92276-YA92287	115J/10	June 28, 1987
Hen 53-74 (22)	YA92292-YA92313	115J/10	June 28, 1987
Hen 75-76 (2)	YA92314-YA92315	115J/9	June 28, 1987
Hen 77-78 (2)	YA92316-YA92317	115J/10	June 28, 1987
Hen 79-88 (22)	YA92318-YA92327	115J/9	June 28, 1987
Kokup 1-8 (8)	YA22201-YA22208	115J/9	October 7, 1987
Kokup 9-24 (16)	YA48327-YA48342	115J/9	October 7, 1987
OKE 1-2 (2)	YA92164-YA92165	115J/9	June 28, 1987
OKE 15-16 (2)	YA92178-YA92179	115J/9	June 28, 1987
OKE 21-24 (4)	YA92184-YA92187	115J/9	June 28, 1987
OKE 31-44 (14)	YA92194-YA92207	115J/9	June 28, 1987
OKE 63-76 (14)	YA92226-YA92239	115J/9	June 28, 1987
Talus 1-12 (12)	YA95053-YA95064	115J/9	July 4, 1987

Total - 156 Claims

* includes 1986 work

The Mt. Cockfield property is located on Mt. Cockfield in the Dawson Range, Y.T. at latitude 62°36'N and 138°30'W on NTS claim sheets 115J/9 and 10 (see Figure 1 on following page). There is no present road access although the Casino Trail, proposed to be completed within the next several years, will pass through the property. Present access is by helicopter from the Casino airstrip, located 25 km to the northwest, which is suitable for Caribou or DC3 aircraft, or from Carmacks, 120 km to the southeast.

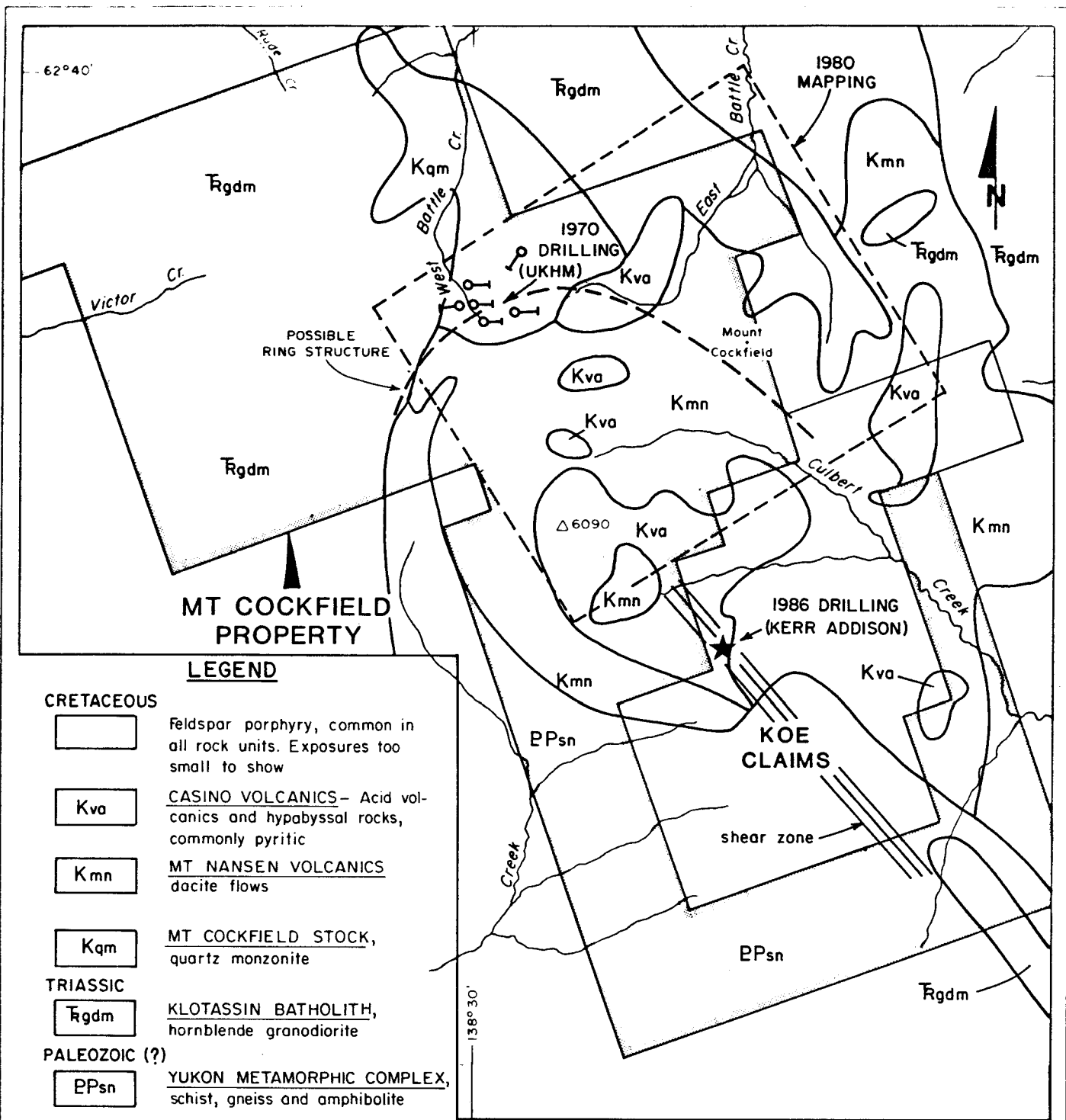
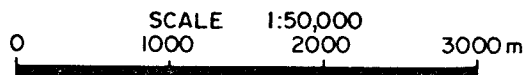
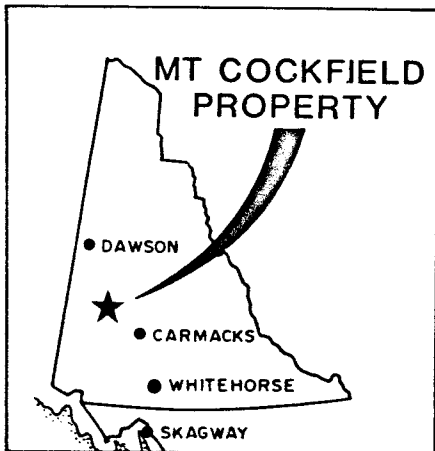

Figure 1
 ARCHER, CATHRO & ASSOCIATES (1981) LIMITED

GEOLOGY

MT COCKFIELD PROPERTY
 NORDAC MINING CORPORATION



To accompany report dated Feb./87

GEOLOGY

The regional geology was mapped by D.J. Tempelman-Kluit in 1970 to 1973 and 1979 and published in GSC Papers 73-41 and 80-1A. In addition, C.I. Godwin studied the Casino Volcanics at the Casino Deposit as part of his Ph.D. Thesis (U.B.C., 1975).

The Mt. Cockfield property is underlain by Paleozoic(?) schists and gneisses of the Yukon Metamorphic Complex intruded by the Triassic Klotassin granodiorite batholith and by the later Mt. Cockfield Stock of Cretaceous quartz monzonite, probably correlatable with Coffee Creek Granite. Mt. Cockfield was the centre of subsequent volcanic activity and rocks of the Dawson Range Suite, which includes Cretaceous Mount Nansen and younger Casino Volcanics, intrude and overlie the older rocks. Swarms of feldspar porphyry dykes intrude all other rocks in the section.

Yukon Metamorphic Complex (PPsn)

The oldest rocks in the region are metasedimentary rocks that belong to the Yukon Metamorphic Complex (PPsn). These occur south of the property in a large pendant or screen that narrows toward Mt. Cockfield and reoccurs on the north end of the mountain as a smaller pendant. Foliation trends NNW and dips steeply. Greenstone and amphibolite are common and schist, gneiss and feldspathic metaquartzite occur in lower sections of the unit. Bedding is not recognizable. Pyritization is occasionally present near volcanic dykes.

Klotassin Batholith (T qdm)

At Mt. Cockfield the Klotassin Batholith is a grey, medium-grained, commonly foliated granodiorite. Hornblende is the principal mafic although biotite occurs locally. Phenocrysts of coarse-grained orthoclase are common.

Mt. Cockfield Stock (Kqm)

The Cretaceous Mt. Cockfield granite stock is similar in appearance to the Klotassin Batholith but is generally finer grained and commonly porphyritic, containing hornblende, biotite and pink orthoclase phenocrysts. Minor amounts of coarse molybdenum and chalcopyrite are occasionally present in quartz veinlets that occupy some fractures.

Mount Nansen Volcanics (Kmn)

The Mount Nansen Volcanics are dark grey weathering, greenish grey, aphanitic and usually structureless dacite flows. In places, they are porphyritic with up to 30% fine- to medium-grained phenocrysts of euhedral feldspars resembling later feldspar porphyry dykes. Fine-grained biotite and hornblende are sometimes present and disseminated pyrite (up to 2%) and magnetite (up to 15%) are common.

Casino Volcanics (Kva)

The Casino Volcanics are composed of gently dipping, rhyolitic ash flow breccias, interpreted as ignimbrites formed from pyroclastic material blown from an adjacent volcanic centre. They typically weather blonde to light grey in colour and decompose into fine talus. A total thickness of 250 m of ash flows is exposed at the summit of Mt. Cockfield.

Feldspar Porphyry (Tfp)

Both the Mount Nansen and Casino Volcanics are cut by feldspar porphyry dykes which comprise some 5% of the rock float on the property. Dykes generally trend north, dip vertically and average about 1.5 m in width. Up to 10% disseminated magnetite, 3% pyrite and traces of chalcopyrite and molybdenite are present. This rock unit is not shown on Figure 1 as individual exposures are too small to represent.

STRUCTURE

Apart from north-trending faulting evident from the feldspar porphyry dyke systems, the only recognized regional structure is a possible ring fracture system identified from air photographs, which is plotted on Figure 1.

MINERALIZATION

Drilling by United Keno Exploration in 1970 showed that low grade porphyry copper-molybdenum mineralization related to late-stage fracturing is associated with the Cretaceous Mt. Cockfield Stock. The mineralizing event is possibly coeval with later emplacement of Casino Volcanics and/or feldspar porphyry dykes. Fractures are filled with quartz, calcite and ankerite with pyrite, chalcopyrite, molybdenum and magnetite associated with the quartz veinlets. A 0.6 m wide fault zone contains chalcopyrite, molybdenite, pyrite, galena and arsenopyrite. No zoning has been recognized that would suggest the presence of a Casino-type eruptive centre.

Pyrite is common in the Mount Nansen Volcanics as minor disseminations and as veinlets along north-trending fractures. Pyrite is also common throughout the Casino Volcanics, ranging up to 5%, mainly as fracture fillings with lesser amounts of disseminated pyrite. Trace amounts of disseminated chalcopyrite and molybdenite are associated with the pyritic mineralization. Magnetite is common in the Mount Nansen Volcanics, averaging 2% and ranging up to 15%, occurring as patchy disseminations with minor fracture fillings. Sulphide content is generally much lower in the porphyry dykes than in the volcanic rocks.

Chalcedonic quartz veins occur in a strong north-northwest trending structure which cuts across the Kerr Addison Koe property and strikes onto the Nordac property both to the north and south. This shear zone is hosted in both the older Paleozoic Yukon Metamorphic Complex gneisses and overlying Casino acid volcanics. As this shear zone strikes through the core of the Mt. Cockfield volcanic complex and is parallel to the basement foliation, it is probably a major structural feature related to this igneous centre. The chalcedonic veins are low in sulphides and carry gold and silver values but the character and extent of mineralization is unknown.

1986 PROGRAM

Twenty mandays were spent in prospecting and geochemical sampling the Mt. Cockfield property. Samples were generally taken at 100 m intervals along traverses located by hip chain and compass. One hundred and ninety-five geochemical samples were taken from a brown clay B horizon soil, generally at depths of about 20 cm. These samples were sent by air to Chemex Labs where they were dried and the -35 mesh sieved portion was pulverized to -100 mesh. This prepared material was preconcentrated by fire assay and analyzed for gold by neutron activation. The results of the gold analysis is shown on Figure 2 on the following page. For clarity, only values over 10 ppb Au are shown. Complete results are shown in Appendix II with sample locations shown on Figure 3, following Figure 2.

No significant new mineralization was found by prospecting.

The background gold content on the Mt. Cockfield property is very low, about 2 or 3 ppb Au although there are too few samples in the present survey to determine this accurately. Values over 20 ppb Au appear to exceed the anomalous threshold and those over 50 ppb are clearly anomalous. The gold background on this property is certainly much lower than that of properties underlain by nearby porphyry gold-copper systems such as Casino and Revenue where gold background values are at least 20 ppb Au and the anomalous threshold is 50 ppb Au or more.

On Mt. Cockfield, a number of samples have anomalous assays ranging up to 157 and 305 ppb Au, indicating that further work is required to locate the mineralized source of these anomalies and to determine if other areas are similarly anomalous.

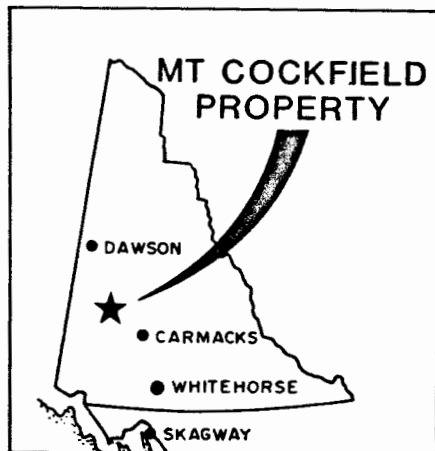
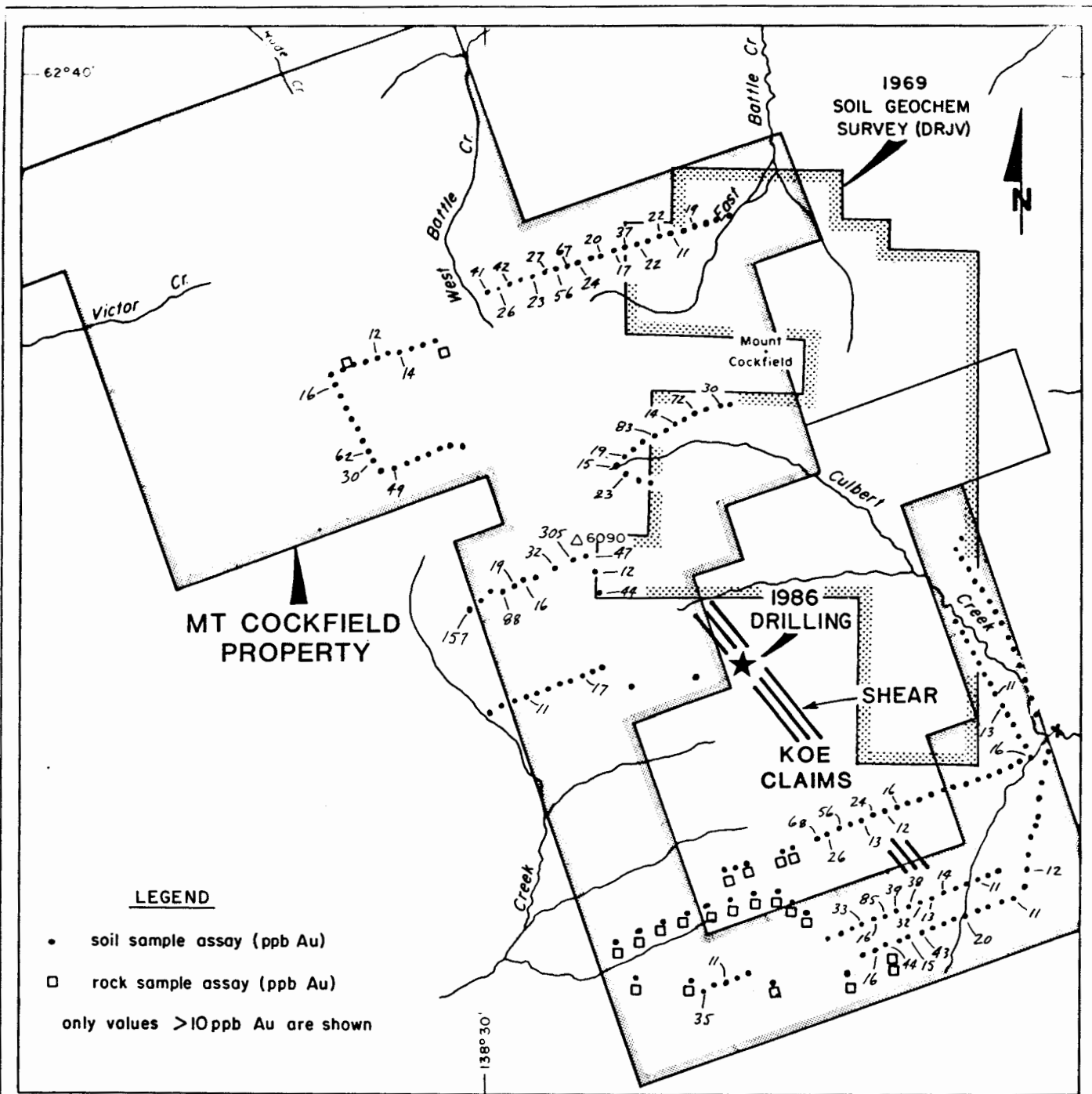
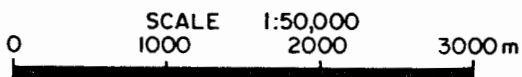

Figure 2
 ARCHER, CATHRO & ASSOCIATES (1981) LIMITED

GOLD GEOCHEMISTRY

MT COCKFIELD PROPERTY
 NORDAC MINING CORPORATION



To accompany report dated Feb./87

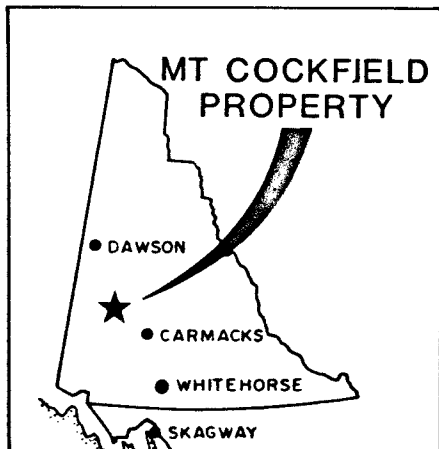
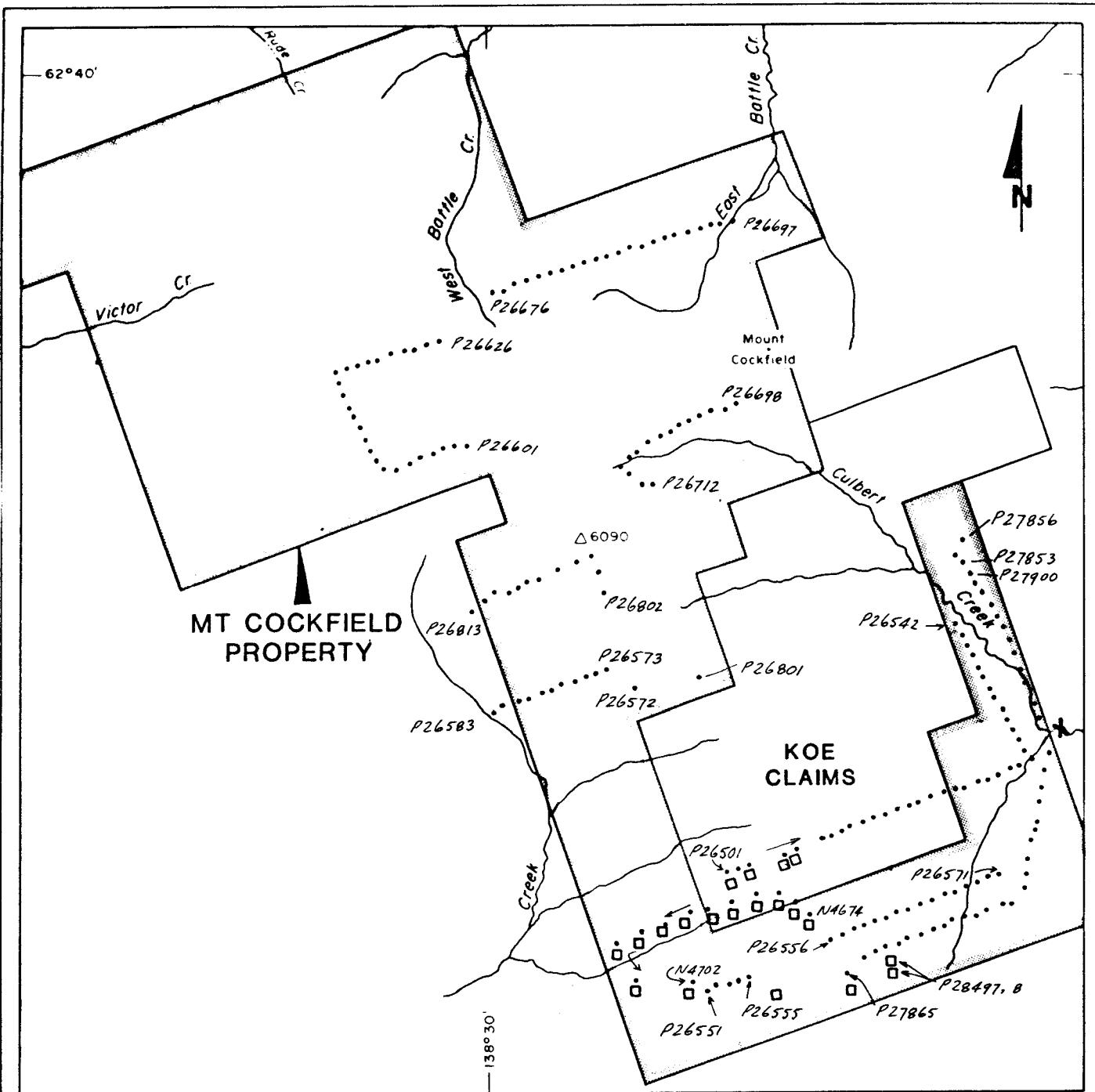
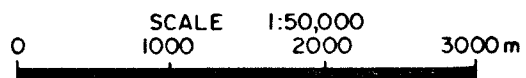

Figure 3

ARCHER, CATHRO & ASSOCIATES (1981) LIMITED

SAMPLE LOCATIONS

MT COCKFIELD PROPERTY
NORDAC MINING CORPORATION



To accompany report dated Feb./87

APPENDIX I
STATEMENT OF QUALIFICATIONS

STATEMENT OF QUALIFICATIONS

I, Robert C. Carne, geologist, with business addresses in Whitehorse, Yukon Territory and Vancouver, British Columbia and residential address in Burnaby, British Columbia, hereby certify that:

1. I graduated from the University of British Columbia in 1974 with a B.Sc. and in 1979 with an M.Sc. majoring in Geological Sciences.
2. I am a member of the Geological Association of Canada.
3. From 1974 to the present, I have been actively engaged as a geologist in mineral exploration in British Columbia and Yukon Territory and on June 1, 1981 became a partner of Archer, Cathro & Associates (1981) Limited.
4. I have personally participated in or supervised the field work reported herein and have interpreted all data resulting from this work.

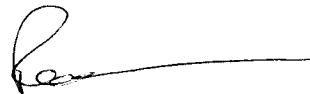

Robert C. Carne, B.Sc., M.Sc.

APPENDIX II
SOIL SAMPLE GOLD ANALYSES



Chemex Labs Ltd.

212 Brooksbank Ave.
North Vancouver, B.C.
Canada V7J 2C1

Analytical Chemists • Geochemists • Registered Assayers

Phone: (604) 984-0221
Telex: 043-52597

CERTIFICATE OF ANALYSIS

TO : ARCHER CATHRO & ASSOC. (1981) LTD.
BOX 4127
3125 THIRD AVE.
WHITEHORSE, Y.T.
Y1A 3S9

CERT. # : A8614399-001-A
INVOICE # : I8614399
DATE : 13-JUL-86
P.G. # : NONE
NORDAL (COCKFIELD)

Sample description	Prep code	Au NAA ppb						
N4674	203	5	--	--	--	--	--	--
N4675	203	4	--	--	--	--	--	--
N4676	203	3	--	--	--	--	--	--
N4677	203	3	--	--	--	--	--	--
N4678	203	3	--	--	--	--	--	--
N4679	203	4	--	--	--	--	--	--
N4680	203	3	--	--	--	--	--	--
N4681	203	1	--	--	--	--	--	--
N4682	203	3	--	--	--	--	--	--
N4683	203	3	--	--	--	--	--	--
N4684	203	<1	--	--	--	--	--	--
N4685	203	<1	--	--	--	--	--	--
N4686	203	1	--	--	--	--	--	--
N4687	203	<1	--	--	--	--	--	--
N4688	203	9	--	--	--	--	--	--
N4689	203	4	--	--	--	--	--	--
N4690	203	5	--	--	--	--	--	--
N4691	203	3	--	--	--	--	--	--
N4692	203	<1	--	--	--	--	--	--
N4693	203	<1	--	--	--	--	--	--
N4694	203	1	--	--	--	--	--	--
N4695	203	5	--	--	--	--	--	--
N4696	203	8	--	--	--	--	--	--
N4697	203	<1	--	--	--	--	--	--
N4698	203	2	--	--	--	--	--	--
N4699	203	4	--	--	--	--	--	--
N4700	203	4	--	--	--	--	--	--
N4701	203	2	--	--	--	--	--	--
N4702	203	1	--	--	--	--	--	--
N4704	203	4	--	--	--	--	--	--
N4708	203	6	--	--	--	--	--	--
N4712	203	<1	--	--	--	--	--	--
N4714	203	7	--	--	--	--	--	--
N4716	203	3	--	--	--	--	--	--
N4718	203	5	--	--	--	--	--	--
N4719	203	<1	--	--	--	--	--	--
N4721	203	2	--	--	--	--	--	--
N4723	203	3	--	--	--	--	--	--
N4724	203	4	--	--	--	--	--	--
N4726	203	4	--	--	--	--	--	--

Hart Buchler

Certified by

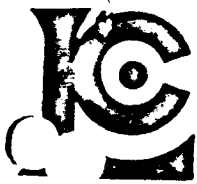

Chemex Labs Ltd.

212 Brooksbank Ave.
North Vancouver, B.C.
Canada V7J 2C1
Phone: (604) 984-0221
Telex: 043-52597

Analytical Chemists • Geochemists • Registered Assayers

CERTIFICATE OF ANALYSIS

TO : ARCHER CATHRO & ASSOC. (1981) LTD.
BOX 4127
3125 THIRD AVE.
WHITEHORSE, Y.T.
Y1A 3S9

CERT. # : A8614399-002-A
INVOICE # : I8614399
DATE : 13-JUL-86
P.O. # : NONE
NORDAL (COCKFIELD)

Sample description	Prep code	Au NAA ppb					
N4728	203	7	--	--	--	--	--
N4730	203	3	--	--	--	--	--
N4732	203	3	--	--	--	--	--
N4734	203	11	--	--	--	--	--
N4735	203	5	--	--	--	--	--
N4737	203	11	--	--	--	--	--
N4739	203	2	--	--	--	--	--
N4742	203	7	--	--	--	--	--
N4744	203	6	--	--	--	--	--
N4745	203	3	--	--	--	--	--
N4747	203	5	--	--	--	--	--
N4748	203	<1	--	--	--	--	--
N4750	203	1	--	--	--	--	--
N4751	203	6	--	--	--	--	--
N4753	203	2	--	--	--	--	--
N4755	203	12	--	--	--	--	--
N4757	203	2	--	--	--	--	--
N4804	203	1	--	--	--	--	--

Certified by Hart Bichler

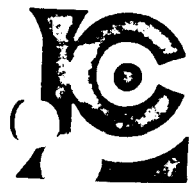

Chemex Labs Ltd.

212 Brooksbank Ave.
North Vancouver, B.C.
Canada V7J 2C1

Analytical Chemists • Geochemists • Registered Assayers

Phone: (604) 984-0221
Telex: 043-52597

CERTIFICATE OF ANALYSIS

TO : ARCHER CATHRO & ASSOC. (1981) LTD.
BOX 4127
3125 THIRD AVE.
WHITEHORSE, Y.T.
Y1A 3S9

CERT. # : AB614592-001-A
INVOICE # : I8614592
DATE : 14-JUL-86
P.O. # : NONE
COCKFIELD NORDAC

Sample description	Prep code	Au NAA ppb						
P 26501	203	<1	--	--	--	--	--	--
26503	203	8	--	--	--	--	--	--
26505	203	1	--	--	--	--	--	--
26506	203	4	--	--	--	--	--	--
26508	203	6	--	--	--	--	--	--
26510	203	68	--	--	--	--	--	--
26511	203	26	--	--	--	--	--	--
26512	203	56	--	--	--	--	--	--
26513	203	5	--	--	--	--	--	--
26514	203	13	--	--	--	--	--	--
26515	203	24	--	--	--	--	--	--
26516	203	12	--	--	--	--	--	--
26517	203	16	--	--	--	--	--	--
26518	203	8	--	--	--	--	--	--
26519	203	10	--	--	--	--	--	--
26520	203	6	--	--	--	--	--	--
26521	203	4	--	--	--	--	--	--
26522	203	3	--	--	--	--	--	--
26523	203	3	--	--	--	--	--	--
26524	203	4	--	--	--	--	--	--
26525	203	<1	--	--	--	--	--	--
26526	203	3	--	--	--	--	--	--
26527	203	2	--	--	--	--	--	--
26528	203	3	--	--	--	--	--	--
26529	203	16	--	--	--	--	--	--
26530	203	6	--	--	--	--	--	--
26531	203	6	--	--	--	--	--	--
26532	203	2	--	--	--	--	--	--
26533	203	7	--	--	--	--	--	--
26534	203	13	--	--	--	--	--	--
26535	203	11	--	--	--	--	--	--
26536	203	3	--	--	--	--	--	--
26537	203	5	--	--	--	--	--	--
26538	203	4	--	--	--	--	--	--
26539	203	3	--	--	--	--	--	--
26540	203	5	--	--	--	--	--	--
26541	203	5	--	--	--	--	--	--
26551	203	35	--	--	--	--	--	--
26552	203	10	--	--	--	--	--	--
26553	203	11	--	--	--	--	--	--

Certified by Hart Bichler

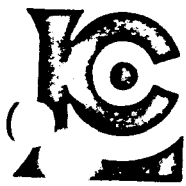

Chemex Labs Ltd.

212 Brooksbank Ave.
North Vancouver, B.C.
Canada V7J 2C1

Analytical Chemists • Geochemists • Registered Assayers

Phone: (604) 984-0221
Telex: 043-52597

CERTIFICATE OF ANALYSIS

TO : ARCHER CATHRD & ASSOC. (1981) LTD.
BOX 4127
3125 THIRD AVE.
WHITEHORSE, Y.T.
Y1A 3S9

CERT. # : A8614592-002-A
INVOICE # : I8614592
DATE : 14-JUL-86
P.O. # : NONE
COCKFIELD NORDAC

Sample description	Prep code	Au NAA ppb					
P 26554	203	2	--	--	--	--	--
26555	203	5	--	--	--	--	--
26556	203	<1	--	--	--	--	--
26557	203	2	--	--	--	--	--
26558	203	6	--	--	--	--	--
26559	203	33	--	--	--	--	--
26560	203	16	--	--	--	--	--
26561	203	85	--	--	--	--	--
26562	203	39	--	--	--	--	--
26563	203	38	--	--	--	--	--
26564	203	32	--	--	--	--	--
26565	203	13	--	--	--	--	--
26566	203	14	--	--	--	--	--
26567	203	6	--	--	--	--	--
26568	203	4	--	--	--	--	--
26569	203	11	--	--	--	--	--
26570	203	8	--	--	--	--	--
26571	203	5	--	--	--	--	--
26572	203	1	--	--	--	--	--
26573	203	3	--	--	--	--	--
26575	203	6	--	--	--	--	--
26576	203	17	--	--	--	--	--
26577	203	5	--	--	--	--	--
26578	203	8	--	--	--	--	--
26579	203	5	--	--	--	--	--
26580	203	4	--	--	--	--	--
26581	203	11	--	--	--	--	--
26582	203	2	--	--	--	--	--
26583	203	5	--	--	--	--	--
26601	203	7	--	--	--	--	--
26602	203	4	--	--	--	--	--
26603	203	5	--	--	--	--	--
26604	203	<1	--	--	--	--	--
26605	203	<1	--	--	--	--	--
26606	203	1	--	--	--	--	--
26607	203	49	--	--	--	--	--
26608	203	4	--	--	--	--	--
609	203	30	--	--	--	--	--
26610	203	62	--	--	--	--	--
26611	203	8	--	--	--	--	--

VOI rev. 4/85

Certified by Hart Bichler



Chemex Labs Ltd.

212 Brooksbank Ave.
North Vancouver, B.C.
Canada V7J 2C1

Analytical Chemists • Geochemists • Registered Assayers

Phone: (604) 984-0221
Telex: 043-52597

CERTIFICATE OF ANALYSIS

TO : ARCHER CATHRO & ASSOC. (1981) LTD.
BOX 4127
3125 THIRD AVE.
WHITEHORSE, Y.T.
Y1A 3S9

CERT. # : A8614592-003-A
INVOICE # : I8614592
DATE : 14-JUL-86
P.O. # : NONE
COCKFIELD NORDAC

Sample description	Prep code	Au NAA ppb						
P 26612	203	3	--	--	--	--	--	--
26613	203	2	--	--	--	--	--	--
26614	203	5	--	--	--	--	--	--
26615	203	<1	--	--	--	--	--	--
26616	203	15	--	--	--	--	--	--
26617	203	5	--	--	--	--	--	--
26618	203	1	--	--	--	--	--	--
26619	203	1	--	--	--	--	--	--
26620	203	<1	--	--	--	--	--	--
26621	203	3	--	--	--	--	--	--
26622	203	9	--	--	--	--	--	--
26623	203	14	--	--	--	--	--	--
624	203	4	--	--	--	--	--	--
26625	203	12	--	--	--	--	--	--
26626	203	7	--	--	--	--	--	--
26676	203	41	--	--	--	--	--	--
26677	203	26	--	--	--	--	--	--
26678	203	42	--	--	--	--	--	--
26679	203	2	--	--	--	--	--	--
26680	203	23	--	--	--	--	--	--
26681	203	27	--	--	--	--	--	--
26682	203	56	--	--	--	--	--	--
26683	203	67	--	--	--	--	--	--
26684	203	24	--	--	--	--	--	--
26685	203	10	--	--	--	--	--	--
26686	203	20	--	--	--	--	--	--
26687	203	17	--	--	--	--	--	--
26688	203	37	--	--	--	--	--	--
26689	203	22	--	--	--	--	--	--
26690	203	1	--	--	--	--	--	--
26691	203	22	--	--	--	--	--	--
26692	203	11	--	--	--	--	--	--
26693	203	6	--	--	--	--	--	--
26694	203	19	--	--	--	--	--	--
26695	203	<1	--	--	--	--	--	--
26696	203	4	--	--	--	--	--	--
26697	203	2	--	--	--	--	--	--
698	203	8	--	--	--	--	--	--
26699	203	30	--	--	--	--	--	--
26700	203	6	--	--	--	--	--	--

VOI rev. 4/85

Certified by Hart Bichler



Chemex Labs Ltd.

Analytical Chemists • Geochemists • Registered Assayers

212 Brooksbank Ave.
North Vancouver, B.C.
Canada V7J 2C1

Phone: (604) 984-0221
Telex: 043-52597

CERTIFICATE OF ANALYSIS

TO : ARCHER CATHRO & ASSOC. (1981) LTD.
BOX 4127
3125 THIRD AVE.
WHITEHORSE, Y.T.
Y1A 3S9

CERT. # : A8614592-004-A
INVOICE # : I8614592
DATE : 14-JUL-86
P.O. # : NONE
COCKFIELD NORDAC

Sample description	Prep code	Au NAA ppb					
P 26701	203	19	--	--	--	--	--
26702	203	72	--	--	--	--	--
26703	203	12	--	--	--	--	--
26704	203	14	--	--	--	--	--
26705	203	13	--	--	--	--	--
26706	203	83	--	--	--	--	--
26707	203	9	--	--	--	--	--
26708	203	10	--	--	--	--	--
26709	203	19	--	--	--	--	--
26710	203	15	--	--	--	--	--
26711	203	23	--	--	--	--	--
26712	203	10	--	--	--	--	--
26801	203	4	--	--	--	--	--
26802	203	44	--	--	--	--	--
26803	203	12	--	--	--	--	--
26804	203	47	--	--	--	--	--
26805	203	305	--	--	--	--	--
26806	203	32	--	--	--	--	--
26807	203	9	--	--	--	--	--
26808	203	16	--	--	--	--	--
26809	203	19	--	--	--	--	--
26810	203	88	--	--	--	--	--
26811	203	4	--	--	--	--	--
26812	203	2	--	--	--	--	--
26813	203	157	--	--	--	--	--
27853	203	4	--	--	--	--	--
27854	203	<1	--	--	--	--	--
27855	203	2	--	--	--	--	--
27856	203	3	--	--	--	--	--
27865	203	2	--	--	--	--	--
27866	203	16	--	--	--	--	--
27867	203	44	--	--	--	--	--
27868	203	<1	--	--	--	--	--
27869	203	15	--	--	--	--	--
27870	203	43	--	--	--	--	--
27871	203	6	--	--	--	--	--
27872	203	8	--	--	--	--	--
27873	203	7	--	--	--	--	--
27874	203	20	--	--	--	--	--
27875	203	4	--	--	--	--	--

VOI rev. 4/85

Certified by Hart Bichler



Chemex Labs Ltd.

212 Brooksbank Ave.
North Vancouver, B.C.
Canada V7J 2C1

Analytical Chemists • Geochemists • Registered Assayers

Phone: (604) 984-0221
Telex: 043-52597

CERTIFICATE OF ANALYSIS

TO : ARCHER CATHRO & ASSOC. (1981) LTD.
BOX 4127
3125 THIRD AVE.
WHITEHORSE, Y.T.
Y1A 3S9

CERT. # : A8614592-005-A
INVOICE # : I8614592
DATE : 14-JUL-86
P.O. # : NONE
COCKFIELD NORDAC

Sample description	Prep code	Au NAA ppb						
27876	203	1	--	--	--	--	--	--
27877	203	6	--	--	--	--	--	--
27878	203	11	--	--	--	--	--	--
27879	203	<1	--	--	--	--	--	--
27880	203	12	--	--	--	--	--	--
27881	203	2	--	--	--	--	--	--
27882	203	4	--	--	--	--	--	--
27883	203	3	--	--	--	--	--	--
27884	203	8	--	--	--	--	--	--
27885	203	8	--	--	--	--	--	--
27886	203	2	--	--	--	--	--	--
27887	203	<1	--	--	--	--	--	--
7888	203	5	--	--	--	--	--	--
27889	203	7	--	--	--	--	--	--
27890	203	2	--	--	--	--	--	--
27891	203	8	--	--	--	--	--	--
27892	203	16	--	--	--	--	--	--
27893	203	2	--	--	--	--	--	--
27894	203	<1	--	--	--	--	--	--
27895	203	3	--	--	--	--	--	--
27896	203	3	--	--	--	--	--	--
27897	203	3	--	--	--	--	--	--
27898	203	<1	--	--	--	--	--	--
27899	203	<1	--	--	--	--	--	--
27900	203	2	--	--	--	--	--	--

Certified by Hart Bichler



Chemex Labs Ltd.

212 Brooksbank Ave.
North Vancouver B.C.
Canada V7J 2C1
Phone: (604) 984-0221
Telex: 043-52597

Analytical Chemists • Geochemists • Registered Assayers

CERTIFICATE OF ANALYSIS

TO : ARCHER CATHRO & ASSOC. (1981) LTD.
BOX 4127
3125 THIRD AVE.
WHITEHORSE, Y.T.
Y1A 3S9

CERT. # : A8614432-001-A
INVOICE # : 18614432
DATE : 8-JUL-86
P.O. # : NONE
NORDAC (COCKFIELD)

Rocks

Sample description	Prep code	AU NAA ppb					
N 4535	205	<1	--	--	--	--	--
N 4703	205	<1	--	--	--	--	--
N 4705	205	1	--	--	--	--	--
N 4706	205	1	--	--	--	--	--
N 4707	205	<1	--	--	--	--	--
N 4709	205	<1	--	--	--	--	--
N 4710	205	<1	--	--	--	--	--
N 4711	205	<1	--	--	--	--	--
N 4713	205	<1	--	--	--	--	--
N 4715	205	<1	--	--	--	--	--
N 4717	205	<1	--	--	--	--	--
N 4720	205	<1	--	--	--	--	--
4722	205	<1	--	--	--	--	--
N 4725	205	<1	--	--	--	--	--
N 4727	205	<1	--	--	--	--	--
N 4729	205	<1	--	--	--	--	--
N 4731	205	<1	--	--	--	--	--
N 4733	205	<1	--	--	--	--	--
N 4736	205	<1	--	--	--	--	--
N 4738	205	<1	--	--	--	--	--
N 4740	205	<1	--	--	--	--	--
N 4741	205	<1	--	--	--	--	--
N 4743	205	<1	--	--	--	--	--
N 4746	205	<1	--	--	--	--	--
N 4749	205	<1	--	--	--	--	--
N 4752	205	<1	--	--	--	--	--
N 4754	205	<1	--	--	--	--	--
N 4756	205	<1	--	--	--	--	--
N 4953	205	<1	--	--	--	--	--
N 4954	205	<1	--	--	--	--	--
N 5495	205	<1	--	--	--	--	--
N 5498	205	<1	--	--	--	--	--
N 5499	205	<1	--	--	--	--	--
N 5500	205	<1	--	--	--	--	--
M 12440	205	<1	--	--	--	--	--
M 18250	205	7	--	--	--	--	--
M 18476	205	<1	--	--	--	--	--
18477	205	<1	--	--	--	--	--
n 18478	205	<1	--	--	--	--	--
M 18479	205	<1	--	--	--	--	--

Certified by *Hart Bichler*

ARCHER, CATHRO

A ASSOCIATES LIMITED

CONSULTING GEOLOGICAL ENGINEERS

091924

VANCOUVER, B.C. (604) 688-2568

BOX 4127, WHITEHORSE, Y.T. Y1A 3S9 (403) 667-4415

1016 - 510 WEST HASTINGS STREET
VANCOUVER, B.C. V6B 1L8

AFFIDAVIT



I, Joan Mariacher, of Whitehorse, Yukon make oath and say:

That to the best of my knowledge the attached Statement of Expenditures for exploration work on the OKE 1-2,15-16,21-24,31-34,63-76; HEN 1-4,19-22,75-78,83-88; and Kokup 3-6 & 11-12 mineral claims on Claim Sheet 115J/9 & 10 is accurate.

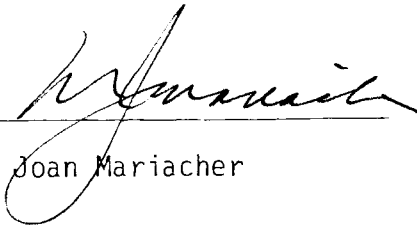
Joan Mariacher

Sworn before me at Whitehorse, Yukon

this 11th day of

July, 1986

Notary, Yukon Territory

Statement of Expenditures
OKE, HEN & Kokup Claims
June 10-28, 1986

Labour

Field

R. Carne - 2 1/2 days at \$270/day	\$675.00	
K. Sax - 5 days at \$119/day	595.00	
B. Wengzynowski - 7 days at \$110/day	770.00	
D. McBeth - 5 days at \$94/day	<u>470.00</u>	\$ 2,510.00

Office

R. Carne - 2 days at \$270/day	540.00	
A. Gelling - 8 hours at \$25/hr	<u>200.00</u>	740.00

Expenses

Helicopter - Trans North Air -		
3.8 hours at \$558.67/hr	2,122.94	
400 l fuel in place at \$2.65/l	1,060.00	
Air North - fixed wing	2,194.88	
Field room and board - 19 1/2		
mandays at \$60/day	1,170.00	
Assaying - 197 samples at \$8/each	1,576.00	
Report printing costs	<u>150.00</u>	<u>8,273.82</u>

Total		<u>\$11,523.82</u>
-------	--	--------------------

Project - NORCAL MINING CORP
 Date -- JUNE 30, 1986

R - RECEIPTS
 A - ANNA
 C - COCKFIELD
 G - GENERAL
 S - SALVER OFFICE Total

MANAGEMENT, CONSULTING FEES

R. CATHRO - 70 HRS (1050 G, 2150 R, 150 U, 150 C)	3500.00	
A. ARCHER - 24 HRS (100 U, 200 C, 200 G, 200 R)	1200.00	
		4700.00

LABOUR
 Field

M. PHILLIPS - 1 day	300.00	R
C. MAIN - 3 days @ 270/d	810.00	R
J. BENNETT - 26 days @ 166/d	4316.00	R
M. WALLS - 7 days @ 138/d	966.00	R
L. ROBINSON - 29 days @ 88/d	2552.00	R
C. WARRINGTON - 30 " @ 125/d	3750.00	R
D. McKEITH - 6 " @ 94/d	564.00	C
R. WENZYNOWSKI - 10 1/2 " @ 114/d (935 C, 220 ANA)	1155.00	-
T. SWIFT - 11 days @ 88/d	968.00	R
R. CARNE - 3 1/2 days @ 270/d (675 C, 270 ANA)	945.00	
K. SAY - 6 days @ 119/d (119 A, 595 C)	714.00	
		17,040.00

Secretarial

M. Cook - 3 hrs @ 22.35	67.05	G
-------------------------	-------	---

Accounting & Expediting

DIMARICHER - 6 1/2 hrs (498.75 C, 355, 35 C, 61.25 U, 1531.25 R)	2161.25	
A. GELLING - 7 1/2 hrs @ 35/hr (12.50 C, 250 R)	262.50	
		2423.75

EXPENSES

Room & Board in Whse 14 1/2 days total @ 60/d	870.00	G
Field equipment from AC stock	276.00	R
Xerox copies, 475 copies at 25¢/copy (22.20 R, 15.50 C, 53.55 C)	121.25	
Radio rental 1 SRX11 FOR JUNE	300.00	R
Petty Cash #1.01, 7.95 C2, 14.28 D1, 14.28 D2, 2 C2, 1.75 D1	41.26	G
Telephone 28.03 + 2.65 + 17.33 + 135.22 + 42.66	225.89	G
Blueprinting, 134 sq. ft Ozolid at 30 c/ft plus - sq. ft. Dilar at \$ - /ft.	40.20	R
Drafting, 10 hrs at \$ 25 /hr	250.00	R
TOOLS FROM AC - 2 HONDA MOTORCYCLES @ 250/MO EACH	500.00	R
- 1 " " " GENERATOR @ 150/MO	150.00	R
- 1 BINOCULAR MICROSCOPE @ 50/MO	50.00	R
- 1 WATER PUMP @ 20/MO JUNE 23-30	20.00	R
BANK OF N.S. CHARGES ON FIELD ACCT MAY-JUNE	21.00	R
R. Cathro services June 12 (50 C2, 68 D3)	118.00	R
NEVILLE CROSBY	12.12	R
VANCEL REPRO	8.35	R
BEANEN GRAPHICS	17.12	R
CORP COURIER	8.50	G
F.W. WOODLUM	3.81	R
Field Kitchen and Board Supplied by SQ Project at Camp 20 meals @ 60/meal (960 C, 270 A)	1260.00	
Helicopter land purchase June SQ Project at Camp 615 @ 2.65/l (1375 C, 238.50 ANA)	1616.50	
Rec. (see) Rental Tables 1-12 @ 11.25	133.50	C
Dilman Communication	100.00	R
Books on Main - D1	21.30	R
Under Office	5.92	R
Photo Expens	19.48	R
MASS	13.50	R
Integrations	11.93	R
Chow Leds	28.35	R
BOXYE	912.49	R
ALPINE BATTERY	26.57	R
AIR NORTH	1639.68	C
HARWOODS	30.11	R
KETHWELL	89.04	R
BEAVER LUMBER	302.83	R
- PAID	61.83	R
TATCHMAN STORE	20.57	R
- BEX	13647.50	R
NORTHWESTERN, RADIO PHONE	192.88	R
		22,476.9

Notes

90 gal diesel sold to SQ (NIF)	(200.00)	R
Amper's land sale from P/MNT, paid in June	(5700.00)	R
		(5900.00)

Total 41,307.78

24.



PERMIT PAYMENT TO
TRANS NORTH AIR
 TRANS NORTH TURBO AIR LTD
 BOX 433R • WHITE HORSE • YUKON TERRITORY • Y1A 3T6
 TELEPHONE (403) 688 2177 TELETYPE 03-8796

ACCOUNT NUMBER	1030
INVOICE NUMBER	74683
INVOICE DATE	01/20/78
A/C TYPE	11-200 GAH
FLIGHT DATE	JAN 20 1978
PURCHASE ORDER NO Contract	

CHARTERER White Horse

BILLING ADDRESS _____

FUEL & OIL X	TNTA FUEL USED	HRS./LITRES	FROM
TNTA	CUST.		
	3500		

FROM	MILES	HOURS	ZONE	REMARKS	NO. OF PASS	FREIGHT Kg
Cambridge						
Whitehorse		35				
ANA		189.				
COXFIELD		283.50				
ALL NORTH (WDR)		236.75				
IDAMO		245.				

SUB	GL	AMOUNT
31145080		1653.75

TERMS: PAYABLE UPON RECEIPT OF INVOICE
 2% INTEREST PER MONTH (24% PER ANNUM) WILL BE CHARGED ON ALL OUTSTANDING AMOUNTS OVER 30 DAYS IF INTEREST IS NOT PAID. FUTURE FLIGHTS WILL BE ON A CASH BASIS.

X [Signature]
 CHARTERER'S SIGNATURE

[Signature]
 PILOT'S SIGNATURE

INITIALS _____ CO-PILOT'S NAME

ENGINEER'S NAME _____

XXX _____ FLIGHT ATTENDANT

WAITING TIME	@	/HR.	
FUEL	@	/LITRE	
FUEL	@	/LITRE	
MEALS & LODGING			
OTHER			
OTHER			

TOTAL \$ 1653.75

THIS IS YOUR ONLY INVOICE — PAY UPON RECEIPT



REMIT PAYMENT TO
TRANS NORTH AIR
 TRANS NORTH TURBO AIR LTD
 BOX 4334 • WHITE HORSE • YUKON TERRITORY • Y1A 3T6
 TELEPHONE (403) 668 2177 • TELEX 036 8 290

ACCOUNT NUMBER	1030
INVOICE NUMBER	75021
INVOICE DATE	210/016/816
A/C TYPE	BOL 206B
AIRCRAFT REGISTRATION C	GML 16
FLIGHT DATE	17/06/86
PURCHASE ORDER NO	Contract

ARCHER CATHRO
 CHARTERER
 BOX 4127
 BILLING ADDRESS
 WHITEHORSE, YUKON

FUEL & OIL X	TNTA FUEL USED	/LITRES	FROM
TNTA	CUST	120	CASINO
X			

FROM	MILES	HOURS	ZONE	REMARKS	NO. OF PASS	FREIGHT Kg
CASINO						
TO IDYHO CREEK				2 PAX + DIESEL		
CASINO		.5				
COCHFELD AREA				2 PAX - STAINL		
CASINO		.7		Nordac		
IDYHO	256	1.5				
NORDAC						
(COCK).	330	1.7				

TOTAL US.

SUB	GL	AMOUNT
3715	5070	567.00

TERMS: PAYABLE UPON RECEIPT OF INVOICE
 2% INTEREST PER MONTH (24% PER ANNUM) WILL BE CHARGED ON ALL OUTSTANDING AMOUNTS OVER 30 DAYS IF INTEREST IS NOT PAID. FUTURE FLIGHTS WILL BE ON A CASH BASIS

x *W. Hallen*
 CHARTERER'S SIGNATURE
 DR *Howe Reid*
 PILOT'S SIGNATURE
 INITIALS CO-PILOT'S NAME
 ENGINEER'S NAME
 XXX *Shap*
 FLIGHT ATTENDANT

WAITING TIME	@	/HR
FUEL:	@	/LITRE
FUEL:	@	/LITRE
MEALS & LODGING		
OTHER		
OTHER		

TOTAL \$ 567.00

THIS IS YOUR ONLY INVOICE — PAY UPON RECEIPT



TRANS NORTH AIR
 TRANSPORT NORTH AIR LTD
 BOX 438 • WHITEHORSE • YUKON TERRITORY • Y1A 3T6
 TELEPHONE (867) 666-2177 TELE FAX 0368-286

ACCOUNT NUMBER	1030
INVOICE NUMBER	75028
INVOICE DATE	012/017/86
A/C TYPE	Bell 206B
AIRCRAFT REGISTRATION C	Gm 1G
FLIGHT DATE	19/06/86
PURCHASE ORDER NO	Continex

CHARTERER ARCTIC CATARE
 BILLING ADDRESS Box 4127
WHITEHORSE, YUKON

FUEL & OIL X	TNTA FUEL USED	LITRES	FROM
TNTA CUST		50	CASINO
X			

FROM	MILES	HOURS	ZONE	REMARKS - NO. OF PASS	FREIGHT Kg
CASINO					
TO COCHFELD AREA				2 Pax, set at 3	
CASINO		.5		P.O.	
<i>Cochfeld</i>					

SUB	G.L.	AMOUNT
3115	5020	236.25

TERMS: PAYABLE UPON RECEIPT OF INVOICE.
 2% INTEREST PER MONTH (24% PER ANNUM) WILL BE CHARGED ON ALL OUTSTANDING AMOUNTS OVER 30 DAYS.
 IF INTEREST IS NOT PAID, FUTURE FLIGHTS WILL BE ON A CASH BASIS.

X *Bill White*
 CHARTERER'S SIGNATURE

DJR
 PILOT'S SIGNATURE

INITIALS *DJR* CO-PILOT'S NAME

ENGINEER'S NAME

Shod.
 FLIGHT ATTENDANT

WAITING TIME	@	/HR.	
FUEL:	@	/LITRE	
FUEL:	@	/LITRE	
MEALS & LODGING			
OTHER			
OTHER			

TOTAL \$ 236.25

THIS IS YOUR ONLY INVOICE — PAY UPON RECEIPT



TRANS NORTH AIR

TRANS NORTH TURBO AIR LTD

Box 4336 • WHITEHORSE • YUKON TERRITORY • Y1A 3T6
TELEPHONE (403) 668-2177 TELEX 036 822

ACCOUNT NUMBER	1030
INVOICE NUMBER	75032
INVOICE DATE	02/07/86
A/C TYPE	Bell 206B
AIRCRAFT REGISTRATION C	GM16
FLIGHT DATE	22/06/86
PURCHASE ORDER NO	Contract

ARCHER CATHRO
CHARTERER

Box 437
BILLING ADDRESS

WHITEHORSE YUKON

FUEL & OIL X	TNTA FUEL USED	LITRES	FROM
TNTA CUST. X		80	CASINO

FROM	MILES	HOURS	ZONE	REMARKS - NO. OF PASS - FREIGHT Kg
CASINO				
TO MT. COCKFIELD AREA				3 PAX
CASINO		0.8		
<i>Cockfield</i>				

SUB	G.L.	AMOUNT
31155020		378.00

0.8 @ 472.50	378.00
@	
@	
@	

TERMS: PAYABLE UPON RECEIPT OF INVOICE.
2% INTEREST PER MONTH (24% PER ANNUM) WILL BE CHARGED ON ALL OUTSTANDING AMOUNTS OVER 30 DAYS. IF INTEREST IS NOT PAID, FUTURE FLIGHTS WILL BE ON A CASH BASIS.

X *Bill Wins*
CHARTERER'S SIGNATURE

DJR *Steve Reed*
PILOT'S SIGNATURE

INITIALS CO-PILOT'S NAME

ENGINEER'S NAME

XXX *Shap*
FLIGHT ATTENDANT

WAITING TIME	@	/HR.
FUEL:	@	/LITRE
FUEL:	@	/LITRE
MEALS & LODGING		
OTHER		
OTHER		

TOTAL \$ 378.00

THIS IS YOUR ONLY INVOICE — PAY UPON RECEIPT



TRANS NORTH AIR

TRANS NORTH TURBO AIR LTD
BOX 4336 • WHITEHORSE • YUKON TERRITORY • Y1A 3T6
TELEPHONE (403) 658-2177 TELEY 036 8276

ACCOUNT NUMBER	1030		
INVOICE NUMBER	75036		
INVOICE DATE	012017		816
A/C TYPE	Bell 206B		
FLIGHT DATE	25	06	86
PURCHASE ORDER NO Contract			

ARCHER CATTRO
CHARTERER
Box 4127
BILLING ADDRESS
WHITEHORSE, YUKON

FUEL & OIL-X	TNTA FUEL USED	FROM
TNTA CUST.		
X	80	CH

FROM	MILES	HOURS	ZONE	REMARKS - NO. OF PASS.	FREIGHT Kg
CASINO				3 PAX	
COCH FIELD ARCO					
CASINO		0.8			
<i>Cochfield</i>					

SUB	G.L.	AMOUNT
31155020		378.00

TERMS: PAYABLE UPON RECEIPT OF INVOICE.
2% INTEREST PER MONTH (24% PER ANNUM) WILL BE CHARGED ON ALL OUTSTANDING AMOUNTS OVER 30 DAYS IF INTEREST IS NOT PAID, FUTURE FLIGHTS WILL BE ON A CASH BASIS.

x *Bill Wine*
CHARTERER'S SIGNATURE

DR *Have used*
INITIALS PILOT'S SIGNATURE

CO-PILOT'S NAME

ENGINEER'S NAME
Shop

FLIGHT ATTENDANT

WAITING TIME	@	/HR	
FUEL:	@	/LITRE	-
FUEL:	@	/LITRE	
MEALS & LODGING			
OTHER			
OTHER			

TOTAL \$ 378.00

THIS IS YOUR ONLY INVOICE — PAY UPON RECEIPT

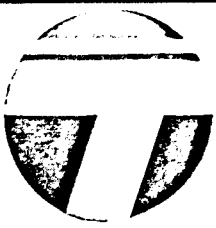

TRANS NORTH AIR

TRANS NORTH TURBO AIR LTD.

BOX 4338 • WHITEHORSE • YUKON TERRITORY • Y1A 3T6
TELEPHONE: (403) 668-2177 TELEX: 036-8-290

TO: Γ

ARCHER, CATHRO & ASSOC.
Box 4127
Whitehorse, YT
Y1A 3S9

DATE	July 02, 1986	INVOICE NO.	117-6
P.O. NO.	Casino Contract	ACCOUNT NO.	1030

TO: Charge you for the following

RE: Unflown minimums under terms of contract for the period May 31 to July 01, 1986, as per agreement with R.F. Connelly

32 days @ 2.0 hours/day minimum	64.0
Less: Actual hours flown	59.1
	<hr/>
Total unflown minimums	4.9 Hrs

4.9 Hours @ \$472.50/Hour = \$2315.25

INVOICE TOTAL	ALL-NORTH	\$2315.25
	7.5 - 6.2 = 1.3 hr	614.25

Corshfield - 327.44
Anna - 77.96
Dolan - 114.25

NORTH	7.5 - 6.4 = 1.1 hr	519.75
SG (I)	= 2.15 hr	1181.25
		<hr/>

paid July 11/86 #061

Air North Charter and Training Ltd.

24 Hour Telephone Service 668-2228
Box 4998, Whitehorse, Yukon, Y1A 4S2

PHONE 668-2228

AIRCRAFT CHARTER

INVOICE 5160

DATE 21 June 1986

Archer Cathro & Associates
Box #4127
Whitehorse, Yukon

DESCRIPTION	AMOUNT	
Re: Charter Beech 18		
Pilot: Sparling		
Flying: 380 miles @ \$2.35/mile	893	00
Fuel: 92 gals @ \$2.85/gal	262	20
<i>Cockfield</i>		
Total	<u>\$1155</u>	<u>20</u>
<i>pd June 26/86</i>		
<i>#047</i>		

A SERVICE CHARGE OF 2 PER CENT PER MONTH ADDED TO ACCOUNTS OVER 30 DAYS

Air North Charter and Training Ltd.

24 Hour Telephone Service 668-2228
Box 4998, Whitehorse, Yukon, Y1A 4S2

PHONE 668-2228

AIRCRAFT CHARTER

INVOICE 5513

DATE 1 July 1986

Archer Cathro
Box#4127
Whitehorse, Yukon

DESCRIPTION	AMOUNT	
Re: Charter Beech 18		
Pilot: Bergren		
Flying: 760 miles @ \$2.35/mile	1786	00
Fuel: 184 gals \$2.85/gal	524	40
<i>Archer - 231.04</i>		
<i>Ikaho - 1039.68</i>		
<i>Cochfield - 1039.68</i>		
Total	\$2310	40

A SERVICE CHARGE OF 2 PER CENT PER MONTH ADDED TO ACCOUNTS OVER 30 DAYS

Total - 2774.49
paid July 11/86
#061