

CASSIAR CREEK PROJECT
(RAIL CLAIMS)

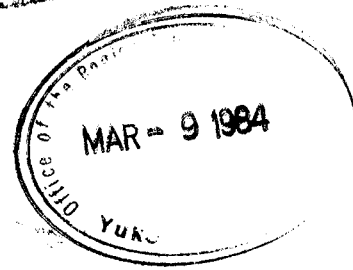

1983 REPORT ON LINE-CUTTING,
TRENCHING AND DRILL DEMOBILIZATION

DAWSON MINING DISTRICT

NTS: 116 C/8

LATITUDE: $64^{\circ}23'N$
LONGITUDE: $140^{\circ}10'W$

OWNER: NORANDA EXPLORATION COMPANY, LTD. (N.P.L.)

AUTHOR: John Biczok, H.B.Sc



091521

This report has been examined by
the Geological Evaluation Unit
under Section 53 (4) Yukon Quartz
Mining Act and is allowed as
representation work in the amount
of \$ 3200.00.

for *K. Grapes*
Regional Manager, Exploration and
Geological Services for Commissioner
of Yukon Territory.

TABLE OF CONTENTS

| | Page |
|--|------|
| CHAPTER ONE: | |
| 1-1: Introduction | 1 |
| 1-2: Location and Access | 1 |
| | |
| CHAPTER TWO: WORK PROGRAM | |
| 2-1: Line-Cutting | 1 |
| 2-2: Trenching | 5 |
| 2-3: Demobilization of Drill Equipment | 5 |
| | |
| Statement of Costs | 6 |
| Statement of Qualifications | 7 |

LIST OF FIGURES

| Figure | Page |
|--|------|
| 1: Location Map | 2 |
| 2: Boundary of Claim Group with Grid Lines | 3 |
| 3: Claim Map with Grid B | 4 |

CHAPTER ONE:

1-1: Introduction

During the summer of 1983, several types of physical exploration work were carried out on Noranda's RAIL claims. These included 156 km of linecutting, excavation of two trenches and the demobilization of drill equipment which was left on the property following the 1982 drilling program. These work types are briefly described in the following sections.

1-2: Location and Access

The property currently consists of 103 claims 56 km northwest of Dawson City, Yukon at $64^{\circ}23'N$, $140^{\circ}10'W$ (Fig. 1). They are situated on NTS mapsheet 116 C/8 within the Dawson Mining District.

Access to the property has been largely via helicopter from Dawson City. Heavy equipment has also been transported to the claims by barge along the Yukon River.

CHAPTER TWO: WORK PROGRAM

2-1: Line-Cutting

In preparation for a detailed magnetometer survey and follow-up trenching, a flagged grid was established by a contract crew from M.Barker Surveys of Whitehorse, Y.T. The lines were established through a chain and compass procedure and flagged at 25 m intervals. The majority of the lines are within the area of "GRID B" which is depicted in Figure 2. They are situated on the following claims: RAIL 9-20, 22, 24, 35-38, 40-44, 46, 48, 79-85 (Fig. 2).

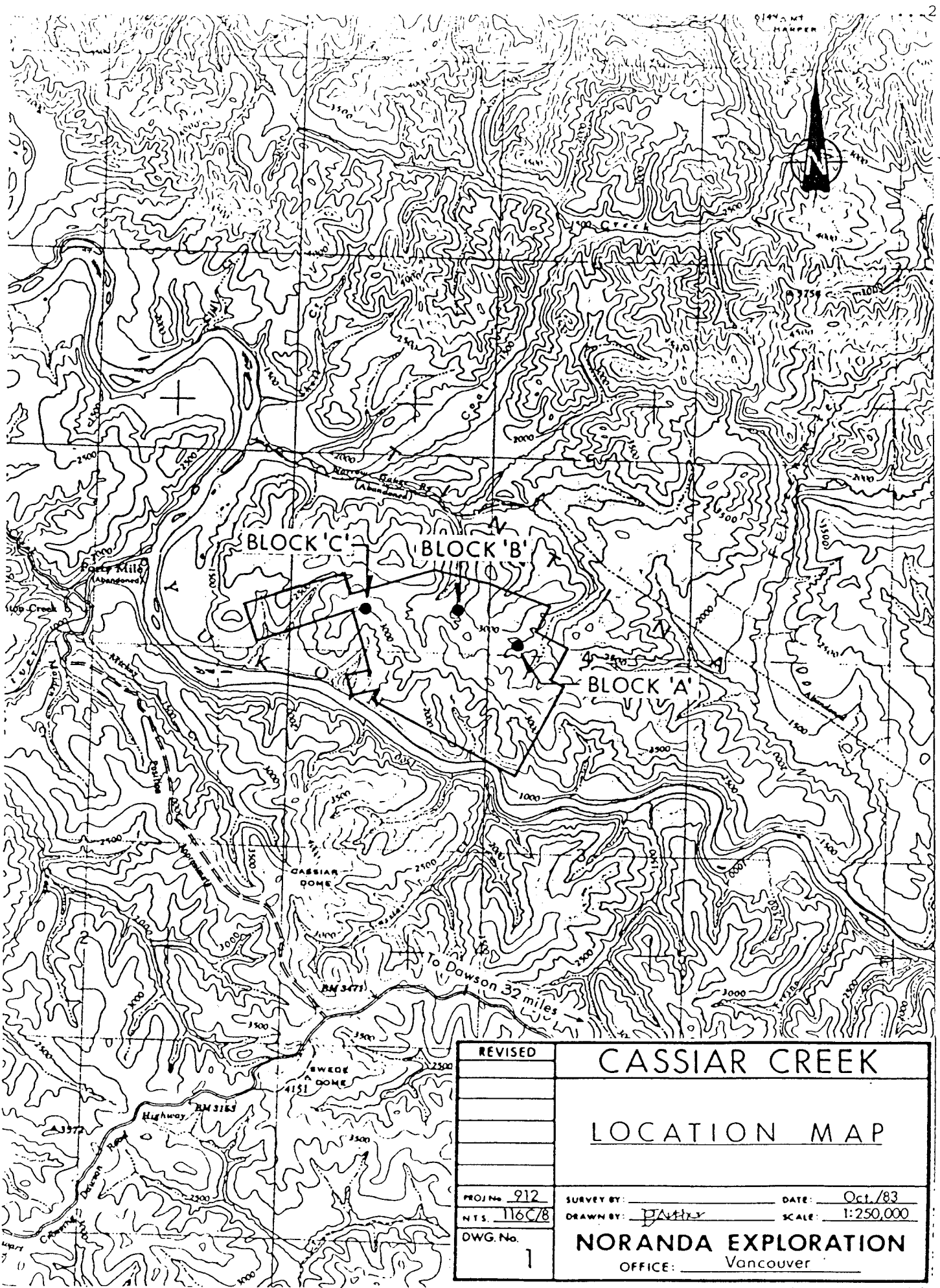

| | | |
|---------------|----------------------------|------------------|
| REVISED | CASSIAR CREEK | |
| | LOCATION MAP | |
| PROJ. No. 912 | SURVEY BY: _____ | DATE: Oct./83 |
| NTS. 116C/8 | DRAWN BY: <i>Patry</i> | SCALE: 1:250,000 |
| DWG. No. 1 | NORANDA EXPLORATION | |
| | OFFICE: Vancouver | |

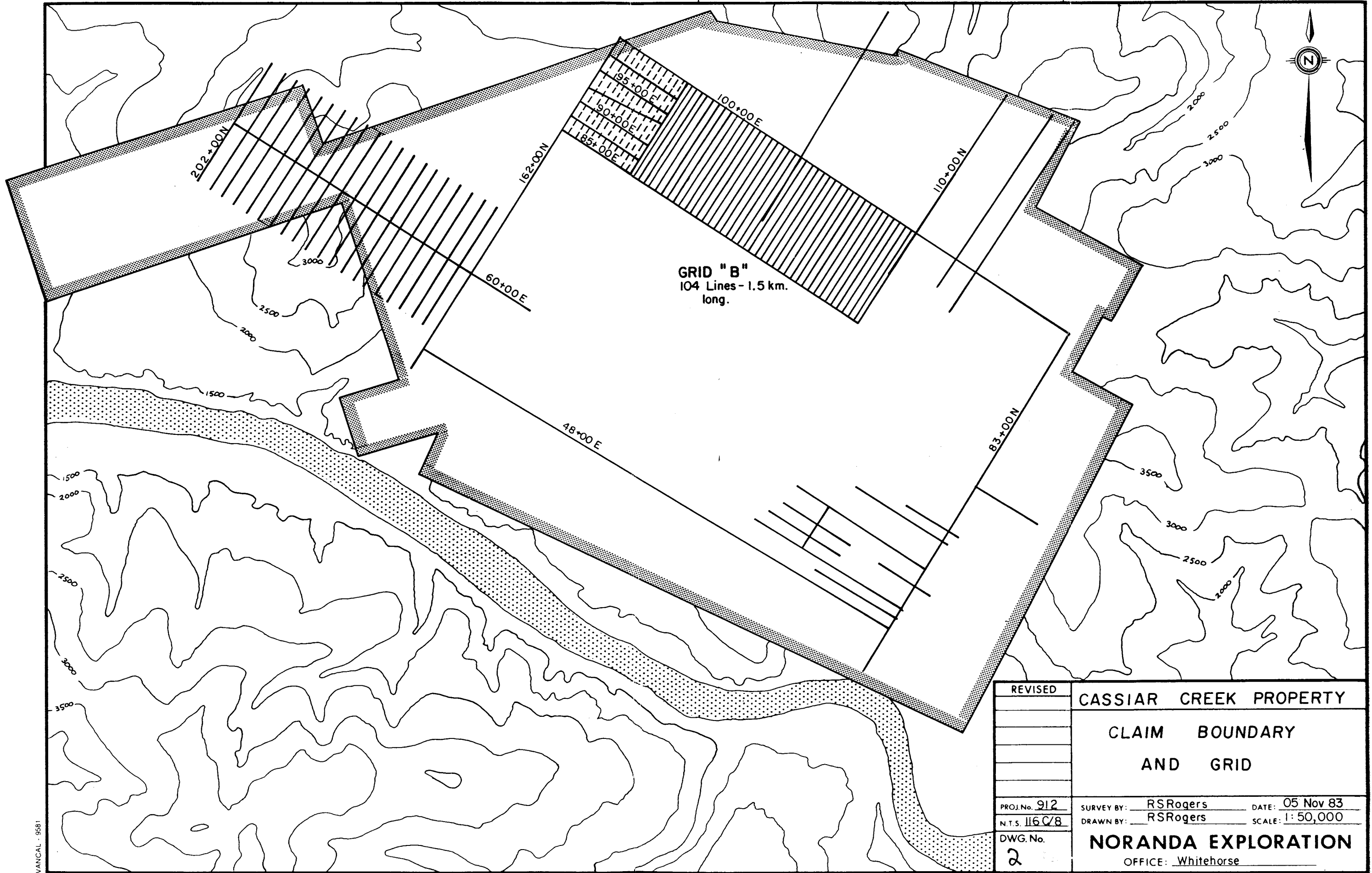

GRID "B"
 104 Lines - 1.5 km.
 long.

| | | |
|-----------------|----------------------------|------------------|
| REVISED | CASSIAR CREEK PROPERTY | |
| | CLAIM BOUNDARY | |
| | AND GRID | |
| PROJ. No. 912 | SURVEY BY: RSRogers | DATE: 05 Nov 83 |
| N.T.S. 1:16 C/8 | DRAWN BY: RSRogers | SCALE: 1: 50,000 |
| DWG. No. | NORANDA EXPLORATION | |
| 2 | OFFICE: Whitehorse | |

VANICAL - 9581

FIG. 3: CLAIM MAP WITH GRID B



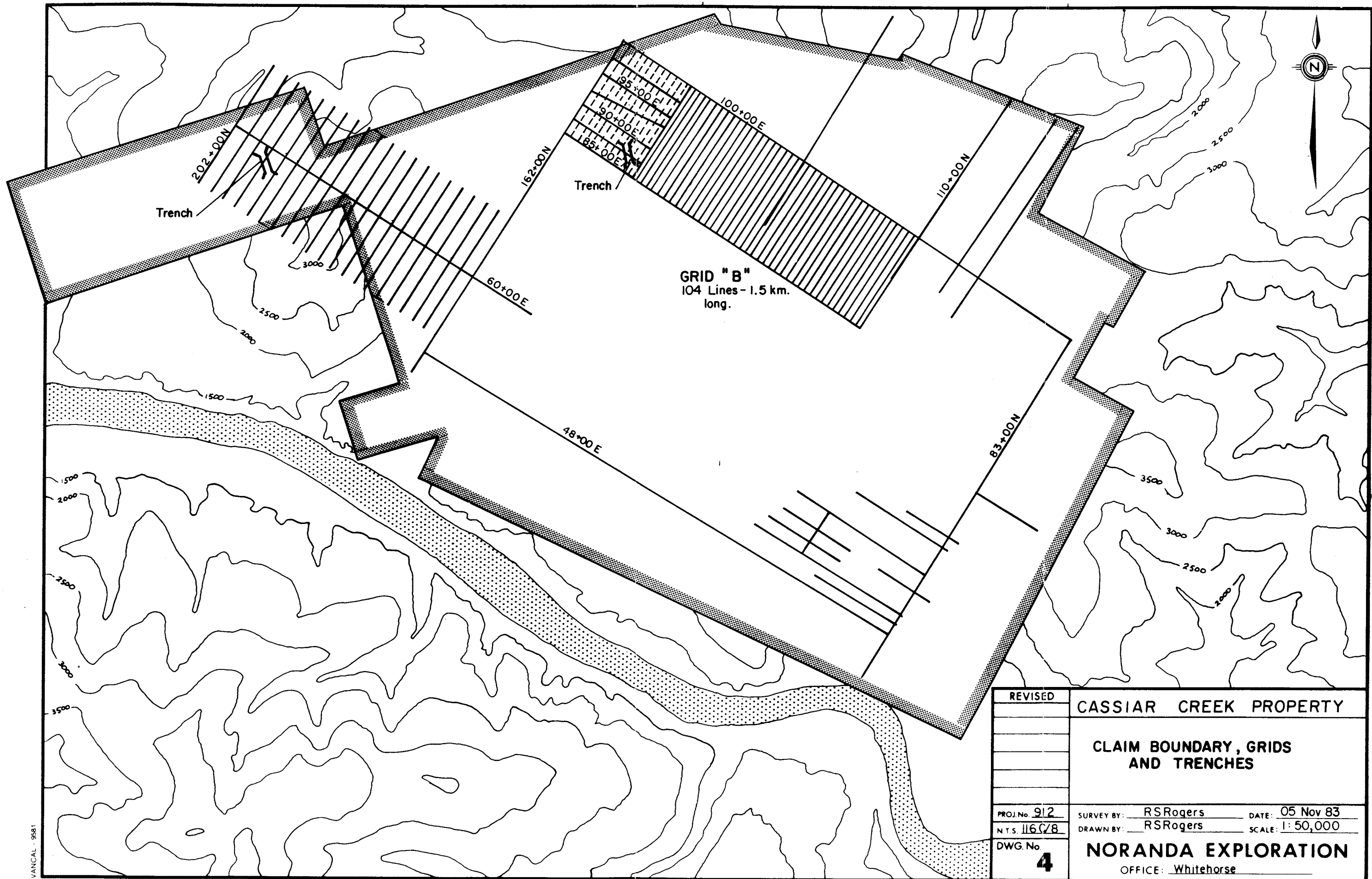

| | | |
|----------------|------------------------------------|-----------------|
| REVISED | CASSIAR CREEK PROPERTY | |
| | CLAIM BOUNDARY, GRIDS AND TRENCHES | |
| PROJ. No. 912 | SURVEY BY: RSRogers | DATE: 05 Nov 83 |
| N.T.S. 1:16078 | DRAWN BY: RSRogers | SCALE: 1:50,000 |
| DWG. No. 4 | NORANDA EXPLORATION | |
| | OFFICE: Whitehorse | |

VAN CAL 9581

091521

P.J.A.

2-2: Trenching

Upon completion of the detailed magnetometer survey, several soil trenches were excavated by hand and blasting. These trenches are in the vicinity of L151 + 00N, 88 + 75E and are generally 2-3 m long and 1-2 m wide. They were completed to depths of 1-2 m but did not reach bedrock. Panning of the soil in the trench bottoms invariably revealed significant quantities of scheelite, apparently developed within the local quartzite and limestone adjacent to porphyry dykes.

2-3: Demobilization of Drill Equipment

In 1982, 2360 feet of BQ diamond drilling was completed on the RAIL claims (principally no. 1,2,4) for the company by E. Caron Diamond Drilling. Approximately 2000 ft. of rods and some other miscellaneous equipment was left on the property until 1983. This was slung off the property in late August using a Hughes 500D chartered from Trans North Turbo Air in Dawson City. The equipment was flown south from the property, across the Yukon River, to an abandoned open pit at the old Clinton Creek asbestos mine. A total of 3.7 hours of helicopter time was utilized in this operation.

Respectfully Submitted

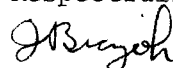

J. Biczok

District Geologist

1983
RAIL CLAIMS

STATEMENT OF COSTS

TRENCHING

| | |
|-------------------------|-----------|
| Blasting Supplies | \$ 327.94 |
| Wages: 4 days X 150/day | 600.00 |

LINECUTTING (156 km)

| | |
|--|----------|
| Contractor Fees (MBW Surveys) | 3,900.00 |
| Camp Supplies: \$20/manday X 24 mandays | 480.00 |
| Helicopter Charges: 3.0 hrs. X \$500/hr. | 1,500.00 |

DEMobilIZATION OF DRILL EQUIPMENT

| | |
|-------------------------------------|----------|
| Helicopter Charges (3.7 hrs.) | 2,069.34 |
| Loading Equipment (Contractor Fees) | 536.00 |

| | |
|--------|-------------------|
| TOTAL: | <u>\$9,413.28</u> |
|--------|-------------------|

STATEMENT OF QUALIFICATIONS

I, John Biczok, of the City of Whitehorse, in the Yukon Territory, do hereby certify :

THAT I have been employed as a Geologist by Noranda Exploration Company, Limited (No Personal Liability) since October 1, 1982, and by Mattagami Lake Exploration Limited (No Personal Liability) (a Noranda subsidiary) for three years previous to that date;

THAT I am a graduate of Lakehead University in Thunder Bay, Ontario, with an Honours Bachelor of Science Degree in Geology;

THAT I am currently completing a Master of Science Degree in Geology with the University of Manitoba;

THAT I am a member of the Geological Association of Canada, and the Canadian Institute of Mining and Metallurgy;

THAT I supervised the work described in this report.

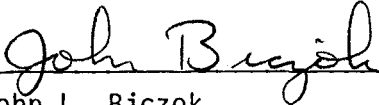

John L. Biczok
District Geologist
Noranda Exploration Co. Ltd. (N.P.L.)