



P. O. Box 269
Watson Lake, Yukon
YOA 1C0

15 October 1982

Your file Votre référence

Our file Notre référence

*Jo Anne
ENTRY TO
Geology*

REGIONAL DIRECTOR RESOURCES

Attention: Supervising Mining Recorder

MICROFILMED

DATE Jan 1984 Indexed

RESTRICTED

Enclosed for your files are drill logs submitted by Pamicon Developments Ltd. for assessment on the CMC Mineral Claims on Map 105-B-7.

CMC 82-1	68.3 m.
CMC 82-2	128.3 m.

Assessment credit requested: \$2,400.00

Drill core is being stored on the property.

Yours truly,

Patti L. McLeod
Mining Recorder
Watson Lake Mining District

pj
encl.
cc; Regional Geologist

091379

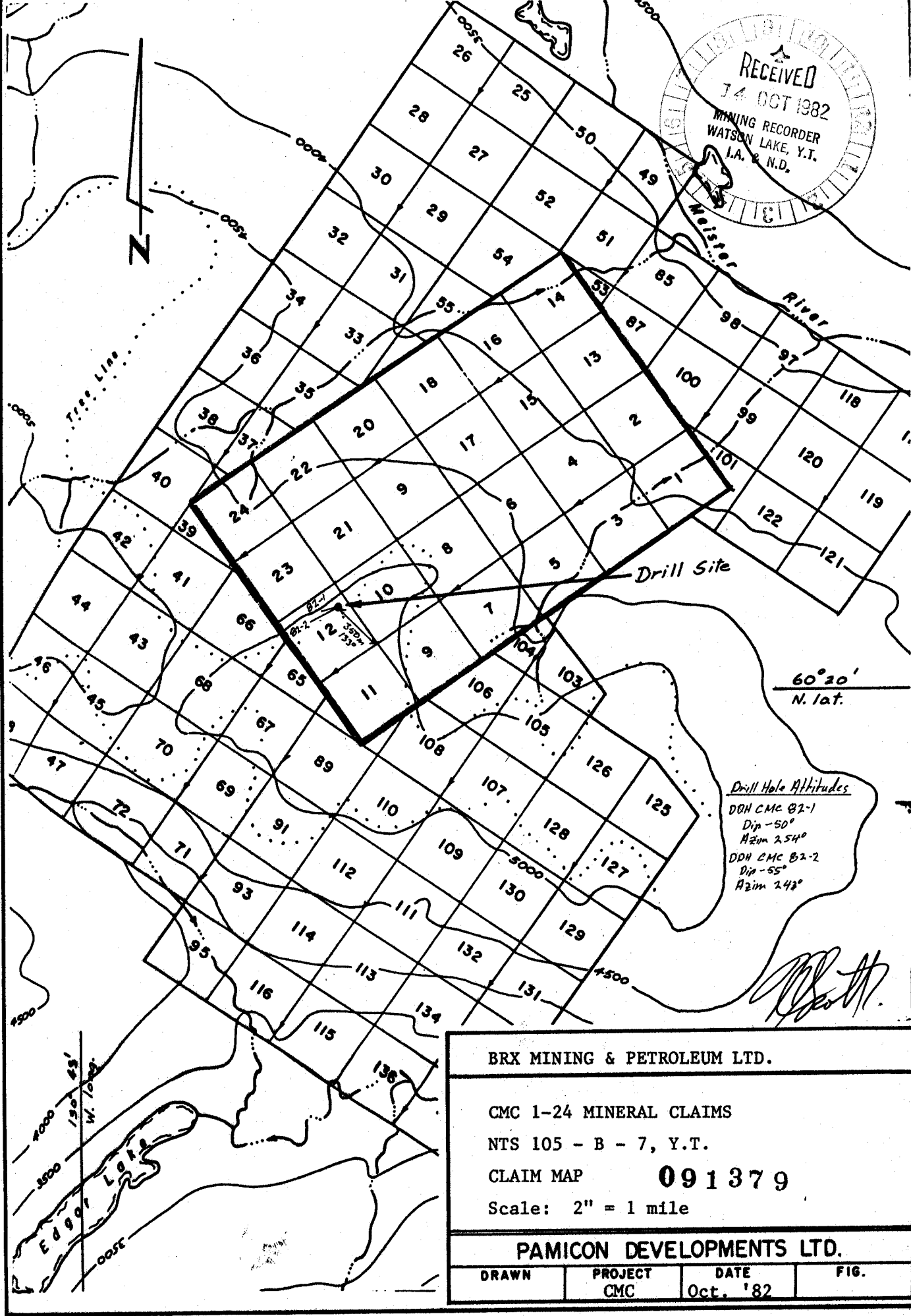
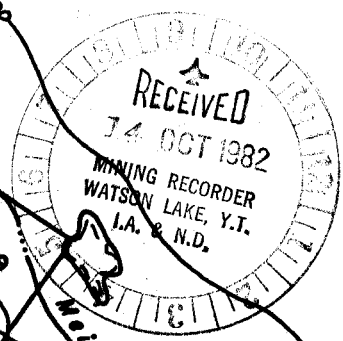

60°20'
N. lat.

Drill Hole Attitudes
DDH CMC B2-1
Dip -50°
Azim 254°
DDH CMC B2-2
Dip -55°
Azim 243°

BRX MINING & PETROLEUM LTD.

CMC 1-24 MINERAL CLAIMS

NTS 105 - B - 7, Y.T.

CLAIM MAP **091379**

Scale: 2" = 1 mile

PAMICON DEVELOPMENTS LTD.

DRAWN	PROJECT	DATE	FIG.
	CMC	Oct. '82	

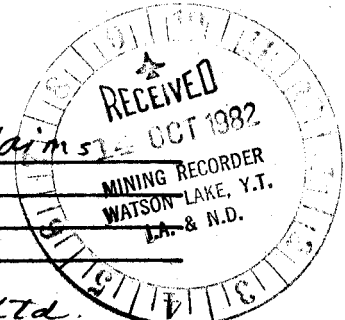

CANADA) In the matter of CMC 1-24 Mineral Claims
) YA 56628 - YA 56651
)
)

TO WIT) On behalf of BRX Mining and Petroleum Ltd.

I, T. Cameron Scott for Pamicon Developments Ltd., of 208,
850 West Hastings Street, Vancouver, B.C. do solemnly declare that the
diamond drilling program was carried out from
July 20, 1982 - Aug. 1, 1982

The following expenses were incurred during the course of this work and in the compilation and reporting of the results:

Equipment Rentals	\$	_____
Expendible Field Supplies		_____
Office Supplies, Maps, Photos		_____
Drafting and Reproduction		_____
Equipment and Machinery		_____
Supplies		_____
Food		_____
Expediting		_____
Freight		_____
Travel and Accommodation		_____
Prepaid Expenses		_____
Sundry		_____
Camp and Miscellaneous Fuels		_____
Camp Fixed Wing Support		_____
Overhead		_____
Wages		_____
Helicopter Support		_____
Assaying and Geochemistry		_____
Trenching		_____
Contracting Fees - <u>Diamond drilling</u>	\$	<u>22,100.86</u>
Report Preparation		_____
Not Assigned		_____
TOTAL	\$	<u>22,100.86</u>

And I make this solemn declaration conscientiously believing it to be true and knowing that it is of the same force and effect as if made under oath and by virtue of the Canada Evidence Act.

Declared before me at Vancouver in)
the Province of British Columbia this)
8th day of October, 1982)

John Cutler

A Commissioner for Oaths for,
or Notary Public for the Yukon Territory

BBS DIAMOND DRILLING
13 Aspen Drive, Whitehorse, Yukon.
(403) 633-2633

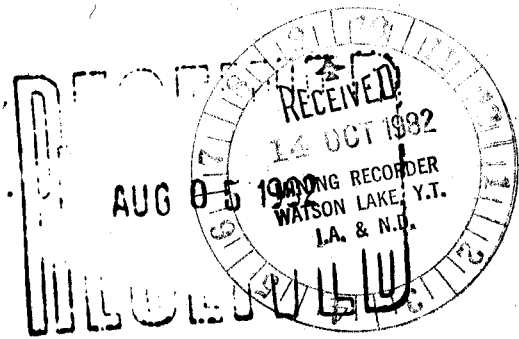

STATEMENT OF FIELD COSTS AND DIAMOND DRILLING

For: BRX Mining & Petroleum Ltd.,
120-800 West Pender Street,
Vancouver, B.C.
V6C 2V6

2 August 1982

Period: 20 July - 1 August 1982

1)	Drilling of CMC 82-1 and 82-2: total 724' @ \$ 24/ft.	=	\$17,376.00
2)	Field cost: mobilization and demobilization, moving, setting up, and standby: total 156 man hours @ \$20/hr.	=	3,120.00
3)	Drill rental: 23 hours @ \$14/hr.	=	322.00
4)	30 core boxes @ \$7.50/box	=	225.00
5)	Truck transport of equipment and supplies	=	1,057.86
	TOTAL	=	\$22,100.86
			=====

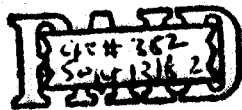

placed on A/C.

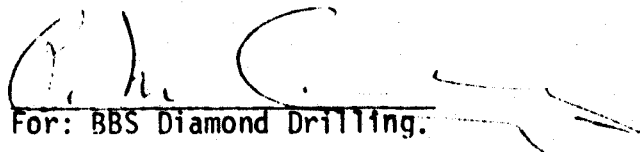
For: BBS Diamond Drilling.

BRX CMC

1982

LOG: DDH CMC-82-1

Dip -50°, Azim 254°

Location: 368.8 m @ 30° to No. 1 Post CMC 12

Logged by: T. Cameron Scott, Pamicon Developments Ltd., August 6, 1982

COMPANY BRX Mining and Petroleum Ltd.

1020, 800 West Pender Street

Vancouver, B.C. V6C 2V6

Property: CMC Claims

Watson Lake MD

Yukon

	m From	m To	Length	Rec. %	Rock type				
	0.0	4.6			Overburden				
	4.6	13.4			Micaceous quartzite, foliation 80°/c.a.				
	13.4	17.0			Coarse garnet-diopside skarn				
	17.0	37.0			Micaceous limey quartzite - minor garnet - foliation 60°/c.a.				
	37.0	38.7			Garnet diopside skarn				
	38.7	39.0			Manganiferous limonitic wad - breccia - looks like weathered skarn				
	39.0	41.7			Skarnified micaceous quartzite - foliation 50°/c.a.				
	41.7	43.3			Gouge and quartzite - trace py in white quartz breccia fragments at 43.3 m				
	43.3	45.3			Manganiferous limonitic wad - breccia with quartz-carbonate stringers, no sulphides				
	45.3	52.5			Altered breccia - crushed - 1 to 3 mm fragments in light brown to buff, limey matrix, no sulphides				

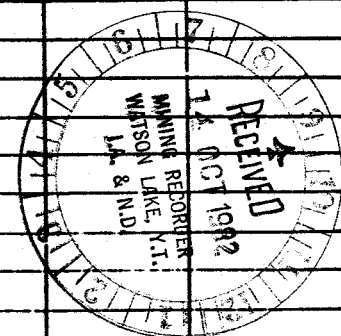

T. Cameron Scott

DATE: 8 Oct. 1982

HOLE No. CMC-82-1

Page 1 of 2

LOG: DDH CMC-82-1

(Continued)

COMPANY _____

Property : _____

	^m From	^m To	Length	Rec. %	Rock type				
	52.5	68.3			Micaceous quartzite - crushed - foliation 60°/c.a. - occasional pyrite stringer parallel to foliation - white clay alteration				
	END OF HOLE								
					Note: No samples were submitted for assay because of lack of significant sulphide mineralization				
					- Drill core stored on site				
					Abbreviations: py - pyrite c.a. - core axis				

R. Smith

DATE : 8 Oct. 1982

HOLE No. CMC-82-1

Page 2 of 2

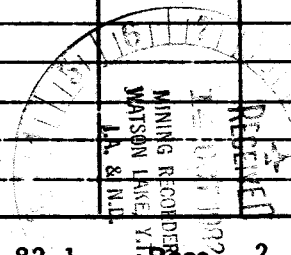

LOG : DDH CMC-82-2

Dip -55°, Azim 254°

COMPANY BRX Mining and Petroleum Ltd.

1020, 800 West Pender Street

Vancouver, B.C. V6C 2V6

Property : CMC Claims
Watson Lake MD
Yukon

Location: 341 m @ 136° to No. 1 Post CMC 12

Logged by: T. Cameron Scott, Pamicon Developments Ltd., August 6, 1982

From	To	Length	Rec. %	Rock type				
0.0	13.7			Garnet diopside skarn - foliation 80°c.a.				
13.7	16.2			Manganiferous limonitic wad - breccia - vuggy quartz-carbonate stringers parallel to c.a. - trace galena				Note: No samples were taken for assay because of ^{lack of} significant sulphide mineralization
16.2	24.4			Garnet diopside skarn				
24.4	32.2			Weathered skarn - minor wad - foliation 70°/c.a.				Drill core stored on site
32.2	49.3			Limey quartzite - white - trace galena at 43.6 m on fractures at 45°/c.a.				
49.3	86.9			As above with numerous small breccia zones containing traces of pyrite and galena - carbonate filled breccia from 82.9 m to 84.1 m				
86.9	128.3			Interbedded limey and micaceous quartzite - in part skarnified - traces of pyrite and galena on occasional fracture and in open spaces - 113.0 m - trace molybdenite with pyrite on fracture 30°/c.a.				

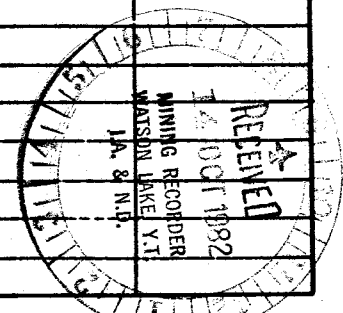

T. Cameron Scott

DATE : 8 Oct. 1982

HOLE No. CMC-82-2

Page 1 of 1