

**WELCOME NORTH MINES LTD. (N.P.L.)**  
1027 - 470 Granville St., Vancouver, B.C. V6C 1V5 Telephone (604) 687-1658

DD-167

VANGORDA PROJECT

LINECUTTING REPORT

ON THE

ALICE 1 - 48 CLAIM GROUP

N.T.S. 105K-5

WHITEHORSE MINING DISTRICT

YUKON TERRITORY

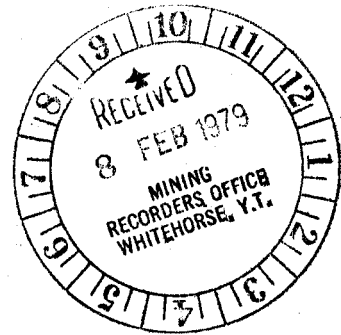

Latitude 62°24'N

Longitude 133°39'W

Work Performed During the Period July 25 to August 10, 1978

Vancouver, BC  
January 23, 1979

H.F. Foster

091231

## TABLE OF CONTENTS

|   | Page |
|---|------|
| PROJECT AREA LOCATION MAP                   |      |
| INTRODUCTION                                | 1    |
| MINERAL CLAIMS                              | 1    |
| LOCATION AND ACCESS                         | 4    |
| APPENDICES                                  |      |
| I.    STATEMENT OF COSTS                    |      |
| II.   AFFIDAVIT SUPPORTING SUMMARY OF COSTS |      |
| LIST OF FIGURES                             |      |
| 1.    PROPERTY LOCATION MAP                 | 2    |
| 2.    LINECUTTING MAP                       | 3    |

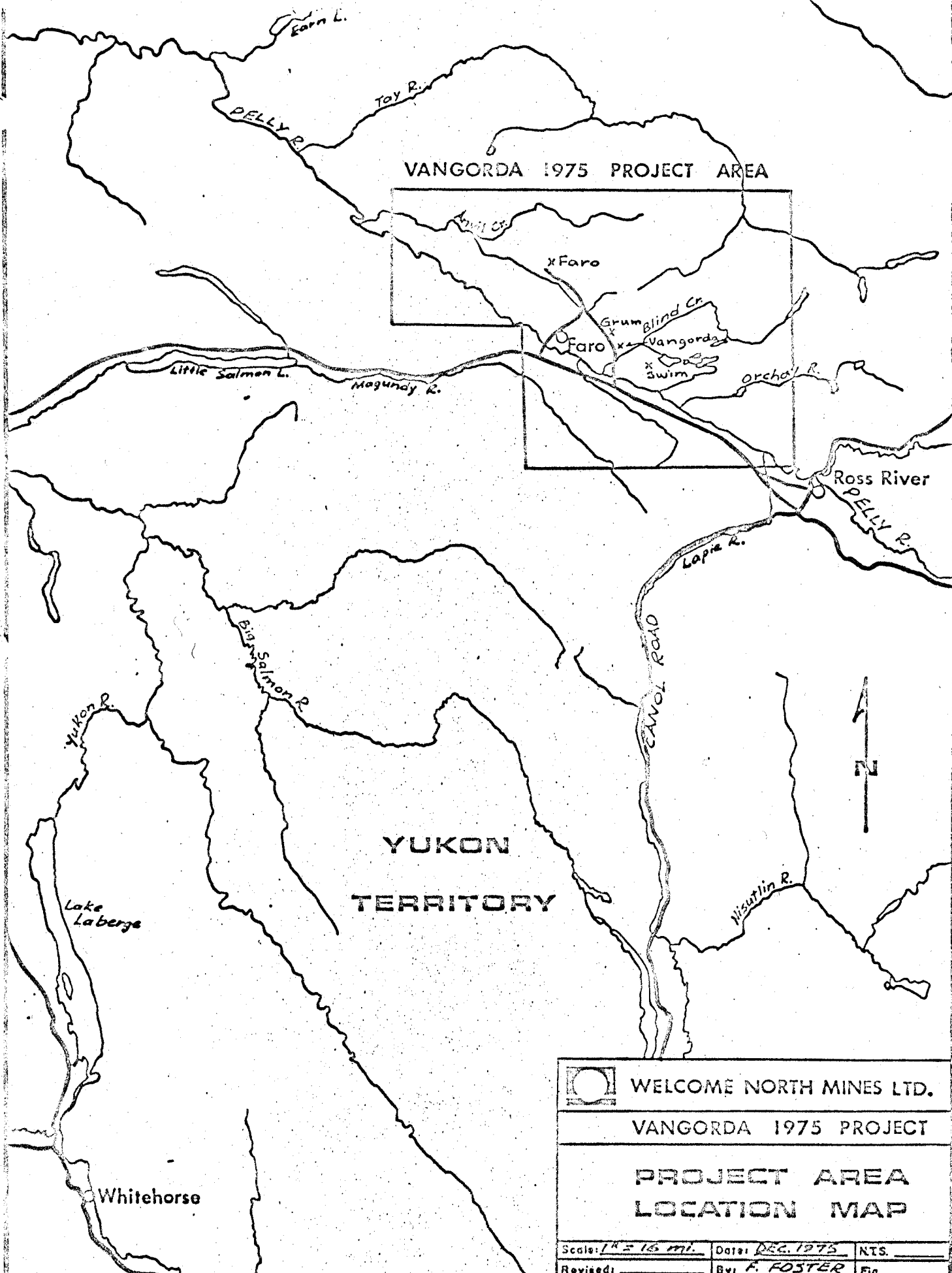

**YUKON  
TERRITORY**

**VANGORDA 1975 PROJECT AREA**

|   |                          |      |  |
|---|--------------------------|------|--|
|  | WELCOME NORTH MINES LTD. |      |  |
|   | VANGORDA 1975 PROJECT    |      |  |
| <b>PROJECT AREA<br/>LOCATION MAP</b>  |                          |      |  |
| Scale: 1" = 16 mi.  | Date: DEC. 1975          | NTS. |  |
| Revised:  | By: F. FOSTER            | Fig. |  |

INTRODUCTION

The ALICE 1-30 claims were staked by Welcome North Mines in February, 1975, and the ALICE 31-48 claims were later tied on in April, 1975. The property was located over what was considered to be a favourable geologic environment for Anvil-Vangorda type massive sulphide deposits.

The ALICE claims were subsequently joint ventured to Getty Mining Pacific Ltd. in March, 1975 as part of the Vangorda 1975 Project. Under the joint venture agreement, Getty Mining Pacific currently holds a 60 percent working interest in the property, with Welcome North as partner with a 40 percent carried interest.

Welcome North, as operator, during the period carried out 22 kilometers of linecutting which consisted of brushing out and repicketing in slope-corrected metric a previously installed grid. Pickets were established at 50-meter intervals on cross lines spaced 240 meters apart. The work was carried out by McCrory Holdings Ltd. from Whitehorse, Yukon.

MINERAL CLAIMS

The ALICE 1-48 claim group consists of the following 48 contiguous mineral claims located in the Whitehorse Mining District of the Yukon Territory (Fig. 1):

| <u>CLAIMS</u> | <u>GRANT NUMBERS</u> | <u>RECORDING DATE</u> |
|---------------|----------------------|-----------------------|
| ALICE 1-28    | Y92118-Y92145        | Feb. 13, 1975         |
| ALICE 29-30   | Y92401-Y92402        | Feb. 13, 1975         |
| ALICE 31-48   | Y93353-Y93370        | April 7, 1975         |



WELCOME NORTH MINES LTD.

VANGORDA 1975 PROJECT

PROPERTY LOCATION MAP

ALICE CLAIMS 1 - 48

|                   |               |           |
|-------------------|---------------|-----------|
| Scale 1" = 10 mi. | Date DEC 1975 | NTS 1054  |
| Revised _____     | By: L. FOSTER | Pl. _____ |

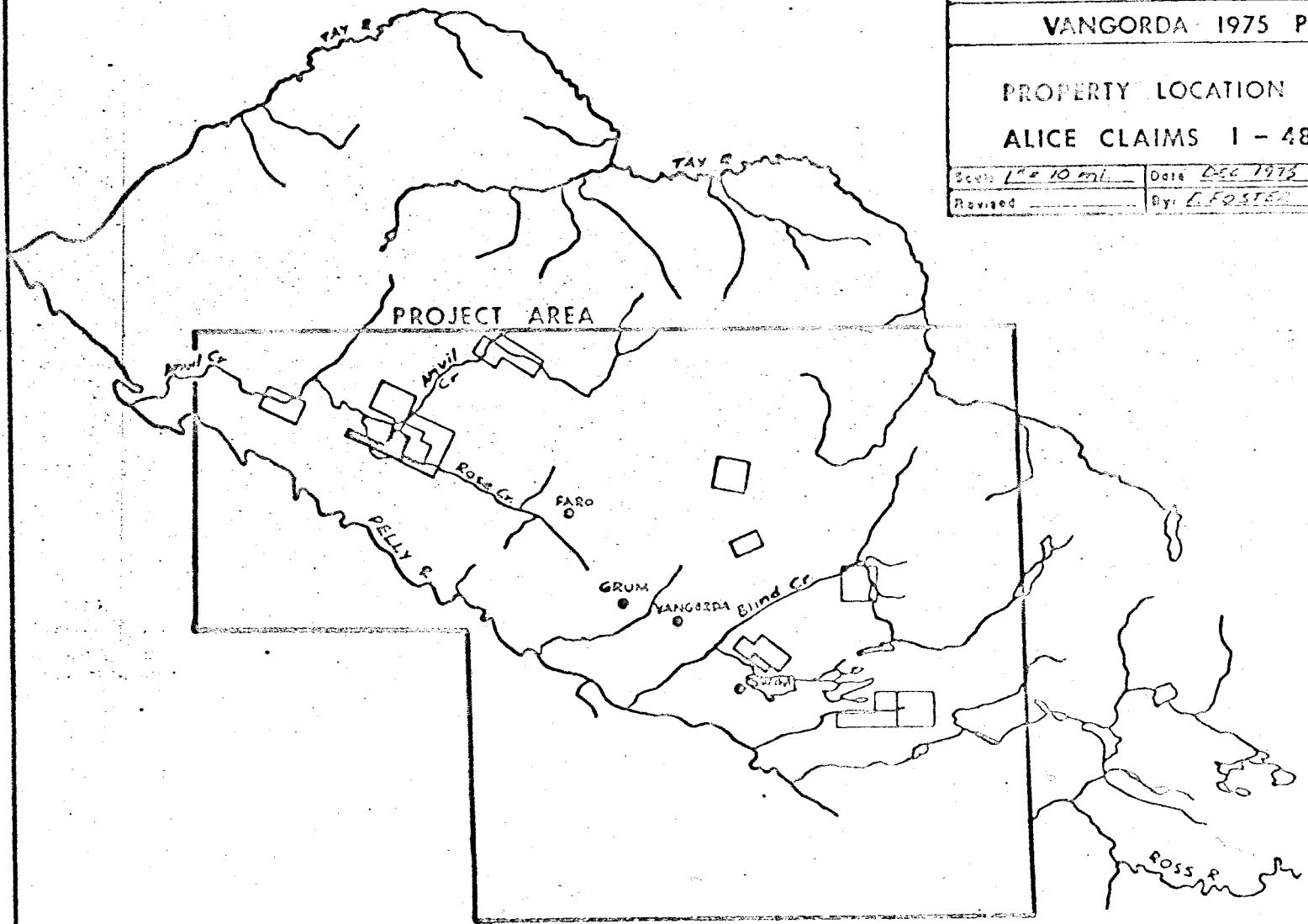

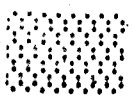
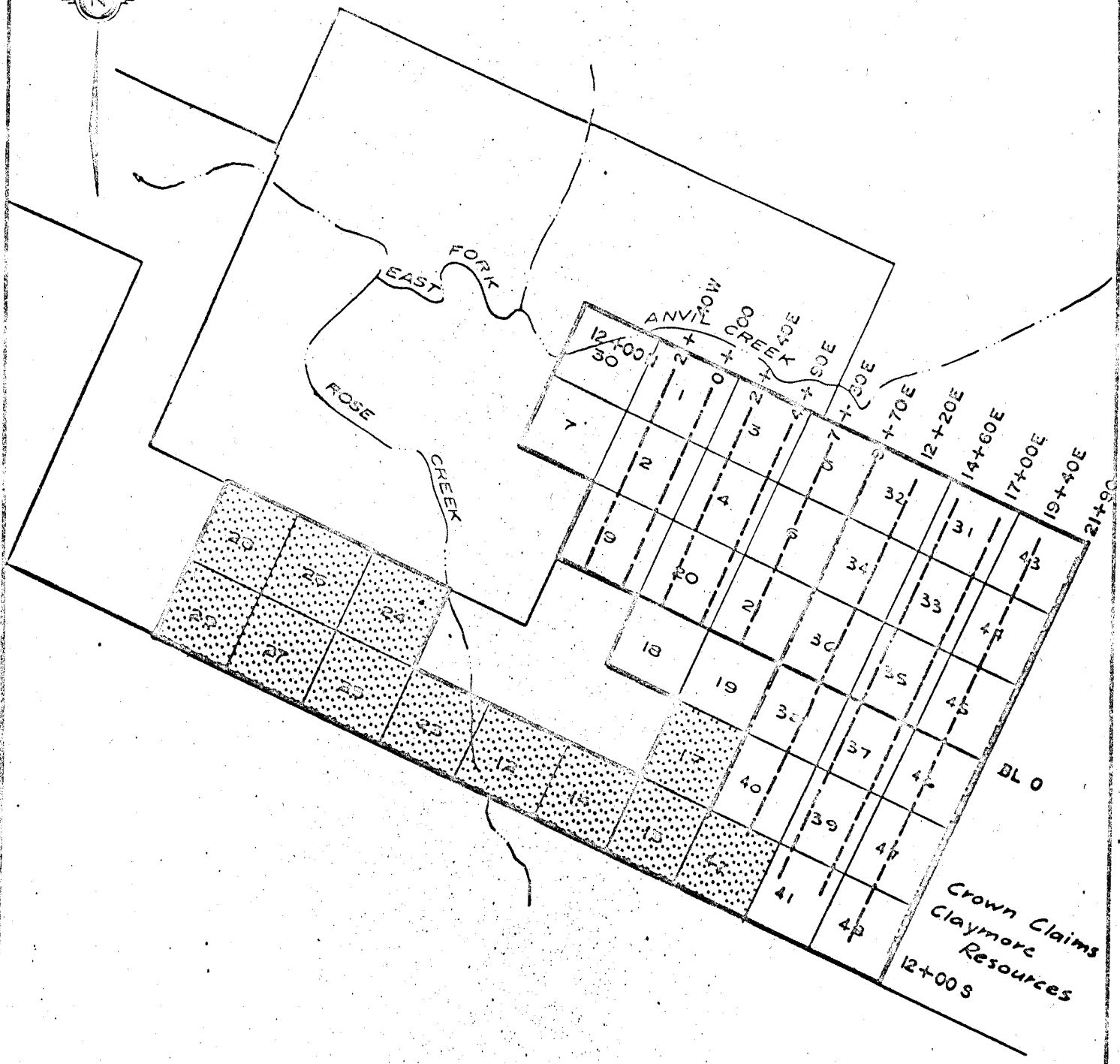

PROPOSED TO LET LAPSE

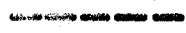

RE-PICKETED LINES

|   |                 |              |
|---|-----------------|--------------|
|  <b>WELCOME NORTH MINES LTD.</b> |                 |              |
| <b>GETTY MINING PACIFIC LTD.</b>  |                 |              |
| <b>VANGORDA PROJECT</b><br><b>ALICE 1-48 CLAIMS</b><br><b>LINE CUTTING MAP</b>                                      |                 |              |
| Scale: 1" = 1/2 MILES   | Date: NOV. 1978 | INT. 103 K/3 |
| Revised:  | By: J. Holland  | Fig. 2       |

LOCATION AND ACCESS

The ALICE 1-48 claims are located in the Whitehorse Mining District of the Yukon Territory (N.T.S. 105K-5) at latitude  $62^{\circ}24'N$ , and longitude  $133^{\circ}39'W$ , 125 miles northeast of Whitehorse, Yukon Territory and 14 miles northwest of the town of Faro, Yukon Territory (Fig. 2).

Access to the property can best be gained by helicopter from Faro or by one cat trail from the Anvil mine site situated 7 miles east of the property in Rose Creek valley. This ground access route is serviceable only by tracked vehicle or trail bike. The route traverses the northeast slope of Rose Creek valley and ends above treeline one mile east of the property. A cat trail in much poorer condition provides access to the eastern portion of the property from the end of the more serviceable cat trail.

The property is located at the junction of Rose Creek and Anvil Creek at an elevation of 4,500 feet on a small peak which terminates a broad southwest trending ridge that divides Anvil Creek valley to the north from Rose Creek valley to the south. Most of the property lies below treeline except for a small portion on the eastern reaches of the property which is at treeline and vegetated with buck brush.

Outcrop is found on the moderate to steep sloping flanks of the ridge and peak which occupy the southeastern portion of the property. The northwestern portion of the property, in the bottom of Anvil Creek valley, is covered by thick (100 feet) overburden and muskeg and little or no outcrop is exposed.

APPENDIX I

STATEMENT OF COSTS



## WELCOME NORTH MINES LTD. (N.P.L.)

PROJECT: ALICE

SCHEDULE OF DISBURSEMENTS FOR THE PERIOD:

December 31st, 1978

|                                   | Forward From<br>Previous<br>Report | Current<br>Period | Total Year<br>To Date | Budget for the<br>Year |
|-----------------------------------|------------------------------------|-------------------|-----------------------|------------------------|
|                                   | \$                                 | \$                | \$                    | \$                     |
| 05 - Assays & Geochem             |                                    |                   |                       |                        |
| 10 - Camp Maintenance             |                                    |                   | 2.99                  |                        |
| 15 - Consulting Fees              |                                    |                   |                       |                        |
| 20 - District-Phone/Expediting    |                                    |                   | 16.80                 |                        |
| 25 - Drilling                     |                                    |                   |                       |                        |
| 30 - Field Supplies/Equipment     |                                    |                   | 244.59                |                        |
| 35 - Fixed Wing Aircraft          |                                    |                   |                       |                        |
| 40 - Fuel                         |                                    |                   |                       |                        |
| 45 - Linecutting                  |                                    |                   | 1,220.00              |                        |
| 55 - Property Acq. & Option Pay's |                                    |                   | 22.50                 |                        |
| 60 - Property Maintenance         |                                    |                   |                       |                        |
| 70 - Rotary Wing-Helicopter       |                                    |                   | 566.36                |                        |
| 75 - Salaries - Regular           |                                    |                   | 884.10                |                        |
| " " Prospector Paym's             |                                    |                   |                       |                        |
| 85 - Surveys - Geochem.           |                                    |                   |                       |                        |
| 90 - Surveys - Geophysical        |                                    |                   |                       |                        |
| 95 - Surveys - Other              |                                    |                   |                       |                        |
| 100 - Transportation - Misc.      |                                    |                   | .86                   |                        |
| 105 - Trenching                   |                                    |                   |                       |                        |
| 120 - Misc. indirect              |                                    |                   | 115.21                |                        |
| 125 - Administration Fee          |                                    |                   | 307.34                |                        |
| TOTAL                             |                                    |                   | 3,380.75              |                        |

To support attached breakdown of expenditures by property for the period.)

Note: Expenditure amounts over budget include costs incurred in 1978 and related to the 1977 program and final report.

APPENDIX II

AFFIDAVIT SUPPORTING SUMMARY OF COSTS

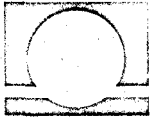

WELCOME NORTH MINES LTD. (N.P.L.)  
1027-470 Granville St., Vancouver, B.C. V6C 1V5 Telephone (604) 687-1658

APPENDIX II

AFFIDAVIT SUPPORTING SUMMARY OF COSTS

I, Frank Foster, staff geologist, Welcome North Mines Ltd. (N.P.L.) of Vancouver, British Columbia, do hereby state that, to the best of my knowledge and belief, the Statement of Costs presented in this report "LINECUTTING REPORT ON THE ALICE 1-48 CLAIM GROUP" is both correct and true.

H.F. Foster

H.F. Foster

DATE: January 31, 1979

SWORN BEFORE ME at the City of Vancouver, in the Province of British Columbia, this 31st day of January, 1979.

Tom Smith

A Notary Public in and for the Province of British Columbia.