

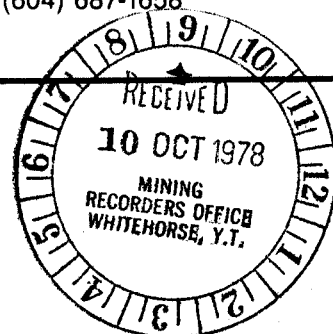

**WELCOME NORTH MINES LTD. (N.P.L.)**

1027-470 Granville St., Vancouver, B.C. V6C 1V5 Telephone (604) 687-1658



LINECUTTING REPORT

AL 1-4, KIRK 1-2 AND RIM 1-6 MINERAL CLAIMS

WHITEHORSE MINING DISTRICT

YUKON TERRITORY

N.T.S. 105K-3

Latitude 62°02'N

Longitude 133°04'W

Work Performed During the Period July 15 - August 10, 1978

Vancouver, BC  
September 25, 1978

H.F. Foster

021227

## TABLE OF CONTENTS

	Page
INTRODUCTION	1
MINERAL CLAIMS	1
LOCATION AND ACCESS	1
LINECUTTING	3
STATEMENT OF COST	4
APPLICATION OF COSTS FOR ASSESSMENT	6
PERSONNEL	7
AFFIDAVIT	8
Fig. 1. CLAIMS AND LOCATION OF LINECUTTING	2

INTRODUCTION

Welcome North Mines Ltd., as Operator of the Woodside Joint Venture Programme with Getty Mining Pacific Ltd., optioned the AL, KIRK, and RIM claims, a group of 12 mineral claims, in 1977, and carried out geological, geophysical and geochemical surveys in 1977 (see "Report on the Geological, Geochemical and Geophysical Surveys and Diamond Drilling and Trenching on the MONI, PMJ, JANE, TELE, KIRK, AL, RIM, EEL and ANGIE Mineral Claims by Graham Scott, May 26, 1978). In July and August of 1978 further linecutting was carried out over the AL, KIRK and RIM claims in preparation for further geophysical and geochemical surveys.

MINERAL CLAIMS

The work being filed under this report covers the following claims in N.T.S. 105K-3 (Fig. 1):

<u>CLAIM</u>	<u>GRANT NUMBERS</u>	<u>DUE DATE</u>
AL 1-4	Y91287-Y91290	October 7, 1978
KIRK 1-2	Y91291-Y91292	October 7, 1978
RIM 1-6	Y91293-Y91298	October 7, 1978

LOCATION AND ACCESS

The AL, KIRK and RIM claims are located in the St. Cyr Range of the southern Yukon, N.T.S. 105K-3. The claims are situated on a ridge top about 25 kilometers southeast of Faro and 7 kilometers from the Robert Campbell Highway. Access to the property can be gained by way of an old cat road connected with the Robert Campbell Highway, or by helicopter from Faro or Ross River.



WELCOME NORTH MINES LTD.

Getty Mining Pacific Ltd.

Woodside Project  
Al, Kirk and Rim Claims  
Claims and  
Location of Linecutting

Scale: 1" = 1/2 mi. Date: Sept. 25/78 N.T.S. 105K-3  
Revised: \_\_\_\_\_ By: F. Foster Fig. 1

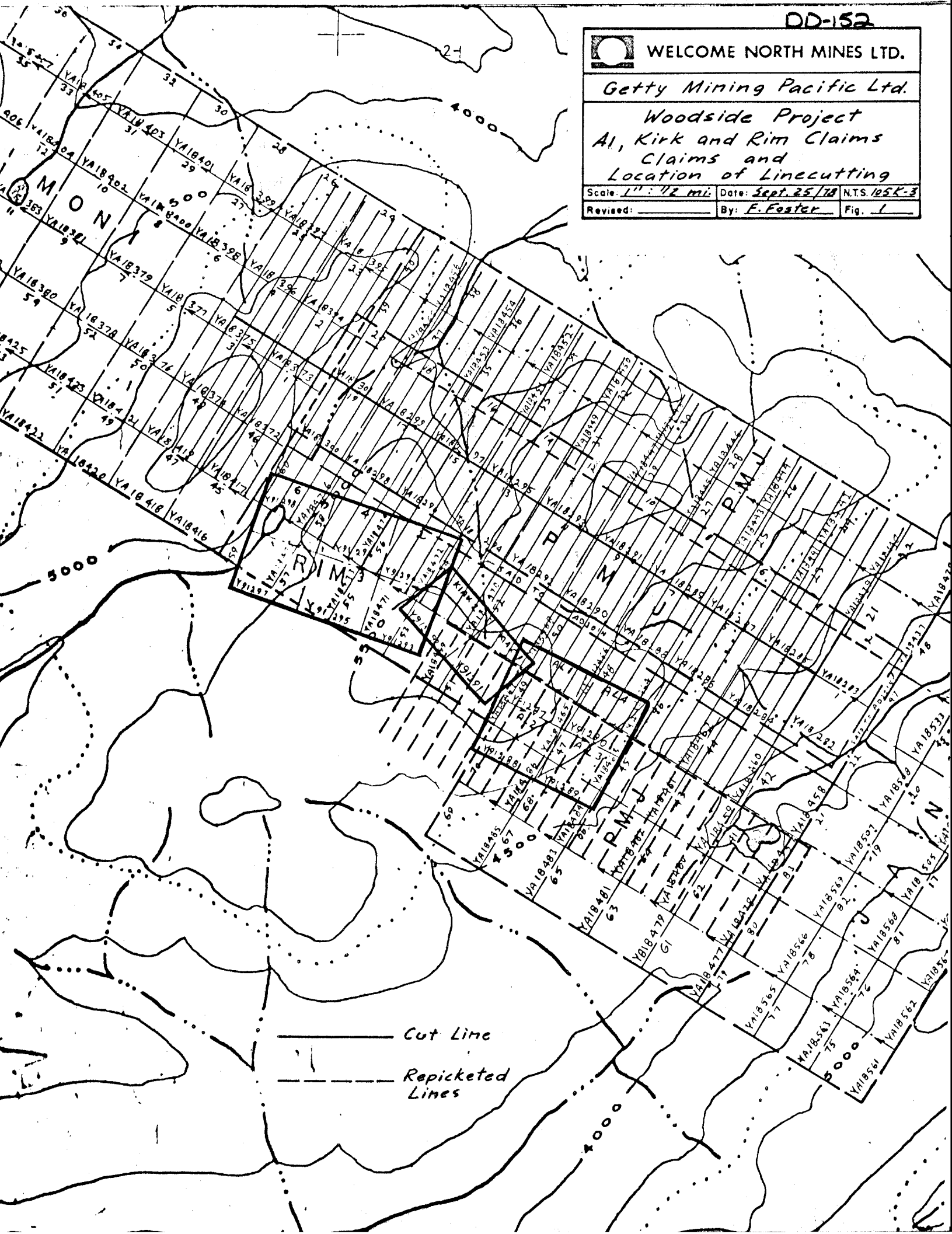

Cut Line

Repicketed Lines

LINECUTTING

Linecutting carried out on the claims consisted of installing new cutline grid and repicketing in slope-corrected metric last year's lines in preparation for geophysical surveys and geochemical surveys. A tieline was installed along the southwestern boundary of the 1977 grid and these previous lines were extended by 900m to the southeast. Pickets were spaced 50m apart, and where new lines were installed in the extreme southeast of the grid the line spacing was 150m (Fig. 1).

STATEMENT OF COSTS

ROTARY WING

<u>Date</u>	<u>Rate</u> \$	<u>Hours</u>	<u>Fuel Cost</u> \$	<u>Total Cost</u> \$
July 15	315/hr.	3.65	3.65 hr. x 1.50/gal. x 25 gal./hr	1,286.50
July 18	315/hr.	1.2	1.2 hr. x 1.50/gal. x 25 gal./hr.	423.00
July 24	175/hr.	2.4	15/hr.	456.00
July 26	175/hr.	1.9	15/hr.	361.00
July 31	175/hr.	0.8	15/hr.	152.00
Aug. 3	175/hr.	1.3	15/hr.	247.00
Aug. 4	175/hr.	0.8	15/hr.	152.00
Aug. 5	175/hr.	2.0	15/hr.	<u>380.00</u>
				<u>3,457.50</u>

Helicopter support was supplied by Bell 47G3B model at a rate of \$175/hour and by Hughes 500D model at a rate of \$315/hour.

$$\begin{aligned} \text{Cost of helicopter per claim} &= \frac{\text{Total helicopter cost}}{\text{Total claims covered by work}} \\ &= \frac{\$3,457.50}{75 \text{ claims}} = \$46.10/\text{claim} \end{aligned}$$

Of the 12 claims involved in this report, the work covers only 10 so that helicopter cost applicable = 10 claims x \$46.10/claim = \$461.00

SALARIES AND WAGES

G. Scott @ \$83.00/day	- 1 day x \$83/day =	\$ 83.00
F. Foster @ \$87.00/day	- 2 days x \$87/day =	174.00
A. Lange @ \$10.00/hour	- 8 hr. x \$10/hr. =	<u>80.00</u>
		\$337.00

Wages applied only to claims reported on in this report.

LINECUTTING

Total line miles of cutline on group = 4.87 miles

Total line miles of repicket line on group  
(as per Fig. 1) = 4.92 miles

Cutline cost = \$265/mile x 4.87 miles = \$1,289.00

Repicketing cost = \$100/mi. x 4.92 miles = 492.00

Total linecutting cost \$1,781.00

TOTAL COST OF ALL WORK CARRIED OUT

\$2,579.00

I, Frank Foster, Geologist, Welcome North Mines Ltd. (N.P.L.) hereby certify that the above itemized Cost Summary can be supported by invoices and docuemnts.

---

H. Frank Foster

APPLICATION OF COSTS FOR ASSESSMENT

Value of Work as per Statement of Costs	\$2,579.00
To be applied to AL, KIRK, RIM GROUP 1	
(AL 1-4, KIRK 1-2, RIM 1, 2, 4, 6) =	
12 claims for 2 years each	<u>\$2,400.00</u>
Excess Credit Not Applied	<u>\$ 179.00</u>



## LIST OF PERSONNEL

Graham H. Scott 10271 Swinton Crescent Richmond, BC	Geologist	August 31	\$83/day
H. Frank Foter 2568 Palmerston Ave. West Vancouver, BC	Geologist	Sept. 21, 22	\$87/day
Angelica Lange 1027 - 470 Granville St. Vancouver, BC	Draftsperson	Sept. 21, 22	\$10/hr.



**WELCOME NORTH MINES LTD. (N.P.L.)**  
 1027-470 Granville St., Vancouver, B.C. V6C 1V5 Telephone (604) 687-1658

September 29, 1978.

AFFIDAVIT SUPPORTING SUMMARY OF COSTS

I, H. FRANK FOSTER, GEOLOGIST

Welcome North Mines Ltd. (N.P.L.) of Vancouver, British Columbia,  
 do hereby state that to the best of my knowledge and belief the  
 statement of costs presented in this report "LINECUTTING REPORT,  
AL 104, KIRK 1-2 AND RIM 1-6 MINERAL CLAIMS"

is both correct and true.

H. F. Foster

SWORN BEFORE ME at the City of  
 Vancouver, in the Province of  
 British Columbia, this 6th day  
 of October, 1978.

J. J. H.

A Notary Public in and for the  
 Province of British Columbia.