

SUPPLEMENTAL GEOCHEMICAL REPORT
ON THE
CAR 57-72 MINERAL CLAIMS,
WHITEHORSE MINING DISTRICT, YUKON

This report has been examined by the Geological Evaluation Unit and is recommended to the Commissioner to be considered as representation work in the amount of \$ see other report for this group rep

Resident Geologist or
Resident Mining Engineer

Considered as representation work under
Section 53 (4) Yukon Quartz Mining Act.

Commissioner of Yukon Territory

Vancouver, B.C.
November 21, 1974.

J.R. Deighton
Geologist.

SUPPLEMENTAL GEOCHEMICAL REPORT
ON THE
CAR 57-72 MINERAL CLAIMS,
WHITEHORSE MINING DISTRICT, YUKON.

The soil samples from the Car 57-72 mineral claims have been run for total molybdenum and cold extractable copper since the formal report on the claims was written. The analysis was done to aid in evaluating the total copper anomaly found on this claim group.

The molybdenum in soils show that there is a coinciding anomaly in this metal with copper. This anomaly is seen to lie on top of or to lie within the total copper anomaly. If one uses the published threshold value for the Dawson Range as found in regional programs carried out by Archer Cathro and Associates Ltd., the anomaly has a range of values from 11 to 184 ppm.

The cold extractable copper values obtained show that there is a cold extractable copper anomaly coincident with the total copper anomaly. The cold extractable anomaly is approximately 1/5 to 1/7 as strong as the total copper anomaly. This indicates that most of the copper present in the total copper analysis came from a close source, ie, that the total copper anomaly is an in place anomaly.

Vancouver, B.C.
November 21, 1974.

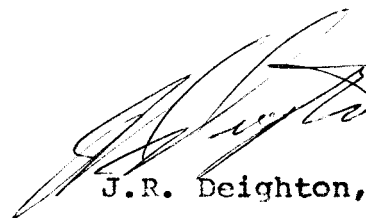

J.R. Deighton,
Geologist.



Free gold.

CHEMEX LABS LTD.

212 BROOKSBANK AVE.
NORTH VANCOUVER, B.C.
CANADA V7J 2C1
TELEPHONE: 985-0648
AREA CODE: 604

• ANALYTICAL CHEMISTS • GEOCHEMISTS • REGISTERED ASSAYERS

CERTIFICATE OF ANALYSIS

TO: Agilis Exploration Services Ltd.,
#107 - 325 Howe St.,
Vancouver 1, B.C.

CERTIFICATE NO. 28452 A

INVOICE NO. 12966

RECEIVED

ATTN: D. Group

ANALYSED Nov. 6/74

SAMPLE NO. :	PPM Molybdenum	PPM Silver	PPB Gold	CoAD Cu
L10W 14S	3			10
L14E 2+00N	38			44
4	22			18
6	20			13
10	1			24
20	< 1			1
22	< 1			1
24+00N	< 1			1
4S	17			21
8	51			26
10	79	0.5	< 30	419
12	78	< 0.5	< 30	313
14	184	0.5	< 30	90
16	132			44
18	1			3
L14E 20S	< 1			1
L18W 10+00N	< 1			3
12	< 1			1
16	< 1			3
20	< 1			1
24	1			3
28+00N	1			3
2S	< 1			1
8	1			1
10	< 1			3
12	2			8
14	2			12
16	1			1
18	< 1			1
20	1			3
L18W 24S	< 1			1
L22E 8+00N	60			100
22	1			1
24	1			1
26	< 1			1
27+50N	< 1			1
2+00S	25			88
4	63			104
L22E 6	163	2.0	30	24
L22E 10+00S	29			7
Std.	25			



MEMBER
CANADIAN TESTING
ASSOCIATION

CERTIFIED BY: *[Signature]*



CHEMEX LABS LTD.

212 BROOKSBANK AVE.
 NORTH VANCOUVER, B.C.
 CANADA V7J 2C1
 TELEPHONE: 985-0648
 AREA CODE: 604

• ANALYTICAL CHEMISTS • GEOCHEMISTS • REGISTERED ASSAYERS

CERTIFICATE OF ANALYSIS

TO: Agilis Exploration Services Ltd.,
 #107 - 325 Howe St.,
 Vancouver 1, B.C.

CERTIFICATE NO. 28451 A

INVOICE NO. 12966

RECEIVED

ATTN: D Group

ANALYSED Nov. 6/74

SAMPLE NO. :	PPM Molybdenum	PPM Silver	PPB Gold	CU Cu & D
L2W 00	7			3
2 OON	1			3
14	< 1			< 1
16	< 1			< 1
18	1			1
20	1			1
22	< 1			3
24	< 1			< 1
26+OON	< 1			1
2 S	16			7
12	11			86
14	18	1.0	<30	90
16	63	0.5	<30	33
20	95			58
22	131			18
24	95	1.0	160	74
26	60	0.5	130	51
L2W 28S	43	1.5	80	22
L6E 4+OON	6			7
14	1			62
18	< 1			< 1
20	< 1			< 1
22A	< 1			1
22B	1			1
25 +50N	< 1			1
10S	45			56
12	56			68
16	25	0.5	50	102
18	108	0.5	190	28
20	77	0.5	190	28
24	34			34
26	37			16
L6E 28S	36			6
L10W 00	2			< 1
14N	< 1			4
16	< 1			1
18	< 1			< 1
22	< 1			< 1
4S	18			13
L10W 12S	5			16
Std.	25			



MEMBER
 CANADIAN TESTING
 ASSOCIATION

CERTIFIED BY: *AP Shep*



CHEMEX LABS LTD.

212 BROOKSBANK AVE.
 NORTH VANCOUVER, B.C.
 CANADA V7J 2C1
 TELEPHONE: 985-0648
 AREA CODE: 604

• ANALYTICAL CHEMISTS • GEOCHEMISTS • REGISTERED ASSAYERS

CERTIFICATE OF ANALYSIS

TO: Agilis Exploration Services Ltd.,
 #107 - 325 Howe St.,
 Vancouver 1, B. C.

CERTIFICATE NO. 28452

INVOICE NO. 13052

RECEIVED

ATTN:

ANALYSED Nov. 21/74

SAMPLE NO. :	PPM
	CX Copper
L10W 14S	10
L14E 2+00N	44
4	18
6	13
10	24
20	1
22	1
24+00N	1
4 S	21
8	26
10	419
12	313
14	90
16	44
18	3
L14E 20S	1
L18W 10+00N	3
12	1
16	3
20	1
24	< 1
28+00N	3
2S	1
8	1
10	3
12	8
14	12
16	1
18	1
20	3
L18W 24S	1
L22E 8+00N	100
22	1
24	< 1
26	1
27+50N	< 1
2+00S	88
4	104
6	24
L22E 10+00S	7
Std.	



MEMBER
 CANADIAN TESTING
 ASSOCIATION

CERTIFIED BY: 



CHEMEX LABS LTD.

212 BROOKSBANK AVE.
NORTH VANCOUVER, B.C.
CANADA V7J 2C1
TELEPHONE: 985-0648
AREA CODE: 604

• ANALYTICAL CHEMISTS • GEOCHEMISTS • REGISTERED ASSAYERS

CERTIFICATE OF ANALYSIS

TO: Agilis Exploration Services Ltd.,
#107 - 325 Howe St.,
Vancouver 1, B.C.

CERTIFICATE NO. 28451

INVOICE NO. 13052

RECEIVED

ATTN:

ANALYSED Nov. 21/74

SAMPLE NO. :	PPM CX Copper
L2W + 00	3
2+00N	3
14	< 1
16	< 1
18	1
20	1
22	3
24	< 1
26+00N	1
2S	4
12	86
14	90
16	33
20	58
22	18
24	74
26	51
L2W 28S	22
L6E 4+00N	7
14	62
18	< 1
20	< 1
22A	1
22B	1
25+50N	1
10S	56
12	68
16	102
18	28
20	28
24	34
26	16
L6E 28S	6
L10W +00	< 1
14N	4
16	1
18	< 1
22N	< 1
4S	13
L10W 12S	16
	8



MEMBER
CANADIAN TESTING
ASSOCIATION

CERTIFIED BY: *[Signature]*



CHEMEX LABS LTD.

212 BROOKSBANK AVE.
NORTH VANCOUVER, B.C.
CANADA V7J 2C1
TELEPHONE: 985-0648
AREA CODE: 604

• ANALYTICAL CHEMISTS • GEOCHEMISTS • REGISTERED ASSAYERS

CERTIFICATE OF ANALYSIS

TO: Agilis Exploration Services Ltd.,
107 - 325 Howe St.,
Vancouver 1, B. C.

CERTIFICATE NO. 28453

INVOICE NO. 13052

RECEIVED

ATTN:

ANALYSED Nov. 21/74

SAMPLE NO. :	PPM Molybdenum	PPM CX Copper
L22E 12+00S	15	18
14	10	8
L22E 30+00S	< 1	1
122W 16+00N	< 1	< 1
18	< 1	< 1
22	2	1
24	< 1	< 1
26	< 1	< 1
28+00N	< 1	< 1
6S	< 1	1
8	< 1	< 1
14	2	8
16	< 1	< 1
20	< 1	3
22	< 1	< 1
L22W 28S	< 1	< 1
L30E 24+00N	< 1	< 1
26	< 1	1
28+00N	< 1	< 1
2S	62	197
4	70	68
6	21	56
8	9	66
10	< 1	1
16	< 1	< 1
18	< 1	1
20	< 1	< 1
L30E 22S	< 1	< 1



MEMBER
CANADIAN TESTING
ASSOCIATION

CERTIFIED BY: 

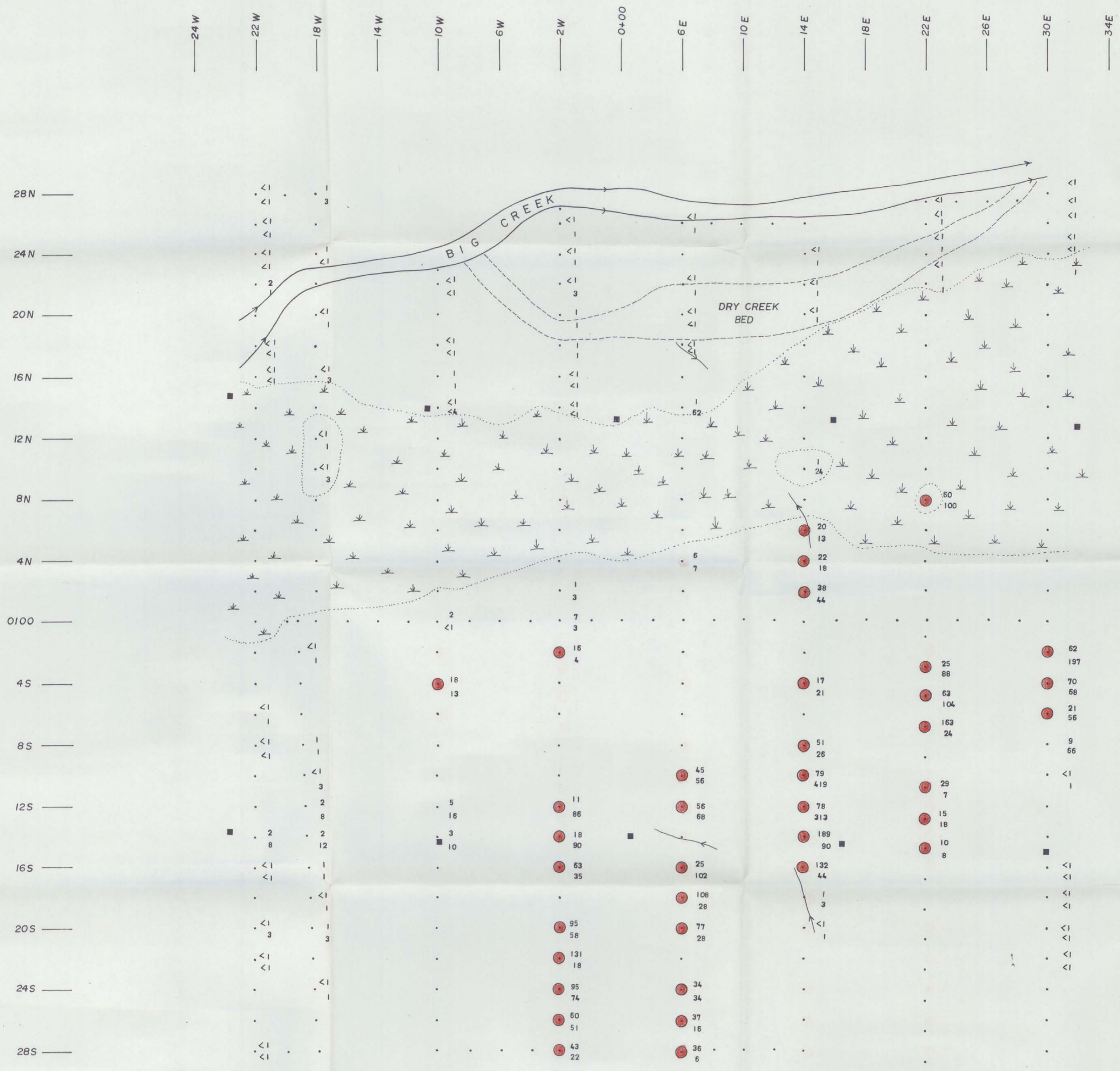

LEGEND

- Survey station
- Claim post
- Drainage
- Marsh
- 63 Geochemical value of molybdenum in p.p.m.
- 104 Geochemical value of cold extractable copper in p.p.m.
- Coloured circle applies to molybdenum only and shows anomalous molybdenum, i.e. above 10 p.p.m.

WESTERN MINES LTD. (NPL)
 CREAM SILVER MINES LTD.(NPL)
 BELMORAL MINES LTD.(NPL)

FREEGOLD MOUNTAIN AREA
 CAR 57-72 MINERAL CLAIMS
 Whitehorse Mining District, Y.T.

**GEOCHEMICAL SURVEY MAP
 FOR MOLYBDENUM AND COPPER**
 IN P.P.M.

SCALE IN FEET
 400 0 400 800 1200

AGILIS ENGINEERING LTD. OCTOBER, 1974