

NORTH-SOUTH SECTION ALONG LINE 50°E

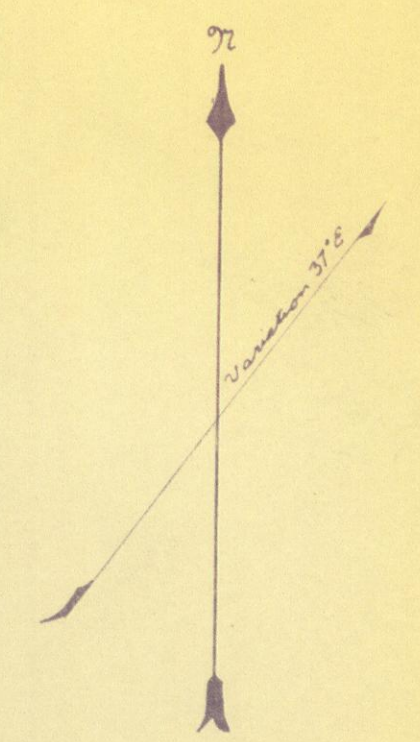

Yukon Gold Company
Topographic and Geologic Map

of the
Keno Hill Area

Mayo District, Y. T. Canada.
To Accompany Report by J. H. Farrell.

Scale 1 inch = 1000 Ft. Contour Interval 50 Ft.
(correction for shrinkage $\frac{1}{16}$ 1018.1')

Legend.

- | | | | | | |
|--------------------------------|----------------|---|-----------------------|----------------------|-----------------------|
| Prospect Pit | Tunnel | Shaft | Road | Keno Hill Co. Claims | Yukon Gold Co. Claims |
| Claims Owned by Yukon Gold Co. | Strike and Dip | Faults and Fractures | Greenstone Quartzite | School | |
| Quartzite | Rhyolite | Silver Lead Veins (Production Type) (Possibly Production) | Quartzite-Pyrite Vein | | |

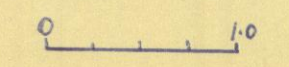

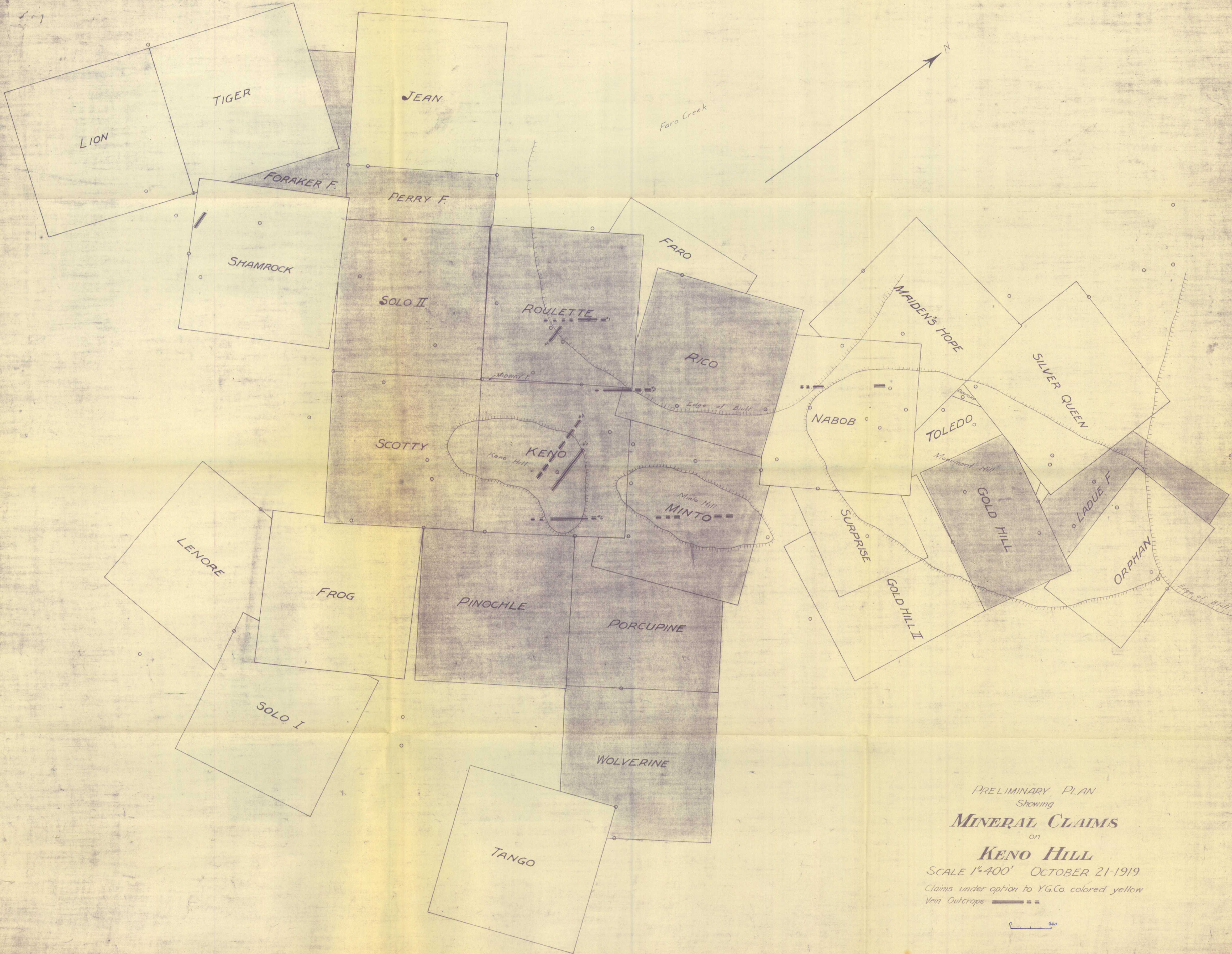

PRELIMINARY PLAN
 Showing
MINERAL CLAIMS
 on
KENO HILL
 SCALE 1"=400' OCTOBER 21-1919
 Claims under option to YG.Co. colored yellow
 Vein Outcrops — — — —

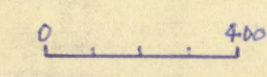

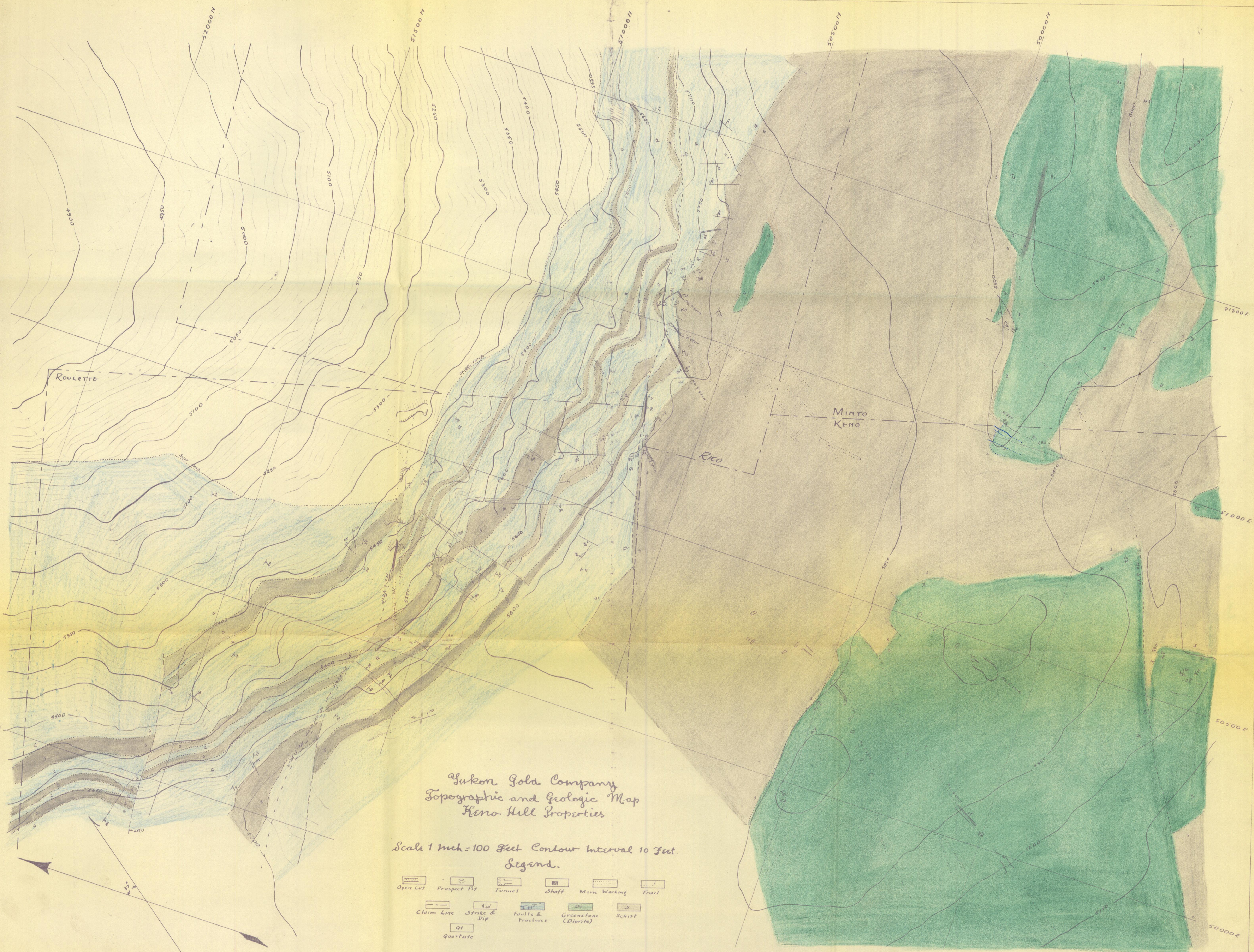

*Yukon Gold Company
Topographic and Geologic Map
Keno Hill Properties*

Scale 1 inch = 100 Feet Contour Interval 10 Feet.

Legend.

- | | | | | | |
|--|--|--|--|--|--|
| | | | | | |
| | | | | | |

*Topography by A. K. Schellinger
Geology by J. H. Farrell
Traces: W. O. M. B. R. D. Dec. 1947*

July 1920

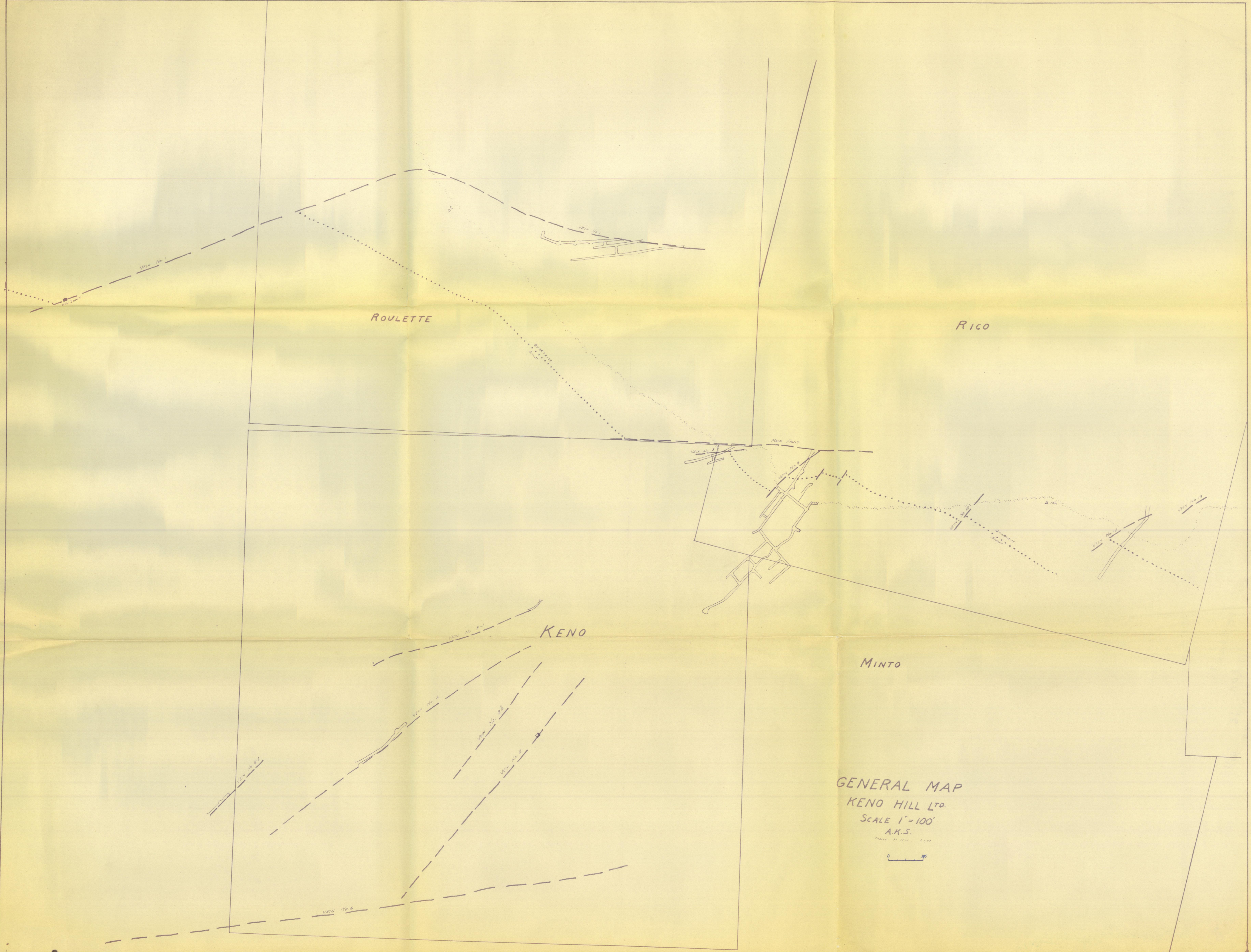

ROULETTE

RICO

KENO

MINTO

GENERAL MAP
KENO HILL LTD.
SCALE 1" = 100'
A.K.S.

