

GOLDEN GATE EXPLORATIONS LTD. (N.P.L.)

KAM 1 - 14 MINERAL CLAIMS

Watson Lake M. D., Y. T. 105 I-12
Lat. 62° 37½' North Long. 129° 45' West

PRELIMINARY REPORT

Appendix "A" to the application
of Golden Gate Explorations
Ltd. (N.P.L.) executed on
February 28, 1973.

By

019895

H. S. Aikins, C.E.T.
Senior Engineering Technician

January 21, 1973.

GOLDEN GATE EXPLORATIONS LTD. (N.P.L.)

KAM 1 - 14 MINERAL CLAIMS

Watson Lake M. D., Y. T. 105 I-12
Lat. 62° 37½' North Long. 129° 45' West

PRELIMINARY REPORT

By

H. S. Aikins, C.E.T.

INTRODUCTION:

A staking rush initiated by what has been described as a significant lead-zinc discovery in the Selwyn Mountains has resulted in some 2,000 mineral claims being located to date. Noranda, Cominco, Dynasty Explorations, and a number of smaller companies, have acquired holdings adjacent to the original location by the Canex-Placer group.

The area now covered by the KAM group was visited on November 28, 1972 and staking commenced two days later. The claims adjoin the north boundary of the ORO group (Noranda). Other interests active at the same time acquired ground adjoining the other boundaries of the KAM group.

PROPERTY:

The property consists of 14 full-sized mineral claims located in accordance with the requirements of the Yukon Quartz Mining Act. The claims are located in the Watson Lake Mining District and all documents are registered at the Mining Records office in Watson Lake. Particulars are as follows:-

<u>Claim Name</u>	<u>Record Numbers</u>	<u>Record Date</u>
KAM 1 - 8	Y 71485 - Y 71492	Dec. 18, 1972
KAM 9 - 14	Y 70893 - Y 70898	Dec. 14, 1972

Claims are shown on Mineral Claim Sheet 105 I-12. Approximate geographic co-ordinates are $62^{\circ} 37\frac{1}{2}'$ north, $129^{\circ} 45'$ west.

As no surveys have been conducted the exact location of the property may vary somewhat from that shown on Figure 2. attached. All claim lines were chained to 1500 feet but no allowance was made for slope correction. Adjoining Oro claim posts were located and used to establish the position of the location line for the Kam Group. Bearing of the location line is 120° true.

LOCATION AND ACCESS:

The property is located about 100 air miles east-north-east of the community of Ross River and about 170 miles north of Watson Lake, the nearest major centre. Several small lakes in the area are suitable for use by float equipped aircraft during summer months. A helicopter would however be required for direct access to the claim groups. It is expected that several machines will be based in the area this season and that local charters will be possible.

The claim group extends from the Pelly River in a westerly direction along a ridge terminating near the height of land. Elevations range from 3800 feet near the river to almost 5500 feet at the summit in the south west corner of the group.

Scrub alder and widely scattered spruce along the valley floor give way to more heavily wooded terrain along the flank slopes. White spruce is the principal species and grows to a diameter of from 6 to 8 inches and extends to a height of perhaps forty feet. The tree line varies according to exposure and may extend to 5000 feet although 4700 feet is about average.

GEOLOGY:

The "Summit Lake Area" is located in the Selwyn Mountains, a series of rugged ranges separated by broad valleys, in which many of the rivers of the region originate.

The area has been glaciated and the main valleys are floored with drift. Esters are well preserved in the smaller valleys.

Rocks of the Selwyn Basin comprise a thick succession of predominately pelitic sediments grading quite abruptly to carbonate rocks as the eastern margin of the basin is approached. The total thickness of palaeozoic sediments may exceed 15000 feet along the geosynclinal axis. A partial hiatus between Upper Cambrian and Devonian strata suggests the presence of an unconformity. In the Mackenzie Mountains to the north and east an unconformity has been mapped at the base of the Upper Ordovician. It is indicated that some Upper Ordovician is included with the unit mapped as Devonian.

A series of small granitic intrusions are located along an arcuate trend located some 6 miles to the north east of present activity. Metamorphism adjacent to these plutons is limited although skarn and minor hornfels have been noted and indications of mineralization are not uncommon.

Structural trends and fold axes are dominantly north west. Tightly compressed and slightly overturned folds characterize the area of current interest. Plunges appear to be shallow to the north west although there is also some suggestion that a north east trending system may also exist.

The lack of marker beds and the intense deformation will continue to provide problems in tracing formation boundaries and structural trends.

Two units are identified in the area of interest. Unit 18b identified as undivided Devonian on figure 2. includes rocks as old as Upper Ordovician. The underlying carbonate is identified as Upper Cambrian.

Sediments of unit 18b include black shales, argillite, siltstone, chert pebble conglomerate and chert. The basal portion of this unit is known to include black graptolitic shale, argillaceous limestone and bedded limestone of the Ordovician-Silurian Road River Formation. This latter formation is tentatively identified as the host for the recently discovered strataform lead-zinc occurrence.

MINERAL OCCURRENCE:

Although several specimens were examined and the location of some trenching was observed from the air, knowledge of the discovery is limited to information released by Placer Development Corporation Ltd. It has been reported that mineralization occurring over a strike length of three miles attained widths of up to 150 feet. The grade of this mineralization is quoted as being 10 - 30 % combined lead-zinc.

A second showing some 12 miles to the north west is known to occur but no grade or thickness data has been reported.

Staking by Placer Development Corp. extends for some 24 miles along the Cambrian-Devonian contact. Ground acquired by Golden Gate Explorations lies at or near the projected extension of this contact.

Specimens of dense grey limestone from an outcrop on the Kam group near the river are assumed to be Upper Cambrian. Black shales mapped as Devonian are found at higher elevation.

SUMMARY AND PROPOSED EXPLORATION:

The presence of a large strataform base metal occurrence within competent beds of low metamorphic

grade provides an excellent basis for the detailed examination of adjacent areas.

Conventional prospecting aided by geochemical analysis of soil and rock specimens is believed to be an essential prerequisite to further work. Geological mapping should also be employed as an aid to the interpretation of other data obtained.

Examination by the Company's Engineer during or following the prospect stage would be required to plan ensuing work.

ESTIMATED FIELD BUDGET:

Mobilization & demobilization	\$ 1,400.00
Camp and Operation	750.00
Prospecting, 1 man month	1,000.00
Geochemical Reconnaissance, 100 samples @ \$6. per sample inclusive	600.00
Geological mapping & Supervision	1,000.00
Engineering Fees & Expenses	750.00
Contingency Allowance, 10%, say	500.00
	<hr/>
TOTAL ESTIMATED BUDGET	\$ 6,000.00
	<hr/> <hr/>

Respectfully submitted,

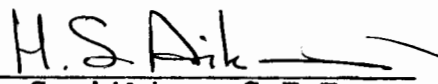

 H. S. Aikins, C.E.T.
 Senior Engineering Technician

January 21, 1973.

KAM
▲ group

Golden Gate Explorations LTD.

SUMMIT LAKE AREA PROPERTY LOCATION MAP

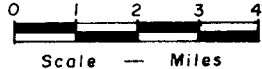
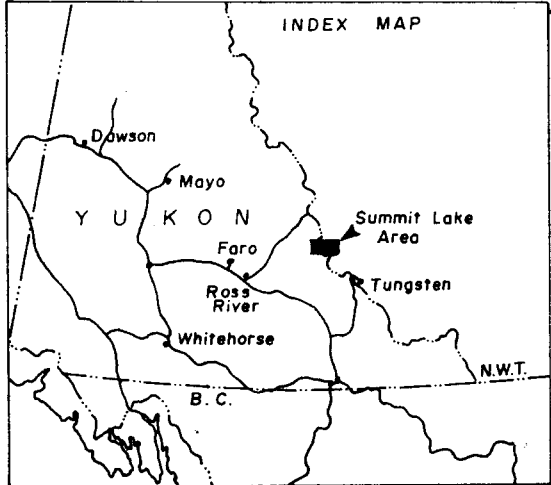
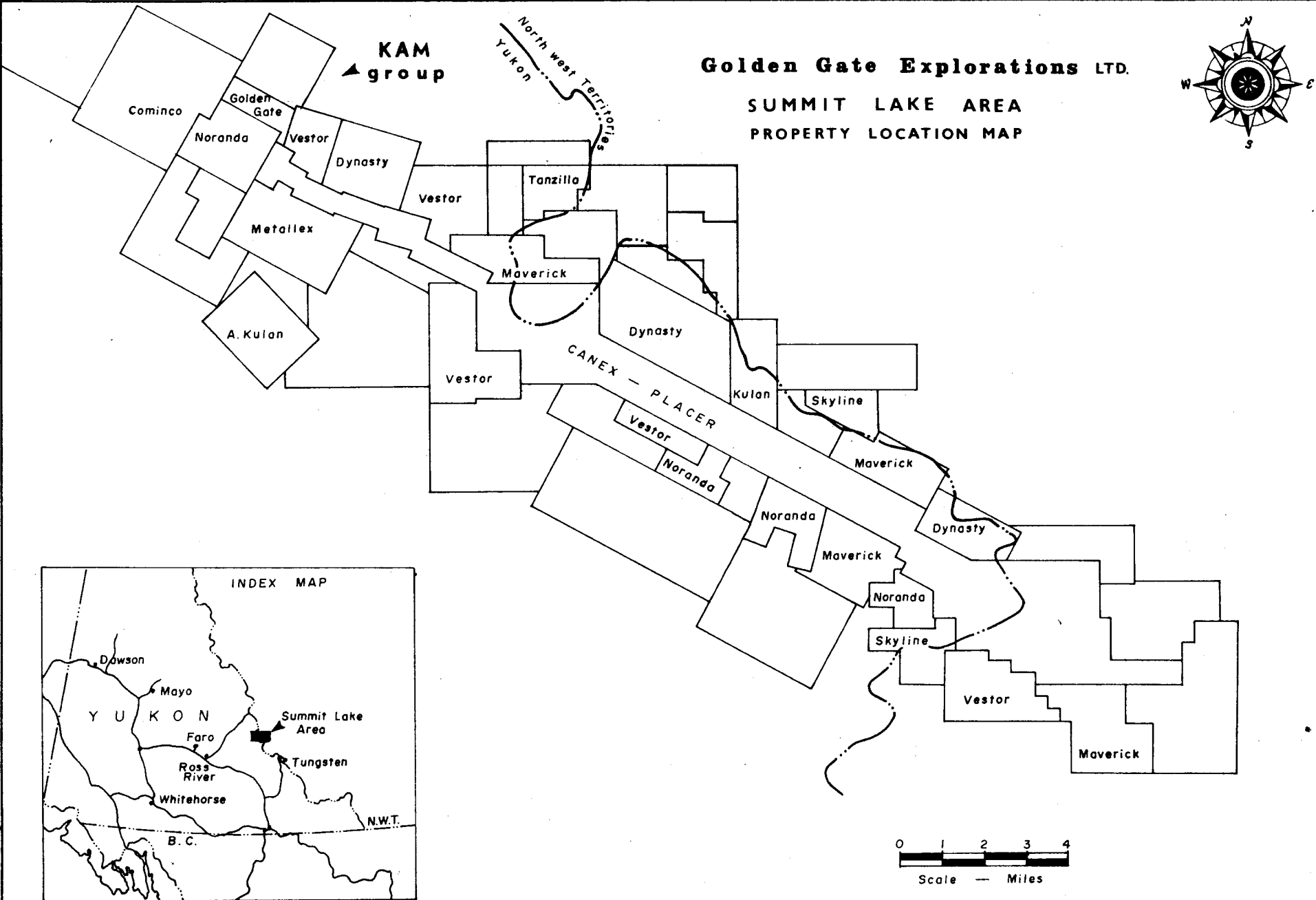
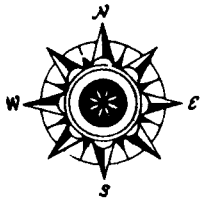

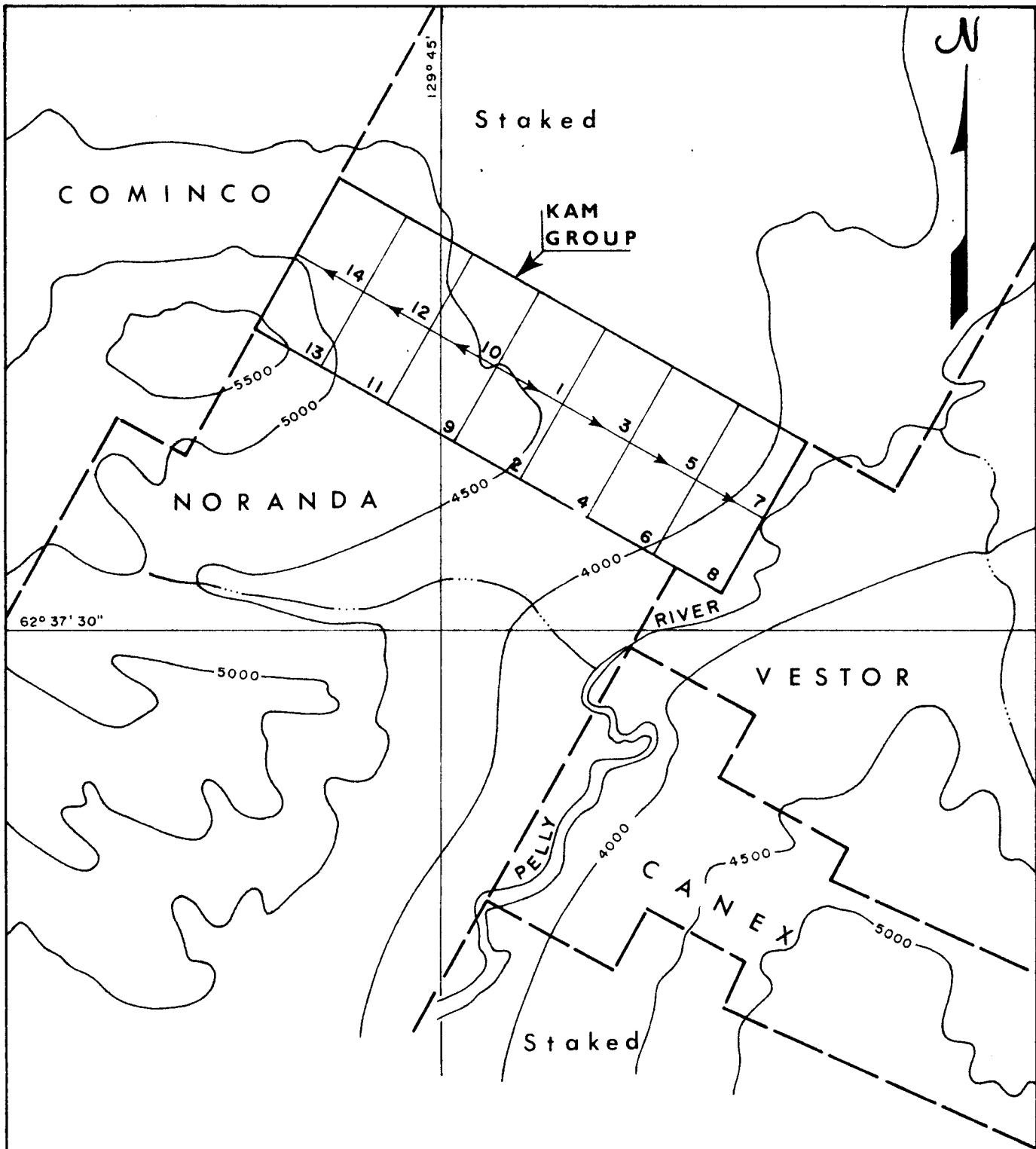

Golden Gate Explorations Ltd. (n.p.l.)

KAM Group

Watson Lake M.D., Y.T.

105 I-12

