

COMINCO LTD.
TRAIL, B.C.

GEOCHEMICAL REPORT ON THE OLGIE 1 TO 16 MINERAL CLAIMS
IN THE WHITEHORSE MINING DIVISION (NTS 105-K-1)
LAT. N 62° 05', LONG. W 132° 25'



Work was done on the claims between August 10, 1966 and
September 15, 1966.

Report by: T.W. MURARO, P. ENG.

Supervised by: T.W. MURARO, P. ENG.

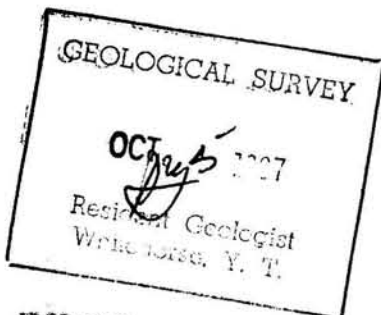

TWM:gmc
July 31, 1967

This report has been examined by
the Geological Evaluation Unit.
Approved as to technical worth by:

D.C. Grindley
RESIDENT GEOLOGIST

Approved as to cost in the amount
of: \$ 3476.29

A.G. Hedderley
RESIDENT MINING ENGINEER

Accepted as representation work
under Section 83(4) Yukon Quartz
Mining Act.

[Signature]
COMMISSIONER OF YUKON

COMINGO LTD.
TRAIL, B.C.

GEOCHEMICAL REPORT ON THE OLGIE 1 TO 16 MINERAL CLAIMS
IN THE WHITEHORSE MINING DIVISION (NTS 105-K-1)
LAT. N 62° 05', LONG. W 132° 25'

TABLE OF CONTENTS

| | <u>Page</u> |
|----------------------------------------------------------------------|-------------|
| INTRODUCTION | 1 |
| GEOLOGY | 1 |
| LINE CUTTING | 1, 2 |
| RESULTS | 2 |
| ATTACHMENTS | 2 |
| (1) Plate 1 - Plan of Geochemical Survey, Olgie Group, 1" = 500'. | |
| (2) Statement of Expenditures. | |
| (3) Statutory Declaration relating to Expenditures. | |

COMINCO LTD.
TRAIL, B.C.

GEOCHEMICAL REPORT ON THE OLGIE 1 TO 16 MINERAL CLAIMS
IN THE WHITEHORSE MINING DIVISION (NTS 105-K-1)
LAT. N 62° 05', LONG. W 132° 25'

INTRODUCTION

The Olgie 1 to 16 mineral claims are in one group south of the east end of Olgie Lake, eight miles north-northwest of Ross River Post, Yukon Territory.

The Olgie claims 1 to 8 were staked on July 22, 1966 by Lawrence Nagy of Cominco Ltd. and Olgie claims 9 to 16 were staked on July 24, 1966 by Theodore Muraro of Cominco Ltd. The 16 claims were recorded on August 2, 1966.

GEOLOGY

To date no bedrock exposures have been located on the Olgie Group. A projection of geological information from adjacent claims to the west (Snowcap and South Groups) suggests that the group is traversed by an easterly trending contact between sediments and volcanics on the south and a granodiorite mass on the north. The sediments represent a part of the group of rocks which contain the known sulfide deposits in the Swim Lakes-Vangorda area.

An airborne geophysical survey on the Snowcap Group to the west indicated a moderate E.M. anomaly extending onto the present Olgie Group. The soil sampling program was designed to test the possibility of a sulfide conductor on the Olgie ground.

LINE CUTTING

During August 1966 the firm of White, Hosford and Impy Ltd. of Whitehorse, Y.T. cut lines on the Olgie Group which included 2.7 miles of transit-controlled baseline with right-angle turnoffs at 400-foot intervals and 17 miles of crosslines chained and picketed at 100-foot intervals.

With the baseline work rated at \$250 per line mile and the crosslines at \$100 per line mile, the total expenditure including transportation charged to this work is \$2,605 broken down as follows:

| | |
|-------------------------------------------------------|-----------------|
| Baselines 2.7 miles @ \$250/line mile | = \$ 675 |
| Crosslines 17 " @ \$100/line mile | = <u>1,700</u> |
| | \$ 2,375 |
| Transportation - line cutting crew from Whitehorse | <u>230</u> |
| Total: | <u>\$ 2,605</u> |

SOIL SAMPLING

Between August 10 and September 15 of 1966 Robert Choumont of Teslin, Y.T. and Terry Wrixon of Vancouver, B.C. collected 328 soil samples on the Olgie claims. Samples were collected at 100-foot intervals on the baselines and 400-foot intervals on the crosslines (see attached plan).

The samples were collected from a brown colored zone in the soil profile which is located immediately below the white to grey Yukon Ash layer which is present in this part of the Yukon. The samples

were prepared and analyzed by Atlas Exploration in their lab at Ross River. Atlas Exploration use a Perkin-Elmer Atomic Absorption unit for geochemical analyses of soil and silt. The charge to Cominco for the analyses was as follows:

| | |
|---------------------------------------------|------------------|
| 328 samples analyzed for Zn @ \$1.50/sample | = \$ 492.00 |
| 328 " prepared for analysis @ \$0.15/sample | = <u>49.20</u> |
| | <u>\$ 541.20</u> |

Expenditures incurred in the collection of samples are as follows:

| | |
|--------------------------------|------------------|
| Labour - 6 man-days | \$ 120.00 |
| Supplies - camp and equipment | 20.00 |
| Transportation from Ross River | <u>30.00</u> |
| | <u>\$ 170.00</u> |

RESULTS

The significant threshold value for Zn in soils in this area is taken as 200 parts per million. The plotted results exhibit two areas in which Zn in the soil exceeds 200 ppm by a maximum factor of about 3. These are not regarded as particularly interesting anomalous values.

The northernmost area outlined by the closed 200 ppm contour is coincident with a low-lying seepage course with a relatively high proportion of organic material in the soil. The general tendency for metal ions to absorb more readily on organic material may constitute the full explanation of this weak anomaly.

The second area within the 200 ppm contour is topographically higher ground and from information to the west is most likely underlain by volcanics. The anomalous values here are slightly lower than the first area described.

It is concluded that the geochemical survey has not provided results which would justify proceeding with direct exploration techniques such as trenching or drilling.

Expenditures covering supervision, compilation of results and preparation of reports are as follows:

4 staff man-days = \$160

ATTACHMENTS:

- 1) Plate 1 - Plan of Geochemical Survey, 1" = 500', on Olgie Group.
- 2) Statement of Expenditures
- 3) Statutory Declaration relating to Expenditures.

Report by:

T.W. Muraro
T.W. Muraro
Professional Engineer

TWN:gms
Trail Expl'n Office, Western District
July 31, 1967

Distribution: Mining Recorder (Whitehorse) (2)
Western Exploration (2)

C. MINCO LTD.
TRAIL, B.C.

1966 EXPENDITURES ON GEOCHEMICAL SURVEY OF THE OLGIE
GROUP - WHITEHORSE M.D.

| | |
|----------------------------------------------------------------------------|--------------------|
| Line cutting contracted to White, Hosford & Impy Ltd., Whitehorse, Y.T. | \$ 2,605.00 |
| Geochemical analyses | 541.20 |
| Collection of soil samples | 170.00 |
| Supervision staff time field and office | <u>160.00</u> |
| Total: | <u>\$ 3,476.20</u> |

Work was done on the claims between
August 10, 1966 and September 15, 1966.

Endorsed by:

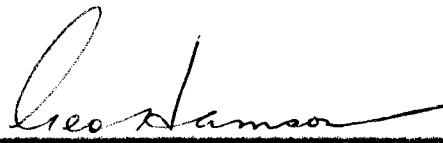
G. Hanson
Accountant, Tadanac Operations

This is Exhibit "A" to the Statutory
Declaration of Theodore William Hararo,
declared before me the ..^{31st} day of
.....July....., A.D. 1967.

A Commissioner for taking Affidavits
for the Province of British Columbia

CANADA } STATUTORY DECLARATION RELATING TO
PROVINCE OF BRITISH COLUMBIA } EXPENDITURES ON A GEOCHEMICAL
TO WIT: } SURVEY OF CERTAIN MINERAL CLAIMS
LOCATED IN THE WHITEHORSE MINING
DIVISION.

I, THEODORE WILLIAM MURARO, Professional Engineer
of the City of Trail, in the Province of British Columbia, DO
SOLEMLY DECLARE:

1. That I am the person who prepared the accompanying
geochemical report as a result of a survey carried out under my
supervision on certain mineral claims owned by Cominco Ltd.
2. That copies of the said report are being filed with
the Mining Recorder in Whitehorse.
3. That attached hereto and marked with the letter
"A" upon which I have signed my name at the time of declaring hereof,
is a statement of expenditures incurred in connection with the geo-
chemical survey of the said claims showing in addition the dates
during which those making the said survey performed their work.

AND I MAKE this solemn declaration conscientiously
believing it to be true and knowing that it is of the same force
and effect as if made under oath and by virtue of the Canada
Evidence Act.

DECLARED before me at the
Municipality of Tadoussac, in the
Province of British Columbia
this 31st day of
July, A.D. 1967.

K. Sweeney
A Commissioner for taking Affidavits for British Columbia

Theodore William Muraro

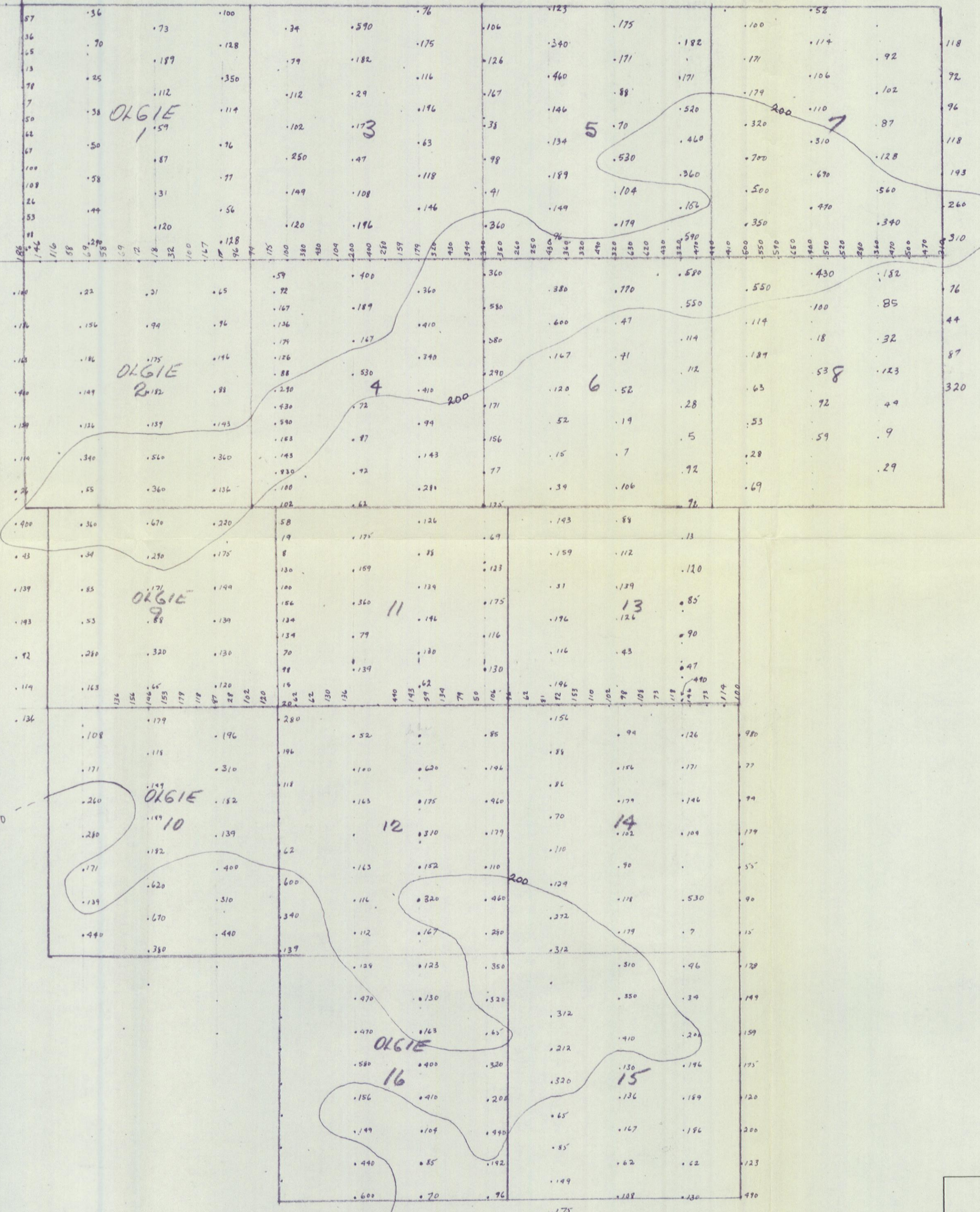
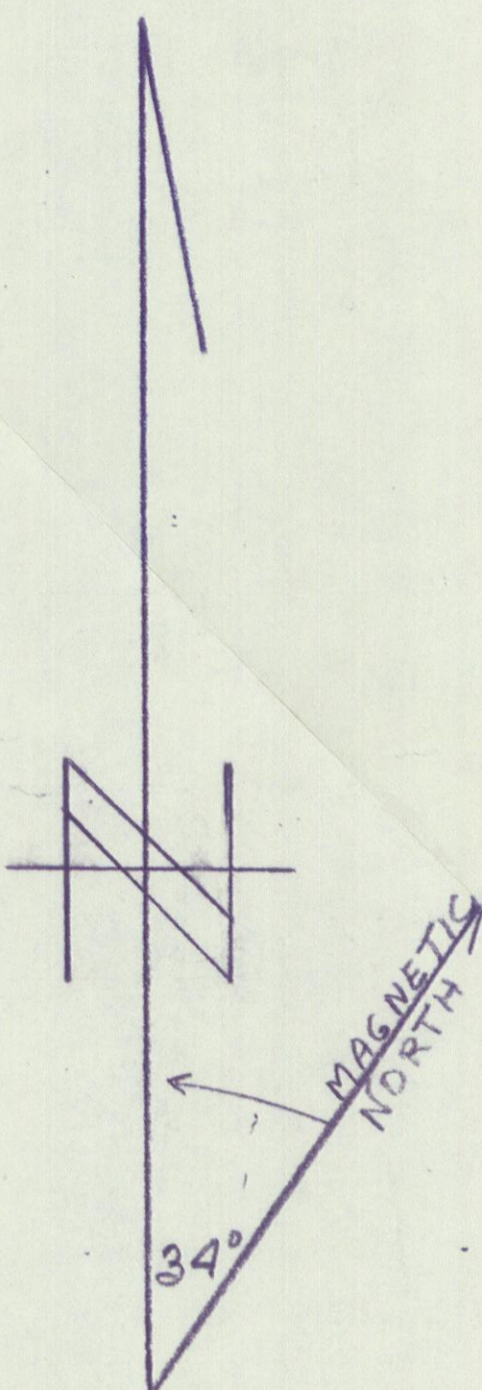
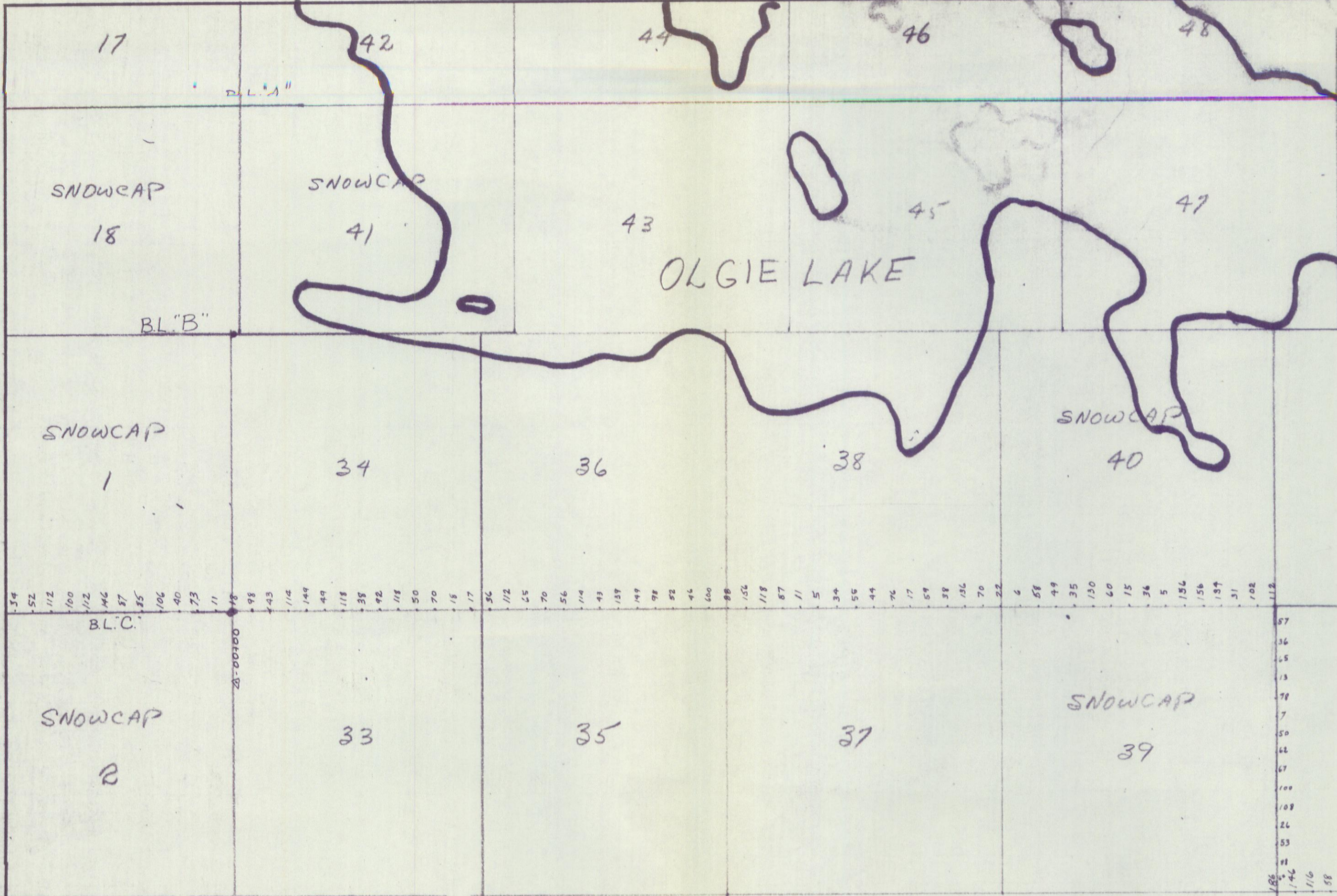

DPI water table sample

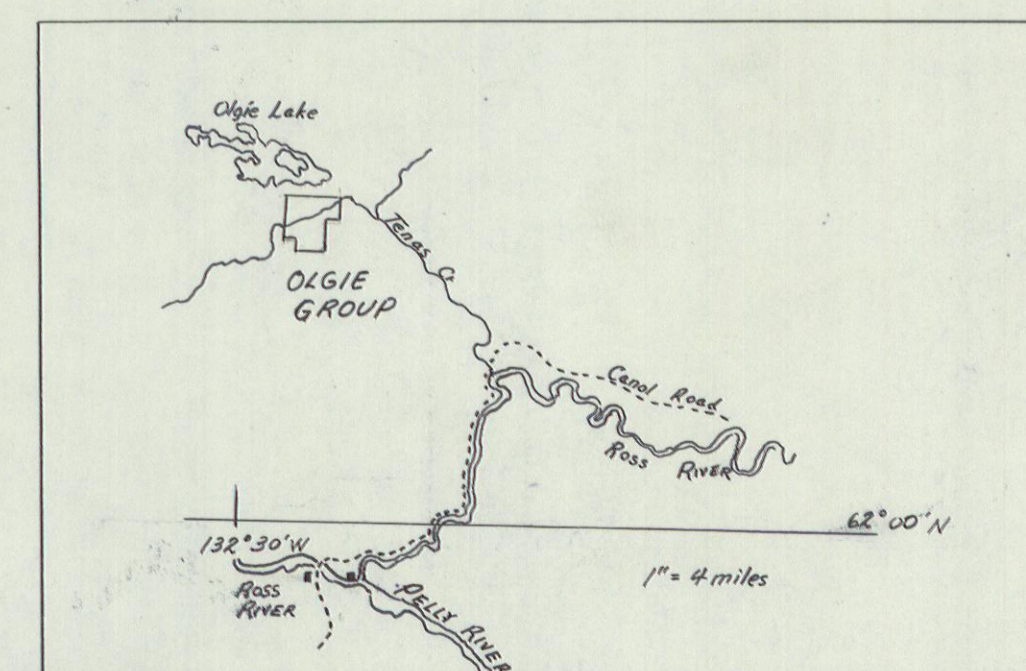

| | | | |
|---------------------------------------------------------------------------------|------------|------------------|----------------|
| The Consolidated Mining and Smelting Company of Canada Limited | | | |
| DRAWN BY: <i>LW</i> | TRACED BY: | | |
| REVISED BY: | DATE: | REVISED BY: | DATE: |
| | | | |
| OLGIE GROUP GEOCHEMICAL SURVEY OLGIE LAKE AREA, YUKON, TERR. Zn IN PPM | | SCALE: 1" = 500' | DATE: DEC 1966 |
| | | | PLATE: |