



Geochemical Survey.

GREEN VALLEY MINES LTD.  
Carcross-Bennet Lake Area.  
Sheet 105-D-2.  
Claims Ruby 1 to 8  
96277 to 96284

by  
EARTH SCIENCES INTERNATIONAL  
Sept - Oct, 1966

H.H. SUTHERLAND, P. ENG.

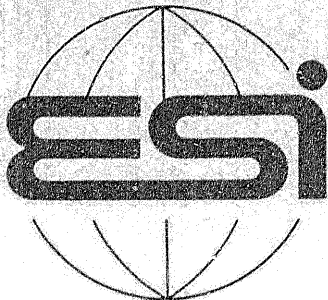

EARTH SCIENCES INTERNATIONAL

**Dominion of Canada**  
PROVINCE OF ONTARIO

County of York

**In the Matter of**

Mining Claims in Carcross Area, Whitehorse map  
area, Yukon Territory, Numbered 96277 to 96284  
incl. (8 claims)

TO WIT:

I, HUGH H. SUTHERLAND, JR.

of the City of Toronto in the County of York

DO SOLEMNLY DECLARE THAT

For the period ending November 2nd, 1966, I and my firm rendered  
services to GREEN VALLEY MINES LIMITED with respect to the above  
noted claims for an amount of \$2,497.62 as set out in the attached  
copy of account.

This declaration is made in order that the expenditures aforesaid may  
be credited against the assessment work with respect to the aforesaid  
claims.

AND I make this solemn Declaration conscientiously believing it to be true, and knowing  
that it is of the same force and effect as if made under oath, and by virtue of "The Canada  
Evidence Act."

DECLARED before me at the City  
of Toronto  
in the County  
of York  
this 27 day of February  
A.D. 1967.

  
Hugh H. Sutherland, Jr.

  
A Commissioner, etc.

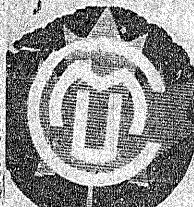

*Carcross - Vancouver*

Air Canada -	Tor. - W.H. - Tor.	\$ 320.00
Air Canada -	Waybill	\$ 25.20
Klondike Helicopters		\$ 81.00
Taxi		\$ 1.50
"		\$ 1.00
"		\$ 1.50
"		\$ .75
"		\$ 6.50
"		\$ 1.00
"		\$ 2.00
C.P.X. Airbill		\$ 37.56
C.P. Baggage		\$ 5.00
G.N.A. - whitehorse to Ross		\$ 62.00
Tilden 265.04/2		\$ 132.92
Truck to whitehorse		\$ 20.00
Boat to Carcross		\$ 50.00
		<hr/>
		\$ 795.23
		<hr/>



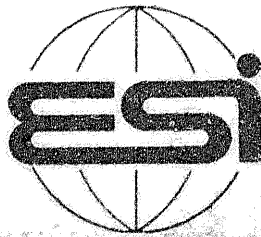

**EARTH SCIENCES INTERNATIONAL** Head Office 12 Richmond Street East, Suite 608 Toronto, Canada Telephone 366-7122  
366-9889

*Geophysics, Geochemistry, Geology  
Photo-interpretation, Economic Analysis  
Drill Supervision, Exploration Expeditions*

Green Valley Mines Ltd.  
Carcross Property,  
Yukon.

November 2nd 1966

To Qualifying Report	\$ 250.00
No Expenses	
Geochemical survey and Line cutting as per contract	\$ 1850.00
Travel & Expenses as appended	
1/2 per property	\$ 397.62
Total Due, Carcross property.....	<u>\$ 2497.62</u>

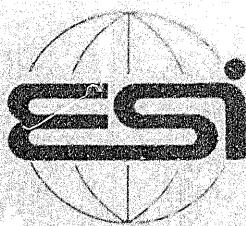

EARTH SCIENCES INTERNATIONAL Head Office: 12 R. Arnold Street East, Suite 608, Toronto, Canada Telephone 366-7122  
366-3083

Geophysics Geochemistry Geology  
Photogrammetry Economic Analysis  
Drill Supervision Exploration Expeditions

Green Valley Mines Ltd.  
Carcross Property,  
Yukon.

November 2nd 1966

To Qualifying Report \$ 250.00

No Expenses

Geochemical survey and Line  
cutting as per contract \$ 1850.00

Travel & Expenses as appended  
1/2 per property \$ 397.62

Total Due, Carcross property..... \$ 2497.62

2497.62

This report was examined by  
the Geological Survey Unit  
Approved as to technical worth by  
D. G. Mackay  
RESIDENT GEOLOGIST  
Approved as to cost at the a. m. of  
\$ 1800.00  
for P. E. Hedden  
Approved as representation work  
under Section 3(4) Yukon Quartz  
Mining Act.  
[Signature]  
COMMISSIONER OF YUKON

A Report on a Survey  
conducted over the ground held by

GREEN VALLEY MINES LTD.

Carcross Area  
Yukon Territories.

---

Green Valley Mines Ltd.

Carcross, Bennet Lake

INDEX

Introduction	Page 1
Property	Page 1
Location & Access	Page 1 - 2
Topography & Facilities	Page 2
General Geology	Page 2
Local Geology	Page 2 - 3
Geochemical Survey	Page 3
Results	Page 3
Conclusions	Page 3 - 4
Recommendations	Page 4
Certificate	after page 4
Geochemical Map	binder at back



A Report on a Survey  
conducted over the ground held by

GREEN VALLEY MINES LTD.

Carcross Area  
Yukon Territories

INTRODUCTION

At the request of the management, a survey using geochemical techniques, was conducted over the claims held by Green Valley Mines Ltd., Carcross - Bennett Lake area, Yukon Territories. The results and ensuing recommendations and conclusions are hereby appended.

PROPERTY

The property comprises eight (8) contiguous claims lying in a rectangular block and identified as Ruby 1 to 8 group. Claim numbers: 96277 to 96284 inclusive.

LOCATION AND ACCESS

The claims are located in the Carcross area, Whitehorse map-area, Yukon Territories. More precisely, they are located four miles due west of the town of Carcross, on the north shore of Bennett Lake, on the south slopes of Grey Mountain (or ridge).

The claims are easily accessible by road, the Alaska Highway connecting some 28 miles east and 30 miles north, or by the White Pass & Yukon Railway which passes through Carcross. Access could also be by float equipped aircraft from Whitehorse, 40 miles to the north.

B

Access from Carcross would be by boat or on foot to the point on the north shore of Bennett Lake.

#### TOPOGRAPHY AND FACILITIES

The topography is very rugged and mountainous, being the east transition portion of the coast mountains as they grade into the Yukon plateau. The Whitehorse trough lies directly to the east and the claims lie on the south slopes of Mount Grey, which rises to a height of 6085 feet above sea level and 3933 feet above the water of Bennett Lake.

The vegetation comprises some scattered white spruce, pine, fir and poplar, but is found only on the valley floors and lower slopes. The higher slopes comprise some low bushes of alder, willow and juniper, but are mainly composed of dwarf grasses and heather.

Water supplies are available from Bennett Lake. Power, telephone and transport facilities are available from Carcross, four miles distant.

#### GENERAL GEOLOGY

The general geology was adequately covered in the qualifying report of February 21st, 1966, and will not be repeated here.

#### LOCAL GEOLOGY

The property is underlain by rocks of the Lower River group of Mesozoic age, which comprise gneisses, andesite and basalt flows, other pyroclastics and limestone and limestone

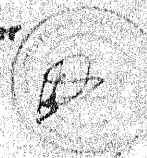

Conf.

breccia.

Mount Gray is composed of Granodiorite Intrusives of the Cretaceous period in the Mesozoic.

Mineralization is found occurring in a 50 foot wide band of limestone at the south end of Grey Ridge.

The copper minerals, chiefly chalcopyrite, occur in the andesitic volcanics in irregular bunches and veins.

#### GEOCHEMICAL SURVEY

The geochemical survey was made over a cut grid of 400 x 100 feet, with a N-S. baseline. Samples were taken from the B/C horizon where possible and where not possible, rock chip samples were taken. These were put in non-contaminative paper bags and appropriately located and marked. The samples were then tested for Pb, Zn and Cu by atomic absorption, spectrographic analysis in parts per million, under controlled laboratory conditions. These results were then calculated, adjusted and plotted for threshold and anomalous values.

#### RESULTS

The results, with a few single exceptions showed no anomalous conditions. Although single readings of anomalous range were present, these must be considered as erratics.

#### CONCLUSIONS

No areas of interest were located by the geochemical survey, therefore it is felt that efforts should be concentrated



Cont.

on the known showing.

RECOMMENDATIONS

In view of the negative results of the geochemical survey, it is recommended that further work be concentrated on the area of the surface showing, and when weather and seasonal conditions permit, a re-evaluation of the ground be made along with some surface exploration.

Respectfully Submitted,

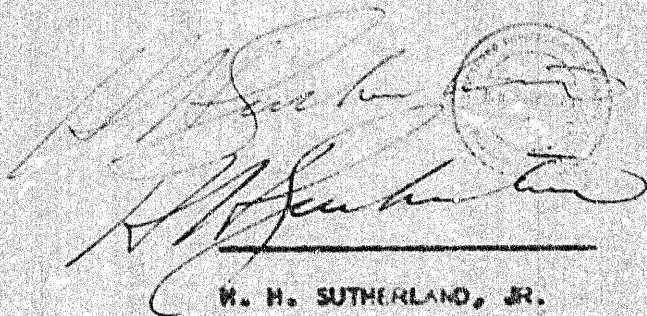
A handwritten signature in cursive script, reading "W. H. Sutherland, Jr.", is written over a circular professional seal. The seal contains some illegible text and a central emblem. Below the signature and seal is a horizontal line.

W. H. SUTHERLAND, JR.

B.A.Sc., P. Eng. M.C.E.

Toronto, Ontario

NOVEMBER 28th, 1966.

CERTIFICATE

I, the undersigned, do hereby certify:

- (1) I am a Mining Geologist with offices located at No. 12 Richmond St. East, in Toronto.
- (2) I have been practicing my profession continuously for over 14 years.
- (3) I am a graduate of the University of Toronto, 1952, with a degree in Mining Engineering.
- (4) I have no interest, nor expect to receive any interest in the property or securities of Green Valley Mines Ltd.
- (5) I am a member of the Association of Professional Engineers of Ontario.
- (6) The above report was based on personal supervision and interpretation of the surveys conducted in Sept., and Oct. 1966.

DATED at Toronto this 28th day of November, 1966.

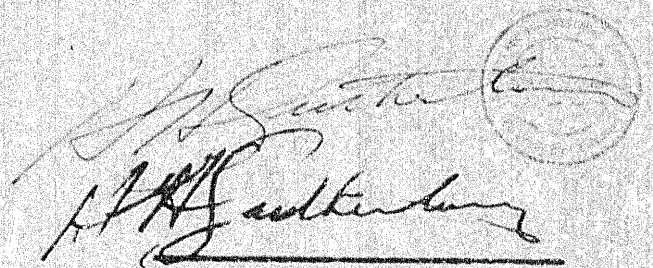

H. W. SUTHERLAND, JR.,

B.A.Sc., P. Eng. M. E.

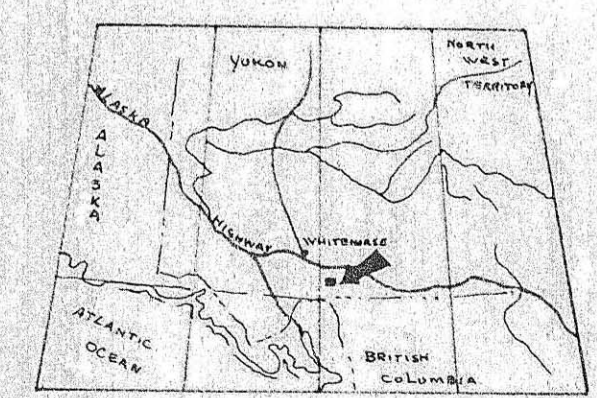
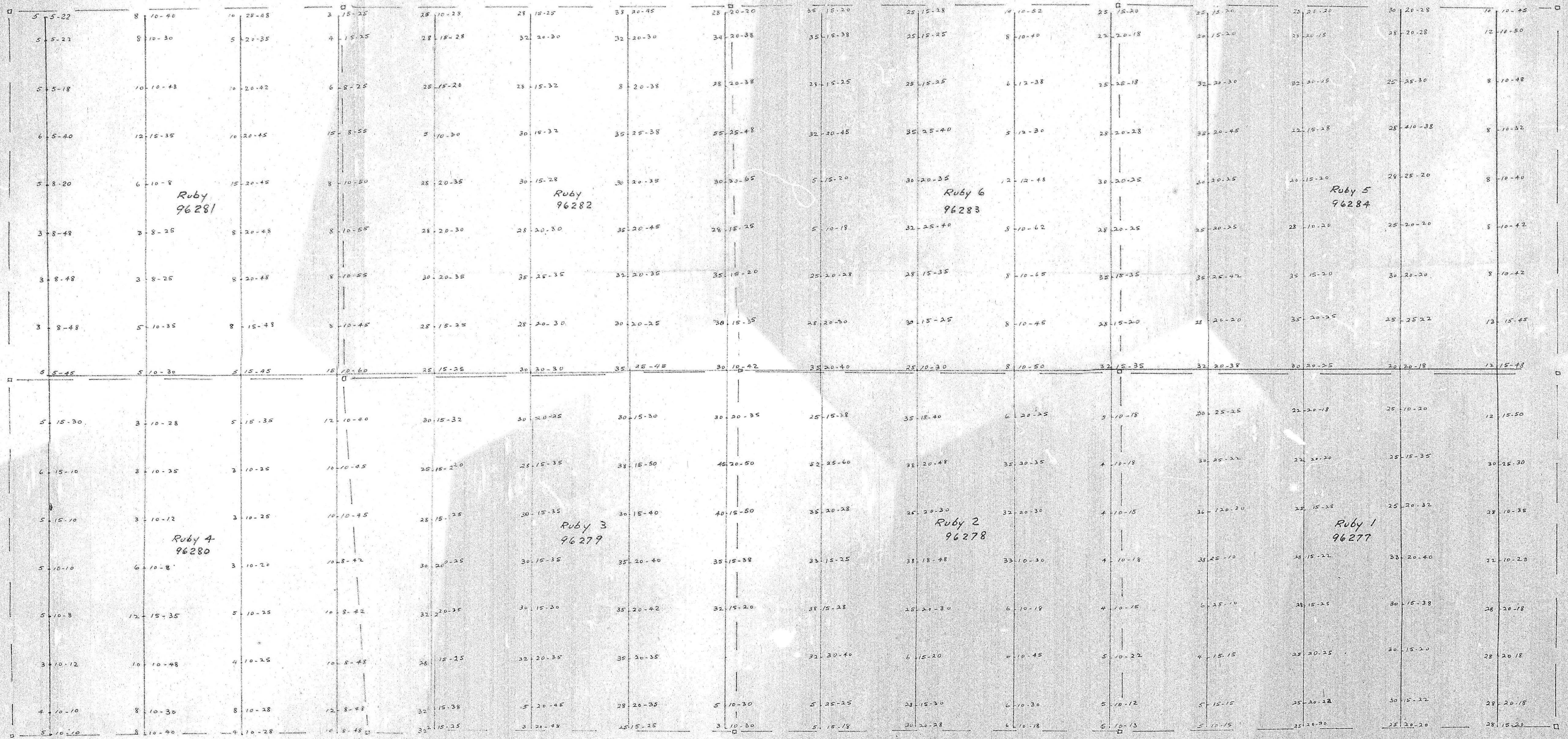

**LEGEND.**

□	SAMPLE LOCATIONS		
□	CHEMICAL ANALYSIS IN PARTS PER MILLION		
	CALCULATED ANOMALY		
	COPPER	LEAD	ZINC
	16 ppm	24 ppm	33 ppm
	25	34	43
	45	55	63



**GEOCHEMICAL SURVEY**  
 for  
**GREEN VALLEY MINES LTD.**  
 CARCROSS AREA YUKON  
 by  
**EARTH SCIENCES INTERNATIONAL**  
 TORONTO ONT.

SCALE 1 in = 200 ft.      NOV. 1966

M.V.C.